

# SOUTH DAKOTA STATE HISTORIC PRESERVATION OFFICE HISTORIC SITES SURVEY STRUCTURE FORM



## SITE INFORMATION

\*SURVEY DATE: July 23, 2012                      \*ADDRESS: 45774 314<sup>th</sup> Street  
\*SURVEYOR: Jim Stone                              \*COUNTY: Clay  
\*CITY: Meckling

LOCATION DESCRIPTION: The intersection of South Dakota Highway 50 bi-pass and South Dakota Highway 19, West 3-3/4 miles to 458<sup>th</sup> Ave., turn right (North) about 1/2 mile to 314<sup>th</sup> Street, turn left (West) about 1/4 mile on the right (North) side.

LEGAL DESCRIPTION: SE 1/4 25 - 93 - 53 Meckling Twp.

\*QUARTER 1: SE 1/4                                      OWNER NAME: D. A. Olson & Sons LLC  
\*QUARTER 2: \_\_\_\_\_ OWNER ADDRESS: 31729 455<sup>th</sup> Street  
\*TOWNSHIP: Meckling                                OWNER CITY: Meckling  
\*RANGE: 53    OWNER STATE: South Dakota  
\*SECTION: 25    OWNER ZIP: 57069  
ACRES: 163.16                                      QUAD NAME: \_\_\_\_\_  
OWNER CODE 1: P  
OWNER CODE 2: \_\_\_\_\_  
OWNER CODE 3: \_\_\_\_\_

## HISTORIC SIGNIFICANCE

\*DOE: \_\_\_\_\_ REGISTER NAME: \_\_\_\_\_  
\*DOE DATE: \_\_\_\_\_ MULTIPLE PROPERTY NAME: \_\_\_\_\_  
REASON INELIGIBLE: \_\_\_\_\_

NOMINATION STATUS: \_\_\_\_\_ CATEGORY: \_\_\_\_\_  
DATE LISTED: \_\_\_\_\_ SIGNIFICANCE LEVEL 1: N S L  
REFERENCE NUMBER: \_\_\_\_\_ SIGNIFICANCE LEVEL 2: N S L  
HISTORIC DISTRICT RATING: C or NC  
PERIOD: \_\_\_\_\_ CRITERIA 1: A B C D  
CRITERIA 2: A B C D  
CRITERIA 3: A B C D  
CRITERIA 4: A B C D

SIGNIFICANCE NOTES: \_\_\_\_\_  
\_\_\_\_\_  
\_\_\_\_\_

## STRUCTURE DETAILS

\* = REQUIRED FIELD

**SOUTH DAKOTA STATE HISTORIC PRESERVATION OFFICE  
HISTORIC SITES SURVEY STRUCTURE FORM**



SHPO ID: \_\_\_\_\_

\*PROPERTY NAME: \_\_\_\_\_

OTHER NAME: \_\_\_\_\_

<p>CURRENT FUNCTION: <u>Farm machinery and hay storage</u></p> <p>CURRENT SUBFUNCTION: <u>Hay storage</u></p> <p>HISTORIC FUNCTION: <u>Cattle feeder barn</u></p> <p>HISTORIC SUBFUNCTION: <u>Hay storage</u></p> <p>OCCUPIED: <u>Yes</u> <u>Yes with</u></p> <p>ACCESSIBLE: <u>permission</u></p> <p>STORIES: <u>2</u></p> <p>*DATE OF CONSTRUCTION: <u>1910 to 1920</u></p>	<p>FOUNDATION: <u>Poured concrete</u> <u>Steel roofing</u> <u>over cedar</u> <u>shingles</u></p> <p>ROOF MATERIAL: _____</p> <p>ROOF SHAPE: <u>Gable</u></p> <p>STRUCTURAL SYSTEM: <u>Balloon framing</u> <u>Livestock feeder</u> <u>barn</u></p> <p>STYLE: _____</p> <p>TYPE: <u>Cattle feeder barn</u> <u>2x6, 1x12 vertical</u> <u>siding, steel</u></p> <p>WALLS: _____</p> <p>SIGNIFICANT PERSON: <u>Steel family</u></p> <p>CULTURAL AFFILIATION: _____</p>
---	---

**ALTERED/MOVED NOTES:** Original site. Appears to have a new poured concrete foundation and a new concrete floor. Walls and roof have been covered with steel roofing. Doors and windows covered with steel roofing. Four windows have been replaced aluminum combination windows. Two 12'x8' and one 18'x14' overhead doors have been installed on the South wall

**INTERIOR NOTES:** Has two 2x6 walls 24' high and 24' between to support the center of the rafters. The 24' high walls have 2x6 studs 4' O.C. 2x8 joists 4' O.C. above the East 13' for a hayloft and 2x8 joists 2' O.C. on the West 13' for a hayloft and grain storage. The 24' high walls have 4' of boards at the bottom and are open to the roof, except two rows of 2x6 horizontal bracing.

**OTHER NOTES:** Windows were 9"x12" four light, two windows close together with 4' to 6' between all along on the East and West walls. The exterior walls are 2x6, 4' O.C. with horizontal 2x4 nailers 3' O.C. for the 1x12 vertical siding.

**\*PHYSICAL NOTES:** Barn is in good condition. This barn with the ground to peak center hayloft and The two side haylofts could hold over 150 tons of loose hay.

This was the Steel Hay Ranch. They cut native grass hay, baled it and had it shipped out by the railroad from Meckling. They employed many men during the haying season. The prairie west, north and east of Meckling is very heavy blue clay and remained native prairie until larger tractors were able to plow up the sod and start farming this area.

\*UTM ZONE: \_\_\_\_\_

\*RESTRICTED: Y or N

\*UTM EASTING: \_\_\_\_\_

\*UTM NORTHING: \_\_\_\_\_

\* = REQUIRED FIELD

**SOUTH DAKOTA STATE HISTORIC PRESERVATION OFFICE  
HISTORIC SITES SURVEY STRUCTURE FORM**



**SKETCH MAP**

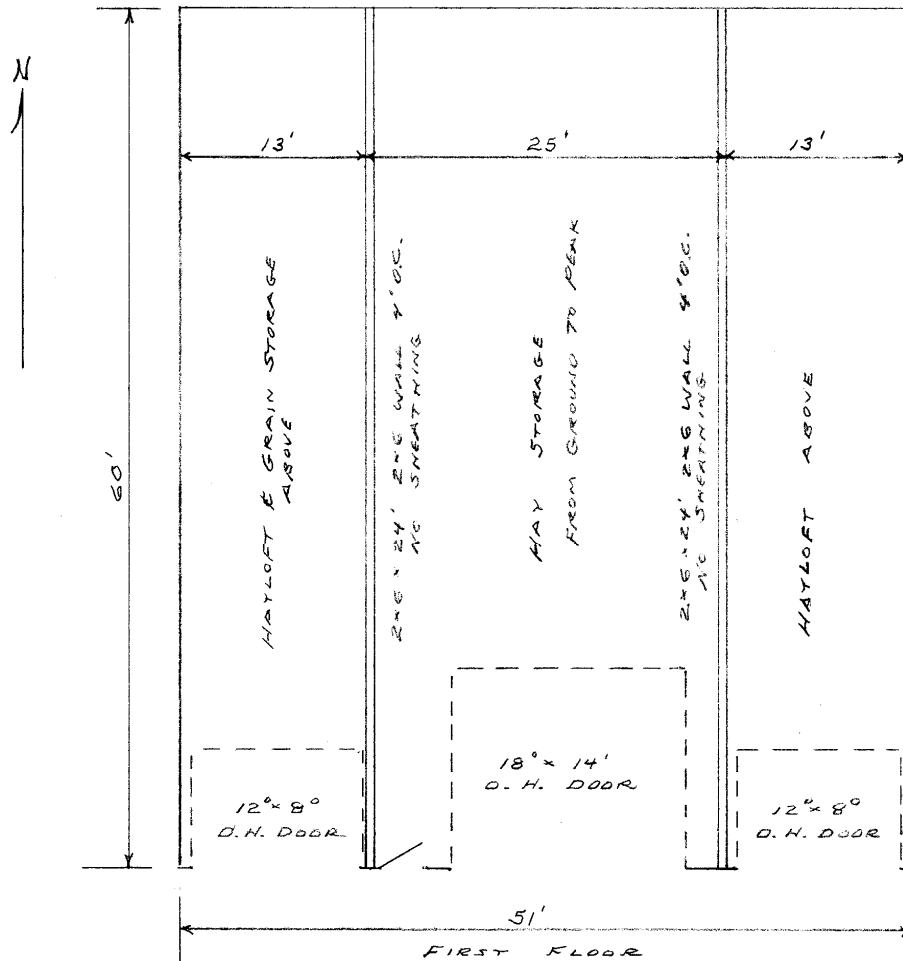

**PHOTOGR**

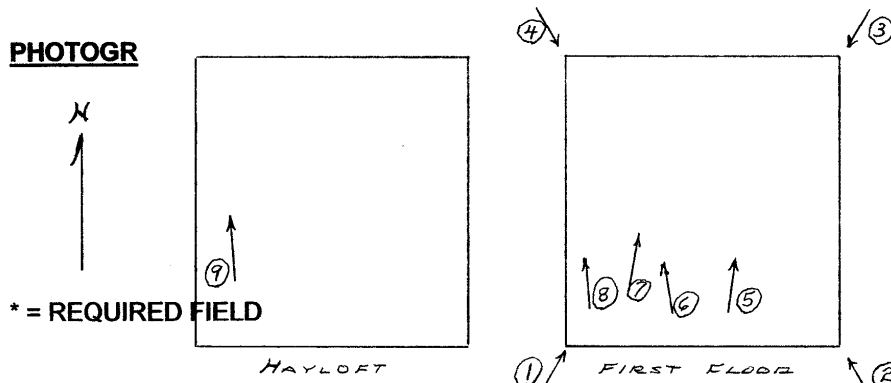

\* = REQUIRED FIELD

\* = REQUIRED FIELD

**SOUTH DAKOTA STATE HISTORIC PRESERVATION OFFICE  
HISTORIC SITES SURVEY STRUCTURE FORM**

**SKETCH MAP**

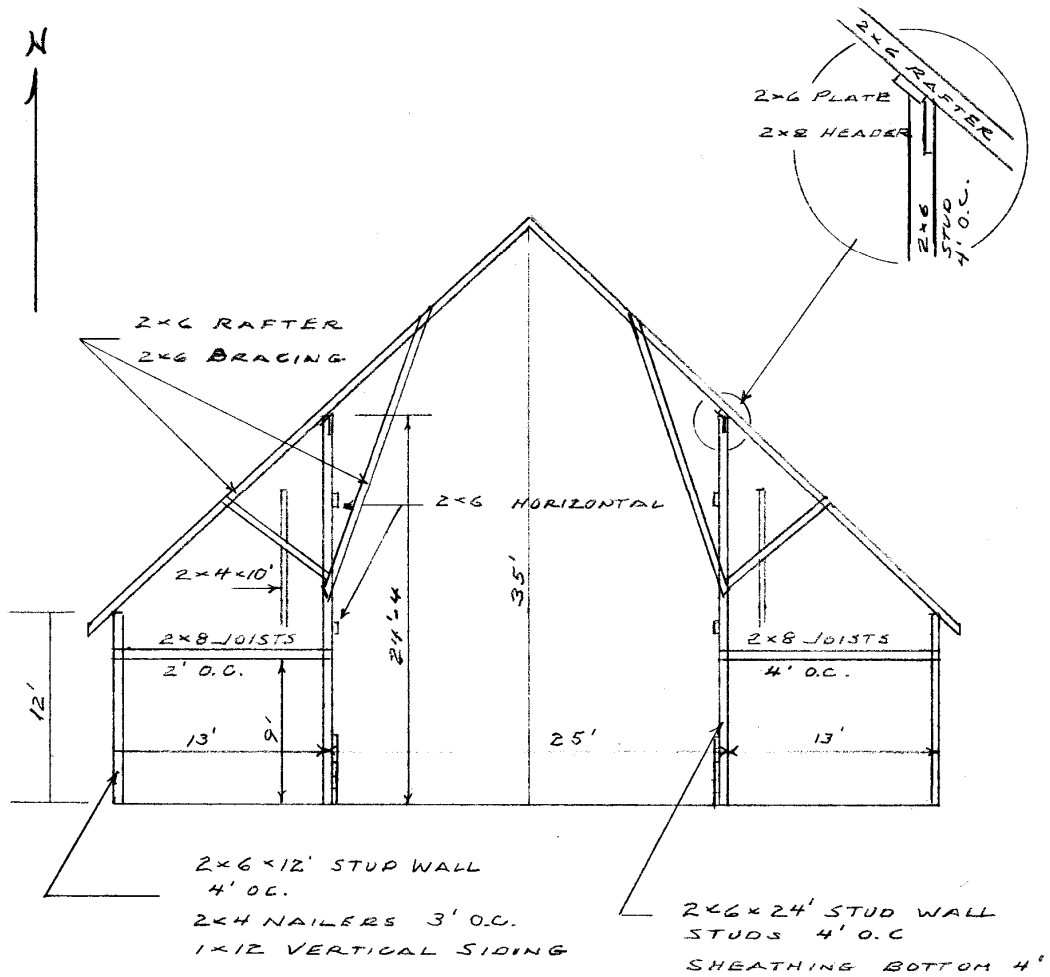

**PHOTOGR**

\* = REQUIRED FIELD

\* = REQUIRED FIELD

**SOUTH DAKOTA STATE HISTORIC PRESERVATION OFFICE  
HISTORIC SITES SURVEY STRUCTURE FORM**



**PHOTOGRAPHER:** Jim Stone  
**DATE OF PHOTO:** July 23, 2012

**ROLL NUMBER:** \_\_\_\_\_  
**PHOTO NUMBER:** 1  
**CAMERA DIRECTION:** Looking NE, SW corner



**PHOTOGRAPHER:** Jim Stone  
**DATE OF PHOTO:** July 23, 2012

**ROLL NUMBER:** \_\_\_\_\_  
**PHOTO NUMBER:** 2  
**CAMERA DIRECTION:** Looking NW, SE corner

\* = REQUIRED FIELD



**SOUTH DAKOTA STATE HISTORIC PRESERVATION OFFICE  
HISTORIC SITES SURVEY STRUCTURE FORM**



**PHOTOGRAPHER:** Jim Stone  
**DATE OF PHOTO:** July 23, 2012

**ROLL NUMBER:** \_\_\_\_\_  
**PHOTO NUMBER:** 3  
**CAMERA DIRECTION:** Looking SW, NE corner



**PHOTOGRAPHER:** Jim Stone  
**DATE OF PHOTO:** July 23, 2012

**ROLL NUMBER:** \_\_\_\_\_  
**PHOTO NUMBER:** 4  
**CAMERA DIRECTION:** Looking SE, NW corner

\* = REQUIRED FIELD

**SOUTH DAKOTA STATE HISTORIC PRESERVATION OFFICE  
HISTORIC SITES SURVEY STRUCTURE FORM**



**PHOTOGRAPHER:** Jim Stone  
**DATE OF PHOTO:** July 23, 2012

**ROLL NUMBER:** 5  
**PHOTO NUMBER:** 5

**First floor, looking North,  
2x6 wall x 24' high,  
supports rafters, East  
side**

**CAMERA DIRECTION:** side



**PHOTOGRAPHER:** Jim Stone  
**DATE OF PHOTO:** July 23, 2012

**ROLL NUMBER:** 6  
**PHOTO NUMBER:** 6

**First floor, 2x6 wall 24'  
high supporting rafters,  
West side**

**CAMERA DIRECTION:** side

\* = REQUIRED FIELD

**SOUTH DAKOTA STATE HISTORIC PRESERVATION OFFICE  
HISTORIC SITES SURVEY STRUCTURE FORM**



**PHOTOGRAPHER:** Jim Stone  
**DATE OF PHOTO:** July 23, 2012

**ROLL NUMBER:** \_\_\_\_\_  
**PHOTO NUMBER:** 7

**First floor, looking North,  
wall bracing to the  
hayloft floor, West side**

**CAMERA DIRECTION:** hayloft floor, West side



**PHOTOGRAPHER:** Jim Stone  
**DATE OF PHOTO:** July 23, 2012

**ROLL NUMBER:** \_\_\_\_\_  
**PHOTO NUMBER:** 8

**First floor, looking North  
grain chutes from the  
hayloft.**

**CAMERA DIRECTION:** hayloft.

\* = REQUIRED FIELD



**SOUTH DAKOTA STATE HISTORIC PRESERVATION OFFICE  
HISTORIC SITES SURVEY STRUCTURE FORM**



**PHOTOGRAPHER:** Jim Stone  
**DATE OF PHOTO:** July 23, 2012

**ROLL NUMBER:** \_\_\_\_\_  
**PHOTO NUMBER:** 9

**CAMERA DIRECTION:** Hayloft, West side,  
looking North, hay or  
grain storage and wall  
bracing



## **HISTORY**

This farm located in the SE ¼ of Section 25, Meckling Township, Clay County was homesteaded by Joseph Hayes.

The 1894 Clay County Atlas lists H. Robinson as the owner.

The 1901 Clay County Atlas lists William E. Doyle as the owner.

The 1912 Clay County Atlas lists Thomas J. Steele as the owner.

The 1924 and 1937 Clay County Atlas lists Ella Steele as the owner. The 1937 lists Martin Knutson as the operator (renter).

The 1948 and 1956 Clay County Atlas lists J. A. Doyle as the owner.

**SOUTH DAKOTA STATE HISTORIC PRESERVATION OFFICE  
HISTORIC SITES SURVEY STRUCTURE FORM**

