

**SOUTH DAKOTA STATE HISTORIC PRESERVATION OFFICE
HISTORIC SITES SURVEY STRUCTURE FORM**



SITE INFORMATION

*SURVEY DATE: July 18,2017 *ADDRESS: 44855 308th Street
*SURVEYOR: Jim Stone *COUNTY: Yankton
*CITY: Mission Hill

LOCATION DESCRIPTION: From Vermillion, South Dakota Highway 50 and South Dakota Highway 19 Intersection, 17 miles west on So. Dak. Highway 50 to 448 Ave., turn right (north) 2-1/2 miles to 308th Street, turn right (east) about 1/2 mile, on the right side

LEGAL DESCRIPTION: NW 1/4 & SW 1/4 & SE 1/4 all in the NE 1/4 of Section 36, 36 – 94 – 54, Volin Twp., Yankton County.

*QUARTER 1: NE 1/4
*QUARTER 2: _____
*TOWNSHIP: Volin
*RANGE: 54
*SECTION: 36
ACRES: 159

OWNER NAME: Betty Highland
OWNER ADDRESS: 30424 451st Ave
OWNER CITY: Volin
OWNER STATE: South Dakota
OWNER ZIP: 57072
QUAD NAME: _____

OWNER CODE 1:
OWNER CODE 2:
OWNER CODE 3:

HISTORIC SIGNIFICANCE

*DOE: _____
*DOE DATE: _____
REASON INELIGIBLE: _____

REGISTER NAME: _____
MULTIPLE PROPERTY NAME: _____

NOMINATION STATUS: _____
DATE LISTED: _____
REFERENCE NUMBER: _____
HISTORIC DISTRICT RATING: C or NC
PERIOD: _____

CATEGORY: _____
SIGNIFICANCE LEVEL 1: N S L
SIGNIFICANCE LEVEL 2: N S L
CRITERIA 1: A B C D
CRITERIA 2: A B C D
CRITERIA 3: A B C D
CRITERIA 4: A B C D

SIGNIFICANCE NOTES: _____

STRUCTURE DETAILS

* = REQUIRED FIELD

**SOUTH DAKOTA STATE HISTORIC PRESERVATION OFFICE
HISTORIC SITES SURVEY STRUCTURE FORM**



SHPO ID: _____
 *PROPERTY NAME: _____
 OTHER NAME: _____

CURRENT FUNCTION: Vacant FOUNDATION: Poured concrete
 CURRENT SUBFUNCTION: Vacant ROOF MATERIAL: Steel roofing over cedar shingles
 HISTORIC FUNCTION: Draft horse barn ROOF SHAPE: Gothic round roof
 HISTORIC SUBFUNCTION: Hay and grain storage STRUCTURAL SYSTEM: Balloon framing
 OCCUPIED: Yes STYLE: Gothic round Roof
 TYPE: Draft horse barn
2x6 studs, 1x8 diagonal sheathing, galvanized embossed brick siding

ACCESSIBLE: Yes with permission WALLS: _____

STORIES: 2 SIGNIFICANT PERSON: John B. Olson
Completed
 *DATE OF CONSTRUCTION: Oct. 15, 1929 CULTURAL AFFILIATION: Norwegian

ALTERED/MOVED NOTES: Roof has been re-roofed with steel roofing.

INTERIOR NOTES: Fourteen (14) double horse stalls 8' wide and 10' deep, 12' x10' granary in the NE corner, 12' x 10' harness room, stairs to hayloft and storage for manure bucket in the SE corner. Three (3) 2x8's for posts under three (3) 2x10's for a beam supporting 2x10 floor joists for hayloft floor. Manure track the full length of the barn with a 15' swinging arm out the West side, see photo #1 & #4.

OTHER NOTES: Diagonal sheathing on all for walls, except upper gable ends see photo #14. Gothic round rafters site built from six (6) ply's of 3/4" cedar, three(3) 1x8's and three(3) 1x12's alternated. Outer edge was hand sawn to the required arch for the gothic round roof. Double 8' sliding doors on the East and West ends of the center 10' alley. Twenty (20) 9x12 four light windows on the first floor, 2 of the same on the East hayloft gable end and the same on the West hayloft gable end. Two (2) galv. metal cupola's. Barn originally had 9x12 four light storm windows for the cold months.

*PHYSICAL NOTES: Barn is in very excellent condition. *RESTRICTED: Y or N
 *UTM EASTING: _____
 *UTM NORTHING: _____

***** SITE INFORMATION**

*UTM EASTING: _____

* = REQUIRED FIELD

SOUTH DAKOTA STATE HISTORIC PRESERVATION OFFICE
 HISTORIC SITES SURVEY STRUCTURE FORM

SKETCH MAP

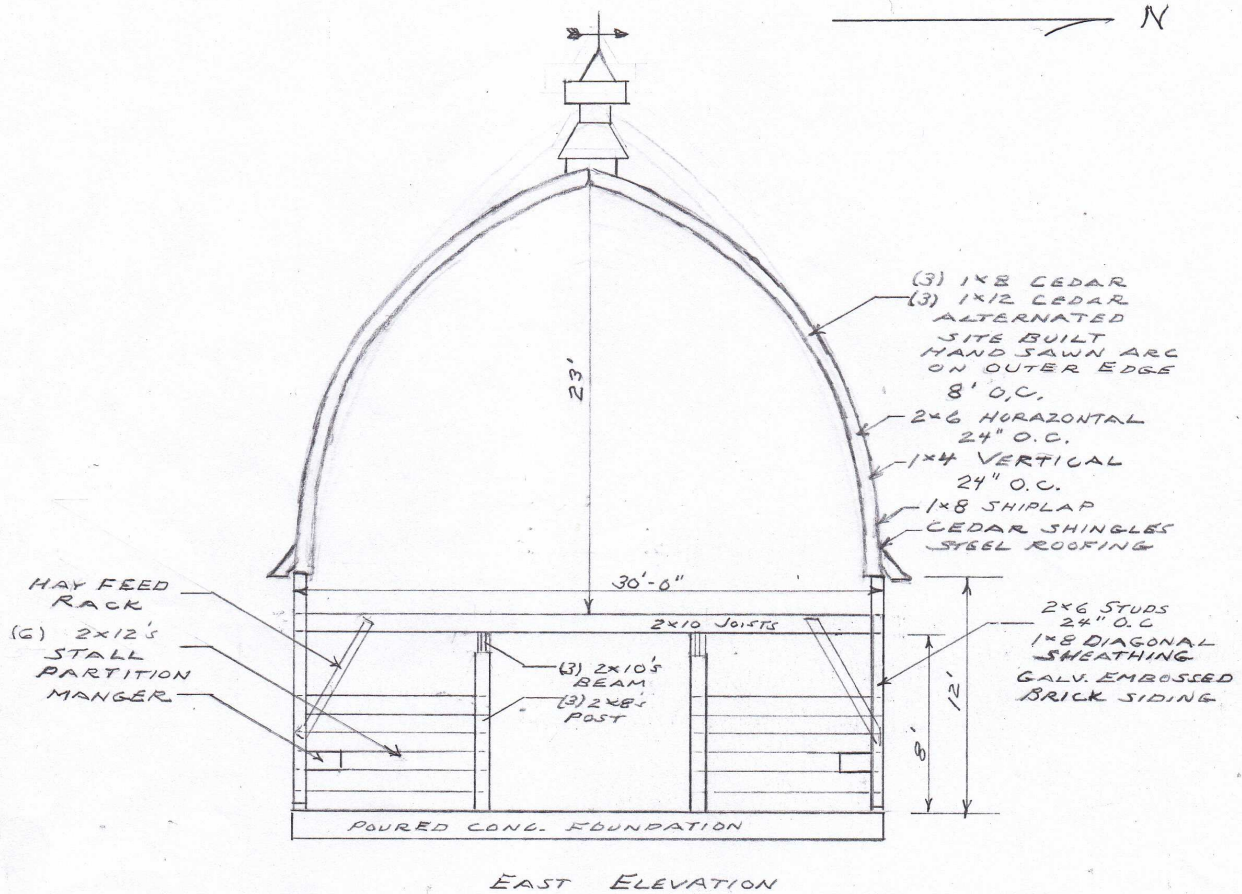

PHOTOGR

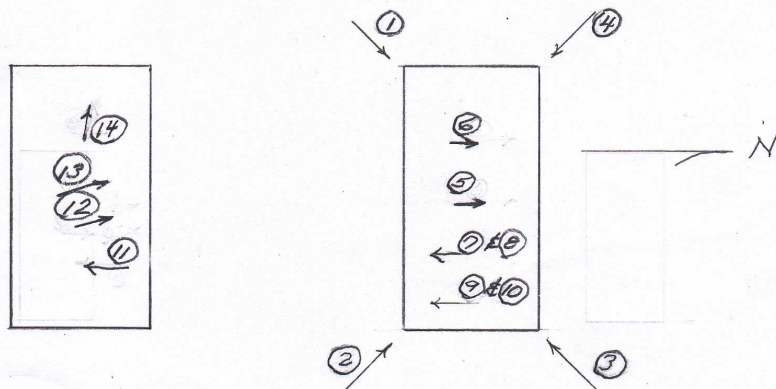

* = REQUIRED FIELD

**SOUTH DAKOTA STATE HISTORIC PRESERVATION OFFICE
HISTORIC SITES SURVEY STRUCTURE FORM**



**SOUTH DAKOTA STATE HISTORIC PRESERVATION OFFICE
HISTORIC SITES SURVEY STRUCTURE FORM**

SKETCH MAP

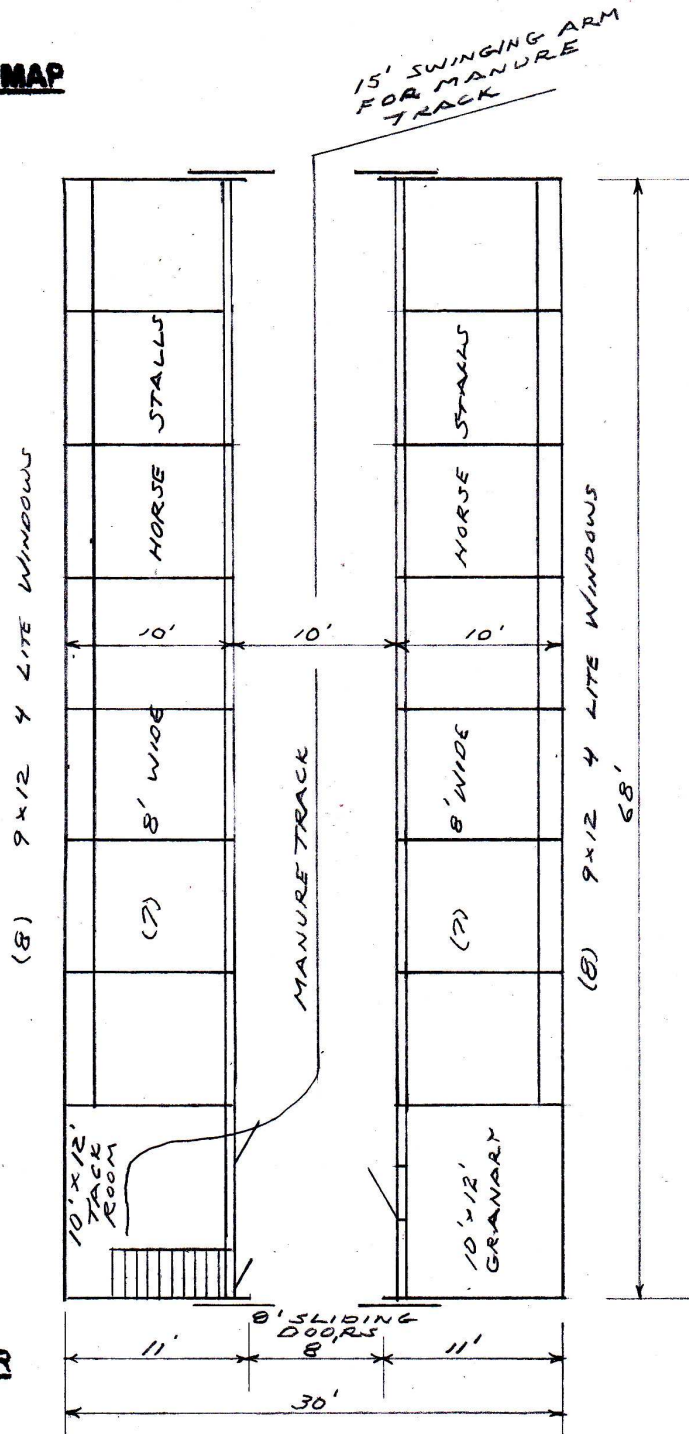

PHOTOGR

(2) 9x12 4 LITE WINDOWS
ON FIRST FLOOR
ALSO SAME IN HAY LOFT
SAME ON OPPOSITE

FIRST FLOOR

**SOUTH DAKOTA STATE HISTORIC PRESERVATION OFFICE
HISTORIC SITES SURVEY STRUCTURE FORM**



PHOTOGRAPHER: Jim Stone
DATE OF PHOTO: July 16, 2017

ROLL NUMBER: _____
PHOTO NUMBER: 1
CAMERA DIRECTION: Looking NE, SW corner



PHOTOGRAPHER: Jim Stone
DATE OF PHOTO: July 16, 2017

ROLL NUMBER: _____
PHOTO NUMBER: 2
CAMERA DIRECTION: Looking NW, SE corner

**SOUTH DAKOTA STATE HISTORIC PRESERVATION OFFICE
HISTORIC SITES SURVEY STRUCTURE FORM**



PHOTOGRAPHER: Jim Stone
DATE OF PHOTO: July 16, 2017

ROLL NUMBER: _____
PHOTO NUMBER: 3
CAMERA DIRECTION: Looking SW, NE corner



PHOTOGRAPHER: Jim Stone
DATE OF PHOTO: July 16, 2017

ROLL NUMBER: _____
PHOTO NUMBER: 4
CAMERA DIRECTION: Looking SE, NW corner

* = REQUIRED FIELD

**SOUTH DAKOTA STATE HISTORIC PRESERVATION OFFICE
HISTORIC SITES SURVEY STRUCTURE FORM**



PHOTOGRAPHER: Jim Stone
DATE OF PHOTO: July 16, 2017

ROLL NUMBER: _____
PHOTO NUMBER: 5

**First floor, looking North,
(3) 2x8's for posts under
(3) 2x10's for a beam
supporting 2x10's for
hayloft floor**

CAMERA DIRECTION: _____



PHOTOGRAPHER: Jim Stone
DATE OF PHOTO: July 16, 2017

ROLL NUMBER: _____
PHOTO NUMBER: 6

**Looking North into one
of 14 double horse stalls.**

**SOUTH DAKOTA STATE HISTORIC PRESERVATION OFFICE
HISTORIC SITES SURVEY STRUCTURE FORM**



PHOTOGRAPHER: Jim Stone
DATE OF PHOTO: July 16, 2017

ROLL NUMBER: 7
PHOTO NUMBER: 7

CAMERA DIRECTION: Looking Southeast through doorway from into harness room, where manure bucket was stored



PHOTOGRAPHER: Jim Stone
DATE OF PHOTO: July 16, 2018

ROLL NUMBER: 8
PHOTO NUMBER: 8

CAMERA DIRECTION: Looking South, looking into the harness room, a young raccoon we woke up.

**SOUTH DAKOTA STATE HISTORIC PRESERVATION OFFICE
HISTORIC SITES SURVEY STRUCTURE FORM**



PHOTOGRAPHER: Jim Stone
DATE OF PHOTO: July 16, 2017

ROLL NUMBER: _____
PHOTO NUMBER: 9

CAMERA DIRECTION: Looking South, stair case to the hayloft, built out of rough sawn cottonwood.



PHOTOGRAPHER: Jim Stone
DATE OF PHOTO: July 16, 2017

ROLL NUMBER: _____
PHOTO NUMBER: 10

CAMERA DIRECTION: Looking South, at the top of the stairs, a second young raccoon who was sound asleep.

**SOUTH DAKOTA STATE HISTORIC PRESERVATION OFFICE
HISTORIC SITES SURVEY STRUCTURE FORM**



PHOTOGRAPHER: Jim Stone
DATE OF PHOTO: July 16, 2017

ROLL NUMBER: _____
PHOTO NUMBER: 11

Looking South in the hay loft, hay fork for lifting hay up into hayloft, like a giant pair of ice tongs

CAMERA DIRECTION: _____



PHOTOGRAPHER: Jim Stone
DATE OF PHOTO: July 16, 2017

ROLL NUMBER: _____
PHOTO NUMBER: 12

Looking NW in the hayloft, six (6) ply, site built rafter, (3) 1x8's and (3) 1x12's alternated, outer edge

CAMERA DIRECTION: sawn by hand.

**SOUTH DAKOTA STATE HISTORIC PRESERVATION OFFICE
HISTORIC SITES SURVEY STRUCTURE FORM**



PHOTOGRAPHER: Jim Stone
DATE OF PHOTO: July 16, 2017

ROLL NUMBER: _____
PHOTO NUMBER: 13

Looking NW in the hayloft. 6 ply cedar rafters, 8' O.C., 2x6's horizontal 2' O.C., 1x4 vertical 2' O. C. with 1x8 sheathing.

CAMERA DIRECTION: _____



PHOTOGRAPHER: Jim Stone
DATE OF PHOTO: July 16, 2017

ROLL NUMBER: _____
PHOTO NUMBER: 14

Looking West in the hayloft, note the diagonal sheathing and the horizontal sheathing above.

CAMERA DIRECTION: _____

* = REQUIRED FIELD

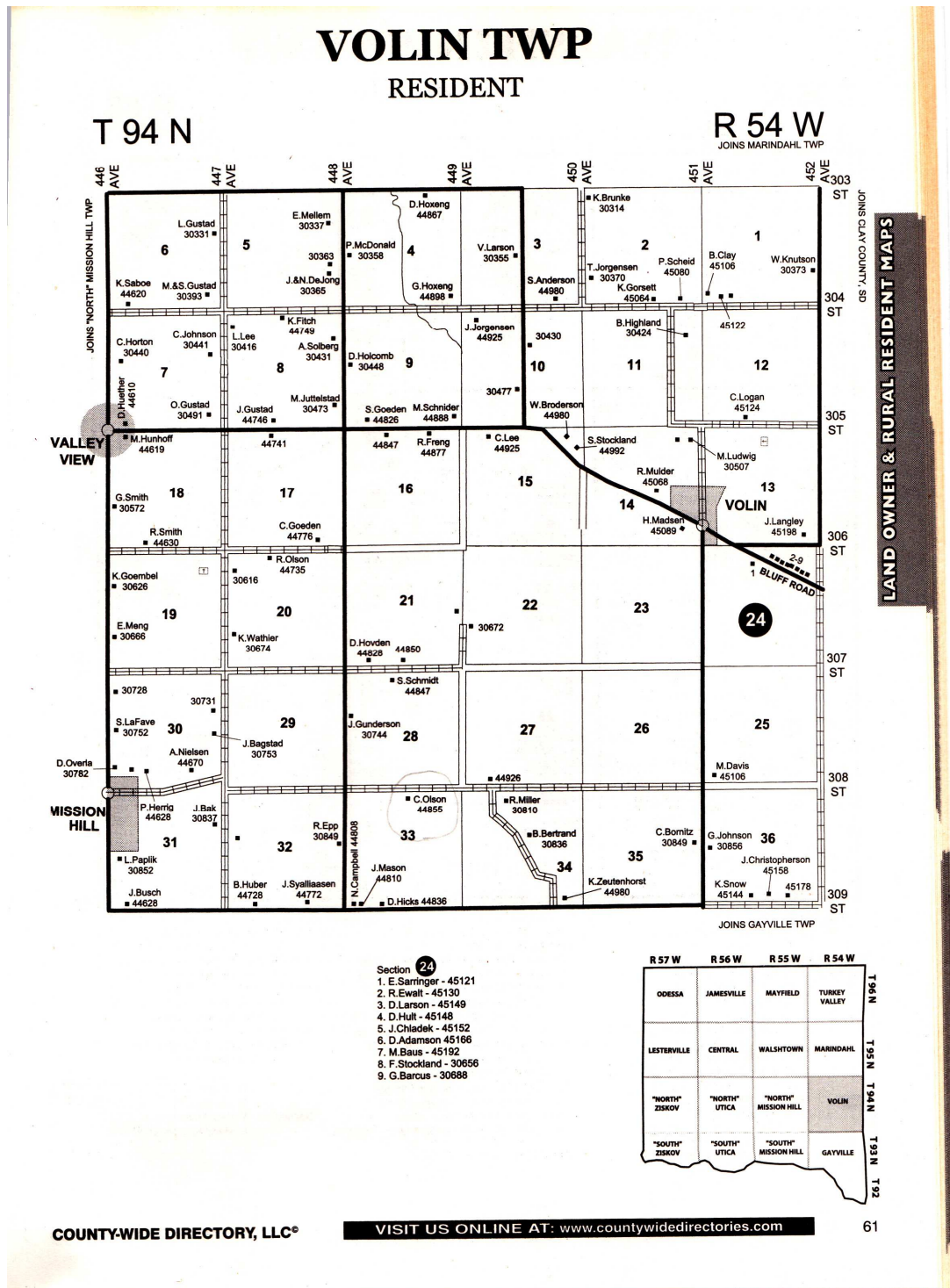

HISTORY

This farm was bought by Christian Olson and eventually became the farm for his son John B. Olson. John had the barn built in 1929. It was completed October 15, 1929. The total bill for the barn was \$2940.87. Labor "Peter and Andrew's, 33 ½ days, \$451.50, freight \$179.52 and lumber and building materials \$2309.85

John B. Olson's son Clifford inherited this farm in 1953. Clifford and Lillian Olson were Betty (Olson) Highland's parents.

In 1968 Betty and her husband Roger Highland started to rent to this farm from Betty's mother Lillian.

In 2016 Betty (Olson) Highland bought the farm from her mother Lillian.



John B. and Julia (Grythe) Olson with their first child, Clifford

90

Labor on Barn

				days
Peter & Andrew	Wed	Aug	27 th	1
"	Thur	Aug	28	1
"	Fri	Aug	29	1
"	Sat	Aug	30	3/4
"	Tue	Sept	31	1
"	Wed	Sept	1	1/2
"	Thur	Sept	2	1
"	Fri	Sept	3	1
"	Sat	Sept	4	1
"	Mon	Sept	5	1
"	Tue	Sept	6	1
"	Wed	Sept	7	1
"	Thur	Sept	8	1
"	Fri	Sept	9	1
"	Sat	Sept	10	3/4
"	Mon	Sept	11	1
"	Tue	Sept	12	1
"	Wed	Sept	13	1
"	Thur	Sept	14	1
"	Fri	Sept	15	1
"	Sat	Sept	16	3/4
"	Mon	Sept	17	1
"	Tue	Sept	18	1
"	Wed	Sept	19	1
"	Thur	Sept	20	1
"	Fri	Sept	21	3/4
"	Sat	Sept	22	1
"	Mon	Sept	23	1
"	Tue	Sept	24	1
"	Wed	Sept	25	1
"	Thur	Sept	26	1
"	Fri	Sept	27	1
"	Sat	Sept	28	1
"	Mon	Sept	29	1
"	Tue	Sept	30	1
"	Wed	Oct	1 st	1
"	Thur	Oct	2	1
"	Fri	Oct	3	1
"	Sat	Oct	4	1/2
"	Mon	Oct	5	1
"	Tue	Oct	6	1
"	Wed	Oct	7	1
"	Thur	Oct	8	1
"	Fri	Oct	9	1
"	Sat	Oct	10	1
"	Mon	Oct	11	1
"	Tue	Oct	12	1
"	Wed	Oct	13	1
"	Thur	Oct	14	1
"	Fri	Oct	15	1/2

Ledger page for carpenter's "Peter & Andrew" days worked building this barn.

John had the barn built in 1929.

It was completed October 15, 1929.

Labor "Peter and Andrew", 33 1/2 days, \$451.50.

The total bill for the barn was \$2940.87.

**SOUTH DAKOTA STATE HISTORIC PRESERVATION OFFICE
HISTORIC SITES SURVEY STRUCTURE FORM**



91

cost of new barn

16 penny nails 100 lbs	5.00	
8 " " " "	5.00	
10 " " " "	5.00	
8 " " " "	5.00	
paid on Lumber bill Sept. 3	1063.76	
lumber & cement for foundation	106.80	
bolts for track clamps	20	
nails hinges & bolts Larson	12.53	
steel siding	188.40	
paying after Marius Larson	33.00	
nails 2d 4d penny galvanized	2.25	
10 penny Larson	4.50	
cotton wood lumber W.P. Brewer	5.60	
paid on Lumber bill Sat Sept 21	703.90	
nails 6d 10 lbs	70	
nails 6d 10 lbs	60	
nails 3d galvanized 60 lbs	4.80	
nails 16d 50 lbs	2.50	
plank 3x12-18 yonkton	3.40	
ridge roll 70ft & 9 finish rolls	6.00	
lightning rods Marius Larson	48.05	
nails 25 lbs 4 penny gal	1.75	
iron for corners	4.00	
buttons & latches & door pulls	3.10	110
roof screws	.95	
nails 5 lbs 4d galvanized	.50	
labor Peter & Andrew Oct 15	451.50	
lumber Oct 26	91.50	
carrier	2768.03	
freight	175.14	
freight on track	4.38	
rope \$1.00	31.35	
	2940.87	
	12.00	

Ledger for expenses building the barn.

John had the barn built in 1929.

It was completed October 15, 1929.

Labor "Peter and Andrew", 33 1/2 days, \$451.50, freight \$179.52 and lumber and building materials \$2309.85

The total bill for the barn was \$2940.87.

The following is from
1968 Yankton County Centennial book

Christian Olson



Christian and Thea (Bagstad) Olson.

Wedding picture of Christian and Thea (Bagstad) Olson

Christian Olson, born on Taaje land in Biri, Norway, on December 16, 1846, immigrated to America in May 1866. After residing in Wisconsin for a year, he came to Dakota Territory and took up a claim of government land on the Section 28, Township 94, Range 54, Yankton County. In 1873 he married Thea Louise Bagstad, who was born in Vernon County, Wisconsin, on January 23, 1856. She had moved with her parents and siblings in 1867 to Section 20, Township 94, Range 54, in Yankton County.

Mr. Olson was the son of Ole (born 1807) and Karen Christofferson (1815-1907) Gaulkstad, also natives of Biri, Norway. His father died in the land of his birth in 1852, and the mother immigrated to the United States in 1867. She raised four children: Berthe (Mrs. Iver Bagstad), Peter, Agnethe (Mrs. Mathias Hoveden), and Christian, the youngest member of the family.

Mrs. Olson's parents were Peter (1808-1886) and Karen Ekeren (1816-1890) Bagstad. Originally having lived in Biri, Norway they moved a short distance in 1843 to Oyer in Gudbrandsdal, Norway. From this area north of Oslo, they made a much longer journey with their children to Wisconsin in 1849. In the early 1850's they were residing in the Coon Valley, Wisconsin area. It is related that some of the Bagstads and Olsons were part of a group of pioneers that walked from their settlements in that state to

SOUTH DAKOTA STATE HISTORIC PRESERVATION OFFICE
HISTORIC SITES SURVEY STRUCTURE FORM



Yankton County in 1868. Thus, the Bagstads began farming here, and Thea and her brothers, Iver, Mathias and Emil, all became involved in local agriculture and business.

The Olson's took an active interest in county affairs. Christian and Thea were concerned about the development of the natural resources here. He became prominent in educational circles and served as treasurer of School District No. 7- sons and grandsons responded to filling various positions on that same school board throughout the life of district. By the late 1800's the Olson farm had grown to a substantial size of 516 acres, of which 300 arces were under cultivation and well improved. A fine frame house was built in the 1890's to replace the log home-which still stands (in 1986). Christian's barn was considered a model structure for the care of livestock, together with ample out buildings. Also, this family found spiritual strength and pioneer fellowship as members of Vangen Lutheran Church.

The Christian Olsons were the parents of Peter Oscar (1874-1935), Carl M. (1876-1963), John B. (1881-1952), and Laura (1885-1885). Working with their father during their growing years, the three sons later farmed in Sections 28, 17, and 33, respectively. Oscar and John B. married sisters, Bergine and Julia (Grythe) Olson, who came from Biri in 1898, and C. M. (Charlie) married Louise Peterson, daughter of Simon and Hannah Marendahl Peterson.

The greatest loss came to the family with Thea's death on March 23, 1888. Grandma Karen helped with the task of raising a "Second family". Christian lived to see his sons grow to adulthood and begin to establish themselves. He died on December 8, 1904.

Although they owned their own farms, which amounted to 640 acres around the turn of the century, the threesome chose to work together as they had done with their father. A huge Flour City tractor-now in a museum-was the their work horse, running a threshing machine and pulling an 8 bottom plow. They traveled about in horse drawn sleds in the winter and Studebaker wagons the rest of the year. When cars came on the scene, they were noted for driving Studebakers too.

The women were known for their cooking. The jelly, jams, canned foods, breads, pies and cakes were all produced over cob and wood stoves. It was common to have 10 or 12 extra men to feed during harvest time. Whatever extra time was left was reserved for sewing.

Children of the "three sons" played a full role in the experiences of life on these farms between Mission Hill and Volin. To Oscar and Bergine were born: Laura (Mrs. Dale) Pritchard, Chester, Oliver, Alice (Mrs. Orton) Anderson, Ivan, Harold, and Gladys (Mrs. E. C.) Peterson; to C. M. and Louise: Thersa (Mrs. Glen) Hanson, Helen (Mrs. L. J.) Weiland, Mildred (Mrs. Noble) White, and Ruth (Mrs. John) Freng, Jr.; and to John B. and Julia: Clifford, Arnold and Esther (Mrs. C. W.) Cook. At the time of this book, Christian and Thea have had 37 great grandchildren, 90 great-great grandchildren and 16 great-great-great grandchildren.

It is interesting to note that these descendants of Christian and Thea, or their spouses, are still involved in Yankton County farming today. (as of 1986). (* indicates persons yet owning a portion of Christian's farm): Ester (Olson) Cook, Phyllis (White) Freng, Ruth (Olson) Freng, Thomas Freng, Jean (Olson) Gunderson, John Gunderson, Jeannie (Cook) Gustad, Paul Gustad, Steve Gustad, Betty (Olson) Highland, *Arnold V. Olson, June (Mrs. Stewart) Olson, *Lillian (Mrs. Clifford) Olson, *Mable (Mrs. Oliver) Olson, Scott Olson, *Gladys (Olson) Peterson, and Charles White.

* = REQUIRED FIELD

**SOUTH DAKOTA STATE HISTORIC PRESERVATION OFFICE
HISTORIC SITES SURVEY STRUCTURE FORM**



Written by Ray A. Scott