

**SOUTH DAKOTA STATE HISTORIC PRESERVATION OFFICE  
HISTORIC SITES SURVEY STRUCTURE FORM**



**SITE INFORMATION**

\*SURVEY DATE: July 18,2017 \*ADDRESS: No number 309<sup>th</sup> Street  
\*SURVEYOR: Jim Stone \*COUNTY: Clay  
\*CITY: Vermillion

LOCATION DESCRIPTION: From Vermillion, South Dakota Highway 50 and South Dakota Highway 19 Intersection, 8 miles north to 309<sup>th</sup> Street, turn right, east, about 1-3/4 miles on the north side, no Fire number, 46357 309th Street is on the south side

LEGAL DESCRIPTION: Bogue Track, SW ¼, SE ¼, Section 36, 94- 52-36, Pleasant Valley Twp.Clay Clay County

\*QUARTER 1: SE 1/4 OWNER NAME: Thomas E. & Gaik-Lin Quah Simmons  
\*QUARTER 2: \_\_\_\_\_ OWNER ADDRESS: 117 Prentis Street  
\*TOWNSHIP: Pleasant Valley OWNER CITY: Vermillion  
\*RANGE: 52 OWNER STATE: South Dakota  
\*SECTION: 36 OWNER ZIP: 57069  
ACRES: 5.57 QUAD NAME: \_\_\_\_\_

OWNER CODE 1: P  
OWNER CODE 2:  
OWNER CODE 3:

**HISTORIC SIGNIFICANCE**

\*DOE: \_\_\_\_\_ REGISTER NAME: \_\_\_\_\_  
\*DOE DATE: \_\_\_\_\_ MULTIPLE PROPERTY NAME: \_\_\_\_\_  
REASON INELIGIBLE: \_\_\_\_\_

NOMINATION STATUS: \_\_\_\_\_ CATEGORY: \_\_\_\_\_  
DATE LISTED: \_\_\_\_\_ SIGNIFICANCE LEVEL 1: N S L  
REFERENCE NUMBER: \_\_\_\_\_ SIGNIFICANCE LEVEL 2: N S L  
HISTORIC DISTRICT RATING: C or NC CRITERIA 1: A B C D  
PERIOD: \_\_\_\_\_ CRITERIA 2: A B C D  
CRITERIA 3: A B C D  
CRITERIA 4: A B C D

SIGNIFICANCE NOTES: \_\_\_\_\_  
\_\_\_\_\_  
\_\_\_\_\_

\* = REQUIRED FIELD

**SOUTH DAKOTA STATE HISTORIC PRESERVATION OFFICE  
HISTORIC SITES SURVEY STRUCTURE FORM**



**STRUCTURE DETAILS**

SHPO ID: \_\_\_\_\_  
 \*PROPERTY NAME: \_\_\_\_\_  
 OTHER NAME: \_\_\_\_\_

CURRENT FUNCTION: <u>Vacant</u>	FOUNDATION: <u>Poured concrete</u>
CURRENT SUBFUNCTION: <u>Vacant</u>	ROOF MATERIAL: <u>Steel roofing over cedar shingles</u>
HISTORIC FUNCTION: <u>Double ear corn crib</u>	ROOF SHAPE: <u>Gable roof</u>
HISTORIC SUBFUNCTION: <u>Double ear corn crib</u>	STRUCTURAL SYSTEM: <u>Balloon framing</u>
OCCUPIED: <u>No</u>	STYLE: <u>Double corn crib</u>
ACCESSIBLE: <u>Yes with permission</u>	TYPE: <u>Double corn crib</u> <u>2x6 studs, 1x6 spaced siding, 1x6 drop siding on gable ends</u>
STORIES: <u>2</u>	WALLS: _____
*DATE OF CONSTRUCTION: <u>1920's</u>	SIGNIFICANT PERSON: <u>J. F. Hickson</u>
	CULTURAL AFFILIATION: <u>?</u>

ALTERED/MOVED NOTES: Roof has steel roofing. Doubled 2x8 floor joists have been added above 10' alley and grain bins were built above.

INTERIOR NOTES: \_\_\_\_\_

OTHER NOTES: Single 9x12 four light window in each gable end. Cupola in the center of peak with openings on each side for an elevator to fill cribs and granaries. Sliding doors on each end to enclose alley.

\*PHYSICAL NOTES: Corn crib is in fair condition. \*RESTRICTED: Y or N  
 \*UTM EASTING: \_\_\_\_\_  
 \*UTM NORTHING: \_\_\_\_\_

**SITE INFORMATION**

\*UTM EASTING: \_\_\_\_\_  
 \*UTM NORTHING: \_\_\_\_\_

**SOUTH DAKOTA STATE HISTORIC PRESERVATION OFFICE  
HISTORIC SITES SURVEY STRUCTURE FORM**



**SOUTH DAKOTA STATE HISTORIC PRESERVATION OFFICE  
HISTORIC SITES SURVEY STRUCTURE FORM**

**SKETCH MAP**

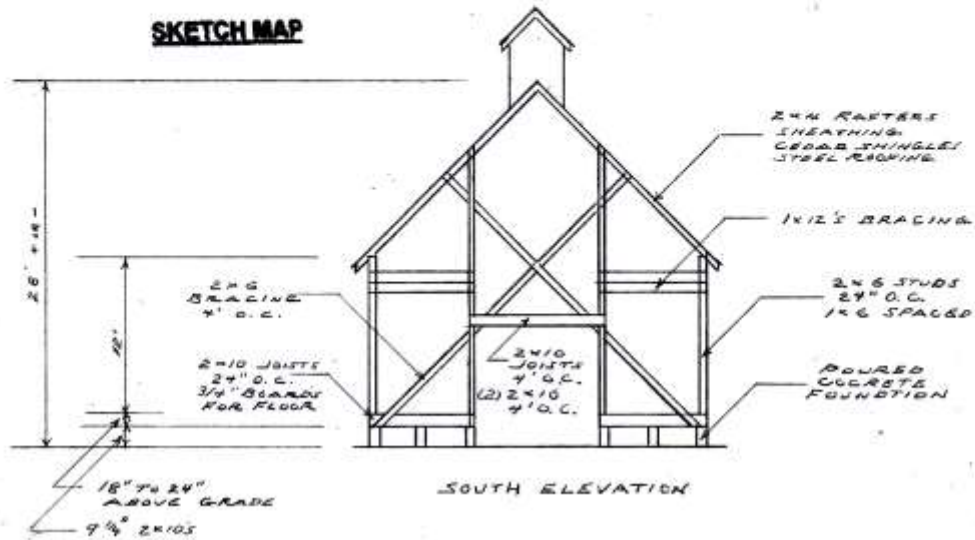

SOUTH ELEVATION

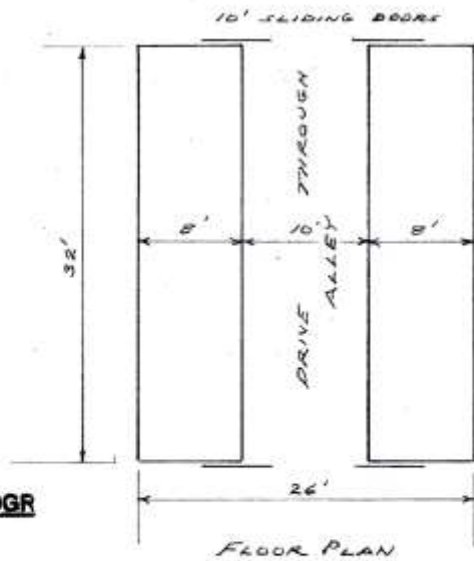

**PHOTOGR**

FLOOR PLAN



\* = REQUIRED FIELD

**SOUTH DAKOTA STATE HISTORIC PRESERVATION OFFICE  
HISTORIC SITES SURVEY STRUCTURE FORM**



**PHOTOGRAPHER:** Jim Stone  
**DATE OF PHOTO:** July 18, 2017

**ROLL NUMBER:** \_\_\_\_\_  
**PHOTO NUMBER:** 1  
**CAMERA DIRECTION:** Looking NE, SW corner



**PHOTOGRAPHER:** Jim Stone  
**DATE OF PHOTO:** July 18, 2017

**ROLL NUMBER:** \_\_\_\_\_  
**PHOTO NUMBER:** 2  
**CAMERA DIRECTION:** Looking NW, SE corner

\* = REQUIRED FIELD

**SOUTH DAKOTA STATE HISTORIC PRESERVATION OFFICE  
HISTORIC SITES SURVEY STRUCTURE FORM**



**PHOTOGRAPHER:** Jim Stone  
**DATE OF PHOTO:** July 18, 2017

**ROLL NUMBER:** \_\_\_\_\_  
**PHOTO NUMBER:** 3  
**CAMERA DIRECTION:** Looking SW, NE corner



**PHOTOGRAPHER:** Jim Stone  
**DATE OF PHOTO:** July 18, 2017

**ROLL NUMBER:** \_\_\_\_\_  
**PHOTO NUMBER:** 4  
**CAMERA DIRECTION:** Looking SE, NW corner

\* = REQUIRED FIELD

**SOUTH DAKOTA STATE HISTORIC PRESERVATION OFFICE  
HISTORIC SITES SURVEY STRUCTURE FORM**



**PHOTOGRAPHER:** Jim Stone  
**DATE OF PHOTO:** July 18, 2017

**ROLL NUMBER:** 5  
**PHOTO NUMBER:** 5  
**CAMERA DIRECTION:** In the alley looking NW into west corn crib.



**PHOTOGRAPHER:** Jim Stone  
**DATE OF PHOTO:** JULY 18, 2017

**ROLL NUMBER:** 6  
**PHOTO NUMBER:** 6  
**CAMERA DIRECTION:** In alley looking NW up at 2x10 joists. Light single joists are original rough sawn cottonwood, the darker doubled 2x10 joists were added when the granaries were built above the alley.

\* = REQUIRED FIELD

**SOUTH DAKOTA STATE HISTORIC PRESERVATION OFFICE  
HISTORIC SITES SURVEY STRUCTURE FORM**



**PHOTOGRAPHER:** Jim Stone  
**DATE OF PHOTO:** July 18, 2017

**ROLL NUMBER:** \_\_\_\_\_  
**PHOTO NUMBER:** 7

**CAMERA DIRECTION:** Looking west up into opening to granaries above alley. Note ladder above, it was removed below.

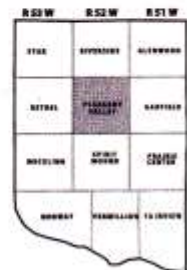
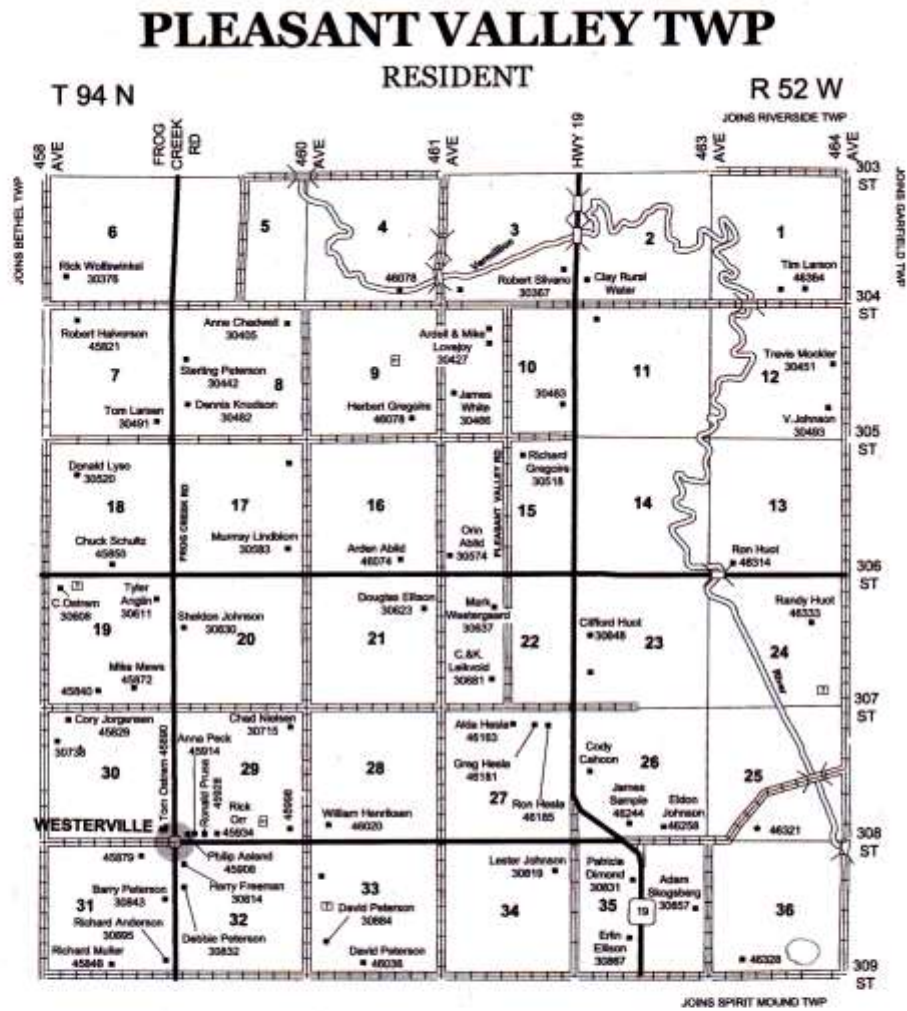

COUNTY-WIDE DIRECTORY, LLC®

VISIT US ONLINE AT: [www.countywidedirectories.com](http://www.countywidedirectories.com)

3

\* = REQUIRED FIELD



## **HISTORY**

This home is located in the SE<sup>1</sup>/<sub>4</sub> of Section 36, Pleasant Valley Township, Clay County was homesteaded by J. L. Olson.

The 1894 Clay County Atlas lists Ole C. Olson as the owner.

The 1901 Clay County Atlas lists A. Hallam as the owner.

The 1912 and 1924 Clay County Atlas lists J. F. Hickson as the owner.

The 1936 Clay County Atlas lists Mae Saunders as the owner.

The 1948 and 1956 Clay County Atlas lists E. A. Bogne as the owner.

**SOUTH DAKOTA STATE HISTORIC PRESERVATION OFFICE  
HISTORIC SITES SURVEY STRUCTURE FORM**

