

SOUTH DAKOTA STATE HISTORIC PRESERVATION OFFICE
HISTORIC SITES SURVEY STRUCTURE FORM



SITE INFORMATION

*SURVEY DATE: November 27, 2012
*SURVEYOR: Jim Stone

*ADDRESS: 30624 464th Ave.
*COUNTY: Clay
*CITY: Centerville

LOCATION DESCRIPTION: Intersection of South Dakota Highway 50 bi-pass and University Road, North 11 miles to 306th Street, turn left, west 1 mile to 464th Ave., turn left South about 1/4 mile on the left, East side

LEGAL DESCRIPTION: E 1/2, NW 1/4, Exc W 121' of S 1,287' of lot 1, NW1/4 & EXC Lindstrom Tract 1, 19 - 94 - 51 Garfield TWP

*QUARTER 1: NW1/4 of
*QUARTER 2: NW1/4
*TOWNSHIP: Garfield
*RANGE: 51
*SECTION: 19
ACRES: 35.44

OWNER NAME: Don Lindstrom
OWNER ADDRESS: 30624 464th Ave.
OWNER CITY: Centerville
OWNER STATE: South Dakota
OWNER ZIP: 57014
QUAD NAME: _____

OWNER CODE 1: P
OWNER CODE 2: _____
OWNER CODE 3: _____

HISTORIC SIGNIFICANCE

*DOE: _____
*DOE DATE: _____
REASON INELIGIBLE: _____

REGISTER NAME: _____
MULTIPLE PROPERTY NAME: _____

NOMINATION STATUS: _____
DATE LISTED: _____
REFERENCE NUMBER: _____
HISTORIC DISTRICT RATING: C or NC
PERIOD: _____

CATEGORY: _____
SIGNIFICANCE LEVEL 1: N S L
SIGNIFICANCE LEVEL 2: N S L

CRITERIA 1: A B C D
CRITERIA 2: A B C D
CRITERIA 3: A B C D
CRITERIA 4: A B C D

SIGNIFICANCE NOTES: _____

STRUCTURE DETAILS

* = REQUIRED FIELD

SOUTH DAKOTA STATE HISTORIC PRESERVATION OFFICE
HISTORIC SITES SURVEY STRUCTURE FORM



SHPO ID: _____

*PROPERTY NAME: _____

OTHER NAME: _____

CURRENT FUNCTION: Livestock

CURRENT SUBFUNCTION: Hay and grain storage

HISTORIC FUNCTION: Horse barn

HISTORIC SUBFUNCTION: Hay and grain storage

OCCUPIED: Yes

ACCESSIBLE: Yes with permission

STORIES: 2

*DATE OF CONSTRUCTION: 1890 - 1910

FOUNDATION: Native stone no mortar

ROOF MATERIAL: Cedar shingles

ROOF SHAPE: Gable

STRUCTURAL SYSTEM: Balloon framing

STYLE: Gable roof

TYPE: Horse barn

WALLS: 2x4 studs, diagonal sheathing, 1/2"x6" cedar lap siding

SIGNIFICANT PERSON: Anders Matteson

CULTURAL AFFILIATION: Swedish

ALTERED/MOVED NOTES: Still in original condition

INTERIOR NOTES: 14 single horse stalls, 8' x 10' granary NW corner, 4x6 posts 5' O.C. with 6x6 beam supporting 2x6 floor joists for hayloft floor. 4x6 posts 10' O.C. in hayloft to support 2x6 rafters.

OTHER NOTES: Has a hay chute from the hayloft down to the left side of each manger in each horse stall. Three 8 x 10 four light windows, two on first floor on North wall and one in the west side of hayloft. Two 8x10 over 8x 10 four light windows on the first floor on south wall .

***PHYSICAL**

NOTES: Barn is in good condition.

*RESTRICTED: Y or N

*UTM EASTING: _____

*UTM NORTHING: _____

SITE INFORMATION

*UTM EASTING: _____

*UTM NORTHING: _____

SOUTH DAKOTA STATE HISTORIC PRESERVATION OFFICE
HISTORIC SITES SURVEY STRUCTURE FORM

SKETCH MAP

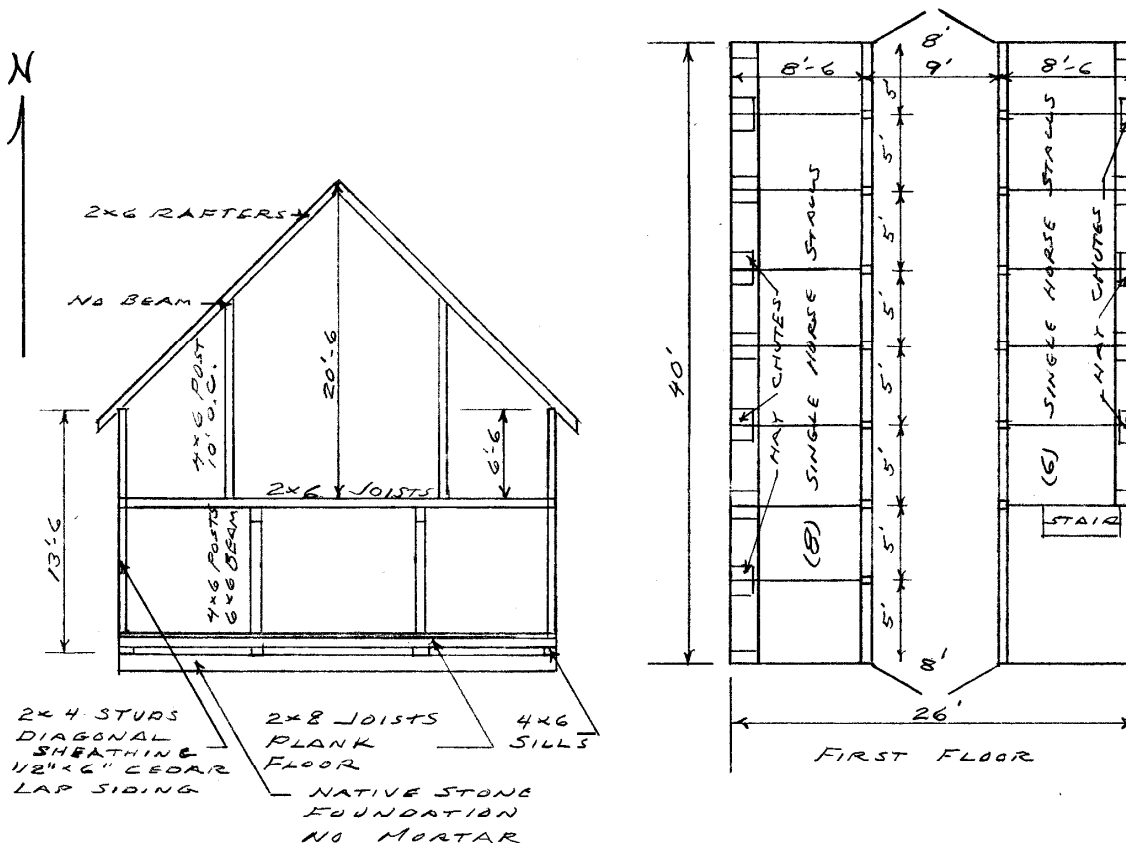

PHOTOGR

* = REQUIRED FIELD

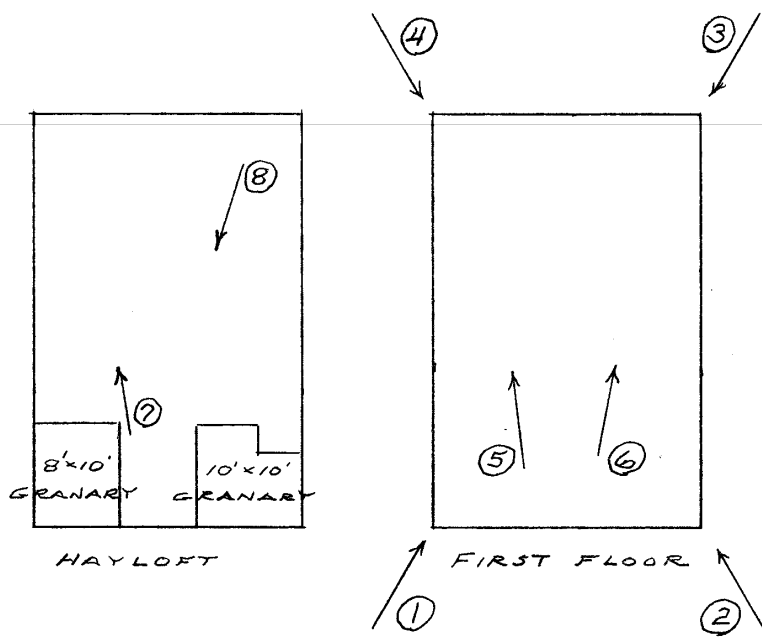

**SOUTH DAKOTA STATE HISTORIC PRESERVATION OFFICE
HISTORIC SITES SURVEY STRUCTURE FORM**



PHOTOGRAPHER: Jim Stone
DATE OF PHOTO: November 27, 2012

ROLL NUMBER: _____
PHOTO NUMBER: 1
CAMERA DIRECTION: Looking NE, SW corner



PHOTOGRAPHER: Jim Stone
DATE OF PHOTO: November 27, 2012

ROLL NUMBER: _____
PHOTO NUMBER: 2
CAMERA DIRECTION: Looking NW, SE corner

**SOUTH DAKOTA STATE HISTORIC PRESERVATION OFFICE
HISTORIC SITES SURVEY STRUCTURE FORM**



PHOTOGRAPHER: Jim Stone
DATE OF PHOTO: November 27, 2012

ROLL NUMBER: _____
PHOTO NUMBER: 3
CAMERA DIRECTION: Looking SW, NE corner



PHOTOGRAPHER: Jim Stone
DATE OF PHOTO: November 27, 2012

ROLL NUMBER: _____
PHOTO NUMBER: 4
CAMERA DIRECTION: Looking SE, NW corner

**SOUTH DAKOTA STATE HISTORIC PRESERVATION OFFICE
HISTORIC SITES SURVEY STRUCTURE FORM**



PHOTOGRAPHER: Jim Stone
DATE OF PHOTO: November 27, 2012

ROLL NUMBER: _____
PHOTO NUMBER: 5

CAMERA DIRECTION: First floor, looking North,
single horse stalls on
West side.



PHOTOGRAPHER: Jim Stone
DATE OF PHOTO: November 27, 2012

ROLL NUMBER: _____
PHOTO NUMBER: 6

CAMERA DIRECTION: First floor, Looking
North, single horse stalls
on the East side.

**SOUTH DAKOTA STATE HISTORIC PRESERVATION OFFICE
HISTORIC SITES SURVEY STRUCTURE FORM**



PHOTOGRAPHER: Jim Stone
DATE OF PHOTO: November 27, 2012

ROLL NUMBER: _____
PHOTO NUMBER: 7

CAMERA DIRECTION: Hayloft, looking North,
4x6 posts 10' O. C. note
lack of beam to support
rafters



PHOTOGRAPHER: Jim Stone
DATE OF PHOTO: November 27, 2012

ROLL NUMBER: _____
PHOTO NUMBER: 8

CAMERA DIRECTION: Hayloft, looking SW,
granary in SW corner

SOUTH DAKOTA STATE HISTORIC PRESERVATION OFFICE

HISTORIC SITES SURVEY STRUCTURE FORM



T-94-N

GARFIELD DIRECTORY

R-51-W

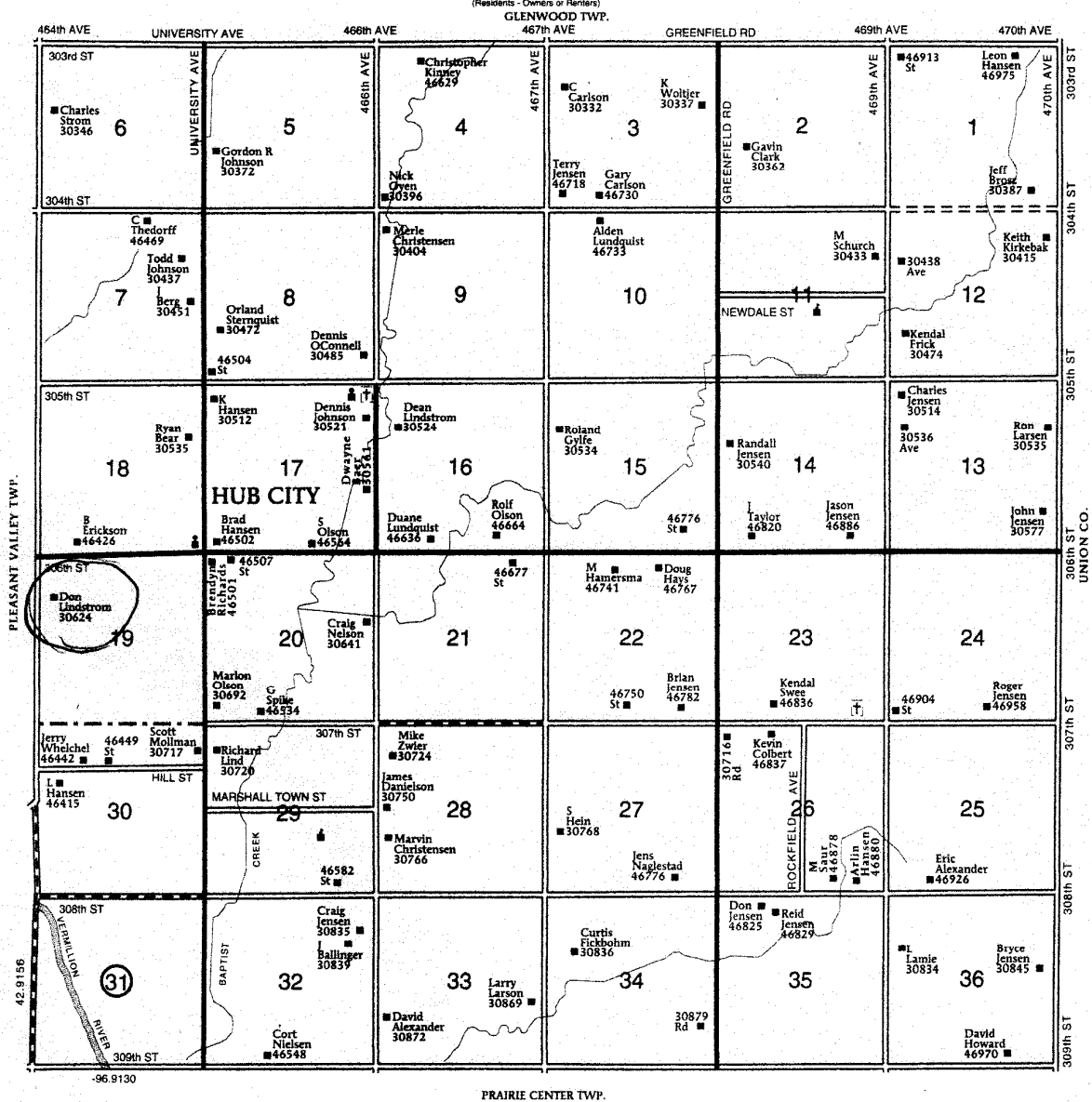

HISTORY

This farm is located in NW ¼ of Section 19, Garfield Township, Clay County, So. Dak.

Homesteaded by A. M. Matteson

1884 Clay county Map lists Anders Matteson as the owner

.

1894 Clay County Atlas lists A. M. Matteson as the owner.

1901 and 1912 Clay County Atlas lists Anders Mattson as the owner.

1924 Clay County Atlas lists A. M. Lindstrom as the owner.

1937, 1948 and 1956 Clay County Atlas lists A. O. Lindstrom as the owner.

**SOUTH DAKOTA STATE HISTORIC PRESERVATION OFFICE
HISTORIC SITES SURVEY STRUCTURE FORM**

