

**SOUTH DAKOTA STATE HISTORIC PRESERVATION OFFICE  
HISTORIC SITES SURVEY STRUCTURE FORM**



**SITE INFORMATION**

\*SURVEY DATE: April 26, 2013                      \*ADDRESS: 45355 312<sup>th</sup> Street  
\*SURVEYOR: Jim Stone                                      \*COUNTY: Clay  
\*CITY: Gayville

LOCATION DESCRIPTION: From Vermillion, South Dakota Highway 50 West to Meckling, continue West on Highway 50, 3-1/4 miles to 312<sup>th</sup> street, turn left(South) then (West) about 1/2 mile on the left (South) side.

LEGAL DESCRIPTION: NE 1/4, Exc Lot H-1 & H-2 & Exc N 500' of E 350' of W 585' of NW 1/4, NE 1/4, 20 - 93 - 53 Meckling Twp.

\*QUARTER 1: NE1/4                                      OWNER NAME: Wade A., William H. Sr. & Jane A. Larson  
\*QUARTER 2: \_\_\_\_\_                                      OWNER ADDRESS: 31377 454<sup>th</sup> Ave.  
\*TOWNSHIP: Meckling                                      OWNER CITY: Meckling  
\*RANGE: 53    OWNER STATE: South Dakota  
\*SECTION: 20    OWNER ZIP: 57069  
ACRES: 155.79    QUAD NAME: \_\_\_\_\_

OWNER CODE 1: P  
OWNER CODE 2:  
OWNER CODE 3:

**HISTORIC SIGNIFICANCE**

\*DOE: \_\_\_\_\_                                      REGISTER NAME: \_\_\_\_\_  
\*DOE DATE: \_\_\_\_\_                                      MULTIPLE PROPERTY NAME: \_\_\_\_\_  
REASON INELIGIBLE: \_\_\_\_\_

NOMINATION STATUS: \_\_\_\_\_                                      CATEGORY: \_\_\_\_\_  
DATE LISTED: \_\_\_\_\_                                      SIGNIFICANCE LEVEL 1: N S L  
REFERENCE NUMBER: \_\_\_\_\_                                      SIGNIFICANCE LEVEL 2: N S L  
HISTORIC DISTRICT RATING: C or NC                                      CRITERIA 1: A B C D  
PERIOD: \_\_\_\_\_    CRITERIA 2: A B C D  
    CRITERIA 3: A B C D  
    CRITERIA 4: A B C D

SIGNIFICANCE NOTES: \_\_\_\_\_  
\_\_\_\_\_  
\_\_\_\_\_

\* = REQUIRED FIELD

**SOUTH DAKOTA STATE HISTORIC PRESERVATION OFFICE  
HISTORIC SITES SURVEY STRUCTURE FORM**



**STRUCTURE DETAILS**

SHPO ID: \_\_\_\_\_  
 \*PROPERTY NAME: \_\_\_\_\_  
 OTHER NAME: \_\_\_\_\_

CURRENT FUNCTION: Vacant FOUNDATION: Poured concrete  
 CURRENT SUBFUNCTION: Storage ROOF MATERIAL: Steel over cedar  
 HISTORIC FUNCTION: Livestock barn ROOF SHAPE: shingles  
 HISTORIC SUBFUNCTION: Hay & grain storage STRUCTURAL SYSTEM: Gambrel  
 OCCUPIED: Yes STYLE: Balloon framing  
 TYPE: Gambrel roof barn  
 ACCESSIBLE: Yes with permission WALLS: Livestock barn  
 TYPE: 2x6 studs, 1x18 sheathing and 1/2"x6" cedar lap siding

STORIES: 2 SIGNIFICANT PERSON: William Larson  
 \*DATE OF CONSTRUCTION: 1938 CULTURAL AFFILIATION: Norwegian

**ALTERED/MOVED NOTES:** Original site. Any evidence of horse stalls and milk cow stanchions has been removed. Parts of the roof has been covered with steel roofing. Granary in the NW corner has been removed. Granary may have been added replacing a horse stall. A lean-to was added on the South end much later.

**INTERIOR NOTES:** The original barn had two rows of 4x6 posts and (3) 2x6 laminated posts and a 6x6 beam. The (2) south posts are 4x6's and the rest of the posts are laminated with (3) 2x6's except the (4) at the north end. These posts are (2) 2x6's with a 2x4 in the center, which created a groove to receive the dividers for the horse stalls. The floor joists are 2x8's for hayloft floor.

**OTHER NOTES:** 2x6 stud walls with 8" sheathing and 1/2"x6" cedar lap siding. Rafters are 2x6's with some steel over cedar shingles. All of the dimension lumber and sheathing is rough sawn Black Hills pine from Hills, South Dakota. Metal cupola is still in place, which had a horse weathervane. The owner found the horse, which is solid brass and is thinking about restoring the weathervane.

**\*PHYSICAL NOTES:** Barn is in good condition.  
This is an English style floor plan. The stalls and stanchions face the gable ends and the doors are on the long sides with the alleys running the width of the barn.

\*UTM ZONE: \_\_\_\_\_

\*RESTRICTED: Y or N

\*UTM EASTING: \_\_\_\_\_

\*UTM NORTHING: \_\_\_\_\_

\* = REQUIRED FIELD

**SOUTH DAKOTA STATE HISTORIC PRESERVATION OFFICE  
HISTORIC SITES SURVEY STRUCTURE FORM**

**SKETCH MAP**

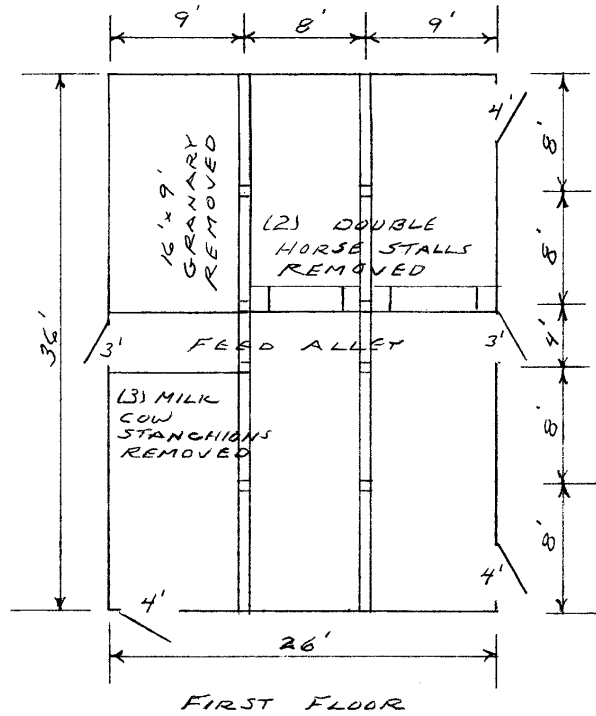
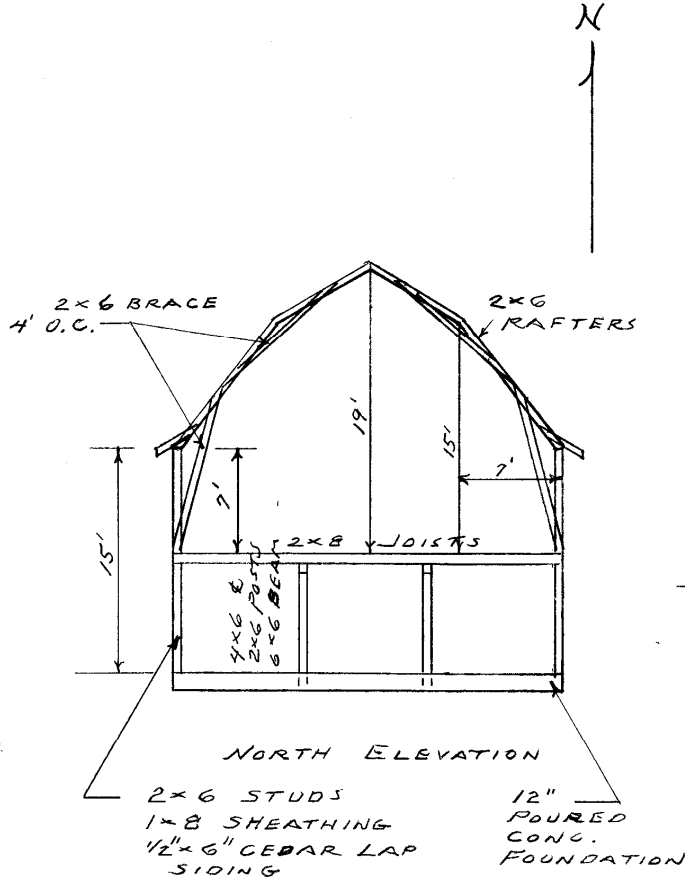

**PHOTOGR**

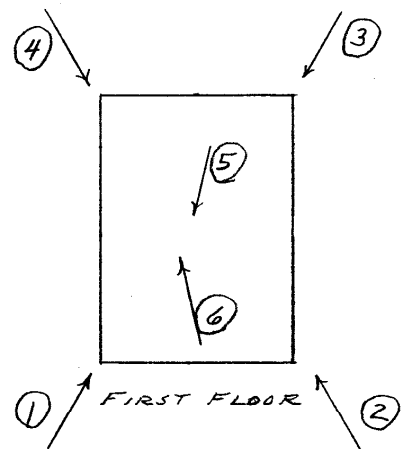
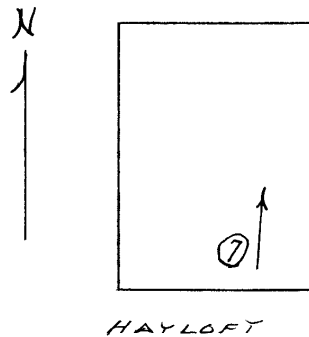

\* = REQUIRED FIELD

**SOUTH DAKOTA STATE HISTORIC PRESERVATION OFFICE  
HISTORIC SITES SURVEY STRUCTURE FORM**



**PHOTOGRAPHER:** Jim Stone  
**DATE OF PHOTO:** April 26, 2013

**ROLL NUMBER:** \_\_\_\_\_  
**PHOTO NUMBER:** 1  
**CAMERA DIRECTION:** Looking NE, SW corner



**PHOTOGRAPHER:** Jim Stone  
**DATE OF PHOTO:** April 26, 2013

**ROLL NUMBER:** \_\_\_\_\_  
**PHOTO NUMBER:** 2  
**CAMERA DIRECTION:** Looking NW, SE corner

\* = REQUIRED FIELD

**SOUTH DAKOTA STATE HISTORIC PRESERVATION OFFICE  
HISTORIC SITES SURVEY STRUCTURE FORM**



PHOTOGRAPHER: Jim Stone  
DATE OF PHOTO: April 26, 2013

ROLL NUMBER: \_\_\_\_\_  
PHOTO NUMBER: 3  
CAMERA DIRECTION: Looking SW, NE corner



PHOTOGRAPHER: Jim Stone  
DATE OF PHOTO: April 26, 2013

ROLL NUMBER: \_\_\_\_\_  
PHOTO NUMBER: 4  
CAMERA DIRECTION: Looking SE, NW corner

\* = REQUIRED FIELD

**SOUTH DAKOTA STATE HISTORIC PRESERVATION OFFICE  
HISTORIC SITES SURVEY STRUCTURE FORM**



**PHOTOGRAPHER:** Jim Stone  
**DATE OF PHOTO:** April 26, 2013

**ROLL NUMBER:** 5  
**PHOTO NUMBER:** 5

**First floor, looking SW,  
4x6 posts, 6x6 beam and  
2x8 joists**

**CAMERA DIRECTION:** \_\_\_\_\_



**PHOTOGRAPHER:** Jim Stone  
**DATE OF PHOTO:** April 26, 2013

**ROLL NUMBER:** 6  
**PHOTO NUMBER:** 6

**First floor, looking NW,  
Granary was in this NW  
corner, posts are (2)  
2x6's with a 2x4 in the  
center creating a groove  
for partitions for horse  
stalls.**

**CAMERA DIRECTION:** \_\_\_\_\_

\* = REQUIRED FIELD

**SOUTH DAKOTA STATE HISTORIC PRESERVATION OFFICE  
HISTORIC SITES SURVEY STRUCTURE FORM**



**PHOTOGRAPHER:** Jim Stone  
**DATE OF PHOTO:** April 26, 2013

**ROLL NUMBER:** 7  
**PHOTO NUMBER:** 7

**CAMERA DIRECTION:** Hayloft, looking NE, 2x6  
bracing 4' O. C. and 2x6  
rafters.

**SOUTH DAKOTA STATE HISTORIC PRESERVATION OFFICE  
HISTORIC SITES SURVEY STRUCTURE FORM**

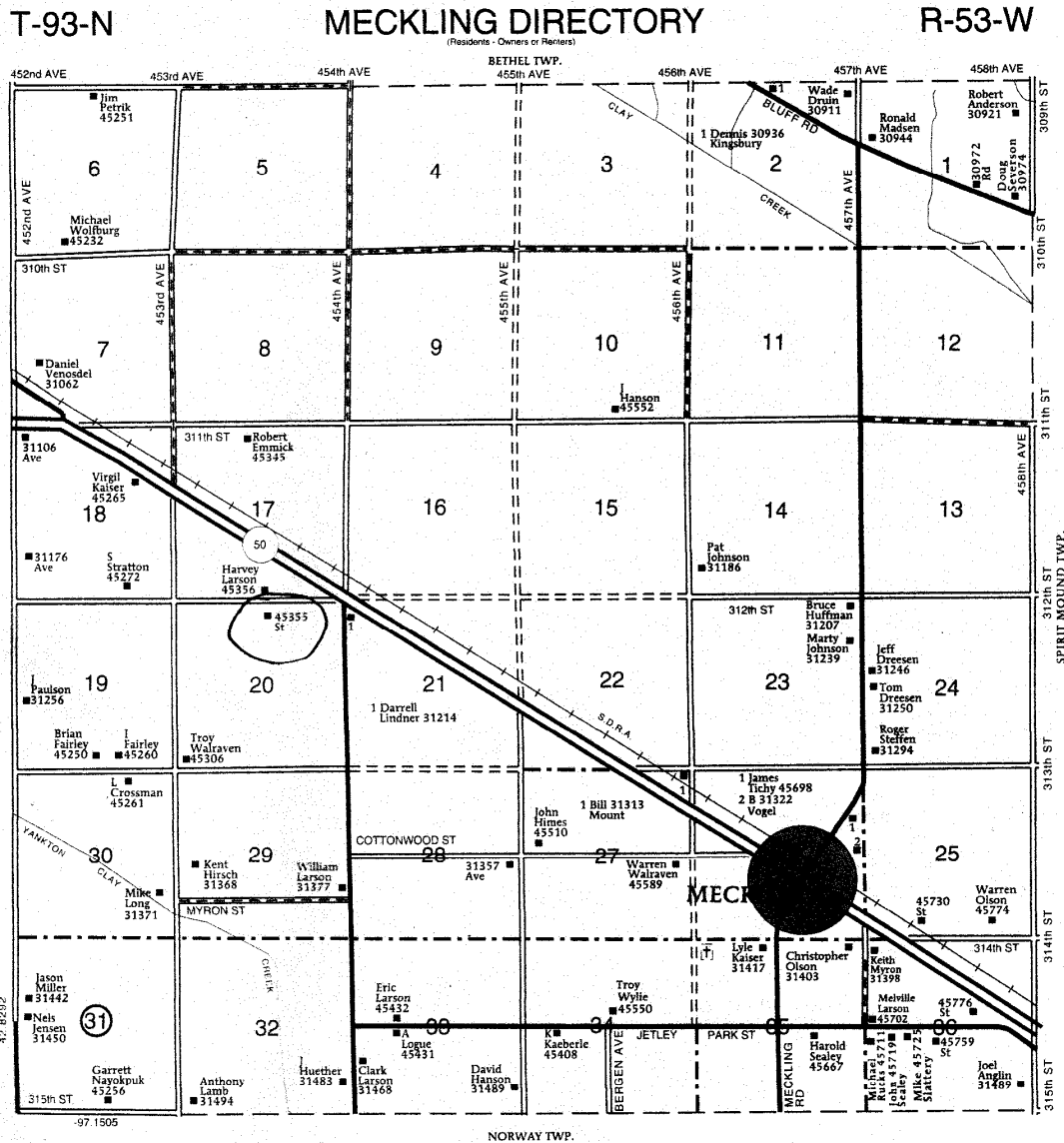

**HISTORY**

\* = REQUIRED FIELD



**SOUTH DAKOTA STATE HISTORIC PRESERVATION OFFICE  
HISTORIC SITES SURVEY STRUCTURE FORM**



This farm located in the NE ¼ of Section 20, Meckling Township, Clay County was homesteaded by John A. Stephenson.

The 1892, 1901 and 1912 Clay County Atlas lists M. N. Richardson and Wm. McClelland as the owners.

The 1924 Clay County Atlas lists M. N. Richardson as the owner.

The 1937 Clay county Atlas lists T. McClelland as the owner and William Larson as the operator.

The 1948 and 1956 Clay county atlas lists William Larson as the owner. Willhelm Larson changed his name to William Larson with no middle name. He was the grandfather to William H. Larson Sr. who owns the farm now.

**The Following Is Furnished by**

William (Bill) Larson Sr., who owns this farm.

In the 1930's, with the terrible drought, hay was in great demand in western South Dakota. William Larson was baling grass hay from the Missouri River bottom and hauling it to western South Dakota. He would drive on to Hills, South Dakota and pick up a load of lumber direct from the lumber mills and haul it back to the Gayville, Meckling and Vermillion area. He had a 1933 Chevrolet truck. In 1938 he decided to build a new barn on his farm. He hauled the lumber back from Hills, South Dakota to build his new barn. The lumber cost \$700.00. His grandson Wm. (Bill) Larson does not remember how many loads it required for this barn. The lumber is rough sawn and oversized. The 2x6's measure 6-1/4" wide and the 2x8's measure 8-1/4" wide. The sheathing boards are just over 3/4" thick and 8" wide.

The builders were Royal Lunde and Robert Brinstall who were partners in a contracting business. William Larson assisted the builders. All of the lumber was sawn by hand just NW of the barn. Royal Lunde and Robert Brinstall also built a barn about 1-1/2 miles West and ¼ mile North of this barn. The two barns were known as the "sister barns", because they were almost exactly alike. This barn is 26' wide and the other barn was 28' wide. The other barn had six double horse stalls and was a horse barn. This barn had two or three double horse stalls and stanchions for milk cows.

**SOUTH DAKOTA STATE HISTORIC PRESERVATION OFFICE  
HISTORIC SITES SURVEY STRUCTURE FORM**

