

**SOUTH DAKOTA STATE HISTORIC PRESERVATION OFFICE
HISTORIC SITES SURVEY STRUCTURE FORM**



SITE INFORMATION

*SURVEY DATE: June 15, 2012 *ADDRESS: 45890
*SURVEYOR: Jim Stone *COUNTY: Clay
*CITY: Vermillion

LOCATION DESCRIPTION: From the intersection of South Dakota Highway 50 bi-pass and South Dakota Highway 19, 9 miles North to 302nd Street, turn left (West), 3-1/2 miles, turn on the right (North) Into to driveway.

LEGAL DESCRIPTION: SE ¼, EXC 1 A in SE corner, 30 – 94 – 52 Pleasant Valley Twp.

*QUARTER 1: SE 1/4 OWNER NAME: Thomas J. & Carla R. Ostrem
*QUARTER 2: _____ OWNER ADDRESS: 45890 308th Street
*TOWNSHIP: Pleasant Valley OWNER CITY: Vermillion
*RANGE: 52 OWNER STATE: South Dakota
*SECTION: 30 OWNER ZIP: 57069
ACRES: 154.87 QUAD NAME: _____
OWNER CODE 1: P
OWNER CODE 2: F S L P
OWNER CODE 3: F S L P

HISTORIC SIGNIFICANCE

*DOE: _____ REGISTER NAME: _____
*DOE DATE: _____ MULTIPLE PROPERTY NAME: _____
REASON INELIGIBLE: _____

NOMINATION STATUS: _____ CATEGORY: _____
DATE LISTED: _____ SIGNIFICANCE LEVEL 1: N S L
REFERENCE NUMBER: _____ SIGNIFICANCE LEVEL 2: N S L
HISTORIC DISTRICT RATING: C or NC CRITERIA 1: A B C D
PERIOD: _____ CRITERIA 2: A B C D
CRITERIA 3: A B C D
CRITERIA 4: A B C D

SIGNIFICANCE NOTES: _____

* = REQUIRED FIELD

**SOUTH DAKOTA STATE HISTORIC PRESERVATION OFFICE
HISTORIC SITES SURVEY STRUCTURE FORM**



STRUCTURE DETAILS

SHPO ID: _____
 *PROPERTY NAME: _____
 OTHER NAME: _____

CURRENT FUNCTION: Grain bin FOUNDATION: Native rock, lime & sand mortar
Asphalt shingles over cedar shingles

CURRENT SUBFUNCTION: Storage ROOF MATERIAL: shingles
 HISTORIC FUNCTION: Horse barn ROOF SHAPE: Gable
 HISTORIC SUBFUNCTION: Hay and grain storage STRUCTURAL SYSTEM: Balloon framing
 OCCUPIED: Yes STYLE: Gable roof barn
 TYPE: Horse barn
 ACCESSIBLE: Yes with permission WALLS: 2x6, sheathing & 1/2x6" cedar lap siding

STORIES: 2 SIGNIFICANT PERSON: John T. Westre
 *DATE OF CONSTRUCTION: Mid-1880's CULTURAL AFFILIATION: Norwegian

ALTERED/MOVED NOTES: Original site. Roof has been re-shingled with asphalt shingles. Horse stalls and grain bins removed. West 28' x 20' lined and converted into grain bin. Some of the foundation has been repaired with poured concrete.

INTERIOR NOTES: Was the original horse barn. Had six double horse stalls and a granary. Small out swing doors above horse stalls for ventilation. Two rows 6x6 posts and 6x6 beams supported the hayloft floor. 2x8 rough sawn cottonwood floor joists.

OTHER NOTES: Rough sawn cottonwood 2x6 walls 16'- 8" high. With horizontal sheathing and 1/2"x6" cedar lap siding. Two rows 4x6 posts of three each side with 2x6 beam to support the center of the rafters. These post were slanted. Native rock foundation with lime and sand mortar. 6x6 sill that is box dovetailed at the corners. 9"x12" four light windows. Rafters are rough sawn cottonwood 2x6's.

*PHYSICAL NOTES: Barn is in very good condition considering the age of the barn.

*RESTRICTED: Y or N

* = REQUIRED FIELD

**SOUTH DAKOTA STATE HISTORIC PRESERVATION OFFICE
HISTORIC SITES SURVEY STRUCTURE FORM**

SKETCH MAP

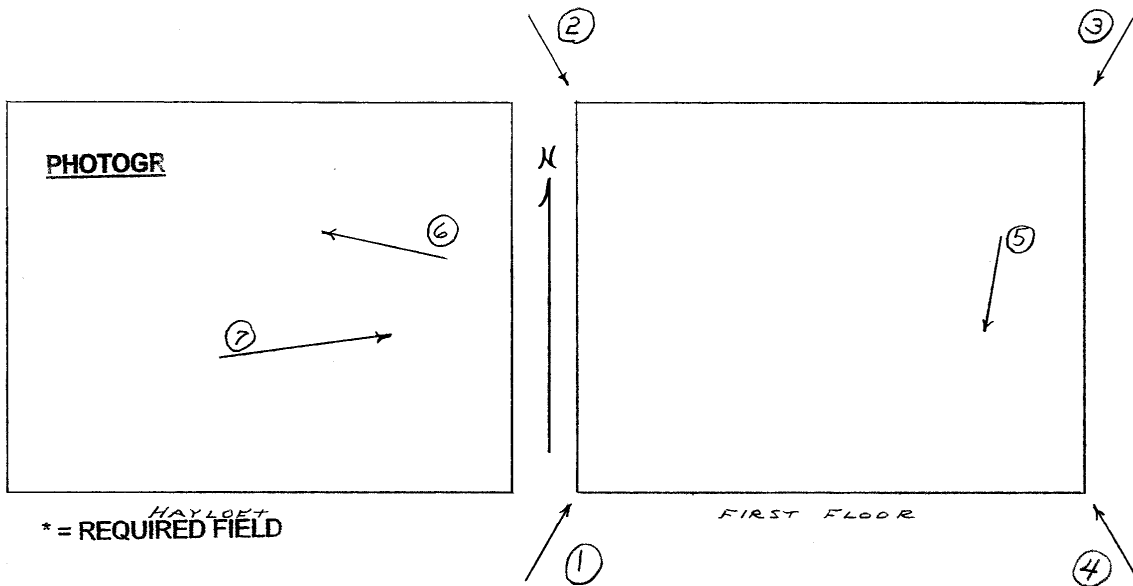
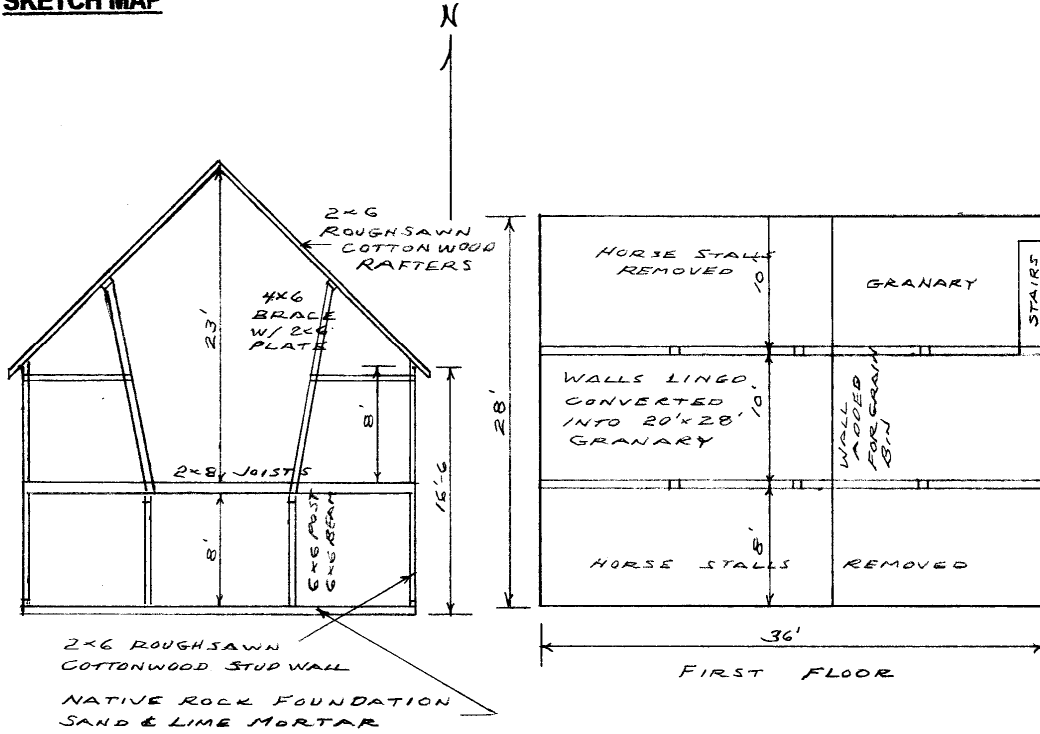

* = REQUIRED FIELD

**SOUTH DAKOTA STATE HISTORIC PRESERVATION OFFICE
HISTORIC SITES SURVEY STRUCTURE FORM**



PHOTOGRAPHER: Jim Stone
DATE OF PHOTO: June 19, 2012

ROLL NUMBER: _____
PHOTO NUMBER: 1

CAMERA DIRECTION: Looking NE, SW corner,
note doors above horse
stalls



PHOTOGRAPHER: Jim Stone
DATE OF PHOTO: June 19, 2012

ROLL NUMBER: _____
PHOTO NUMBER: 2

CAMERA DIRECTION: Looking SE, NW corner,
note doors above horse
stalls

* = REQUIRED FIELD

**SOUTH DAKOTA STATE HISTORIC PRESERVATION OFFICE
HISTORIC SITES SURVEY STRUCTURE FORM**



PHOTOGRAPHER: Jim Stone
DATE OF PHOTO: June 19, 2012

ROLL NUMBER: _____
PHOTO NUMBER: 3
CAMERA DIRECTION: Looking SW, NE corner



PHOTOGRAPHER: Jim Stone
DATE OF PHOTO: June 19, 2012

ROLL NUMBER: _____
PHOTO NUMBER: 4
CAMERA DIRECTION: Looking NW, SE corner

* = REQUIRED FIELD

**SOUTH DAKOTA STATE HISTORIC PRESERVATION OFFICE
HISTORIC SITES SURVEY STRUCTURE FORM**



PHOTOGRAPHER: Jim Stone
DATE OF PHOTO: June 19, 2012

ROLL NUMBER: _____
PHOTO NUMBER: 5

CAMERA DIRECTION: First floor, looking South, where some of the horse stalls were



PHOTOGRAPHER: Jim Stone
DATE OF PHOTO: June 19, 2012

ROLL NUMBER: _____
PHOTO NUMBER: 6

CAMERA DIRECTION: Hayloft, looking West, 4x6 posts & 2x6 beam supporting center of rafter

**SOUTH DAKOTA STATE HISTORIC PRESERVATION OFFICE
HISTORIC SITES SURVEY STRUCTURE FORM**



PHOTOGRAPHER: Jim Stone
DATE OF PHOTO: June 19, 2012

ROLL NUMBER: _____
PHOTO NUMBER: 7
CAMERA DIRECTION: Hayloft, looking East,
framing on gable end

**SOUTH DAKOTA STATE HISTORIC PRESERVATION OFFICE
HISTORIC SITES SURVEY STRUCTURE FORM**



T-94-N PLEASANT VALLEY DIRECTORY R-52-W

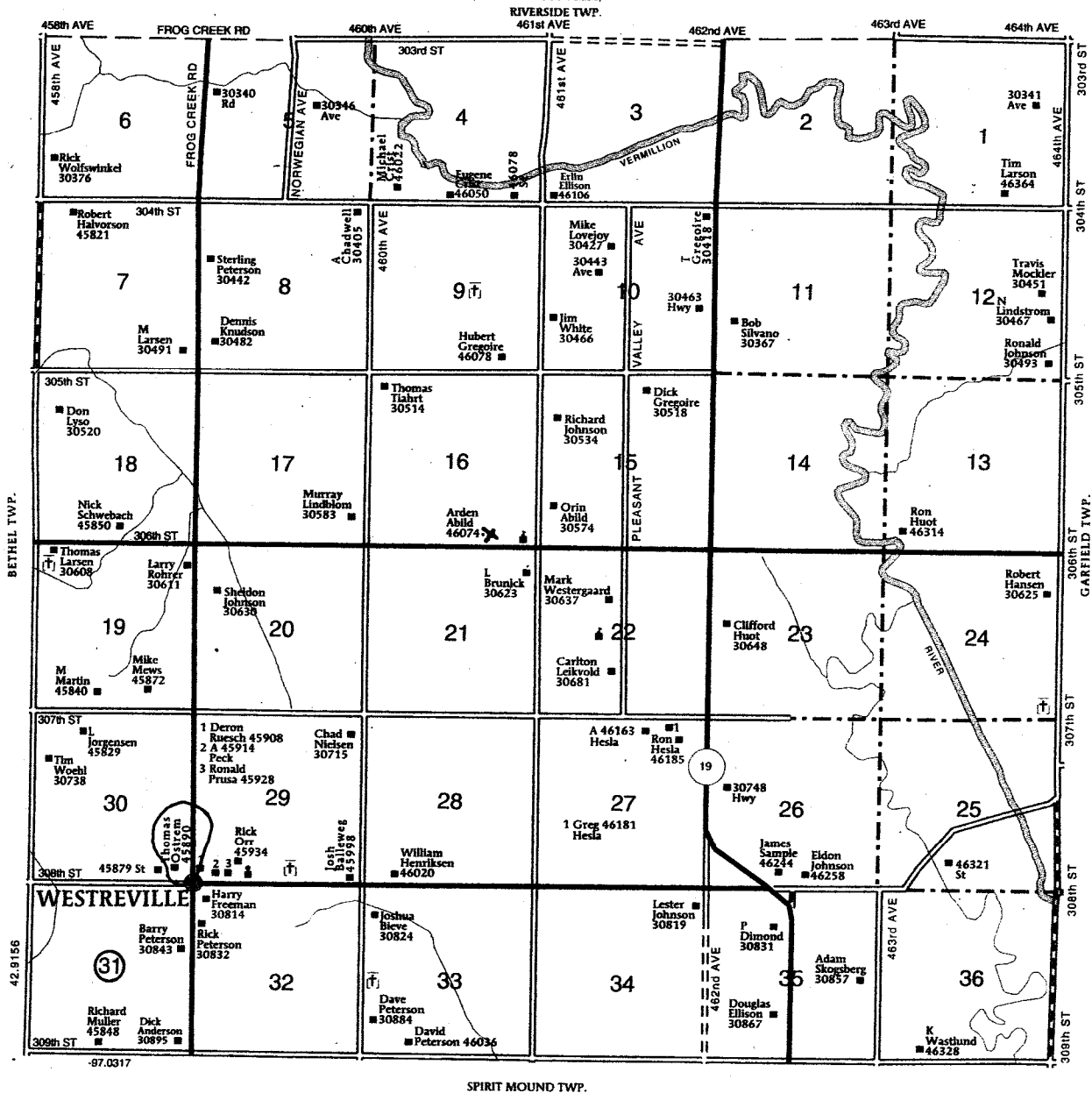

* = REQUIRED FIELD

HISTORY

This farm located in the SE ¼ of Section 30, Pleasant Valley Township, Clay County was homesteaded by Lindley Bailey.

The 1894 and 1901 Clay County Atlas lists John Westre as the owner.

The 1012, 1924 and 1937 Clay County Atlas lists Jay N. Westre as the owner.

The 1948 Clay County Atlas lists Carrie Westre as the owner.

The 1956 Clay County Atlas lists Chester Westre as the owner.

The Following Information Is From
Thomas Ostrem, the present owner.

They Started the Westreville store later. This barn is the first horse barn and has a sign on the south wall “Century Farm 1883 – 1983”. The family changed the name from Vestre to Westre soon after arriving in America.

Thomas Ostrem’s mother was a Westre.

Editor’s Note
The land was not homesteaded in 1883 by John T. Vestre. The 1884 Clay County map of original homesteaders shows John and Thomas J. Westre both homesteaded in Section 31, which is just South of this Section 30.

The Following Is From The

Wakonda, S. D. Centennial Book 1885 – 1985

John T. and Kristi Westre Family

By Bertha Ostrem

John T. (Jone) Westre and his wife, Kristi were both natives of Skjold, Norway. They came with their family to America in 1865 and settled in La Salle County, Illinois, later in Mahaska County, Iowa and then to Dakota Territory. They settled in Star Township near Wakonda, S. D. In the fall of 1871 they moved to the southwest $\frac{1}{4}$ of section 30 of Pleasant Valley township.*

This family had five sons and five daughters all of whom later settled in the same area in Pleasant Valley Township. It became known as Westreville. This family was very community minded and helped start a store, a school and a church which became known as the Bethel Lutheran Church. The sons and daughters of John T. and Kristi Westre were: Thomas J., Wife Martha; Chris J., wife Rhoda; Jacob, wife Colosta; Henry, wife Olive; John J., wife Mary; Rachelle, Mrs. Ed Bervin; Mary, Mrs Jacob Johnson; Sara, Mrs. Hans Skonvold; Bertha, Mrs. Nels Thompson; Ellen, Mrs. Lewis Bervin.

John J. Westre, my grandfather, at the age of 17 years, accompanied his parent on their journey to America. He was born on Norway in 1848. In 1870 when he came to Dakota territory, Star Township he homesteaded on 160 acres.** Aug 13, 1873, he married Mary Sorenson. They lived on the homestead for a number of years then, purchased and settled on the southeast $\frac{1}{4}$ of Section 30 of Pleasant Valley Township. Mr. Westre gave his full attention to buying and selling livestock and general farming. To this marriage four children were born; one son Jay N. Westre, and four daughters, Mable, Mrs. Oscar Gran; Nellie, Mrs. Joseph Elleson; Lillie, Mrs Joseph Thorson; and Bertie, Lillie's twin sister who died as a young child. John J. Westre purchased land and moved four miles west of Westreville(the farm known as the Wilma Backland farm). He did general farming and fed livestock there. In 1915 he retired and moved to Vermillion, S. D. and lived with his daughter, Mrs. Mable Gran, until his death in 1921. He was a charter member of the Bethlehem (Norwegian) Church and he retained his membership until his death. When John T. Westre moved to a larger farm in Bethel Township, his son Jay N. Westre took over the operation of the Westreville farm.

Jay N. Westre was born Dec. 11, 1874 in northern Clay County and as child moved with his parents to Westreville where he grew up. Feb. 18, 1903 in Vermillion, S. D., he married Carrie Nelson, a neighbor girl, who lived only two miles west and one-half north of where he grew up. She was the daughter of Amos and Karn Nelson, who were also homesteaders of the community. My father and mother spent their entire lives in Westreville as farmers. They were interested in the school and church, my father being an officer of the Pleasant Valley Lutheran Church. To this marriage were born two sons, Norman J. and Chester and two daughters, Minora and Bertha.

* = REQUIRED FIELD

**SOUTH DAKOTA STATE HISTORIC PRESERVATION OFFICE
HISTORIC SITES SURVEY STRUCTURE FORM**



As for myself (Bertha) I was born at Westreville Oct. 16, 1910. I attended rural school, graduated from Vermillion High School and attended the University of South Dakota and received a teacher's degree and taught five years in rural schools of Clay County. I married a farmer, Joseph Ostrem, June 22, 1935. We farmed in Clay and Yankton Counties and I worked as a credit clerk for Montgomery Ward, Yankton, S. D. and in the office of the Gurney Co. Upon the death of my father Jay N. Westre, Joe and I moved to Westreville and farmed, making our home with my mother. We later purchased the Westre farm. Joe and I have three children; Christine, Karen and Thomas J. They all attended Westreville rural school until it became part of Wakonda District and are graduates of Wakonda High School. Kristine now lives in Spearfish, S. D. and Karen lives in New Ibers, La.

In early 1970 Joe's health failed and we quit farming. A few years after his death, Jan. 27, 1978, I moved to the Wakonda apartment. Thomas, his wife Carla (Girard) and children Joseph and Carrie, now live on the farm. Thomas is the fourth generation to live on this farm. We believe that he is the only Westre descendant still living in the Westreville, a village that was named from the Westre relatives five generations ago.

Editors Notes

From the 1884 Clay County homesteaders map.

*John J. Westre purchased the SE ¼ in Section 30, Pleasant Valley Township. He also homesteaded the NW ¼ of the NE ¼ and the NE ¼ of the NW ¼ and NE ¼ of the SW ¼ all in Section 31, Pleasant Valley township. This land is located south just across the road. At the same time John J. Westre's brother Thomas J. homesteaded The S ½ of the NE1/4 and the N ½ of the SE ¼ in Section 31, Pleasant Valley Township.

**John J. Westre homesteaded the NE ¼ of Section 6 in Star Township. His father homesteaded the N1/4 of Section 13 in Star Township at the same time.

**SOUTH DAKOTA STATE HISTORIC PRESERVATION OFFICE
HISTORIC SITES SURVEY STRUCTURE FORM**

