

**SOUTH DAKOTA STATE HISTORIC PRESERVATION OFFICE  
HISTORIC SITES SURVEY STRUCTURE FORM**



**SITE INFORMATION**

\*SURVEY DATE: October 24, 2012 \*ADDRESS: 46852 Burbank Road  
\*SURVEYOR: Jim Stone \*COUNTY: Clay  
\*CITY: Burbank

LOCATION DESCRIPTION: From intersection of Main Street and Dakota Street in Vermillion, South  
About ¼ mile to Burbank Road, turn left (East), follow This road about 5 miles, turn Left (North) at  
address 46852 Burbank Road.

LEGAL DESCRIPTION: Macy Tract 1 of NW ¼, NE ¼ & NE ¼, NW ¼, 35 – 92 – 51 Fairview Twp.

\*QUARTER 1: NW 1/4  
\*QUARTER 2: \_\_\_\_\_  
\*TOWNSHIP: Fairview  
\*RANGE: 51  
\*SECTION: 35  
ACRES: 9.82

OWNER NAME: Kevin Lynch  
OWNER ADDRESS: 46852 Burbank road  
OWNER CITY: Burbank  
OWNER STATE: South Dakota  
OWNER ZIP: 57010  
QUAD NAME: \_\_\_\_\_

OWNER CODE 1: P  
OWNER CODE 2: \_\_\_\_\_  
OWNER CODE 3: \_\_\_\_\_

**HISTORIC SIGNIFICANCE**

\*DOE: \_\_\_\_\_  
\*DOE DATE: \_\_\_\_\_  
REASON INELIGIBLE: \_\_\_\_\_

REGISTER NAME: \_\_\_\_\_  
MULTIPLE PROPERTY NAME: \_\_\_\_\_

NOMINATION STATUS: \_\_\_\_\_  
DATE LISTED: \_\_\_\_\_  
REFERENCE NUMBER: \_\_\_\_\_  
HISTORIC DISTRICT RATING: C or NC  
PERIOD: \_\_\_\_\_

CATEGORY: \_\_\_\_\_  
SIGNIFICANCE LEVEL 1: N S L  
SIGNIFICANCE LEVEL 2: N S L  
CRITERIA 1: A B C D  
CRITERIA 2: A B C D  
CRITERIA 3: A B C D  
CRITERIA 4: A B C D

SIGNIFICANCE NOTES: \_\_\_\_\_  
\_\_\_\_\_  
\_\_\_\_\_

**STRUCTURE DETAILS**

\* = REQUIRED FIELD

**SOUTH DAKOTA STATE HISTORIC PRESERVATION OFFICE  
HISTORIC SITES SURVEY STRUCTURE FORM**



SHPO ID: \_\_\_\_\_  
 \*PROPERTY NAME: \_\_\_\_\_  
 OTHER NAME: \_\_\_\_\_

CURRENT FUNCTION: <u>Storage</u>	FOUNDATION: <u>Poured concrete foundation</u>
CURRENT SUBFUNCTION: <u>Storage</u>	ROOF MATERIAL: <u>Steel roofing over cedar shingles</u>
HISTORIC FUNCTION: <u>Livestock barn</u>	ROOF SHAPE: <u>Gambrel</u>
HISTORIC SUBFUNCTION: <u>Hay and grain storage</u>	STRUCTURAL SYSTEM: <u>Balloon framing</u>
	STYLE: <u>Gambrel roof barn</u>
OCCUPIED: <u>Yes</u>	TYPE: <u>Livestock barn</u>
	<u>2x6 stud with 1x8 sheathing and 1/2"x6" cedar lap siding.</u>
ACCESSIBLE: <u>Yes with permission</u>	WALLS: _____

STORIES: 2                      SIGNIFICANT PERSON: Wallace L. Cusick  
 \*DATE OF CONSTRUCTION: 1927                      CULTURAL AFFILIATION: ?

ALTERED/MOVED NOTES: Original site. Roof covered with steel roofing.

INTERIOR NOTES: Has two rows of 6x6 posts 10' O. C. with 6x8 beams. 2x10 floor joists. All of the 2x6's, 2x10's, 2x12's, 6x6's, 6x8's and 3/4" roof sheathing lumber is rough sawn cottonwood. Granaries in the SW and SE corners are still in place. Five double horse stalls and one single horse stall are still in place.

OTHER NOTES: 2x6 stud walls with 1x8 sheathing (sheathing is actually 1x8 red painted siding that has been salvaged and applied backwards) and 1/2"x6" cedar lap siding. Rafters are 2x6 with (2) 1x6 braces at the hip. A 2x12 brace, 4'-6"-8'-4'-8'-4'-6' O.C. from South end, runs from the center of top rafter down to the floor. 1x6 braces tie this 2x12 brace to the rafters at three points. It creates 1/2 of a Shawver truss. Has a dormer on the East side of roof. Dormer has three 9"x12" four light windows. Metal cupola.

\*PHYSICAL NOTES: Barn is in good condition. Has a lot of water stains from the roof leaking before the new steel roof was applied.

\*UTM ZONE: \_\_\_\_\_

\*RESTRICTED: Y or N

\*UTM EASTING: \_\_\_\_\_

\*UTM NORTHING: \_\_\_\_\_

\* = REQUIRED FIELD

**SOUTH DAKOTA STATE HISTORIC PRESERVATION OFFICE  
HISTORIC SITES SURVEY STRUCTURE FORM**



**SKETCH MAP**

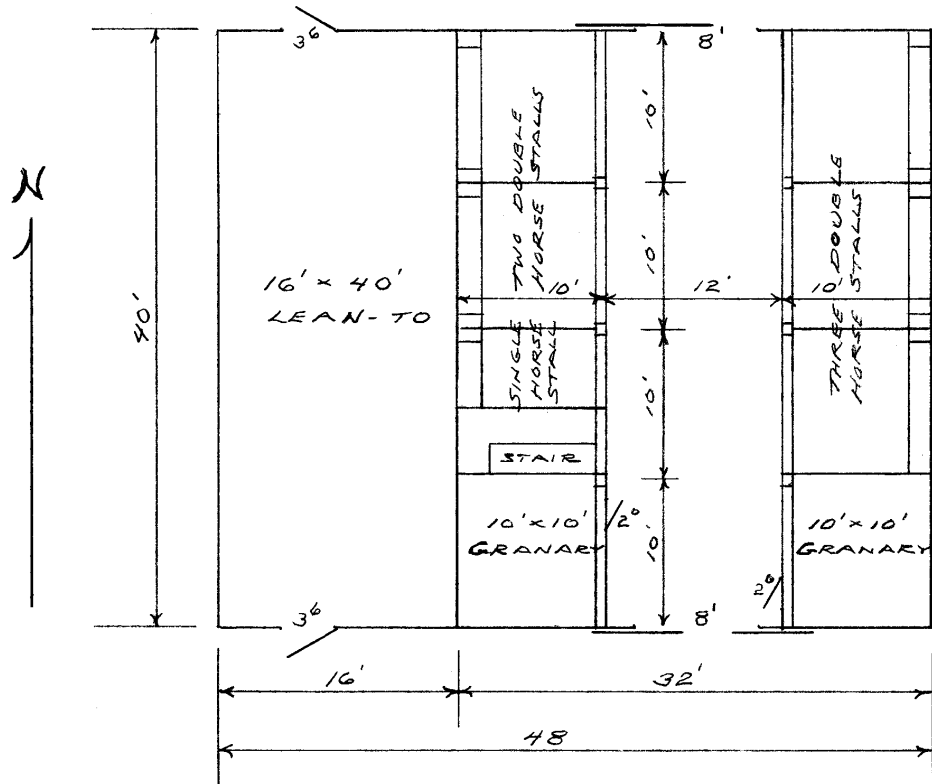

**PHOTOGR**

\* = REQUIRED FIELD

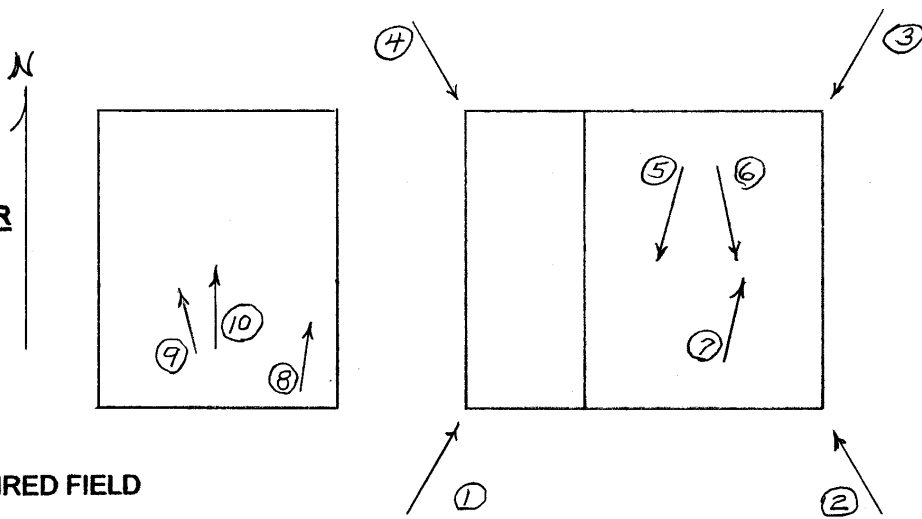

\* = REQUIRED FIELD

**SOUTH DAKOTA STATE HISTORIC PRESERVATION OFFICE  
HISTORIC SITES SURVEY STRUCTURE FORM**



**SKETCH MAP**

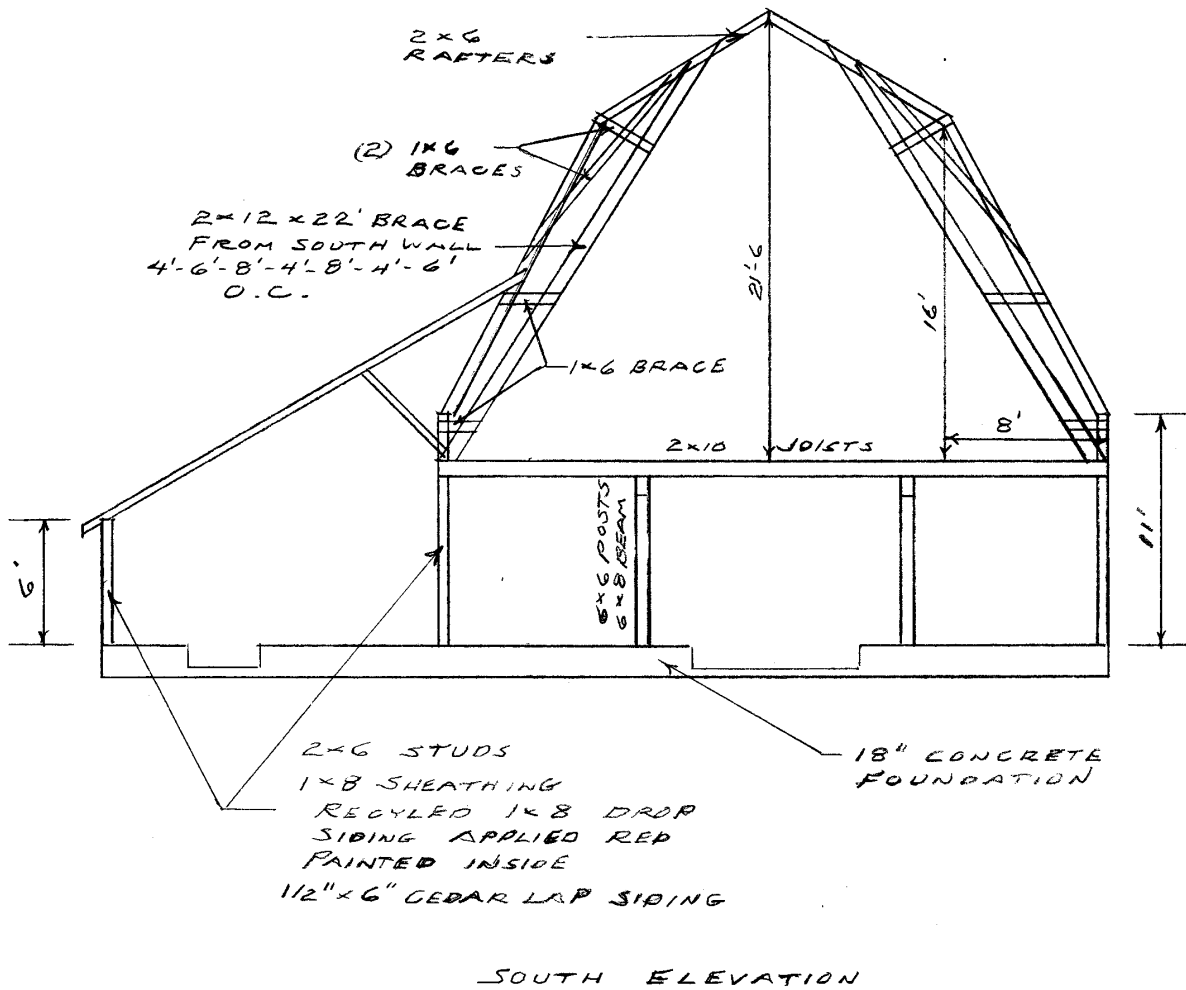

**PHOTOGR**

\* = REQUIRED FIELD

**SOUTH DAKOTA STATE HISTORIC PRESERVATION OFFICE  
HISTORIC SITES SURVEY STRUCTURE FORM**



**PHOTOGRAPHER:** Jim Stone  
**DATE OF PHOTO:** October 24, 2012

**ROLL NUMBER:** \_\_\_\_\_  
**PHOTO NUMBER:** 1  
**CAMERA DIRECTION:** Looking NE, SW corner



**PHOTOGRAPHER:** Jim Stone  
**DATE OF PHOTO:** October 24, 2012

**ROLL NUMBER:** \_\_\_\_\_  
**PHOTO NUMBER:** 2  
**CAMERA DIRECTION:** Looking NW, SE corner

\* = REQUIRED FIELD

**SOUTH DAKOTA STATE HISTORIC PRESERVATION OFFICE  
HISTORIC SITES SURVEY STRUCTURE FORM**



**PHOTOGRAPHER:** Jim Stone  
**DATE OF PHOTO:** October 24, 2012

**ROLL NUMBER:** \_\_\_\_\_  
**PHOTO NUMBER:** 3  
**CAMERA DIRECTION:** Looking SW, NE corner



**PHOTOGRAPHER:** Jim Stone  
**DATE OF PHOTO:** October 24, 2012

**ROLL NUMBER:** \_\_\_\_\_  
**PHOTO NUMBER:** 4  
**CAMERA DIRECTION:** Looking SE, NW corner

\* = REQUIRED FIELD

**SOUTH DAKOTA STATE HISTORIC PRESERVATION OFFICE  
HISTORIC SITES SURVEY STRUCTURE FORM**



**PHOTOGRAPHER:** Jim Stone  
**DATE OF PHOTO:** October 24, 2012

**ROLL NUMBER:** \_\_\_\_\_  
**PHOTO NUMBER:** 5

**CAMERA DIRECTION:** First floor, looking SW,  
granary in SW corner  
and stairs to hayloft



**PHOTOGRAPHER:** Jim Stone  
**DATE OF PHOTO:** October 24, 2012

**ROLL NUMBER:** \_\_\_\_\_  
**PHOTO NUMBER:** 6

**CAMERA DIRECTION:** First floor, looking SE,  
granary in SE corner,  
note water stains on  
joists and granary wall  
from roof leaking before  
the new roof.

\* = REQUIRED FIELD

**SOUTH DAKOTA STATE HISTORIC PRESERVATION OFFICE  
HISTORIC SITES SURVEY STRUCTURE FORM**



**PHOTOGRAPHER:** Jim Stone  
**DATE OF PHOTO:** October 24, 2012

**ROLL NUMBER:** 7  
**PHOTO NUMBER:** 7

**CAMERA DIRECTION:** First floor, looking NE,  
posts and beam and  
horse stalls on East wall.



**PHOTOGRAPHER:** Jim Stone  
**DATE OF PHOTO:** October 24, 2012

**ROLL NUMBER:** 8  
**PHOTO NUMBER:** 8

**CAMERA DIRECTION:** Hayloft, looking North,  
2x12 bracing, almost 1/2  
of Shawver truss.

\* = REQUIRED FIELD



**SOUTH DAKOTA STATE HISTORIC PRESERVATION OFFICE  
HISTORIC SITES SURVEY STRUCTURE FORM**



**PHOTOGRAPHER:** Jim Stone  
**DATE OF PHOTO:** October 24, 2012

**ROLL NUMBER:** \_\_\_\_\_  
**PHOTO NUMBER:** 9

**Hayloft, looking North,  
2x12 brace and leat-to  
framing on West side.**

**CAMERA DIRECTION:** \_\_\_\_\_



**PHOTOGRAPHER:** Jim Stone  
**DATE OF PHOTO:** October 24, 2012

**ROLL NUMBER:** \_\_\_\_\_  
**PHOTO NUMBER:** 10

**Hayloft, looking North,  
gable end, sheathing is  
1x8 recycled siding  
painted red and applied  
face side in.**

**CAMERA DIRECTION:** \_\_\_\_\_

\* = REQUIRED FIELD

# SOUTH DAKOTA STATE HISTORIC PRESERVATION OFFICE HISTORIC SITES SURVEY STRUCTURE FORM



T-91-92-N

## FAIRVIEW DIRECTORY

R-51-W

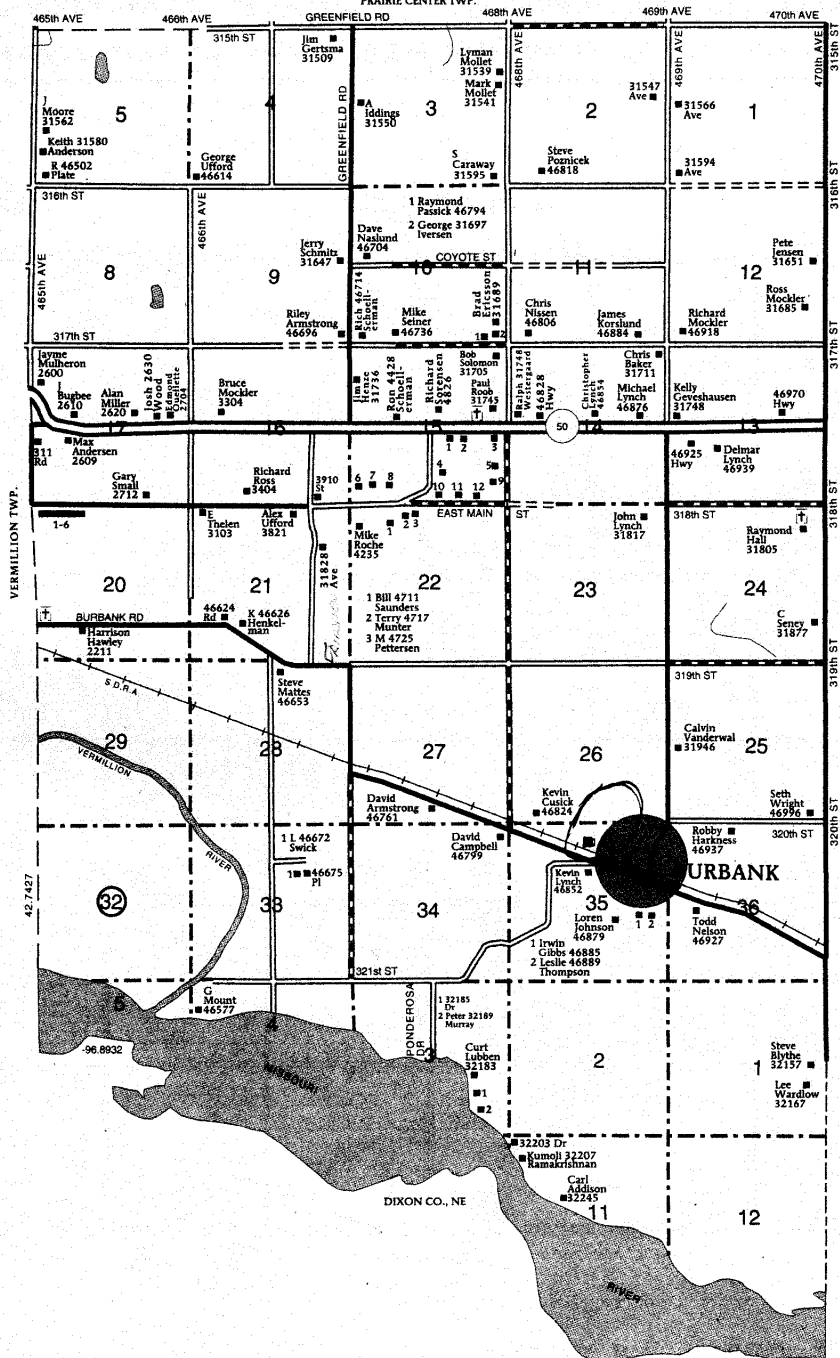

FAIRVIEW TOWNSHIP		
1 Turnbaugh, V 5009	6 Meyer, Leroy 4206	SECTION 20
2 Ashes, Severn 5225	7 Nauertz, James 4306	1 2509
3 Behrmann, David 31761	8 Schoenrock, K 4424	2 Crew, M 2531
4 Albers, Dave 4745	9 Knutson, Richard 5101	3 Neitzke, Mark 2703
5 Ouellette, Loren 31765	10 Mogck, John 4733	4 Cook, Cleland 2711
	11 Miller, Stan 4901	5 Miskimins, Robin 2835
	12 Hovden, Donald 4905	6 Ahmed, Mike 2925

© Farm & Home Publishers, Ltd.

\* = REQUIRED FIELD

## **HISTORY**

This farm located in the NW ¼ and the NE ¼ of the NW ¼ of Section 35, Fairview, Township, Clay County was homesteaded by Jesse Fisher.

The 1894 and 1901 Clay County Atlas lists Caroline Maynard as the owner.

The 1912 Clay County Atlas lists F. H. Maynard as the owner.

The 1924, 1937 and 1948 Clay County Atlas lists Wallace L. Cusick as the owner.

The 1956 Clay County Atlas lists Laverne Macy as the owner.

**The Following Information Courtesy of  
Clay County Historical Society**

Wallace L. Cusick was born October 11, 1875 at Burbank, South Dakota. His parents were Nelson William Cusick and Anna Louise (Ladieu). They homesteaded in Section 26, less that a ½ mile from this farm.

Farm was bought by Wallace Cusick. He built this barn in 1927. He had a sawmill on his farm, which was just over a 1/2 mile northwest of this farm. He cut the cottonwood logs on his farm, which was the original homestead and sawed the lumber for this barn.

His daughter LaVerne Belle, who married Arthur Solomon Macy February 12, 1919, rented this farm from Wallace and then later bought the farm.

**SOUTH DAKOTA STATE HISTORIC PRESERVATION OFFICE  
HISTORIC SITES SURVEY STRUCTURE FORM**

