

**SOUTH DAKOTA STATE HISTORIC PRESERVATION OFFICE  
HISTORIC SITES SURVEY STRUCTURE FORM**



**SITE INFORMATION**

\*SURVEY DATE: January 18, 2013 \*ADDRESS: 46562 312<sup>th</sup> Street  
\*SURVEYOR: Jim Stone \*COUNTY: Clay  
\*CITY: Vermillion

LOCATION DESCRIPTION: From Vermillion, South Dakota Highway 50, East 2 miles to Greenfield Road, turn left (North) 5-1/2 miles to 312th Street turn left (West), about 2-1/3 miles, on the right (North) side.

LEGAL DESCRIPTION: SW 1/4 , SE 1/4, Exc. Lots H 1 & H 2, 17- 93 - 51 Prairie Center Twp.

\*QUARTER 1: SW 1/4 OWNER NAME: Matthew E. Olson  
\*QUARTER 2: SE 1/4 OWNER ADDRESS: 46562 312<sup>th</sup> Street  
\*TOWNSHIP: Prairie Center OWNER CITY: Vermillion  
\*RANGE: 51 OWNER STATE: South Dakota  
\*SECTION: 17 OWNER ZIP: 57069  
ACRES: 38.50 QUAD NAME: \_\_\_\_\_

OWNER CODE 1: P  
OWNER CODE 2:  
OWNER CODE 3:

**HISTORIC SIGNIFICANCE**

\*DOE: \_\_\_\_\_ REGISTER NAME: \_\_\_\_\_  
\*DOE DATE: \_\_\_\_\_ MULTIPLE PROPERTY NAME: \_\_\_\_\_  
REASON INELIGIBLE: \_\_\_\_\_

NOMINATION STATUS: \_\_\_\_\_ CATEGORY: \_\_\_\_\_  
DATE LISTED: \_\_\_\_\_ SIGNIFICANCE LEVEL 1: N S L  
REFERENCE NUMBER: \_\_\_\_\_ SIGNIFICANCE LEVEL 2: N S L  
HISTORIC DISTRICT RATING: C or NC CRITERIA 1: A B C D  
PERIOD: \_\_\_\_\_ CRITERIA 2: A B C D  
CRITERIA 3: A B C D  
CRITERIA 4: A B C D

SIGNIFICANCE NOTES: \_\_\_\_\_  
\_\_\_\_\_  
\_\_\_\_\_

**STRUCTURE DETAILS**

\* = REQUIRED FIELD

**SOUTH DAKOTA STATE HISTORIC PRESERVATION OFFICE  
HISTORIC SITES SURVEY STRUCTURE FORM**



SHPO ID: \_\_\_\_\_  
 \*PROPERTY NAME: \_\_\_\_\_  
 OTHER NAME: \_\_\_\_\_

CURRENT FUNCTION: <u>Machinery storage</u>	FOUNDATION: <u>Poured concrete foundation</u>
CURRENT SUBFUNCTION: <u>Machinery storage</u>	ROOF MATERIAL: <u>Asphalt shingles over cedar shingles</u>
HISTORIC FUNCTION: <u>Livestock barn</u>	ROOF SHAPE: <u>Gable</u>
HISTORIC SUBFUNCTION: <u>Hay storage</u>	STRUCTURAL SYSTEM: <u>Balloon framing Western feeder barn</u>
OCCUPIED: <u>Yes</u>	STYLE: <u>barn</u>
ACCESSIBLE: <u>Yes with permission</u>	TYPE: <u>Livestock barn 2x6 &amp; 2x4 studs, sheathing &amp; 1/2"x6" cedar lap siding</u>
STORIES: <u>2</u>	WALLS: _____
*DATE OF CONSTRUCTION: <u>1910 to 1920</u>	SIGNIFICANT PERSON: <u>Theo Anker</u>
	CULTURAL AFFILIATION: <u>?</u>

**ALTERED/MOVED NOTES:** Original site. Any evidence of milk cow stanchions or horse stalls has been removed in the center of barn. Hayloft floor has been removed except the North 8'. A lot of bracing added to re-enforce rafters after removing hayloft floor. Large 17' x 13' sliding doors added on the South wall to allow large machinery into barn. 44' x 29' pole barn lean-to added on the East side.

**INTERIOR NOTES:** Had two rows of 6x6 posts, with 6x6's for beams. Floor joists are 2x8's for hayloft floor. Three single horse stalls and cattle shelter still in place on the West lean-to.

**OTHER NOTES:** 2x6 stud walls with 1/2"x6" drop siding. The 7' West wall is 2x4 studs. The 2x6 studs on the 18' wall on the West wall of the center barn are 2' O.C. with 1x10 shiplap on the first floor. The studs are double in hayloft and 4' O. C. on the same West wall. Rafters are 2x6's with 2x6 bracing. 2 x 8 floor joists that were removed have been used as bracing to re-enforce the rafters, after the hayloft floor was removed. Windows are 9" x 12" four light. Metal cupola is still in place.

**\*PHYSICAL NOTES:** Barn is in good condition.

\_\_\_\_\_  
 \_\_\_\_\_  
 \_\_\_\_\_

\*UTM ZONE: \_\_\_\_\_ \*RESTRICTED: Y or N  
 \*UTM EASTING: \_\_\_\_\_  
 \*UTM NORTHING: \_\_\_\_\_

\* = REQUIRED FIELD

**SOUTH DAKOTA STATE HISTORIC PRESERVATION OFFICE  
HISTORIC SITES SURVEY STRUCTURE FORM**



**SKETCH MAP**

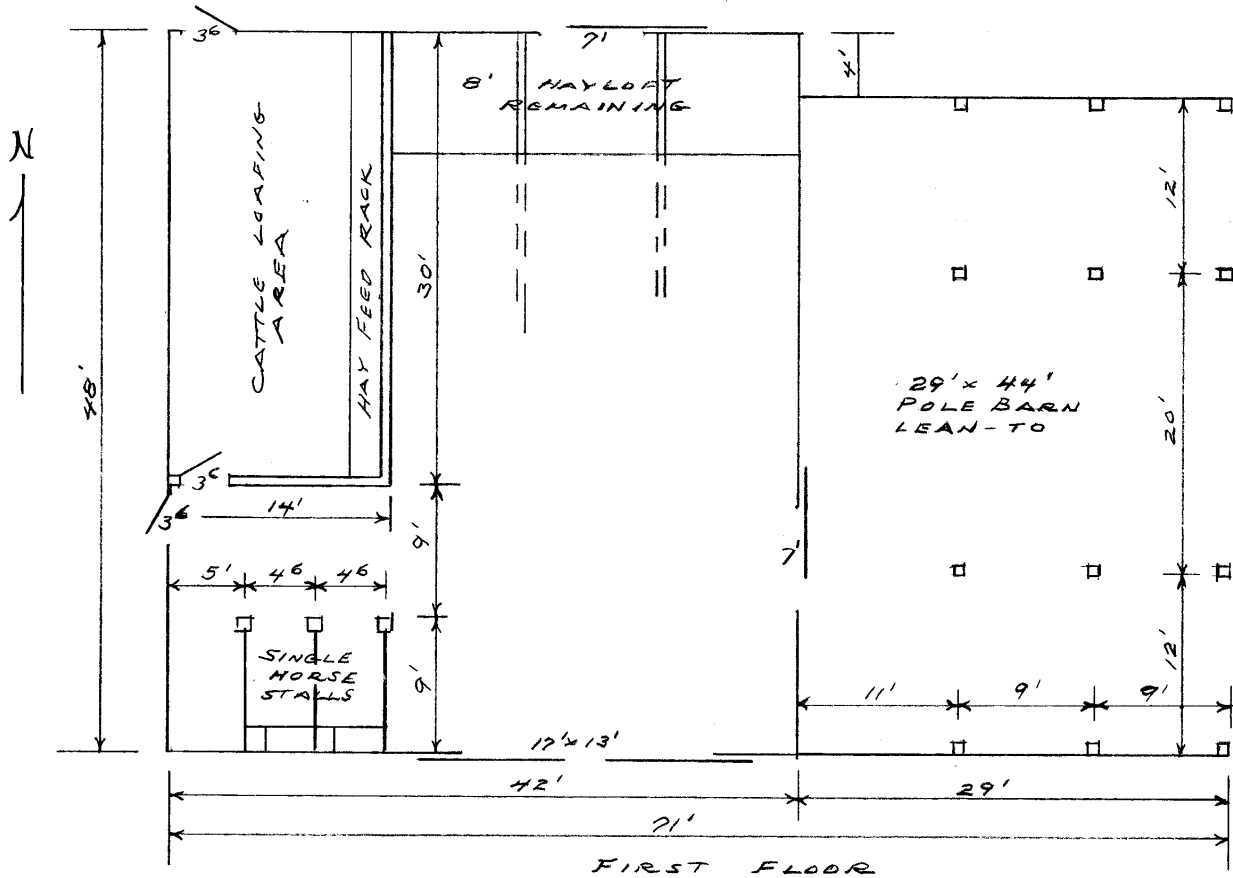

**PHOTOGR**

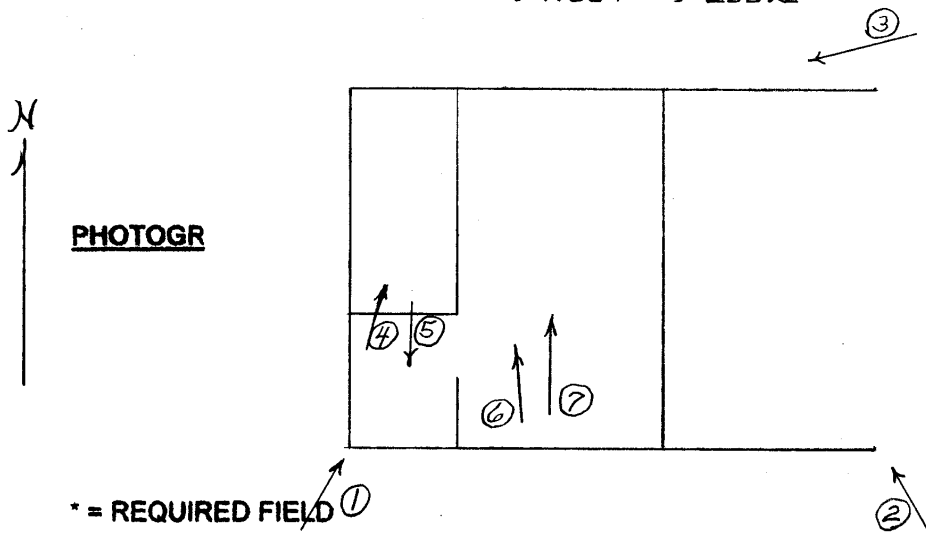

\* = REQUIRED FIELD ①

SOUTH DAKOTA STATE HISTORIC PRESERVATION OFFICE  
HISTORIC SITES SURVEY STRUCTURE FORM



**SKETCH MAP**

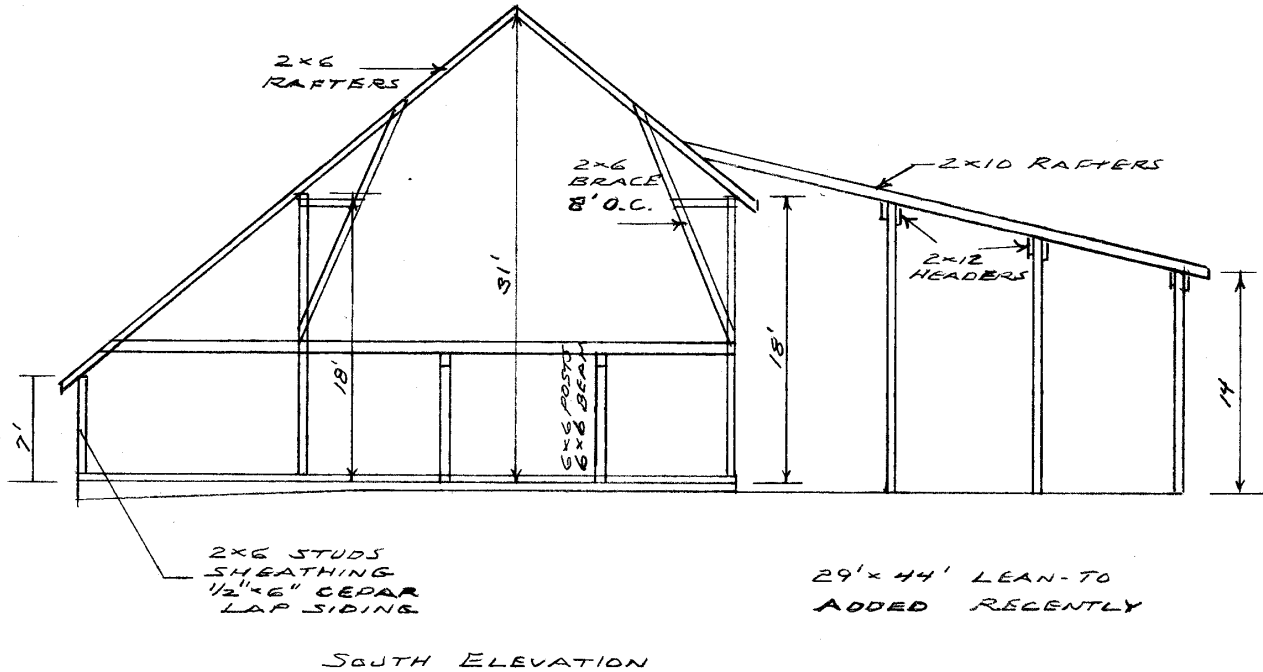

**PHOTOGR**

\* = REQUIRED FIELD

**SOUTH DAKOTA STATE HISTORIC PRESERVATION OFFICE  
HISTORIC SITES SURVEY STRUCTURE FORM**



**PHOTOGRAPHER:** Jim Stone  
**DATE OF PHOTO:** January 18, 2013

**ROLL NUMBER:** \_\_\_\_\_  
**PHOTO NUMBER:** 1  
**CAMERA DIRECTION:** Looking NE, SW corner



**PHOTOGRAPHER:** Jim Stone  
**DATE OF PHOTO:** January 18, 2013

**ROLL NUMBER:** \_\_\_\_\_  
**PHOTO NUMBER:** 2  
**CAMERA DIRECTION:** Looking NW, SE corner

\* = REQUIRED FIELD

**SOUTH DAKOTA STATE HISTORIC PRESERVATION OFFICE  
HISTORIC SITES SURVEY STRUCTURE FORM**



**PHOTOGRAPHER:** Jim Stone  
**DATE OF PHOTO:** January 18, 2013

**ROLL NUMBER:** 3  
**PHOTO NUMBER:** 3  
**CAMERA DIRECTION:** Looking SW, NE corner



**PHOTOGRAPHER:** Jim Stone  
**DATE OF PHOTO:** January 18, 2013

**ROLL NUMBER:** 4  
**PHOTO NUMBER:** 4  
**CAMERA DIRECTION:** First floor, looking NE, cattle shelter and hay feed rack in the North end of West lean-to

\* = REQUIRED FIELD

**SOUTH DAKOTA STATE HISTORIC PRESERVATION OFFICE  
HISTORIC SITES SURVEY STRUCTURE FORM**



**PHOTOGRAPHER:** Jim Stone  
**DATE OF PHOTO:** January 18, 2013

**ROLL NUMBER:** \_\_\_\_\_  
**PHOTO NUMBER:** 5

**First floor, West lean-to, looking South, one of the single horse stalls on South wall.**

**CAMERA DIRECTION:** \_\_\_\_\_



**PHOTOGRAPHER:** Jim Stone  
**DATE OF PHOTO:** January 18, 2013

**ROLL NUMBER:** \_\_\_\_\_  
**PHOTO NUMBER:** 6

**First floor, looking up, double 2x6 studs on the West wall of center of barn and 2x6 original bracing and 2x8 added bracing.**

**CAMERA DIRECTION:** \_\_\_\_\_

\* = REQUIRED FIELD

**SOUTH DAKOTA STATE HISTORIC PRESERVATION OFFICE  
HISTORIC SITES SURVEY STRUCTURE FORM**



**PHOTOGRAPHER:** Jim Stone  
**DATE OF PHOTO:** January 18, 2013

**ROLL NUMBER:** \_\_\_\_\_  
**PHOTO NUMBER:** 7

**CAMERA DIRECTION:** First floor, looking up, 2x8 cross bracing to re-enforce rafters after removing hayloft floor.



SOUTH DAKOTA STATE HISTORIC PRESERVATION OFFICE  
 HISTORIC SITES SURVEY STRUCTURE FORM

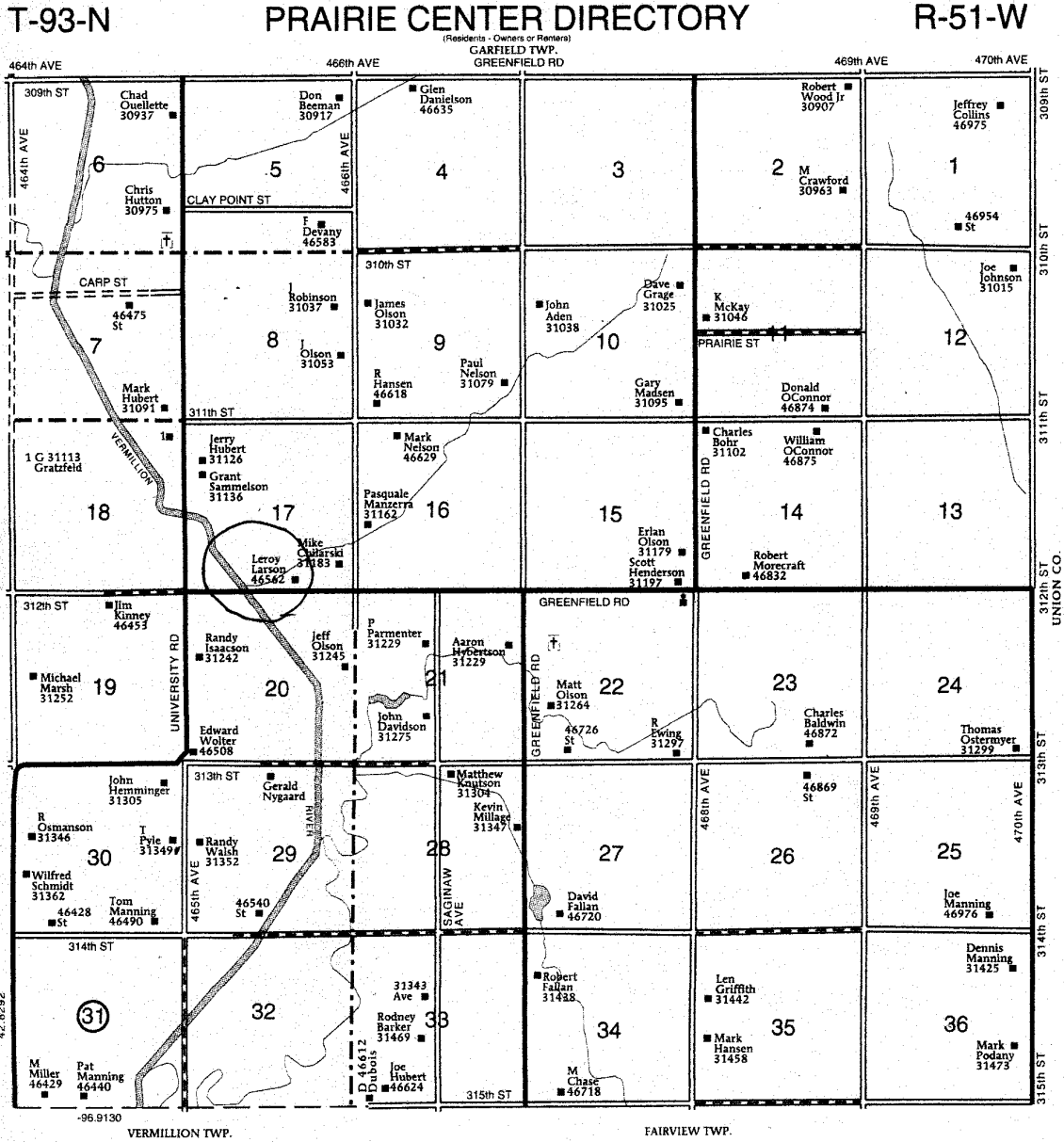

\* = REQUIRED FIELD

## **HISTORY**

This farm located in the SE ¼ of Section 17, Prairie Center Township, Clay County was homesteaded by August Nyman.

The 1894 Clay County Atlas lists H. G. & M. H. Anderson as the owners.

1901 and 1912 Clay County Atlas lists Theo. Anker as the owner.

The 1924, 1937, 1948 and 1956 Clay county Atlas lists B. K. Jaeger as the owner.