

**SOUTH DAKOTA STATE HISTORIC PRESERVATION OFFICE
HISTORIC SITES SURVEY STRUCTURE FORM**



SITE INFORMATION

*SURVEY DATE: July 13, 2012 *ADDRESS: 45587 307th Street
*SURVEYOR: Jim Stone *COUNTY: Clay
*CITY: Volin

LOCATION DESCRIPTION: From intersection of South Dakota Highway 50 bi-pass and South Dakota Highway 19, North about 1/2 mile to Bluff Road, turn left (West), follow Bluff Road for 11-1/4 miles to 456th Street, turn right (North) 1-3/4 miles to 307th Street, turn left (West) about 1/4 mile, on the left (South) side.
LEGAL DESCRIPTION: Lot 1 OF Nicholl's Tract 1, NE 1/4, 27 - 94 - 53 Bethel Twp.

*QUARTER 1: NE 1/4
*QUARTER 2: _____
*TOWNSHIP: Bethel
*RANGE: 53
*SECTION: 27
ACRES: 5.75

OWNER NAME: Rodney T. & Kayleen A. Deacon
OWNER ADDRESS: 45587 307th Street
OWNER CITY: Volin
OWNER STATE: South Dakota
OWNER ZIP: 57072
QUAD NAME: _____

OWNER CODE 1: P
OWNER CODE 2: F S L P
OWNER CODE 3: F S L P

HISTORIC SIGNIFICANCE

*DOE: _____
*DOE DATE: _____
REASON INELIGIBLE: _____

REGISTER NAME: _____
MULTIPLE PROPERTY NAME: _____

NOMINATION STATUS: _____
DATE LISTED: _____
REFERENCE NUMBER: _____
HISTORIC DISTRICT RATING: C or NC
PERIOD: _____

CATEGORY: _____
SIGNIFICANCE LEVEL 1: N S L
SIGNIFICANCE LEVEL 2: N S L
CRITERIA 1: A B C D
CRITERIA 2: A B C D
CRITERIA 3: A B C D
CRITERIA 4: A B C D

SIGNIFICANCE NOTES: This barn was built before the 1900's, because of the sand and lime mortar On the native rock basement walls and foundation on the west 16'. Portland cement was not available until the late 1890's.

STRUCTURE DETAILS

* = REQUIRED FIELD

**SOUTH DAKOTA STATE HISTORIC PRESERVATION OFFICE
HISTORIC SITES SURVEY STRUCTURE FORM**



SHPO ID: _____

*PROPERTY NAME: _____

OTHER NAME: _____

CURRENT FUNCTION:	<u>Farm machinery storage</u>	FOUNDATION:	<u>Native rock, sand and lime mortar</u>
CURRENT SUBFUNCTION:	<u>Storage</u>	ROOF MATERIAL:	<u>Cedar shingles</u>
HISTORIC FUNCTION:	<u>Livestock barn</u>	ROOF SHAPE:	<u>Gable</u>
HISTORIC SUBFUNCTION:	<u>Hay and grain storage</u>	STRUCTURAL SYSTEM:	<u>Balloon framing Gable roof bank barn</u>
		STYLE:	<u>barn</u>
OCCUPIED:	<u>Yes</u>	TYPE:	<u>Livestock barn</u>
	<u>Yes with permission</u>	WALLS:	<u>2x6, 1x8 ? drop siding</u>
ACCESSIBLE:			
STORIES:	<u>2</u>	SIGNIFICANT PERSON:	<u>T. T. Orton</u>
*DATE OF CONSTRUCTION:	<u>Pre - 1900</u>	CULTURAL AFFILIATION:	<u>Norwegian</u>

ALTERED/MOVED NOTES: Original site. Some of the basement walls have been repaired with Portland cement mortar and a short section has been replaced with poured concrete in the SW corner of the basement.

INTERIOR NOTES: Has two rows 6x8 posts and 6x8 beams to support hayloft floor in the East 50' (basement area). One row 6x8 posts and 6x8 beam in the West 16', but extends 6' more over the hayloft above the hayloft over the basement. Milk cow stanchions are still in place in the West 16'

OTHER NOTES: Windows were 8"x10" four light. Walls are 2x6 with 1x8 drop siding (a pattern that I can't identify). Rafters are 2x6. Floor joists are 2x8's. The West hayloft is 32' x 22' and 19' to the peak. The East hayloft is 32' x 50' and is 27'-6" to the peak. This barn could hold over 100 tons of loose hay.

*PHYSICAL NOTES: Barn is in poor condition. The rock walls are crumbling. The roof is leaking and rotting out the hayloft floor over the basement.

**SOUTH DAKOTA STATE HISTORIC PRESERVATION OFFICE
HISTORIC SITES SURVEY STRUCTURE FORM**



**SOUTH DAKOTA STATE HISTORIC PRESERVATION OFFICE
HISTORIC SITES SURVEY STRUCTURE FORM**



SKETCH MAP

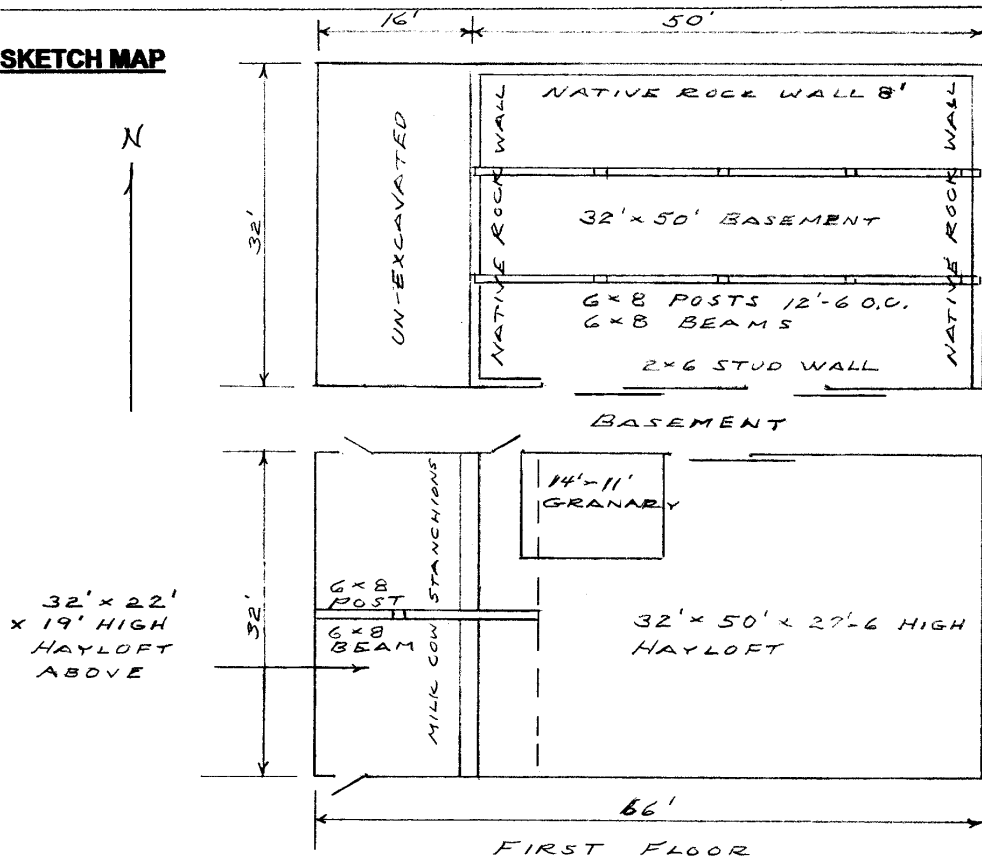

PHOTOGRAPHS

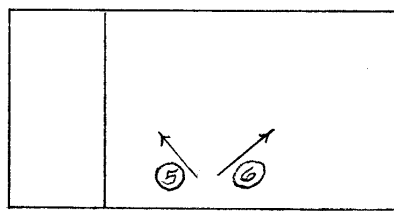

BASEMENT

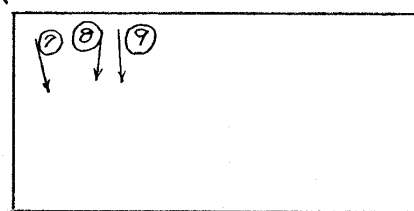

FIRST FLOOR

PHOTOGRAPHER: _____
DATE OF PHOTO: _____

ROLL NUMBER: _____
PHOTO NUMBER: _____
CAMERA DIRECTION: _____

* = REQUIRED FIELD

* = REQUIRED FIELD

**SOUTH DAKOTA STATE HISTORIC PRESERVATION OFFICE
HISTORIC SITES SURVEY STRUCTURE FORM**



SKETCH MAP

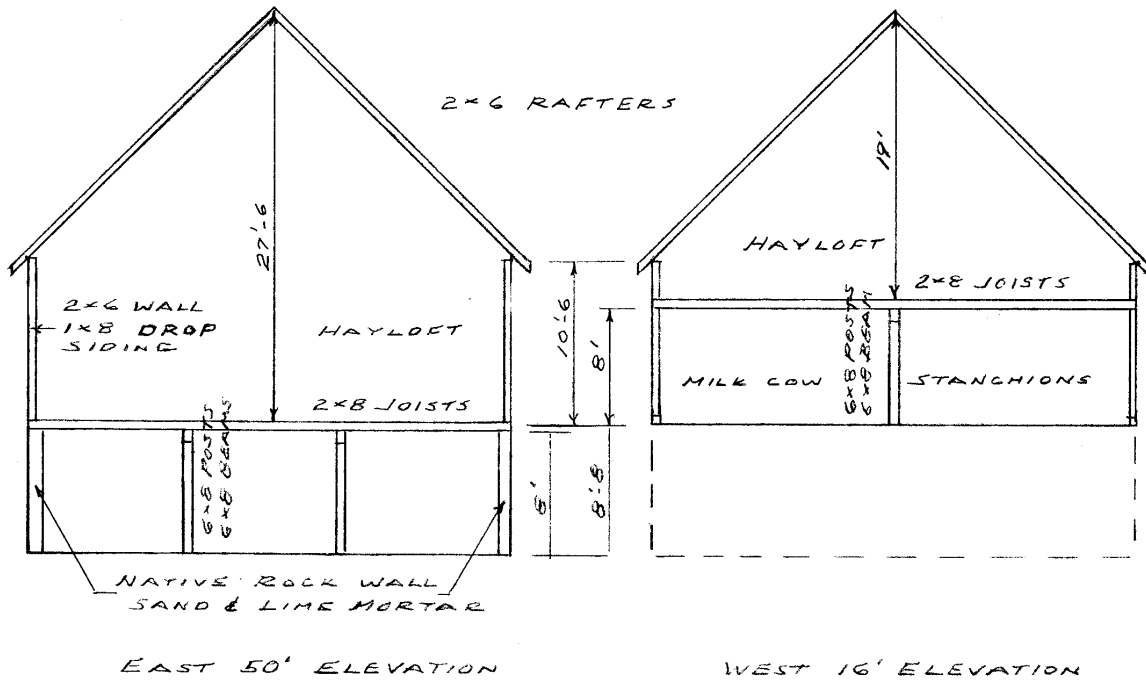

PHOTOGRAPHS



PHOTOGRAPHER: _____
DATE OF PHOTO: _____

ROLL NUMBER: _____
PHOTO NUMBER: _____
CAMERA DIRECTION: _____

* = REQUIRED FIELD

**SOUTH DAKOTA STATE HISTORIC PRESERVATION OFFICE
HISTORIC SITES SURVEY STRUCTURE FORM**



PHOTOGRAPHER: Jim Stone
DATE OF PHOTO: July 13, 2012

ROLL NUMBER: _____
PHOTO NUMBER: 1
CAMERA DIRECTION: Looking NE, SW corner



PHOTOGRAPHER: Jim Stone
DATE OF PHOTO: July 13, 2012

ROLL NUMBER: _____
PHOTO NUMBER: 2
CAMERA DIRECTION: Looking NW, SE corner

* = REQUIRED FIELD

**SOUTH DAKOTA STATE HISTORIC PRESERVATION OFFICE
HISTORIC SITES SURVEY STRUCTURE FORM**



PHOTOGRAPHER: Jim Stone
DATE OF PHOTO: July 13, 2012

ROLL NUMBER: _____
PHOTO NUMBER: 3
CAMERA DIRECTION: Looking SW, NE corner



PHOTOGRAPHER: Jim Stone
DATE OF PHOTO: July 13, 2012

ROLL NUMBER: _____
PHOTO NUMBER: 4
CAMERA DIRECTION: Looking SE, NW corner

* = REQUIRED FIELD

**SOUTH DAKOTA STATE HISTORIC PRESERVATION OFFICE
HISTORIC SITES SURVEY STRUCTURE FORM**



PHOTOGRAPHER: Jim Stone
DATE OF PHOTO: July 13, 2012

ROLL NUMBER: _____
PHOTO NUMBER: 5

CAMERA DIRECTION: Basement, looking NW,
native rock walls, sand
and lime mortar



PHOTOGRAPHER: Jim Stone
DATE OF PHOTO: July 13, 2012

ROLL NUMBER: _____
PHOTO NUMBER: 6

CAMERA DIRECTION: Basement, looking NE,
6x8 posts, 6x8 beams,
rock walls, note
crumbling

* = REQUIRED FIELD

**SOUTH DAKOTA STATE HISTORIC PRESERVATION OFFICE
HISTORIC SITES SURVEY STRUCTURE FORM**



PHOTOGRAPHER: Jim Stone
DATE OF PHOTO: July 13, 2012

ROLL NUMBER: _____
PHOTO NUMBER: 7

First floor, West 16',
looking SE, original milk
cow stanchions

CAMERA DIRECTION:



PHOTOGRAPHER: Jim Stone
DATE OF PHOTO: July 13, 2012

ROLL NUMBER: _____
PHOTO NUMBER: 8

First floor, looking
South, South, 14' x 11'
granary in hayloft

CAMERA DIRECTION:

* = REQUIRED FIELD

**SOUTH DAKOTA STATE HISTORIC PRESERVATION OFFICE
HISTORIC SITES SURVEY STRUCTURE FORM**



PHOTOGRAPHER: Jim Stone
DATE OF PHOTO: July 13, 2012

ROLL NUMBER: _____
PHOTO NUMBER: 9

CAMERA DIRECTION: First floor, looking South, South, solid stud wall dividing West 16' from the East hayloft over basement

HISTORY

This farm located in the NE ¼ of Section 27, Bethel Township, Clay County was homesteaded by Losten F. Orton.

The 1894, 1901, 1912 and 1912 Clay County Atlas lists Thorsten T. Orton as the owner.

The 1937 and 1948 Clay County Atlas lists Lena Orton as the owner.

The 1956 Clay County Atlas lists M. L. Henderson as the owner.

The Following Is From

Wakonda, S. D. Centennial Book 1885 - 9185

Laverne Orton was born July 18, 1916 to Mr. and Mrs. Daniel Orton. Spent my younger years on the farm, homesteaded by T. T. Orton around 1869. Had a sister, Ione and a brother John, who was killed in an auto accident in 1927.

I married Marjorie Issackson in 1938. Left South Dakota in 1942 to work in a war plant. After the war I went to work for a dairy as a driver, a job I worked at until 1982, when I retired. I have two daughters, six grand children and two great grand children. My first wife died in 1972. I have since remarried.

As to my family background; my mother was Guida Rice, one of eight children born to Mr. and Mrs. John Rice of Vermillion, S.D. Her father came from Norway, moved west and married my grandmother, Guereana Severson, of a pioneer family that crossed the Missouri River in the winter with an ox cart loaded with their belongings, about 1860. They lived in a dugout in the hills along Bluff Road. Many times having to leave, fleeing the Indians, going to a fort in Sioux City, Iowa. Most of the family died of diphtheria. Only the father, my grandmother and a sister Martha survived. My grandmother often told us, she was the first white child baptized in Dakota Territory. I am sending a picture of their first home, a log cabin, still standing along the Bluff Road.

My paternal grandfather, born Dec 11, 1844, in Aathum, Sand, Rogaland, Norway, came to the United States in 1864, in a sailing ship, a trip of many weeks. He went to Lisbon, Illinois, where he worked as a farm hand. A few years later he went to Roland, Iowa. From there he traveled to Dakota Territory. In 1870 he became a naturalized citizen, filed a claim on a homestead of 160 acres in Clay County, six miles southeast of Wakonda. In 1873 he returned to Iowa to marry Daarthe Seselia Thompson, who had been born on Rogaland, Norway, coming to the United States at the age of 18. She and T. T. Orton were married Dec. 11, 1873. They raised a family of 13 children. They survived many hardships, prairie fires, drought and a plague of grasshoppers. Most of their food was raised on their farm. Wheat was hauled to Volin to be ground into flour. They spun wool and knitted warm clothing for the family.

**SOUTH DAKOTA STATE HISTORIC PRESERVATION OFFICE
HISTORIC SITES SURVEY STRUCTURE FORM**



(Rice farm) Log cabin along the Bluff Road

My grandfather Orton nearly lost his life in the blizzard of 1888. The horses would not face the wind. He had gone to the Missouri river timber to get a load of wood. He survived because he let the horses find their own way and because of the heavy clothing he wore.

My grandparents also helped to start and built the Lodi Lutheran Church. Until the church was built, services were held in various homes. All of the 13 children were baptized and confirmed there. In the 1920's the church was removed and the records were moved to the Pleasant Valley Lutheran Church.

My grandparents also helped get a grade school started. It was the Bluff Center School #45, one mile from their home. Grandfather served many years on the school board, township board and church boards.

My grandparents lived on the farm until 1917, when they moved to Volin. They lived there until 1927 and 1928 when they died at the ages of 73 and 84 after being married 54 years. They both are buried at the Union Cemetery. My great grandparents, Ole and Karen Thompson lived on the Orton farm. Both died in the 1890's and are buried in the Lodi Lutheran Cemetery.

Log cabin has dove tailed logs on the corners. It is listed on the National register. Owners are Jerry and Norma Wilson.

This barn was built before the 1890's, because of the sand and lime mortar on the native stonewalls for and foundation the basement. Portland cement was not available until after 1890.