

**SOUTH DAKOTA STATE HISTORIC PRESERVATION OFFICE  
HISTORIC SITES SURVEY STRUCTURE FORM**



**SITE INFORMATION**

\*SURVEY DATE: July 2, 2012

\*SURVEYOR: Jim Stone

\*ADDRESS: 45719 Jetly Park Street

\*COUNTY: Clay

\*CITY: Vermillion

LOCATION DESCRIPTION: From intersection of South Dakota Highway 50 bi-pass and South Dakota Highway 19, West about 5-3/4 miles to 459<sup>th</sup> Ave., turn left (South) about 200 feet and turn right (West), About 3/4 mile on the left (South) side.

LEGAL DESCRIPTION: SW 1/4, EXC E 1/2, E 1/2, SW 1/4 & W 1/2, NW 1/4, NW 1/4, NE 1/4, SW 1/4 & E 1/2, NE 1/4, NW 1/4, SW 1/4 & Sealy Tract 1, 36 – 93 – 53 Meckling Twp.

\*QUARTER 1: SW 1/4

\*QUARTER 2: \_\_\_\_\_

\*TOWNSHIP: Meckling

\*RANGE: 53

\*SECTION: 36

ACRES: 131.35

OWNER CODE 1: P

OWNER CODE 2: F S L P

OWNER CODE 3: F S L P

OWNER NAME: John F. & Agnes F. Sealy

OWNER ADDRESS: 45719 Jetly Park Street

OWNER CITY: Vermillion

OWNER STATE: South Dakota

OWNER ZIP: 57069

QUAD NAME: \_\_\_\_\_

**HISTORIC SIGNIFICANCE**

\*DOE: \_\_\_\_\_

\*DOE DATE: \_\_\_\_\_

REASON INELIGIBLE: \_\_\_\_\_

REGISTER NAME: \_\_\_\_\_

MULTIPLE PROPERTY NAME: \_\_\_\_\_

CATEGORY: \_\_\_\_\_

NOMINATION STATUS: \_\_\_\_\_

DATE LISTED: \_\_\_\_\_

REFERENCE NUMBER: \_\_\_\_\_

HISTORIC DISTRICT RATING: C or NC

PERIOD: \_\_\_\_\_

SIGNIFICANCE LEVEL 1: N S L

SIGNIFICANCE LEVEL 2: N S L

CRITERIA 1: A B C D

CRITERIA 2: A B C D

CRITERIA 3: A B C D

CRITERIA 4: A B C D

SIGNIFICANCE NOTES: Sophia Demann

# SOUTH DAKOTA STATE HISTORIC PRESERVATION OFFICE

## HISTORIC SITES SURVEY STRUCTURE FORM



### STRUCTURE DETAILS

SHPO ID: \_\_\_\_\_

\*PROPERTY NAME: \_\_\_\_\_

OTHER NAME: \_\_\_\_\_

CURRENT FUNCTION: <u>Farm machinery shop</u>	FOUNDATION: <u>Poured concrete</u>
CURRENT SUBFUNCTION: <u>Auto repair</u>	ROOF MATERIAL: <u>Asphalt over cedar shingles</u>
HISTORIC FUNCTION: <u>Livestock barn</u>	ROOF SHAPE: <u>Gambrel</u>
HISTORIC SUBFUNCTION: <u>Hay and grain storage</u>	STRUCTURAL SYSTEM: <u>Balloon framing</u>
	STYLE: <u>Gambrel roof barn</u>
OCCUPIED: <u>Yes</u>	TYPE: <u>Livestock barn</u>
	<u>2x6, 1x6 #106 drop</u>
ACCESSIBLE: <u>Yes with permission</u>	WALLS: <u>siding</u>

STORIES: <u>2</u>	SIGNIFICANT PERSON: <u>Sophia Demann</u>
*DATE OF CONSTRUCTION: <u>1915 to 1917</u>	CULTURAL AFFILIATION: <u>German</u>

ALTERED/MOVED NOTES: Original site. Hayloft floor raised to 14'. All stanchions, horse stalls and granary have been removed. Walls and Ceiling have been insulated and lined. 16'x12' overhead door installed in the North wall. 32' x 32' addition added to the South side with a gable roof. South wall of original barn partially removed to make a 32' x 64' shop. 18' x 32' lean-to added to the East side.

INTERIOR NOTES: Had 6x6 posts and 6x6 beams to support hayloft floor. Joists were 2x10. The 6x6 posts and 6x6 beams were rough sawn.

OTHER NOTES: Windows were 8"x10" four light. 2x6 stud walls with 1x6 #106 drop siding. Rafters and Bracing are 2x6. Rafter bracing left intact when floor joists were raised to 14'. Shop is heated with a large wood burning stove. West addition is used as shop also.

\*PHYSICAL NOTES: Barn is in very good condition.

\_\_\_\_\_

\_\_\_\_\_

\_\_\_\_\_

\_\_\_\_\_

\_\_\_\_\_

**SOUTH DAKOTA STATE HISTORIC PRESERVATION OFFICE**  
**HISTORIC SITES SURVEY STRUCTURE FORM**

**SKETCH MAP**

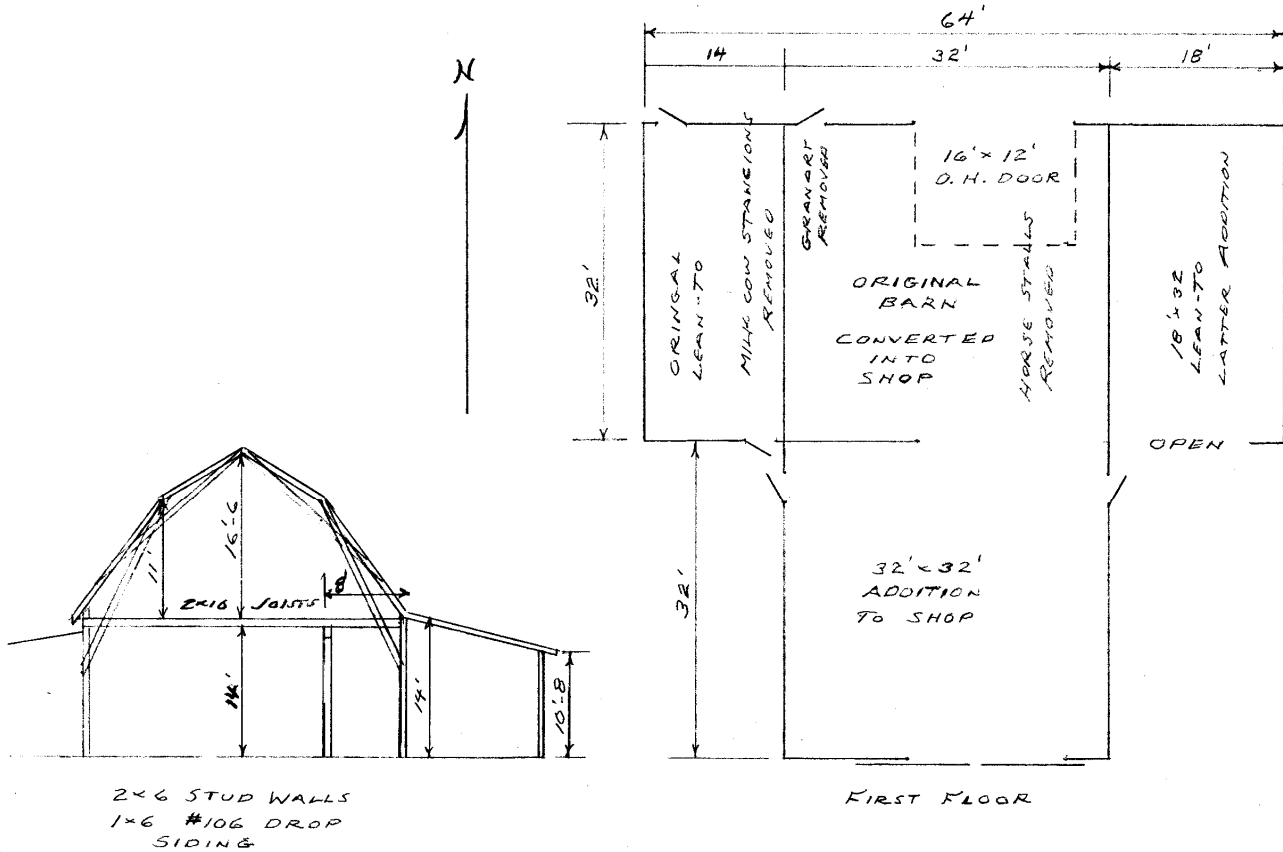

**PHOTOGR**

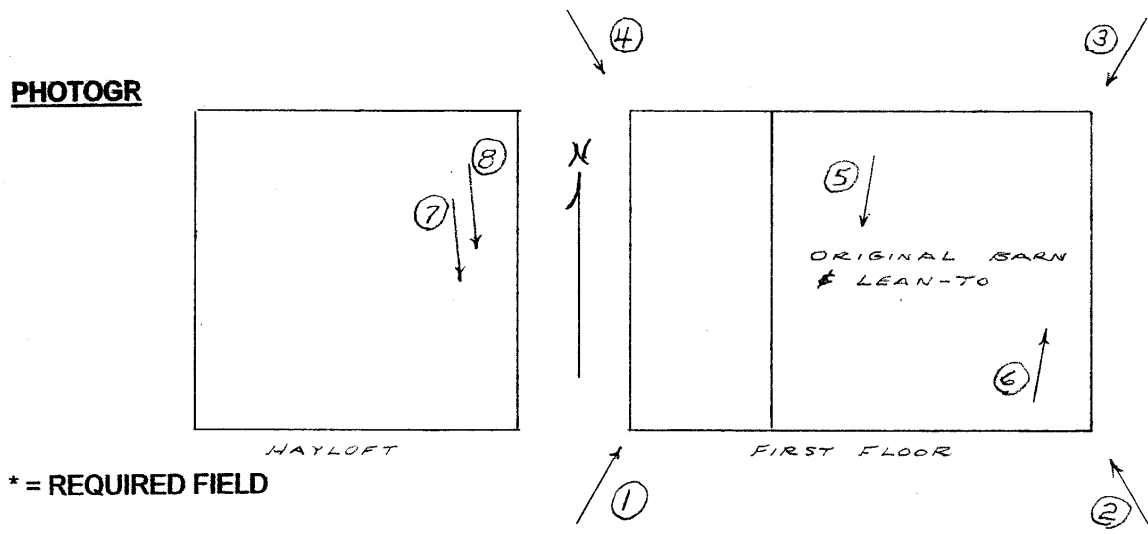

**SOUTH DAKOTA STATE HISTORIC PRESERVATION OFFICE  
HISTORIC SITES SURVEY STRUCTURE FORM**



PHOTOGRAPHER: Jim Stone  
DATE OF PHOTO: July 2, 2012

ROLL NUMBER: \_\_\_\_\_  
PHOTO NUMBER: 1  
CAMERA DIRECTION: Looking NE, SW corner



PHOTOGRAPHER: Jim Stone  
DATE OF PHOTO: July 2, 2012

ROLL NUMBER: \_\_\_\_\_  
PHOTO NUMBER: 2  
CAMERA DIRECTION: Looking NW, SE corner,  
32'x32' addition on the  
South

**SOUTH DAKOTA STATE HISTORIC PRESERVATION OFFICE  
HISTORIC SITES SURVEY STRUCTURE FORM**



PHOTOGRAPHER: Jim Stone  
DATE OF PHOTO: July 2, 2012

ROLL NUMBER: \_\_\_\_\_  
PHOTO NUMBER: 3  
CAMERA DIRECTION: Looking SW, NE corner



PHOTOGRAPHER: Jim Stone  
DATE OF PHOTO: July 2, 2012

ROLL NUMBER: \_\_\_\_\_  
PHOTO NUMBER: 4  
CAMERA DIRECTION: Looking SE, NW corner

**SOUTH DAKOTA STATE HISTORIC PRESERVATION OFFICE  
HISTORIC SITES SURVEY STRUCTURE FORM**



PHOTOGRAPHER: Jim Stone  
DATE OF PHOTO: July 2, 2012

ROLL NUMBER: \_\_\_\_\_  
PHOTO NUMBER: 5

First floor, looking  
South, original 6x6 beam  
with 6x6 beam used as a  
post

CAMERA DIRECTION: \_\_\_\_\_



PHOTOGRAPHER: Jim Stone  
DATE OF PHOTO: July 2, 2012

ROLL NUMBER: \_\_\_\_\_  
PHOTO NUMBER: 6

CAMERA DIRECTION: First floor, looking North,  
original rafter bracing.

**SOUTH DAKOTA STATE HISTORIC PRESERVATION OFFICE  
HISTORIC SITES SURVEY STRUCTURE FORM**



PHOTOGRAPHER: Jim Stone  
DATE OF PHOTO: July 2, 2012

ROLL NUMBER: \_\_\_\_\_  
PHOTO NUMBER: 7

CAMERA DIRECTION: Hayloft, looking South,  
lower rafter bracing



PHOTOGRAPHER: Jim Stone  
DATE OF PHOTO: July 2, 2012

ROLL NUMBER: \_\_\_\_\_  
PHOTO NUMBER: 8

CAMERA DIRECTION: Hayloft, looking South,  
upper/ hip rafter bracing

SOUTH DAKOTA STATE HISTORIC PRESERVATION OFFICE  
HISTORIC SITES SURVEY STRUCTURE FORM



**MECKLING TWP**  
RESIDENT

T 93 N

R 53 W

JOINS BETHEL TWP

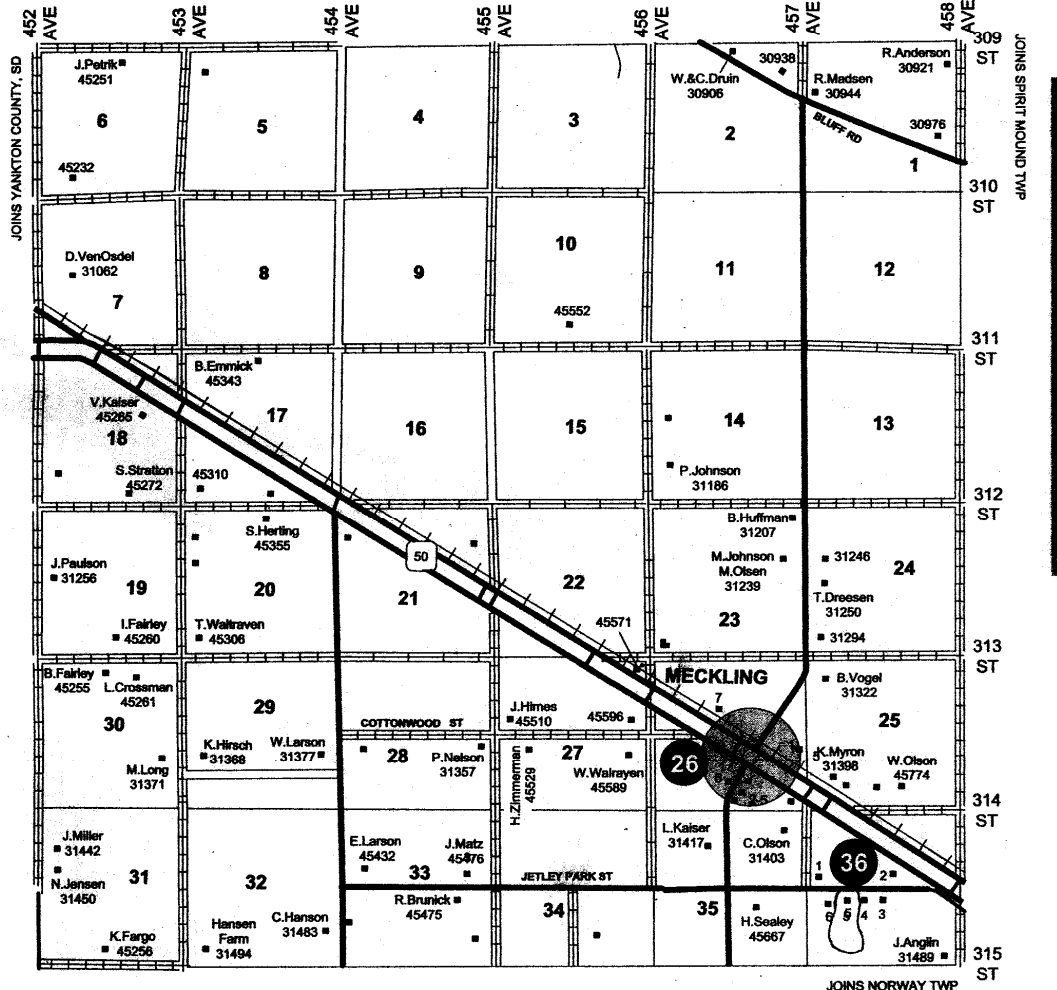

- Section 1 ●
1. J. Tichy - 45698
  2. K. Orr - 31375
  3. R. Ebsen - 31379
  4. J. Sealey - 31383
  5. J. Althaus - 31389
  6. A. Plutonum - 31376
  7. A. Johnson - 45746
- Section 2 ●
1. M. Larson - 45702
  2. L. Delaney - 45776
  3. P. Berglund - 45789
  4. M. Slattery - 45725
  5. J. Sealey - 45719
  6. M. Rucks - 45711

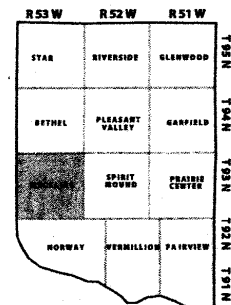

COUNTY-WIDE DIRECTORY, LLC®

VISIT US ONLINE AT: [www.countywidedirectories.com](http://www.countywidedirectories.com)

31

\* = REQUIRED FIELD

## **HISTORY**

This farm located in the SE ¼ of Section 35, Meckling Township, Clay County was homesteaded by Fredrick Branson.

The 1894 and 1901 Clay County Atlas lists Albert M. Edgerton as the owner.

The 1912 and 1924 Clay County Atlas lists Fred L. Demann as the owner.

The 1937 Clay County Atlas lists Albert M. Edgerton as the owner.

The 1948 and 1956 Clay County Atlas lists Caroline Sealey as the owner.

Sophia Demann purchased the Bergland farm SE ¼ of Section 36 in Meckling Township in 1909 and the SW ¼ of Section 36 in Meckling Township in 1915. The SW ¼ in Section 36 is now the John Sealy place.

Fred and Sophia Demann had two children Caroline and Delores. Caroline married Fred Sealy. John Sealy is the son of Caroline and Fred.

Delores married Carl Berland Sr. Their children are Madalenn, Carl Jr (Dutches) and Melvin.

**SOUTH DAKOTA STATE HISTORIC PRESERVATION OFFICE  
HISTORIC SITES SURVEY STRUCTURE FORM**

