

**SOUTH DAKOTA STATE HISTORIC PRESERVATION OFFICE
HISTORIC SITES SURVEY STRUCTURE FORM**



SITE INFORMATION

*SURVEY DATE: April 15, 2013 *ADDRESS: 46891 299th Street
*SURVEYOR: Jim Stone *COUNTY: Clay
*CITY: Beresford

LOCATION DESCRIPTION: From Vermillion, South Dakota Highway 50 East 2 miles to Greenfield Road North 19-1/2 miles to 299th Street, turn right (East) about 3/4 mile on the right (South) side.

LEGAL DESCRIPTION: E 1/2, NE 1/4, 14 - 95 - 51 Glenwood Twp.

*QUARTER 1: NE 1/4 OWNER NAME: Ron Nielsen
*QUARTER 2: _____ OWNER ADDRESS: 46891 299th Street
*TOWNSHIP: Glenwood OWNER CITY: Beresford
*RANGE: 51 OWNER STATE: South Dakota
*SECTION: 14 OWNER ZIP: 57004
ACRES: 80.22 QUAD NAME: _____
OWNER CODE 1: P
OWNER CODE 2:
OWNER CODE 3:

HISTORIC SIGNIFICANCE

*DOE: _____ REGISTER NAME: _____
*DOE DATE: _____ MULTIPLE PROPERTY NAME: _____
REASON INELIGIBLE: _____

NOMINATION STATUS: _____ CATEGORY: _____
DATE LISTED: _____ SIGNIFICANCE LEVEL 1: N S L
REFERENCE NUMBER: _____ SIGNIFICANCE LEVEL 2: N S L
HISTORIC DISTRICT RATING: C or NC CRITERIA 1: A B C D
PERIOD: _____ CRITERIA 2: A B C D
CRITERIA 3: A B C D
CRITERIA 4: A B C D

SIGNIFICANCE NOTES: _____

STRUCTURE DETAILS

* = REQUIRED FIELD

**SOUTH DAKOTA STATE HISTORIC PRESERVATION OFFICE
HISTORIC SITES SURVEY STRUCTURE FORM**



SHPO ID: _____
 *PROPERTY NAME: _____
 OTHER NAME: _____

CURRENT FUNCTION: Storage FOUNDATION: Poured concrete
Asphalt shingles
over cedar
shingles
 CURRENT SUBFUNCTION: Straw storage ROOF MATERIAL: _____
 HISTORIC FUNCTION: Livestock barn ROOF SHAPE: Gambrel
 HISTORIC SUBFUNCTION: Hay storage STRUCTURAL SYSTEM: Balloon framing
 OCCUPIED: Yes STYLE: Gambrel roof barn
 TYPE: Livestock barn
2x6 studs, 1x8
sheathing and
1/2"x6" cedar lap
siding
 ACCESSIBLE: Yes with
permission WALLS: _____

STORIES: 2 SIGNIFICANT PERSON: Rosie D. (Johnson)
Nelson
 *DATE OF CONSTRUCTION: 1920's CULTURAL AFFILIATION: ?

ALTERED/MOVED NOTES: Original site. Roof has been covered with asphalt shingles. East wall covered with horizontal steel roofing.

INTERIOR NOTES: The original barn had two rows of (3) 2x6 posts and (3) 2x8's for a beam and one row of 4x6 posts with (3) 2x8's for a beam. Floor joists are 2x8's for the hayloft floor. (9) milk cow stanchions are still in place on the East side. (4) double horse stalls are still on the West side. The mangers are removed in (2) stalls. (2) pens in the NE corner appear to have been added or replaced.

Room in the NW corner may have been a granary and remodeled into a milk room.

OTHER NOTES: 2x6 stud walls with 1x8 sheathing and 1/2"x6" cedar lap siding with steel roofing on the East wall. Rafters are 2x6's with 2x6 bracing 24" O. C. at the hip and from the center of lower rafters down to the floor. Interesting note on the rafter bracing, 6' O. C., a 1x6 brace was substituted for the 2x6 Brace. A 1x8 brace from hip out to hip bracing and a 2x6brace on 2x6 bracing or 1x6 brace on 1x6 bracing from the bottom of the lower rafters out to the lower brace. Windows are 4"x24" four light. Two metal cupola's still in place.

*PHYSICAL NOTES: Barn is in fair condition. Needs some maintenance.

*UTM ZONE: _____

*RESTRICTED: Y or N

*UTM EASTING: _____

*UTM NORTHING: _____

**SOUTH DAKOTA STATE HISTORIC PRESERVATION OFFICE
HISTORIC SITES SURVEY STRUCTURE FORM**



SKETCH MAP

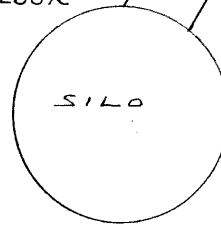
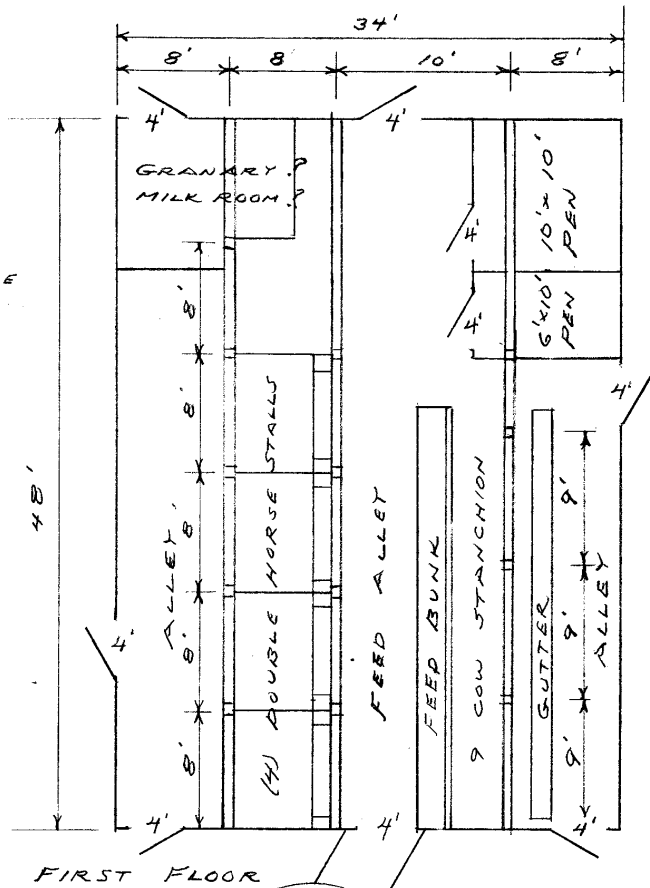
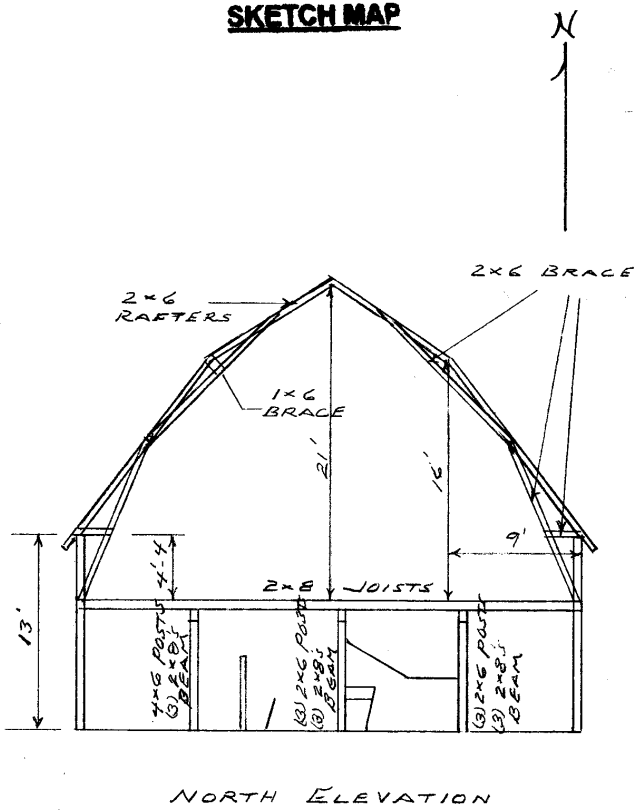

PHOTOGR

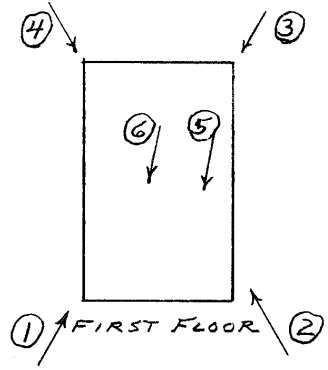
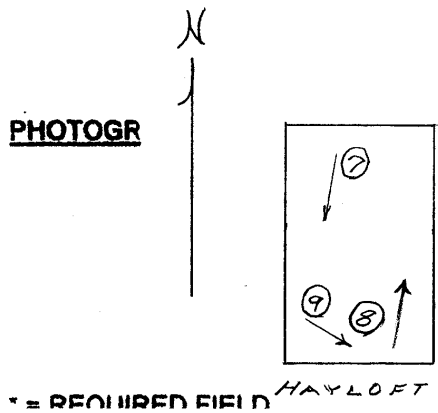

* = REQUIRED FIELD

**SOUTH DAKOTA STATE HISTORIC PRESERVATION OFFICE
HISTORIC SITES SURVEY STRUCTURE FORM**



PHOTOGRAPHER: Jim Stone
DATE OF PHOTO: April 15, 2013

ROLL NUMBER: _____
PHOTO NUMBER: 1
CAMERA DIRECTION: Looking NE, SW corner



PHOTOGRAPHER: Jim Stone
DATE OF PHOTO: April 15, 2013

ROLL NUMBER: _____
PHOTO NUMBER: 2
CAMERA DIRECTION: Looking NW, SE corner

* = REQUIRED FIELD

**SOUTH DAKOTA STATE HISTORIC PRESERVATION OFFICE
HISTORIC SITES SURVEY STRUCTURE FORM**



PHOTOGRAPHER: Jim Stone
DATE OF PHOTO: April 15, 2013

ROLL NUMBER: _____
PHOTO NUMBER: 3
CAMERA DIRECTION: Looking SW, NE corner



PHOTOGRAPHER: Jim Stone
DATE OF PHOTO: April 15, 2013

ROLL NUMBER: _____
PHOTO NUMBER: 4
CAMERA DIRECTION: Looking SE, NW corner

* = REQUIRED FIELD

**SOUTH DAKOTA STATE HISTORIC PRESERVATION OFFICE
HISTORIC SITES SURVEY STRUCTURE FORM**



PHOTOGRAPHER: Jim Stone
DATE OF PHOTO: April 15, 2013

ROLL NUMBER: _____
PHOTO NUMBER: 5

**First floor, looking SW
on East side, (9) milk
cow stanchions still in
place.**

CAMERA DIRECTION: _____



PHOTOGRAPHER: Jim Stone
DATE OF PHOTO: April 15, 2013

ROLL NUMBER: _____
PHOTO NUMBER: 6

**First floor, looking SW
from in the center feed
alley, (4) double horse
stalls on the West side.**

CAMERA DIRECTION: _____

* = REQUIRED FIELD

**SOUTH DAKOTA STATE HISTORIC PRESERVATION OFFICE
HISTORIC SITES SURVEY STRUCTURE FORM**



PHOTOGRAPHER: Jim Stone
DATE OF PHOTO: April 15, 2013

ROLL NUMBER: _____
PHOTO NUMBER: 7

Hayloft, looking SW,
lower rafter bracing, note
1x6 bracing 6' O. C.

CAMERA DIRECTION: _____

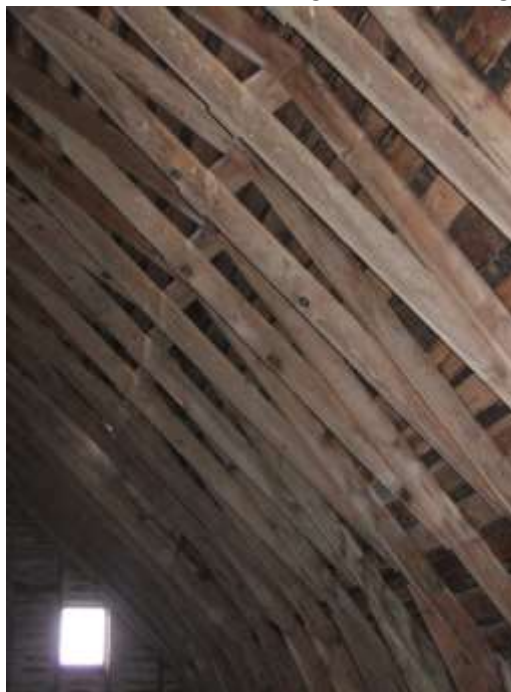

PHOTOGRAPHER: Jim Stone
DATE OF PHOTO: April 15, 2013

ROLL NUMBER: _____
PHOTO NUMBER: 8

Hayloft, looking NE,
upper rafter bracing,
note 1x6 bracing 6' O. C.

CAMERA DIRECTION: _____

* = REQUIRED FIELD

**SOUTH DAKOTA STATE HISTORIC PRESERVATION OFFICE
HISTORIC SITES SURVEY STRUCTURE FORM**



PHOTOGRAPHER: Jim Stone
DATE OF PHOTO: April 15, 2013

ROLL NUMBER: _____
PHOTO NUMBER: 9

CAMERA DIRECTION: Hayloft, looking up and SE, wooden roller for the hay track rope, this is the first one I have seen, usually this is a wooden block pulley.

**SOUTH DAKOTA STATE HISTORIC PRESERVATION OFFICE
HISTORIC SITES SURVEY STRUCTURE FORM**



T-95-N GLENWOOD DIRECTORY R-51-W

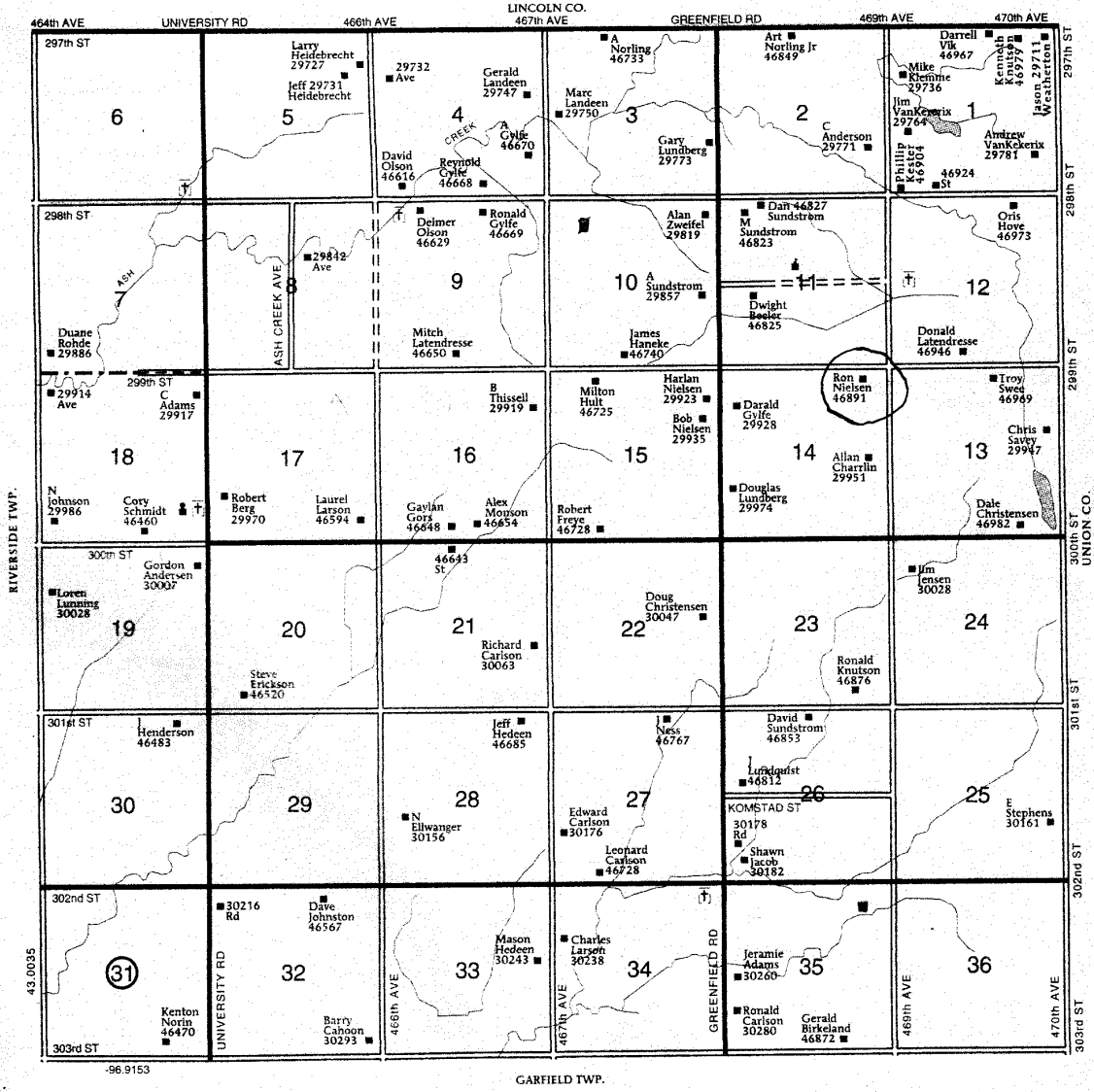

* = REQUIRED FIELD

HISTORY

This farm located in the NE ¼ of Section 14, Glenwood Township, Clay County was homesteaded by Gustaf Dunder.

The 1894 Clay County Atlas lists Frank Johnson as the owner.

The 1901 Clay County Atlas lists Elmer Johnson as the owner.

The 1912 Clay County Atlas lists Jens Johnson as the owner.

The 1924, 1937, 1948 and 1956 lists Rosie D. (Johnson) Nelson as the owner.