

**SOUTH DAKOTA STATE HISTORIC PRESERVATION OFFICE
HISTORIC SITES SURVEY STRUCTURE FORM**



SITE INFORMATION

*SURVEY DATE: July 20, 2012 *ADDRESS: 30624 470th Ave.
*SURVEYOR: Jim Stone *COUNTY: Union
*CITY: Beresford

LOCATION DESCRIPTION: South Dakota Highway 50 East of Vermillion 2 miles to Greenfield Road, turn left (North) 12-1/2 miles to 306th Street, turn right (East) 5 miles to 470th Ave., turn right (South) about 1/4 mile on the left (East) side.

LEGAL DESCRIPTION: NW 1/4 19 - 94 - 50 Emmet Twp.

*QUARTER 1: NW 1/4
*QUARTER 2: _____
*TOWNSHIP: Emmet
*RANGE: 50
*SECTION: 19
ACRES: 148.34

OWNER NAME: Ronald Larson
OWNER ADDRESS: 30535 470th Ave.
OWNER CITY: Beresford
OWNER STATE: South Dakota
OWNER ZIP: 57004
QUAD NAME: _____

OWNER CODE 1: P
OWNER CODE 2: F S L P
OWNER CODE 3: F S L P

HISTORIC SIGNIFICANCE

*DOE: _____
*DOE DATE: _____
REASON INELIGIBLE: _____

REGISTER NAME: _____
MULTIPLE PROPERTY NAME: _____

NOMINATION STATUS: _____
DATE LISTED: _____
REFERENCE NUMBER: _____
HISTORIC DISTRICT RATING: C or NC
PERIOD: _____

CATEGORY: _____
SIGNIFICANCE LEVEL 1: N S L
SIGNIFICANCE LEVEL 2: N S L

CRITERIA 1: A B C D
CRITERIA 2: A B C D
CRITERIA 3: A B C D
CRITERIA 4: A B C D

SIGNIFICANCE NOTES: _____

STRUCTURE DETAILS

* = REQUIRED FIELD

**SOUTH DAKOTA STATE HISTORIC PRESERVATION OFFICE
HISTORIC SITES SURVEY STRUCTURE FORM**



SHPO ID: _____

*PROPERTY NAME: _____

OTHER NAME: _____

CURRENT FUNCTION: Livestock barn

FOUNDATION: Poured concrete

CURRENT SUBFUNCTION: Storage

ROOF MATERIAL: Steel over cedar shingles

HISTORIC FUNCTION: Draft horse barn

ROOF SHAPE: Gothic Round

HISTORIC SUBFUNCTION: Hay and grain storage

STRUCTURAL SYSTEM: Balloon framing
Gothic round roof

STYLE: barn

OCCUPIED: Yes

TYPE: Draft horse barn

ACCESSIBLE: Yes with permission

WALLS: 2x6, 1x10 shiplap sheathing, 1/2"x6" cedar lap siding

STORIES: 2

SIGNIFICANT PERSON: Robert & Mary Larson

*DATE OF CONSTRUCTION: 1920

CULTURAL AFFILIATION: Swedish

ALTERED/MOVED NOTES: Original site. Roof covered with steel roofing.

INTERIOR NOTES: Has two rows 6x6 posts and (3) 2x8's beam to support hayloft floor. Floor joists are 2x8's. Horse stalls and harness room are still in place.

OTHER NOTES: Windows were 8"x10" four light. Walls are 2x6 with 1x10 shiplap sheathing and 1/2"x6" cedar lap siding. Rafters are site built from short 2x6's with 1x6's on each side, joints staggered. 10'x10' granary in SE corner of hayloft, divided into a 4'x10' and a 6'x 10' bins.

*PHYSICAL NOTES: Barn is in very good condition.

*UTM ZONE: _____

*RESTRICTED: Y or N

*UTM EASTING: _____

*UTM NORTHING: _____

**SOUTH DAKOTA STATE HISTORIC PRESERVATION OFFICE
HISTORIC SITES SURVEY STRUCTURE FORM**



SKETCH MAP

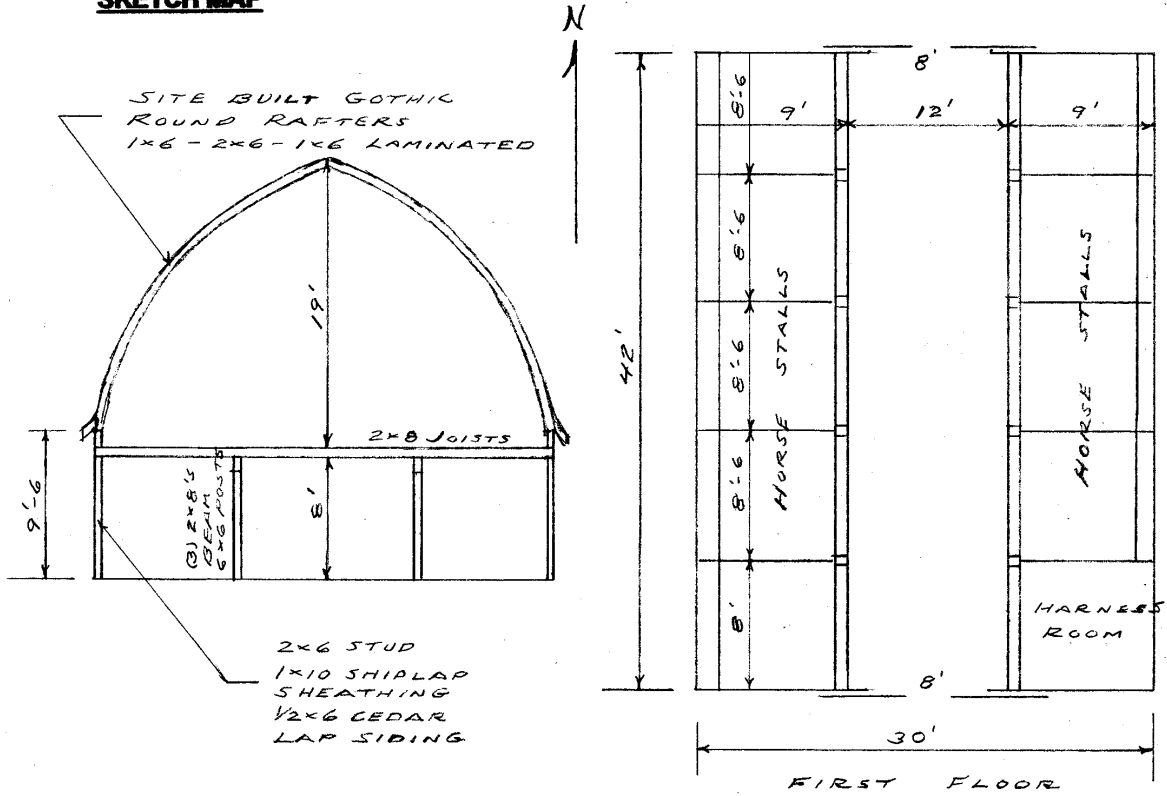

PHOTOGRAPHS

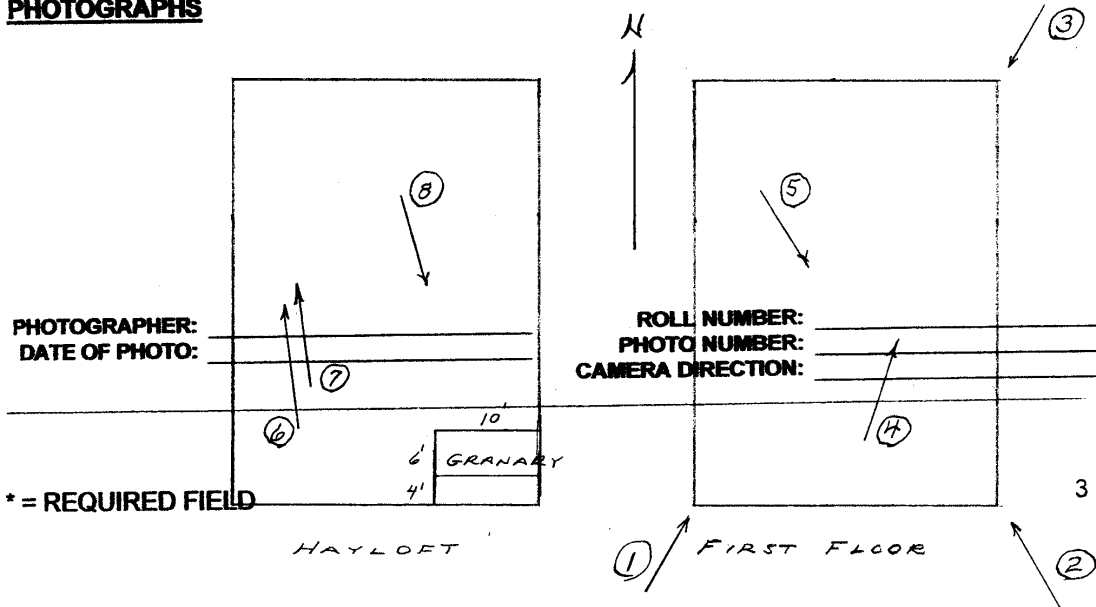

* = REQUIRED FIELD

* = REQUIRED FIELD

**SOUTH DAKOTA STATE HISTORIC PRESERVATION OFFICE
HISTORIC SITES SURVEY STRUCTURE FORM**



PHOTOGRAPHER: Jim Stone
DATE OF PHOTO: July 20, 2012

ROLL NUMBER: _____
PHOTO NUMBER: 1
CAMERA DIRECTION: Looking NE, SW corner



PHOTOGRAPHER: Jim Stone
DATE OF PHOTO: July 20, 2012

ROLL NUMBER: _____
PHOTO NUMBER: 2
CAMERA DIRECTION: Looking NW, SE corner

* = REQUIRED FIELD

**SOUTH DAKOTA STATE HISTORIC PRESERVATION OFFICE
HISTORIC SITES SURVEY STRUCTURE FORM**



PHOTOGRAPHER: Jim Stone
DATE OF PHOTO: July 20, 2012

ROLL NUMBER: _____
PHOTO NUMBER: 3
CAMERA DIRECTION: Looking SW, NE corner



PHOTOGRAPHER: Jim Stone
DATE OF PHOTO: July 20, 2012

ROLL NUMBER: _____
PHOTO NUMBER: 4
CAMERA DIRECTION: First floor, looking NE, post, beam and horse stalls

* = REQUIRED FIELD

**SOUTH DAKOTA STATE HISTORIC PRESERVATION OFFICE
HISTORIC SITES SURVEY STRUCTURE FORM**



PHOTOGRAPHER: Jim Stone
DATE OF PHOTO: July 20, 2012

ROLL NUMBER: _____
PHOTO NUMBER: 5
CAMERA DIRECTION: First floor, looking East, harness room

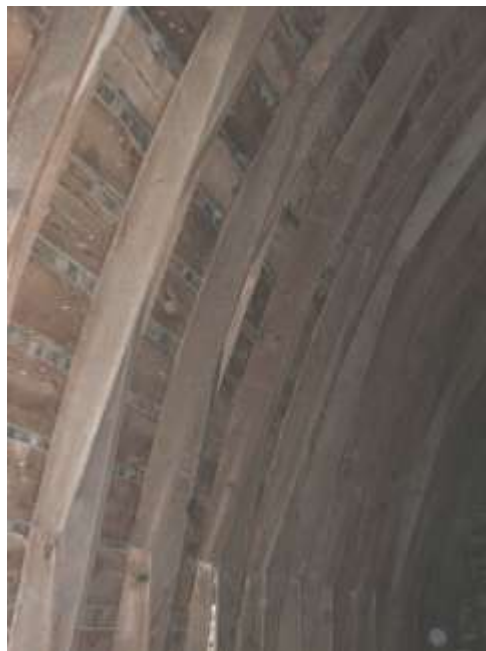

PHOTOGRAPHER: Jim Stone
DATE OF PHOTO: July 20, 2012

ROLL NUMBER: _____
PHOTO NUMBER: 6
CAMERA DIRECTION: Hayloft, looking North, site built gothic round rafters, laminated 1x6-2x6-1x6

* = REQUIRED FIELD

**SOUTH DAKOTA STATE HISTORIC PRESERVATION OFFICE
HISTORIC SITES SURVEY STRUCTURE FORM**



PHOTOGRAPHER: Jim Stone
DATE OF PHOTO: July 20, 2012

ROLL NUMBER: _____
PHOTO NUMBER: 7

CAMERA DIRECTION: Hayloft, looking North, rafters, North gable end and diagonal bracing



PHOTOGRAPHER: Jim Stone
DATE OF PHOTO: July 20, 2012

ROLL NUMBER: _____
PHOTO NUMBER: 8

CAMERA DIRECTION: Hayloft, looking SE, granary in hayloft

* = REQUIRED FIELD

EMMET TWP

T 94 N

RESIDENT

R 50 W

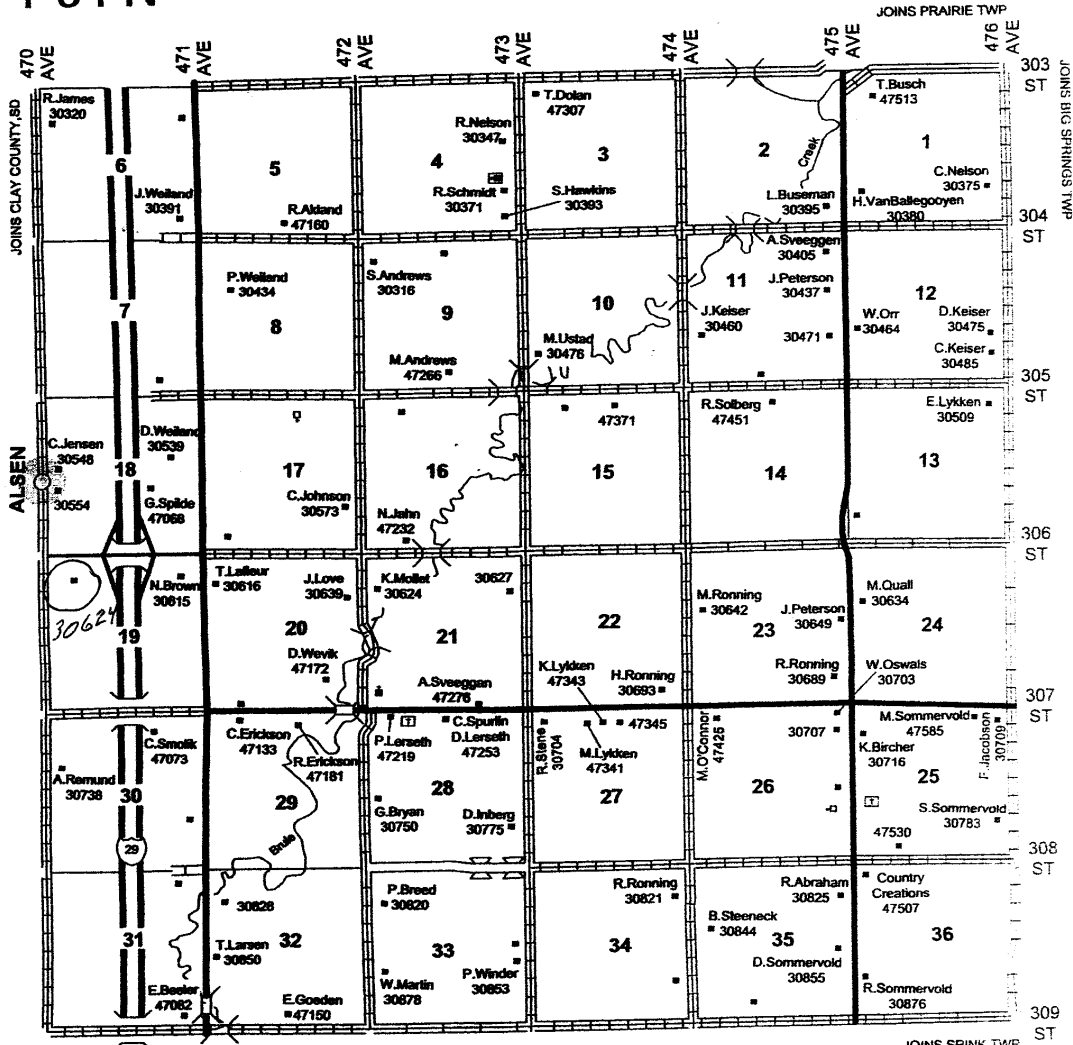

LAND OWNER & RURAL RESIDENT MAPS

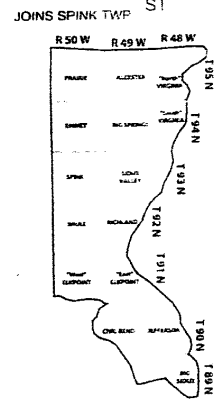

* = REQUIRED FIELD

HISTORY

The Following Information Was Furnished by
Ronald Larson

Peter Larson homesteaded on this farm in 1876. He would have built the first barn South of where it is today. He moved it about 300' North up on top of the hill. There appears to have been some urgency to get the barn moved and remodeled.

Peter Larson's son Robert built the second barn in 1920 for a draft horse barn.

Robert Larson's son Wesley Larson farmed the land.

Wesley Larson's son Ronald Larson now owns and farms the land.

Ronald Larson's son now lives on the farm and helps his father farm.

This is the fifth generation of Larson's to live here and farm the land for the last 136 years.

**SOUTH DAKOTA STATE HISTORIC PRESERVATION OFFICE
HISTORIC SITES SURVEY STRUCTURE FORM**

