

**SOUTH DAKOTA STATE HISTORIC PRESERVATION OFFICE**  
**HISTORIC SITES SURVEY STRUCTURE FORM**



**SITE INFORMATION**

\*SURVEY DATE: July 27, 2013  
\*SURVEYOR: Jim Stone

\*ADDRESS: 45850 306<sup>th</sup> Street  
\*COUNTY: Clay  
\*CITY: Wakonda

LOCATION DESCRIPTION: From Vermillion, intersection of South Dakota Highway 50 bi-pass and South Dakota Highway 19, North about 11 miles to 306<sup>th</sup> Street, turn left (West) about 3-1/2 miles, on the right, (North) side.

LEGAL DESCRIPTION: W 350' of S 840' Exc H-1 & H-2 in SW 1/4, 18 - 94 - 52 Pleasant Valley Twp

\*QUARTER 1: SW 1/4  
\*QUARTER 2: \_\_\_\_\_  
\*TOWNSHIP: Pleasant Valley  
\*RANGE: 52  
\*SECTION: 18  
ACRES: 6.71

OWNER NAME: Nickolas Schwebach  
OWNER ADDRESS: 45850 306<sup>th</sup> Street  
OWNER CITY: Wakonda  
OWNER STATE: South Dakota  
OWNER ZIP: 57073  
QUAD NAME: \_\_\_\_\_

OWNER CODE 1: P  
OWNER CODE 2: \_\_\_\_\_  
OWNER CODE 3: \_\_\_\_\_

**HISTORIC SIGNIFICANCE**

\*DOE: \_\_\_\_\_  
\*DOE DATE: \_\_\_\_\_  
REASON INELIGIBLE: \_\_\_\_\_

REGISTER NAME: \_\_\_\_\_  
MULTIPLE PROPERTY NAME: \_\_\_\_\_

NOMINATION STATUS: \_\_\_\_\_  
DATE LISTED: \_\_\_\_\_  
REFERENCE NUMBER: \_\_\_\_\_  
HISTORIC DISTRICT RATING: C or NC  
PERIOD: \_\_\_\_\_

CATEGORY: \_\_\_\_\_  
SIGNIFICANCE LEVEL 1: N S L  
SIGNIFICANCE LEVEL 2: N S L  
CRITERIA 1: A B C D  
CRITERIA 2: A B C D  
CRITERIA 3: A B C D  
CRITERIA 4: A B C D

SIGNIFICANCE NOTES: \_\_\_\_\_

**STRUCTURE DETAILS**

\* = REQUIRED FIELD

**SOUTH DAKOTA STATE HISTORIC PRESERVATION OFFICE**  
**HISTORIC SITES SURVEY STRUCTURE FORM**



SHPO ID: \_\_\_\_\_

\*PROPERTY NAME: \_\_\_\_\_

OTHER NAME: \_\_\_\_\_

CURRENT FUNCTION: Vacant

FOUNDATION: Native Rock and poured concrete

CURRENT SUBFUNCTION: Lumber storage

ROOF MATERIAL: Steel roofing over cedar shingles

HISTORIC FUNCTION: Livestock barn

ROOF SHAPE: Gable roof

HISTORIC SUBFUNCTION: Hay storage

STRUCTURAL SYSTEM: Balloon framing

STYLE: Gable roof barn

OCCUPIED: No

TYPE: Livestock barn

ACCESSIBLE: Yes with permission

WALLS: 2x4 studs, 1x8 #106 drop siding and assorted steel roofing.

STORIES: 2

SIGNIFICANT PERSON: Edward Mart

\*DATE OF CONSTRUCTION: Late 1800's

CULTURAL AFFILIATION: ?

ALTERED/MOVED NOTES: Original site. Any evidence of horse stalls has been removed. Racks built for lumber storage. Roof has been covered with steel roofing. Covered addition out to silo on the South side added later. Some of the native rock foundation has been repaired with poured concrete.

INTERIOR NOTES: One row of 4x4 posts and 4x4 beam to support hayloft floor, partially removed. The hayloft floor joists were 2x6's. The East wall of center barn is open 2x4 studs with feed trough and milk cow stanchions still in place in the East lean-to. The East part of the center barn had milk cow stanchions, but are removed. The West wall of the center barn is 2x4 studs with sheathing up to hayloft floor.

OTHER NOTES: 2x4 stud walls, 1x8 #106 drop siding on all four walls. Rafters are 2x4's. Windows are 9" x12" four light. All of the 2x4 studs, 2x4 rafters and 2x6 floor joists are rough sawn cottonwood. Both lean-to's on the East and West sides appear to have been built at the same as the barn.

\*PHYSICAL NOTES: Barn is in poor condition.

\*UTM ZONE: \_\_\_\_\_

\*RESTRICTED: Y or N

\*UTM EASTING: \_\_\_\_\_

\*UTM NORTHING: \_\_\_\_\_

**SOUTH DAKOTA STATE HISTORIC PRESERVATION OFFICE**  
**HISTORIC SITES SURVEY STRUCTURE FORM**

**SKETCH MAP**

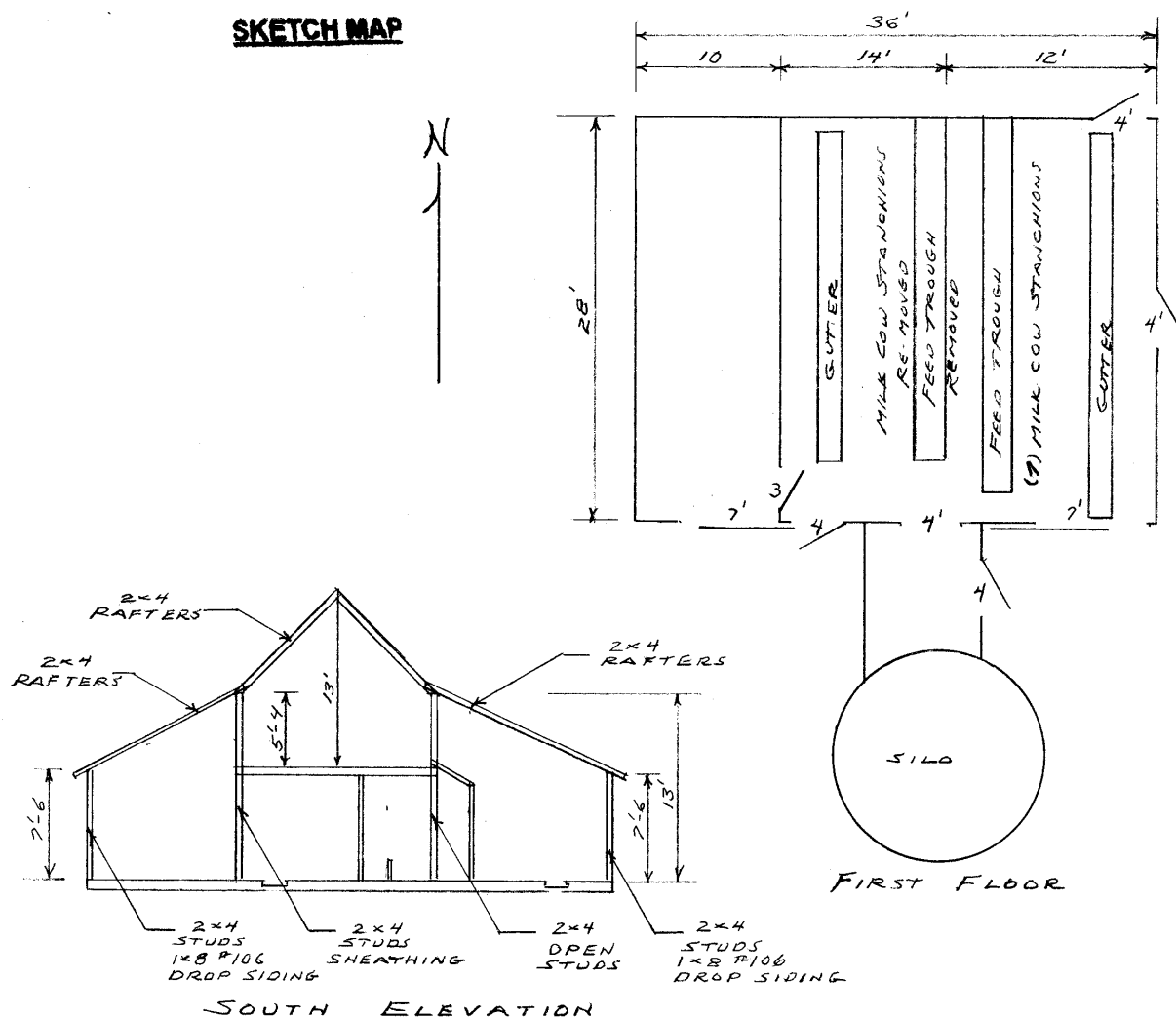

**PHOTOGR**

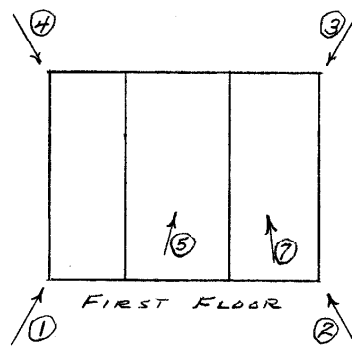
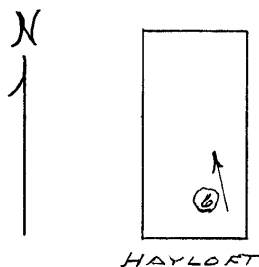

**SOUTH DAKOTA STATE HISTORIC PRESERVATION OFFICE  
HISTORIC SITES SURVEY STRUCTURE FORM**



PHOTOGRAPHER: Jim Stone  
DATE OF PHOTO: July 26, 2013

ROLL NUMBER: \_\_\_\_\_  
PHOTO NUMBER: 1  
CAMERA DIRECTION: Looking NE, SW corner



PHOTOGRAPHER: Jim Stone  
DATE OF PHOTO: July 26, 2013

ROLL NUMBER: \_\_\_\_\_  
PHOTO NUMBER: 2  
CAMERA DIRECTION: Looking NW, SE corner

\* = REQUIRED FIELD



**SOUTH DAKOTA STATE HISTORIC PRESERVATION OFFICE**  
**HISTORIC SITES SURVEY STRUCTURE FORM**



PHOTOGRAPHER: Jim Stone  
DATE OF PHOTO: July 26, 2013

ROLL NUMBER: \_\_\_\_\_  
PHOTO NUMBER: 3  
CAMERA DIRECTION: Looking SW, NE corner



PHOTOGRAPHER: Jim Stone  
DATE OF PHOTO: July 26, 2013

ROLL NUMBER: \_\_\_\_\_  
PHOTO NUMBER: 4  
CAMERA DIRECTION: Looking SE, NW corner

\* = REQUIRED FIELD

**SOUTH DAKOTA STATE HISTORIC PRESERVATION OFFICE  
HISTORIC SITES SURVEY STRUCTURE FORM**



PHOTOGRAPHER: Jim Stone  
DATE OF PHOTO: July 26, 2013

ROLL NUMBER: \_\_\_\_\_  
PHOTO NUMBER: 5

CAMERA DIRECTION: First floor, looking NE, in center barn, parts of 4x4 posts and 4x4 beam, racks for lumber storage



PHOTOGRAPHER: Jim Stone  
DATE OF PHOTO: July 26, 2013

ROLL NUMBER: \_\_\_\_\_  
PHOTO NUMBER: 6

CAMERA DIRECTION: Hayloft, looking NW, 2x4 rafters, open 2x4 stud walls in hayloft.



**SOUTH DAKOTA STATE HISTORIC PRESERVATION OFFICE  
HISTORIC SITES SURVEY STRUCTURE FORM**



**PHOTOGRAPHER:** Jim Stone  
**DATE OF PHOTO:** July 26, 2013

**ROLL NUMBER:** \_\_\_\_\_  
**PHOTO NUMBER:** 7

**CAMERA DIRECTION:** First floor, looking NW,  
(7) milk cow stanchions  
still in place in East lean-  
to.

# SOUTH DAKOTA STATE HISTORIC PRESERVATION OFFICE

## HISTORIC SITES SURVEY STRUCTURE FORM

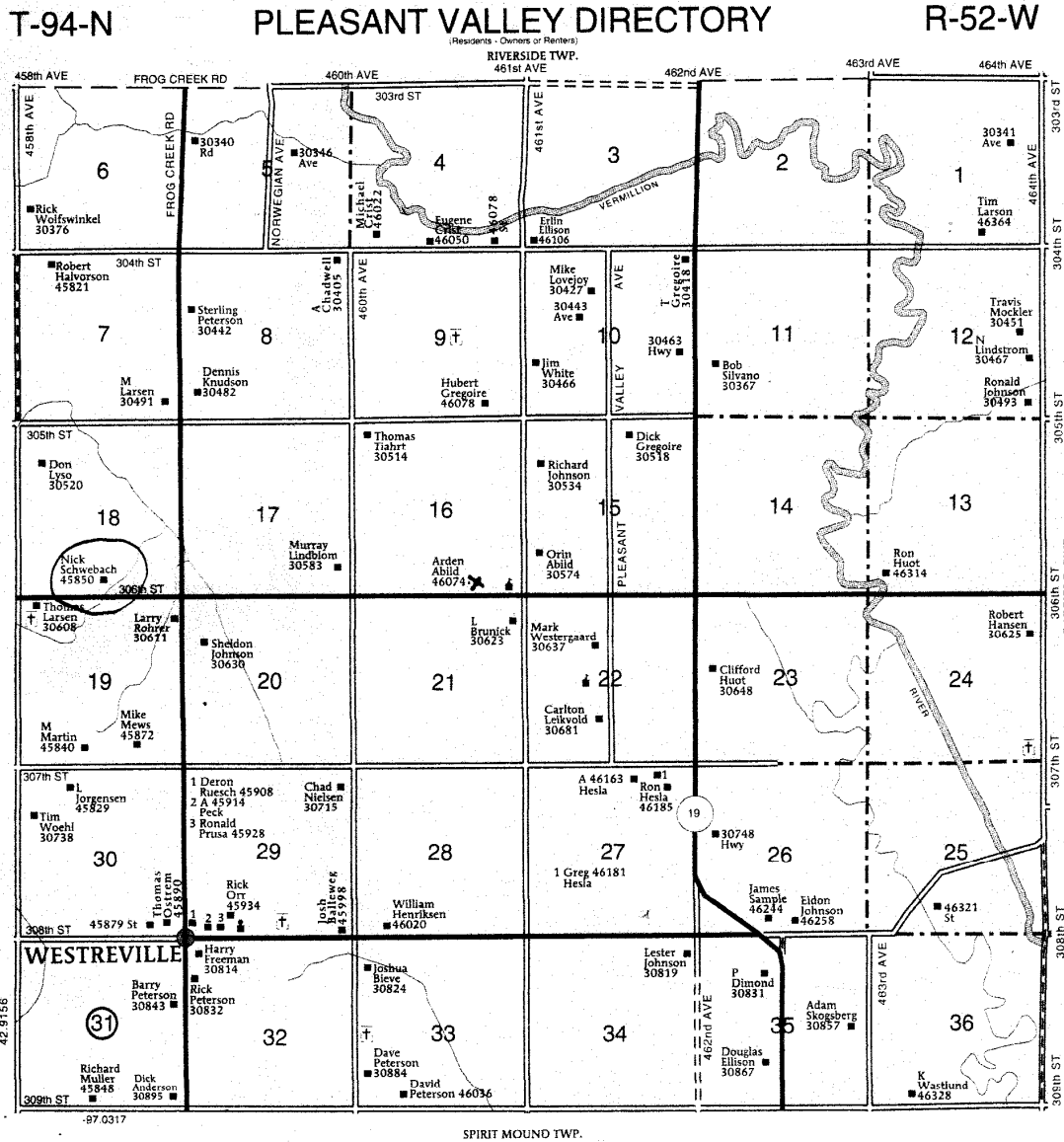



## **HISTORY**

This farm located in the SE ¼ of Section 18, Pleasant Valley Township, Clay County was homesteaded by Walter Palmer.

The 1894 Clay County Atlas lists Edward Mart as the owner.

The 1912 and 1924 Clay County Atlas lists George F. Groves as the owner.

The 1937 Clay County Atlas lists Northwestern Life Insurance Co. as the owner and Hans & Oren Lewison as the operators (renters).

The 1948 and 1956 Clay County Atlas lists C. M. Olson as the owner.

**SOUTH DAKOTA STATE HISTORIC PRESERVATION OFFICE  
HISTORIC SITES SURVEY STRUCTURE FORM**

