

**SOUTH DAKOTA STATE HISTORIC PRESERVATION OFFICE  
HISTORIC SITES SURVEY STRUCTURE FORM**



**SITE INFORMATION**

\*SURVEY DATE: December 27, 2013 \*ADDRESS: 30722 464<sup>th</sup> Ave.  
\*SURVEYOR: Jim Stone \*COUNTY: Clay  
\*CITY: Vermillion

LOCATION DESCRIPTION: From Vermillion, intersection of South Dakota Highway 50 bi-pass and University road, North about 10- 3/4 miles to Hill Street, turn left (West) 1 mile to 464<sup>th</sup> Ave., turn right (North) about 1/8<sup>th</sup> mile on the right (East) side.

LEGAL DESCRIPTION: W 1/2, N 1/2, Lot 2, NW 1/4, 30 - 94 - 51 Garfield Twp.

\*QUARTER 1: NW 1/4  
\*QUARTER 2: \_\_\_\_\_  
\*TOWNSHIP: Garfield  
\*RANGE: 51  
\*SECTION: 30  
ACRES: 17.18

OWNER NAME: Dale R. & Sherry D. Olson  
OWNER ADDRESS: 29009 454<sup>th</sup> Ave.  
OWNER CITY: Viborg  
OWNER STATE: South Dakota  
OWNER ZIP: 57070  
QUAD NAME: \_\_\_\_\_

OWNER CODE 1: P  
OWNER CODE 2: \_\_\_\_\_  
OWNER CODE 3: \_\_\_\_\_

**HISTORIC SIGNIFICANCE**

\*DOE: \_\_\_\_\_  
\*DOE DATE: \_\_\_\_\_  
REASON INELIGIBLE: \_\_\_\_\_

REGISTER NAME: \_\_\_\_\_  
MULTIPLE PROPERTY NAME: \_\_\_\_\_

NOMINATION STATUS: \_\_\_\_\_  
DATE LISTED: \_\_\_\_\_  
REFERENCE NUMBER: \_\_\_\_\_  
HISTORIC DISTRICT RATING: C or NC  
PERIOD: \_\_\_\_\_

CATEGORY: \_\_\_\_\_  
SIGNIFICANCE LEVEL 1: N S L  
SIGNIFICANCE LEVEL 2: N S L  
CRITERIA 1: A B C D  
CRITERIA 2: A B C D  
CRITERIA 3: A B C D  
CRITERIA 4: A B C D

SIGNIFICANCE NOTES: \_\_\_\_\_  
\_\_\_\_\_  
\_\_\_\_\_

**STRUCTURE DETAILS**

\* = REQUIRED FIELD

**SOUTH DAKOTA STATE HISTORIC PRESERVATION OFFICE  
HISTORIC SITES SURVEY STRUCTURE FORM**



SHPO ID: \_\_\_\_\_  
 \*PROPERTY NAME: \_\_\_\_\_  
 OTHER NAME: \_\_\_\_\_

CURRENT FUNCTION: Vacant FOUNDATION: Poured concrete  
 CURRENT SUBFUNCTION: Vacant ROOF MATERIAL: Steel roofing over cedar shingles  
 HISTORIC FUNCTION: Livestock barn ROOF SHAPE: Gable roof  
 HISTORIC SUBFUNCTION: Hay and grain storage STRUCTURAL SYSTEM: Balloon framing  
 OCCUPIED: No STYLE: Gable roof barn  
 ACCESSIBLE: Yes with permission TYPE: Livestock barn  
 WALLS: 2x4 studs, and 1x10 shiplap & 1/2" x 6" cedar lap siding

STORIES: 2 SIGNIFICANT PERSON: Phillip Olson  
 \*DATE OF CONSTRUCTION: 1910 to 1920 CULTURAL AFFILIATION: ?

ALTERED/MOVED NOTES: Original site. Steel roofing applied over cedar shingles on the roof. Any evidence of stalls and or pens in the main barn have been removed. Concrete floors in the lean-to and the main barn may have been added later.

INTERIOR NOTES: Milk cow stanchions are still in place in the South lean-to and it has a concrete floor with a gutter. 6' x 8' granary is still in place in the NE corner of the main barn. A stairs to the hayloft is built into the granary.

OTHER NOTES: 2X4 stud walls with 1x10 shiplap applied diagonally and 1/2" x 6" cedar lap siding on all four exterior walls. The South wall of the main barn is 2x4 studs with 1x10 shiplap applied horizontally. Windows are 9"x 12" four light. No evidence of a cupola ever being in the hayloft. The South lean-to appears to have been built at the same time as the barn. 2x4 rafters in the hayloft, but 2x6 rafters in the South lean-to.

\*PHYSICAL NOTES: Barn is in fair condition. \*RESTRICTED: Y or N  
 \*UTM EASTING: \_\_\_\_\_  
 \*UTM NORTHING: \_\_\_\_\_

\* = REQUIRED FIELD

SOUTH DAKOTA STATE HISTORIC PRESERVATION OFFICE  
 HISTORIC SITES SURVEY STRUCTURE FORM



**SKETCH MAP**

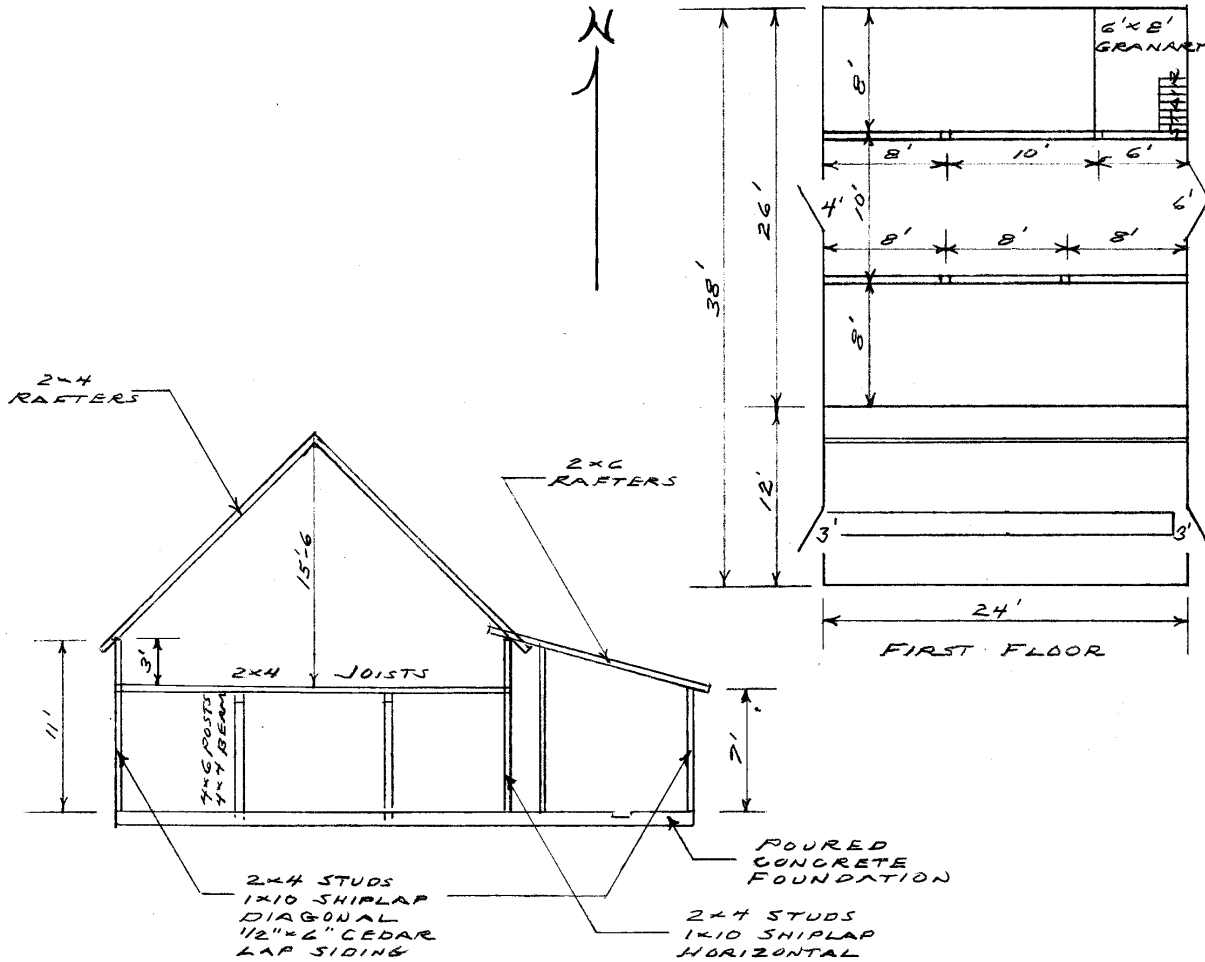

WEST ELEVATION

**PHOTOGR**

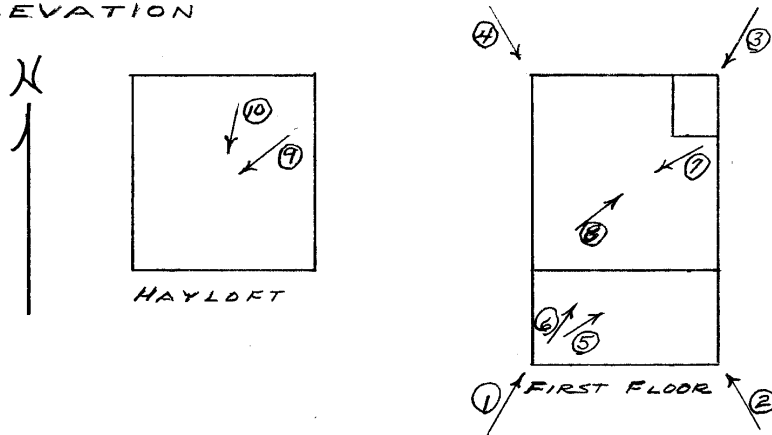

\* = REQUIRED FIELD

**SOUTH DAKOTA STATE HISTORIC PRESERVATION OFFICE  
HISTORIC SITES SURVEY STRUCTURE FORM**



**PHOTOGRAPHER:** Jim Stone  
**DATE OF PHOTO:** December 27, 2013

**ROLL NUMBER:** \_\_\_\_\_  
**PHOTO NUMBER:** 1  
**CAMERA DIRECTION:** Looking NE, SW corner



**PHOTOGRAPHER:** Jim Stone  
**DATE OF PHOTO:** December 27, 2013

**ROLL NUMBER:** \_\_\_\_\_  
**PHOTO NUMBER:** 2  
**CAMERA DIRECTION:** Looking NW, SE corner

\* = REQUIRED FIELD

**SOUTH DAKOTA STATE HISTORIC PRESERVATION OFFICE  
HISTORIC SITES SURVEY STRUCTURE FORM**



**PHOTOGRAPHER:** Jim Stone  
**DATE OF PHOTO:** December 27, 2013

**ROLL NUMBER:** \_\_\_\_\_  
**PHOTO NUMBER:** 3  
**CAMERA DIRECTION:** Looking SW, NE corner



**PHOTOGRAPHER:** Jim Stone  
**DATE OF PHOTO:** December 27, 2013

**ROLL NUMBER:** \_\_\_\_\_  
**PHOTO NUMBER:** 4  
**CAMERA DIRECTION:** Looking SE, NW corner

\* = REQUIRED FIELD

**SOUTH DAKOTA STATE HISTORIC PRESERVATION OFFICE  
HISTORIC SITES SURVEY STRUCTURE FORM**



**PHOTOGRAPHER:** Jim Stone  
**DATE OF PHOTO:** December 27, 2013

**ROLL NUMBER:** \_\_\_\_\_  
**PHOTO NUMBER:** 5

**CAMERA DIRECTION:** First floor, South lean-to, looking NE at milk cow stanchions still in place.



**PHOTOGRAPHER:** Jim Stone  
**DATE OF PHOTO:** December 27, 2013

**ROLL NUMBER:** \_\_\_\_\_  
**PHOTO NUMBER:** 6

**CAMERA DIRECTION:** First floor, looking NE, South wall of the main barn, 1x10 shiplap applied horizontally.

\* = REQUIRED FIELD

**SOUTH DAKOTA STATE HISTORIC PRESERVATION OFFICE  
HISTORIC SITES SURVEY STRUCTURE FORM**



**PHOTOGRAPHER:** Jim Stone  
**DATE OF PHOTO:** December 27, 2013

**ROLL NUMBER:** \_\_\_\_\_  
**PHOTO NUMBER:** 7

**First floor, main barn, looking SW, 4x6 posts, 4x4 beam and 2x4 floor joists. Note diagonal sheathing on West wall and horizontal sheathing on the South wall.**

**CAMERA DIRECTION:** \_\_\_\_\_



**PHOTOGRAPHER:** Jim Stone  
**DATE OF PHOTO:** December 27, 2013

**ROLL NUMBER:** \_\_\_\_\_  
**PHOTO NUMBER:** 8

**First floor, main barn, looking NE, granary in the NE corner and stairs built into granary.**

**CAMERA DIRECTION:** \_\_\_\_\_

\* = REQUIRED FIELD

**SOUTH DAKOTA STATE HISTORIC PRESERVATION OFFICE  
HISTORIC SITES SURVEY STRUCTURE FORM**



PHOTOGRAPHER: Jim Stone  
DATE OF PHOTO: December 27, 2013

ROLL NUMBER: \_\_\_\_\_  
PHOTO NUMBER: 9

Hayloft, looking SW, 2x4  
rafters, note difference in  
sheathing on the two  
walls.

CAMERA DIRECTION: \_\_\_\_\_



PHOTOGRAPHER: Jim Stone  
DATE OF PHOTO: December 27, 2013

ROLL NUMBER: \_\_\_\_\_  
PHOTO NUMBER: 10

Hayloft, looking SW,  
special trolley for a 4x4  
hay track.

CAMERA DIRECTION: \_\_\_\_\_

\* = REQUIRED FIELD



SOUTH DAKOTA STATE HISTORIC PRESERVATION OFFICE  
 HISTORIC SITES SURVEY STRUCTURE FORM



T-94-N GARFIELD DIRECTORY R-51-W

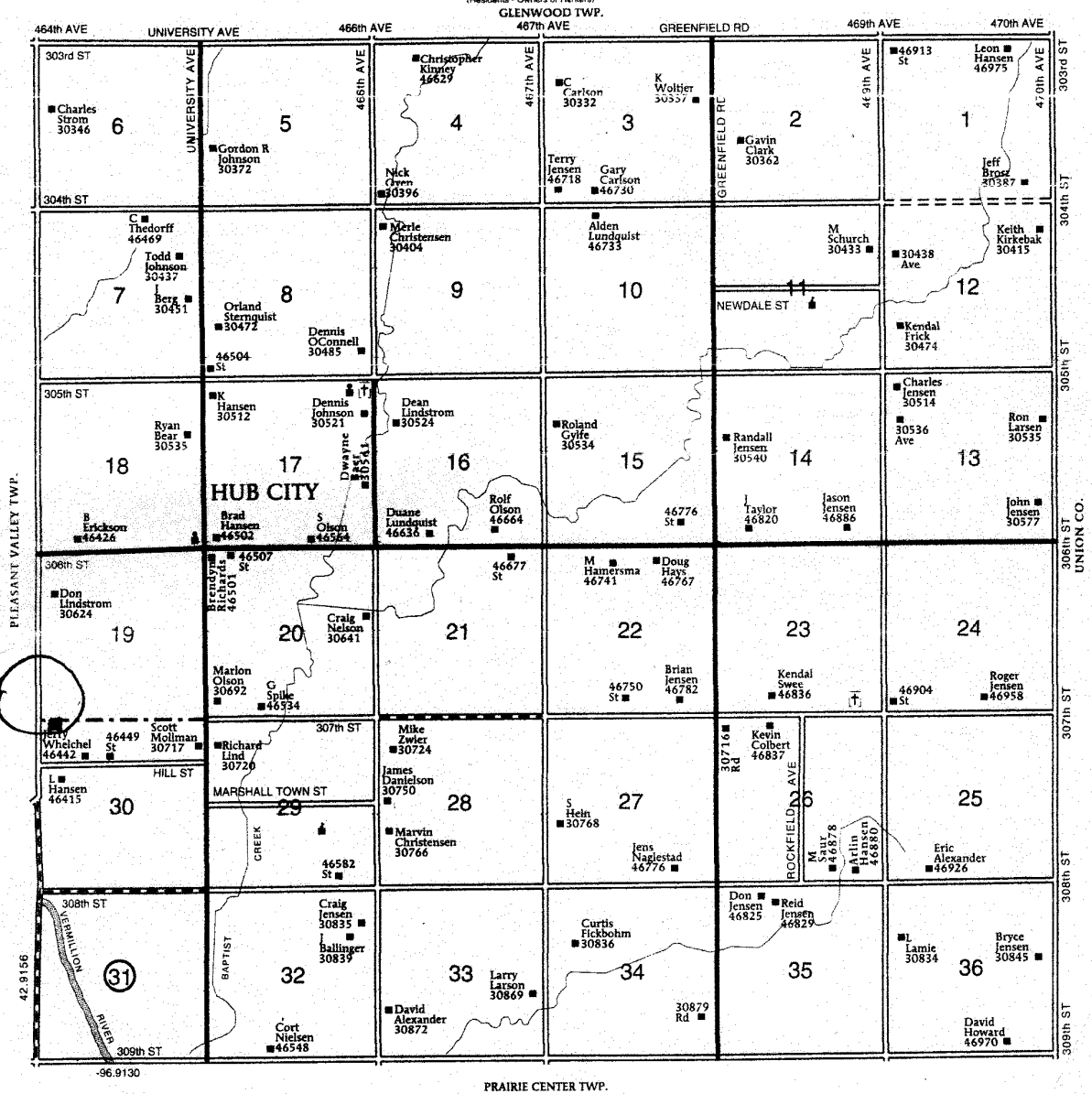

## **HISTORY**

This farm located in the NW¼ of Section 30, Garfield Township, Clay County was homesteaded by Thomas Getman.

The 1894 Clay County Atlas lists John Williamson as the owner.

The 1901 Clay County Atlas lists Fred Olson as the owner.

The 1912 and 1924 Clay County Atlas lists Phillip Olson as the owner.

The 1937 and 1948 Clay County Atlas lists Edla C. Olson as the owner.

The 1956 Clay County Atlas lists H. R. Olson as the owner.