

**SOUTH DAKOTA STATE HISTORIC PRESERVATION OFFICE  
HISTORIC SITES SURVEY STRUCTURE FORM**



**SITE INFORMATION**

\*SURVEY DATE: February 8, 2012 \*ADDRESS: 27 North Yale Street  
\*SURVEYOR: Jim Stone \*COUNTY: Clay  
\*CITY: Vermillion

LOCATION DESCRIPTION: East on main street from downtown Vermillion to Yale Street, turn left (North) on North Yale Street, 1 block, Home is on the corner of Yale and National Street, turn right (East) carriage barn is behind house off National Street.

LEGAL DESCRIPTION: N 35' of Lot 9, all of Lot 10 and W 1/2 of Vacated Alley, Block 63, Bigelow Addition, City of Vermillion, Clay County, South Dakota

\*QUARTER 1: \_\_\_\_\_ OWNER NAME: Richard and Sara Hammond  
\*QUARTER 2: \_\_\_\_\_ OWNER ADDRESS: 27 North Yale Street  
\*TOWNSHIP: \_\_\_\_\_ OWNER CITY: Vermillion  
\*RANGE: \_\_\_\_\_ OWNER STATE: South Dakota  
\*SECTION: \_\_\_\_\_ OWNER ZIP: 57069  
ACRES: \_\_\_\_\_ QUAD NAME: \_\_\_\_\_

OWNER CODE 1: P  
OWNER CODE 2: F S L P  
OWNER CODE 3: F S L P

**HISTORIC SIGNIFICANCE**

\*DOE: \_\_\_\_\_ REGISTER NAME: \_\_\_\_\_  
\*DOE DATE: \_\_\_\_\_ MULTIPLE PROPERTY NAME: \_\_\_\_\_  
REASON INELIGIBLE: \_\_\_\_\_

NOMINATION STATUS: \_\_\_\_\_ CATEGORY: \_\_\_\_\_  
DATE LISTED: \_\_\_\_\_ SIGNIFICANCE LEVEL 1: N S L  
SIGNIFICANCE LEVEL 2: N S L  
REFERENCE NUMBER: \_\_\_\_\_  
HISTORIC DISTRICT RATING: C or NC CRITERIA 1: A B C D  
PERIOD: Early 1900's CRITERIA 2: A B C D  
CRITERIA 3: A B C D  
CRITERIA 4: A B C D

SIGNIFICANCE NOTES: House is in the Vermillion Historical District. House built in 1905 by a Peterson family. The family lived there for many years and then their daughter lived there into the 1970's. Steve Dill bought the house and lived here for a few years and then sold it to the Hammonds. A poem that was written by Dill for Shoebox Greeting Card Co. and eventually used by Hallmark Greeting Card Co. has the credit, Dill - 27 No. Yale St.

\* = REQUIRED FIELD

**SOUTH DAKOTA STATE HISTORIC PRESERVATION OFFICE  
HISTORIC SITES SURVEY STRUCTURE FORM**



**STRUCTURE DETAILS**

SHPO ID: 13 CL 00200095

\*PROPERTY NAME: Peter William Peterson carriage barn

OTHER NAME: \_\_\_\_\_

CURRENT FUNCTION: Shop

FOUNDATION: Brick foundation

CURRENT SUBFUNCTION: Storage

ROOF MATERIAL: Asphalt shingles

HISTORIC FUNCTION: Carriage barn

ROOF SHAPE: Gambrel

HISTORIC SUBFUNCTION: Hay storage

STRUCTURAL SYSTEM: Balloon framing

STYLE: Gambrel roof

Carriage/horse

OCCUPIED: Yes

TYPE: barn

ACCESSIBLE: Yes

WALLS: 2x4 w/ #106 siding

STORIES: 2

SIGNIFICANT PERSON: Peter William Peterson

\*DATE OF CONSTRUCTION: Early 1900's

CULTURAL AFFILIATION: Sweden

ALTERED/MOVED NOTES: Original site. First floor has been remodeled. Insulated and drywalled. Stalls and or stanchions removed. Concrete floor poured. Windows on first floor have been replaced with 20"x20" over 20"x20" insulated double hung windows. Sliding door on North has been replaced with an overhead door. Steel beam running east to west installed in the center of ceiling on the first floor.

INTERIOR NOTES: 2x4 walls with #106 drop siding. Truss running east to west in the center of the hayloft to support floor joists. Floor joists run the length (32') north to south. 1x12 sheathing on roof spaced for wood shingles. Shingles removed, OSB sheets applied and roof has been shingled with asphalt shingles.

OTHER NOTES: Windows in hayloft on west dormer are 20"x28" over 20"x28" and appear to be original. Sliding doors on the west and south are original doors with original track and rollers.

\*PHYSICAL NOTES: Carriage barn is in very good condition.

\*UTM ZONE: \_\_\_\_\_

\*RESTRICTED: Y or N

\*UTM EASTING: \_\_\_\_\_

\*UTM NORTHING: \_\_\_\_\_

\* = REQUIRED FIELD

**SOUTH DAKOTA STATE HISTORIC PRESERVATION OFFICE  
HISTORIC SITES SURVEY STRUCTURE FORM**

**SKETCH MAP**

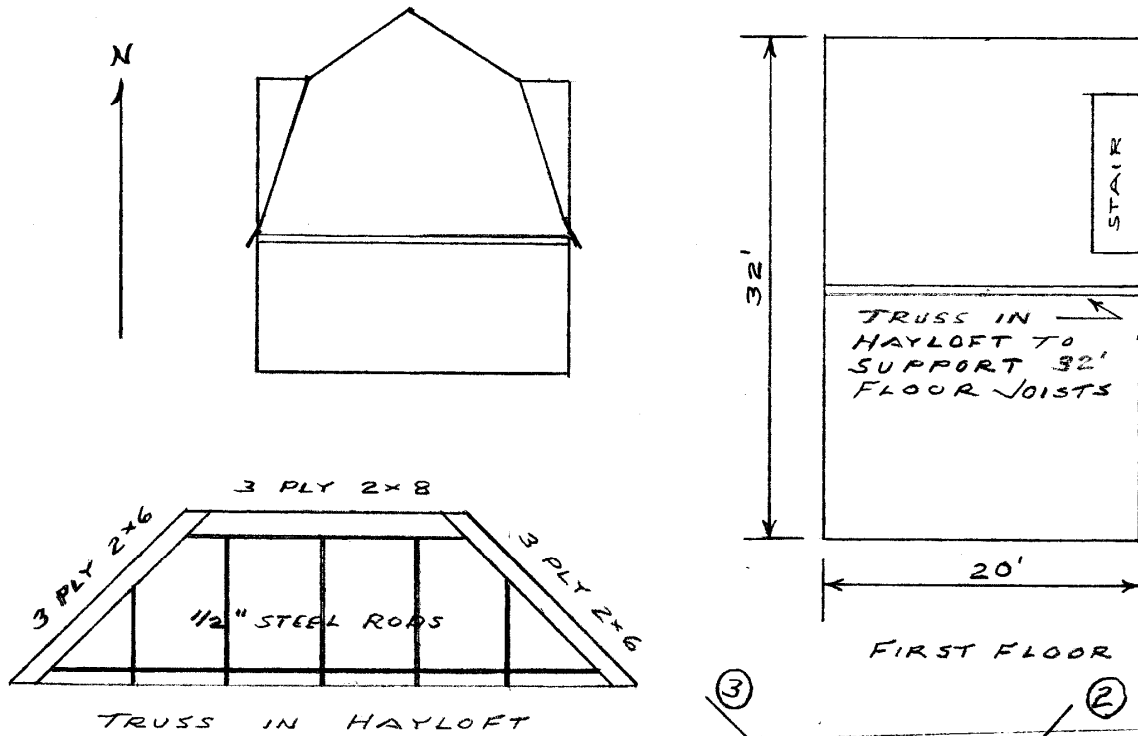

**PHOTOGRAPHS**

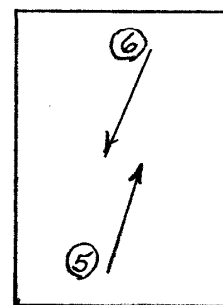
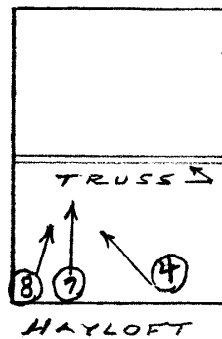

PHOTOGRAPHER: \_\_\_\_\_  
DATE OF PHOTO: \_\_\_\_\_

① ROLL NUMBER: \_\_\_\_\_  
PHOTO NUMBER: \_\_\_\_\_  
CAMERA DIRECTION: \_\_\_\_\_

\* = REQUIRED FIELD

**SOUTH DAKOTA STATE HISTORIC PRESERVATION OFFICE  
HISTORIC SITES SURVEY STRUCTURE FORM**



PHOTOGRAPHER: Jim Stone  
DATE OF PHOTO: February 8, 2012

ROLL NUMBER: \_\_\_\_\_  
PHOTO NUMBER: 1  
CAMERA DIRECTION: Looking NE, SW corner



PHOTOGRAPHER: Jim Stone  
DATE OF PHOTO: February 8, 2012

ROLL NUMBER: \_\_\_\_\_  
PHOTO NUMBER: 2  
CAMERA DIRECTION: Looking SW, NE corner

\* = REQUIRED FIELD



**SOUTH DAKOTA STATE HISTORIC PRESERVATION OFFICE  
HISTORIC SITES SURVEY STRUCTURE FORM**



**PHOTOGRAPHER:** Jim Stone  
**DATE OF PHOTO:** February 8, 2012

**ROLL NUMBER:** \_\_\_\_\_  
**PHOTO NUMBER:** 3  
**CAMERA DIRECTION:** Looking SW, NW corner



**PHOTOGRAPHER:** Jim Stone  
**DATE OF PHOTO:** February 8, 2012

**ROLL NUMBER:** \_\_\_\_\_  
**PHOTO NUMBER:** 4  
**CAMERA DIRECTION:** Hayloft, Looking NW, dormer framing

\* = REQUIRED FIELD

**SOUTH DAKOTA STATE HISTORIC PRESERVATION OFFICE  
HISTORIC SITES SURVEY STRUCTURE FORM**



**PHOTOGRAPHER:** Jim Stone  
**DATE OF PHOTO:** February 8, 2012

**ROLL NUMBER:** \_\_\_\_\_  
**PHOTO NUMBER:** 5  
**CAMERA DIRECTION:** First floor, looking North



**PHOTOGRAPHER:** Jim Stone  
**DATE OF PHOTO:** February 8, 2012

**ROLL NUMBER:** \_\_\_\_\_  
**PHOTO NUMBER:** 6  
**CAMERA DIRECTION:** First floor, looking South

\* = REQUIRED FIELD



**SOUTH DAKOTA STATE HISTORIC PRESERVATION OFFICE  
HISTORIC SITES SURVEY STRUCTURE FORM**



Jim Stone  
February 8, 2012

ROLL NUMBER:  
PHOTO NUMBER: 7

CAMERA DIRECTION: Hayloft, looking North,  
truss that supports 32'  
floor joists



PHOTOGRAPHER: Jim Stone  
DATE OF PHOTO: February 8, 2012

ROLL NUMBER:  
PHOTO NUMBER: 8  
CAMERA DIRECTION: Hayloft, looking North

\* = REQUIRED FIELD

SOUTH DAKOTA STATE HISTORIC PRESERVATION OFFICE  
HISTORIC SITES SURVEY STRUCTURE FORM

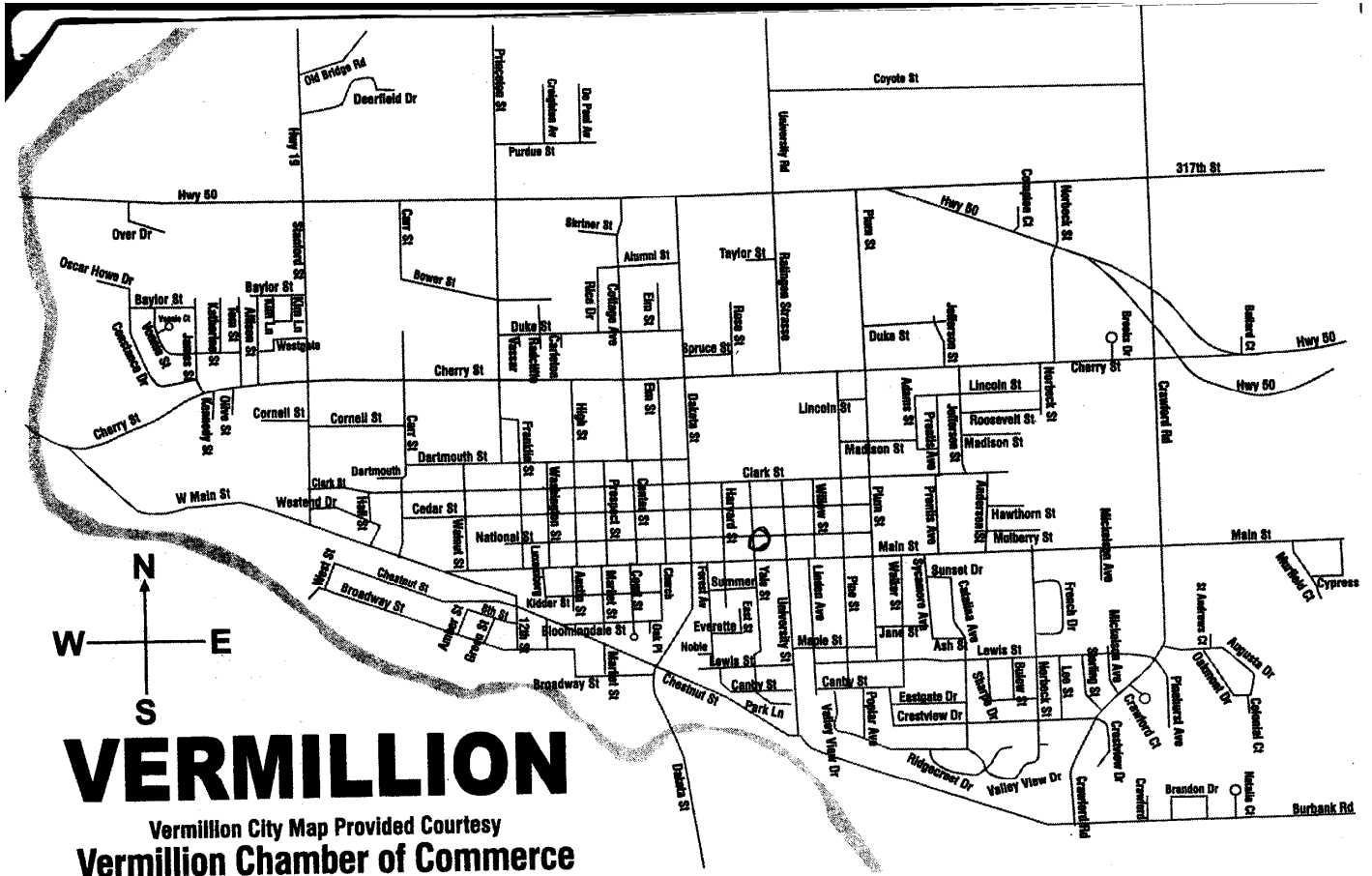

The Following Is From

\* = REQUIRED FIELD



## **History Of The Swedes of Clay County, South Dakota**

### **HISTORY**

Peter William Peterson owned this home in Vermillion. We think that he may have built it, but have no records.

Peter William Peterson was born May 1, 1860 in Sweden. His parents were G. J. Peterson or Gjed-Jonas Peterson born June 6, 1840 in Vasterfors Parish, Dalarna, Sweden and Christine (Olsdotter) born Sept 4, 1841 in Vasterfors Parish, Dalarna, Sweden. With their two children, Peter William and Christine the two oldest of their thirteen children, they immigrated from Sweden on May 9, 1868 and arrived in Clay County in July of 1868. They filed on their homestead, the S1/2 of the NE 1/4 and the N 1/2 of the SE 1/4, Section 8, Paririe Center Twp. He obtained patents on this land March 20, 1877. G. J. Peterson was believed to be the first Swede to settle on a government claim in Clay County.

They lived in a used wagon box with a covered top on their claim until the frame house was built. It was the first frame building in that settlement. A son Carl Johan was born July 12, 1868 and is believed to be the first Swedish child born in Clay County. It was at this home that G. Jonas Peterson organized the Dalesburg Lutheran Church in October 1869.

G. Jonas Peterson wrote two books and had them published. "The Public Schools One Thousand Years Hence" and "The Horseless Carriage". He moved to Vermillion and engaged in the mercantile business with his oldest son P. W. Peterson.

G. Jonas Perteson later moved to Texas and engaged in the cattle business on a large scale, also the growing of rice and became independently wealthy.

Peter William Peterson married Ada E. (Maurer) born March 11, 1866 in Cedar Rapids, Iowa on September 24, 1885. Ada was of German / English ancestry. They farmed north of Vermillion for many years where he was a breeder of thoroughbred Poland China hogs. He represented Clay in the state legislature for two sessions, 1908 and 1910.

They had four children.

Mable Angleine, born July 24, 1886, died September 1898

Lee Arthur, born September 17, 1888, died October 22, 1889

Edna Irene, born November 8, 1890. She never married and made her home with her father, taking care of him in his old age.

Howard Maurer, born March 21, 1897, Died Sept 4, 1918 at the Great Lakes Naval Training Station, Chicago, during the first World War.

Ada E. (Maurer) Peterson died February 6, 1941 at 27 North Yale Street.

Edna Irene Peterson lived in the home after her father died and into the 1970's. She died in the nursing home here in Vermillion.

**SOUTH DAKOTA STATE HISTORIC PRESERVATION OFFICE  
HISTORIC SITES SURVEY STRUCTURE FORM**

