

**SOUTH DAKOTA STATE HISTORIC PRESERVATION OFFICE
HISTORIC SITES SURVEY STRUCTURE FORM**



SITE INFORMATION

*SURVEY DATE: July 20, 2012 *ADDRESS: 30624 470th Ave.
*SURVEYOR: Jim Stone *COUNTY: Union
*CITY: Beresford

LOCATION DESCRIPTION: South Dakota Highway 50 East of Vermillion 2 miles to Greenfield Road, Turn left (North) 12-1/2 miles to 306th Street, turn right (East) to 466th Ave., turn right (South) about 1/3 mile, on the right (West) side

LEGAL DESCRIPTION: NW ¼ 19 – 94 – 50 Union Twp.

*QUARTER 1: NW 1/4
*QUARTER 2: _____
*TOWNSHIP: Union
*RANGE: 50
*SECTION: 19
ACRES: 148.34

OWNER NAME: Ronald Larson
OWNER ADDRESS: 30535 470th Ave.
OWNER CITY: Beresford
OWNER STATE: South Dakota
OWNER ZIP: 57004
QUAD NAME: _____

OWNER CODE 1: P
OWNER CODE 2: F S L P
OWNER CODE 3: F S L P

HISTORIC SIGNIFICANCE

*DOE: _____
*DOE DATE: _____
REASON INELIGIBLE: _____

REGISTER NAME: _____
MULTIPLE PROPERTY NAME: _____

NOMINATION STATUS: _____
DATE LISTED: _____
REFERENCE NUMBER: _____
HISTORIC DISTRICT RATING: C or NC
PERIOD: _____

CATEGORY: _____
SIGNIFICANCE LEVEL 1: N S L
SIGNIFICANCE LEVEL 2: N S L
CRITERIA 1: A B C D
CRITERIA 2: A B C D
CRITERIA 3: A B C D
CRITERIA 4: A B C D

SIGNIFICANCE NOTES: Farm was homesteaded in 1876 by Peter Larson. Farm has been in the Larson family for 136 years.

STRUCTURE DETAILS

* = REQUIRED FIELD

**SOUTH DAKOTA STATE HISTORIC PRESERVATION OFFICE
HISTORIC SITES SURVEY STRUCTURE FORM**



SHPO ID: _____

*PROPERTY NAME: _____

OTHER NAME: _____

CURRENT FUNCTION: Livestock barn FOUNDATION: Poured concrete
Steel over cedar

CURRENT SUBFUNCTION: Storage ROOF MATERIAL: shingles

HISTORIC FUNCTION: Livestock barn ROOF SHAPE: Gable

HISTORIC SUBFUNCTION: Hay storage STRUCTURAL SYSTEM: Balloon framing

OCCUPIED: Yes STYLE: Gable roof barn

ACCESSIBLE: Yes with permission TYPE: Livestock barn
2x6, no sheathing,
1/2"x6" cedar lap

WALLS: siding

STORIES: 2 SIGNIFICANT PERSON: Peter Larson

*DATE OF CONSTRUCTION: 1890 CULTURAL AFFILIATION: Swedish

ALTERED/MOVED NOTES: Moved about 300' North and remodeled. Appears to have been built with some urgency. Studs were spliced at the top to make the wall 2' taller. Some of the studs and the added top on all studs are rough sawn cottonwood and some are regular 2x6. All milk cow stanchions and horse stalls have been removed.

INTERIOR NOTES: Has two rows 4x6 posts and 4x6 beam to support hayloft floor. Floor joists are 2x8's, some rough sawn cottonwood and some milled.

OTHER NOTES: Windows were 8"x10" four light. Walls are 2x6, no sheathing and 1/2"x6" cedar lap siding. Rafters are 2-1/2" to 3" wide x 6" rough sawn cottonwood 3'- 4" O.C. Two 2x4's rough sawn for a top plate. Very wide sheathing on roof. One metal cupola.

*PHYSICAL NOTES: Barn is in poor condition. Without sheathing the 1/2"x6" cedar siding bows and allows the rain to start rotting the siding. The siding is in very poor condition.

*UTM ZONE: _____ *RESTRICTED: Y or N

*UTM EASTING: _____

*UTM NORTHING: _____

* = REQUIRED FIELD

**SOUTH DAKOTA STATE HISTORIC PRESERVATION OFFICE
HISTORIC SITES SURVEY STRUCTURE FORM**

SKETCH MAP

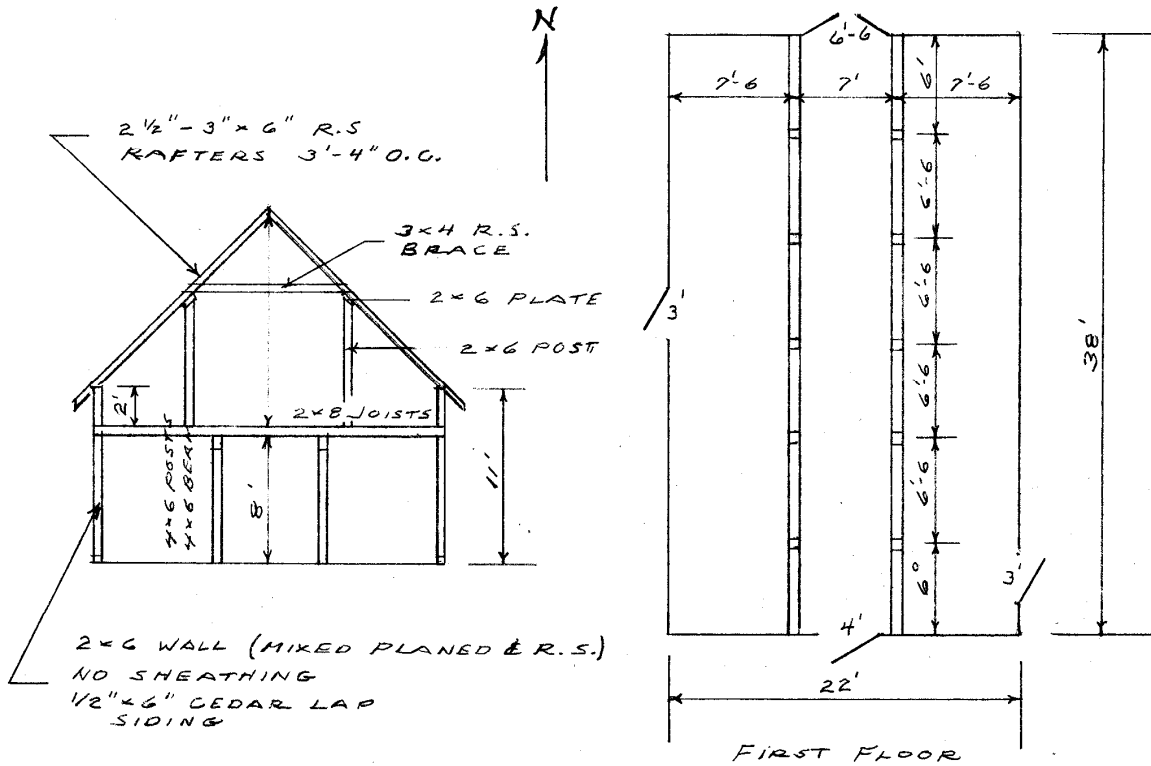

PHOTOGRAPHS

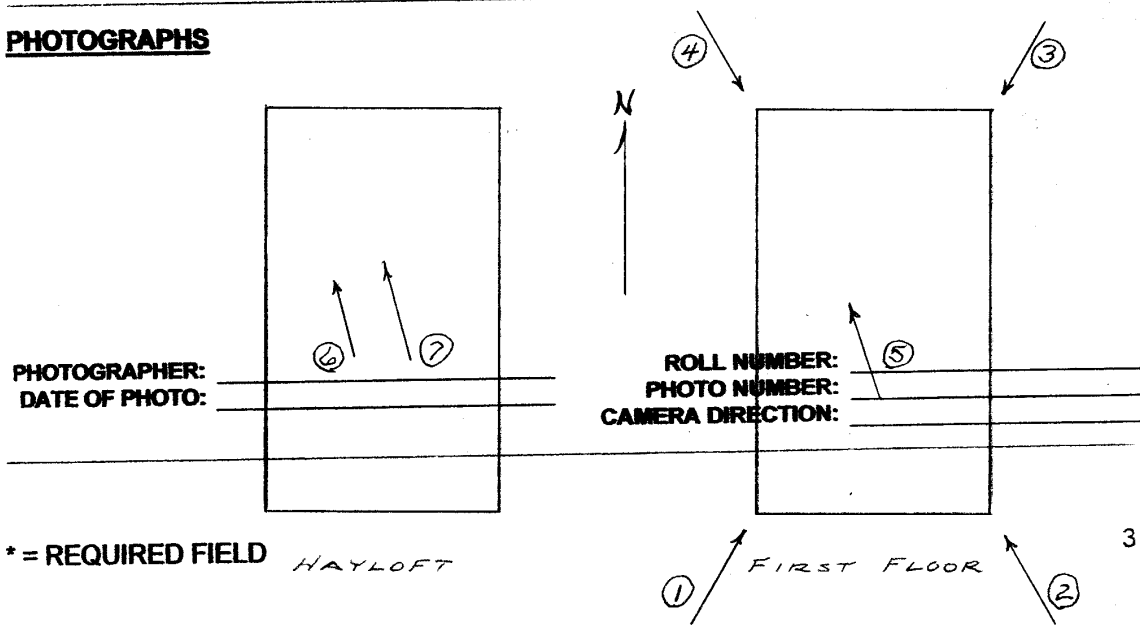

**SOUTH DAKOTA STATE HISTORIC PRESERVATION OFFICE
HISTORIC SITES SURVEY STRUCTURE FORM**



PHOTOGRAPHER: Jim Stone
DATE OF PHOTO: July 20, 2012

ROLL NUMBER: _____
PHOTO NUMBER: 1
CAMERA DIRECTION: Looking NE, SW corner



PHOTOGRAPHER: Jim Stone
DATE OF PHOTO: July 20, 2012

ROLL NUMBER: _____
PHOTO NUMBER: 2
CAMERA DIRECTION: Looking NW, SE corner

* = REQUIRED FIELD

**SOUTH DAKOTA STATE HISTORIC PRESERVATION OFFICE
HISTORIC SITES SURVEY STRUCTURE FORM**



PHOTOGRAPHER: Jim Stone
DATE OF PHOTO: July 20, 2012

ROLL NUMBER: _____
PHOTO NUMBER: 3
CAMERA DIRECTION: Looking SW, NE corner



PHOTOGRAPHER: Jim Stone
DATE OF PHOTO: July 20, 2012

ROLL NUMBER: _____
PHOTO NUMBER: 4
CAMERA DIRECTION: Looking SE, NW corner

**SOUTH DAKOTA STATE HISTORIC PRESERVATION OFFICE
HISTORIC SITES SURVEY STRUCTURE FORM**



PHOTOGRAPHER: Jim Stone
DATE OF PHOTO: July 20, 2012

ROLL NUMBER: _____
PHOTO NUMBER: 5

First floor. Looking
North, 4x6 post, 4x6
beam and 2x8 rough
sawn cottonwood

CAMERA DIRECTION: _____



PHOTOGRAPHER: Jim Stone
DATE OF PHOTO: July 20, 2012

ROLL NUMBER: _____
PHOTO NUMBER: 6

Hayloft, looking North,
2x6 rafter support

CAMERA DIRECTION: _____

**SOUTH DAKOTA STATE HISTORIC PRESERVATION OFFICE
HISTORIC SITES SURVEY STRUCTURE FORM**



PHOTOGRAPHER: Jim Stone
DATE OF PHOTO: July 20, 2012

ROLL NUMBER: _____
PHOTO NUMBER: 7

CAMERA DIRECTION: Hayloft, looking North,
3x4 rough sawn
cottonwood rafters ties.

EMMET TWP

T 94 N

RESIDENT

R 50 W

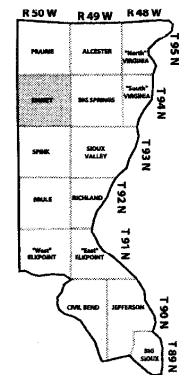
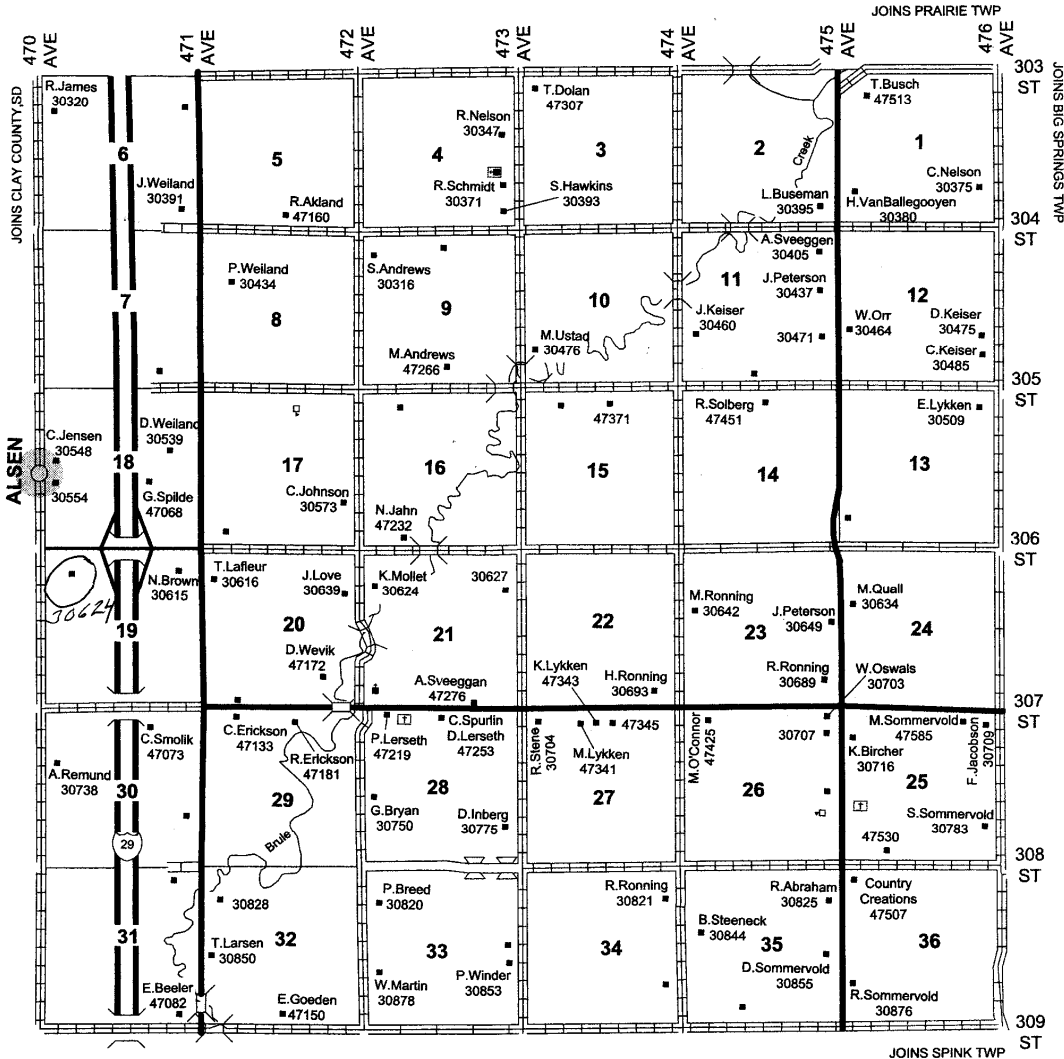

* = REQUIRED FIELD

HISTORY

The Following Information Was Furnished

Ronald Larson

Peter Larson homesteaded on this farm in 1876. He would have built the first barn South of where it is today. He moved it about 300' North up on top of the hill. There appears to have been some urgency to get the barn moved and remodeled.

Peter Larson's son Robert Larson built the second barn in 1920 for a draft horse barn.

Robert Larson's son Wesley Larson farmed the land.

Wesley Larson's son Ronald Larson now owns and farms the land.

Ronald Larson's son lives on the farm and helps his father farm.

This is the fifth generation of Larson's to live on here and farm the land for the last 136 years.

**SOUTH DAKOTA STATE HISTORIC PRESERVATION OFFICE
HISTORIC SITES SURVEY STRUCTURE FORM**

