

**SOUTH DAKOTA STATE HISTORIC PRESERVATION OFFICE
HISTORIC SITES SURVEY STRUCTURE FORM**



SITE INFORMATION

*SURVEY DATE: February 8, 2013 *ADDRESS: 46520 301th Street
*SURVEYOR: Jim Stone *COUNTY: Clay
*CITY: Beresford

LOCATION DESCRIPTION: From Vermillion, South Dakota Highway 50, East about 2 miles to Greenfield Road, Turn left (North) 17-1/2 miles to 301st Street, turn left (West) about 2-3/4 miles, on the right (North) side.

LEGAL DESCRIPTION: S 1/2, SW 1/4 & S 1/8, N 1/2, SW 1/4, 20 - 95 - 51 Glenwood Twp.

*QUARTER 1: SW 1/4
*QUARTER 2: _____
*TOWNSHIP: Glenwood
*RANGE: 51
*SECTION: 20
ACRES: 88.47

OWNER NAME: Steven A. Erickson
OWNER ADDRESS: 46520 301th Street
OWNER CITY: Beresford
OWNER STATE: South Dakota
OWNER ZIP: 57004
QUAD NAME: _____

OWNER CODE 1: P
OWNER CODE 2: _____
OWNER CODE 3: _____

HISTORIC SIGNIFICANCE

*DOE: _____
*DOE DATE: _____
REASON INELIGIBLE: _____

REGISTER NAME: _____
MULTIPLE PROPERTY NAME: _____

NOMINATION STATUS: _____
DATE LISTED: _____
REFERENCE NUMBER: _____
HISTORIC DISTRICT RATING: C or NC
PERIOD: _____

CATEGORY: _____
SIGNIFICANCE LEVEL 1: N S L
SIGNIFICANCE LEVEL 2: N S L
CRITERIA 1: A B C D
CRITERIA 2: A B C D
CRITERIA 3: A B C D
CRITERIA 4: A B C D

SIGNIFICANCE NOTES: _____

STRUCTURE DETAILS

* = REQUIRED FIELD

**SOUTH DAKOTA STATE HISTORIC PRESERVATION OFFICE
HISTORIC SITES SURVEY STRUCTURE FORM**



SHPO ID: _____
 *PROPERTY NAME: _____
 OTHER NAME: _____

CURRENT FUNCTION: Storage FOUNDATION: Native stone
 CURRENT SUBFUNCTION: Storage ROOF MATERIAL: Cedar shingles
 HISTORIC FUNCTION: Livestock barn ROOF SHAPE: Gable
 HISTORIC SUBFUNCTION: Hay storage STRUCTURAL SYSTEM: Balloon framing
 OCCUPIED: Yes STYLE: Gable roof barn
 TYPE: Livestock barn
2x4 studs, 1x6 #106 drop siding & 1/2"x6" cedar lap siding

ACCESSIBLE: Yes with permission WALLETS: _____
 STORIES: 2 SIGNIFICANT PERSON: Peter Hurtig
 *DATE OF CONSTRUCTION: 1890 to 1910 CULTURAL AFFILIATION: ?

ALTERED/MOVED NOTES: Original site. Any evidence of milk cow stanchions has been removed. 14' x 42' lean-to added to the East side soon after the original barn was built. 12' x 16' lean-to was on the South side, but has been removed. Concrete foundation and floor are still in place.

INTERIOR NOTES: Has four rows of double 2x6 posts with a spacer and 4x6's for a beam. Beams run North to South, 6' - 6' - 10' - 4' - 6' O. C. from the West wall and two rows of 4x6 beams running East to West, 8' and 12' O. C. from the North wall. These beams are under the North to South beams.

OTHER NOTES: 2x6 stud walls with 1x6 #106 drop siding. Stairs, tack room, two double and one single horse stalls are still along the North wall. Rafters and bracing are 2x6's. Floor joists are 2x8's. All of the dimension lumber is rough sawn cottonwood. Barn has a flat roof 10' wide at the peak, which is very unusual for a barn.

*PHYSICAL NOTES: Barn is in very poor condition. Flat roof at the peak is rotted out and gone.

*UTM ZONE: _____ *RESTRICTED: Y or N
 *UTM EASTING: _____
 *UTM NORTHING: _____

* = REQUIRED FIELD

SOUTH DAKOTA STATE HISTORIC PRESERVATION OFFICE
 HISTORIC SITES SURVEY STRUCTURE FORM



SKETCH MAP

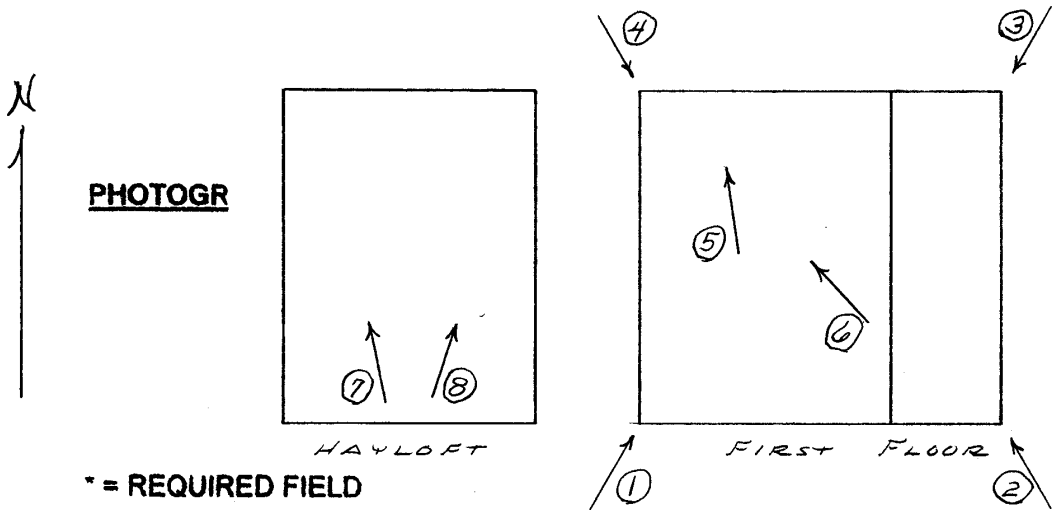
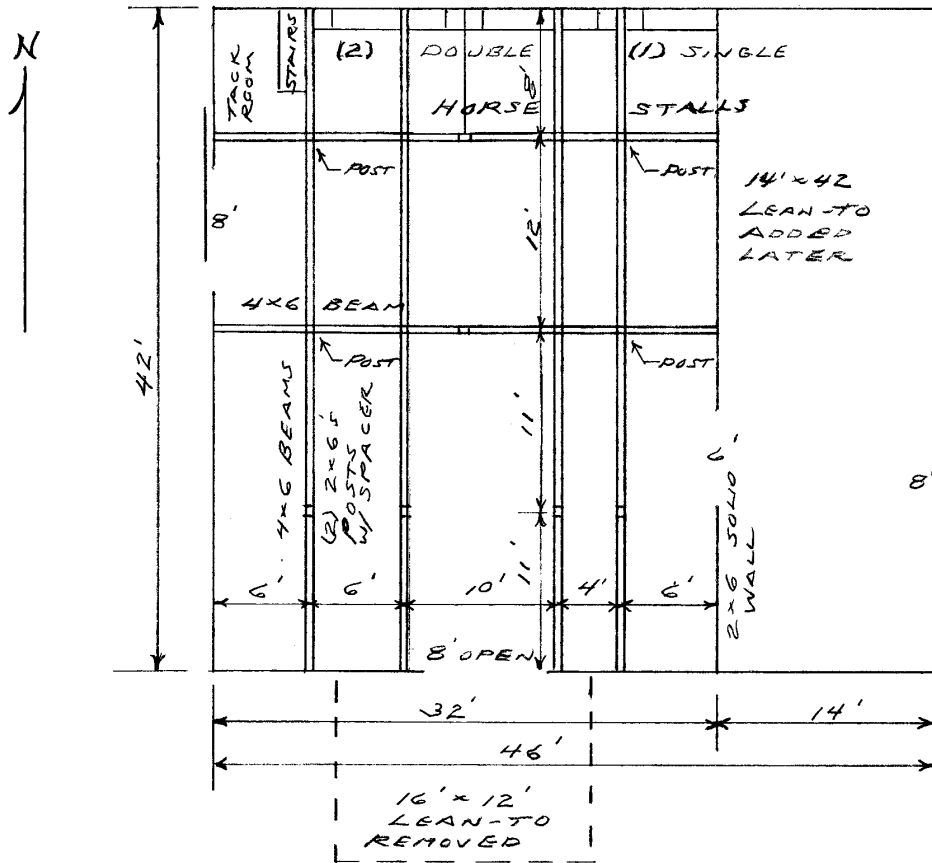

* = REQUIRED FIELD

* = REQUIRED FIELD

SOUTH DAKOTA STATE HISTORIC PRESERVATION OFFICE
 HISTORIC SITES SURVEY STRUCTURE FORM



SKETCH MAP

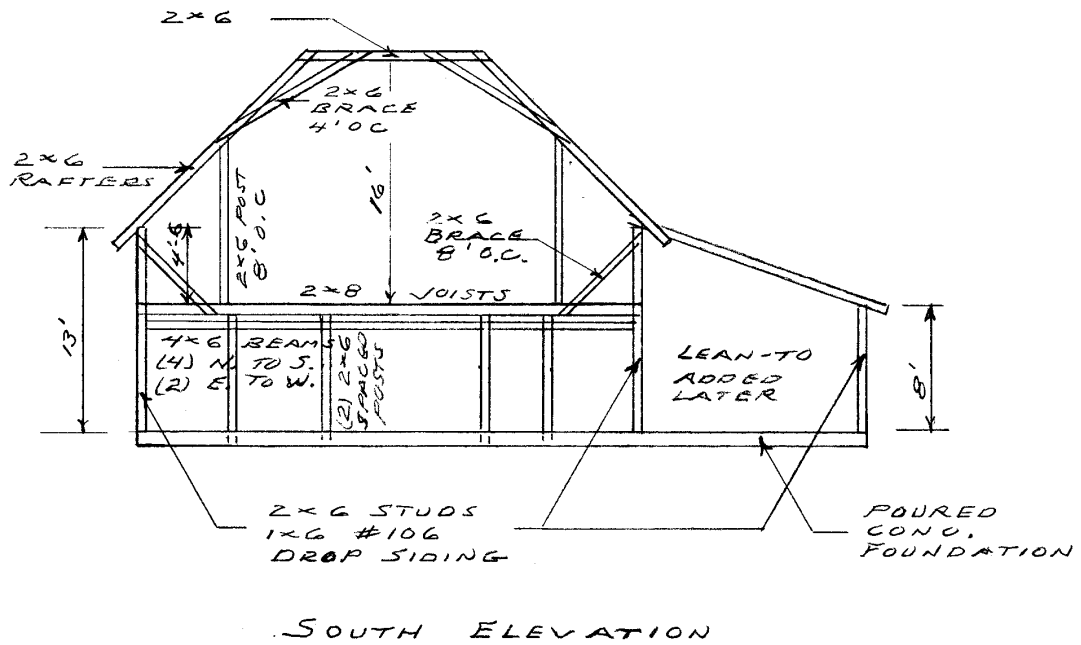

PHOTOGR

* = REQUIRED FIELD

* = REQUIRED FIELD

**SOUTH DAKOTA STATE HISTORIC PRESERVATION OFFICE
HISTORIC SITES SURVEY STRUCTURE FORM**



PHOTOGRAPHER: Jim Stone
DATE OF PHOTO: February 8, 2013

ROLL NUMBER: _____
PHOTO NUMBER: 1
CAMERA DIRECTION: Looking NE, SW corner,
note flat roof at the peak



PHOTOGRAPHER: Jim Stone
DATE OF PHOTO: February 8, 2013

ROLL NUMBER: _____
PHOTO NUMBER: 2
CAMERA DIRECTION: Looking NW, SE corner

* = REQUIRED FIELD

**SOUTH DAKOTA STATE HISTORIC PRESERVATION OFFICE
HISTORIC SITES SURVEY STRUCTURE FORM**



PHOTOGRAPHER: Jim Stone
DATE OF PHOTO: February 8, 2013

ROLL NUMBER: _____
PHOTO NUMBER: 3
CAMERA DIRECTION: Looking SW, NE corner



PHOTOGRAPHER: Jim Stone
DATE OF PHOTO: February 8, 2013

ROLL NUMBER: _____
PHOTO NUMBER: 4
CAMERA DIRECTION: Looking SE, NW corner

* = REQUIRED FIELD

**SOUTH DAKOTA STATE HISTORIC PRESERVATION OFFICE
HISTORIC SITES SURVEY STRUCTURE FORM**



PHOTOGRAPHER: Jim Stone
DATE OF PHOTO: February 8, 2013

ROLL NUMBER: _____
PHOTO NUMBER: 5

CAMERA DIRECTION: First floor, looking NW,
4x6 beams under 4x6
beams, tack room, stairs
and double horse stall



PHOTOGRAPHER: Jim Stone
DATE OF PHOTO: February 8, 2013

ROLL NUMBER: _____
PHOTO NUMBER: 6

CAMERA DIRECTION: First floor, looking NW,
4x6 beam under 4x6
beams, 2x8 floor joists

* = REQUIRED FIELD

**SOUTH DAKOTA STATE HISTORIC PRESERVATION OFFICE
HISTORIC SITES SURVEY STRUCTURE FORM**



PHOTOGRAPHER: Jim Stone
DATE OF PHOTO: February 8, 2013

ROLL NUMBER: _____
PHOTO NUMBER: 7

First floor, looking up into hayloft, Floor rotted out, 2x6 rafters and 2x6 bracing

CAMERA DIRECTION: _____



PHOTOGRAPHER: Jim Stone
DATE OF PHOTO: February 8, 2013

ROLL NUMBER: _____
PHOTO NUMBER: 8

First floor, looking up into hayloft, floor rotted out, 2x6 rafters and 2x6 bracing

CAMERA DIRECTION: _____

* = REQUIRED FIELD

SOUTH DAKOTA STATE HISTORIC PRESERVATION OFFICE
HISTORIC SITES SURVEY STRUCTURE FORM



T-95-N GLENWOOD DIRECTORY R-51-W

(Residents - Owners or Renters)

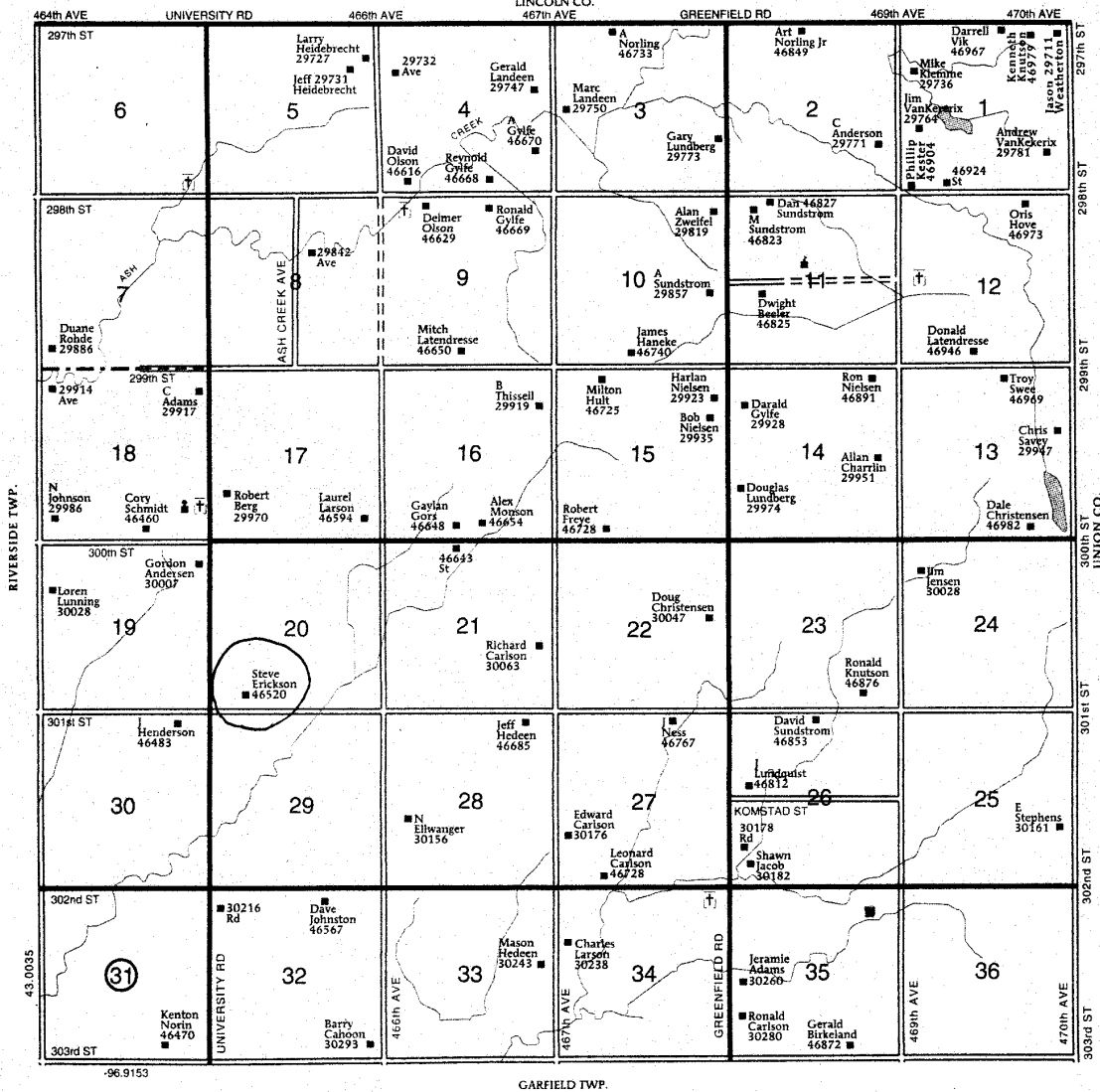

* = REQUIRED FIELD

HISTORY

This farm located in the SW ¼ of Section 20, Glenwood Township, Clay County was homesteaded by John P. Lundin.

The 1894 and 1901 Clay County Atlas lists Peter Hurtig as the owner. The farm was called “Northland”.

The 1912, 1924 and 1937 Clay County Atlas lists Ellen Hurtig as the owner. P. S. Peterson is listed as the operator.

1948 Clay County Atlas lists Sig Erickson as the owner.

The 1956 Clay County atlas lists Lydia Beckstrom as the owner.