

**SOUTH DAKOTA STATE HISTORIC PRESERVATION OFFICE
HISTORIC SITES SURVEY STRUCTURE FORM**



SITE INFORMATION

*SURVEY DATE: Aug. 2, 2012 *ADDRESS: 31229 Greenfield Road
*SURVEYOR: Jim Stone *COUNTY: Clay
*CITY: Vermillion

LOCATION DESCRIPTION: South Dakota Highway 50, East two miles to Greenfield Road, turn left (North), 4-1/2 S curve, about 1/4 mile East, on the left (North) side.

LEGAL DESCRIPTION: SW 1/4, 15 - 93 - 51 Prairie Center Twp.

*QUARTER 1: SW 1/4 OWNER NAME: Heath Hybertson
*QUARTER 2: _____ OWNER ADDRESS: 28875 461st Ave.
*TOWNSHIP: Prairie Center OWNER CITY: Centerville
*RANGE: 51 OWNER STATE: South Dakota
*SECTION: 15 OWNER ZIP: 57014
ACRES: 160.85 QUAD NAME: _____

OWNER CODE 1: P
OWNER CODE 2:
OWNER CODE 3:

HISTORIC SIGNIFICANCE

*DOE: _____ REGISTER NAME: _____
*DOE DATE: _____ MULTIPLE PROPERTY NAME: _____
REASON INELIGIBLE: _____

NOMINATION STATUS: _____ CATEGORY: _____
DATE LISTED: _____ SIGNIFICANCE LEVEL 1: N S L
REFERENCE NUMBER: _____ SIGNIFICANCE LEVEL 2: N S L
HISTORIC DISTRICT RATING: C or NC CRITERIA 1: A B C D
PERIOD: _____ CRITERIA 2: A B C D
CRITERIA 3: A B C D
CRITERIA 4: A B C D

SIGNIFICANCE NOTES: _____

STRUCTURE DETAILS

* = REQUIRED FIELD

**SOUTH DAKOTA STATE HISTORIC PRESERVATION OFFICE
HISTORIC SITES SURVEY STRUCTURE FORM**



SHPO ID: _____
 *PROPERTY NAME: _____
 OTHER NAME: _____

CURRENT FUNCTION:	<u>Cattle barn</u>	FOUNDATION:	<u>Poured concrete</u>
CURRENT SUBFUNCTION:	<u>Straw storage</u>	ROOF MATERIAL:	<u>Steel over cedar shingles</u>
HISTORIC FUNCTION:	<u>Livestock barn</u>	ROOF SHAPE:	<u>Gambrel</u>
HISTORIC SUBFUNCTION:	<u>Hay and grain storage</u>	STRUCTURAL SYSTEM:	<u>Balloon framing</u>
		STYLE:	<u>Gambrel roof barn</u>
OCCUPIED:	<u>Yes</u>	TYPE:	<u>Livestock barn</u>
	<u>Yes with</u>		<u>2x6, 1x6 #106 drop</u>
ACCESSIBLE:	<u>permission</u>	WALLS:	<u>siding</u>

STORIES: 2 SIGNIFICANT PERSON: _____
 *DATE OF CONSTRUCTION: _____ CULTURAL AFFILIATION: _____

ALTERED/MOVED NOTES: Original site. All but one horse stall, calf pen and stairs have been removed. Roof re-roofed with steel roofing.

INTERIOR NOTES: Has two rows 6x8 posts and (4) 2x8's for a beam. 2x10 floor joists. Has two massive 6"x 10" timbers used as bracing for the West hayloft gable end wall. These timbers are attached to the wall about 10' above the hayloft floor and down through the floor and are attached to the beams that support the hayloft floor. Has three double 2x6's for posts to support the hip on each side.

OTHER NOTES: Windows were 4"x 24" four light. Walls are 2x6 with no sheathing and 1x6 #106 drop siding. Rafters are 2x6 with 2x6 bracing from the bottom of hayloft wall to the hip and from the hip to 4' down from the peak, 24" O.C. Has a metal cupola.

*PHYSICAL NOTES: Barn is in good condition. Sliding doors are in good repair and move easily.

*UTM ZONE: _____ *RESTRICTED: Y or N
 *UTM EASTING: _____
 *UTM NORTHING: _____

* = REQUIRED FIELD

**SOUTH DAKOTA STATE HISTORIC PRESERVATION OFFICE
HISTORIC SITES SURVEY STRUCTURE FORM**

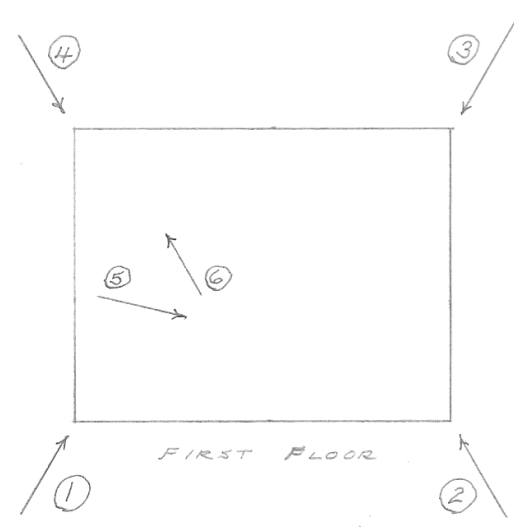
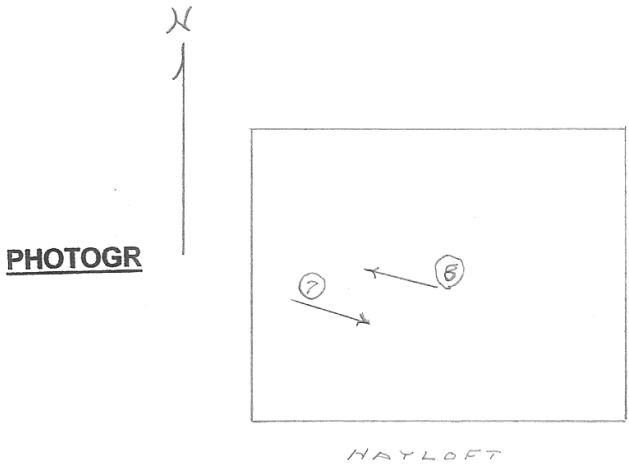
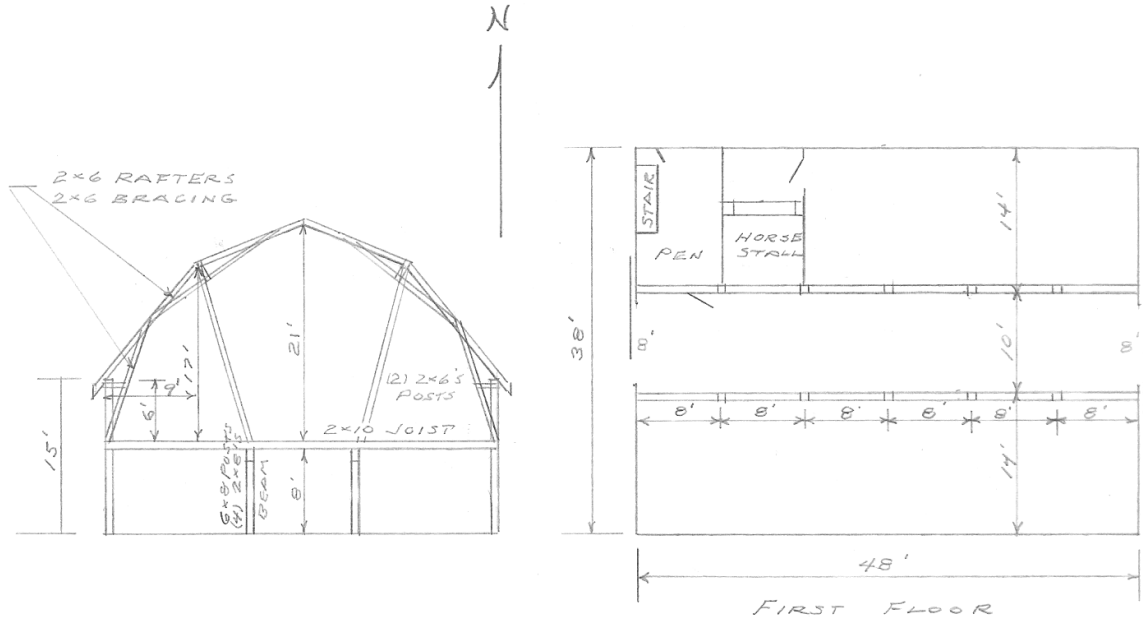

* = REQUIRED FIELD

**SOUTH DAKOTA STATE HISTORIC PRESERVATION OFFICE
HISTORIC SITES SURVEY STRUCTURE FORM**



PHOTOGRAPHER: Jim Stone
DATE OF PHOTO: Aug. 2, 2012

ROLL NUMBER: _____
PHOTO NUMBER: 1
CAMERA DIRECTION: Looking NE, SW corner



PHOTOGRAPHER: Jim Stone
DATE OF PHOTO: Aug. 2, 2012

ROLL NUMBER: _____
PHOTO NUMBER: 2
CAMERA DIRECTION: Looking NW, SE corner

* = REQUIRED FIELD

**SOUTH DAKOTA STATE HISTORIC PRESERVATION OFFICE
HISTORIC SITES SURVEY STRUCTURE FORM**



PHOTOGRAPHER: Jim Stone
DATE OF PHOTO: Aug. 2, 2012

ROLL NUMBER: _____
PHOTO NUMBER: 3
CAMERA DIRECTION: Looking SW, NE corner



PHOTOGRAPHER: Jim Stone
DATE OF PHOTO: Aug. 2, 2012

ROLL NUMBER: _____
PHOTO NUMBER: 4
CAMERA DIRECTION: Looking SE, NW corner

* = REQUIRED FIELD

**SOUTH DAKOTA STATE HISTORIC PRESERVATION OFFICE
HISTORIC SITES SURVEY STRUCTURE FORM**



PHOTOGRAPHER: Jim Stone
DATE OF PHOTO: Aug. 2, 2012

ROLL NUMBER: _____
PHOTO NUMBER: 5

CAMERA DIRECTION: First floor, looking East,
6x8 posts and (4) 2x8's
for a beam



PHOTOGRAPHER: Jim Stone
DATE OF PHOTO: Aug. 2, 2012

ROLL NUMBER: _____
PHOTO NUMBER: 6

CAMERA DIRECTION: First floor, looking NW,
horse pen/stall and feed
room in the NW corner

**SOUTH DAKOTA STATE HISTORIC PRESERVATION OFFICE
HISTORIC SITES SURVEY STRUCTURE FORM**



PHOTOGRAPHER: Jim Stone
DATE OF PHOTO: Aug. 2, 2012

ROLL NUMBER: _____
PHOTO NUMBER: 7

CAMERA DIRECTION: Hayloft, looking East, (2)
2x6's for post to support
hip



PHOTOGRAPHER: Jim Stone
DATE OF PHOTO: Aug. 2, 2012

ROLL NUMBER: _____
PHOTO NUMBER: 8

CAMERA DIRECTION: Hayloft, looking West,
one of two massive
6"x10" timbers to brace
the West gable end wall

* = REQUIRED FIELD

SOUTH DAKOTA STATE HISTORIC PRESERVATION OFFICE
HISTORIC SITES SURVEY STRUCTURE FORM

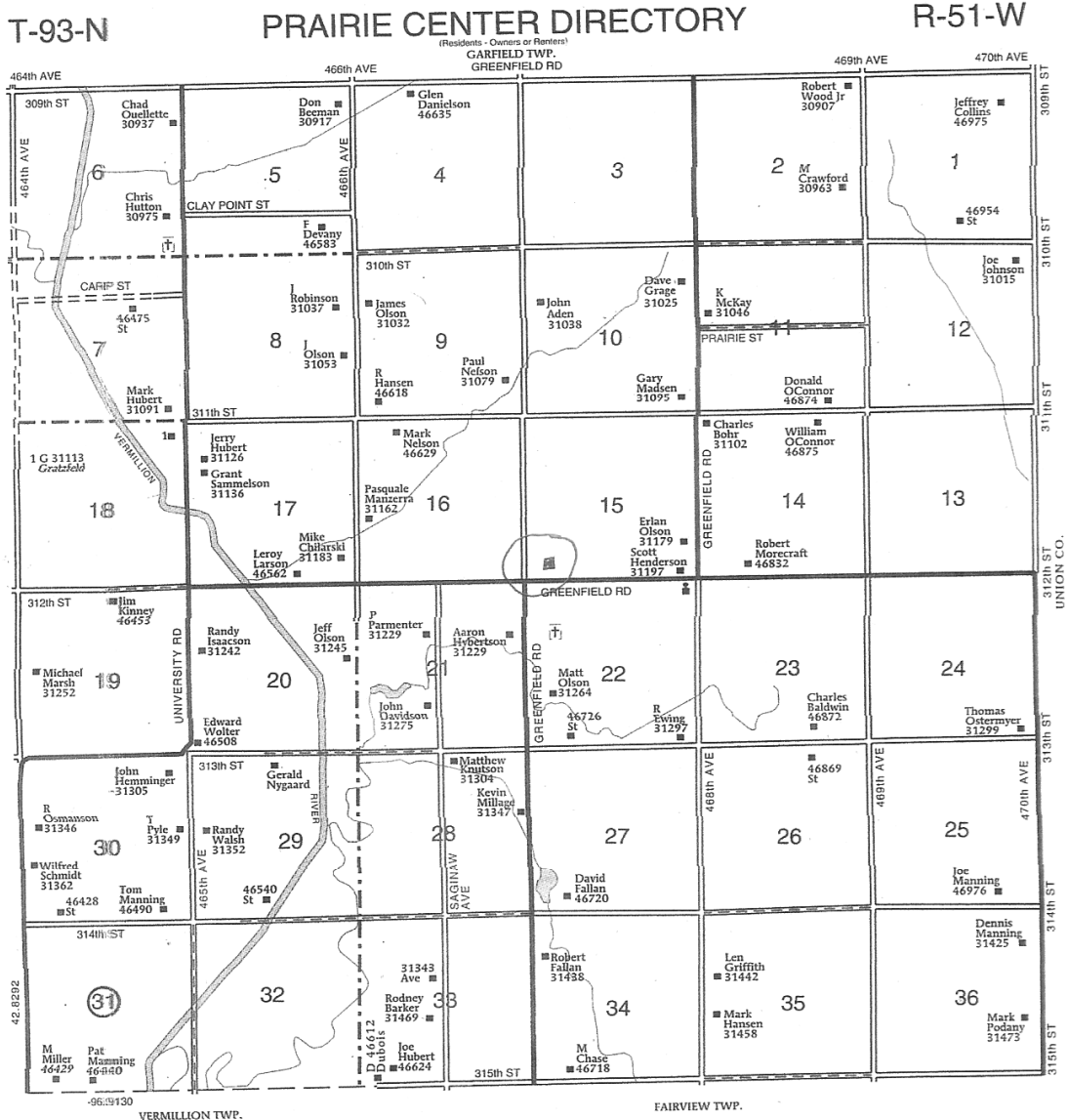

* = REQUIRED FIELD

History

This farm located in the SW ¼ of Section 15, Prairie Center Township, Clay County was homesteaded by Ole Johnson.

The 1894, 1901, 1912 and 1924 Clay County Atlas lists Ole. J. Opland as the owner.

The 1937 Clay County Atlas lists Hilma Opland and Ogla Hybertson as the owners and J. Hybertson as the operator (renter).

The 1948 and 1956 Clay County Atlas lists John Hybertson as the owner.

**SOUTH DAKOTA STATE HISTORIC PRESERVATION OFFICE
HISTORIC SITES SURVEY STRUCTURE FORM**

