

**SOUTH DAKOTA STATE HISTORIC PRESERVATION OFFICE
HISTORIC SITES SURVEY STRUCTURE FORM**



SITE INFORMATION

*SURVEY DATE: July 13, 2012 *ADDRESS: 45582 307th Street
*SURVEYOR: Jim Stone *COUNTY: Clay
*CITY: Volin

LOCATION DESCRIPTION: From intersection of South Dakota Highway 50 bi-pass and South Dakota Highway 19, North about 1/2 mile to Bluff Road, turn left (West), follow Bluff Road for 11-1/4 miles to 456th Street, turn right (North) 1-3/4 miles to 307th Street, turn left (West) about 1/4 mile, on the right (North) side.

LEGAL DESCRIPTION: Lots A, B, C, & D, SE 1/4, 22 - 94 - 53 Bethel Twp.

*QUARTER 1: SE 1/4
*QUARTER 2: _____
*TOWNSHIP: Bethel
*RANGE: 53
*SECTION: 22
ACRES: 47.59

OWNER NAME: Vitalis Gaidelis
OWNER ADDRESS: 45582 307th Street
OWNER CITY: Volin
OWNER STATE: South Dakota
OWNER ZIP: 57072
QUAD NAME: _____

OWNER CODE 1: P
OWNER CODE 2: F S L P
OWNER CODE 3: F S L P

HISTORIC SIGNIFICANCE

*DOE: _____
*DOE DATE: _____
REASON INELIGIBLE: _____

REGISTER NAME: _____
MULTIPLE PROPERTY NAME: _____

NOMINATION STATUS: _____
DATE LISTED: _____
REFERENCE NUMBER: _____
HISTORIC DISTRICT RATING: C or NC
PERIOD: _____

CATEGORY: _____
SIGNIFICANCE LEVEL 1: N S L
SIGNIFICANCE LEVEL 2: N S L
CRITERIA 1: A B C D
CRITERIA 2: A B C D
CRITERIA 3: A B C D
CRITERIA 4: A B C D

SIGNIFICANCE NOTES: _____

STRUCTURE DETAILS

* = REQUIRED FIELD

**SOUTH DAKOTA STATE HISTORIC PRESERVATION OFFICE
HISTORIC SITES SURVEY STRUCTURE FORM**



SHPO ID: _____
 *PROPERTY NAME: _____
 OTHER NAME: _____

CURRENT FUNCTION: Sheep and goats FOUNDATION: Poured concrete
Asphalt shingles,
cedar shingles
removed
 CURRENT SUBFUNCTION: Hay storage ROOF MATERIAL: _____
 HISTORIC FUNCTION: Cattle barn ROOF SHAPE: Gambrel
 HISTORIC SUBFUNCTION: Hay and grain storage STRUCTURAL SYSTEM: Balloon framing
 OCCUPIED: Yes STYLE: Gambrel roof barn
 Yes with TYPE: Livestock barn
 ACCESSIBLE: permission WALLS: 2x6, sheathing &
1/2"x6" cedar siding

STORIES: 2 SIGNIFICANT PERSON: Lewis & Julia Bervin
 *DATE OF CONSTRUCTION: 1918 CULTURAL AFFILIATION: Norwegian

ALTERED/MOVED NOTES: Original site. Cedar shingles removed, orientated strand board (OSB) installed over sheathing and asphalt shingles installed. Top of two metal cupola's missing (wind storm). Most of the pens have been removed.

INTERIOR NOTES: Had two rows 4x4 posts and 4x4 beams to support hayloft floor. Joists were 2x8. Had two metal ducts from the hayloft floor up to each of the three cupola's. Duct work has been removed, but the wire brackets that held the ducts in place between the rafters are still there.

OTHER NOTES: Windows were 8"x10" four light over 8"x10" four light, double hung for ventilation. 2x6 stud walls with diagonal sheathing and 1/2"x6" cedar siding on all four walls. 2x4 rafters with two 1x6 braces on each hip. A short 2x4 was at the hip, held in place with two short 1x6's, down to the two 1x6 braces. No rafter to wall bracing.

*PHYSICAL NOTES: Barn is in very good condition. Barn needs some maintance. Doors repaired, some windows replaced and some siding replaced. 1918 is embossed in the base of the center cupola.

* = REQUIRED FIELD

**SOUTH DAKOTA STATE HISTORIC PRESERVATION OFFICE
HISTORIC SITES SURVEY STRUCTURE FORM**



SKETCH MAP

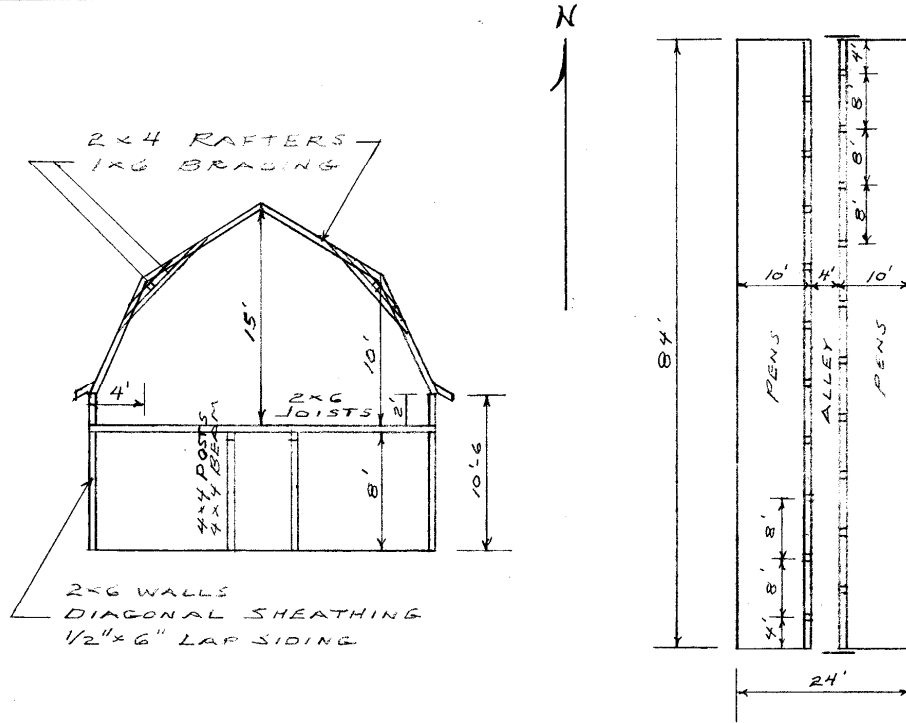

PHOTOGRAPHS

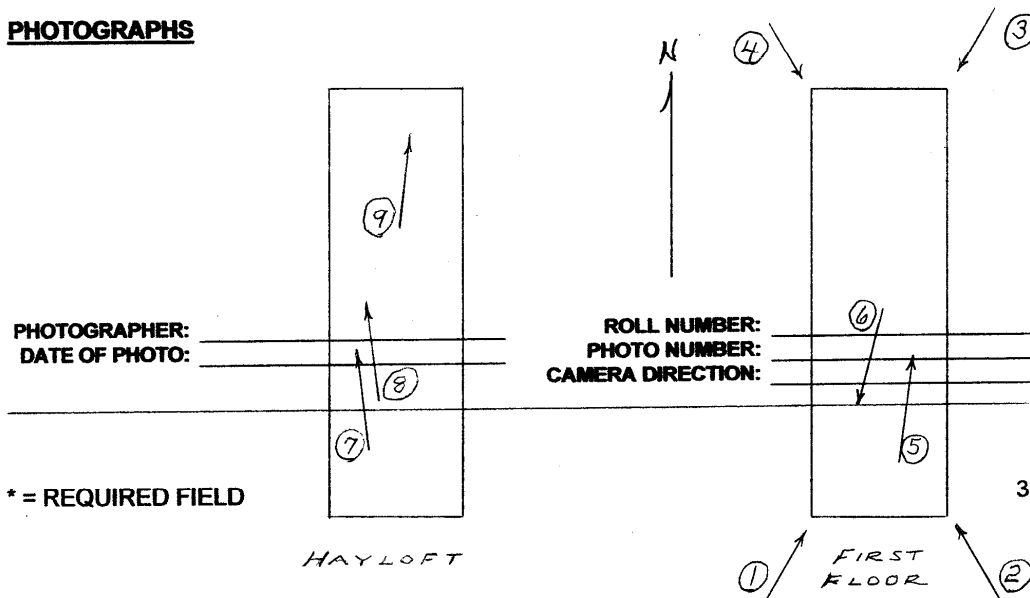

* = REQUIRED FIELD

**SOUTH DAKOTA STATE HISTORIC PRESERVATION OFFICE
HISTORIC SITES SURVEY STRUCTURE FORM**



PHOTOGRAPHER: Jim Stone
DATE OF PHOTO: July 13, 2012

ROLL NUMBER: _____
PHOTO NUMBER: 1
CAMERA DIRECTION: Looking NE, SW corner



PHOTOGRAPHER: Jim Stone
DATE OF PHOTO: July 13, 2012

ROLL NUMBER: _____
PHOTO NUMBER: 2
CAMERA DIRECTION: Looking SE, NW corner

* = REQUIRED FIELD

**SOUTH DAKOTA STATE HISTORIC PRESERVATION OFFICE
HISTORIC SITES SURVEY STRUCTURE FORM**



PHOTOGRAPHER: Jim Stone
DATE OF PHOTO: July 13, 2012

ROLL NUMBER: _____
PHOTO NUMBER: 3
CAMERA DIRECTION: Looking SW, NE corner



PHOTOGRAPHER: Jim Stone
DATE OF PHOTO: July 13, 2012

ROLL NUMBER: _____
PHOTO NUMBER: 4
CAMERA DIRECTION: Looking NE, SW corner

* = REQUIRED FIELD

**SOUTH DAKOTA STATE HISTORIC PRESERVATION OFFICE
HISTORIC SITES SURVEY STRUCTURE FORM**



PHOTOGRAPHER: Jim Stone
DATE OF PHOTO: July 13, 2012

ROLL NUMBER: 5
PHOTO NUMBER: 5

CAMERA DIRECTION: First floor, looking North,
4x4 posts, 4x4 beams &
2x6 floor joists



PHOTOGRAPHER: Jim Stone
DATE OF PHOTO: July 13, 2012

ROLL NUMBER: 6
PHOTO NUMBER: 6

CAMERA DIRECTION: First floor, looking SW,
stairs to hayloft SW
corner

**SOUTH DAKOTA STATE HISTORIC PRESERVATION OFFICE
HISTORIC SITES SURVEY STRUCTURE FORM**



PHOTOGRAPHER: Jim Stone
DATE OF PHOTO: July 13, 2012

ROLL NUMBER: _____
PHOTO NUMBER: 7

CAMERA DIRECTION: Hayloft, looking North,
lower rafter and hip
bracing



PHOTOGRAPHER: Jim Stone
DATE OF PHOTO: July 13, 2012

ROLL NUMBER: _____
PHOTO NUMBER: 8

CAMERA DIRECTION: Hayloft, looking North,
rafter bracing at the hip

**SOUTH DAKOTA STATE HISTORIC PRESERVATION OFFICE
HISTORIC SITES SURVEY STRUCTURE FORM**



PHOTOGRAPHER: Jim Stone
DATE OF PHOTO: July 13, 2012

ROLL NUMBER: _____
PHOTO NUMBER: 9

CAMERA DIRECTION: Hayloft, looking North
rafter bracing, diagonal
sheathing on gable end

**SOUTH DAKOTA STATE HISTORIC PRESERVATION OFFICE
HISTORIC SITES SURVEY STRUCTURE FORM**



T-94-N

BETHEL DIRECTORY
(Residents - Owners or Renters)

R-53-W

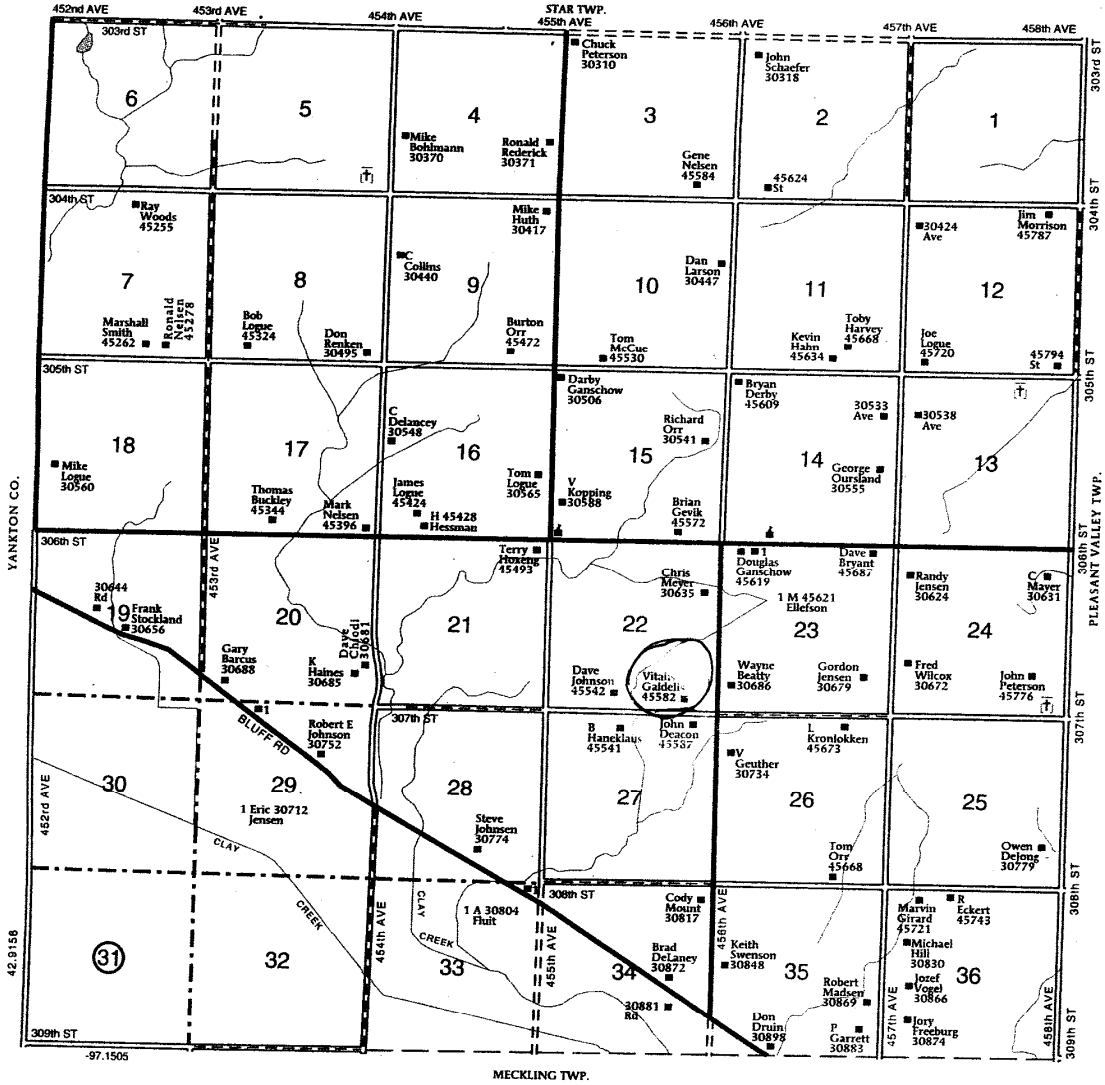

* = REQUIRED FIELD

HISTORY

This farm located in the SE ¼ of Section 23, Bethel Township, Clay County was homestead by Hans Jacobson.

The 1894 and 1901 Clay County Atlas lists Hans Jacobson as the owner.

The 1912 Clay County Atlas lists Mrs. Hans Jacobson as the owner.

The 1924, 1937, 1948 and 1956 Clay County Atlas lists Willaim Jacobson as the owner. The 1924 Clay County Atlas lists the farm as “The Homestead Farm”.

The Following Is From

Wakonda, S. D. Centennial Book 1885 - 1985

Lewis and Julia Bervin were born in Handanger, Norway. Julia was born on July 15, 1838 and Lewis was born on Dec. 21, 1838. They immigrated to the United States after the Civil War, coming to their respective relatives in Illinois. They were married Nov. 24, 1870 in Yankton and homesteaded seven miles southeast of Wakonda in what was then Dakota Territory. A sod hut was their home, while their house was being built. They had two children, Ole, born Nov. 26, 1873 and Ellen, Born July 25, 1879. The children were at the Bethel School during the famous blizzard of 1888, but their teacher wisely kept all of the children in the schoolhouse overnight. Lewis walked to the school the next morning fearing that every uneven spot in the snow would be his children, frozen in the storm.

As members of the Pleasant Valley Lutheran Church they often had the minister staying with them, as he was a circuit-rider, who came occasionally to marry, baptize and perform funerals. As pioneers they coped with prairie fires, grasshopper plagues and floods on the bottomland. Lewis was a county commissioner.

Ole was educated at Lutheran Normal School, now Augustana and farmed the homestead. He was married to Martina Knutson, daughter of K. A. Knutson of Centerville, South Dakota, on June 29, 1910. He told of observing Halley’s comet when he was coming home by horse and buggy from visiting Martina before the wedding. Ole and Martina had four children, Grace Pickles who passed away at the age of 22, Louise Hagedon, Rock Rapids, Iowa, Helen Sorensen, Sioux Falls, So. Dak. and Leland, Glendale, Ariz.

**SOUTH DAKOTA STATE HISTORIC PRESERVATION OFFICE
HISTORIC SITES SURVEY STRUCTURE FORM**



Ellen was educated at Lutheran Normal School and Redwing Lutheran Ladies Academy and married Andrew Larson of Spink, So. Dak., in Union County. They had two children, Julia Hintz, Sacramento, Calif. and Norman, Elsinore, Calif.

Before Julia passed away in July, 1936, she was the oldest living person in Clay County, So. Dak.

Ole Bervin son of Lewis and Julia Bervin had this barn built in 1918. Ole Bervin was raising purebred cattle at this time and selling breeding stock, which was the reason for this barn. I don't know the breed of cattle. The date is embossed on the base of center cupola on the barn. A large swine farrowing barn was built west of this barn. It burned down several years ago. Ole and his father raised and fed a lot of cattle and hogs.

**SOUTH DAKOTA STATE HISTORIC PRESERVATION OFFICE
HISTORIC SITES SURVEY STRUCTURE FORM**

