

**SOUTH DAKOTA STATE HISTORIC PRESERVATION OFFICE  
HISTORIC SITES SURVEY STRUCTURE FORM**



**SITE INFORMATION**

\*SURVEY DATE: November 17, 2012 \*ADDRESS: 46142 308<sup>th</sup> Street  
\*SURVEYOR: Jim Stone \*COUNTY: Clay  
\*CITY: Wakonda

LOCATION DESCRIPTION: From the intersection of South Dakota Highway 50 bi-pass and South Dakota Highway 19, North 9 miles to 308th Street, turn left (West) 1-1/4 miles on the right (North) side.

LEGAL DESCRIPTION: SW 1/4, 27 - 94 - 52 Pleasant Valley Twp.

\*QUARTER 1: SW 1/4 OWNER NAME: Duane A. & Michelle D. Johnson  
\*QUARTER 2: \_\_\_\_\_ OWNER ADDRESS: 307 Sycamore  
\*TOWNSHIP: Pleasant Valley OWNER CITY: Vermillion  
\*RANGE: 52 OWNER STATE: South Dakota  
\*SECTION: 27 OWNER ZIP: 57069  
ACRES: 150.82 QUAD NAME: \_\_\_\_\_  
OWNER CODE 1: P  
OWNER CODE 2: \_\_\_\_\_  
OWNER CODE 3: \_\_\_\_\_

**HISTORIC SIGNIFICANCE**

\*DOE: \_\_\_\_\_ REGISTER NAME: \_\_\_\_\_  
\*DOE DATE: \_\_\_\_\_ MULTIPLE PROPERTY NAME: \_\_\_\_\_  
REASON INELIGIBLE: \_\_\_\_\_

NOMINATION STATUS: \_\_\_\_\_ CATEGORY: \_\_\_\_\_  
DATE LISTED: \_\_\_\_\_ SIGNIFICANCE LEVEL 1: N S L  
REFERENCE NUMBER: \_\_\_\_\_ SIGNIFICANCE LEVEL 2: N S L  
HISTORIC DISTRICT RATING: C or NC CRITERIA 1: A B C D  
PERIOD: \_\_\_\_\_ CRITERIA 2: A B C D  
CRITERIA 3: A B C D  
CRITERIA 4: A B C D

SIGNIFICANCE NOTES: \_\_\_\_\_  
\_\_\_\_\_  
\_\_\_\_\_

**STRUCTURE DETAILS**

\* = REQUIRED FIELD

**SOUTH DAKOTA STATE HISTORIC PRESERVATION OFFICE  
HISTORIC SITES SURVEY STRUCTURE FORM**



SHPO ID: \_\_\_\_\_

\*PROPERTY NAME: \_\_\_\_\_

OTHER NAME: \_\_\_\_\_

<p>CURRENT FUNCTION: <u>Cattle and calving barn</u></p> <p>CURRENT SUBFUNCTION: <u>Storage</u></p> <p>HISTORIC FUNCTION: <u>Livestock barn</u></p> <p>HISTORIC SUBFUNCTION: <u>Hay storage</u></p> <p>OCCUPIED: <u>Yes</u></p> <p>ACCESSIBLE: <u>Yes with permission</u></p> <p>STORIES: <u>2</u></p> <p>*DATE OF CONSTRUCTION: <u>1910 to 1920</u></p>	<p>FOUNDATION: <u>Poured concrete foundation</u></p> <p>ROOF MATERIAL: <u>Steel roofing over cedar shingles</u></p> <p>ROOF SHAPE: <u>Gambrel</u></p> <p>STRUCTURAL SYSTEM: <u>Balloon framing</u></p> <p>STYLE: <u>Gambrel roof barn</u></p> <p>TYPE: <u>Livestock barn</u></p> <p>WALLS: <u>2x6 studs &amp; 2x8 studs with sheathing and 1/2"x6" cedar drop siding</u></p> <p>SIGNIFICANT PERSON: <u>O. A. Abild</u></p> <p>CULTURAL AFFILIATION: <u>1/2 Danish &amp; 1/2 Norwegian</u></p>
---	---

ALTERED/MOVED NOTES: Original site. Most evidence of milk cow stanchions or horse stalls has been removed. Roof has been covered with steel roofing.

INTERIOR NOTES: Has two rows of 6x6 posts with 6x8 for a beam. Floor joists are 2x8's. Solid 2x6 wall divides East 12' from the West 24'. Horse stalls were on the West side. 12'x12' granary in the SE corner. 4x6 posts 12' O.C. in hayloft to support hip. 4x6 rafter behind each post, with (2) 2x10 bracing from the bottom of the center rafter down to the bottom of the 4x6 post. Only the center rafter and post have this (2) 2x10 bracing.

OTHER NOTES: 2x6 stud walls on the East and West with horizontal sheathing, 2x8 stud walls with diagonal sheathing on the North and South and 1/2"x6" cedar lap siding. Rafters are 2x6's. 6 x 8 beams supporting floor joists have a special scarf joint. Windows are 8"x10" four light over 8"x10" four light. Has two very ornate metal cupola's.

\*PHYSICAL NOTES: Barn is in good condition. Very straight and plumb because of 2x8 stud walls on gable ends and the diagonal sheathing. Needs some repairs on doors and windows.

\*UTM ZONE: \_\_\_\_\_

\*RESTRICTED: Y or N

\*UTM EASTING: \_\_\_\_\_

\*UTM NORTHING: \_\_\_\_\_

\* = REQUIRED FIELD



**SOUTH DAKOTA STATE HISTORIC PRESERVATION OFFICE  
HISTORIC SITES SURVEY STRUCTURE FORM**



**PHOTOGRAPHER:** Jim Stone  
**DATE OF PHOTO:** November 17, 2012

**ROLL NUMBER:** \_\_\_\_\_  
**PHOTO NUMBER:** 1  
**CAMERA DIRECTION:** Looking NE, SW corner



**PHOTOGRAPHER:** Jim Stone  
**DATE OF PHOTO:** November 17, 2012

**ROLL NUMBER:** \_\_\_\_\_  
**PHOTO NUMBER:** 2  
**CAMERA DIRECTION:** Looking NW, SE corner

\* = REQUIRED FIELD

**SOUTH DAKOTA STATE HISTORIC PRESERVATION OFFICE  
HISTORIC SITES SURVEY STRUCTURE FORM**



**PHOTOGRAPHER:** Jim Stone  
**DATE OF PHOTO:** November 17, 2012

**ROLL NUMBER:** \_\_\_\_\_  
**PHOTO NUMBER:** 3  
**CAMERA DIRECTION:** Looking SW, NE corner



**PHOTOGRAPHER:** Jim Stone  
**DATE OF PHOTO:** November 17, 2012

**ROLL NUMBER:** \_\_\_\_\_  
**PHOTO NUMBER:** 4  
**CAMERA DIRECTION:** First floor, looking South, 6x6 posts, 6x8 beam and 2x10 floor joists

\* = REQUIRED FIELD

**SOUTH DAKOTA STATE HISTORIC PRESERVATION OFFICE  
HISTORIC SITES SURVEY STRUCTURE FORM**



**PHOTOGRAPHER:** Jim Stone  
**DATE OF PHOTO:** November 17, 2012

**ROLL NUMBER:** \_\_\_\_\_  
**PHOTO NUMBER:** 5

**CAMERA DIRECTION:** First floor, looking North,  
2x6 solid wall dividing  
East 12' from rest of barn



**PHOTOGRAPHER:** Jim Stone  
**DATE OF PHOTO:** November 17, 2012

**ROLL NUMBER:** \_\_\_\_\_  
**PHOTO NUMBER:** 6

**CAMERA DIRECTION:** Hayloft, looking North,  
4x6 posts & 6x6 beam  
supporting hip

\* = REQUIRED FIELD

**SOUTH DAKOTA STATE HISTORIC PRESERVATION OFFICE  
HISTORIC SITES SURVEY STRUCTURE FORM**



**PHOTOGRAPHER:** Jim Stone  
**DATE OF PHOTO:** November 17, 2012

**ROLL NUMBER:** \_\_\_\_\_  
**PHOTO NUMBER:** 7

**CAMERA DIRECTION:** Hayloft, looking North,  
4x6 posts 6x6 beam & (2)  
1x6 bracing on hip



**PHOTOGRAPHER:** Jim Stone  
**DATE OF PHOTO:** November 17, 2012

**ROLL NUMBER:** \_\_\_\_\_  
**PHOTO NUMBER:** 8

**CAMERA DIRECTION:** Hayloft, looking North,  
North gable end,  
2x8studwall with  
diagonal sheathing

\* = REQUIRED FIELD

**SOUTH DAKOTA STATE HISTORIC PRESERVATION OFFICE  
HISTORIC SITES SURVEY STRUCTURE FORM**



**T-94-N PLEASANT VALLEY DIRECTORY R-52-W**

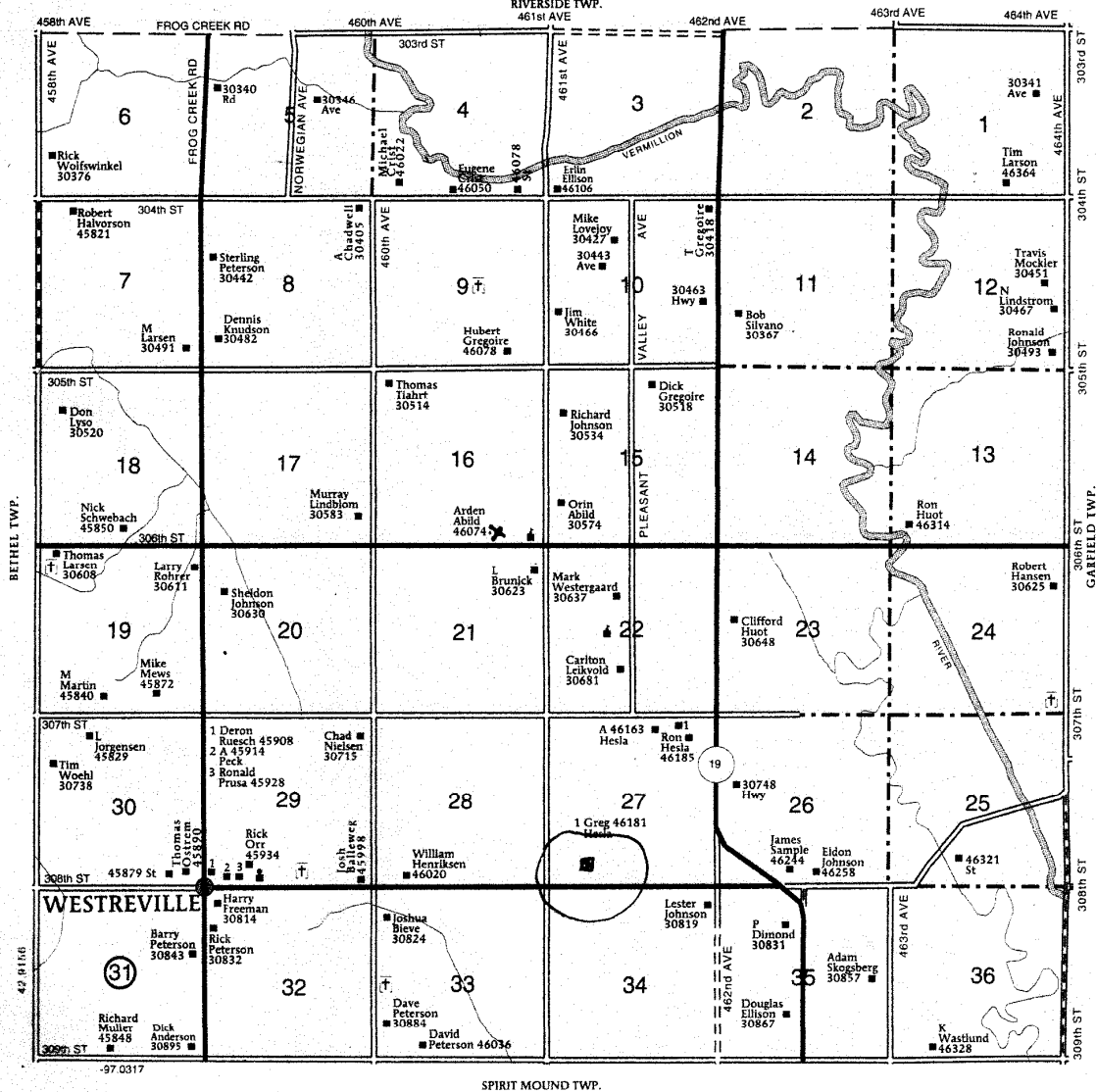



## **HISTORY**

This farm located in the SW ¼ of Section 27, Pleasant Valley township, Clay County was homesteaded by Ole Jacob Morvedt.

The 1894 and 1901 Clay County Atlas lists Lee & Prentis as the owners.

The 1912 and 1924 Clay County Atlas lists O. A. Abild as the owner.

The 1937 Clay County Atlas lists P. J. Bowman as the owner and E. Lindblom as the operator (renter).

The 1948 Clay County Atlas lists J. E. Bowman as the owner.

The 1956 Clay County Atlas lists F. E. Bowman as the owner.

**The Following Information furnished by  
Clay County Historical Society records**

Lee & Prentis are listed as the owners in the 1901 Clay County Atlas. They had a large general merchandise store in Vermillion. They extended credit to local farmers and then during the 1890's had to re-possess several farms.

The 1912 and 1924 Clay County Atlas's lists O. A. Abild as the owner. This barn would have been built about this time.

**SOUTH DAKOTA STATE HISTORIC PRESERVATION OFFICE  
HISTORIC SITES SURVEY STRUCTURE FORM**

