

**SOUTH DAKOTA STATE HISTORIC PRESERVATION OFFICE
HISTORIC SITES SURVEY STRUCTURE FORM**



SITE INFORMATION

*SURVEY DATE: July 23, 2012 *ADDRESS: 45774 314th Street
*SURVEYOR: Jim Stone *COUNTY: Clay
*CITY: Meckling

LOCATION DESCRIPTION: The intersection of South Dakota Highway 50 bi-pass and South Dakota Highway 19, West 3-3/4 miles to 458th Ave., turn right (North) about 1/2 mile to 314th Street, turn left (West) about 1/4 mile on the right (North) side.

LEGAL DESCRIPTION: SE 1/4 25 - 93 - 53 Meckling Twp.

*QUARTER 1: SE 1/4
*QUARTER 2: _____
*TOWNSHIP: Meckling
*RANGE: 53
*SECTION: 25
ACRES: 163.16

OWNER NAME: D. A. Olson & Sons LLC
OWNER ADDRESS: 31729 455th Street
OWNER CITY: Meckling
OWNER STATE: South Dakota
OWNER ZIP: 57069
QUAD NAME: _____

OWNER CODE 1: P
OWNER CODE 2: _____
OWNER CODE 3: _____

HISTORIC SIGNIFICANCE

*DOE: _____
*DOE DATE: _____
REASON INELIGIBLE: _____

REGISTER NAME: _____
MULTIPLE PROPERTY NAME: _____

NOMINATION STATUS: _____
DATE LISTED: _____
REFERENCE NUMBER: _____
HISTORIC DISTRICT RATING: C or NC
PERIOD: _____

CATEGORY: _____
SIGNIFICANCE LEVEL 1: N S L
SIGNIFICANCE LEVEL 2: N S L
CRITERIA 1: A B C D
CRITERIA 2: A B C D
CRITERIA 3: A B C D
CRITERIA 4: A B C D

SIGNIFICANCE NOTES: _____

STRUCTURE DETAILS

* = REQUIRED FIELD

**SOUTH DAKOTA STATE HISTORIC PRESERVATION OFFICE
HISTORIC SITES SURVEY STRUCTURE FORM**



SHPO ID: _____
 *PROPERTY NAME: _____
 OTHER NAME: _____

CURRENT FUNCTION:	<u>Farm machinery and hay storage</u>	FOUNDATION:	<u>Poured concrete</u>
CURRENT SUBFUNCTION:	<u>Hay storage</u>	ROOF MATERIAL:	<u>Steel roofing over cedar shingles</u>
HISTORIC FUNCTION:	<u>Cattle feeder barn</u>	ROOF SHAPE:	<u>Gable</u>
HISTORIC SUBFUNCTION:	<u>Hay storage</u>	STRUCTURAL SYSTEM:	<u>Balloon framing Livestock feeder barn</u>
OCCUPIED:	<u>Yes</u>	STYLE:	<u>barn</u>
ACCESSIBLE:	<u>Yes with permission</u>	TYPE:	<u>Cattle feeder barn</u>
		WALLS:	<u>2x6, 1x12 vertical siding, steel</u>
STORIES:	<u>2</u>	SIGNIFICANT PERSON:	<u>(Nielson) Nelson</u>
*DATE OF CONSTRUCTION:	<u>1910 to 1920</u>	CULTURAL AFFILIATION:	<u>Danish</u>

ALTERED/MOVED NOTES: Original site. Appears to have a new poured concrete foundation and a new concrete floor. Walls and roof have been covered with steel roofing. Doors and windows covered with steel roofing. Four windows have been replaced aluminum combination windows. Two 12'x8' and one 18'x14' overhead doors have been installed on the South wall

INTERIOR NOTES: Has two 2x6 walls 24' high and 24' between to support the center of the rafters. The 24' high walls have 2x6 studs 4' O.C. 2x8 joists 4' O.C. above the East 13' for a hayloft and 2x8 joists 2' O.C. on the West 13' for a hayloft and grain storage. The 24' high walls have 4' of boards at the bottom and are open to the roof, except two rows of 2x6 horizontal bracing.

OTHER NOTES: Windows were 9"x12" four light, two windows close together with 4' to 6' between all along on the East and West walls. The exterior walls are 2x6, 4' O.C. with horizontal 2x4 nailers 3' O.C. for the 1x12 vertical siding.

*PHYSICAL NOTES: Barn is in good condition. This barn with the ground to peak center hayloft and The two side haylofts could hold over 150 tons of loose hay.

*UTM ZONE: _____ *RESTRICTED: Y or N
 *UTM EASTING: _____
 *UTM NORTHING: _____

* = REQUIRED FIELD

**SOUTH DAKOTA STATE HISTORIC PRESERVATION OFFICE
HISTORIC SITES SURVEY STRUCTURE FORM**



SKETCH MAP

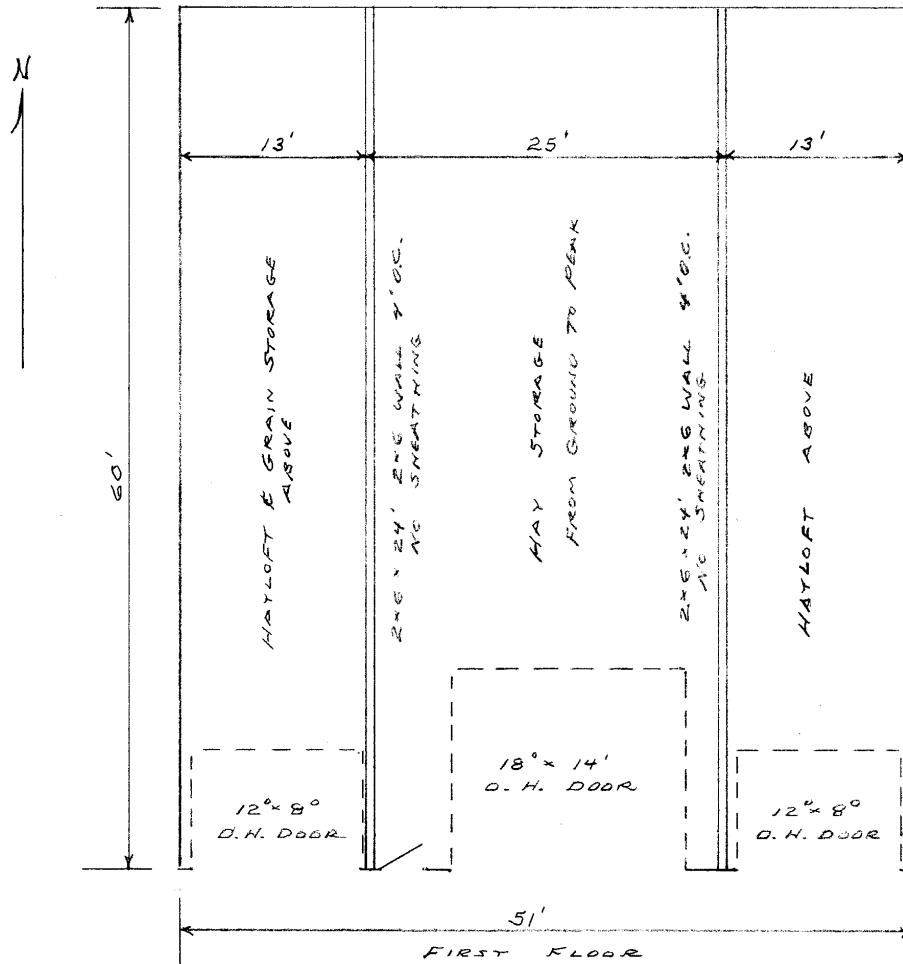

PHOTOGR

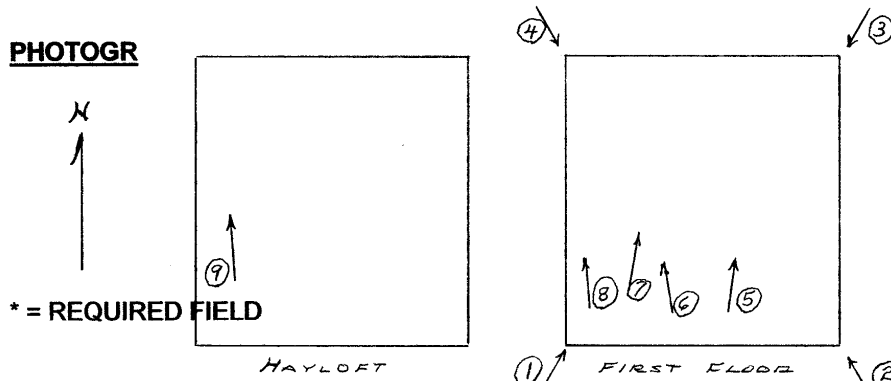

* = REQUIRED FIELD

**SOUTH DAKOTA STATE HISTORIC PRESERVATION OFFICE
HISTORIC SITES SURVEY STRUCTURE FORM**

SKETCH MAP

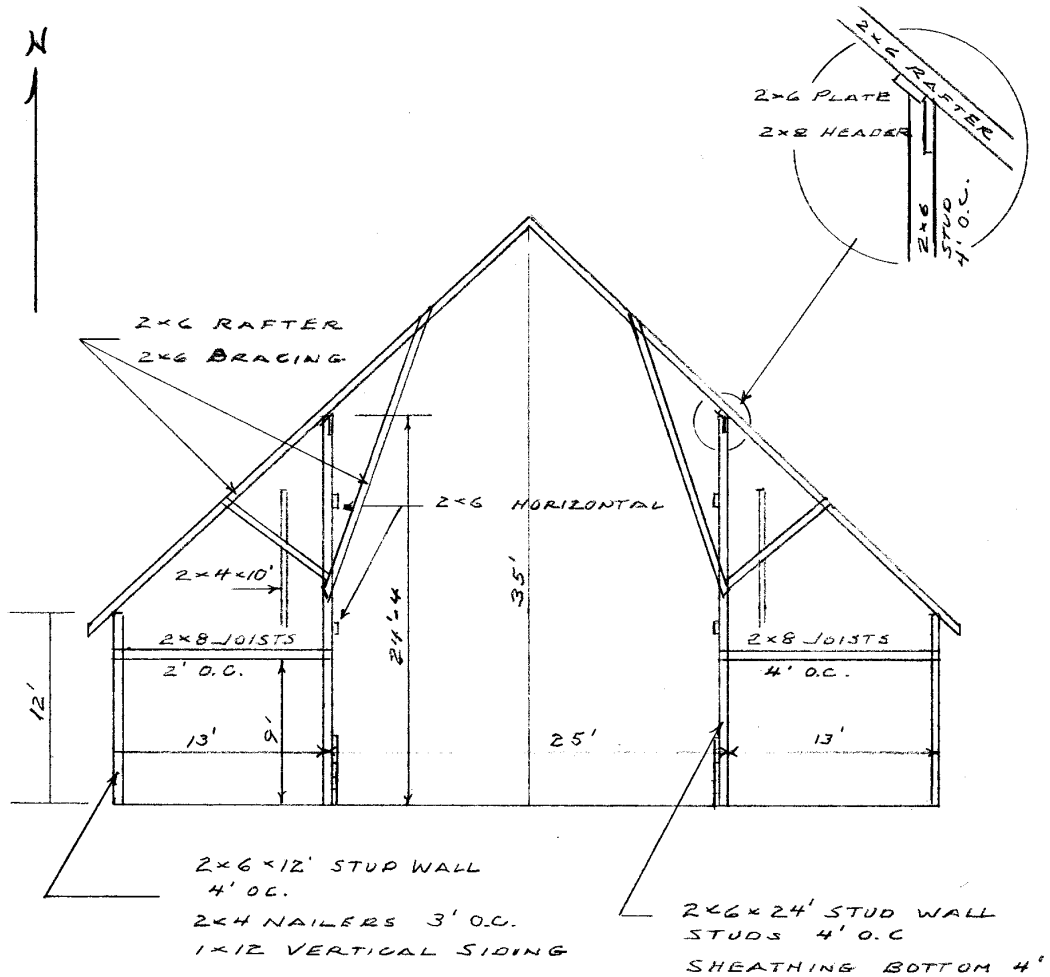

PHOTOGR

* = REQUIRED FIELD

* = REQUIRED FIELD

**SOUTH DAKOTA STATE HISTORIC PRESERVATION OFFICE
HISTORIC SITES SURVEY STRUCTURE FORM**



PHOTOGRAPHER: Jim Stone
DATE OF PHOTO: July 23, 2012

ROLL NUMBER: _____
PHOTO NUMBER: 1
CAMERA DIRECTION: Looking NE, SW corner



PHOTOGRAPHER: Jim Stone
DATE OF PHOTO: July 23, 2012

ROLL NUMBER: _____
PHOTO NUMBER: 2
CAMERA DIRECTION: Looking NW, SE corner

* = REQUIRED FIELD

**SOUTH DAKOTA STATE HISTORIC PRESERVATION OFFICE
HISTORIC SITES SURVEY STRUCTURE FORM**



PHOTOGRAPHER: Jim Stone
DATE OF PHOTO: July 23, 2012

ROLL NUMBER: 3
PHOTO NUMBER: 3
CAMERA DIRECTION: Looking SW, NE corner



PHOTOGRAPHER: Jim Stone
DATE OF PHOTO: July 23, 2012

ROLL NUMBER: 4
PHOTO NUMBER: 4
CAMERA DIRECTION: Looking SE, NW corner

* = REQUIRED FIELD

**SOUTH DAKOTA STATE HISTORIC PRESERVATION OFFICE
HISTORIC SITES SURVEY STRUCTURE FORM**



PHOTOGRAPHER: Jim Stone
DATE OF PHOTO: July 23, 2012

ROLL NUMBER: 5
PHOTO NUMBER: 5

**First floor, looking North,
2x6 wall x 24' high,
supports rafters, East
side**

CAMERA DIRECTION: side



PHOTOGRAPHER: Jim Stone
DATE OF PHOTO: July 23, 2012

ROLL NUMBER: 6
PHOTO NUMBER: 6

**First floor, 2x6 wall 24'
high supporting rafters,
West side**

CAMERA DIRECTION: West side

**SOUTH DAKOTA STATE HISTORIC PRESERVATION OFFICE
HISTORIC SITES SURVEY STRUCTURE FORM**



PHOTOGRAPHER: Jim Stone
DATE OF PHOTO: July 23, 2012

ROLL NUMBER: _____
PHOTO NUMBER: 7

CAMERA DIRECTION: First floor, looking North,
wall bracing to the
hayloft floor, West side



PHOTOGRAPHER: Jim Stone
DATE OF PHOTO: July 23, 2012

ROLL NUMBER: _____
PHOTO NUMBER: 8

CAMERA DIRECTION: First floor, looking North
grain chutes from the
hayloft.

**SOUTH DAKOTA STATE HISTORIC PRESERVATION OFFICE
HISTORIC SITES SURVEY STRUCTURE FORM**



PHOTOGRAPHER: Jim Stone
DATE OF PHOTO: July 23, 2012

ROLL NUMBER: _____
PHOTO NUMBER: 9

CAMERA DIRECTION: Hayloft, West side,
looking North, hay or
grain storage and wall
bracing

SOUTH DAKOTA STATE HISTORIC PRESERVATION OFFICE
 HISTORIC SITES SURVEY STRUCTURE FORM

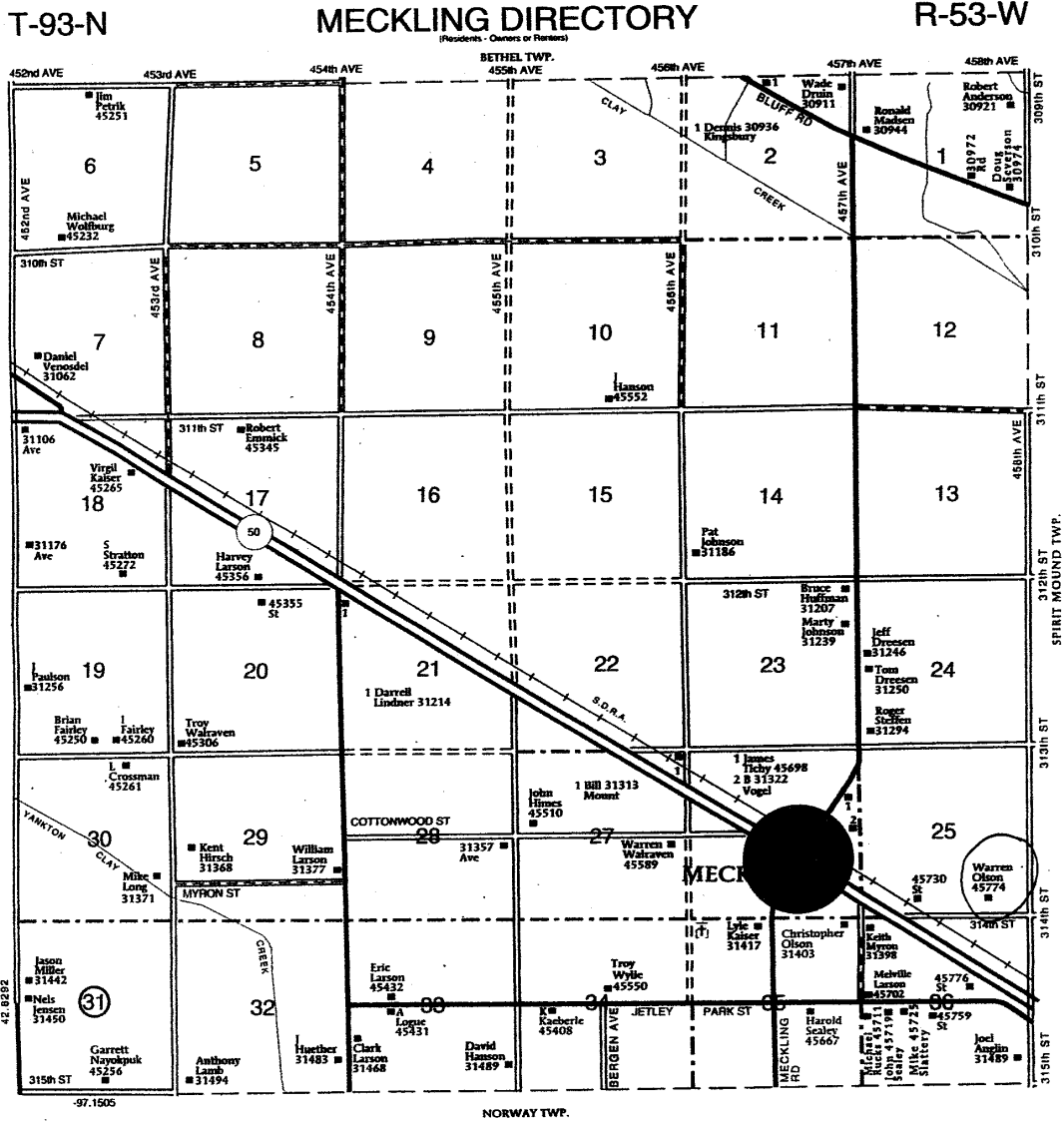

* = REQUIRED FIELD

HISTORY

This farm located in the SE ¼ of Section 25, Meckling Township, Clay County was homesteaded by Joseph Hayes.

The 1894 Clay County Atlas lists H. Robinson as the owner.

The 1901 Clay County Atlas lists William E. Doyle as the owner.

The 1912 Clay County Atlas lists Thomas J. Steele as the owner.

The 1924 and 1937 Clay County Atlas lists Ella Steele as the owner. The 1937 lists Martin Knutson as the operator (renter).

The 1948 and 1956 Clay County Atlas lists J. A. Doyle as the owner.