

**SOUTH DAKOTA STATE HISTORIC PRESERVATION OFFICE**  
**HISTORIC SITES SURVEY STRUCTURE FORM**



**SITE INFORMATION**

\*SURVEY DATE: July 30, 2013  
\*SURVEYOR: Jim Stone

\*ADDRESS: 30635 456<sup>th</sup> Ave.  
\*COUNTY: Clay  
\*CITY: Volin

LOCATION DESCRIPTION: From Vermillion, intersection of South Dakota Highway 50 bi-pass and South Dakota Highway 19, North about 11 miles to 306<sup>th</sup> Street, turn left (West) about 6 miles to 456<sup>th</sup> Ave., turn left, (South) about ¼ mile, on the right (West) side.

LEGAL DESCRIPTION: N 704' of S 1,200' of E 898', NE 1/4, 22 - 94 - 53 Bethel Twp.

\*QUARTER 1: NE 1/4  
\*QUARTER 2: \_\_\_\_\_  
\*TOWNSHIP: Bethel  
\*RANGE: 53  
\*SECTION: 22  
ACRES: 13.68

OWNER NAME: Krishna K. Mastel & Christopher A Meyer  
OWNER ADDRESS: 30635 456<sup>th</sup> Ave.  
OWNER CITY: Volin  
OWNER STATE: South Dakota  
OWNER ZIP: 57072  
QUAD NAME: \_\_\_\_\_

OWNER CODE 1: P  
OWNER CODE 2: \_\_\_\_\_  
OWNER CODE 3: \_\_\_\_\_

**HISTORIC SIGNIFICANCE**

\*DOE: \_\_\_\_\_  
\*DOE DATE: \_\_\_\_\_  
REASON INELIGIBLE: \_\_\_\_\_

REGISTER NAME: \_\_\_\_\_  
MULTIPLE PROPERTY NAME: \_\_\_\_\_

NOMINATION STATUS: \_\_\_\_\_  
DATE LISTED: \_\_\_\_\_  
REFERENCE NUMBER: \_\_\_\_\_  
HISTORIC DISTRICT RATING: C or NC  
PERIOD: \_\_\_\_\_

CATEGORY: \_\_\_\_\_  
SIGNIFICANCE LEVEL 1: N S L  
SIGNIFICANCE LEVEL 2: N S L  
CRITERIA 1: A B C D  
CRITERIA 2: A B C D  
CRITERIA 3: A B C D  
CRITERIA 4: A B C D

SIGNIFICANCE NOTES: \_\_\_\_\_  
\_\_\_\_\_  
\_\_\_\_\_  
\_\_\_\_\_

**STRUCTURE DETAILS**

\* = REQUIRED FIELD

**SOUTH DAKOTA STATE HISTORIC PRESERVATION OFFICE**  
**HISTORIC SITES SURVEY STRUCTURE FORM**



SHPO ID: \_\_\_\_\_

\*PROPERTY NAME: \_\_\_\_\_

OTHER NAME: \_\_\_\_\_

CURRENT FUNCTION: <u>Vacant</u>	FOUNDATION: <u>Poured concrete</u>
CURRENT SUBFUNCTION: <u>Storage</u>	ROOF MATERIAL: <u>Steel roofing over cedar shingles</u>
HISTORIC FUNCTION: <u>Livestock barn</u>	ROOF SHAPE: <u>Gambrel roof</u>
HISTORIC SUBFUNCTION: <u>Hay and grain storage</u>	STRUCTURAL SYSTEM: <u>Balloon framing</u>
	STYLE: <u>Gambrel roof barn</u>
OCCUPIED: <u>No</u>	TYPE: <u>Swine farrowing barn</u>
	<u>2x4 studs, 1x8 sheathing and 1/2"x6" cedar lap siding.</u>
ACCESSIBLE: <u>Yes with permission</u>	WALLS: _____
STORIES: <u>2</u>	SIGNIFICANT PERSON: <u>Nels C. &amp; Hans M. Nelson</u>
*DATE OF CONSTRUCTION: <u>1920's's</u>	CULTURAL AFFILIATION: <u>Danish</u>

ALTERED/MOVED NOTES: Original site. Roof covered with steel roofing over cedar shingles.  
Some of the farrowing pens have been removed.

INTERIOR NOTES: Two rows of 4x4 posts with (2) 2x6 beams support 2x6 joists for hayloft floor. Most of  
The farrowing pens are still place.

OTHER NOTES: 2x4 stud walls, 1x8 sheathing and 1/2"x"x 6" cedar lap siding on all four exterior walls.  
Rafters are 2x4's with a 2x6 brace at the roof hip. Windows are 8" x10"four light over 8"x10" for double  
hung for ventilation.

\*PHYSICAL  
NOTES:

Barn is in good condition.

\*RESTRICTED: Y or N

\*UTM EASTING: \_\_\_\_\_

\*UTM NORTHING: \_\_\_\_\_

**SOUTH DAKOTA STATE HISTORIC PRESERVATION OFFICE**  
**HISTORIC SITES SURVEY STRUCTURE FORM**

**SKETCH MAP**

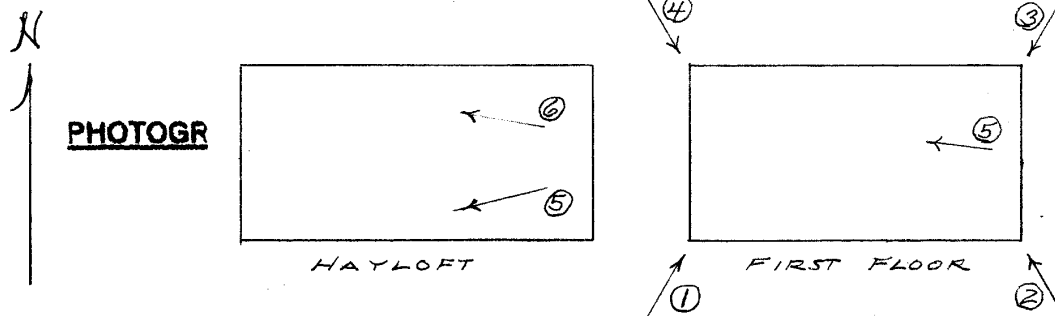
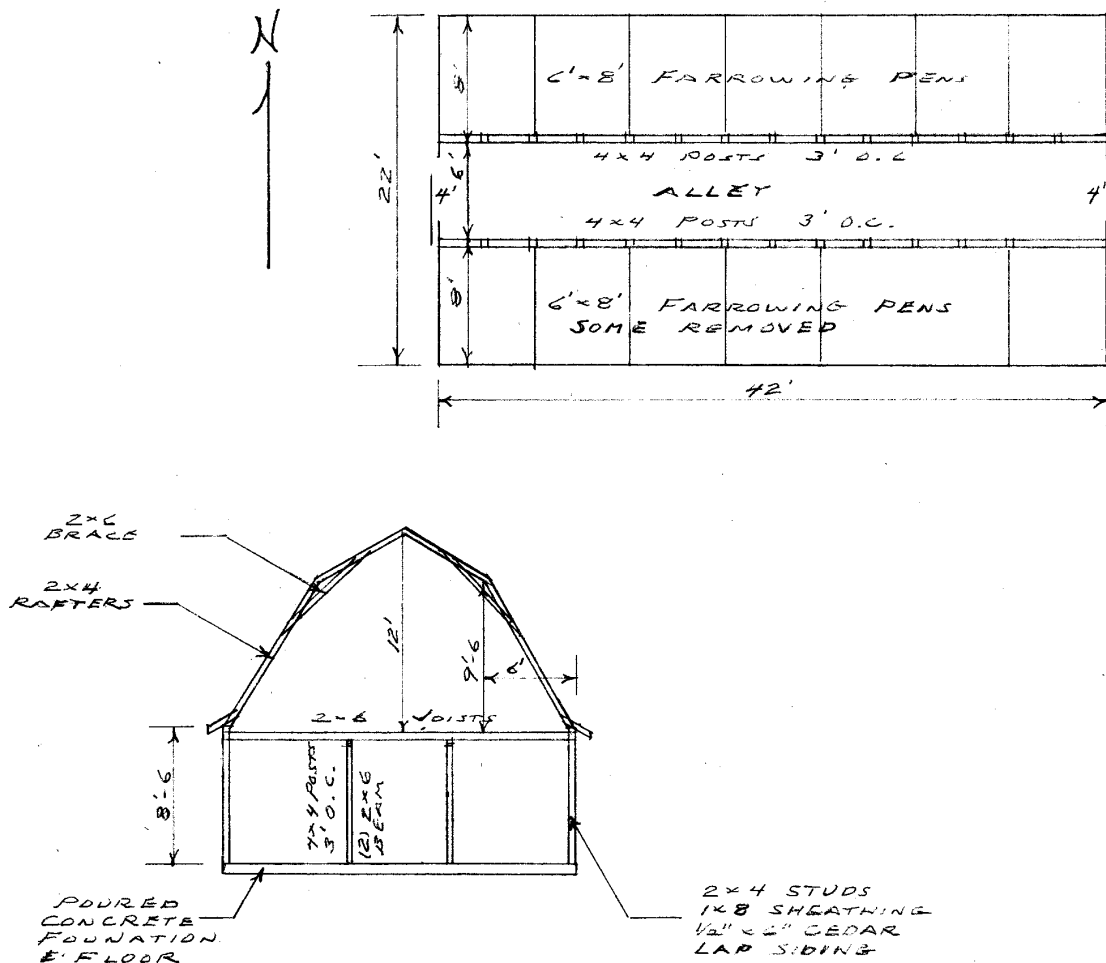

**SOUTH DAKOTA STATE HISTORIC PRESERVATION OFFICE  
HISTORIC SITES SURVEY STRUCTURE FORM**



PHOTOGRAPHER: Jim Stone  
DATE OF PHOTO: July 30, 2013

ROLL NUMBER: \_\_\_\_\_  
PHOTO NUMBER: 1  
CAMERA DIRECTION: Looking NE, SW corner

**SOUTH DAKOTA STATE HISTORIC PRESERVATION OFFICE**  
**HISTORIC SITES SURVEY STRUCTURE FORM**



PHOTOGRAPHER: Jim Stone  
DATE OF PHOTO: July 30, 2013

ROLL NUMBER: \_\_\_\_\_  
PHOTO NUMBER: 2  
CAMERA DIRECTION: Looking NW, SE corner



**SOUTH DAKOTA STATE HISTORIC PRESERVATION OFFICE**  
**HISTORIC SITES SURVEY STRUCTURE FORM**



PHOTOGRAPHER: Jim Stone  
DATE OF PHOTO: July 30, 2013

ROLL NUMBER: \_\_\_\_\_  
PHOTO NUMBER: 3  
CAMERA DIRECTION: Looking SW, NE corner

**SOUTH DAKOTA STATE HISTORIC PRESERVATION OFFICE**  
**HISTORIC SITES SURVEY STRUCTURE FORM**



PHOTOGRAPHER: Jim Stone  
DATE OF PHOTO: July 30, 2013

ROLL NUMBER: \_\_\_\_\_  
PHOTO NUMBER: 4  
CAMERA DIRECTION: Looking SE, NW corner



**SOUTH DAKOTA STATE HISTORIC PRESERVATION OFFICE**  
**HISTORIC SITES SURVEY STRUCTURE FORM**



**PHOTOGRAPHER:** Jim Stone  
**DATE OF PHOTO:** July 30, 2013

**ROLL NUMBER:** \_\_\_\_\_  
**PHOTO NUMBER:** 5

**CAMERA DIRECTION:** First floor, looking NW,  
4x4 posts, (2) 2x6 beams  
and 2x6 floor joists.



**SOUTH DAKOTA STATE HISTORIC PRESERVATION OFFICE**  
**HISTORIC SITES SURVEY STRUCTURE FORM**



PHOTOGRAPHER: Jim Stone  
DATE OF PHOTO: July 30, 2013

ROLL NUMBER: \_\_\_\_\_  
PHOTO NUMBER: 6

CAMERA DIRECTION: Hayloft, looking SW, 2x4  
rafters with 2x6 brace at  
roof hip.



**SOUTH DAKOTA STATE HISTORIC PRESERVATION OFFICE**  
**HISTORIC SITES SURVEY STRUCTURE FORM**



PHOTOGRAPHER: Jim Stone  
DATE OF PHOTO: July 30, 2013

ROLL NUMBER: \_\_\_\_\_  
PHOTO NUMBER: 7

CAMERA DIRECTION: Hayloft, looking NW, 2x4  
rafters and 2x6 brace at  
roof hip.

# SOUTH DAKOTA STATE HISTORIC PRESERVATION OFFICE

## HISTORIC SITES SURVEY STRUCTURE FORM



T-94-N

BETHEL DIRECTORY

R-53-W

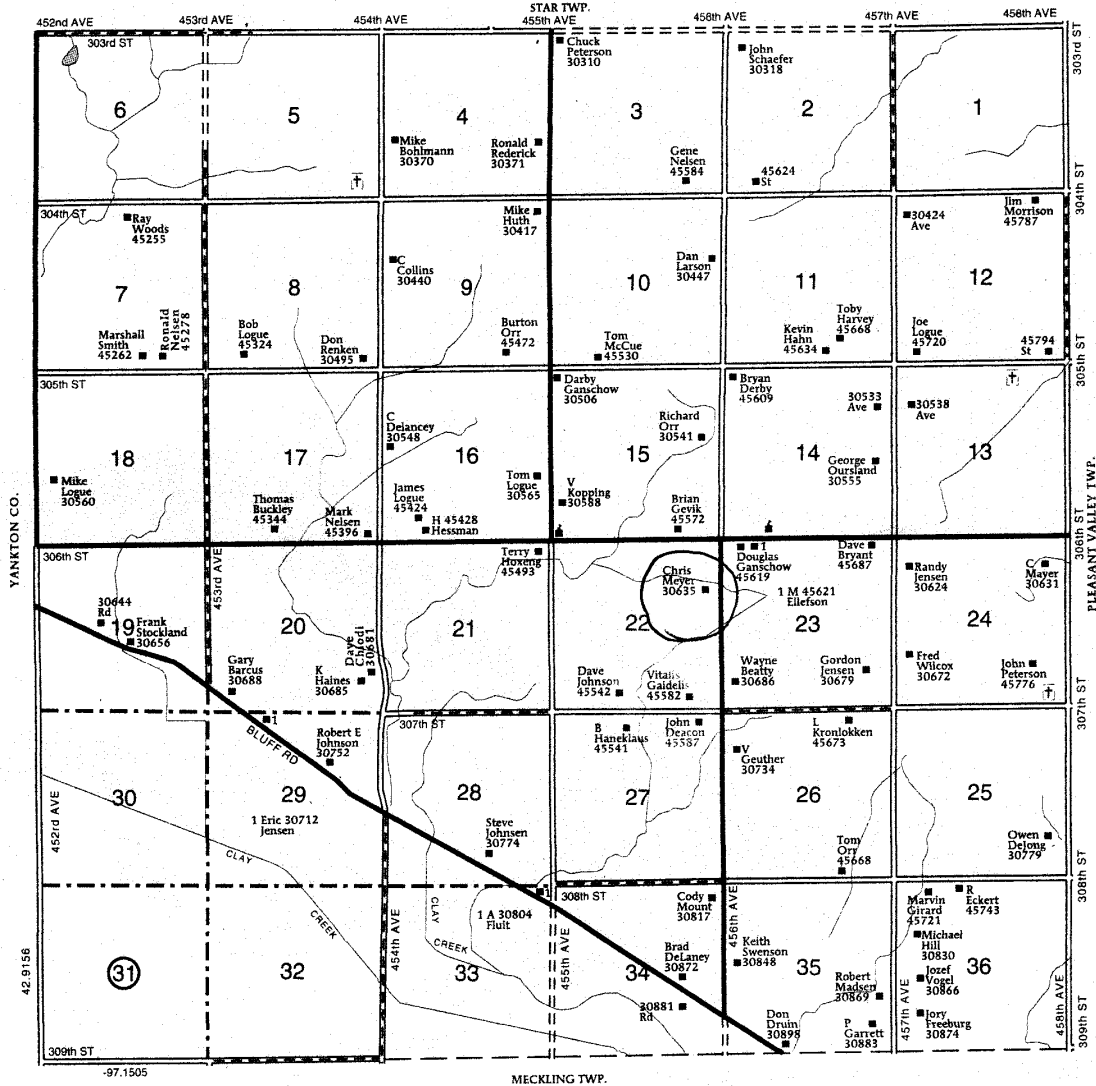



## **HISTORY**

This farm located in the NE ¼ of Section 22, Bethel Township, Clay County was homesteaded by Charles Nelson.

The 1894 Clay County Atlas lists Charles Nelson as the owner.

The 1901, 1912 and 1924 Clay County Atlas lists Nels C. & Hans M. Nelson as the owners. The farm was named “Morningside Farm” in the 1924 atlas.

The 1937 Clay County Atlas lists Carrie M. Nelson as the owner.

The 1948 and 1956 Clay County Atlas lists W. H. Beaty as the owner.

**The following Is From The  
Wakonda, S. D.  
Centennial Book  
1885 – 1985**

### **Hans M. and Mable Nelson Family**

Hans M. Nelson (March 27, 1875 – April 3, 1963) was born in Clay county to Hans and Hannah Nelson who homesteaded four south, one east of and ½ mile south of Wakonda. Their sons, Hans married Mable Conrad (Feb. 11, 1885- May 17, 1940) and they continued to live on the farm and raised four children. Maynard Nelson (June 15, 1914). Pearl Nelson Sorenson (Aug. 26, 1915), Harlan Nelson (May 29, 1921) and Dorthy Nelson Babb (Jan. 11, 1927). Hans built onto the homestead house and then built a larger house in 1930 which was home to many people. As friends and relatives came from the “old country,” Denmark, many of them lived with Hans and Mable until they could get started on their own. It was not unusual to have extra people to feed and Pearl remembers well stirring up a cake when they could see unexpected company coming down the long driveway.

Wayne Beaty, a great grandnephew of the homestead family, now owns on this farm with his wife.