

**SOUTH DAKOTA STATE HISTORIC PRESERVATION OFFICE  
HISTORIC SITES SURVEY STRUCTURE FORM**



**SITE INFORMATION**

\*SURVEY DATE: February 1, 2013 \*ADDRESS: 46882 311<sup>th</sup> Street  
\*SURVEYOR: Jim Stone \*COUNTY: Clay  
\*CITY: Beresford

LOCATION DESCRIPTION: From Vermillion, South Dakota Highway 50, East 2 miles to Greenfield Road, turn left (North) 8-1/2 miles to 311<sup>th</sup> Street, turn right (East) about 7/8 mile, on the left (North) side, vacant place.

LEGAL DESCRIPTION: E 1/2 , SE 1/4, 11 – 93 – 51 Prairie Center Twp.

\*QUARTER 1: SE 1/4  
\*QUARTER 2: \_\_\_\_\_  
\*TOWNSHIP: Prairie Center  
\*RANGE: 51  
\*SECTION: 11  
ACRES: 80.62

OWNER NAME: Else S. (Host) Englund  
OWNER ADDRESS: 46882 311<sup>th</sup> Street  
OWNER CITY: Burbank  
OWNER STATE: South Dakota  
OWNER ZIP: 57010  
QUAD NAME: \_\_\_\_\_

OWNER CODE 1: P  
OWNER CODE 2: \_\_\_\_\_  
OWNER CODE 3: \_\_\_\_\_

**HISTORIC SIGNIFICANCE**

\*DOE: \_\_\_\_\_  
\*DOE DATE: \_\_\_\_\_  
REASON INELIGIBLE: \_\_\_\_\_

REGISTER NAME: \_\_\_\_\_  
MULTIPLE PROPERTY NAME: \_\_\_\_\_

NOMINATION STATUS: \_\_\_\_\_  
DATE LISTED: \_\_\_\_\_  
REFERENCE NUMBER: \_\_\_\_\_  
HISTORIC DISTRICT RATING: C or NC  
PERIOD: \_\_\_\_\_

CATEGORY: \_\_\_\_\_  
SIGNIFICANCE LEVEL 1: N S L  
SIGNIFICANCE LEVEL 2: N S L  
CRITERIA 1: A B C D  
CRITERIA 2: A B C D  
CRITERIA 3: A B C D  
CRITERIA 4: A B C D

SIGNIFICANCE NOTES: \_\_\_\_\_  
\_\_\_\_\_  
\_\_\_\_\_

**STRUCTURE DETAILS**

\* = REQUIRED FIELD

**SOUTH DAKOTA STATE HISTORIC PRESERVATION OFFICE  
HISTORIC SITES SURVEY STRUCTURE FORM**



SHPO ID: \_\_\_\_\_  
 \*PROPERTY NAME: \_\_\_\_\_  
 OTHER NAME: \_\_\_\_\_

CURRENT FUNCTION: <u>Storage</u>	FOUNDATION: <u>Poured concrete foundation</u>
CURRENT SUBFUNCTION: <u>Storage</u>	ROOF MATERIAL: <u>Asphalt shingles over cedar shingles</u>
HISTORIC FUNCTION: <u>Livestock barn</u>	ROOF SHAPE: <u>Gambrel</u>
HISTORIC SUBFUNCTION: <u>Hay storage</u>	STRUCTURAL SYSTEM: <u>Balloon framing</u>
OCCUPIED: <u>Yes</u>	STYLE: <u>Gambrel roof barn</u>
ACCESSIBLE: <u>Yes with permission</u>	TYPE: <u>Livestock barn</u>
STORIES: <u>2</u>	WALLS: _____
*DATE OF CONSTRUCTION: <u>1894</u>	SIGNIFICANT PERSON: <u>Maren Jacobson</u>
	CULTURAL AFFILIATION: <u>Danish</u>

ALTERED/MOVED NOTES: Original site. Any evidence of milk cow stanchions has been removed. \_\_\_' x 40' lean-to was built on the North side later. It is gone and no evidence of a foundation or the size. Walls and roof have been covered with 26" galvanized 1-1/4" corrugated steel roofing.

INTERIOR NOTES: Has two rows of 2x4 posts, with a 4x4 for a beam. Most of the 2x4 posts are gone. Solid 2x4 wall in 18' from the East wall and another 2x4 partial wall in 14' from the East wall. This creates a 4' wide feed alley. Floor joists are 2x6's. Four single horse stalls facing the feed alley in the East part of the barn. The West part of the barn was for calves.

OTHER NOTES: 2x4 stud walls with 1x8 #106 drop siding. 2x6 rafters with a 2x6 cross brace 4' O.C. Walls and roof have been covered with 26" galvanized, 1-1/4" corrugated roofing.

Windows are 8"x10" four light. Originally there were two horse stalls and two milk cow stanchions on The East side. The two milk cow stalls were converted into horse stalls and the milk cow stanchions were in the North lean-to.

\*PHYSICAL NOTES: Barn is in poor condition. 4x4 beams are sagging after the 2x4 posts were removed. Wind has torn off some of the steel roofing.

\*UTM ZONE: \_\_\_\_\_ \*RESTRICTED: Y or N  
 \*UTM EASTING: \_\_\_\_\_  
 \*UTM NORTHING: \_\_\_\_\_

\* = REQUIRED FIELD

**SOUTH DAKOTA STATE HISTORIC PRESERVATION OFFICE  
HISTORIC SITES SURVEY STRUCTURE FORM**



**SKETCH MAP**

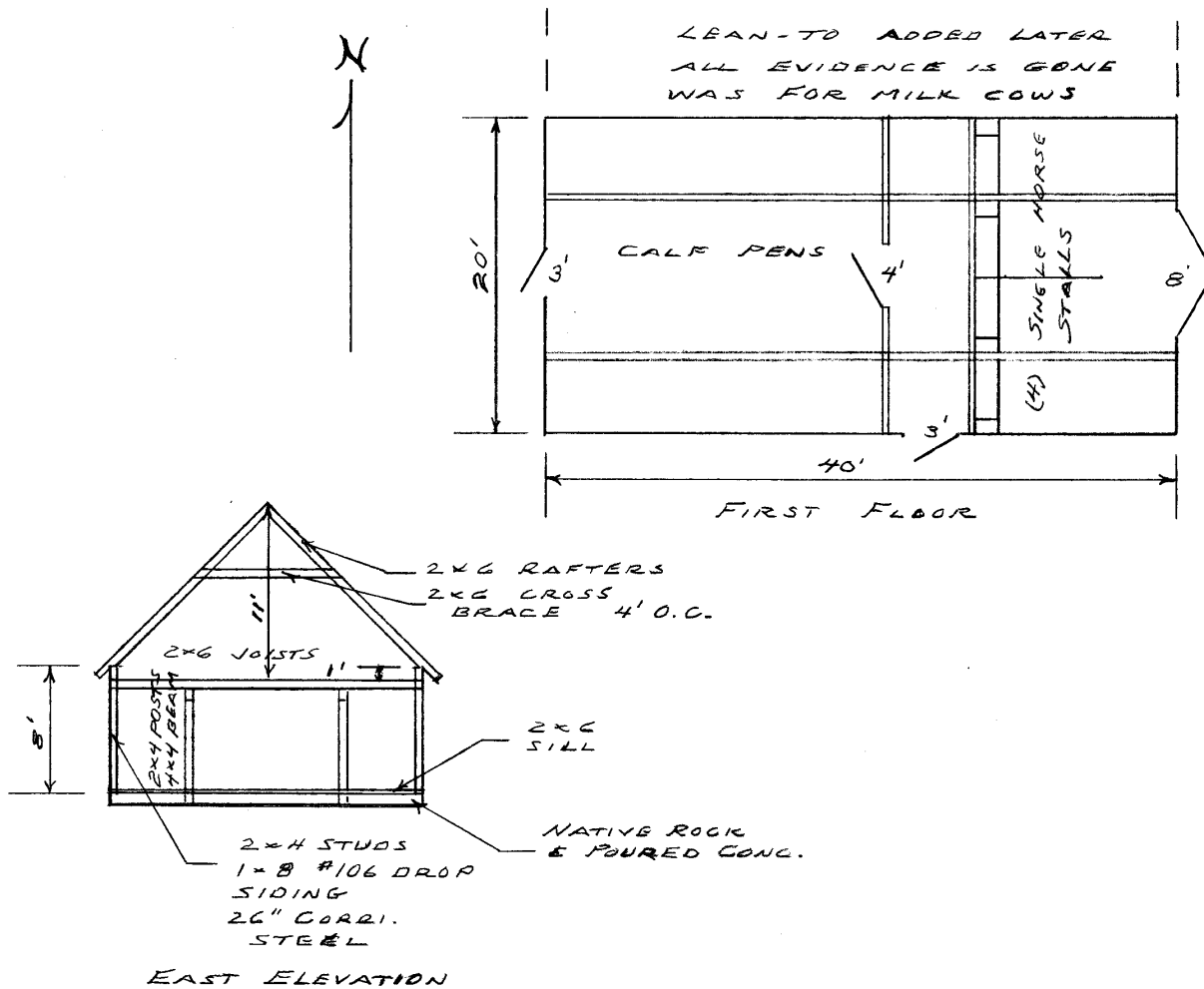

**PHOTOGR**

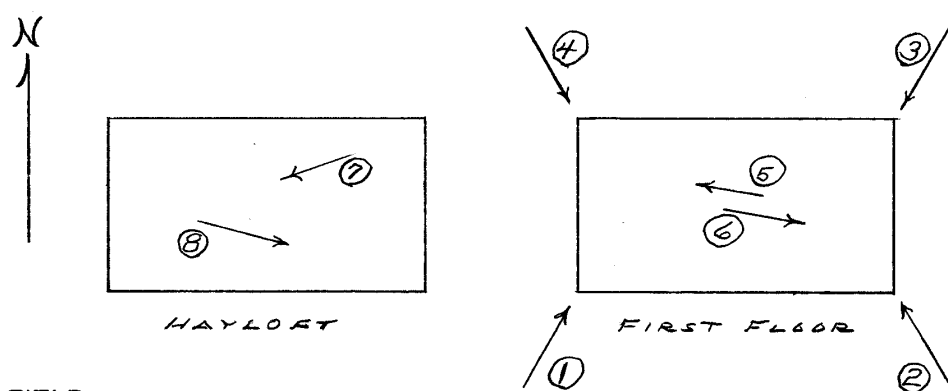

\* = REQUIRED FIELD

**SOUTH DAKOTA STATE HISTORIC PRESERVATION OFFICE  
HISTORIC SITES SURVEY STRUCTURE FORM**



**PHOTOGRAPHER:** Jim Stone  
**DATE OF PHOTO:** February 1, 2013

**ROLL NUMBER:** \_\_\_\_\_  
**PHOTO NUMBER:** 1  
**CAMERA DIRECTION:** Looking NE, SW corner



**PHOTOGRAPHER:** Jim Stone  
**DATE OF PHOTO:** February 1, 2013

**ROLL NUMBER:** \_\_\_\_\_  
**PHOTO NUMBER:** 2  
**CAMERA DIRECTION:** Looking NW, SE corner

\* = REQUIRED FIELD



**SOUTH DAKOTA STATE HISTORIC PRESERVATION OFFICE  
HISTORIC SITES SURVEY STRUCTURE FORM**



**PHOTOGRAPHER:** Jim Stone  
**DATE OF PHOTO:** February 1, 2013

**ROLL NUMBER:** \_\_\_\_\_  
**PHOTO NUMBER:** 3  
**CAMERA DIRECTION:** Looking SW, NE corner



**PHOTOGRAPHER:** Jim Stone  
**DATE OF PHOTO:** February 1, 2013

**ROLL NUMBER:** \_\_\_\_\_  
**PHOTO NUMBER:** 4  
**CAMERA DIRECTION:** Looking SE, NW corner

\* = REQUIRED FIELD

**SOUTH DAKOTA STATE HISTORIC PRESERVATION OFFICE  
HISTORIC SITES SURVEY STRUCTURE FORM**



**PHOTOGRAPHER:** Jim Stone  
**DATE OF PHOTO:** February 1, 2013

**ROLL NUMBER:** \_\_\_\_\_  
**PHOTO NUMBER:** 5

**CAMERA DIRECTION:** First floor, looking NW,  
4x4 beam sagging after  
2x4 posts were removed.



**PHOTOGRAPHER:** Jim Stone  
**DATE OF PHOTO:** February 1, 2013

**ROLL NUMBER:** \_\_\_\_\_  
**PHOTO NUMBER:** 6

**CAMERA DIRECTION:** First floor, looking SE,  
where the single horse  
stalls were located.

\* = REQUIRED FIELD

**SOUTH DAKOTA STATE HISTORIC PRESERVATION OFFICE  
HISTORIC SITES SURVEY STRUCTURE FORM**



**PHOTOGRAPHER:** Jim Stone  
**DATE OF PHOTO:** February 1, 2013

**ROLL NUMBER:** \_\_\_\_\_  
**PHOTO NUMBER:** 7

**CAMERA DIRECTION:** Hayloft, looking SW, 2x6  
rafters with 2x6 cross  
brace, note 12" wall.



**PHOTOGRAPHER:** Jim Stone  
**DATE OF PHOTO:** February 1, 2013

**ROLL NUMBER:** \_\_\_\_\_  
**PHOTO NUMBER:** 8

**CAMERA DIRECTION:** Hayloft, looking SE, 2x6  
rafters with 2x6 cross  
brace.



**SOUTH DAKOTA STATE HISTORIC PRESERVATION OFFICE  
HISTORIC SITES SURVEY STRUCTURE FORM**



**PHOTOGRAPHER:** Jim Stone  
**DATE OF PHOTO:** February 1, 2013

**ROLL NUMBER:** \_\_\_\_\_  
**PHOTO NUMBER:** 9

Horse powered corn and grain grinder. The spout pointing down in the bottom center allowed the ground grain to pour into a 5 gallon pail. The brackets on the front of the large gear held an oak tongue that the horses were hitched to. The horses walked around in a circle to power the grinder.

**CAMERA DIRECTION:** \_\_\_\_\_



**SOUTH DAKOTA STATE HISTORIC PRESERVATION OFFICE  
HISTORIC SITES SURVEY STRUCTURE FORM**



**T-93-N PRAIRIE CENTER DIRECTORY R-51-W**

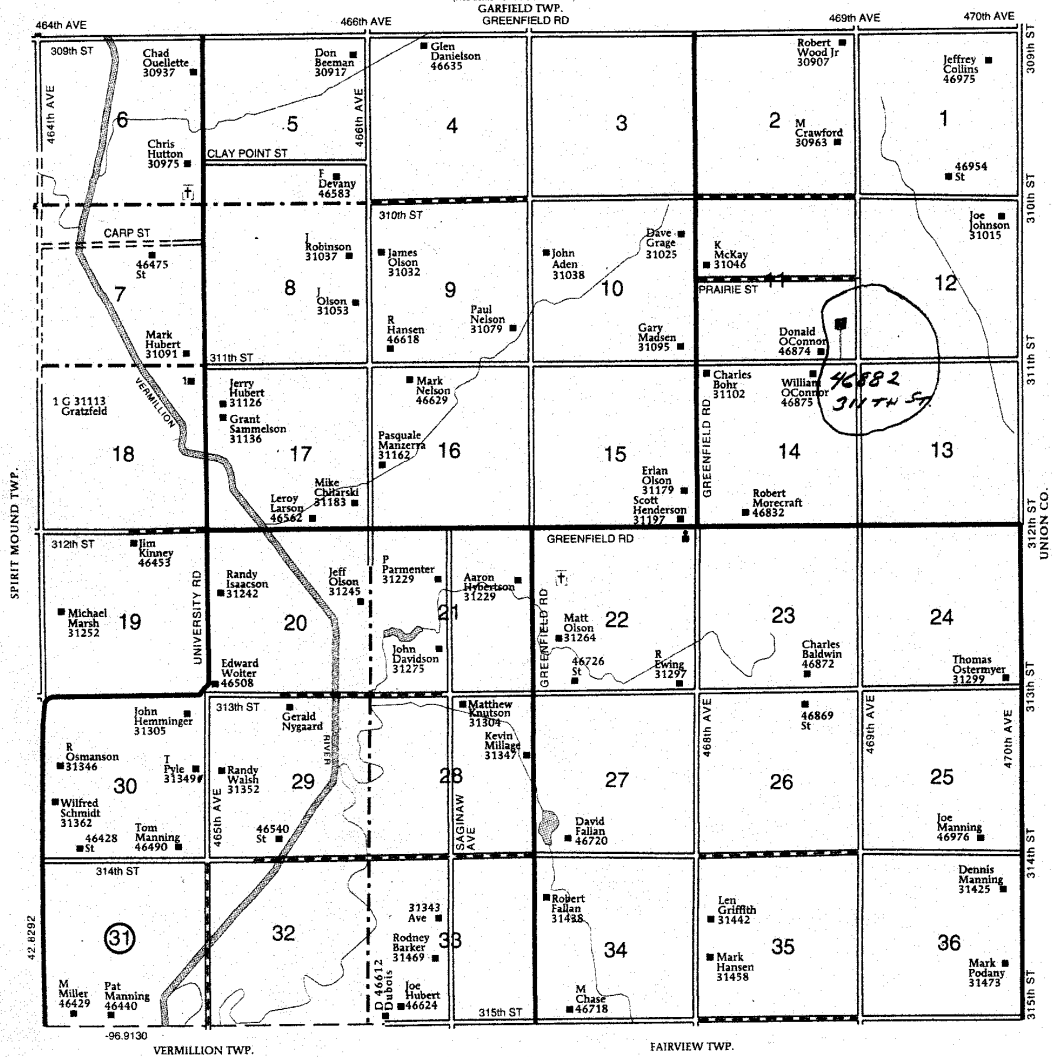

## **HISTORY**

This farm located in the SE ¼ of Section 11, Prairie Center Township, Clay County was homesteaded by Edwin Robbins.

A Danish immigrant family bought this farm. Their name was Maren and Pauline Jacobson.

The 1894 and 1901 Clay County Atlas lists Maren Jacobson as the owner.

The 1912 and 1924 Clay County Atlas lists Pauline Jacobson as the owner.

1937, 1948 and 1956 Clay county Atlas lists Jeppe Host as the owner.

**The Following Information was furnished by**  
Else Host, the owner of this farm.

A Danish immigrant family bought this farm. Their name was Maren and Pauline Jacobson.

Their 14-year old son designed and built this barn in 1894. The neighbors felt sorry for him and came to help him finish. The father may have sought work elsewhere at the time trying to support the family and maybe pay for the land.