

**SOUTH DAKOTA STATE HISTORIC PRESERVATION OFFICE
HISTORIC SITES SURVEY STRUCTURE FORM**



SITE INFORMATION

*SURVEY DATE: July 26, 2012 *ADDRESS: 30770 458th Ave. (Vacant)
*SURVEYOR: Jim Stone *COUNTY: Clay
*CITY: Wakonda

LOCATION DESCRIPTION: From the intersection of South Dakota Highway 50 bi-pass and South Dakota Highway 19, North 9 miles to 308th Street, turn left (West) 4-1/2 miles to 458th Ave., turn right (North) about 1/4 mile, on the right (East) side.

LEGAL DESCRIPTION: SW 1/4, Lots 1 & 2, 30 – 94 – 52 Pleasant Valley Twp.

*QUARTER 1: SW 1/4
*QUARTER 2: _____
*TOWNSHIP: Pleasant Valley
*RANGE: 52
*SECTION: 30
ACRES: 150.03

OWNER NAME: Carol Jean Mayer
OWNER ADDRESS: 30631 458th Ave.
OWNER CITY: Wakonda
OWNER STATE: South Dakota
OWNER ZIP: 57073
QUAD NAME: _____

OWNER CODE 1: P
OWNER CODE 2: _____
OWNER CODE 3: _____

HISTORIC SIGNIFICANCE

*DOE: _____
*DOE DATE: _____
REASON INELIGIBLE: _____

REGISTER NAME: _____
MULTIPLE PROPERTY NAME: _____

NOMINATION STATUS: _____
DATE LISTED: _____
REFERENCE NUMBER: _____
HISTORIC DISTRICT RATING: C or NC
PERIOD: _____

CATEGORY: _____
SIGNIFICANCE LEVEL 1: N S L
SIGNIFICANCE LEVEL 2: N S L
CRITERIA 1: A B C D
CRITERIA 2: A B C D
CRITERIA 3: A B C D
CRITERIA 4: A B C D

SIGNIFICANCE NOTES: _____

STRUCTURE DETAILS

* = REQUIRED FIELD

**SOUTH DAKOTA STATE HISTORIC PRESERVATION OFFICE
HISTORIC SITES SURVEY STRUCTURE FORM**



SHPO ID: _____

*PROPERTY NAME: _____

OTHER NAME: _____

CURRENT FUNCTION: Vacant

CURRENT SUBFUNCTION: Vacant

HISTORIC FUNCTION: Livestock barn

HISTORIC SUBFUNCTION: Hay storage

FOUNDATION: Poured concrete

ROOF MATERIAL: Cedar shingles

ROOF SHAPE: Gable

STRUCTURAL SYSTEM: Balloon framing

STYLE: Gable roof barn

TYPE: Livestock barn

2x6, 1x8 shiplap,
horizontal galv.

WALLS: corr. steel

OCCUPIED: No

ACCESSIBLE: Yes with
permission

STORIES: 2

SIGNIFICANT PERSON: Mable & Oscar Gran

*DATE OF CONSTRUCTION: 1910 to 1920

CULTURAL AFFILIATION: ?

ALTERED/MOVED NOTES: Original site. All evidence of horse stalls or milk cow stanchions have been removed. Posts under beams have been replaced with 6" round creosote posts. Do not know if horizontal steel was original or added later. There is some 1x8 #106 drop siding on the East wall of the main barn inside the lean-to. Concrete floor was poured later. Appears to have been used for farrowing and feeding swine.

INTERIOR NOTES: Has two rows 6" round creosote posts and (2) 2x6's for a beam to support hayloft floor. Floor joists are 2x6's.

OTHER NOTES: Windows were 4"x24" four light with metal sides for adjustable window ventilation. Tops of windows tilt in to prevent direct drafts and prevent rain from coming into the barn. Walls are 2x6 with 1x8 shiplap sheathing and horizontal galv. corr. steel. Rafters are 2x6's with 2x6 horizontal bracing close to the peak, 4' O.C.

*PHYSICAL NOTES: Barn is in good condition. The roof is leaking, will need re-roofing soon. The doors and windows need repairs.

*UTM ZONE: _____

*RESTRICTED: Y or N

*UTM EASTING: _____

*UTM NORTHING: _____

SKETCH MAP

**SOUTH DAKOTA STATE HISTORIC PRESERVATION OFFICE
HISTORIC SITES SURVEY STRUCTURE FORM**

SKETCH MAP

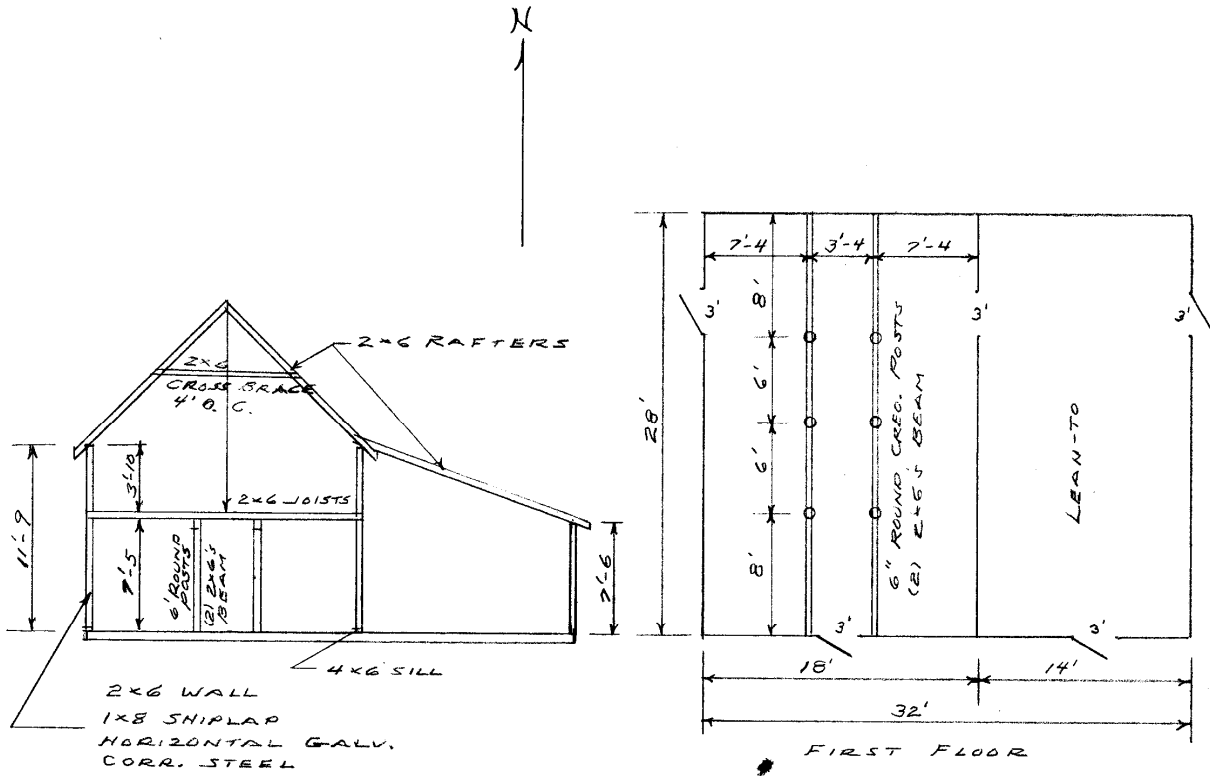

PHOTOGR

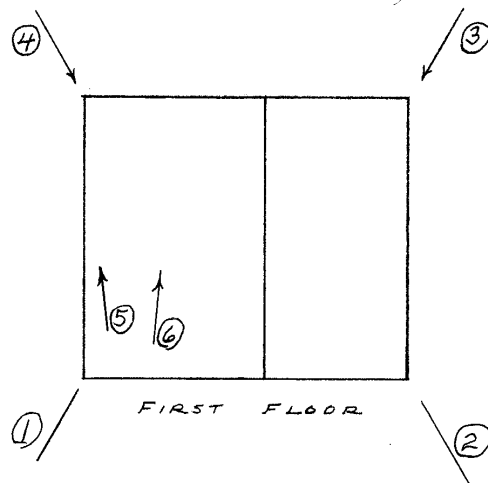
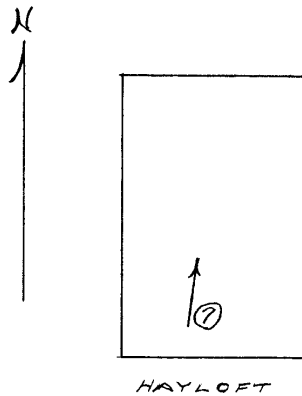

* = REQUIRED FIELD

* = REQUIRED FIELD

**SOUTH DAKOTA STATE HISTORIC PRESERVATION OFFICE
HISTORIC SITES SURVEY STRUCTURE FORM**



PHOTOGRAPHER: Jim Stone
DATE OF PHOTO: July 26, 2012

ROLL NUMBER: _____
PHOTO NUMBER: 1
CAMERA DIRECTION: Looking NE, SW corner



PHOTOGRAPHER: Jim Stone
DATE OF PHOTO: July 26, 2012

ROLL NUMBER: _____
PHOTO NUMBER: 2
CAMERA DIRECTION: Looking NW, SE corner

* = REQUIRED FIELD

**SOUTH DAKOTA STATE HISTORIC PRESERVATION OFFICE
HISTORIC SITES SURVEY STRUCTURE FORM**



PHOTOGRAPHER: Jim Stone
DATE OF PHOTO: July 26, 2012

ROLL NUMBER: _____
PHOTO NUMBER: 3
CAMERA DIRECTION: Looking SW, NE corner



PHOTOGRAPHER: Jim Stone
DATE OF PHOTO: July 26, 2012

ROLL NUMBER: _____
PHOTO NUMBER: 4
CAMERA DIRECTION: Looking SE, NW corner

* = REQUIRED FIELD

**SOUTH DAKOTA STATE HISTORIC PRESERVATION OFFICE
HISTORIC SITES SURVEY STRUCTURE FORM**



PHOTOGRAPHER: Jim Stone
DATE OF PHOTO: July 26, 2012

ROLL NUMBER: 5
PHOTO NUMBER: 5

**First floor, looking North,
6" round creosoted
posts and (2) 2x6's for
beam**

CAMERA DIRECTION: _____



PHOTOGRAPHER: Jim Stone
DATE OF PHOTO: July 26, 2012

ROLL NUMBER: _____
PHOTO NUMBER: 6

**First floor, looking North,
Special metal sides on
windows for Adj.**

CAMERA DIRECTION: ventilation

* = REQUIRED FIELD

**SOUTH DAKOTA STATE HISTORIC PRESERVATION OFFICE
HISTORIC SITES SURVEY STRUCTURE FORM**



PHOTOGRAPHER: Jim Stone
DATE OF PHOTO: July 26, 2012

ROLL NUMBER: _____
PHOTO NUMBER: 7
CAMERA DIRECTION: Hayloft, looking NW,
rafters and brace 4' O.C.

**SOUTH DAKOTA STATE HISTORIC PRESERVATION OFFICE
HISTORIC SITES SURVEY STRUCTURE FORM**

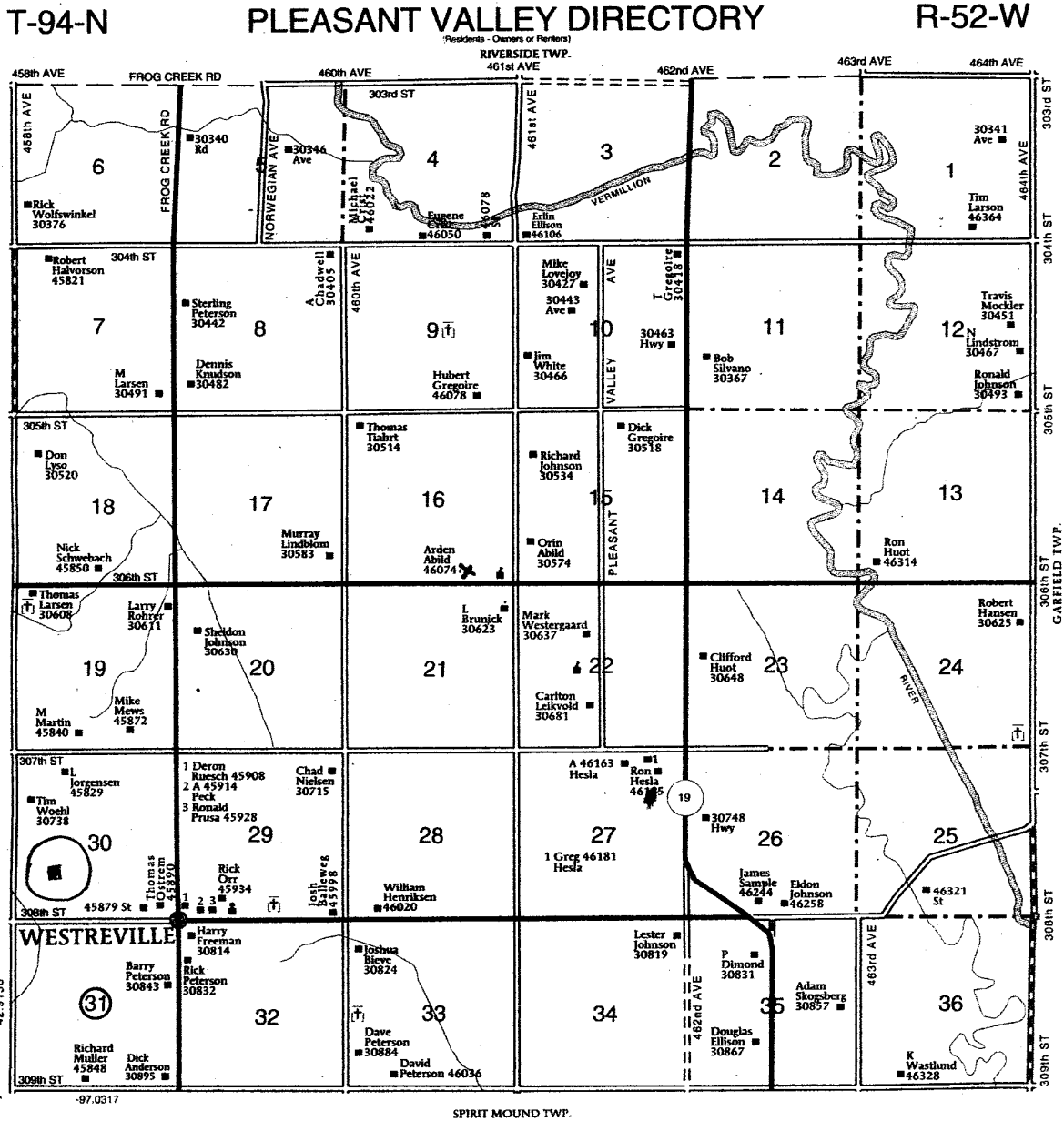

* = REQUIRED FIELD

HISTORY

This farm located in the SW ¼ of Section 30, Pleasant Valley Township, Clay County was homesteaded by Joseph Rhodes.

The 1894 and 1901 Clay County Atlas lists J. J. Westre as the owner.

The 1912 Clay County Atlas lists Mable Gran as the owner.

The 1924 Clay County Atlas lists Osaer Gran as the owner.

The 1937 Clay County Atlas lists M. Gran as the owner and lists G. Vagnild as the operator (renter).

The 1948 and 1956 Clay County Atlas lists Elmer Friese as the owner.

**SOUTH DAKOTA STATE HISTORIC PRESERVATION OFFICE
HISTORIC SITES SURVEY STRUCTURE FORM**

