

**SOUTH DAKOTA STATE HISTORIC PRESERVATION OFFICE
HISTORIC SITES SURVEY STRUCTURE FORM**



SITE INFORMATION

*SURVEY DATE: April 21, 2012 *ADDRESS: 30337 Frog Creek Road
*SURVEYOR: Jim Stone *COUNTY: Clay
*CITY: Wakonda

LOCATION DESCRIPTION: From the intersection of South Dakota Highway 50 bypass and South Dakota Highway 19, North 9 miles to 308th Street, turn left (West) 3-1/2 miles to Frog Creek Road, turn right (North) 4-1/2 miles on the left (West) side

LEGAL DESCRIPTION: E 1/2 Lot 1 NE 1/4, 6 - 94 - 52, Pleasant Valley Twp.

*QUARTER 1: NE 1/4 OWNER NAME: Patricia J. Knutson
*QUARTER 2: _____ OWNER ADDRESS: 1228 So. Holly Drive
*TOWNSHIP: Pleasant Valley OWNER CITY: Sioux Falls
*RANGE: 52 OWNER STATE: South Dakota
*SECTION: 6 OWNER ZIP: 57105-0220
ACRES: 41.51 QUAD NAME: _____
OWNER CODE 1: P
OWNER CODE 2: F S L P
OWNER CODE 3: F S L P

HISTORIC SIGNIFICANCE

*DOE: _____ REGISTER NAME: _____
*DOE DATE: _____ MULTIPLE PROPERTY NAME: _____
REASON INELIGIBLE: _____

NOMINATION STATUS: _____ CATEGORY: _____
DATE LISTED: _____ SIGNIFICANCE LEVEL 1: N S L
REFERENCE NUMBER: _____ SIGNIFICANCE LEVEL 2: N S L
HISTORIC DISTRICT RATING: C or NC CRITERIA 1: A B C D
PERIOD: _____ CRITERIA 2: A B C D
CRITERIA 3: A B C D
CRITERIA 4: A B C D

SIGNIFICANCE NOTES: Knud Knudson (one armed Knud). Early pioneer to this area. Loved horses and became a large land owner. Raised and fed a lot of cattle.

* = REQUIRED FIELD

**SOUTH DAKOTA STATE HISTORIC PRESERVATION OFFICE
HISTORIC SITES SURVEY STRUCTURE FORM**



STRUCTURE DETAILS

SHPO ID: _____
 *PROPERTY NAME: _____
 OTHER NAME: _____

CURRENT FUNCTION: <u>Vacant</u>	FOUNDATION: <u>Poured concrete</u> <u>Asphalt shingles</u> <u>over cedar</u> <u>shingles</u>
CURRENT SUBFUNCTION: <u>Vacant</u>	ROOF MATERIAL: <u>shingles</u>
HISTORIC FUNCTION: <u>Livestock barn</u>	ROOF SHAPE: <u>Gambrel</u>
HISTORIC SUBFUNCTION: <u>Hay storage</u>	STRUCTURAL SYSTEM: <u>Balloon framing</u>
	STYLE: <u>Gambrel roof barn</u>
OCCUPIED: <u>No</u>	TYPE: <u>Livestock barn</u>
	<u>2x6 w/ #106 drop</u>
ACCESSIBLE: <u>Yes with</u> <u>permission</u>	WALLS: <u>siding</u>

STORIES: 2 SIGNIFICANT PERSON: Knud Knudson
 *DATE OF CONSTRUCTION: ? CULTURAL AFFILIATION: Norwegian

ALTERED/MOVED NOTES: May have been moved to this site, owner is not sure.

INTERIOR NOTES: One row 4x6 beam in the center, with 4x6 posts 6' - 7' - 6' - 6' - 7' O. C. from the South wall. 2x6 floor joists for hayloft floor. Horse stalls sill in place.

OTHER NOTES: 2x6 walls 14' high on the East and West. 2x6 balloon frame walls on the North and South gable end walls, No sheathing, #106 1x6 siding. Rafters are 2x6 with 3x4" sheathing, cedar shingles and asphalt shingles. Lean-to on the West side has 2x6 stud wall 7' high on the West side and 2x6 stud walls on the North and South. Rafters are 2x6. Windows are 8"x10" four light windows.

*PHYSICAL NOTES: Barn is in fair condition. Needs some maintance.

* = REQUIRED FIELD

**SOUTH DAKOTA STATE HISTORIC PRESERVATION OFFICE
HISTORIC SITES SURVEY STRUCTURE FORM**



SKETCH MAP

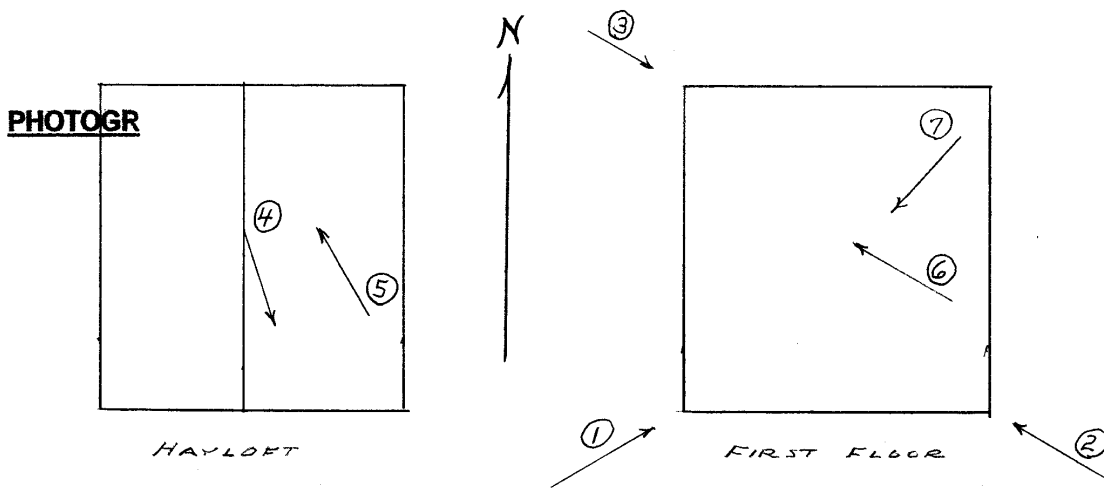
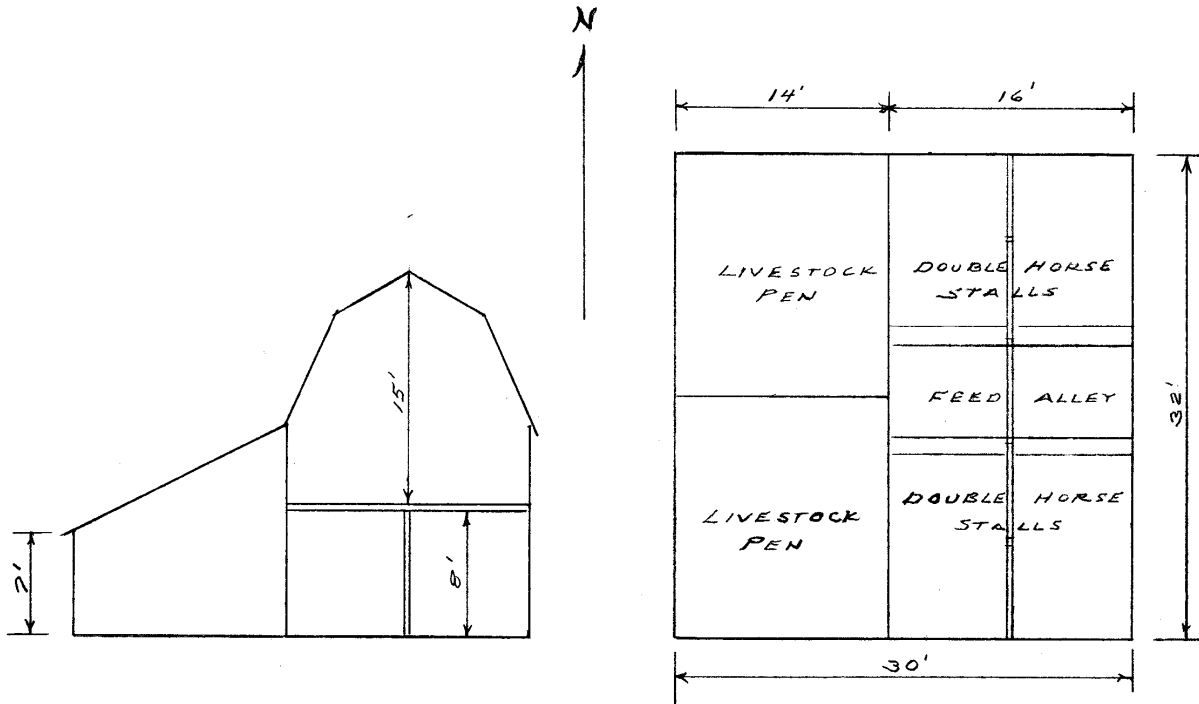

* = REQUIRED FIELD

* = REQUIRED FIELD

**SOUTH DAKOTA STATE HISTORIC PRESERVATION OFFICE
HISTORIC SITES SURVEY STRUCTURE FORM**



PHOTOGRAPHER: Jim Stone
DATE OF PHOTO: April 21, 2012

ROLL NUMBER: _____
PHOTO NUMBER: 1
CAMERA DIRECTION: Looking NE, SW corner



PHOTOGRAPHER: Jim Stone
DATE OF PHOTO: April 21, 2012

ROLL NUMBER: _____
PHOTO NUMBER: 2
CAMERA DIRECTION: Looking NW, SE corner

* = REQUIRED FIELD

**SOUTH DAKOTA STATE HISTORIC PRESERVATION OFFICE
HISTORIC SITES SURVEY STRUCTURE FORM**



PHOTOGRAPHER: Jim Stone
DATE OF PHOTO: April 21, 2012

ROLL NUMBER: _____
PHOTO NUMBER: 3
CAMERA DIRECTION: Looking SE, NW corner



PHOTOGRAPHER: Jim Stone
DATE OF PHOTO: April 21, 2012

ROLL NUMBER: _____
PHOTO NUMBER: 4
CAMERA DIRECTION: Hayloft, looking South

* = REQUIRED FIELD

**SOUTH DAKOTA STATE HISTORIC PRESERVATION OFFICE
HISTORIC SITES SURVEY STRUCTURE FORM**



PHOTOGRAPHER: Jim Stone
DATE OF PHOTO: April 21, 2012

ROLL NUMBER: _____
PHOTO NUMBER: 5
CAMERA DIRECTION: Hayloft, looking NW



PHOTOGRAPHER: Jim Stone
DATE OF PHOTO: April 21, 2012

ROLL NUMBER: _____
PHOTO NUMBER: 6
CAMERA DIRECTION: First floor, horse stalls, looking NW

* = REQUIRED FIELD

**SOUTH DAKOTA STATE HISTORIC PRESERVATION OFFICE
HISTORIC SITES SURVEY STRUCTURE FORM**



PHOTOGRAPHER: Jim Stone
DATE OF PHOTO: April 21, 2012

ROLL NUMBER: _____
PHOTO NUMBER: 7
CAMERA DIRECTION: First floor, horse stalls,
looking SE

**SOUTH DAKOTA STATE HISTORIC PRESERVATION OFFICE
HISTORIC SITES SURVEY STRUCTURE FORM**



T-94-N

PLEASANT VALLEY PLAT

R-52-W

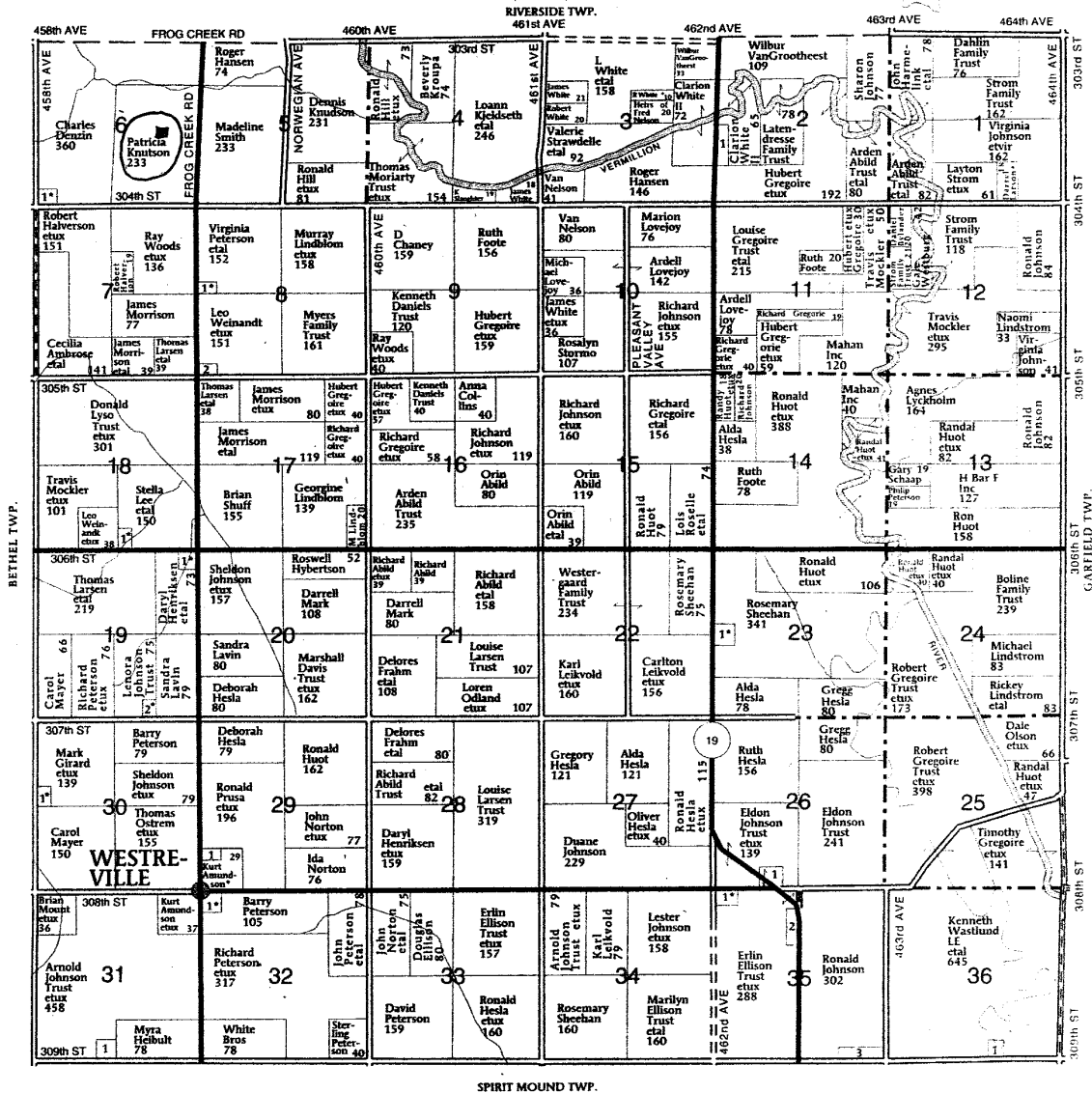

**PLEASANT VALLEY
TOWNSHIP**

SECTION 2

1. County of Clay 13

SECTION 5

1. Wolfswinkel, Sandra 8

SECTION 8

1. Peterson, Sterling 6
2. Knudson, Dennis 6

SECTION 18

1. Schwebach, Nicholas 7

SECTION 19

1. Rohrer, Larry 6

2. Mews, Michael 5

SECTION 23

1. Huot, Clifford 11

SECTION 26

1. Sample Jr, James 10

SECTION 29

1. Pleasant Valley Lutheran Church 5

SECTION 30

1. Woehl, Timothy 5

SECTION 31

1. Muller, Richard 10

SECTION 32

1. Freeman, Harry 9

SECTION 35

1. Dimond, Patricia 8

2. American State Bank 8

3. Wibben, Cristeen 12

SECTION 36

1. Christensen, Scott 6

* = REQUIRED FIELD

HISTORY

This farm located in ther E ½ of the NE ¼ of Section 6, Pleasant Valley Township, Clay County was homesteaded by Knud Knudson.

The 1894, 1901 and 1912 Clay County Atlas lists Knud Knudson as the owner.

The 1924 Clay County Atlas lists Ole Knudson as the owner.

The 1937 and 1948 Clay County Atlas lists Severt Knudson as the owner.

The 1948 Clay County Atlas lists Stella Knudson as the owner.

The following was furnished by
Patricia Knutson

Knud Knudson was born 1849 in Norway and immigrated to America.

He was known as “one arm Knud”. He lost part of his arm in a horse powered silage cutter.

Knud loved horses.

He raised and fed a lot of cattle.

He became a large landowner in Clay County.

He bought a farm for each of his four sons. Lewis, Severt, Knud Inman (aka) KI and __?__.

Severt Knudson was Patricia J. Knutson’s grandfather. Stella (Knudson) Knutson was a daughter of Severt Knudson.

Palmer Knutson married Stella Knudson and were the parents of Patricia Knutson.

Palmer bought this farm and this is where Patricia grew up.

The following is from
Wakonda, S. D. Centennial Book
1885 – 1985

Knud and Ingeborg Knudson Family

Knud Ulven was born near Voss, Norway Jan. 25, 1849, the son of Knud and Anna (Fenne) Ulven. He came to the United States in 1868. It was then that he changed his family name from ulven to Knudson by taking his fathers name Knud and adding son, hence the name knudson. Knud lost his arm in a corn-sheller accident and was from then on known as “One Arm” Knudson.

**SOUTH DAKOTA STATE HISTORIC PRESERVATION OFFICE
HISTORIC SITES SURVEY STRUCTURE FORM**



Ingeborg Nesheim was born in Voss, Norway, Aug. 8, 1856. she came to the United states in 1867 and was married yo Knud in 1874. they had 12 children but only seven grew to adulthood; Knut 1875 – 1939, Anna 1877-1897, Severt 1881-1947, Ole 1884-1955, Emma 1887-1970, Lewis 1889-1955, Clara 1896 –1910.

Knud filed a homestead claim east of Wakonda in Pleasant Valley Township. Besides farming he raised and fed cattle and hogs. He also raised horses and took much pride in his driving horses and saddle ponies.

Knud owned a ranch in Lyman County, south of Presho on the White River. His oldest son, Knut, lived there and operated the ranch in conjunction with his father. It consisted mainly of raising cattle and horses.

Knud died of a heart attack in June of 1918. He was visiting at his son Knut’s home at Presho and was shadow boxing with his young grandson Bud (Joseph) when he died. He is buried at the Lodi Lutheran Cemetery in Clay County.

After her husband’s death, Ingeborg lived with the Severt Knudson family until her death in June of 1938. She too was buried at the Lodi Lutheran Cemetery.