

**SOUTH DAKOTA STATE HISTORIC PRESERVATION OFFICE  
HISTORIC SITES SURVEY STRUCTURE FORM**



**SITE INFORMATION**

\*SURVEY DATE: April 21, 2012 \*ADDRESS: Vacated farmstead  
\*SURVEYOR: Jim Stone \*COUNTY: Clay  
\*CITY: Wakonda

LOCATION DESCRIPTION: From the intersection of South Dakota Highway 19 bi-pass and South Dakota Highway 19, 9 miles North, turn left (West) on 308<sup>th</sup> Street, 3-1/2 miles to Frog Creek Road, turn right (North) , 8 miles to 298<sup>th</sup> Street, turn left (West) about 3/4 miles, on the right (North) side

LEGAL DESCRIPTION: SW 1/4, 18 – 95 – 52, Riverside Twp

\*QUARTER 1: SW 1/4  
\*QUARTER 2: \_\_\_\_\_  
\*TOWNSHIP: Riverside  
\*RANGE: 52  
\*SECTION: 18  
ACRES: 142

OWNER NAME: Patricia J. Knutson  
OWNER ADDRESS: 1228 So. Holly Drive  
OWNER CITY: Sioux Falls  
OWNER STATE: South Dakota  
OWNER ZIP: 57105 - 0220  
QUAD NAME: \_\_\_\_\_

OWNER CODE 1: P  
OWNER CODE 2: F S L P  
OWNER CODE 3: F S L P

**HISTORIC SIGNIFICANCE**

\*DOE: \_\_\_\_\_  
\*DOE DATE: \_\_\_\_\_  
REASON INELIGIBLE: \_\_\_\_\_

REGISTER NAME: \_\_\_\_\_  
MULTIPLE PROPERTY NAME: \_\_\_\_\_

NOMINATION STATUS: \_\_\_\_\_  
DATE LISTED: \_\_\_\_\_  
REFERENCE NUMBER: \_\_\_\_\_  
HISTORIC DISTRICT RATING: C or NC  
PERIOD: \_\_\_\_\_

CATEGORY: \_\_\_\_\_  
SIGNIFICANCE LEVEL 1: N S L  
SIGNIFICANCE LEVEL 2: N S L  
CRITERIA 1: A B C D  
CRITERIA 2: A B C D  
CRITERIA 3: A B C D  
CRITERIA 4: A B C D

SIGNIFICANCE NOTES: A very fine example of a large western livestock feeder barn.

\* = REQUIRED FIELD

**SOUTH DAKOTA STATE HISTORIC PRESERVATION OFFICE  
HISTORIC SITES SURVEY STRUCTURE FORM**



**STRUCTURE DETAILS**

SHPO ID: \_\_\_\_\_  
 \*PROPERTY NAME: \_\_\_\_\_  
 OTHER NAME: \_\_\_\_\_

CURRENT FUNCTION: <u>Vacant</u>	FOUNDATION: <u>Poured concrete</u>
CURRENT SUBFUNCTION: <u>Vacant</u>	ROOF MATERIAL: <u>Cedar shingles</u>
HISTORIC FUNCTION: <u>Livestock barn</u>	ROOF SHAPE: <u>Gable</u>
HISTORIC SUBFUNCTION: <u>Hay and grain storage</u>	STRUCTURAL SYSTEM: <u>Balloon framing</u>
	<u>Western feeder</u>
	STYLE: <u>barn</u>
OCCUPIED: <u>No</u>	TYPE: <u>Livestock barn</u>
	<u>2x6 with #106 drop</u>
ACCESSIBLE: <u>Yes with</u>	<u>siding &amp; covered</u>
<u>permission</u>	WALLS: <u>with steel</u>

STORIES: 1                      SIGNIFICANT PERSON: John Mossifn  
 \*DATE OF CONSTRUCTION: Early 1920's      CULTURAL AFFILIATION: Norwegian

ALTERED/MOVED NOTES: Original site. Walls are covered with 8' vertical steel roofing.

---



---

INTERIOR NOTES: Horse stalls are still in place. Four double horse stalls are enclosed by a solid wall East and North sides, with a hayloft above. 6x6x23' posts and 6x6 beams support the roof on each side of the 20' center hay storage area. 80' feed rack on the North and 40' feed rack on the South.

OTHER NOTES: 2x6x8' walls on the North and South sides. 2x6 walls on the gable ends ballooned framed. 6x6 posts are 8' O. C. with extensive 6x6 bracing 16' O.C. Four 1" steel rods tie the North and South walls over the top of the 16' O. C. bracing. These rods appear to have been made by a blacksmith. The rods are about 20' long with closed hooks on each end. The rod is hooked into a large clevis that is bolted into the bottom of a rafter. 2x6 rafters with spaced sheathing and cedar shingles.

\*PHYSICAL NOTES: Large granary on the West wall in the center. Hay storage area in the center is 20' wide, 80' long and 34' from the ground to the peak. Roof is in poor shape and is leaking. Owner thinks she will cover the roof with steel roofing to save the barn. Solid wall on the North side of horse stalls has doors that you lift up to feed horses hay and grain.

---



---

\* = REQUIRED FIELD

**SOUTH DAKOTA STATE HISTORIC PRESERVATION OFFICE  
HISTORIC SITES SURVEY STRUCTURE FORM**



**SKETCH MAP**

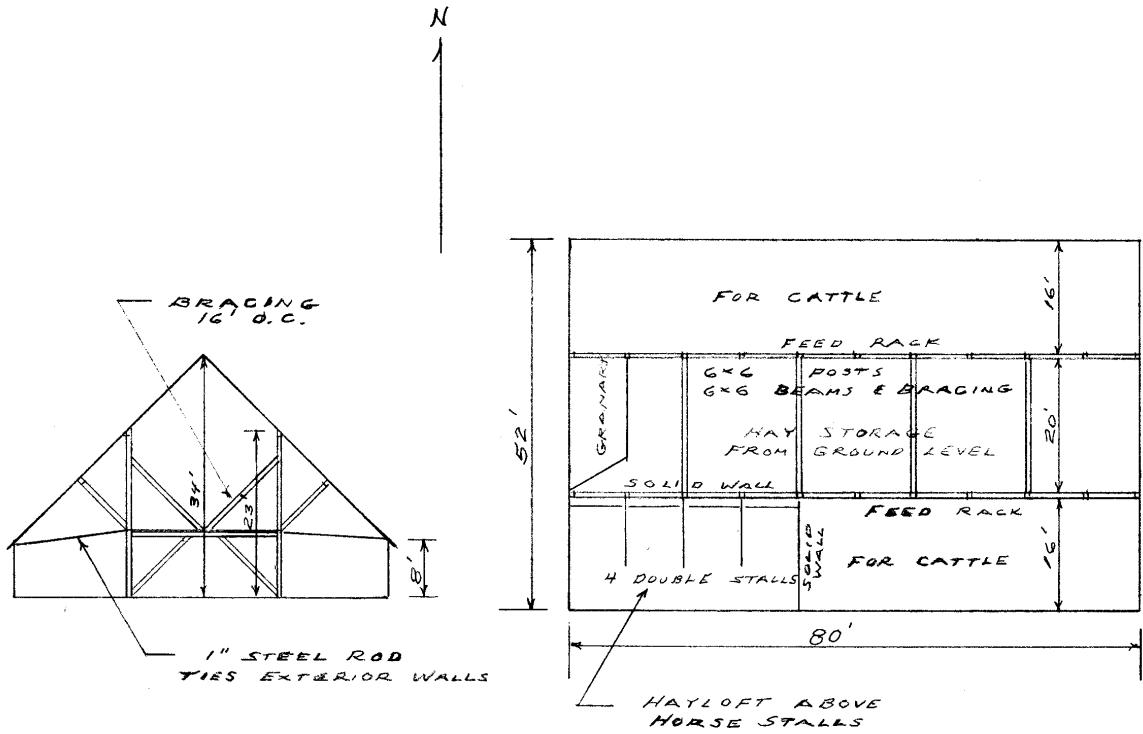

**PHOTOGR**

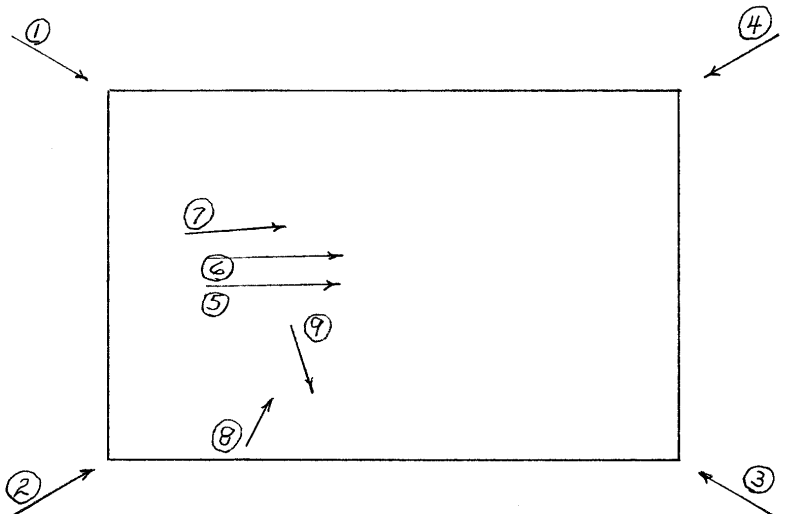

\* = REQUIRED FIELD

\* = REQUIRED FIELD

**SOUTH DAKOTA STATE HISTORIC PRESERVATION OFFICE  
HISTORIC SITES SURVEY STRUCTURE FORM**



**PHOTOGRAPHER:** Jim Stone  
**DATE OF PHOTO:** April 21, 2012

**ROLL NUMBER:** \_\_\_\_\_  
**PHOTO NUMBER:** 1  
**CAMERA DIRECTION:** Looking SE, NW corner



**PHOTOGRAPHER:** Jim Stone  
**DATE OF PHOTO:** April 21, 2012

**ROLL NUMBER:** \_\_\_\_\_  
**PHOTO NUMBER:** 2  
**CAMERA DIRECTION:** Looking NE, SW corner

\* = REQUIRED FIELD

**SOUTH DAKOTA STATE HISTORIC PRESERVATION OFFICE  
HISTORIC SITES SURVEY STRUCTURE FORM**



**PHOTOGRAPHER:** Jim Stone  
**DATE OF PHOTO:** April 21, 2012

**ROLL NUMBER:** \_\_\_\_\_  
**PHOTO NUMBER:** 3  
**CAMERA DIRECTION:** Looking NW, SE corner



**PHOTOGRAPHER:** Jim Stone  
**DATE OF PHOTO:** April 21, 2012

**ROLL NUMBER:** \_\_\_\_\_  
**PHOTO NUMBER:** 4  
**CAMERA DIRECTION:** Looking SW, NE corner

\* = REQUIRED FIELD

**SOUTH DAKOTA STATE HISTORIC PRESERVATION OFFICE  
HISTORIC SITES SURVEY STRUCTURE FORM**

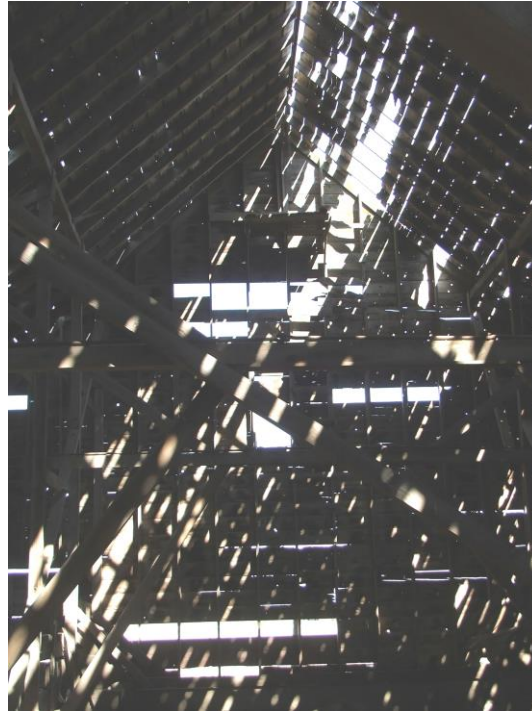

**PHOTOGRAPHER:** Jim Stone  
**DATE OF PHOTO:** April 21, 2012

**ROLL NUMBER:** 5  
**PHOTO NUMBER:** 5  
**CAMERA DIRECTION:** First floor, looking East,  
center bracing 16' O.C.

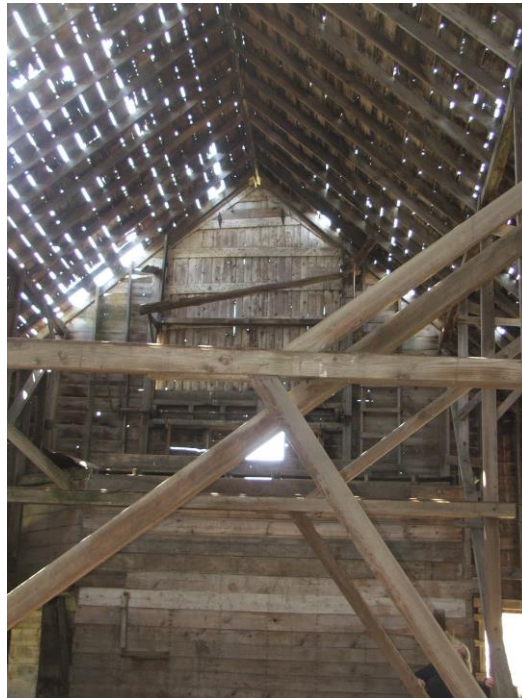

**PHOTOGRAPHER:** Jim Stone  
**DATE OF PHOTO:** April 21, 2012

**ROLL NUMBER:** 6  
**PHOTO NUMBER:** 6  
**CAMERA DIRECTION:** First floor, looking West,  
roof needs roofing

**SOUTH DAKOTA STATE HISTORIC PRESERVATION OFFICE  
HISTORIC SITES SURVEY STRUCTURE FORM**



**PHOTOGRAPHER:** Jim Stone  
**DATE OF PHOTO:** April 21, 2012

**ROLL NUMBER:** \_\_\_\_\_  
**PHOTO NUMBER:** 7

**CAMERA DIRECTION:** First floor, looking East,  
6x6 posts and bracing on  
North side of center hay  
storage area



**PHOTOGRAPHER:** Jim Stone  
**DATE OF PHOTO:** April 21, 2012

**ROLL NUMBER:** \_\_\_\_\_  
**PHOTO NUMBER:** 8

**CAMERA DIRECTION:** First floor, looking North,  
Horse stalls

**SOUTH DAKOTA STATE HISTORIC PRESERVATION OFFICE  
HISTORIC SITES SURVEY STRUCTURE FORM**



**PHOTOGRAPHER:** Jim Stone  
**DATE OF PHOTO:** April 21, 2012

**ROLL NUMBER:** \_\_\_\_\_  
**PHOTO NUMBER:** 9  
**CAMERA DIRECTION:** First floor, looking South, horse stall manger



**SOUTH DAKOTA STATE HISTORIC PRESERVATION OFFICE  
HISTORIC SITES SURVEY STRUCTURE FORM**



T-95-N

**RIVERSIDE PLAT**

R-52-W

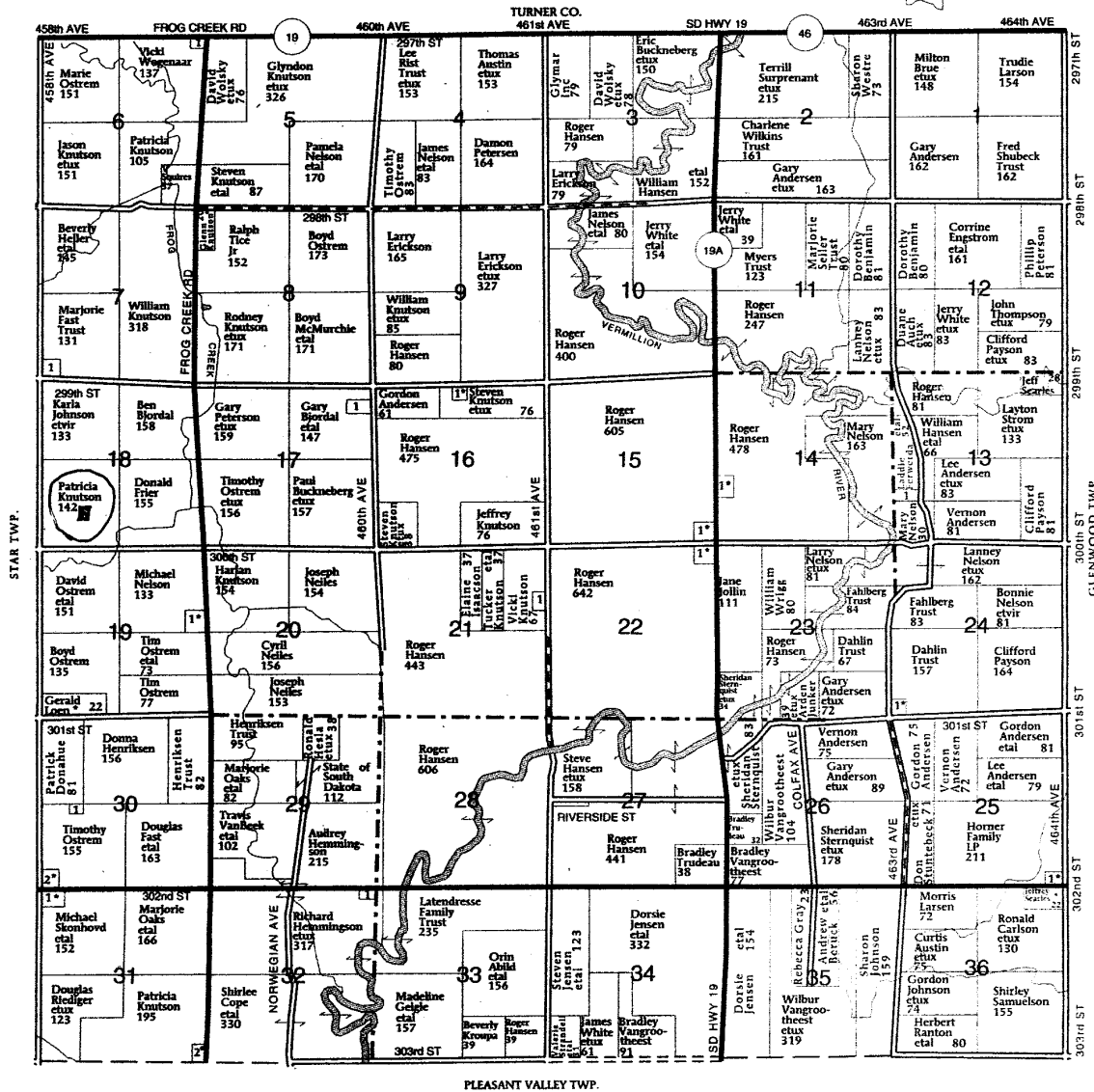

- RIVERSIDE TOWNSHIP**
- SECTION 6**  
1. Martz, Royce 8
- SECTION 7**  
1. Heller, Beverly 6
- SECTION 13**  
1. Lomen, Jeffery 13
- SECTION 14**  
1. Hardsawick, Victor 10

- SECTION 15**  
1. White, Jerry 13
- SECTION 16**  
1. Pease, Quintin 9
- SECTION 17**  
1. Attebury, Linda 10
- SECTION 19**  
1. Olsen, Collin 19
- SECTION 21**  
1. Hansen, Roger 8

- SECTION 22**  
1. Hansen, Scott 14
- SECTION 24**  
1. Andersen, Gary 8
- SECTION 25**  
1. Walters, Austin 9
- SECTION 30**  
1. Henriksen Trust 6  
2. Krekelberg, Karen 8

- SECTION 31**  
1. Donahue, James 10
- SECTION 24**  
1. Elits, Richard 6
- SECTION 32**  
1. Latendresse Family Trust 8

\* = REQUIRED FIELD

## **HISTORY**

This farm located in the SW ¼ of Section 18, Riverside Township, Clay County as homesteaded by Fredwick Kreebs.

The 1894 and 1901 Clay County Atlas lists Frank D. Harvey as the owner.

The 1924 Clay County Atlas lists John Mossifn as the owner.

The 1937 and 1948 Clay County Atlas lists Severt Knudson as the owner.

The 1956 Clay County Atlas lists Stella Knudson as the owner.

### **The Following Is From**

Patricia Knutson and Donald Frier

John Mossifn built this barn in the early 1920's.

They raised a lot of cattle and hogs

John Mossifn had 19 children. The house that they lived in had three rooms on the first floor and 2 rooms on the second floor. The younger children went barefoot in the summer.

Six of the Mossifn boys served in WWII. All six boys came home alive. When the draft board called the seventh son, Donald, John Mossifn went to the draft board and explained that six of his sons were already serving and he needed this son at home to help with the farming operation. The draft board granted this son an agriculture deferment.

John Mossifn was also a blacksmith. He did blacksmithing for neighbors. He most likely manufactured the 1" steel rods that tied the barn together.

They had a daughter who was 4 to 5 years old. She climbed into the hog yard. A large sow started dragging her around the hog yard. She was bitten so many times that she died. They found her in the hog yard latter that day.

Severt Knudson bought this farm after the financial crash in 1929. The Mosifn had lost the farm. Severt Knudson also raised and fed a lot of cattle. Stella (Knudson) Knutson was Severt's daughter and the mother of Patricia J. Knutson. Patricia inherited this farm from her parents.

The Following Is From

## **Wakonda, S. D. Centennial Book 1885 – 1985**

### **John and Clara Mossefin Family**

John Mossifin , born 1876 and clara Adell White, born 1888, were married Dec. 24, 1906. they established their home five northeast of Wakonda, where they lived for 26 years before moving to the swan lake area.

John's parents were immigrants from Norway coming first to Wisconsin, then to Iowa and south Dakota, making the trip by covered wagon. John was born west of Viborg. They family later established their home southwest of Centerville.

Clara was born in Clay County to Ellis and Mary J. Eaton White.

They were parents of 16 children, ten sons and six daughters. All were born at the same farm northeast of Wakonda.

Elma Mae died as a young child and was buried in Barton Cemetery south of Centerville.

Florence Genivive married Elmer Mutchler and made their home in Rapid City. She passed away in 1980 and is buried at Mount Cavalry, Rapid City.

Mary Jeannette married John Terrel. Their children were Elane, Ruth and Roger Dennis.

The fourth daughter is Edith Leola and she was followed by Floyd.

Cecil Vernon died in 1969 and was buried in Hillcrest Cemetery at Irene.

Wallace Berdell married Jean Lane. Their children are Berdell, Rota Jean and John.

Evert Leslie married Arlet Andal, passed away in 1970 and is buried at Lans, near Hudson.

Quentin Luvern lives in Tuscon, Arizona.

Verle, married Mildred Danielson and their children are Darlene, Marilyn, Judy and Jerry.

Lewis Nels lives in Sioux City, Iowa.

Eldon Wayne married Shannon Buckley and their children are Mary, Bernadette, Vicky and Eldon Wayne Jr.

**SOUTH DAKOTA STATE HISTORIC PRESERVATION OFFICE  
HISTORIC SITES SURVEY STRUCTURE FORM**



Arleen Mae lives in Salem, Oregon.

Dale married Marcene Benson and their children are Lynette, Jeannette and Janice.

Donald Married Alice Sonneborn Geomany and have one son Raymond.

Clara LaDell married Norbert Baumgard and their children are Connie ray and Steven Norbert.

Wallace, Everette, Quentin, Verle and Lewis all served in the U. S. Army during WWII. Eldon served in the marines. Donald entered the Air Force after the war, where he served for 20 years.

John owned and operated a threshing machine for 50 years, having threshed on many farms in the community. He also drilled wells having done work on nearly every farm around.

John died in 1952 and Clara in 1970. They are both buried in Hillcrest Cemetery at Irene.