

**SOUTH DAKOTA STATE HISTORIC PRESERVATION OFFICE
HISTORIC SITES SURVEY STRUCTURE FORM**



SITE INFORMATION

*SURVEY DATE: March 10, 2014 *ADDRESS: 30053 461st Ave.
*SURVEYOR: Jim Stone *COUNTY: Clay
*CITY: Centerville

LOCATION DESCRIPTION: From Vermillion, intersection of South Dakota Highway 50 bi-pass and South Dakota Highway 19, North 15-1/2 miles to Riverside Street, turn left (West) about 7/8 mile, on the right (North) side.

LEGAL DESCRIPTION: Tract 2 of Bluff's Addn in NE 1/4, SE 1/4, 21 -95 - 52 Riverside Twp.

*QUARTER 1: NE 1/4 OWNER NAME: Roger Hansen DBA Hansen Properties
*QUARTER 2: _____ OWNER ADDRESS: 700 Broadway Box B
*TOWNSHIP: Riverside OWNER CITY: Centerville
*RANGE: 52 OWNER STATE: South Dakota
*SECTION: 21 OWNER ZIP: 57014
ACRES: 6.66 QUAD NAME: _____
OWNER CODE 1: P
OWNER CODE 2:
OWNER CODE 3:

HISTORIC SIGNIFICANCE

*DOE: _____ REGISTER NAME: _____
*DOE DATE: _____ MULTIPLE PROPERTY NAME: _____
REASON INELIGIBLE: _____

NOMINATION STATUS: _____ CATEGORY: _____
DATE LISTED: _____ SIGNIFICANCE LEVEL 1: N S L
REFERENCE NUMBER: _____ SIGNIFICANCE LEVEL 2: N S L
HISTORIC DISTRICT RATING: C or NC CRITERIA 1: A B C D
PERIOD: _____ CRITERIA 2: A B C D
CRITERIA 3: A B C D
CRITERIA 4: A B C D

SIGNIFICANCE NOTES: _____

* = REQUIRED FIELD

**SOUTH DAKOTA STATE HISTORIC PRESERVATION OFFICE
HISTORIC SITES SURVEY STRUCTURE FORM**



STRUCTURE DETAILS

SHPO ID: _____
 *PROPERTY NAME: _____
 OTHER NAME: _____

CURRENT FUNCTION: Vacant FOUNDATION: Poured concrete
 CURRENT SUBFUNCTION: Vacant ROOF MATERIAL: Steel roofing over cedar shingles
 HISTORIC FUNCTION: Livestock barn ROOF SHAPE: Gambrel roof
 HISTORIC SUBFUNCTION: Hay and grain storage STRUCTURAL SYSTEM: Balloon framing
 OCCUPIED: Yes STYLE: Gambrel roof barn
 TYPE: Livestock barn
Yes with ACCESSIBLE: Yes with permission WALLS: 2x6 studs, 1x10 diagonal sheathing and 1/2"x6" cedar lap siding
 STORIES: 2 SIGNIFICANT PERSON: John Gaylord
 *DATE OF CONSTRUCTION: 1895 to 1910 CULTURAL AFFILIATION: ?

ALTERED/MOVED NOTES: Original site. Most evidence of horse stalls in the barn have been removed. Steel roofing applied over cedar shingles.

INTERIOR NOTES: Two rows of 6x6 posts, (3) 2x10's beams and 2x10 floor joists for the hayloft floor. 9' x 9' granary still in the NE corner and 9' x 9' tack room still in the SE corner. 9' x 9' granary still in the NE corner of hayloft. most of the horse stalls have been removed, but enough evidence to know where they were.

OTHER NOTES: 2X6 stud walls with 1x10 diagonal sheathing and 1/2' x 6" cedar lap siding on all four exterior walls. Windows are 8" x 10" four light with 4 double hung windows in the hayloft. Rafters are 2x6's with two rows of 6x6 posts and double 2x6 beam supporting the hip. 1x6 bracing at the hip between posts. The 2x6 studs, 2x6 rafters, 2x10 floor joists, 2x10 beams and 6x6 posts are all rough sawn cottonwood.

*PHYSICAL NOTES: Barn is in fair condition. *RESTRICTED: Y or N
 *UTM EASTING: _____
 *UTM NORTHING: _____

* = REQUIRED FIELD

**SOUTH DAKOTA STATE HISTORIC PRESERVATION OFFICE
HISTORIC SITES SURVEY STRUCTURE FORM**

SKETCH MAP

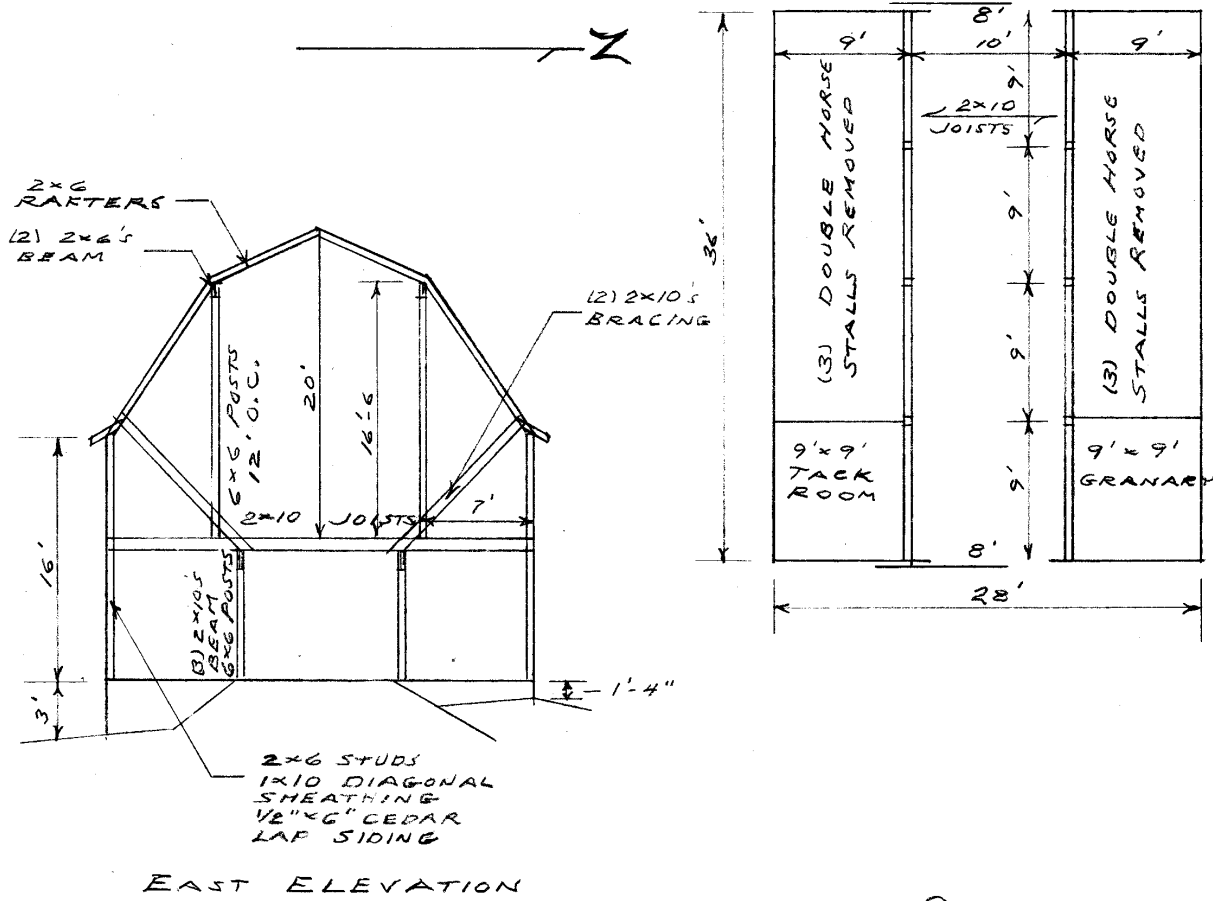

PHOTOGR

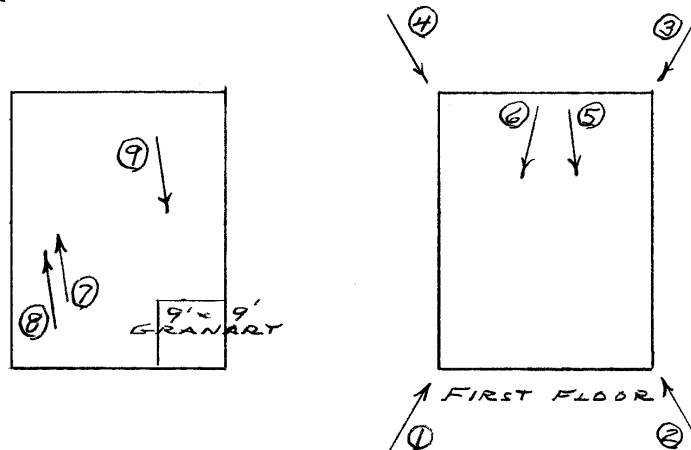

* = REQUIRED FIELD

**SOUTH DAKOTA STATE HISTORIC PRESERVATION OFFICE
HISTORIC SITES SURVEY STRUCTURE FORM**



PHOTOGRAPHER: Jim Stone
DATE OF PHOTO: March 10, 2014

ROLL NUMBER: _____
PHOTO NUMBER: 1
CAMERA DIRECTION: Looking NE, SW corner



PHOTOGRAPHER: Jim Stone
DATE OF PHOTO: March 10, 2014

ROLL NUMBER: _____
PHOTO NUMBER: 2
CAMERA DIRECTION: Looking NW, SE corner

* = REQUIRED FIELD

**SOUTH DAKOTA STATE HISTORIC PRESERVATION OFFICE
HISTORIC SITES SURVEY STRUCTURE FORM**



PHOTOGRAPHER: Jim Stone
DATE OF PHOTO: March 10, 2014

ROLL NUMBER: _____
PHOTO NUMBER: 3
CAMERA DIRECTION: Looking SW, NE corner



PHOTOGRAPHER: Jim Stone
DATE OF PHOTO: March 10, 2014

ROLL NUMBER: _____
PHOTO NUMBER: 4
CAMERA DIRECTION: Looking SE, NW corner

* = REQUIRED FIELD

**SOUTH DAKOTA STATE HISTORIC PRESERVATION OFFICE
HISTORIC SITES SURVEY STRUCTURE FORM**



PHOTOGRAPHER: Jim Stone
DATE OF PHOTO: March 10, 2014

ROLL NUMBER: _____
PHOTO NUMBER: 5

First floor, looking NE at 6x6 posts, (3) 2x10's beams and 2x10 floor joists, note granary in NE corner.

CAMERA DIRECTION: _____



PHOTOGRAPHER: Jim Stone
DATE OF PHOTO: March 10, 2014

ROLL NUMBER: _____
PHOTO NUMBER: 6

First floor, looking SE, 6x6 posts, (3) 2x10's beam and 2x10 floor joists, tack room in SE corner.

CAMERA DIRECTION: _____

* = REQUIRED FIELD

**SOUTH DAKOTA STATE HISTORIC PRESERVATION OFFICE
HISTORIC SITES SURVEY STRUCTURE FORM**



PHOTOGRAPHER: Jim Stone
DATE OF PHOTO: March 10, 2014

ROLL NUMBER: _____
PHOTO NUMBER: 7

CAMERA DIRECTION: Hayloft, looking SW, 6x6 posts, double 2x6 beam and 2x6 rafters.



PHOTOGRAPHER: Jim Stone
DATE OF PHOTO: March 10, 2014

ROLL NUMBER: _____
PHOTO NUMBER: 8

CAMERA DIRECTION: Hayloft, looking SW, 6x6 post with (2) 2x10 bracing from bottom of rafter down to the bottom of posts and tied to floor joists.

**SOUTH DAKOTA STATE HISTORIC PRESERVATION OFFICE
HISTORIC SITES SURVEY STRUCTURE FORM**



PHOTOGRAPHER: Jim Stone
DATE OF PHOTO: March 10, 2014

ROLL NUMBER: _____
PHOTO NUMBER: 9
CAMERA DIRECTION: Hayloft, looking NE, 9' x 9' granary in NE corner of hayloft.

HISTORY

This farm located in the NE ¼, SE ¼ of Section 21, Riverside Township, Clay County was homesteaded by John Halver.

The 1894 Clay County Atlas lists John Halver as the owner.

The 1901 and 1912 Clay County Atlas lists John L. Gaylord as the owner

The 1924, 1937, 1948 and 1956 Clay County Atlas lists Myrtle Shepard Lee as the owner. In 1937 M. Buckinberg was listed as the operator (renter).