

**SOUTH DAKOTA STATE HISTORIC PRESERVATION OFFICE
HISTORIC SITES SURVEY STRUCTURE FORM**



SITE INFORMATION

*SURVEY DATE: May 24, 2012 *ADDRESS: 30088 458th Street
*SURVEYOR: Jim Stone *COUNTY: Clay
*CITY: Wakonda

LOCATION DESCRIPTION: From the intersection of South Dakota Highway 50 bi-pass and South Dakota Highway 19, North 15 miles, turn left (West) on 302nd Street, 4 miles turn right (North) about 1-1/8th mile , turn right into lane

LEGAL DESCRIPTION: W 485' of S 1,976' SW ¼ 19 – 95 – 52 Riverside Twp.

*QUARTER 1: SW 1/4
*QUARTER 2: _____
*TOWNSHIP: Riverside
*RANGE: 52
*SECTION: 19
ACRES: 22

OWNER NAME: Jerry Loen
OWNER ADDRESS: 30088 458th Street
OWNER CITY: Wakonda
OWNER STATE: South Dakota
OWNER ZIP: 57073
QUAD NAME: _____

OWNER CODE 1: P
OWNER CODE 2: F S L P
OWNER CODE 3: F S L P

HISTORIC SIGNIFICANCE

*DOE: _____
*DOE DATE: _____
REASON INELIGIBLE: _____

REGISTER NAME: _____
MULTIPLE PROPERTY NAME: _____

NOMINATION STATUS: _____
DATE LISTED: _____
REFERENCE NUMBER: _____
HISTORIC DISTRICT RATING: C or NC
PERIOD: _____

CATEGORY: _____
SIGNIFICANCE LEVEL 1: N S L
SIGNIFICANCE LEVEL 2: N S L
CRITERIA 1: A B C D
CRITERIA 2: A B C D
CRITERIA 3: A B C D
CRITERIA 4: A B C D

SIGNIFICANCE NOTES: _____

* = REQUIRED FIELD

**SOUTH DAKOTA STATE HISTORIC PRESERVATION OFFICE
HISTORIC SITES SURVEY STRUCTURE FORM**



STRUCTURE DETAILS

SHPO ID: _____
 *PROPERTY NAME: _____
 OTHER NAME: _____

CURRENT FUNCTION:	<u>Automotive repair shop</u>	FOUNDATION:	<u>Poured concrete</u>
CURRENT SUBFUNCTION:	<u>Storage</u>	ROOF MATERIAL:	<u>Steel over cedar shingles</u>
HISTORIC FUNCTION:	<u>Livestock barn</u>	ROOF SHAPE:	<u>Gambrel</u>
HISTORIC SUBFUNCTION:	<u>Hay and grain storage</u>	STRUCTURAL SYSTEM:	<u>Balloon framing</u>
		STYLE:	<u>Gambrel roof barn</u>
OCCUPIED:	<u>Yes</u>	TYPE:	<u>Livestock barn</u>
			<u>Rough sawn 2x6 with 1x6 drop siding</u>
ACCESSIBLE:	<u>Yes with permission</u>	WALLS:	<u>_____</u>
			<u>_____</u>
STORIES:	<u>2</u>	SIGNIFICANT PERSON:	<u>?</u>
*DATE OF CONSTRUCTION:	<u>?</u>	CULTURAL AFFILIATION:	<u>?</u>

ALTERED/MOVED NOTES: Original site. Roof covered with steel roofing. 30' by 36' addition added on the East side. Addition rafters start at the peak of the original barn. The addition dwarfs the original barn. Milk cow stanchions and horse stalls have been removed. 10' x 11'-6" granary removed.

INTERIOR NOTES: Two rows 4x6 posts with two 2x8's for a beam. Rough sawn 2x10's for floor joists.

OTHER NOTES: Rough sawn 2x6 walls 10' high on all four walls. Rough sawn 2x6 stud walls above on the gable ends. No sheathing, 1x6 #106 drop siding applied directly to the studs. 9"x 12" four light windows with galv. metal triangles on each side of the windows. This allows the window to tip in at the top for ventilation and keeps out the rain. It also directs the air up over the livestock and eliminates any direct drafts on livestock.

***PHYSICAL NOTES:** Barn is in excellent condition.
The family is fixing the barn up for a daughter's wedding, reception and wedding dance.

* = REQUIRED FIELD

**SOUTH DAKOTA STATE HISTORIC PRESERVATION OFFICE
HISTORIC SITES SURVEY STRUCTURE FORM**

SKETCH MAP

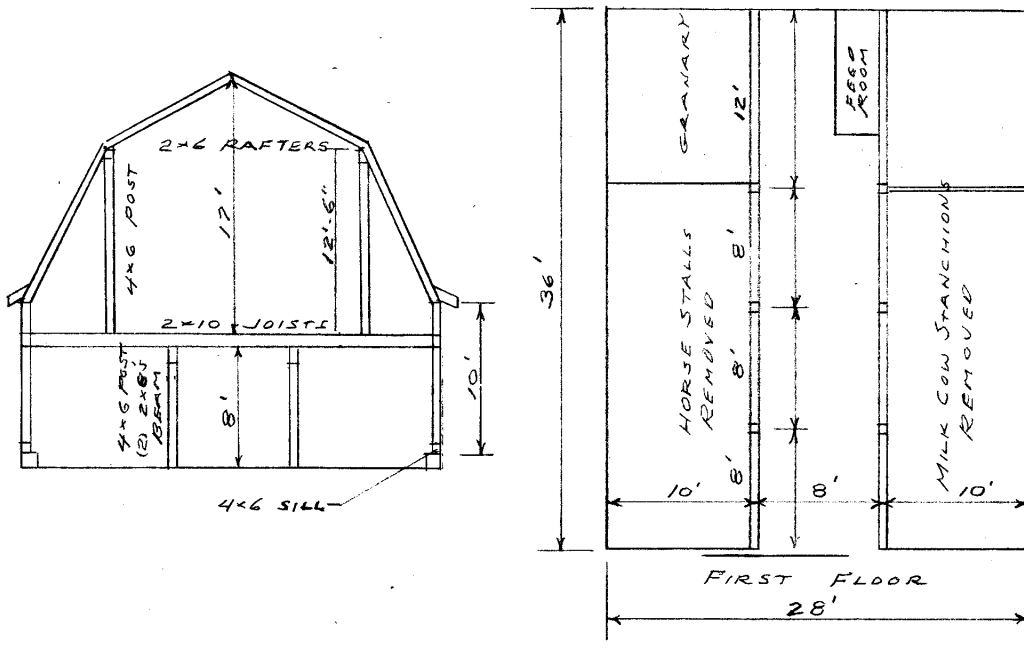

PHOTOGR

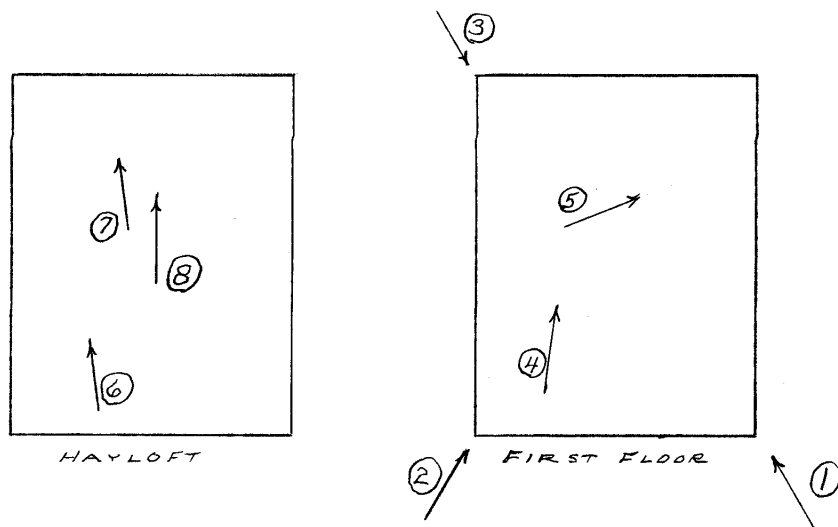

* = REQUIRED FIELD

**SOUTH DAKOTA STATE HISTORIC PRESERVATION OFFICE
HISTORIC SITES SURVEY STRUCTURE FORM**



PHOTOGRAPHER: Jim Stone
DATE OF PHOTO: May 24, 2012

ROLL NUMBER: _____
PHOTO NUMBER: 1
CAMERA DIRECTION: Looking NW, SE corner



* = REQUIRED FIELD

**SOUTH DAKOTA STATE HISTORIC PRESERVATION OFFICE
HISTORIC SITES SURVEY STRUCTURE FORM**



PHOTOGRAPHER: Jim Stone
DATE OF PHOTO: May 24, 2012

ROLL NUMBER: _____
PHOTO NUMBER: 2
CAMERA DIRECTION: Looking NE, SW corner



PHOTOGRAPHER: Jim Stone
DATE OF PHOTO: May 24, 2012

ROLL NUMBER: _____
PHOTO NUMBER: 3
CAMERA DIRECTION: Looking SE, Nw corner

**SOUTH DAKOTA STATE HISTORIC PRESERVATION OFFICE
HISTORIC SITES SURVEY STRUCTURE FORM**



PHOTOGRAPHER: Jim Stone
DATE OF PHOTO: May 24, 2012

ROLL NUMBER: _____
PHOTO NUMBER: 4

CAMERA DIRECTION: First floor, looking North,
6x6 posts, two 2x8's
beam, rough sawn
2x10's for floor joists



PHOTOGRAPHER: Jim Stone
DATE OF PHOTO: May 24, 2012

ROLL NUMBER: _____
PHOTO NUMBER: 5

CAMERA DIRECTION: First floor, looking East,
granary in NE corner

**SOUTH DAKOTA STATE HISTORIC PRESERVATION OFFICE
HISTORIC SITES SURVEY STRUCTURE FORM**



PHOTOGRAPHER: Jim Stone
DATE OF PHOTO: May 24, 2012

ROLL NUMBER: _____
PHOTO NUMBER: 6
CAMERA DIRECTION: Hayloft, 4x6 posts
supporting roof hip



PHOTOGRAPHER: Jim Stone
DATE OF PHOTO: May 24, 2012

ROLL NUMBER: _____
PHOTO NUMBER: 7
CAMERA DIRECTION: Hayloft, looking North,
part of granary, rough
sawn 2x6 stud wall

**SOUTH DAKOTA STATE HISTORIC PRESERVATION OFFICE
HISTORIC SITES SURVEY STRUCTURE FORM**



PHOTOGRAPHER: Jim Stone
DATE OF PHOTO: May 24, 2012

ROLL NUMBER: _____
PHOTO NUMBER: 8
CAMERA DIRECTION: Hayloft, looking North,
trolley on hay track

SOUTH DAKOTA STATE HISTORIC PRESERVATION OFFICE HISTORIC SITES SURVEY STRUCTURE FORM



T-95-N

RIVERSIDE PLAT

(Landowners)

R-52-W

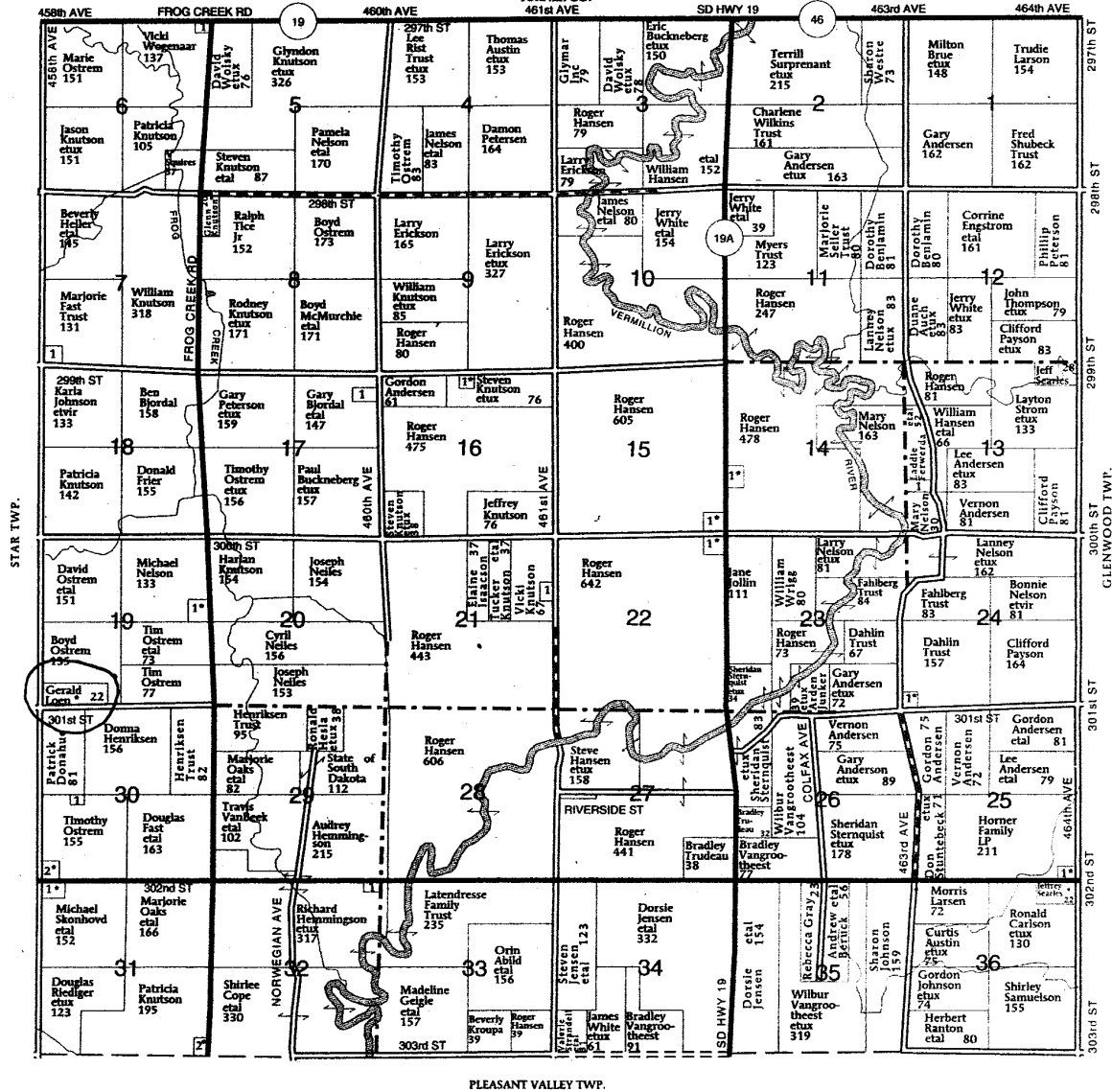

RIVERSIDE TOWNSHIP

- SECTION 6**
1. Martz, Royce 8
- SECTION 7**
1. Heller, Beverly 6
- SECTION 13**
1. Loman, Jeffery 13
- SECTION 14**
1. Hardaswick, Victor 10

- SECTION 15**
1. White, Jerry 13
- SECTION 16**
1. Pease, Quintin 9
- SECTION 17**
1. Attebury, Linda 30
- SECTION 19**
1. Olsen, Colin 19
- SECTION 21**
1. Hansen, Roger 8

- SECTION 22**
1. Hansen, Scott 14
- SECTION 24**
1. Andersen, Gary 8
- SECTION 25**
1. Walters, Austin 9
- SECTION 30**
1. Henriksen Trust 6
- 2. Krokelsberg, Karen 8

- SECTION 31**
1. Donahue, James 10
- 2. Ehrs, Richard 6
- SECTION 32**
1. Latendresse Family Trust 8

* = REQUIRED FIELD

History

This farm located, in the SW ¼ of section 19, Riverside Township, Clay County was homesteaded by William C. Washburn.

The 1894 and 1901 Clay County Atlas lists John H. Baker as the owner.

The 1912 Clay County Atlas lists W. O. Baker as the owner.

The 1924 Clay County Atlas lists John H. Baker as the owner.

The 1937 Clay County Atlas lists Rosine E. Frier as the owner.

The 1948 and 1956 Clay County Atlas lists R. W. Frier as the owner.