

**SOUTH DAKOTA STATE HISTORIC PRESERVATION OFFICE  
HISTORIC SITES SURVEY STRUCTURE FORM**



**SITE INFORMATION**

\*SURVEY DATE: July 30, 2013 \*ADDRESS: 30832 Frog Creek Road  
\*SURVEYOR: Jim Stone \*COUNTY: Clay  
\*CITY: Vermillion

LOCATION DESCRIPTION: From Vermillion, intersection of South Dakota Highway 50 bi-pass and South Dakota Highway 19, North about 11 miles to 306<sup>th</sup> Street, turn left (West) about 3-1/2 miles to Frog Creek Road, turn right (North) about 3/4 mile, on the right, (East) side.

LEGAL DESCRIPTION: S 1/2, NW 1/4, 32 – 94 – 52 Pleasant Valley Twp.

\*QUARTER 1: NW 1/4  
\*QUARTER 2: \_\_\_\_\_  
\*TOWNSHIP: Pleasant Valley  
\*RANGE: 52  
\*SECTION: 32  
ACRES: 78.55

OWNER NAME: Richard & Debra Peterson  
OWNER ADDRESS: 30832 Frog Creek Road  
OWNER CITY: Vermillion  
OWNER STATE: South Dakota  
OWNER ZIP: 57069  
QUAD NAME: \_\_\_\_\_

OWNER CODE 1: P  
OWNER CODE 2: \_\_\_\_\_  
OWNER CODE 3: \_\_\_\_\_

**HISTORIC SIGNIFICANCE**

\*DOE: \_\_\_\_\_  
\*DOE DATE: \_\_\_\_\_  
REASON INELIGIBLE: \_\_\_\_\_

REGISTER NAME: \_\_\_\_\_  
MULTIPLE PROPERTY NAME: \_\_\_\_\_

NOMINATION STATUS: \_\_\_\_\_  
DATE LISTED: \_\_\_\_\_  
REFERENCE NUMBER: \_\_\_\_\_  
HISTORIC DISTRICT RATING: C or NC  
PERIOD: \_\_\_\_\_

CATEGORY: \_\_\_\_\_  
SIGNIFICANCE LEVEL 1: N S L  
SIGNIFICANCE LEVEL 2: N S L  
CRITERIA 1: A B C D  
CRITERIA 2: A B C D  
CRITERIA 3: A B C D  
CRITERIA 4: A B C D

SIGNIFICANCE NOTES: \_\_\_\_\_

**STRUCTURE DETAILS**

\* = REQUIRED FIELD

**SOUTH DAKOTA STATE HISTORIC PRESERVATION OFFICE  
HISTORIC SITES SURVEY STRUCTURE FORM**



SHPO ID: \_\_\_\_\_  
 \*PROPERTY NAME: \_\_\_\_\_  
 OTHER NAME: \_\_\_\_\_

CURRENT FUNCTION: <u>Vacant</u>	FOUNDATION: <u>Native stone and poured concrete</u>
CURRENT SUBFUNCTION: <u>Storage</u>	ROOF MATERIAL: <u>Steel roofing over cedar shingles</u>
HISTORIC FUNCTION: <u>Livestock barn</u>	ROOF SHAPE: <u>Gable roof</u>
HISTORIC SUBFUNCTION: <u>Hay and grain storage</u>	STRUCTURAL SYSTEM: <u>Mortised posts and beams</u>
	STYLE: <u>Post &amp; beam gable roof barn</u>
OCCUPIED: <u>No</u>	TYPE: <u>Livestock barn</u>
	<u>2x6 studs, 1x8 ship lap and 1/2"x6" cedar lap siding.</u>
ACCESSIBLE: <u>Yes with permission</u>	WALLS: _____
STORIES: <u>2</u>	SIGNIFICANT PERSON: <u>J. O. Johnson</u>
*DATE OF CONSTRUCTION: <u>Late 1800's</u>	CULTURAL AFFILIATION: <u>Norwegian</u>

ALTERED/MOVED NOTES: Original site. Any milk cow stanchions has been removed. Roof covered with steel roofing over cedar shingles. Native stone foundation has been patched, plastered and replaced with poured concrete in places. A 20' x 100' addition has been added on the East side. Roof covered with steel roofing.

INTERIOR NOTES: Two rows of 6x6 posts with 6x6 beams and one 2x6 solid wall support hayloft floor. The hayloft floor joists are 2x8' on the West 22' and run North to South. 2x12 floor joists run East to West on the East 14'. This part of the hayloft floor is 6" lower than the West side.

OTHER NOTES: 2x6 stud walls, 1x8 shiplap and 1/2"x 6" cedar lap siding on all four walls. Rafters are 2x6's . Rough sawn 6x6 Douglas fir posts and beams in the hayloft with 6x6 posts from the foundation to roof line. Theses posts support the 6x6 beams that are 7' above the hayloft floor. 4x4 angle braces on posts and beams. The posts and beams are all mortised and tendon with pegs. Windows are 9" x12" four light and 4"x24" four light. All of the 2x6's, 2x8's, 2x12's and roof sheathing are rough sawn cottonwood.

\*PHYSICAL NOTES: Barn is in good condition.

\*UTM ZONE: \_\_\_\_\_ \*RESTRICTED: Y or N  
 \*UTM EASTING: \_\_\_\_\_  
 \*UTM NORTHING: \_\_\_\_\_

\* = REQUIRED FIELD



**SOUTH DAKOTA STATE HISTORIC PRESERVATION OFFICE  
HISTORIC SITES SURVEY STRUCTURE FORM**



**SKETCH MAP**

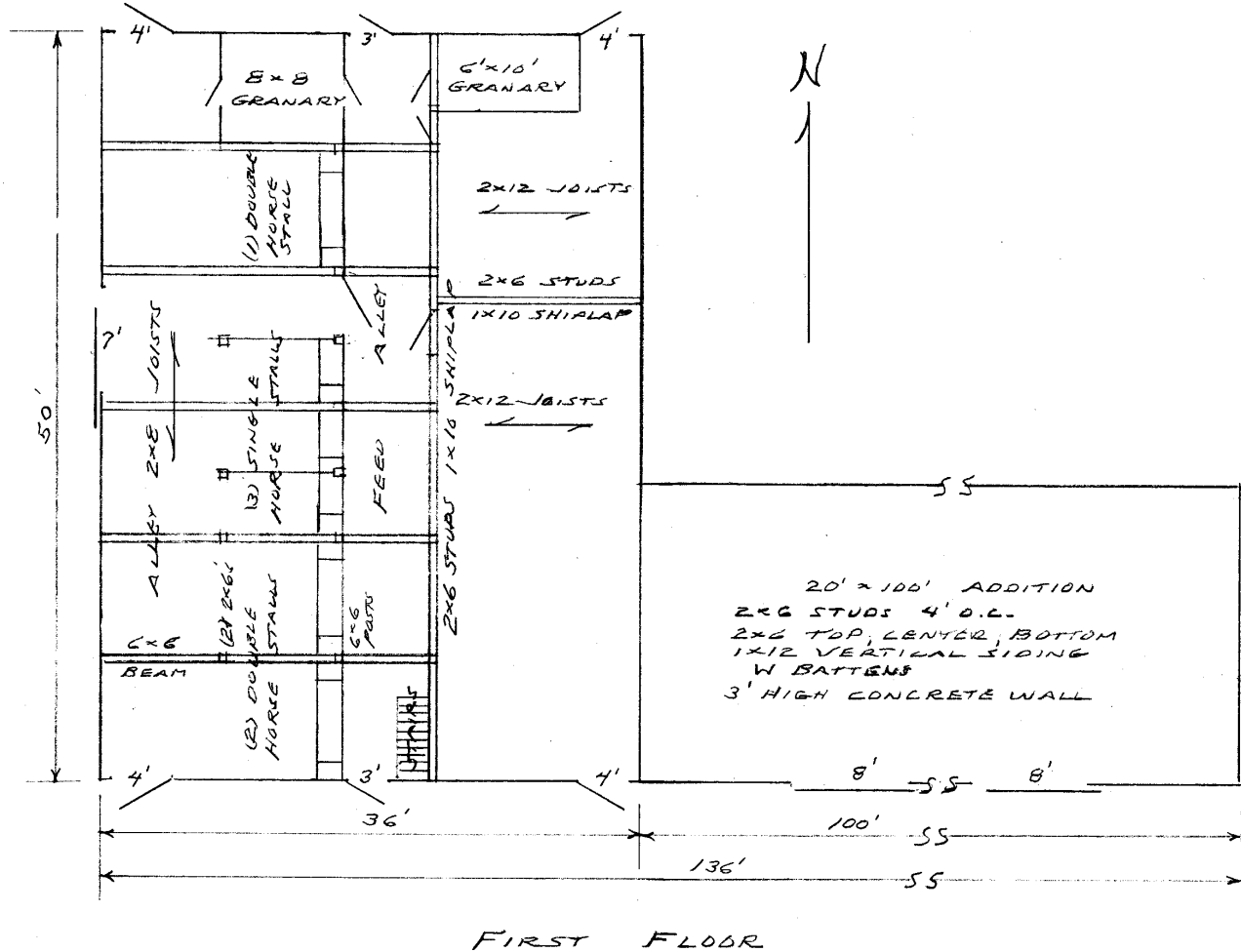

**PHOTOGR**

\* = REQUIRED FIELD

**SOUTH DAKOTA STATE HISTORIC PRESERVATION OFFICE  
HISTORIC SITES SURVEY STRUCTURE FORM**



**PHOTOGRAPHER:** Jim Stone  
**DATE OF PHOTO:** July 30, 2013

**ROLL NUMBER:** \_\_\_\_\_  
**PHOTO NUMBER:** 1  
**CAMERA DIRECTION:** Looking NE, SW corner



**PHOTOGRAPHER:** Jim Stone  
**DATE OF PHOTO:** July 30, 2013

**ROLL NUMBER:** \_\_\_\_\_  
**PHOTO NUMBER:** 2  
**CAMERA DIRECTION:** Looking NW, SE corner

\* = REQUIRED FIELD



**SOUTH DAKOTA STATE HISTORIC PRESERVATION OFFICE  
HISTORIC SITES SURVEY STRUCTURE FORM**



**PHOTOGRAPHER:** Jim Stone  
**DATE OF PHOTO:** July 30, 2013

**ROLL NUMBER:** \_\_\_\_\_  
**PHOTO NUMBER:** 3  
**CAMERA DIRECTION:** Looking SW, NE corner



**PHOTOGRAPHER:** Jim Stone  
**DATE OF PHOTO:** July 30, 2013

**ROLL NUMBER:** \_\_\_\_\_  
**PHOTO NUMBER:** 4  
**CAMERA DIRECTION:** Looking SE, NW corner

\* = REQUIRED FIELD

**SOUTH DAKOTA STATE HISTORIC PRESERVATION OFFICE  
HISTORIC SITES SURVEY STRUCTURE FORM**



**PHOTOGRAPHER:** Jim Stone  
**DATE OF PHOTO:** July 30, 2013

**ROLL NUMBER:** \_\_\_\_\_  
**PHOTO NUMBER:** 5

**First floor, looking SW,  
6x6 post, 6x6 beam, 2x8  
joists and horse stalls  
on West side.**

**CAMERA DIRECTION:** \_\_\_\_\_



**PHOTOGRAPHER:** Jim Stone  
**DATE OF PHOTO:** July 30, 2013

**ROLL NUMBER:** \_\_\_\_\_  
**PHOTO NUMBER:** 6

**First floor, looking SE on  
East side, note rough  
sawn 2x12 floor joists  
and 8' sliding door  
framed to 4' swing door**

**CAMERA DIRECTION:** \_\_\_\_\_

\* = REQUIRED FIELD

**SOUTH DAKOTA STATE HISTORIC PRESERVATION OFFICE  
HISTORIC SITES SURVEY STRUCTURE FORM**



**PHOTOGRAPHER:** Jim Stone  
**DATE OF PHOTO:** July 30, 2013

**ROLL NUMBER:** \_\_\_\_\_  
**PHOTO NUMBER:** 7

**First floor, looking North, in center feed alley, note granaries on each side on North wall.**

**CAMERA DIRECTION:** \_\_\_\_\_



**PHOTOGRAPHER:** Jim Stone  
**DATE OF PHOTO:** July 30, 2013

**ROLL NUMBER:** \_\_\_\_\_  
**PHOTO NUMBER:** 8

**Hayloft. looking North, 6x6 beam on 6x6 post supporting 6x6 post up to hip, all mortised and tendon with pegs.**

**CAMERA DIRECTION:** \_\_\_\_\_

\* = REQUIRED FIELD



**SOUTH DAKOTA STATE HISTORIC PRESERVATION OFFICE  
HISTORIC SITES SURVEY STRUCTURE FORM**



**PHOTOGRAPHER:** Jim Stone  
**DATE OF PHOTO:** July 30, 2013

**ROLL NUMBER:** \_\_\_\_\_  
**PHOTO NUMBER:** 9

**Hayloft. looking NE, 6x6 beam on 6x6 post supporting slanted 6x6 post to roof hip.**

**CAMERA DIRECTION:** \_\_\_\_\_



**PHOTOGRAPHER:** Jim Stone  
**DATE OF PHOTO:** July 30, 2013

**ROLL NUMBER:** \_\_\_\_\_  
**PHOTO NUMBER:** 10

**Hayloft. looking NE, 6x6 beam on 6x6 post supporting 6x6 post up to hip, all mortised and tendon with pegs.**

**CAMERA DIRECTION:** \_\_\_\_\_

\* = REQUIRED FIELD

**SOUTH DAKOTA STATE HISTORIC PRESERVATION OFFICE  
HISTORIC SITES SURVEY STRUCTURE FORM**



**PHOTOGRAPHER:** Jim Stone  
**DATE OF PHOTO:** July 30, 2013

**ROLL NUMBER:** \_\_\_\_\_  
**PHOTO NUMBER:** 11

**Hayloft. looking NW, 6x6 beam on 6x6 post supporting 6x6 post up to hip, note all of the 4x4 bracing also mortised and tendon, no pegs**

**CAMERA DIRECTION:** \_\_\_\_\_



**PHOTOGRAPHER:** Jim Stone  
**DATE OF PHOTO:** July 30, 2013

**ROLL NUMBER:** \_\_\_\_\_  
**PHOTO NUMBER:** 12

**Hayloft. looking NE, 6x6x16' post in wall on 6 supporting 6x6 beam and 4x6 beam on top of wall, all mortised and tendon with pegs.**

**CAMERA DIRECTION:** \_\_\_\_\_

\* = REQUIRED FIELD

**SOUTH DAKOTA STATE HISTORIC PRESERVATION OFFICE  
HISTORIC SITES SURVEY STRUCTURE FORM**

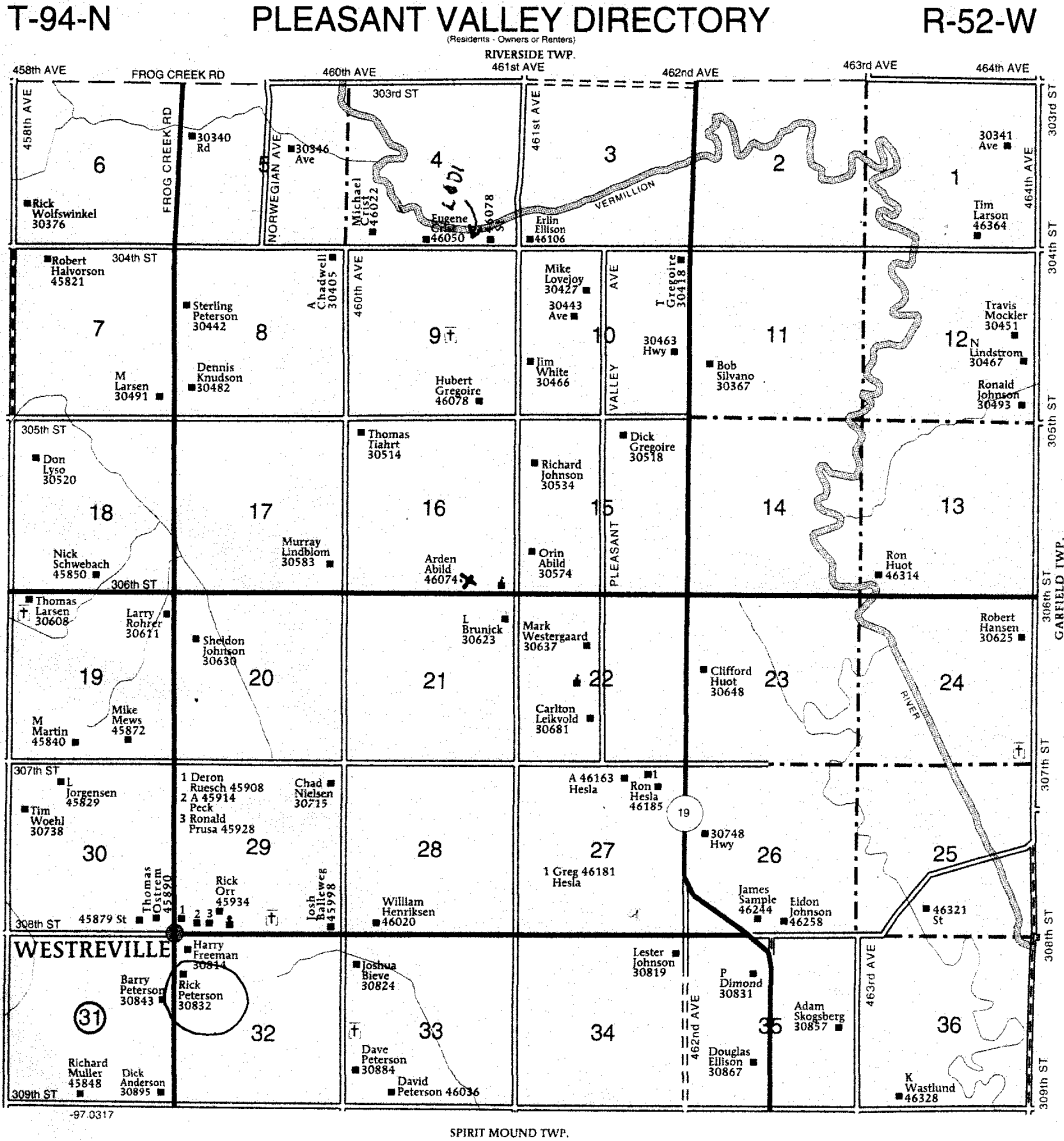

## **HISTORY**

This farm located in the NW ¼ of Section 32, Pleasant Valley Township, Clay County was homesteaded by Nels Thompson.

The 1894 Clay County Atlas lists J. O. Johnson as the owner.

The 1901 Clay County Atlas lists William W. Park as the owner.

The 1912 Clay County Atlas lists Hans Skonhovd as the owner.

The 1924 and 1937 Clay County Atlas lists Henry Witt as the owner.

The 1948 and 1956 Clay County Atlas lists Henry J. Witt as the owner.