

**SOUTH DAKOTA STATE HISTORIC PRESERVATION OFFICE  
HISTORIC SITES SURVEY STRUCTURE FORM**



**SITE INFORMATION**

\*SURVEY DATE: December 16, 2012 \*ADDRESS: 30857 463rd Ave.  
\*SURVEYOR: Jim Stone \*COUNTY: Clay  
\*CITY: Vermillion

LOCATION DESCRIPTION: Vermillion, from the intersection of South Dakota Highway 50 bi-pass and South Dakota Highway 19, North 8 miles to 309<sup>th</sup> Street, turn right (East) about 1/2 mile to 463<sup>rd</sup> Ave., turn left (North) about 1/2 mile on the left (West) side.

LEGAL DESCRIPTION: Johnson's Addition, SE 1/4, 35 - 94 - 52 Pleasant Valley Twp.

\*QUARTER 1: SE 1/4  
\*QUARTER 2: \_\_\_\_\_  
\*TOWNSHIP: Pleasant Valley  
\*RANGE: 52  
\*SECTION: 35  
ACRES: 12.38

OWNER NAME: Cristeen Wibben  
OWNER ADDRESS: 30857 463<sup>rd</sup> Ave.  
OWNER CITY: Vermillion  
OWNER STATE: South Dakota  
OWNER ZIP: 57069  
QUAD NAME: \_\_\_\_\_

OWNER CODE 1: P  
OWNER CODE 2: \_\_\_\_\_  
OWNER CODE 3: \_\_\_\_\_

**HISTORIC SIGNIFICANCE**

\*DOE: \_\_\_\_\_  
\*DOE DATE: \_\_\_\_\_  
REASON INELIGIBLE: \_\_\_\_\_

REGISTER NAME: \_\_\_\_\_  
MULTIPLE PROPERTY NAME: \_\_\_\_\_

NOMINATION STATUS: \_\_\_\_\_  
DATE LISTED: \_\_\_\_\_  
REFERENCE NUMBER: \_\_\_\_\_  
HISTORIC DISTRICT RATING: C or NC  
PERIOD: \_\_\_\_\_

CATEGORY: \_\_\_\_\_  
SIGNIFICANCE LEVEL 1: N S L  
SIGNIFICANCE LEVEL 2: N S L  
CRITERIA 1: A B C D  
CRITERIA 2: A B C D  
CRITERIA 3: A B C D  
CRITERIA 4: A B C D

SIGNIFICANCE NOTES: \_\_\_\_\_  
\_\_\_\_\_  
\_\_\_\_\_

**STRUCTURE DETAILS**

\* = REQUIRED FIELD

**SOUTH DAKOTA STATE HISTORIC PRESERVATION OFFICE  
HISTORIC SITES SURVEY STRUCTURE FORM**



SHPO ID: \_\_\_\_\_  
 \*PROPERTY NAME: \_\_\_\_\_  
 OTHER NAME: \_\_\_\_\_

CURRENT FUNCTION: <u>Calving and cattle</u>	FOUNDATION: <u>Poured concrete foundation</u>
CURRENT SUBFUNCTION: <u>Storage</u>	ROOF MATERIAL: <u>Steel roofing over cedar shingles</u>
HISTORIC FUNCTION: <u>Livestock barn</u>	ROOF SHAPE: <u>Gothic round</u>
HISTORIC SUBFUNCTION: <u>Hay storage</u>	STRUCTURAL SYSTEM: <u>Balloon framing Wisconsin dairy barn</u>
OCCUPIED: <u>Yes</u>	STYLE: <u>barn</u>
ACCESSIBLE: <u>Yes with permission</u>	TYPE: <u>Livestock barn 2x6 studs with 1x10 sheathing and steel siding</u>
STORIES: <u>2</u>	SIGNIFICANT PERSON: <u>J. F. Hickson</u>
*DATE OF CONSTRUCTION: <u>1920's</u>	CULTURAL AFFILIATION: <u>?</u>

ALTERED/MOVED NOTES: Original site. Any evidence of milk cow stanchions or horse stalls has been removed. Walls on first floor are lined. 4x4 posts have been added for lambing pens. Roof has been covered with steel roofing. 24' x 30' lean-to addition added to the West side at a later date.

INTERIOR NOTES: Has four rows of 4x6 posts, with 6x6's for a beams and a short beam with one post for the access to hayloft. Also a 2x4 wall with solid sheathing in the center of barn from the North wall South 12'. Double 2x6 floor joists that run East to West.

OTHER NOTES: 2x6 stud walls with 1x10 sheathing and embossed brick steel siding. Rafters are 1x4's five ply thick and 2' O. C. and a rafter, site built from 3 plies of 1x12 x 8'-6" cedar, 8' O. C.

2x6 brace from top of wall down to hayloft floor, 8' O. C. 2x6 studs and bracing, 6x6 posts and beams are rough sawn cottonwood. 2x6 studs above 12' walls on the gable ends and rafters are milled lumber. Two long 2x6 braces 10' O.C. from center of East gable end wall down to the hayloft floor. Windows are 8"x10" four light on first floor and two 8'x10" four light over 8"x10" four light in each gable end.

\*PHYSICAL NOTES: Barn is in fair to good condition.

\*UTM ZONE: \_\_\_\_\_

\*RESTRICTED: Y or N

\*UTM EASTING: \_\_\_\_\_

\*UTM NORTHING: \_\_\_\_\_

**SOUTH DAKOTA STATE HISTORIC PRESERVATION OFFICE  
HISTORIC SITES SURVEY STRUCTURE FORM**

**SKETCH MAP**

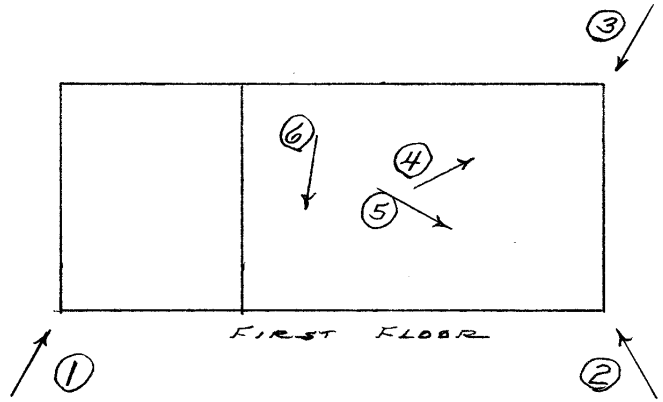
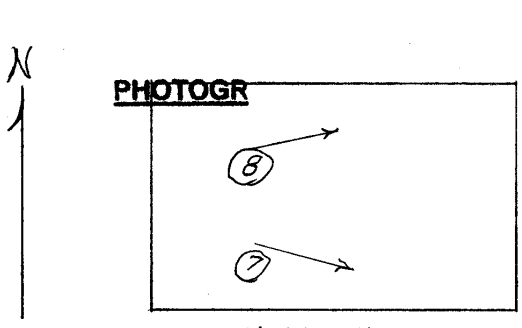
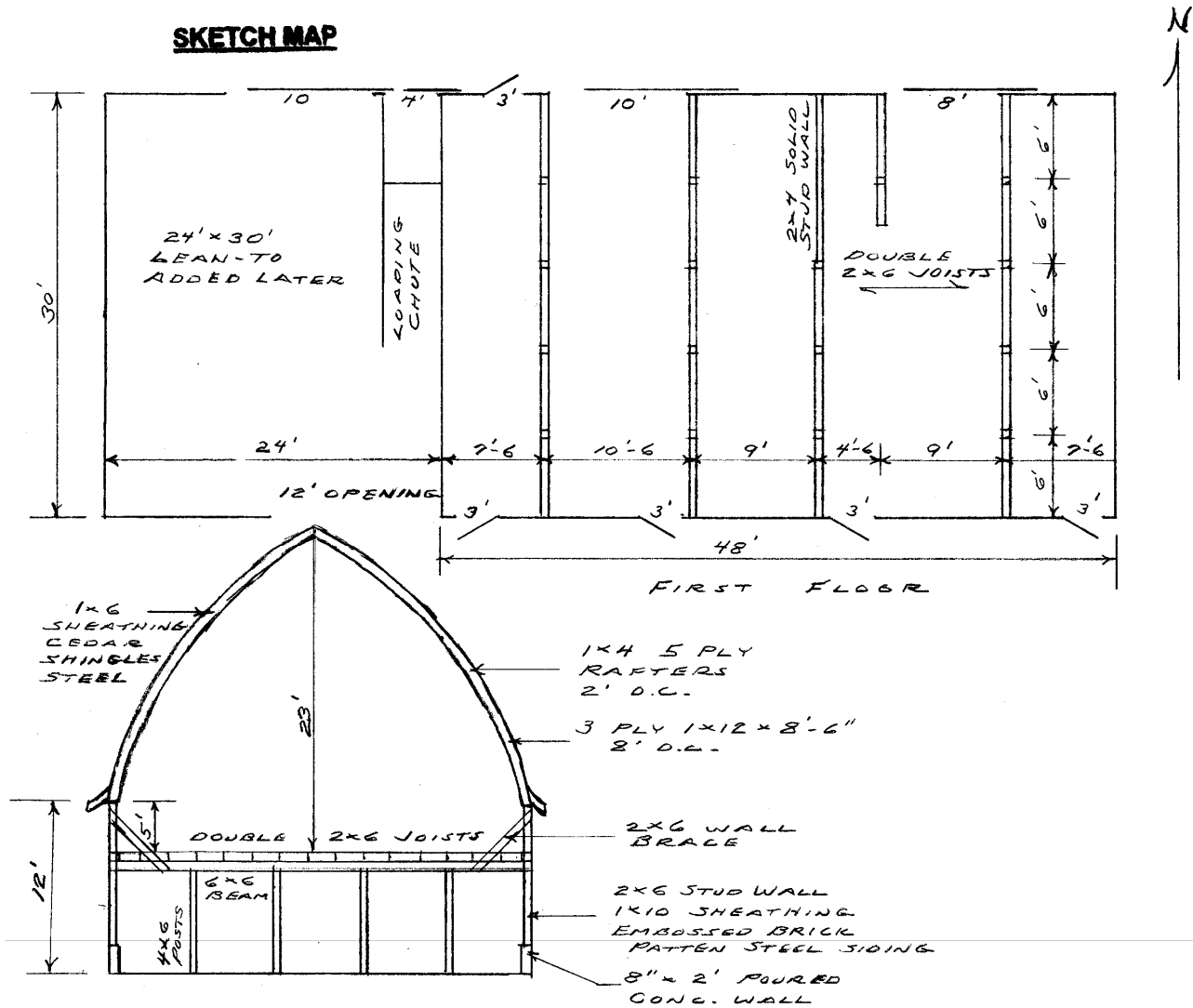

\* = REQUIRED FIELD

**SOUTH DAKOTA STATE HISTORIC PRESERVATION OFFICE  
HISTORIC SITES SURVEY STRUCTURE FORM**



**PHOTOGRAPHER:** Jim Stone  
**DATE OF PHOTO:** December 16, 2012

**ROLL NUMBER:** \_\_\_\_\_  
**PHOTO NUMBER:** 1  
**CAMERA DIRECTION:** Looking NE, SW corner



**PHOTOGRAPHER:** Jim Stone  
**DATE OF PHOTO:** December 16, 2012

**ROLL NUMBER:** \_\_\_\_\_  
**PHOTO NUMBER:** 2  
**CAMERA DIRECTION:** Looking NW, SE corner

\* = REQUIRED FIELD

**SOUTH DAKOTA STATE HISTORIC PRESERVATION OFFICE  
HISTORIC SITES SURVEY STRUCTURE FORM**



**PHOTOGRAPHER:** Jim Stone  
**DATE OF PHOTO:** December 16, 2012

**ROLL NUMBER:** \_\_\_\_\_  
**PHOTO NUMBER:** 3  
**CAMERA DIRECTION:** Looking SW, NE corner



**PHOTOGRAPHER:** Jim Stone  
**DATE OF PHOTO:** December 16, 2012

**ROLL NUMBER:** \_\_\_\_\_  
**PHOTO NUMBER:** 4  
**CAMERA DIRECTION:** First floor, looking NE,  
4x6 posts, 6x6 beam and  
double 2x6 floor joists.

**SOUTH DAKOTA STATE HISTORIC PRESERVATION OFFICE  
HISTORIC SITES SURVEY STRUCTURE FORM**



**PHOTOGRAPHER:** Jim Stone  
**DATE OF PHOTO:** December 16, 2012

**ROLL NUMBER:** \_\_\_\_\_  
**PHOTO NUMBER:** 5

**CAMERA DIRECTION:** First floor, looking SE,  
posts and beams and  
4x4 posts added recently  
for lambing pens.



**PHOTOGRAPHER:** Jim Stone  
**DATE OF PHOTO:** December 16, 2012

**ROLL NUMBER:** \_\_\_\_\_  
**PHOTO NUMBER:** 6

**CAMERA DIRECTION:** First floor, looking SW,  
4x6 posts and 6x6 beam,  
note short 6x6 beam  
under top 6x6

\* = REQUIRED FIELD

**SOUTH DAKOTA STATE HISTORIC PRESERVATION OFFICE  
HISTORIC SITES SURVEY STRUCTURE FORM**



**PHOTOGRAPHER:** Jim Stone  
**DATE OF PHOTO:** December 16 2012

**ROLL NUMBER:** \_\_\_\_\_  
**PHOTO NUMBER:** 7

**CAMERA DIRECTION:** Hayloft, looking SE, 5 ply  
1x4 rafters 2' O. C. and 3  
ply 1x12 cedar rafters 8'  
O. C.



**PHOTOGRAPHER:** Jim Stone  
**DATE OF PHOTO:** December 16, 2012

**ROLL NUMBER:** \_\_\_\_\_  
**PHOTO NUMBER:** 8

**CAMERA DIRECTION:** Hayloft, looking NE,  
rafters, 1x6 roof  
sheathing and 2x6  
bracing from top of wall  
down to hayloft floor.

**SOUTH DAKOTA STATE HISTORIC PRESERVATION OFFICE  
HISTORIC SITES SURVEY STRUCTURE FORM**

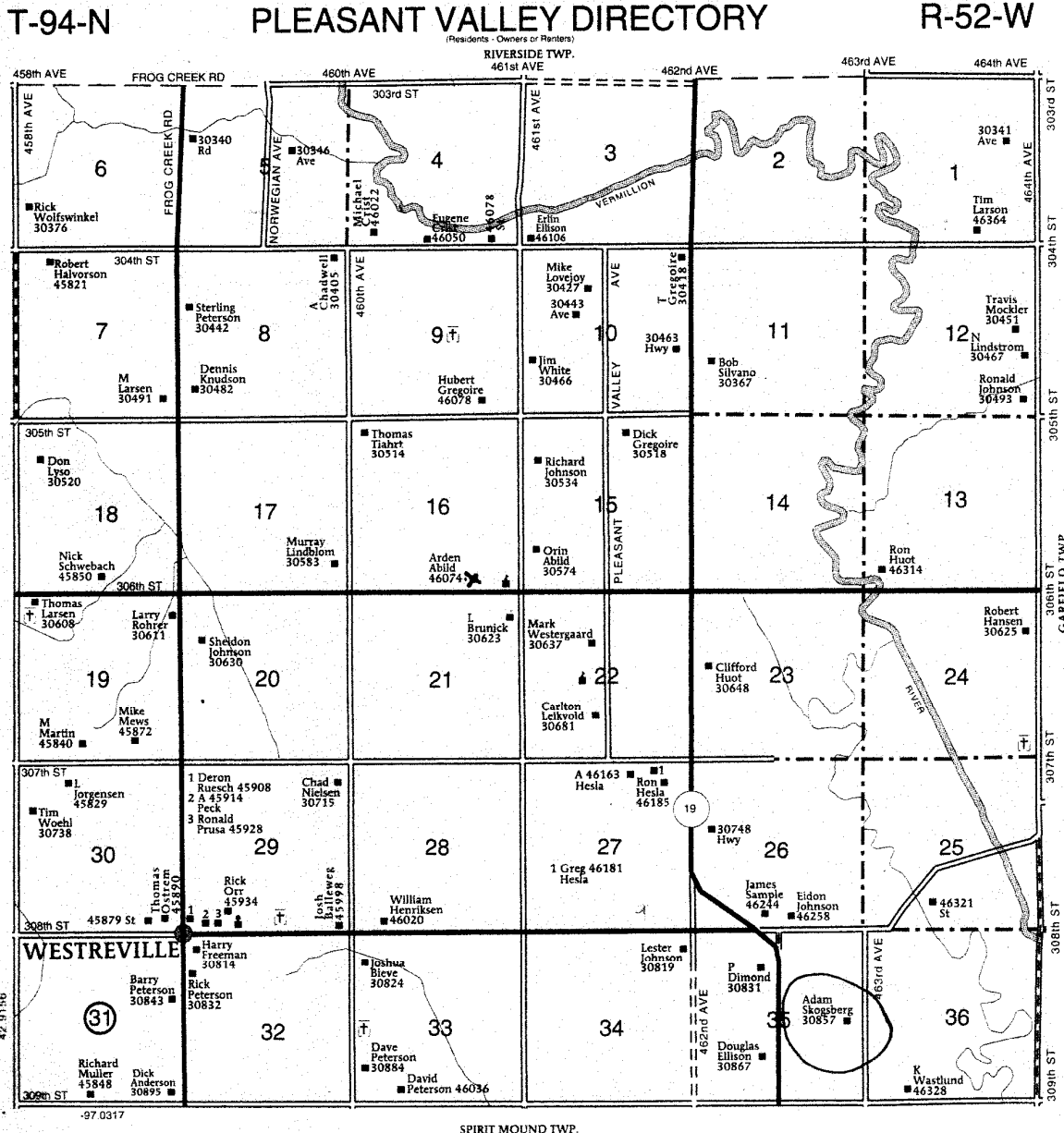

\* = REQUIRED FIELD



## **HISTORY**

This farm located in the SE ¼ of Section 35, Pleasant Valley Township, Clay County was homesteaded by Daniel Cookley

The 1894, 1901, 1912 and 1924 Clay County Atlas lists J. F. Hickson as the owner. This barn would have been built during this time and most likely in the 1920's.

The 1937, 1948 and 1956 Clay County Atlas lists Thos. Host as the owner.

**SOUTH DAKOTA STATE HISTORIC PRESERVATION OFFICE  
HISTORIC SITES SURVEY STRUCTURE FORM**

