

SOUTH DAKOTA STATE HISTORIC PRESERVATION OFFICE
HISTORIC SITES SURVEY STRUCTURE FORM



SITE INFORMATION

*SURVEY DATE: October 15, 2012

*SURVEYOR: Jim Stone

*ADDRESS: #1226 463rd Ave.

*COUNTY: Clay

*CITY: Vermillion

LOCATION DESCRIPTION: From the intersection of South Dakota Highway 50 bi-pass and South Dakota Highway 19, North 5-1/2 miles to 312th Street, turn right (East) 1/2 mile to 363rd Ave, turn right (South) about 1/4 mile on the left (East) side.

LEGAL DESCRIPTION: NW 1/4, 24 – 93 – 52 Spirit Mound Twp.

*QUARTER 1: NW 1/4

*QUARTER 2: _____

*TOWNSHIP: Spirit Mound

*RANGE: 52

*SECTION: 24

ACRES: 160.89

OWNER CODE 1: P

OWNER CODE 2: _____

OWNER CODE 3: _____

OWNER NAME: Robert L. Macy

OWNER ADDRESS: P. O. Box 512

OWNER CITY: Wellsburg

OWNER STATE: Iowa

OWNER ZIP: 50680

QUAD NAME: _____

HISTORIC SIGNIFICANCE

*DOE: _____

*DOE DATE: _____

REASON INELIGIBLE: _____

REGISTER NAME: _____

MULTIPLE PROPERTY NAME: _____

CATEGORY: _____

NOMINATION STATUS: _____

DATE LISTED: _____

REFERENCE NUMBER: _____

HISTORIC DISTRICT RATING: C or NC

PERIOD: _____

SIGNIFICANCE LEVEL 1: N S L

SIGNIFICANCE LEVEL 2: N S L

CRITERIA 1: A B C D

CRITERIA 2: A B C D

CRITERIA 3: A B C D

CRITERIA 4: A B C D

SIGNIFICANCE NOTES: _____

STRUCTURE DETAILS

* = REQUIRED FIELD

SOUTH DAKOTA STATE HISTORIC PRESERVATION OFFICE

HISTORIC SITES SURVEY STRUCTURE FORM



SHPO ID: _____

*PROPERTY NAME: _____

OTHER NAME: _____

CURRENT FUNCTION: Vacant
 CURRENT SUBFUNCTION: Vacant
 HISTORIC FUNCTION: Livestock barn
 HISTORIC SUBFUNCTION: Hay storage

FOUNDATION: Poured concrete foundation
 ROOF MATERIAL: Cedar shingles
 ROOF SHAPE: Gambrel
 STRUCTURAL SYSTEM: Balloon framing
 STYLE: English style gambrel roof barn
 TYPE: Livestock barn
 WALLS: 2x6 stud with 1x6 car siding.

OCCUPIED: No
Yes with
 ACCESSIBLE: permission

STORIES: 2
 *DATE OF CONSTRUCTION: About 1910

SIGNIFICANT PERSON: Henry Witt
 CULTURAL AFFILIATION: ?

ALTERED/MOVED NOTES: Original site. Milk cow stanchions have been removed. Lean-to on the West side may have been added later.

INTERIOR NOTES: Has one row of 4x6 posts with a 4x6 beam. 2x8 floor joists. The milk cow stanchions have been removed. Any trace of horse stalls is gone. 2x4's, 2x6's, 2x8's and 4x6's are all rough sawn cottonwood.

OTHER NOTES: 2x6 stud walls with 1x6 car siding. Lean-to is 2x6 studs 4' O.C. with 2x4 purlins 3' O.C. and 1x12 vertical siding with metal battens. Rafters are 2x6 with 1x6 brace on hip. Two 2x6 braces from the bottom of rafter down to the floor, 10' - 8' - 10' O.C. on each side. 1x6 sheathing on roof with cedar shingles. 4' x 4' wood cupola built on site. 8"x10" four light windows.

*PHYSICAL NOTES: Barn is in fair condition. Needs roofing now. Doors and windows need some repair. Concrete foundation is crumbling in North West corner.

*UTM ZONE: _____

*RESTRICTED: Y or N

*UTM EASTING: _____

*UTM NORTHING: _____

SOUTH DAKOTA STATE HISTORIC PRESERVATION OFFICE HISTORIC SITES SURVEY STRUCTURE FORM

SKETCH MAP

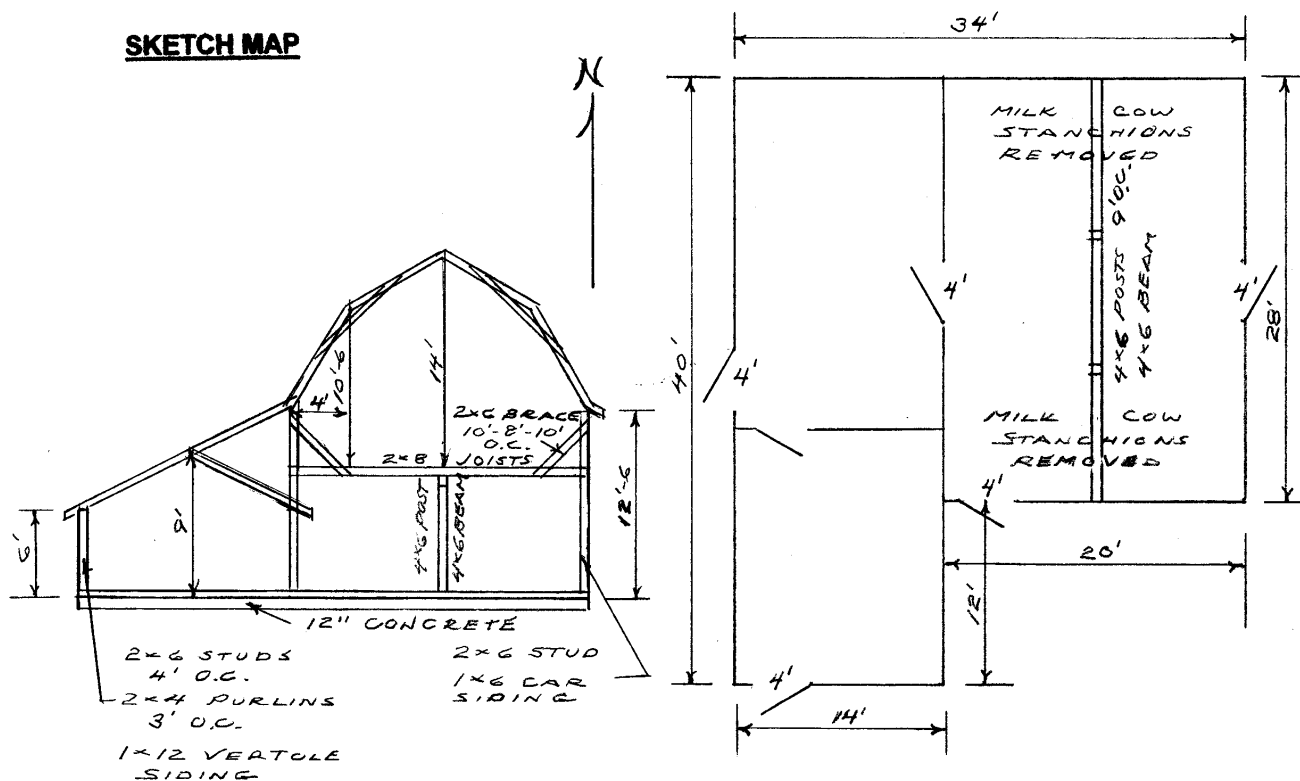

PHOTOGR

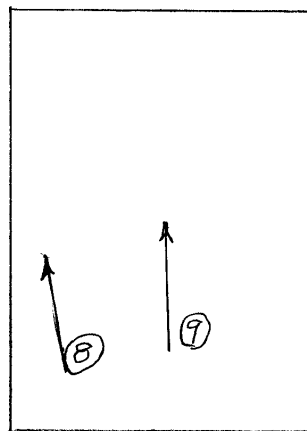

* = REQUIRED FIELD

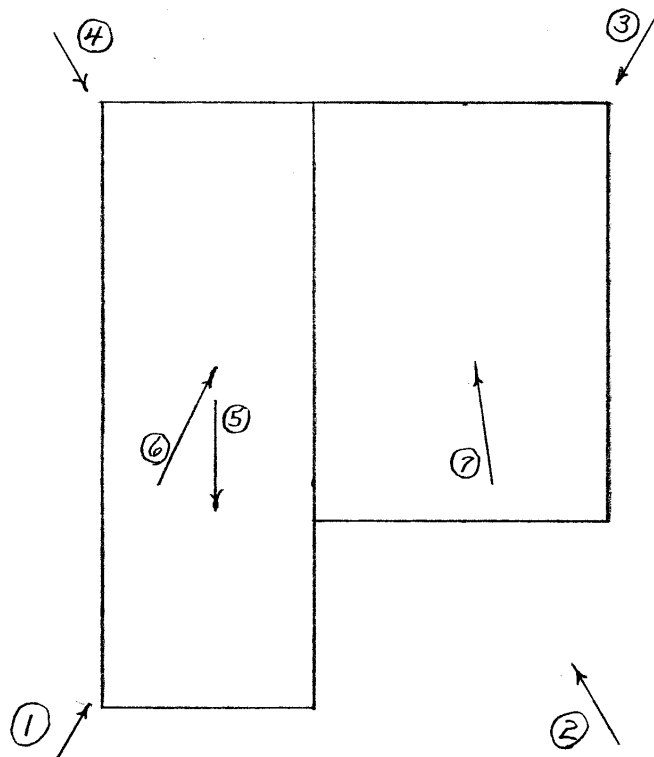

* = REQUIRED FIELD

**SOUTH DAKOTA STATE HISTORIC PRESERVATION OFFICE
HISTORIC SITES SURVEY STRUCTURE FORM**



PHOTOGRAPHER: Jim Stone
DATE OF PHOTO: October 15, 2012

ROLL NUMBER: _____
PHOTO NUMBER: 1
CAMERA DIRECTION: Looking NE, SW corner



PHOTOGRAPHER: Jim Stone
DATE OF PHOTO: October 15, 2012

ROLL NUMBER: _____
PHOTO NUMBER: 2
CAMERA DIRECTION: Looking NW, SE corner

**SOUTH DAKOTA STATE HISTORIC PRESERVATION OFFICE
HISTORIC SITES SURVEY STRUCTURE FORM**



PHOTOGRAPHER: Jim Stone
DATE OF PHOTO: October 15, 2012

ROLL NUMBER: _____
PHOTO NUMBER: 3
CAMERA DIRECTION: Looking SW, NE corner



PHOTOGRAPHER: Jim Stone
DATE OF PHOTO: October 15, 2012

ROLL NUMBER: _____
PHOTO NUMBER: 4
CAMERA DIRECTION: Looking SE, NW corner

* = REQUIRED FIELD

**SOUTH DAKOTA STATE HISTORIC PRESERVATION OFFICE
HISTORIC SITES SURVEY STRUCTURE FORM**



PHOTOGRAPHER: Jim Stone
DATE OF PHOTO: October 15, 2012

ROLL NUMBER: _____
PHOTO NUMBER: 5

CAMERA DIRECTION: First floor, looking
South, in West lean-to



PHOTOGRAPHER: Jim Stone
DATE OF PHOTO: October 15, 2012

ROLL NUMBER: _____
PHOTO NUMBER: 6

CAMERA DIRECTION: First floor, looking NE, in
West lean-to, looking at
West wall of main barn
and into hayloft

**SOUTH DAKOTA STATE HISTORIC PRESERVATION OFFICE
HISTORIC SITES SURVEY STRUCTURE FORM**



PHOTOGRAPHER: Jim Stone
DATE OF PHOTO: October 15, 2012

ROLL NUMBER: _____
PHOTO NUMBER: 7

CAMERA DIRECTION: First floor, looking North, posts and beam in main barn



PHOTOGRAPHER: Jim Stone
DATE OF PHOTO: October 15, 2012

ROLL NUMBER: _____
PHOTO NUMBER: 8

CAMERA DIRECTION: Hayloft, looking North, rafter bracing at hip.

**SOUTH DAKOTA STATE HISTORIC PRESERVATION OFFICE
HISTORIC SITES SURVEY STRUCTURE FORM**



PHOTOGRAPHER: Jim Stone
DATE OF PHOTO: October 15, 2012

ROLL NUMBER: _____
PHOTO NUMBER: 9
CAMERA DIRECTION: Hayloft, looking North,
North gable end.

SOUTH DAKOTA STATE HISTORIC PRESERVATION OFFICE

HISTORIC SITES SURVEY STRUCTURE FORM

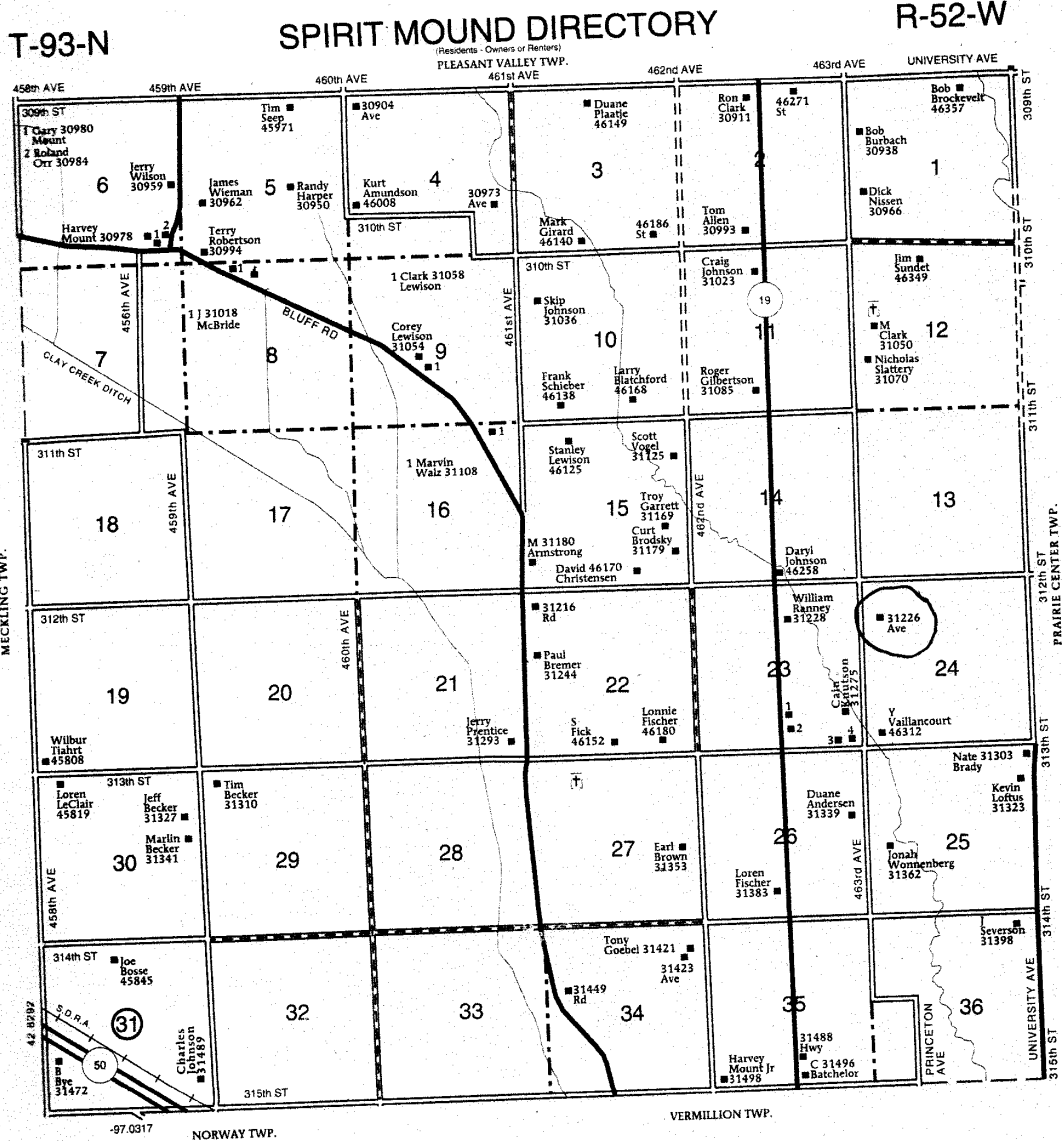

**SPRIT MOUND
TOWNSHIP
SECTION 23**
1 McDonald, Ben 31284
2 Freidel, Mike 31288
3 46292
4 Wood, Robert 46296

© Farm & Home Publishers, Ltd.

HISTORY

This farm located in the NW ¼ of Section 24, Spirit Mound township, clay County was homesteaded by William W. Deming.

The 1894 and 1901 Clay County Atlas lists William Gettoes as the owner.

The 1912 , 1924, 1937, 1948 and 1956 Clay County Atlas lists Henry Witt as the land owner.

Mr. and Mrs. Henry Witt had no children. After they died, a niece Mary Harding inherited the farm. She lived here until she died. Her heirs then sold the farm to Robert L. Macy in 1990.