

**SOUTH DAKOTA STATE HISTORIC PRESERVATION OFFICE
HISTORIC SITES SURVEY STRUCTURE FORM**



SITE INFORMATION

*SURVEY DATE: January 13, 2012 *ADDRESS: 30867 S. D. Highway 19
*SURVEYOR: Jim Stone *COUNTY: Clay
*CITY: Vermillion

LOCATION DESCRIPTION: 8-3/4 miles north of junction S. D. Highway 50 bi-pass and Highway 19,
On the left (West) side. Lane is about 1/4 mile long.

LEGAL DESCRIPTION: SW 1/4, Exc. Lot H2, 35 – 94 – 52, Pleasant Valley Twp.

*QUARTER 1: SW 1/4
*QUARTER 2: _____
*TOWNSHIP: Pleasant valley
*RANGE: 52
*SECTION: 35
ACRES: 156.80

OWNER NAME: Erlin Ellison Trust
OWNER ADDRESS: 46106 304th Street
OWNER CITY: Wakonda
OWNER STATE: South Dakota
OWNER ZIP: 57073
QUAD NAME: _____

OWNER CODE 1: P
OWNER CODE 2: F S L P
OWNER CODE 3: F S L P

HISTORIC SIGNIFICANCE

*DOE: _____
*DOE DATE: _____
REASON INELIGIBLE: _____

REGISTER NAME: Elmer Ellison barn
MULTIPLE PROPERTY NAME: _____

NOMINATION STATUS: _____
DATE LISTED: _____
REFERENCE NUMBER: _____
HISTORIC DISTRICT RATING: C or NC
PERIOD: _____

CATEGORY: _____
SIGNIFICANCE LEVEL 1: N S L
SIGNIFICANCE LEVEL 2: N S L
CRITERIA 1: A B C D
CRITERIA 2: A B C D
CRITERIA 3: A B C D
CRITERIA 4: A B C D

SIGNIFICANCE NOTES: Barn is in very good condition.

* = REQUIRED FIELD

**SOUTH DAKOTA STATE HISTORIC PRESERVATION OFFICE
HISTORIC SITES SURVEY STRUCTURE FORM**



STRUCTURE DETAILS

SHPO ID: 35 CL 0000579
*PROPERTY NAME: _____
OTHER NAME: _____

CURRENT FUNCTION: Storage FOUNDATION: Poured concrete
CURRENT SUBFUNCTION: _____ ROOF MATERIAL: Steel over cedar
HISTORIC FUNCTION: Livestock barn ROOF SHAPE: shingles
Hay and Grain
HISTORIC SUBFUNCTION: Storage STRUCTURAL SYSTEM: Gambrel
STYLE: Balloon framing
OCCUPIED: YES TYPE: Gambrel roof
ACCESSIBLE: YES TYPE: Livestock barn
WALLS: 2x6 w/ sheathing
and 1/2x6 cedar sdg.

STORIES: 2 SIGNIFICANT PERSON: Elmer Ellison
*DATE OF CONSTRUCTION: 1945 CULTURAL AFFILIATION: Norwegian

ALTERED/MOVED NOTES: Original site. Stalls and stanchions have been removed. Roof and east and north walls have been covered with steel roofing. 2x6 stud wall added to partition off west 1/3 of the first floor.

INTERIOR NOTES: Two rows 6x6 posts and 6x6 beams with 2x8 floor joists to support the hayloft floor. Gambrel roof with diagonal bracing at the hip. Note the longer bracing 6 foot O.C. anchoring the rafter to top of the wall. Similar to the lower one half of a Shawver truss.

OTHER NOTES: Windows are 4"x24" four light barn sash. 2x6 stud walls with sheathing and 1/2" x 6" cedar lap siding. 2x6 rafters with 2x6 bracing at the hip 2' O. C. Also a 2x6 brace from the center of the top rafter down to the floor and exterior wall 6' O. C. There is no 2x6 hip brace 6' O. C.

***PHYSICAL NOTES:** Barn is in very good condition. Needs siding on the west end and south side.

*UTM ZONE: _____ *RESTRICTED: Y or N
*UTM EASTING: _____
*UTM NORTHING: _____

* = REQUIRED FIELD

**SOUTH DAKOTA STATE HISTORIC PRESERVATION OFFICE
HISTORIC SITES SURVEY STRUCTURE FORM**

SKETCH MAP

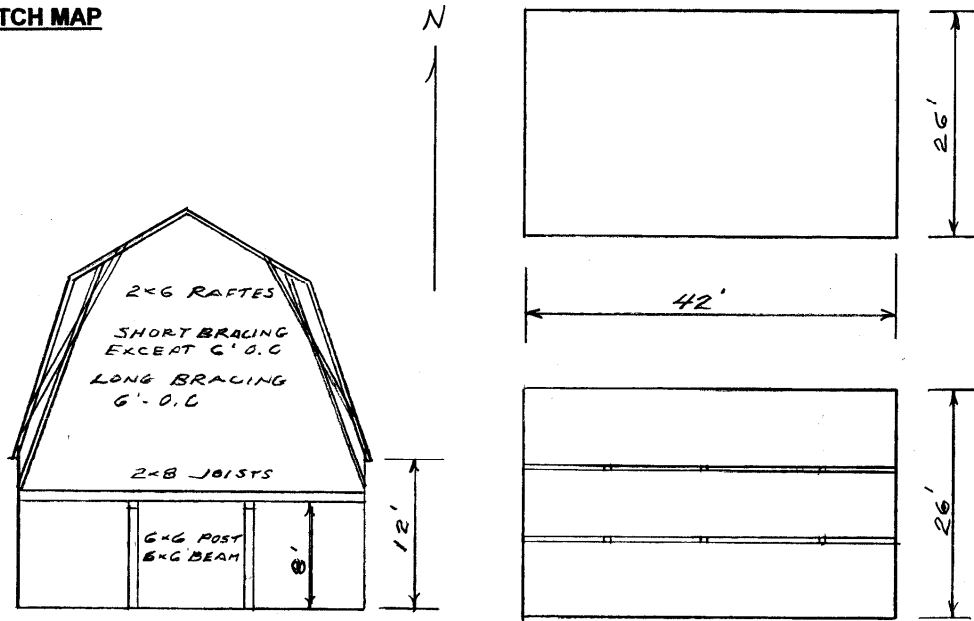

PHOTOGRAPHS

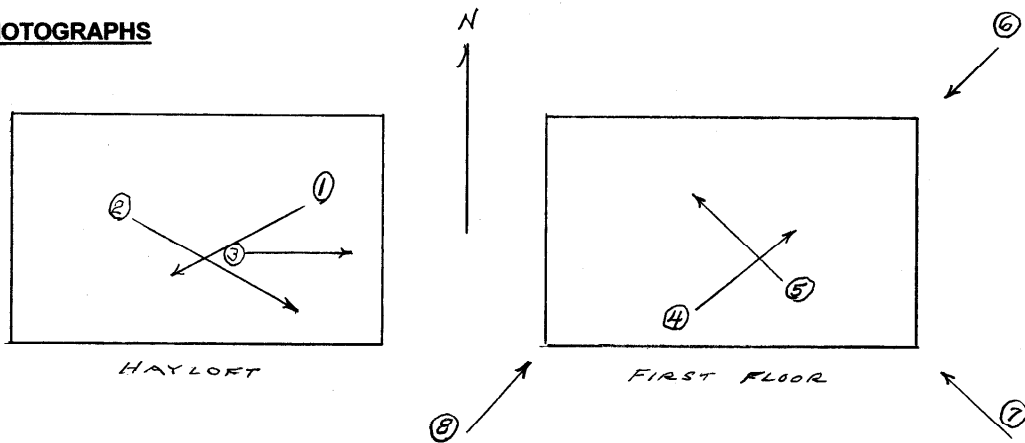

* = REQUIRED FIELD

**SOUTH DAKOTA STATE HISTORIC PRESERVATION OFFICE
HISTORIC SITES SURVEY STRUCTURE FORM**



PHOTOGRAPHER: Jim Stone
DATE OF PHOTO: January 13, 2012

ROLL NUMBER: _____
PHOTO NUMBER: 1
CAMERA DIRECTION: Hayloft, looking SW



PHOTOGRAPHER: Jim Stone
DATE OF PHOTO: January 13, 2012

ROLL NUMBER: _____
PHOTO NUMBER: 2
CAMERA DIRECTION: Hayloft, looking SE

* = REQUIRED FIELD

**SOUTH DAKOTA STATE HISTORIC PRESERVATION OFFICE
HISTORIC SITES SURVEY STRUCTURE FORM**



PHOTOGRAPHER: Jim Stone
DATE OF PHOTO: January 13, 2012

ROLL NUMBER: _____
PHOTO NUMBER: 3
CAMERA DIRECTION: Hayloft, looking East



PHOTOGRAPHER: Jim Stone
DATE OF PHOTO: January 13, 2012

ROLL NUMBER: _____
PHOTO NUMBER: 4
CAMERA DIRECTION: First floor, looking NE

* = REQUIRED FIELD

**SOUTH DAKOTA STATE HISTORIC PRESERVATION OFFICE
HISTORIC SITES SURVEY STRUCTURE FORM**



PHOTOGRAPHER: Jim Stone
DATE OF PHOTO: January 13, 2012

ROLL NUMBER: _____
PHOTO NUMBER: 5

CAMERA DIRECTION: First floor, looking NW.
Note granary in NW
corner



PHOTOGRAPHER: Jim Stone
DATE OF PHOTO: January 13, 2012

ROLL NUMBER: _____
PHOTO NUMBER: 6
CAMERA DIRECTION: Looking SW, NE corner

* = REQUIRED FIELD

**SOUTH DAKOTA STATE HISTORIC PRESERVATION OFFICE
HISTORIC SITES SURVEY STRUCTURE FORM**



PHOTOGRAPHER: Jim Stone
DATE OF PHOTO: January 13, 2012

ROLL NUMBER: _____
PHOTO NUMBER: 7
CAMERA DIRECTION: Looking NW, SE corner



PHOTOGRAPHER: Jim Stone
DATE OF PHOTO: January 13, 2012

ROLL NUMBER: _____
PHOTO NUMBER: 8
CAMERA DIRECTION: Looking NE, SW corner

* = REQUIRED FIELD

**SOUTH DAKOTA STATE HISTORIC PRESERVATION OFFICE
HISTORIC SITES SURVEY STRUCTURE FORM**

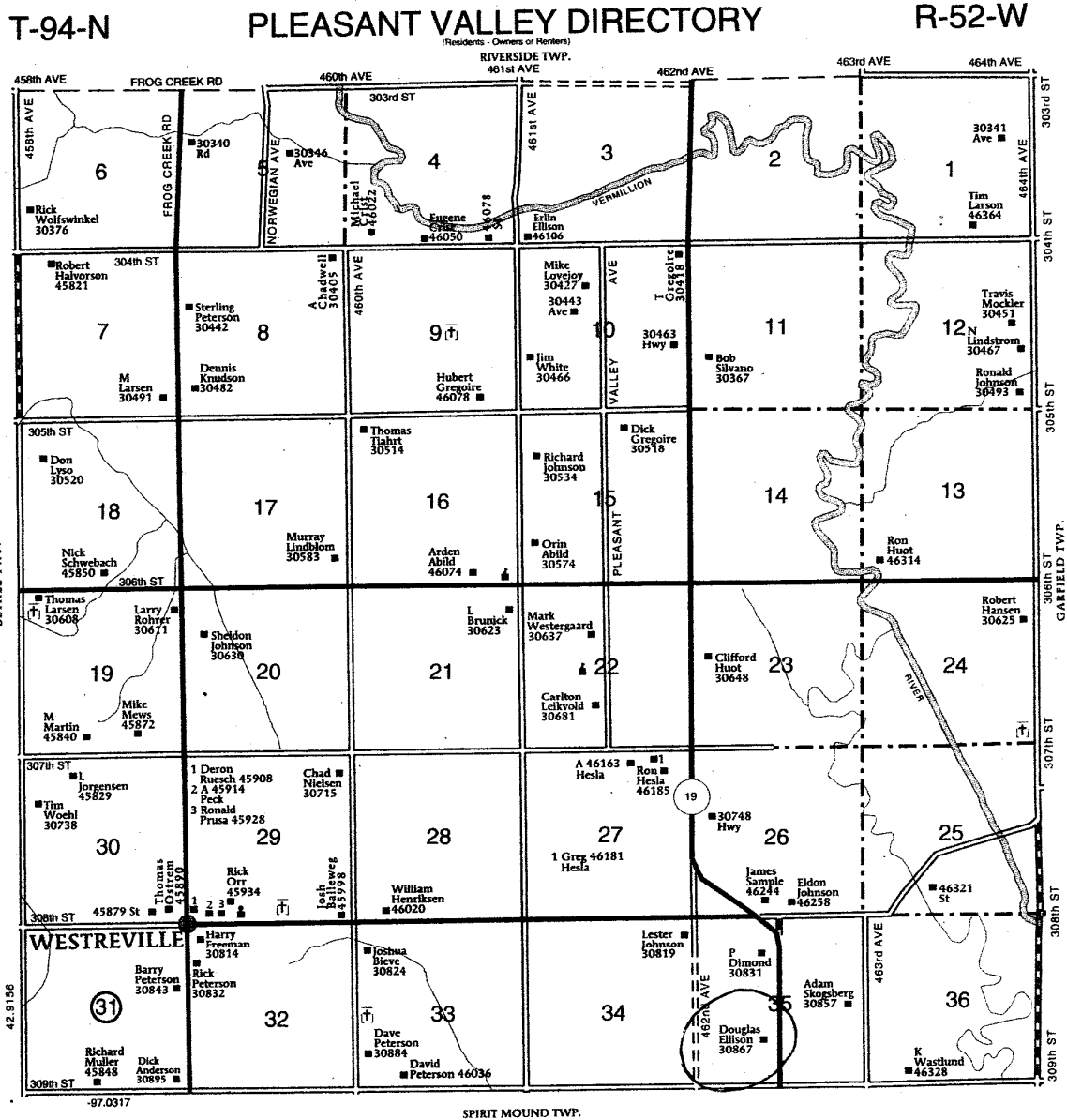

* = REQUIRED FIELD

History

This farm located in the SW ¼ of Section 35, Pleasant Valley Township was homesteaded by Andrew Sidlinger.

The 1894, 1901, 1912 and 1924 Clay County Atlas lists Goodman Ellison as the owner.

The 1937, 1948 and 1956 Clay county Atlas lists Elmer J. Ellison as the owner.

The Following Is From
Erlin Ellison

Erlin Ellison's grandfather Goodman Ellison bought the farm in 1889 from the Seiler Family. The Seiler family thought that they were too far from Vermillion. They sold the farm and purchased another farm just north of the Highway 50 bi-pass.

Erlin Ellison's father Elmer Ellison bought the farm from Goodman Ellison in 1927.

Erlin Ellison bought the farm from his father Elmer Ellison in 1967 or 1968.

**SOUTH DAKOTA STATE HISTORIC PRESERVATION OFFICE
HISTORIC SITES SURVEY STRUCTURE FORM**

