

**SOUTH DAKOTA STATE HISTORIC PRESERVATION OFFICE
HISTORIC SITES SURVEY STRUCTURE FORM**



SITE INFORMATION

*SURVEY DATE: January 8, 2013 *ADDRESS: 46874 302rd Street
*SURVEYOR: Jim Stone *COUNTY: Clay
*CITY: Beresford

LOCATION DESCRIPTION: From Vermillion, South Dakota Highway 50, East 2 miles to Greenfield Road, Turn left (North) 16-1/2 miles to 302nd Street, turn right (East) about 3/4 mile, on left (North) side

LEGAL DESCRIPTION: SE 1/4, 26 - 95 - 51 , EXC S 50' Glenwood Twp.

*QUARTER 1: SE 1/4 OWNER NAME: Neva Erickson
*QUARTER 2: _____ OWNER ADDRESS: 1917 Cardinal Dr.
*TOWNSHIP: Glenwood OWNER CITY: Sioux Falls
*RANGE: 51 OWNER STATE: South Dakota
*SECTION: 26 OWNER ZIP: 57105-0000
ACRES: 157.72 QUAD NAME: _____

OWNER CODE 1: P
OWNER CODE 2:
OWNER CODE 3:

HISTORIC SIGNIFICANCE

*DOE: _____ REGISTER NAME: _____
*DOE DATE: _____ MULTIPLE PROPERTY NAME: _____
REASON INELIGIBLE: _____

NOMINATION STATUS: _____ CATEGORY: _____
DATE LISTED: _____ SIGNIFICANCE LEVEL 1: N S L
REFERENCE NUMBER: _____ SIGNIFICANCE LEVEL 2: N S L
HISTORIC DISTRICT RATING: C or NC CRITERIA 1: A B C D
PERIOD: _____ CRITERIA 2: A B C D
 CRITERIA 3: A B C D
 CRITERIA 4: A B C D

SIGNIFICANCE NOTES: _____

STRUCTURE DETAILS

* = REQUIRED FIELD

**SOUTH DAKOTA STATE HISTORIC PRESERVATION OFFICE
HISTORIC SITES SURVEY STRUCTURE FORM**



SHPO ID: _____
 *PROPERTY NAME: _____
 OTHER NAME: _____

CURRENT FUNCTION: <u>Vacant</u>	FOUNDATION: <u>Poured concrete foundation</u>
CURRENT SUBFUNCTION: <u>Vacant</u>	ROOF MATERIAL: <u>Asphalt shingles over cedar shingles</u>
HISTORIC FUNCTION: <u>Livestock barn</u>	ROOF SHAPE: <u>Gable</u>
HISTORIC SUBFUNCTION: <u>Hay and grain storage</u>	STRUCTURAL SYSTEM: <u>Balloon framing</u>
OCCUPIED: <u>No</u>	STYLE: <u>Gable roof barn</u>
ACCESSIBLE: <u>Yes with permission</u>	TYPE: <u>Livestock barn</u>
	WALLS: <u>2x6 studs with 1x6 #106 drop siding</u>
STORIES: <u>2</u>	SIGNIFICANT PERSON: <u>Eddie C. Madsen</u>
*DATE OF CONSTRUCTION: <u>Early 1900's</u>	CULTURAL AFFILIATION: <u>?</u>

ALTERED/MOVED NOTES: Original site. Roof has been covered with asphalt shingles. 18'x32' lean-to added on the North side at a later date.

INTERIOR NOTES: Has two rows of 6x6 posts, with 4x6's for a beam. 2x8 floor joists. Two rows of 4x4 posts with 4x4 beams support the center of the rafters in the hayloft.

OTHER NOTES: 2x6 stud walls with 1x6 #106 drop siding. Rafters are 2x6's. Milk cow stanchions are still in place in the North lean-to. Six single and two double horse stalls, 4' x 12' granary and a 6' x 12' tack room are also still in place. Windows are 9"x12" four light. Wooden cupola still on roof.

*PHYSICAL NOTES: Barn is in fair to good condition, but needs some siding repairs and some of the doors rebuilt. Will need to be re-roofed in near future.

*UTM ZONE: _____ *RESTRICTED: Y or N
 *UTM EASTING: _____
 *UTM NORTHING: _____

* = REQUIRED FIELD

SOUTH DAKOTA STATE HISTORIC PRESERVATION OFFICE
 HISTORIC SITES SURVEY STRUCTURE FORM

SKETCH MAP

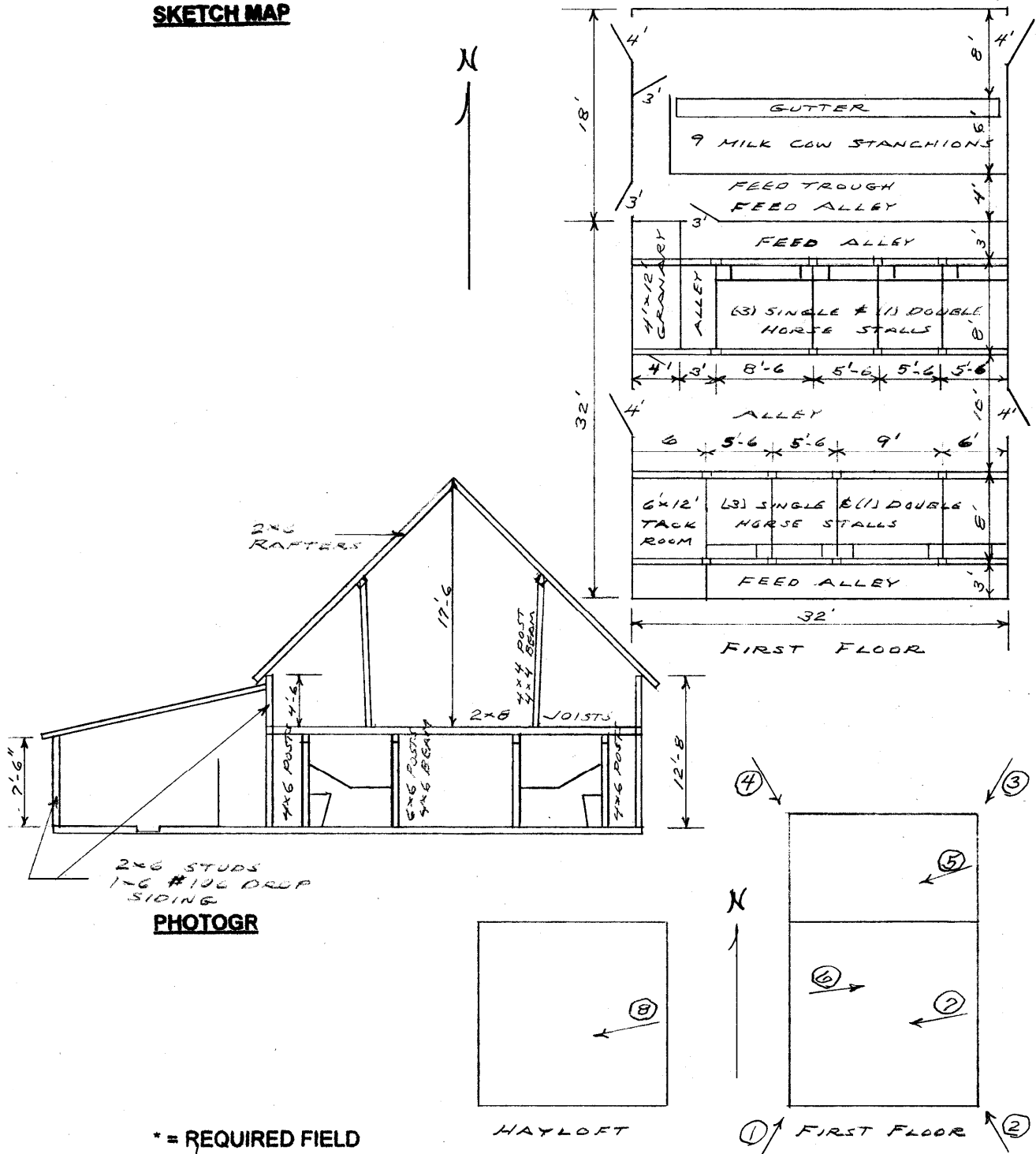

* = REQUIRED FIELD

HAYLOFT

① FIRST FLOOR ②

* = REQUIRED FIELD

**SOUTH DAKOTA STATE HISTORIC PRESERVATION OFFICE
HISTORIC SITES SURVEY STRUCTURE FORM**



PHOTOGRAPHER: Jim Stone
DATE OF PHOTO: January 8, 2013

ROLL NUMBER: _____
PHOTO NUMBER: 1
CAMERA DIRECTION: Looking NE, SW corner



PHOTOGRAPHER: Jim Stone
DATE OF PHOTO: January 8, 2013

ROLL NUMBER: _____
PHOTO NUMBER: 2
CAMERA DIRECTION: Looking NW, SE corner

* = REQUIRED FIELD

**SOUTH DAKOTA STATE HISTORIC PRESERVATION OFFICE
HISTORIC SITES SURVEY STRUCTURE FORM**



PHOTOGRAPHER: Jim Stone
DATE OF PHOTO: January 8, 2013

ROLL NUMBER: _____
PHOTO NUMBER: 3
CAMERA DIRECTION: Looking SW, NE corner



PHOTOGRAPHER: Jim Stone
DATE OF PHOTO: January 8, 2013

ROLL NUMBER: _____
PHOTO NUMBER: 4
CAMERA DIRECTION: Looking SE, NW corner

* = REQUIRED FIELD

**SOUTH DAKOTA STATE HISTORIC PRESERVATION OFFICE
HISTORIC SITES SURVEY STRUCTURE FORM**



PHOTOGRAPHER: Jim Stone
DATE OF PHOTO: January 8, 2013

ROLL NUMBER: 5
PHOTO NUMBER: 5

**First floor, looking West
in the North lean-to, (9)
milk cow stanchions.**

CAMERA DIRECTION: West



PHOTOGRAPHER: Jim Stone
DATE OF PHOTO: January 8, 2013

ROLL NUMBER: 6
PHOTO NUMBER: 6

**First floor, looking East,
horse stalls on the North
side**

CAMERA DIRECTION: East

**SOUTH DAKOTA STATE HISTORIC PRESERVATION OFFICE
HISTORIC SITES SURVEY STRUCTURE FORM**



PHOTOGRAPHER: Jim Stone
DATE OF PHOTO: January 8, 2013

ROLL NUMBER: 7
PHOTO NUMBER: 7

**First floor, looking SE,
horse stalls on the South
side.**

CAMERA DIRECTION: _____



PHOTOGRAPHER: Jim Stone
DATE OF PHOTO: January 8, 2013

ROLL NUMBER: 8
PHOTO NUMBER: 8

**Hayloft, looking West.
4x4 posts and 4x4 beam
supporting the center of
the rafters.**

CAMERA DIRECTION: _____

* = REQUIRED FIELD

SOUTH DAKOTA STATE HISTORIC PRESERVATION OFFICE
HISTORIC SITES SURVEY STRUCTURE FORM



T-95-N

GLENWOOD DIRECTORY
(Residents - Owners or Renters)

R-51-W

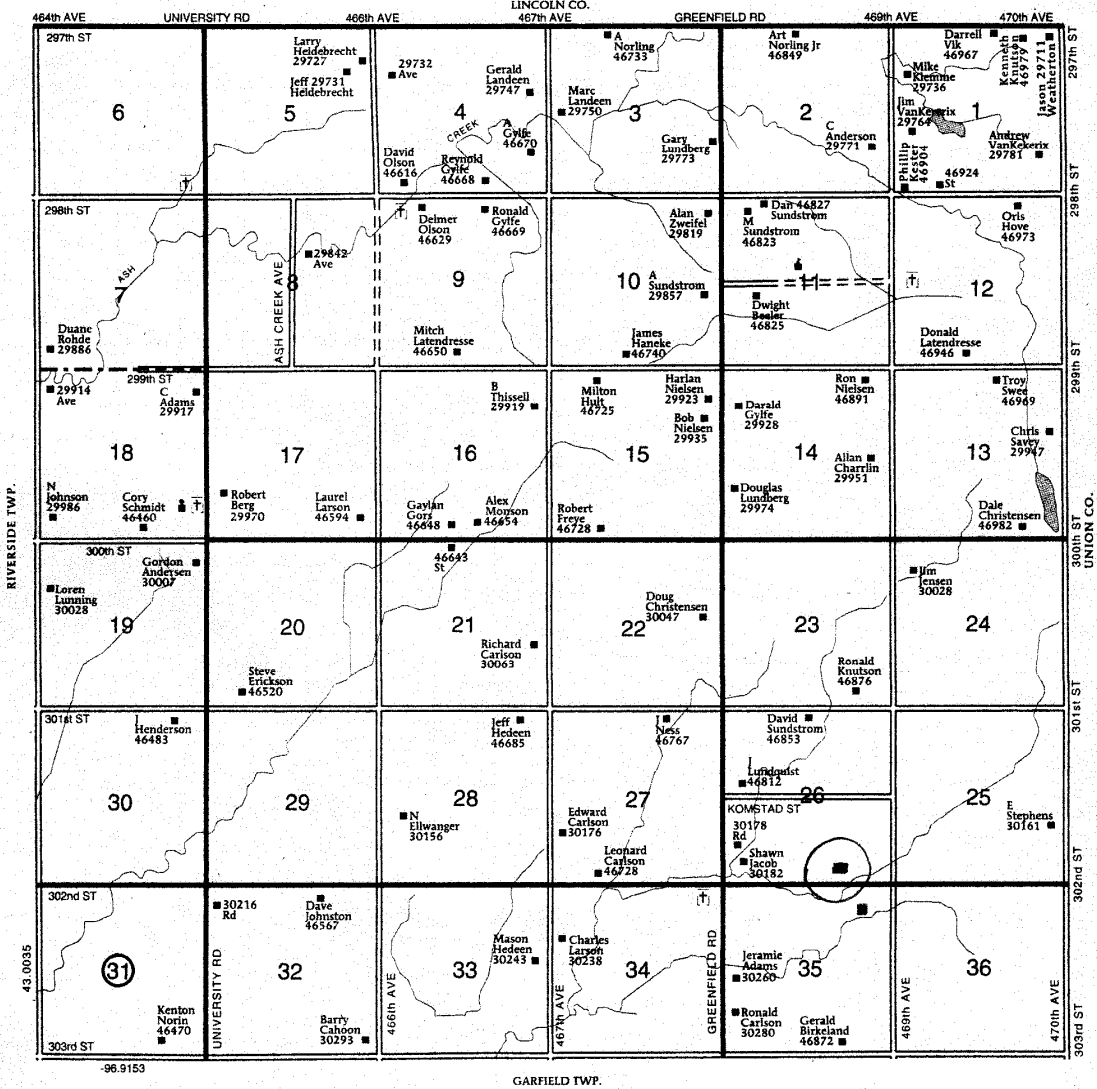

* = REQUIRED FIELD

HISTORY

This farm located in the SE ¼ of Section 26, Glenwood Township, Clay County was homesteaded by Charles L. Fox.

The 1894, 1901 and 1912 Clay County Atlas lists Lars Madsen as the owner.

The 1924 Clay County Atlas lists Eddie C. Madsen as the owner.

The 1937 Clay County Atlas lists A. Nelson as the owner.

The 1948 and 1956 Clay County Atlas lists George Martinson as the owner.

**SOUTH DAKOTA STATE HISTORIC PRESERVATION OFFICE
HISTORIC SITES SURVEY STRUCTURE FORM**

