

SOUTH DAKOTA STATE HISTORIC PRESERVATION OFFICE
HISTORIC SITES SURVEY STRUCTURE FORM



SITE INFORMATION

*SURVEY DATE: October 30, 2012 *ADDRESS: 46952 306th Street
*SURVEYOR: Jim Stone *COUNTY: Clay
*CITY: Beresford

From Vermillion, South Dakota Highway 50 East about 2 miles to Greenfield
LOCATION DESCRIPTION: _____
Road, turn left, (North) 12-1/2 miles to 306th Street, turn right (East) 1-1/2 miles, turn right (South)
(no address or fire number) into lane about 1/4 mile long

LEGAL DESCRIPTION: W1/2. NE 1/4, 24 – 94 – 51 Garfield Twp.

*QUARTER 1: NE1/4 OWNER NAME: John C. Jensen, Keistal D. Kirkle &
*QUARTER 2: _____ OWNER ADDRESS: Jacqueline E. Jens Jensen
*TOWNSHIP: Garfield OWNER CITY: 30577 470th Ave.
*RANGE: 51 OWNER STATE: Beresford
*SECTION: 24 OWNER ZIP: South Dakota
ACRES: 77.64 QUAD NAME: 57004
OWNER CODE 1: P
OWNER CODE 2:
OWNER CODE 3:

HISTORIC SIGNIFICANCE

*DOE: _____ REGISTER NAME: _____
*DOE DATE: _____ MULTIPLE PROPERTY NAME: _____
REASON INELIGIBLE: _____

NOMINATION STATUS: _____ CATEGORY: _____
DATE LISTED: _____ SIGNIFICANCE LEVEL 1: N S L
REFERENCE NUMBER: _____ SIGNIFICANCE LEVEL 2: N S L
HISTORIC DISTRICT RATING: C or NC CRITERIA 1: A B C D
PERIOD: _____ CRITERIA 2: A B C D
CRITERIA 3: A B C D
CRITERIA 4: A B C D

SIGNIFICANCE NOTES: _____

* = REQUIRED FIELD

**SOUTH DAKOTA STATE HISTORIC PRESERVATION OFFICE
HISTORIC SITES SURVEY STRUCTURE FORM**



STRUCTURE DETAILS

SHPO ID: _____
 *PROPERTY NAME: _____
 OTHER NAME: _____

CURRENT FUNCTION: Storage FOUNDATION: Poured concrete
 Some corri. Galv. steel roofing over cedar shingles

CURRENT SUBFUNCTION: Storage ROOF MATERIAL: _____
 HISTORIC FUNCTION: Livestock barn ROOF SHAPE: Gable
 HISTORIC SUBFUNCTION: Hay storage STRUCTURAL SYSTEM: Balloon framing

OCCUPIED: Yes STYLE: Gable roof barn
 TYPE: Livestock barn
 2x4 stud with 1x8 #106 drop siding and corri. galv. steel

ACCESSIBLE: Yes with permission WALLS: _____

STORIES: 2 SIGNIFICANT PERSON: Hans Johnson
 *DATE OF CONSTRUCTION: ? CULTURAL AFFILIATION: _____

ALTERED/MOVED NOTES: Original site. Milk cow stanchions have been removed. Part of the roof and some of the walls are covered with 26" wide galvanized corrugated steel roofing. Interior has been Remodeled. East 30' of hayloft removed. 11'x 11' sliding doors added on the East wall. Roll asphalt brick siding on the South wall.

INTERIOR NOTES: Has three rows of 4 x6 posts with (2) 2x6's for beams and (2) 2x8's for a center beam. All posts and beams removed from East 30'. May have only been a center beam in that area, as there is a 2x4 solid dividing wall between. Four single horse stalls on the West wall still in place.

OTHER NOTES: 2x4 stud walls, 16" O. C. , 1x8 drop siding. Lean-to on the North was added later and walls are 4x4 studs 48" O. C. with sheathing and galv. corrugated steel roofing. Rafters are 2x6 with sheathing, cedar shingles and some galvanized corrugated steel roofing on the North side. Windows are 8" x 10" four light. Wood cupola.

*PHYSICAL NOTES: _____ *RESTRICTED: Y or N
 *UTM EASTING: _____
 *UTM NORTHING: _____

SITE INFORMATION

*UTM EASTING: _____
 *UTM NORTHING: _____

* = REQUIRED FIELD

**SOUTH DAKOTA STATE HISTORIC PRESERVATION OFFICE
HISTORIC SITES SURVEY STRUCTURE FORM**



**SOUTH DAKOTA STATE HISTORIC PRESERVATION OFFICE
HISTORIC SITES SURVEY STRUCTURE FORM**

SKETCH MAP

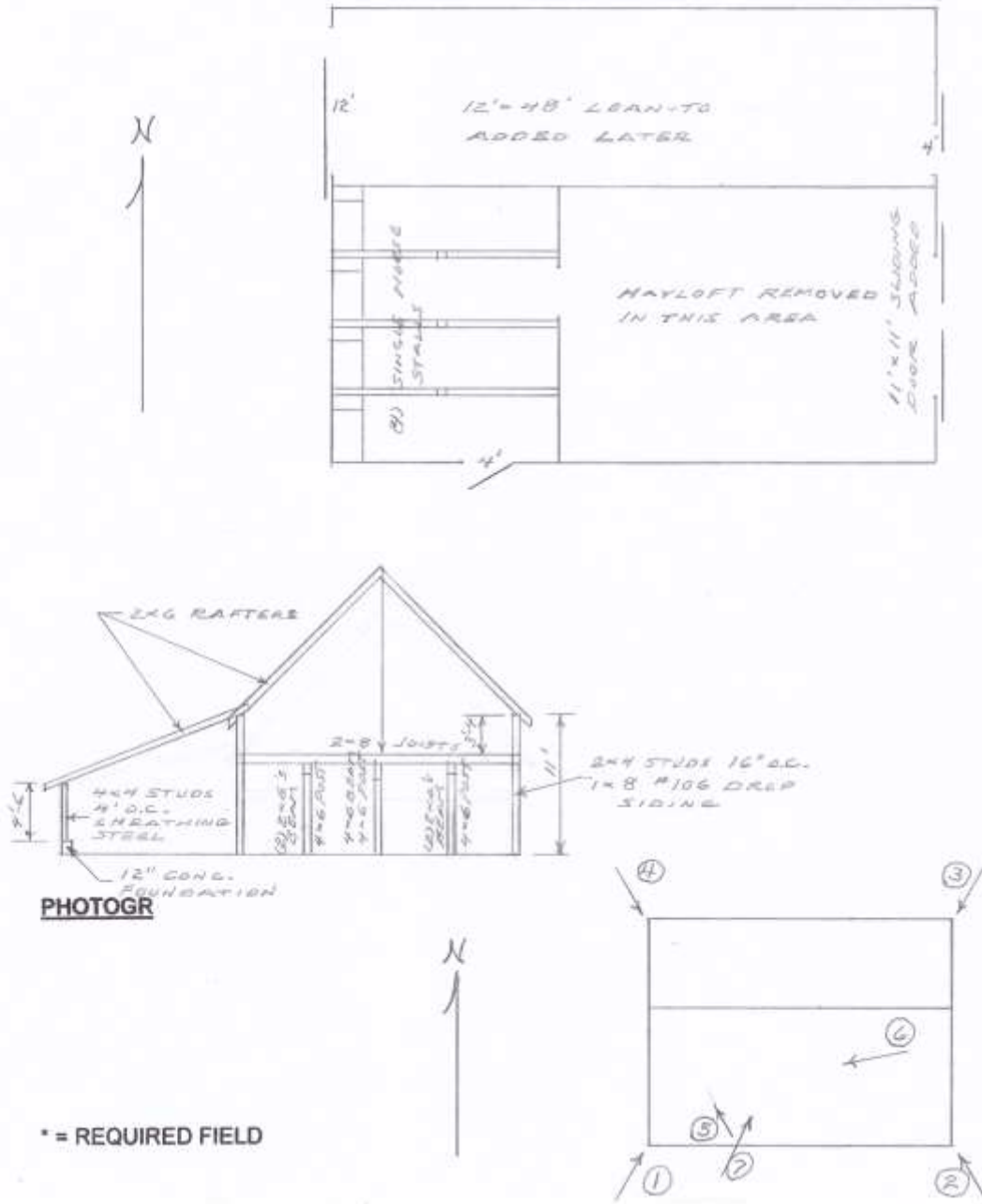

* = REQUIRED FIELD

**SOUTH DAKOTA STATE HISTORIC PRESERVATION OFFICE
HISTORIC SITES SURVEY STRUCTURE FORM**



PHOTOGRAPHER: Jim Stone
DATE OF PHOTO: October 30, 2012

ROLL NUMBER: _____
PHOTO NUMBER: 1
CAMERA DIRECTION: Looking NE, SW corner



PHOTOGRAPHER: Jim Stone
DATE OF PHOTO: October 30, 2012

ROLL NUMBER: _____
PHOTO NUMBER: 2
CAMERA DIRECTION: Looking NW, SE corner

* = REQUIRED FIELD

**SOUTH DAKOTA STATE HISTORIC PRESERVATION OFFICE
HISTORIC SITES SURVEY STRUCTURE FORM**



PHOTOGRAPHER: Jim Stone
DATE OF PHOTO: October 30, 2012

ROLL NUMBER: _____
PHOTO NUMBER: 3
CAMERA DIRECTION: Looking SW, NE corner



PHOTOGRAPHER: Jim Stone
DATE OF PHOTO: October 30, 2012

ROLL NUMBER: _____
PHOTO NUMBER: 4
CAMERA DIRECTION: Looking SE, NW corner

* = REQUIRED FIELD

**SOUTH DAKOTA STATE HISTORIC PRESERVATION OFFICE
HISTORIC SITES SURVEY STRUCTURE FORM**



PHOTOGRAPHER: Jim Stone
DATE OF PHOTO: October 30, 2012

ROLL NUMBER: _____
PHOTO NUMBER: 5

CAMERA DIRECTION: First floor, looking NW,
5' wide horse stalls on
the West wall.



PHOTOGRAPHER: Jim Stone
DATE OF PHOTO: October 30, 2012

ROLL NUMBER: _____
PHOTO NUMBER: 6

CAMERA DIRECTION: First floor. looking West,
into hayloft that is still in
place

**SOUTH DAKOTA STATE HISTORIC PRESERVATION OFFICE
HISTORIC SITES SURVEY STRUCTURE FORM**



PHOTOGRAPHER: Jim Stone
DATE OF PHOTO: October 30, 2012

ROLL NUMBER: _____
PHOTO NUMBER: 7

CAMERA DIRECTION: First floor, looking NE,
solid wall dividing west
side from the East side.

**SOUTH DAKOTA STATE HISTORIC PRESERVATION OFFICE
HISTORIC SITES SURVEY STRUCTURE FORM**

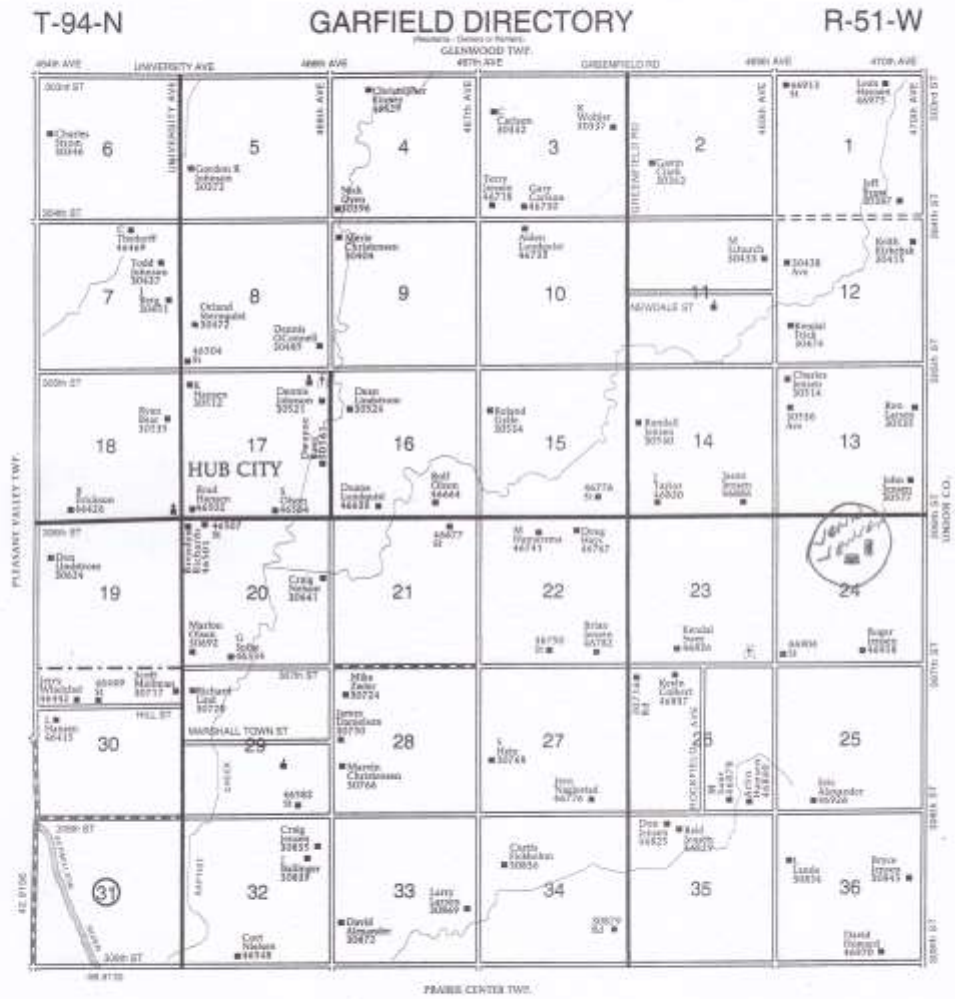

CLAY COUNTY ABSTRACT & TITLE COMPANY
PHONE 605-624-2068 FAX 605-624-9640
 Title Insurance - Closings - Title Reports
 121 Kidder St., Suite 104 - Vermillion, SD
 "Service You're Entitled To."
 clayabstract@iw.net

* = REQUIRED FIELD

HISTORY

This farm located in the W1/2 of the NE1/4 in Section 24, Garfield Township, Clay County was homesteaded by Hans Johnson.

The 1894 Clay County Atlas lists Hans Johnson as the owner.

The 1901 Clay County Atlas lists Anton Jensen as the owner.

The 1912 and 1924 Clay County Atlas lists Peter Rasmussen as the owner.

The 1937 Clay County Atlas lists Clara Ulvag as the owner and Knute Ulvag as the operator (renter).

The 1948 Clay County Atlas lists Oscar Austin as the owner.

The 1956 Clay County Atlas lists K. I. Jensen as the owner.

**SOUTH DAKOTA STATE HISTORIC PRESERVATION OFFICE
HISTORIC SITES SURVEY STRUCTURE FORM**

