

**SOUTH DAKOTA STATE HISTORIC PRESERVATION OFFICE
HISTORIC SITES SURVEY STRUCTURE FORM**



SITE INFORMATION

*SURVEY DATE: October 30, 2012 *ADDRESS: 46951 306th Street
*SURVEYOR: Jim Stone *COUNTY: Clay
*CITY: Beresford

LOCATION DESCRIPTION: From Vermillion South Dakota Highway 50 East about 2 miles to Greenfield Road, turn left, (North) 12-1/2 miles to 306th Street, turn right (East) 1-1/2 miles, turn right (South) (no address or fire number) into lane about 1/4 mile long.

LEGAL DESCRIPTION: W 1/2, NE 1/4, 24 - 94 - 51 Garfield Twp.

*QUARTER 1: NE 1/4
*QUARTER 2: _____
*TOWNSHIP: Garfield
*RANGE: 51
*SECTION: 24
ACRES: 77.64

OWNER NAME: John C. Jensen, Kristal D. Kirkle & Jacqueline E. Jens Jensen
OWNER ADDRESS: 30577 470th Ave.
OWNER CITY: Beresford
OWNER STATE: South Dakota
OWNER ZIP: 57004
QUAD NAME: _____

OWNER CODE 1: P
OWNER CODE 2: _____
OWNER CODE 3: _____

HISTORIC SIGNIFICANCE

*DOE: _____
*DOE DATE: _____
REASON INELIGIBLE: _____

REGISTER NAME: _____
MULTIPLE PROPERTY NAME: _____

NOMINATION STATUS: _____
DATE LISTED: _____
REFERENCE NUMBER: _____
HISTORIC DISTRICT RATING: C or NC
PERIOD: _____

CATEGORY: _____
SIGNIFICANCE LEVEL 1: N S L
SIGNIFICANCE LEVEL 2: N S L
CRITERIA 1: A B C D
CRITERIA 2: A B C D
CRITERIA 3: A B C D
CRITERIA 4: A B C D

SIGNIFICANCE NOTES: _____

STRUCTURE DETAILS

* = REQUIRED FIELD

**SOUTH DAKOTA STATE HISTORIC PRESERVATION OFFICE
HISTORIC SITES SURVEY STRUCTURE FORM**



SHPO ID: _____

*PROPERTY NAME: _____

OTHER NAME: _____

CURRENT FUNCTION: Storage

FOUNDATION: Poured concrete foundation

Some corri. galv. steel roofing over cedar shingles

CURRENT SUBFUNCTION: Storage

ROOF MATERIAL: _____

HISTORIC FUNCTION: Livestock barn

ROOF SHAPE: Gable

HISTORIC SUBFUNCTION: Hay storage

STRUCTURAL SYSTEM: Balloon framing

STYLE: Gable roof barn

OCCUPIED: Yes

TYPE: Livestock barn

2x4 stud with 1x8 #106 drop siding and corri. galv. steel

ACCESSIBLE: Yes with permission

WALLS: _____

STORIES: 2

SIGNIFICANT PERSON: Ovlag Knudson

*DATE OF CONSTRUCTION: ?

CULTURAL AFFILIATION: ?

ALTERED/MOVED NOTES: Original site. Milk cow stanchions have been removed. Part of roof and some of the walls are covered with 26" wide galvanized corrugated steel roofing. Interior has been remodeled. East 30' of hayloft removed. 11'x11" sliding doors added on East wall. Roll asphalt brick siding on South wall.

INTERIOR NOTES: Has three rows of 4x6 posts with (2) 2x6's for beams and (2) 2X8's for center beam. All posts and beams removed from East 30'. May have only been a center beam in that area, as there is a 2x4 solid dividing wall between. Four single horse stalls on West wall still in place.

OTHER NOTES: 2x4 stud walls, 16" O.C., 1x8 #106 drop siding. Lean-to on North was added later and walls are 4x4 studs, 48" O.C. with sheathing and galv. corrugated steel roofing. Rafters are 2x6's with sheathing, cedar shingles and some galvanized corrugated steel roofing on the North side.

Windows are 8"x10" four light. Wood cupola.

*PHYSICAL NOTES: Barn is poor condition.

*UTM ZONE: _____

*RESTRICTED: Y or N

*UTM EASTING: _____

*UTM NORTHING: _____

**SOUTH DAKOTA STATE HISTORIC PRESERVATION OFFICE
HISTORIC SITES SURVEY STRUCTURE FORM**

SKETCH MAP

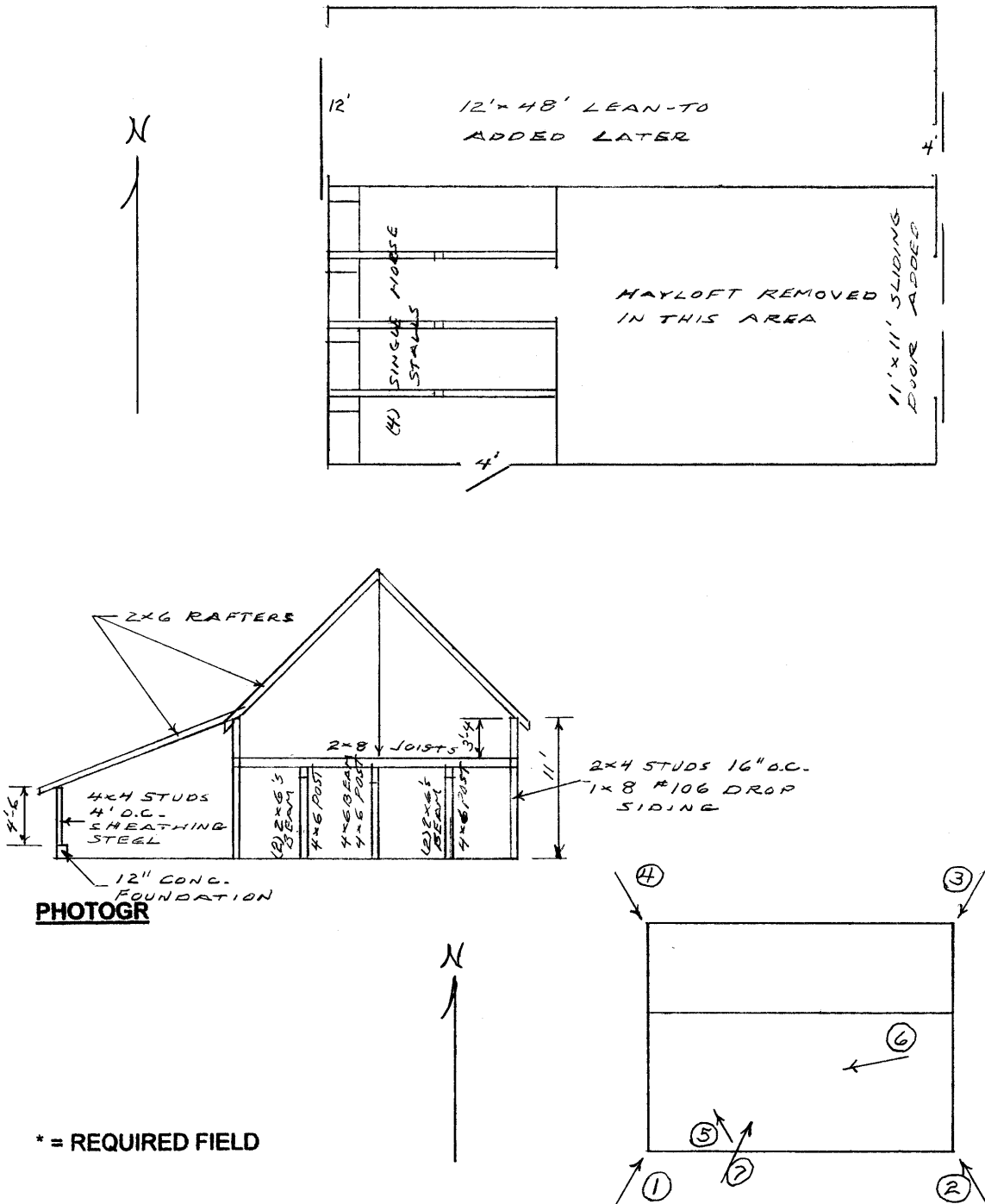

**SOUTH DAKOTA STATE HISTORIC PRESERVATION OFFICE
HISTORIC SITES SURVEY STRUCTURE FORM**



PHOTOGRAPHER: Jim Stone
DATE OF PHOTO: October 30, 2012

ROLL NUMBER: _____
PHOTO NUMBER: 1
CAMERA DIRECTION: Looking NE, SW corner



PHOTOGRAPHER: Jim Stone
DATE OF PHOTO: October 30, 2012

ROLL NUMBER: _____
PHOTO NUMBER: 2
CAMERA DIRECTION: Looking NW, SE corner

* = REQUIRED FIELD

**SOUTH DAKOTA STATE HISTORIC PRESERVATION OFFICE
HISTORIC SITES SURVEY STRUCTURE FORM**



PHOTOGRAPHER: Jim Stone
DATE OF PHOTO: October 30, 2012

ROLL NUMBER: _____
PHOTO NUMBER: 3
CAMERA DIRECTION: Looking SW, NE corner



PHOTOGRAPHER: Jim Stone
DATE OF PHOTO: October 30, 2012

ROLL NUMBER: _____
PHOTO NUMBER: 4
CAMERA DIRECTION: Looking SE, NW corner

* = REQUIRED FIELD

**SOUTH DAKOTA STATE HISTORIC PRESERVATION OFFICE
HISTORIC SITES SURVEY STRUCTURE FORM**



PHOTOGRAPHER: Jim Stone
DATE OF PHOTO: October 30, 2012

ROLL NUMBER: 5
PHOTO NUMBER: 5

CAMERA DIRECTION: First floor, looking NW,
5' wide horse stalls on
West wall



PHOTOGRAPHER: Jim Stone
DATE OF PHOTO: October 30, 2012

ROLL NUMBER: 6
PHOTO NUMBER: 6

CAMERA DIRECTION: First floor, East side,
looking up into hayloft
that is still in place

* = REQUIRED FIELD

**SOUTH DAKOTA STATE HISTORIC PRESERVATION OFFICE
HISTORIC SITES SURVEY STRUCTURE FORM**



PHOTOGRAPHER: Jim Stone
DATE OF PHOTO: October 30, 2012

ROLL NUMBER: _____
PHOTO NUMBER: 7

CAMERA DIRECTION: First floor, looking NE,
solid wall dividing West
18' from East 30'

**SOUTH DAKOTA STATE HISTORIC PRESERVATION OFFICE
HISTORIC SITES SURVEY STRUCTURE FORM**



T-94-N

GARFIELD DIRECTORY

R-51-W

(Residents - Owners or Renters)
GLENWOOD TWP.

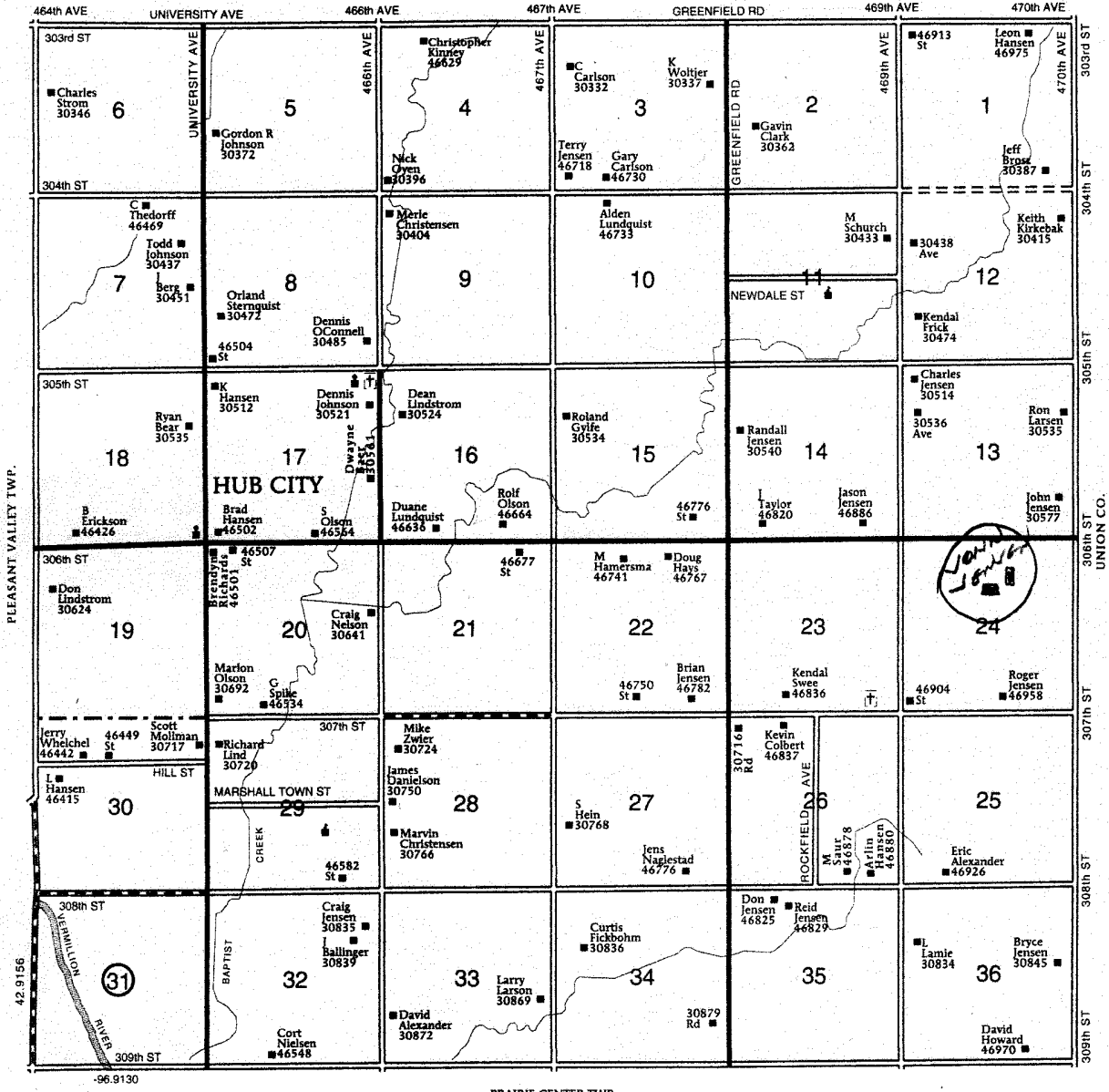

* = REQUIRED FIELD

HISTORY

This farm located in the W ½ of the NE ¼ in Section 24, Garfield Township, Clay County was homesteaded by Hans Johnson.

The 1894 Clay County Atlas lists Hans Johnson as the owner.

The 1901 Clay County Atlas lists Anton Jensen as the owner.

The 1912 and 1924 Clay County Atlas lists Peter Rasmussen as the owner.

The 1937 Clay County Atlas lists Clara Ulvag as the owner and Knute Ulvag as the operator (renter).

The 1948 Clay County Atlas lists Oscar Austin as the owner.

The 1956 Clay County Atlas lists K. I. Jensen as the owner.

**SOUTH DAKOTA STATE HISTORIC PRESERVATION OFFICE
HISTORIC SITES SURVEY STRUCTURE FORM**

