

**SOUTH DAKOTA STATE HISTORIC PRESERVATION OFFICE
HISTORIC SITES SURVEY STRUCTURE FORM**



SITE INFORMATION

*SURVEY DATE: December 2, 2013 *ADDRESS: 926 E. 316th Street
*SURVEYOR: Jim Stone *COUNTY: Clay
*CITY: Vermillion

LOCATION DESCRIPTION: From Vermillion, from intersection of South Dakota Highway 50 bi-pass and University Road, North 1 mile to 316th Street, turn right (East) about 1/4 mile on the left (North) side

LEGAL DESCRIPTION: Lot C of Lot 1 in SW 1/4, 6 - 92 - 51 Vermillion Twp.

*QUARTER 1: SW 1/4
*QUARTER 2: _____
*TOWNSHIP: Vermillion
*RANGE: 51
*SECTION: 6
ACRES: 3.91

OWNER NAME: Jeffery S. & Carolyn A. Jensen
OWNER ADDRESS: 926 E. 316th Street
OWNER CITY: Vermillion
OWNER STATE: South Dakota
OWNER ZIP: 57069
QUAD NAME: _____

OWNER CODE 1: P
OWNER CODE 2: _____
OWNER CODE 3: _____

HISTORIC SIGNIFICANCE

*DOE: _____
*DOE DATE: _____
REASON INELIGIBLE: _____

REGISTER NAME: _____
MULTIPLE PROPERTY NAME: _____

NOMINATION STATUS: _____
DATE LISTED: _____
REFERENCE NUMBER: _____
HISTORIC DISTRICT RATING: C or NC
PERIOD: _____

CATEGORY: _____
SIGNIFICANCE LEVEL 1: N S L
SIGNIFICANCE LEVEL 2: N S L
CRITERIA 1: A B C D
CRITERIA 2: A B C D
CRITERIA 3: A B C D
CRITERIA 4: A B C D

SIGNIFICANCE NOTES: _____

STRUCTURE DETAILS

* = REQUIRED FIELD

**SOUTH DAKOTA STATE HISTORIC PRESERVATION OFFICE
HISTORIC SITES SURVEY STRUCTURE FORM**



SHPO ID: _____
 *PROPERTY NAME: _____
 OTHER NAME: _____

CURRENT FUNCTION: Storage FOUNDATION: Poured concrete
 CURRENT SUBFUNCTION: Storage ROOF MATERIAL: Steel roofing over cedar shingles
 HISTORIC FUNCTION: Livestock barn ROOF SHAPE: Gable roof
 HISTORIC SUBFUNCTION: Hay storage STRUCTURAL SYSTEM: Balloon framing
 OCCUPIED: No STYLE: Gable roof barn
 Yes with TYPE: Western feeder barn
 ACCESSIBLE: Yes with permission WALLS: 2x4 studs, and 1x6 #106 drop siding

STORIES: 2 SIGNIFICANT PERSON: H. A. Atwood
 *DATE OF CONSTRUCTION: 1890 to 1910 CULTURAL AFFILIATION: ?

ALTERED/MOVED NOTES: Original site. 1-1/4" x 26" galvanized, corrugated steel installed on roof over cedar shingles. All evidence of milk cow stanchions has been removed from the East lean-to.

INTERIOR NOTES: Six double horse stalls still in place in West lean-to. Double 2x6 posts 8' O. C. support the center of the rafters on each side of the center 24'. The west side is open into the horse stalls. The East side is covered with 1x8 shiplap for a solid wall up to the rafters. 32' x 16' hayloft floor at the South end. The loft floor extends 8' over the two South horse stalls. The 24' x 32' in the center area at the North end is a hayloft from the ground up 28' to the peak of the roof.

OTHER NOTES: Exterior walls are 2x4 stud walls with 1x6 #106 drop siding. The windows are 9" x 12" four light. The cupola has been removed. The 2x4 studs, 2x6 rafters, 2x6 floor joists, 2x6 posts, 4x4 Posts and 4x4 beams are all rough sawn cottonwood.

*PHYSICAL NOTES: Barn is in good condition. *RESTRICTED: Y or N
 *UTM EASTING: _____
 *UTM NORTHING: _____

**SOUTH DAKOTA STATE HISTORIC PRESERVATION OFFICE
HISTORIC SITES SURVEY STRUCTURE FORM**

SKETCH MAP

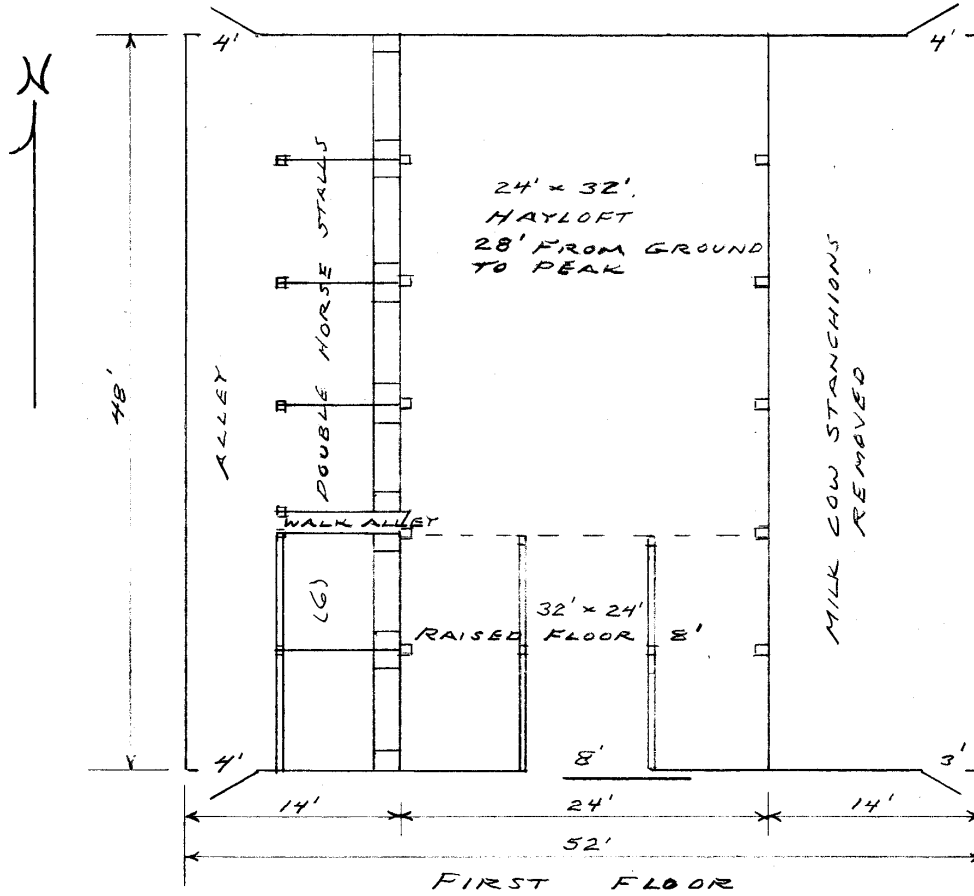

PHOTOGR

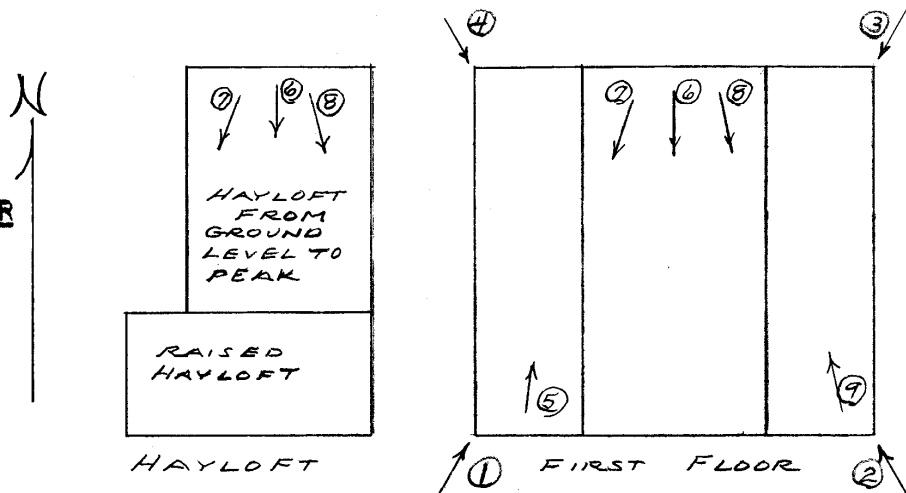

* = REQUIRED FIELD

SOUTH DAKOTA STATE HISTORIC PRESERVATION OFFICE
HISTORIC SITES SURVEY STRUCTURE FORM

SKETCH MAP

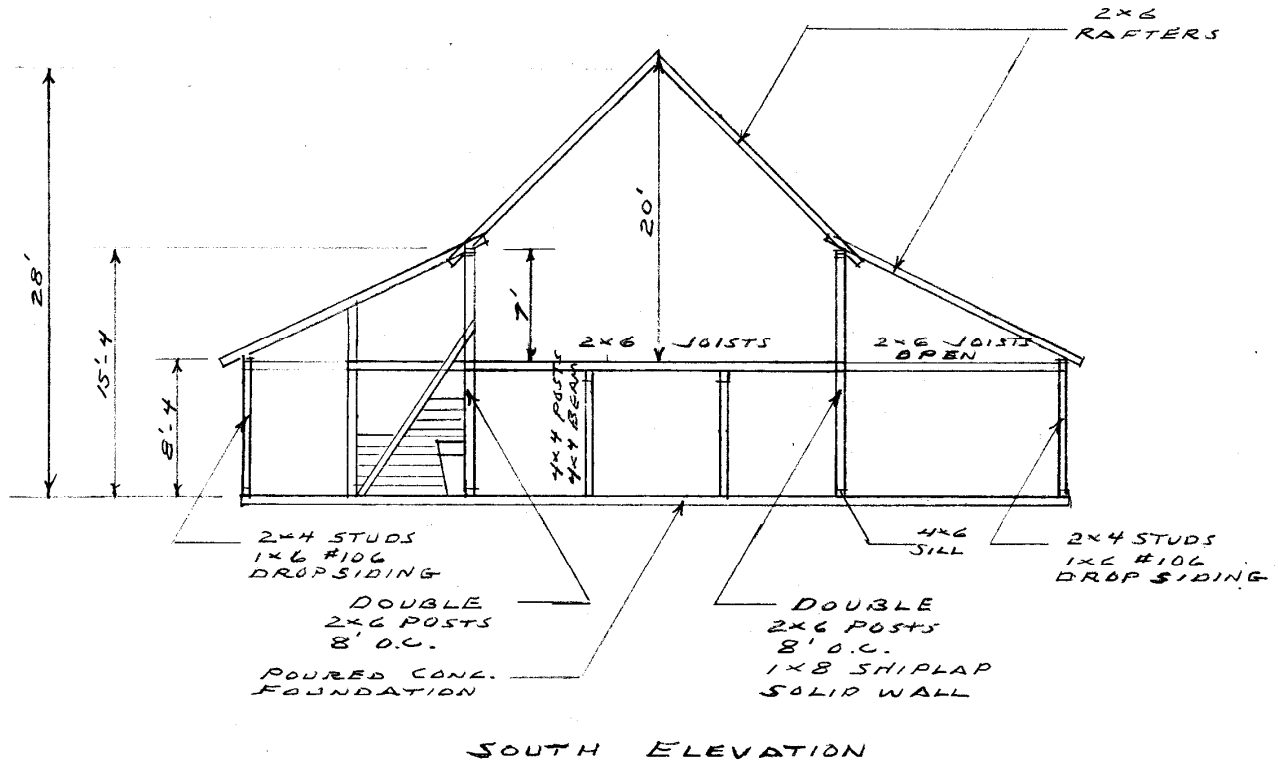

PHOTOGR

* = REQUIRED FIELD

**SOUTH DAKOTA STATE HISTORIC PRESERVATION OFFICE
HISTORIC SITES SURVEY STRUCTURE FORM**



PHOTOGRAPHER: Jim Stone
DATE OF PHOTO: December 2, 2013

ROLL NUMBER: _____
PHOTO NUMBER: 1
CAMERA DIRECTION: Looking NE, SW corner



PHOTOGRAPHER: Jim Stone
DATE OF PHOTO: December 2, 2013

ROLL NUMBER: _____
PHOTO NUMBER: 2
CAMERA DIRECTION: Looking NW, SE corner

* = REQUIRED FIELD

**SOUTH DAKOTA STATE HISTORIC PRESERVATION OFFICE
HISTORIC SITES SURVEY STRUCTURE FORM**



PHOTOGRAPHER: Jim Stone
DATE OF PHOTO: December 2, 2013

ROLL NUMBER: _____
PHOTO NUMBER: 3
CAMERA DIRECTION: Looking SW, NE corner



PHOTOGRAPHER: Jim Stone
DATE OF PHOTO: December 2, 2013

ROLL NUMBER: _____
PHOTO NUMBER: 4
CAMERA DIRECTION: Looking SE, NW corner

* = REQUIRED FIELD

**SOUTH DAKOTA STATE HISTORIC PRESERVATION OFFICE
HISTORIC SITES SURVEY STRUCTURE FORM**



PHOTOGRAPHER: Jim Stone
DATE OF PHOTO: December 2, 2013

ROLL NUMBER: _____
PHOTO NUMBER: 5

First floor, West lean-to looking NE, double horse stalls on West side, note hayloft above two South stalls.

CAMERA DIRECTION: _____



PHOTOGRAPHER: Jim Stone
DATE OF PHOTO: December 2, 2013

ROLL NUMBER: _____
PHOTO NUMBER: 6

First floor, looking South, hayloft floor at the South 16'.

CAMERA DIRECTION: _____

* = REQUIRED FIELD

**SOUTH DAKOTA STATE HISTORIC PRESERVATION OFFICE
HISTORIC SITES SURVEY STRUCTURE FORM**



PHOTOGRAPHER: Jim Stone
DATE OF PHOTO: December 2, 2013

ROLL NUMBER: _____
PHOTO NUMBER: 7

Center of barn, looking SW, double 2x6 posts 8' O. C. supporting center of rafters on West side.

CAMERA DIRECTION: _____



PHOTOGRAPHER: Jim Stone
DATE OF PHOTO: December 2, 2013

ROLL NUMBER: _____
PHOTO NUMBER: 8

Center of barn, looking SE, double 2x6 posts with 1x8 shiplap up to roof on the East side.

CAMERA DIRECTION: _____

* = REQUIRED FIELD

**SOUTH DAKOTA STATE HISTORIC PRESERVATION OFFICE
HISTORIC SITES SURVEY STRUCTURE FORM**



PHOTOGRAPHER: Jim Stone
DATE OF PHOTO: December 2, 2013

ROLL NUMBER: _____
PHOTO NUMBER: 9

CAMERA DIRECTION: First floor, East lean-to, looking NW, where the milk cow stanchions were, note 1x8 shiplap on West wall and 2x6 open joists 4' O. C.

**SOUTH DAKOTA STATE HISTORIC PRESERVATION OFFICE
HISTORIC SITES SURVEY STRUCTURE FORM**



T-91-92-N VERMILLION DIRECTORY R-51-52-W
(Residents - Owners or Renters)

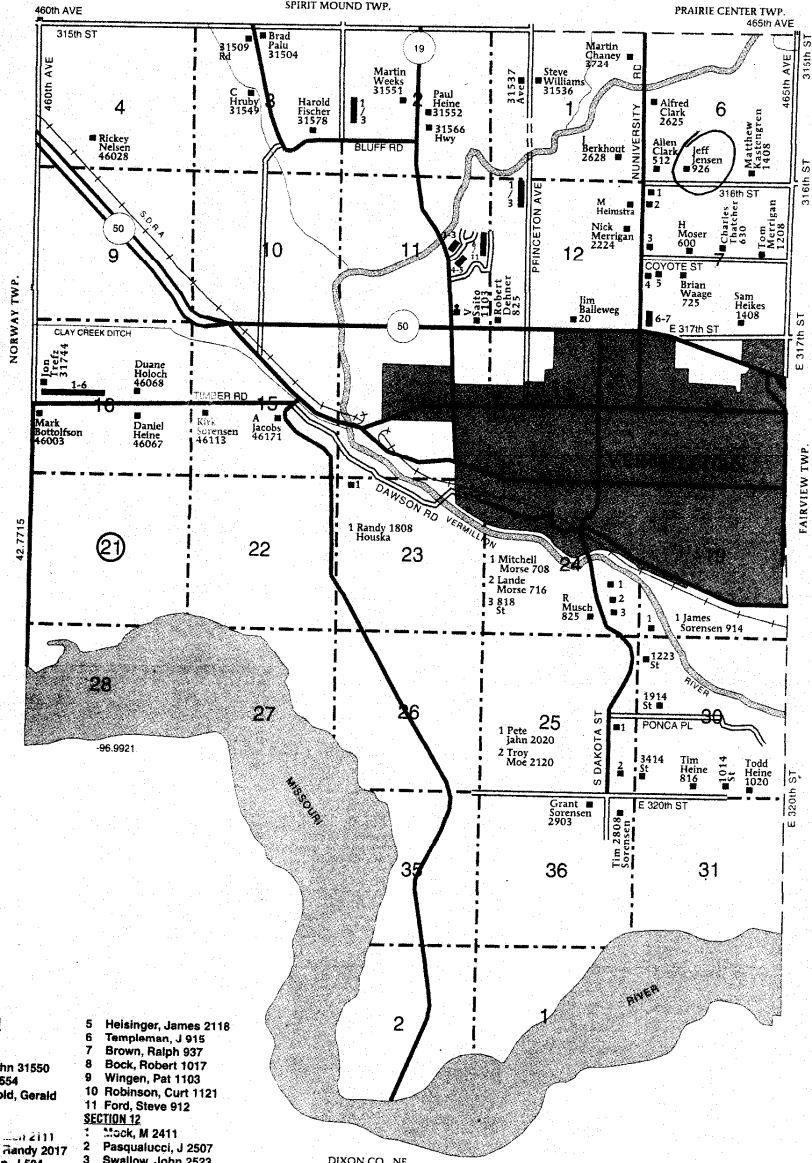

- VERMILLION TOWNSHIP**
- SECTION 21**
- 1 Koeter, John 31550
 - 2 Patri, V 31554
 - 3 Sommersvoid, Gerald 31558
- SECTION 7**
- 1 [Name], [Address] 2111
 - 2 [Name], Randy 2017
 - 3 Zimmerman, J 504
 - 4 1909
 - 5 Laitala, Terry 711
 - 6 [Name]
 - 7 Simons, [Name]
- SECTION 11**
- 1 Gilbertson, Marty 2021
 - 2 Storm, John 2109
 - 3 [Name], Richard 2102
- SECTION 5**
- 5 Helsing, James 2118
 - 6 Templeman, J 915
 - 7 Brown, Ralph 937
 - 8 Bock, Robert 1017
 - 9 Wingen, Pat 1103
 - 10 Robinson, Curt 1121
 - 11 Ford, Steve 912
- SECTION 12**
- 1 [Name], M 2411
 - 2 Pasqualucci, J 2507
 - 3 Swallow, John 2523
- SECTION 15**
- 1 45002
 - 2 [Name]
 - 3 [Name]
 - 4 Johnson, Robert L 46020
 - 5 Halverson, Ernest 46044
 - 6 [Name], [Address] 46048

© Farm & Home Publishers, Ltd.

* = REQUIRED FIELD

History

This farm located in the SW ¼ of Section 6, Vermillion Township, Clay County was homesteaded by Ezbrian Harrington.

The 1894 and 1901 Clay County Atlas lists H. H. Atwood as the owner.

The 1912 Clay County Atlas lists E. Atwood as the owner.

The 1924 Clay County Atlas lists T. J. Helgenson as the owner.

The 1937 and 1948 Clay County Atlas lists Bertha A. Atwood as the owner.

The 1956 Clay County Atlas lists H. C. Johnson as the owner.

**SOUTH DAKOTA STATE HISTORIC PRESERVATION OFFICE
HISTORIC SITES SURVEY STRUCTURE FORM**

