

**SOUTH DAKOTA STATE HISTORIC PRESERVATION OFFICE
HISTORIC SITES SURVEY STRUCTURE FORM**



SITE INFORMATION

*SURVEY DATE: November 4, 2011 *ADDRESS: 46068 Timber Road
*SURVEYOR: Jim Stone *COUNTY: Clay
*CITY: Vermillion

LOCATION DESCRIPTION: West of Vermillion on Hwy 50, turn South (left) on Hwy 19 and turn West (right) on Timber Road, West about 1-1/4 miles, address 46068 on the North side .

LEGAL DESCRIPTION: SW 1/4 of NE 1/4 of Section 16, 92, R52

*QUARTER 1: NE 1/4 OWNER NAME: Duane and Connie Holoch
*QUARTER 2: _____ OWNER ADDRESS: 46068 Timber Road
*TOWNSHIP: Vermillion OWNER CITY: Vermillion
*RANGE: 52 W OWNER STATE: South Dakota
*SECTION: 16 OWNER ZIP: 57069
ACRES: 38.85 QUAD NAME: _____
OWNER CODE 1: P
OWNER CODE 2: F S L P
OWNER CODE 3: F S L P

HISTORIC SIGNIFICANCE

*DOE: _____ REGISTER NAME: _____
*DOE DATE: _____ MULTIPLE PROPERTY NAME: _____
REASON INELIGIBLE: _____

NOMINATION STATUS: _____ CATEGORY: _____
DATE LISTED: _____ SIGNIFICANCE LEVEL 1: N S L
REFERENCE NUMBER: _____ SIGNIFICANCE LEVEL 2: N S L
HISTORIC DISTRICT RATING: C or NC CRITERIA 1: A B C D
PERIOD: _____ CRITERIA 2: A B C D
CRITERIA 3: A B C D
CRITERIA 4: A B C D

SIGNIFICANCE NOTES: Barn was remodeled in 1999, all but the north ten feet of haymow has been removed, 20' x 15' 6" overhead door installed on south side. Roof has been covered with steel roofing and Mr. Holoch is installing steel siding over the existing wood siding. Barn is in good condition. 2x6 framing is all Douglas Fir which was the lumber of choice from 1900's to 1970's.

* = REQUIRED FIELD

**SOUTH DAKOTA STATE HISTORIC PRESERVATION OFFICE
HISTORIC SITES SURVEY STRUCTURE FORM**



STRUCTURE DETAILS

SHPO ID: _____
 *PROPERTY NAME: Chaney barn
 OTHER NAME: _____

CURRENT FUNCTION: Hay & machinery storage FOUNDATION: Poured concrete

CURRENT SUBFUNCTION: Hay & machinery storage ROOF MATERIAL: Steel over cedar shingles
 HISTORIC FUNCTION: Livestock barn ROOF SHAPE: Gambrel
 HISTORIC SUBFUNCTION: Hay and grain storage STRUCTURAL SYSTEM: Balloon framing
 STYLE: Ground floor with huge hayloft
 OCCUPIED: YES TYPE: Livestock barn
 YES with 2x6 with 1x6 #106
 ACCESSIBLE: permission WALLS: drop siding

STORIES: 2 SIGNIFICANT PERSON: George Jaspersen
 *DATE OF CONSTRUCTION: 1920 to 1930 CULTURAL AFFILIATION: ?

ALTERED/MOVED NOTES: Original site. In 1999 all but the north ten feet of hayloft has been removed and 20' x 15'-6" overhead door installed on the South side for hay and machinery storage.

INTERIOR NOTES: Original barn had two rows 6x6 posts with (4) 2x6's nailed together for a beam which ran North and South. Posts were 10' O.C. North to South and 12' O.C. East to West. Hayloft floor is 2x10 floor joists with 3/4" floor boards. This can be seen in the 10 feet of floor left at the North end. Rafters are modified braced rafter truss.

OTHER NOTES: Four dormers off the hip on roof. Two dormers on East and two dormers on the West. Each dormer has (3) four light windows. A very large metal cupola on the roof peak. Barn had (3) 9x12 four light windows on the East wall and (2) more next to the peak on the North. The South wall had (2) large windows next to peak. These windows were 4"x24" four light over 4"x12" four light and are double hung for ventilation.

*PHYSICAL NOTES: Barn is in good condition. Windows and small walk doors will be covered on the outside with steel siding when Mr. Holoch is through siding the exterior.

* = REQUIRED FIELD

**SOUTH DAKOTA STATE HISTORIC PRESERVATION OFFICE
HISTORIC SITES SURVEY STRUCTURE FORM**



**SOUTH DAKOTA STATE HISTORIC PRESERVATION OFFICE
HISTORIC SITES SURVEY STRUCTURE FORM**



SKETCH MAP

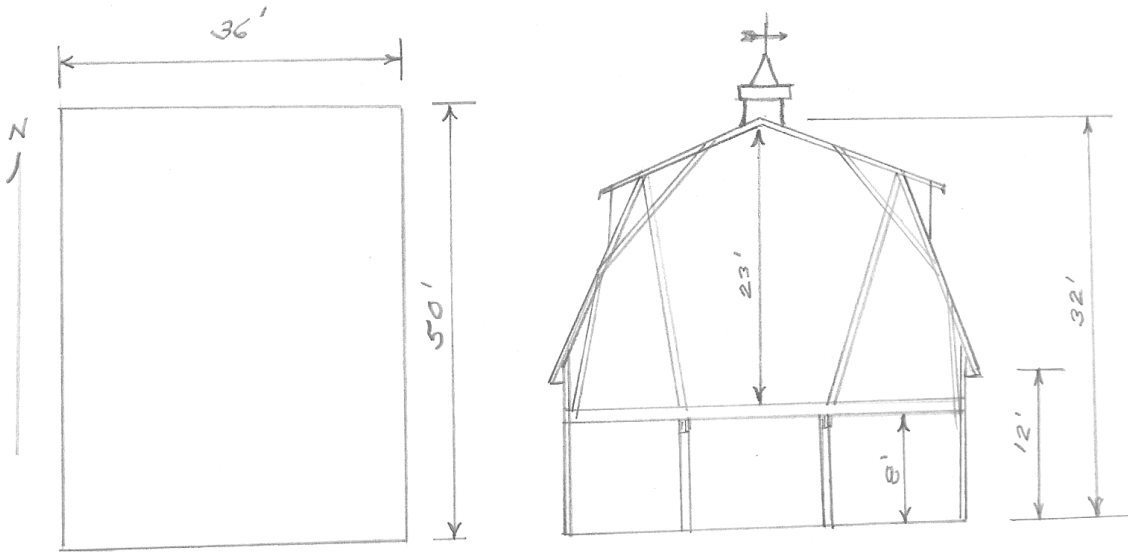

PHOTOGRAPHS

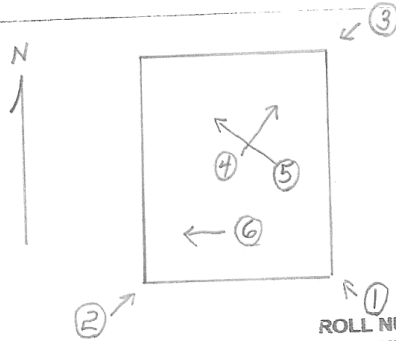

PHOTOGRAPHER: _____
DATE OF PHOTO: _____

ROLL NUMBER: _____
PHOTO NUMBER: _____
CAMERA DIRECTION: _____

* = REQUIRED FIELD

**SOUTH DAKOTA STATE HISTORIC PRESERVATION OFFICE
HISTORIC SITES SURVEY STRUCTURE FORM**



PHOTOGRAPHER: Jim Stone
DATE OF PHOTO: November 4, 2011

ROLL NUMBER: _____
PHOTO NUMBER: 1
CAMERA DIRECTION: Looking NW, SE corner



PHOTOGRAPHER: Jim Stone
DATE OF PHOTO: November 4, 2011

ROLL NUMBER: _____
PHOTO NUMBER: 2
CAMERA DIRECTION: Looking NE, SW corner

* = REQUIRED FIELD

**SOUTH DAKOTA STATE HISTORIC PRESERVATION OFFICE
HISTORIC SITES SURVEY STRUCTURE FORM**



PHOTOGRAPHER: Jim Stone

ROLL NUMBER: _____

DATE OF PHOTO: November 4, 2011

PHOTO NUMBER: 3
CAMERA DIRECTION: Looking SW, NE corner



PHOTOGRAPHER: Jim Stone

ROLL NUMBER: _____

DATE OF PHOTO: November 4, 2011

PHOTO NUMBER: 4
CAMERA DIRECTION: Looking NE, Rafters and existing 10' of hayloft

* = REQUIRED FIELD

**SOUTH DAKOTA STATE HISTORIC PRESERVATION OFFICE
HISTORIC SITES SURVEY STRUCTURE FORM**



PHOTOGRAPHER: Jim Stone
DATE OF PHOTO: November 4, 2011

ROLL NUMBER: _____
PHOTO NUMBER: 5
CAMERA DIRECTION: Looking NW, Rafters and existing 10' of hayloft



PHOTOGRAPHER: Jim Stone
DATE OF PHOTO: November 4, 2011

ROLL NUMBER: _____
PHOTO NUMBER: 6
CAMERA DIRECTION: Looking West, rafters, bracing and wall

* = REQUIRED FIELD

**SOUTH DAKOTA STATE HISTORIC PRESERVATION OFFICE
HISTORIC SITES SURVEY STRUCTURE FORM**



PHOTOGRAPHER: Connie Holoch
DATE OF PHOTO: Winter of 2000- 2001

ROLL NUMBER: _____
PHOTO NUMBER: 7

CAMERA DIRECTION: Looking SE, NW corner
of barn



PHOTOGRAPHER: Connie Holoch
DATE OF PHOTO: 1990

ROLL NUMBER: _____
PHOTO NUMBER: 8

CAMERA DIRECTION: Looking NW, SE corner
of barn

**SOUTH DAKOTA STATE HISTORIC PRESERVATION OFFICE
HISTORIC SITES SURVEY STRUCTURE FORM**



T-91-92-N VERMILLION DIRECTORY R-51-52-W

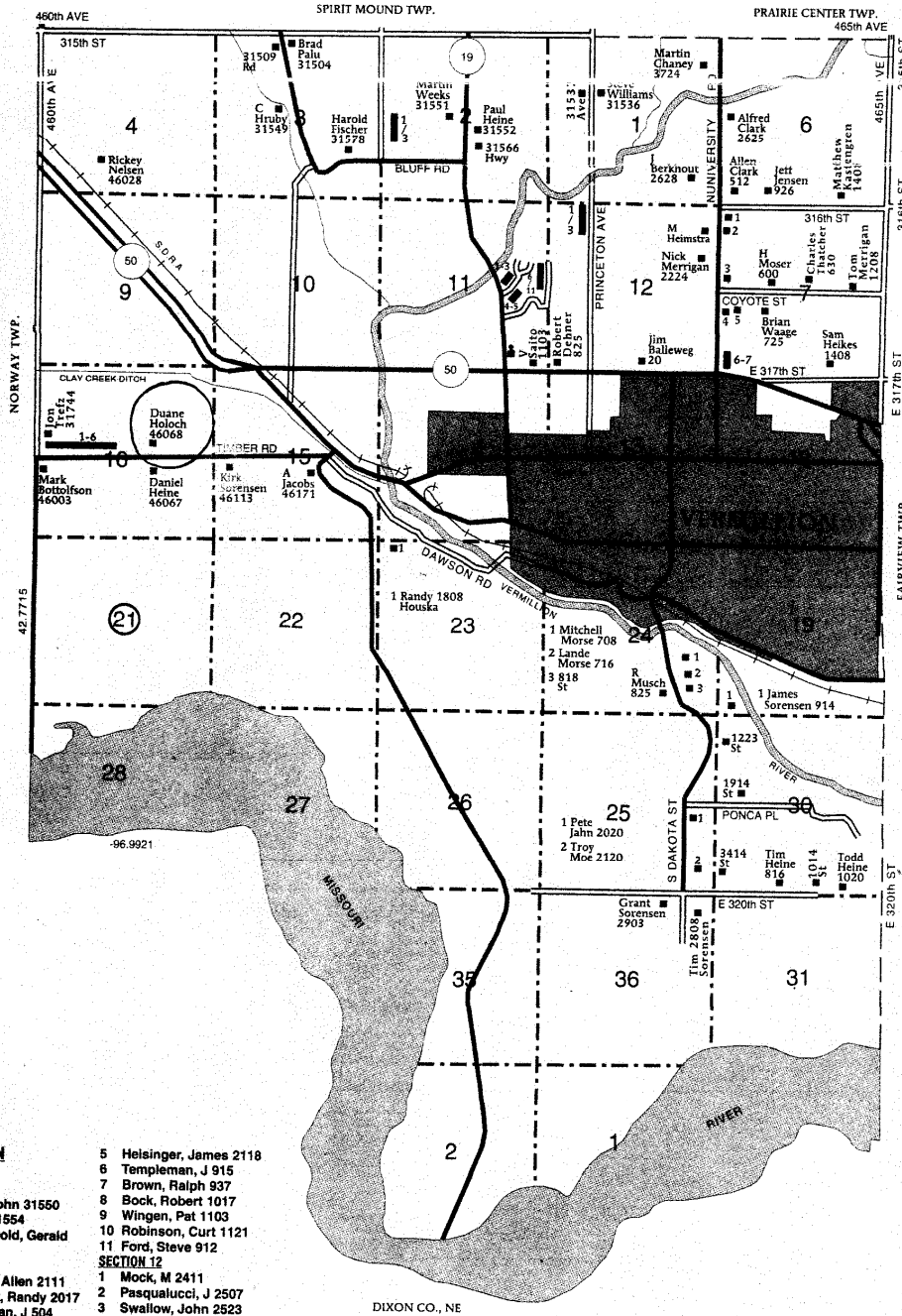

- VERMILLION TOWNSHIP**
- SECTION 2H**
- 1 Koester, John 31550
 - 2 Patri, V 31554
 - 3 Sommervold, Gerald 31558
- SECTION 7**
- 1 Johnson, Allen 2111
 - 2 Wheelock, Randy 2017
 - 3 Zimmerman, J 504
 - 4 1909
 - 5 Lehtala, Terry 711
 - 6 Olson, Eric 1817
 - 7 Simons, Kai 1421
- SECTION 11**
- 1 Gilbertson, Marty 2021
 - 2 Storm, John 2109
 - 3 Campbell, B 1919
 - 4 McBride, Richard 2102
- SECTION 12**
- 1 Mock, M 2411
 - 2 Pasqualucci, J 2507
 - 3 Swallow, John 2523
- SECTION 16**
- 1 46002
 - 2 Kober, Tom 46004
 - 3 Myron, Warren 46008
 - 4 Johnson, Robert L 46020
 - 5 Halverson, Ernest 46044
 - 6 Struckman, Dave 46048
- SECTION 28**
- 5 Helsingier, James 2118
 - 6 Templeman, J 915
 - 7 Brown, Ralph 937
 - 8 Bock, Robert 1017
 - 9 Wingen, Pat 1103
 - 10 Robinson, Curt 1121
 - 11 Ford, Steve 912

© Farm & Home Publishers, Ltd.

* = REQUIRED FIELD

History

This farm located in the NE ¼ of Section 16, Vermillion Township, Clay County was a “School Section” to be rented or sold with the proceeds set aside for rural school education.

The 1894 and 1901 Clay County Atlas lists Lee & Prentis as the owners.

The 1912 Clay County Atlas lists C. E. Prentis as the owner.

The 1924 Clay County Atlas lists George Jasperson as the owner.

The 1937 Clay County Atlas lists M. J. Chaney as the owner.

The 1948 and 1956 Clay County Atlas lists M. A. Chaney as the owner.

**SOUTH DAKOTA STATE HISTORIC PRESERVATION OFFICE
HISTORIC SITES SURVEY STRUCTURE FORM**

