

**SOUTH DAKOTA STATE HISTORIC PRESERVATION OFFICE
HISTORIC SITES SURVEY STRUCTURE FORM**



SITE INFORMATION

*SURVEY DATE: Aug. 17, 2012 *ADDRESS: 45667 Jetley Park Street
*SURVEYOR: Jim Stone *COUNTY: Clay
*CITY: Meckling

LOCATION DESCRIPTION: From the intersection of South Dakota Highway 50 bi-pass and South Dakota Highway 19, West 4-3/4 miles to 459th Ave., turn left (South) about 200' to Jetley Park Street, turn Right (West), about 1-1/3rd mile, on the left (South) side.

LEGAL DESCRIPTION: SW 1/4, EXC. Lot G-1, 35 – 93 – 53 Meckling Twp.

*QUARTER 1: SE 1/4
*QUARTER 2: _____
*TOWNSHIP: Meckling
*RANGE: 53
*SECTION: 35
ACRES: _____

OWNER NAME: Henrietta Sealey
OWNER ADDRESS: 45667 Jetley Park Street
OWNER CITY: Vermillion
OWNER STATE: South Dakota
OWNER ZIP: 57069
QUAD NAME: _____

OWNER CODE 1: P
OWNER CODE 2: _____
OWNER CODE 3: _____

HISTORIC SIGNIFICANCE

*DOE: _____
*DOE DATE: _____
REASON INELIGIBLE: _____

REGISTER NAME: _____
MULTIPLE PROPERTY NAME: _____

NOMINATION STATUS: _____
DATE LISTED: _____
REFERENCE NUMBER: _____
HISTORIC DISTRICT RATING: C or NC
PERIOD: _____

CATEGORY: _____
SIGNIFICANCE LEVEL 1: N S L
SIGNIFICANCE LEVEL 2: N S L
CRITERIA 1: A B C D
CRITERIA 2: A B C D
CRITERIA 3: A B C D
CRITERIA 4: A B C D

SIGNIFICANCE NOTES: _____

STRUCTURE DETAILS

* = REQUIRED FIELD

**SOUTH DAKOTA STATE HISTORIC PRESERVATION OFFICE
HISTORIC SITES SURVEY STRUCTURE FORM**



SHPO ID: _____
 *PROPERTY NAME: _____
 OTHER NAME: _____

CURRENT FUNCTION: <u>Vacant</u>	FOUNDATION: <u>None – built on poles</u>
CURRENT SUBFUNCTION: <u>storage</u>	ROOF MATERIAL: <u>steel over sheathing</u>
HISTORIC FUNCTION: <u>Western feeder barn</u>	ROOF SHAPE: <u>Gable</u>
HISTORIC SUBFUNCTION: <u>Hay storage</u>	STRUCTURAL SYSTEM: <u>Pole barn</u>
	STYLE: <u>Western feeder barn</u>
OCCUPIED: <u>Yes</u>	TYPE: <u>Livestock barn</u>
	WALLS: <u>Untreated poles & logs, girts 4' O.C.</u>
ACCESSIBLE: <u>Yes with permission</u>	WALLS: <u>vertical 1x12 siding</u>
STORIES: <u>1</u>	SIGNIFICANT PERSON: <u>Fred Demann</u>
*DATE OF CONSTRUCTION: <u>?</u>	CULTURAL AFFILIATION: <u>German</u>

ALTERED/MOVED NOTES: Original site. Lean-to on the East and South may have been added, but Would have been a long time ago. There is evidence that the cedar shingles were removed and 26" galv. corrugated steel roofing was installed. This may have been when the lean-to's were added.

INTERIOR NOTES: Has three rows of 8" logs and poles supporting the main barn. Two rows are the exterior walls and the third row is in the center. All the bracing and horizontal girts are 2x6's. The South and East walls are open in the main barn with feed racks to feed cattle.

OTHER NOTES: Walls are 2x6 girts 4' O.C. over 8" poles and 6" poles on the lean-to's with 1x12 vertical siding with battens over the cracks. All of the dimension lumber is rough sawn cottonwood. The 2x6 rafters are the only milled lumber in the barn. The logs on the main barn are logs with the bark peeled off. Some of poles on the lean-to appear to be milled posts.

*PHYSICAL NOTES: Barn is in fair condition. The roof is not leaking yet.

*UTM ZONE: _____

*RESTRICTED: Y or N

*UTM EASTING: _____

*UTM NORTHING: _____

* = REQUIRED FIELD

**SOUTH DAKOTA STATE HISTORIC PRESERVATION OFFICE
HISTORIC SITES SURVEY STRUCTURE FORM**

SKETCH MAP

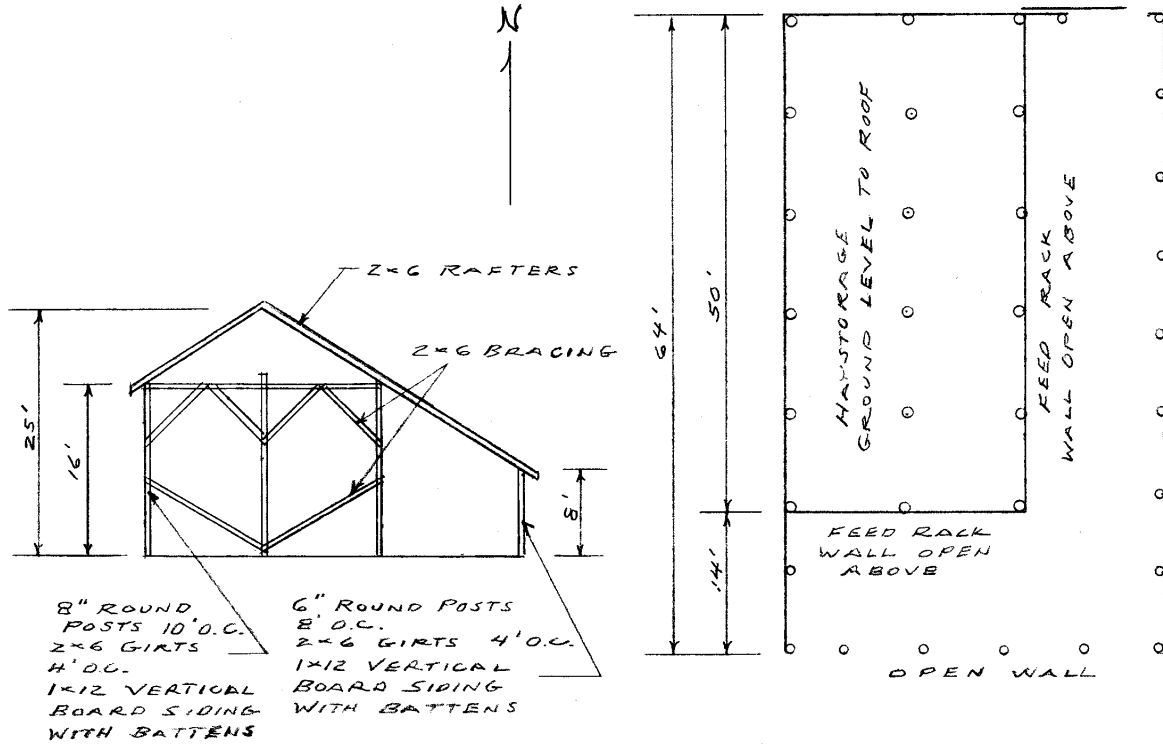

PHOTOGR

* = REQUIRED FIELD

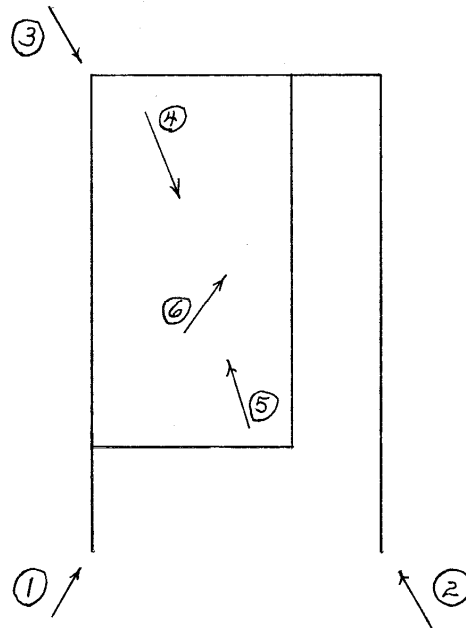

* = REQUIRED FIELD

**SOUTH DAKOTA STATE HISTORIC PRESERVATION OFFICE
HISTORIC SITES SURVEY STRUCTURE FORM**



PHOTOGRAPHER: Jim Stone
DATE OF PHOTO: Aug. 17, 2012

ROLL NUMBER: _____
PHOTO NUMBER: 1
CAMERA DIRECTION: Looking NE, SW corner



PHOTOGRAPHER: Jim Stone
DATE OF PHOTO: Aug. 17, 2012

ROLL NUMBER: _____
PHOTO NUMBER: 2
CAMERA DIRECTION: Looking NW, SE corner

**SOUTH DAKOTA STATE HISTORIC PRESERVATION OFFICE
HISTORIC SITES SURVEY STRUCTURE FORM**



PHOTOGRAPHER: Jim Stone
DATE OF PHOTO: Aug. 17, 2012

ROLL NUMBER: _____
PHOTO NUMBER: 3
CAMERA DIRECTION: Looking SE, NW corner



PHOTOGRAPHER: Jim Stone
DATE OF PHOTO: Aug. 17, 2012

ROLL NUMBER: _____
PHOTO NUMBER: 4
CAMERA DIRECTION: Main barn, looking NW, poles and bracing

* = REQUIRED FIELD

**SOUTH DAKOTA STATE HISTORIC PRESERVATION OFFICE
HISTORIC SITES SURVEY STRUCTURE FORM**



PHOTOGRAPHER: Jim Stone
DATE OF PHOTO: Aug. 17, 2012

ROLL NUMBER: _____
PHOTO NUMBER: 5

CAMERA DIRECTION: Main barn, looking SE,
poles, bracing and hip
roof on lean-to's



PHOTOGRAPHER: Jim Stone
DATE OF PHOTO: Aug. 17, 2012

ROLL NUMBER: _____
PHOTO NUMBER: 6

CAMERA DIRECTION: Main barn, looking NE,
East wall and NE corner
of lean-to

SOUTH DAKOTA STATE HISTORIC PRESERVATION OFFICE HISTORIC SITES SURVEY STRUCTURE FORM



T-93-N

MECKLING DIRECTORY

R-53-W

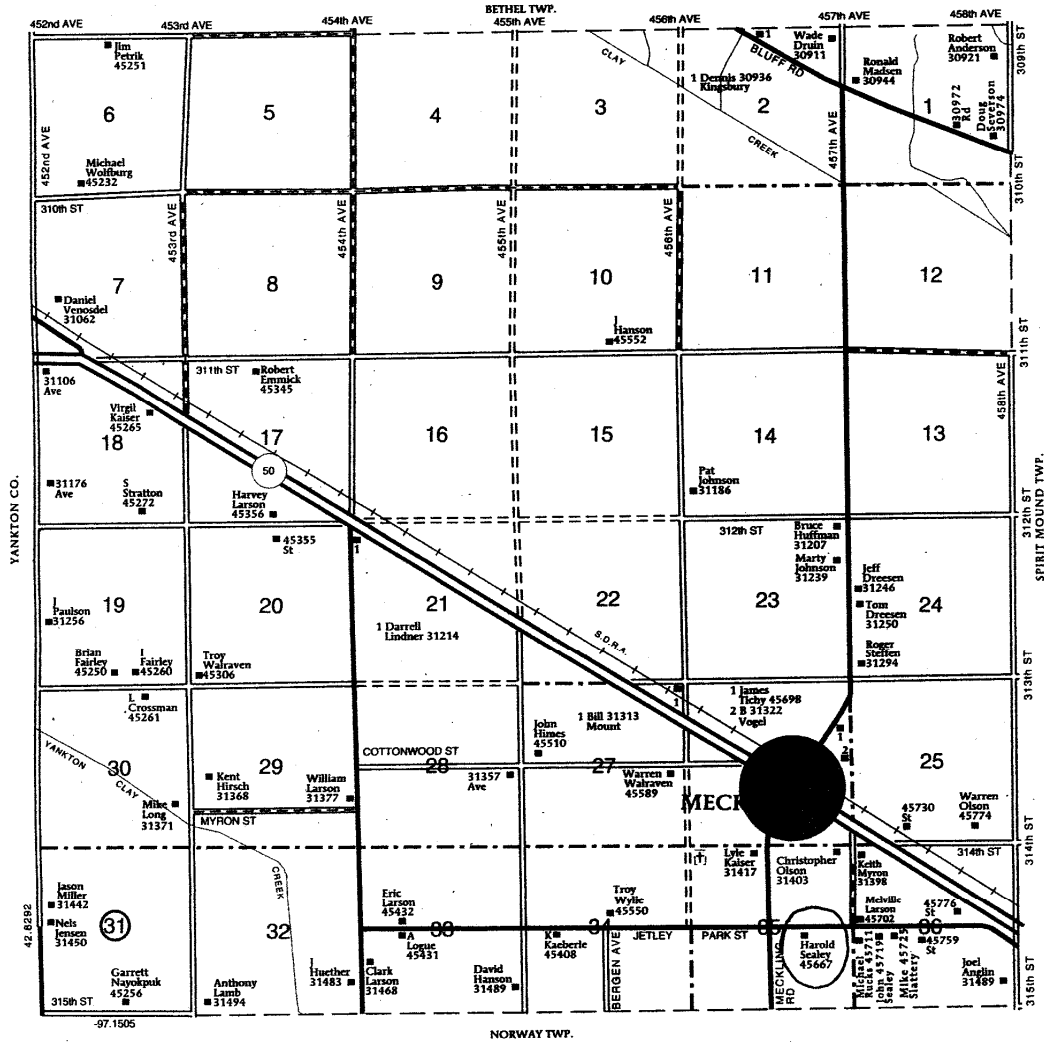

* = REQUIRED FIELD

HISTORY

This farm located in the SE ¼ of Section 35, Meckling Township, Clay County was homesteaded by Fredrick E. Branson.

The 1894 and 1901 Clay County Atlas lists Albert M. Edgerton as the owner.

The 1912 and 1924 Clay County Atlas lists Fred L. Demann as the owner.

The 1937 Clay County Atlas lists Albert M. Edgerton as the owner.

The 1948 and 1956 Clay County Atlas lists Caroline Sealey as the owner.