

**SOUTH DAKOTA STATE HISTORIC PRESERVATION OFFICE
HISTORIC SITES SURVEY STRUCTURE FORM**



SITE INFORMATION

*SURVEY DATE: February 5, 2013 *ADDRESS: 46083 303rd Street
*SURVEYOR: Jim Stone *COUNTY: Clay
*CITY: Centerville

LOCATION DESCRIPTION: From Vermillion, South Dakota Highway 50 bi-pass and South Dakota Highway 19, North 15 miles to 302nd Street, turn left (West) 1 mile to 461st Ave., turn South 1 mile to 303rd street, turn right (West) about ¼ mile, on the left (South) side, vacated place.

LEGAL DESCRIPTION: Lots 1 & 2, NE ¼, 4 – 94 – 52 Pleasant Valley Twp.

*QUARTER 1: NE 1/4
*QUARTER 2: _____
*TOWNSHIP: Pleasant Valley
*RANGE: 52
*SECTION: 4
ACRES: 148.10

OWNER NAME: Loann Kjeldseth & Jane Sommer
OWNER ADDRESS: 45141 300th
OWNER CITY: Irene
OWNER STATE: South Dakota
OWNER ZIP: 570037
QUAD NAME: _____

OWNER CODE 1: P
OWNER CODE 2: _____
OWNER CODE 3: _____

HISTORIC SIGNIFICANCE

*DOE: _____
*DOE DATE: _____
REASON INELIGIBLE: _____

REGISTER NAME: _____
MULTIPLE PROPERTY NAME: _____

NOMINATION STATUS: _____
DATE LISTED: _____
REFERENCE NUMBER: _____
HISTORIC DISTRICT RATING: C or NC
PERIOD: _____

CATEGORY: _____
SIGNIFICANCE LEVEL 1: N S L
SIGNIFICANCE LEVEL 2: N S L
CRITERIA 1: A B C D
CRITERIA 2: A B C D
CRITERIA 3: A B C D
CRITERIA 4: A B C D

SIGNIFICANCE NOTES: _____

STRUCTURE DETAILS

* = REQUIRED FIELD

**SOUTH DAKOTA STATE HISTORIC PRESERVATION OFFICE
HISTORIC SITES SURVEY STRUCTURE FORM**



SHPO ID: _____
 *PROPERTY NAME: _____
 OTHER NAME: _____

CURRENT FUNCTION: Vacant FOUNDATION: Poured concrete
 CURRENT SUBFUNCTION: Storage ROOF MATERIAL: Steel roofing over cedar shingles
 HISTORIC FUNCTION: Livestock barn ROOF SHAPE: Gable
 HISTORIC SUBFUNCTION: Hay and grain storage STRUCTURAL SYSTEM: Post frame
 STYLE: Western Feeder barn
 OCCUPIED: No TYPE: Livestock barn
 ACCESSIBLE: ? WALLS: 4x6 and 6x6 posts, with 2x6 girts 4' O. C. and 12" vertical board siding

STORIES: 1 SIGNIFICANT PERSON: Edward Heller
 *DATE OF CONSTRUCTION: Early 1900's CULTURAL AFFILIATION: ?

ALTERED/MOVED NOTES: Original site. Steel roofing has been applied on the roof.

INTERIOR NOTES: Has two rows of 6x6 posts 20' high on each side of the center 24', with (2) 2x6's for a beam to support the center of the rafters. Three double horse stalls and 7 milk cow stanchions are still in place on the North side. Two 9'x6' granaries are still in place along center of the West wall.
 OTHER NOTES: 4x6 and 6x6 posts with 2x6 girts, 4' O. C. and 1x12 vertical siding on exterior walls. Windows are 10"x12" four light. Rafters are 2x6, 32" O. C. There is a feed bunk and a hay feed rack above it along the North wall in the South area. The center area 24' wide by 50' long and is a hayloft from the ground level to the peak. It is 31' from the ground to the peak.
 *PHYSICAL NOTES: Barn is in fair condition. Needs repairs on doors and windows. Some of the battens are missing on the siding.

*UTM ZONE: _____ *RESTRICTED: Y or N
 *UTM EASTING: _____
 *UTM NORTHING: _____

* = REQUIRED FIELD

**SOUTH DAKOTA STATE HISTORIC PRESERVATION OFFICE
HISTORIC SITES SURVEY STRUCTURE FORM**



SKETCH MAP

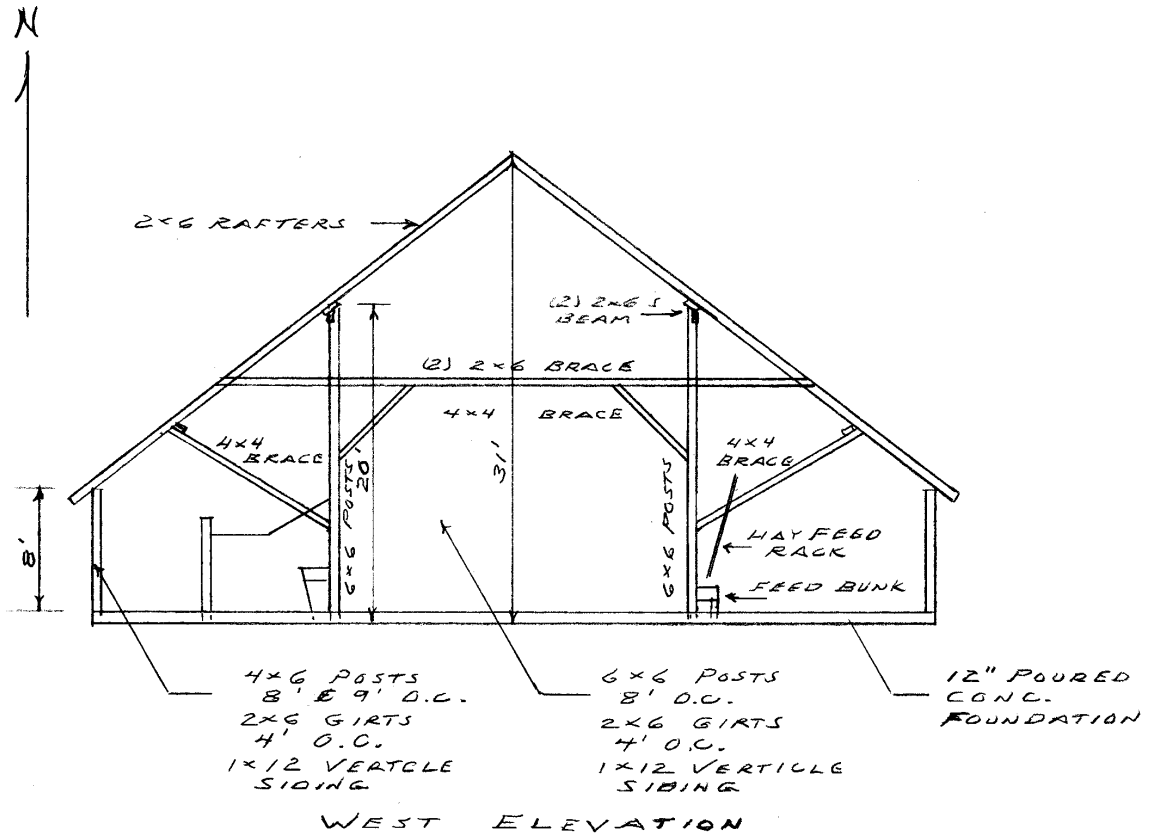

PHOTOGR

* = REQUIRED FIELD

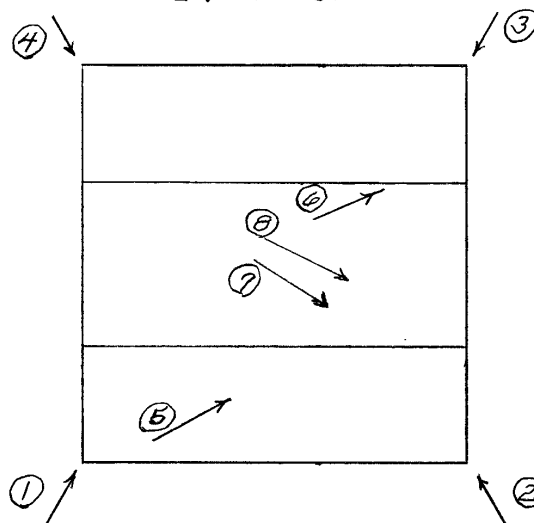

**SOUTH DAKOTA STATE HISTORIC PRESERVATION OFFICE
HISTORIC SITES SURVEY STRUCTURE FORM**



SKETCH MAP

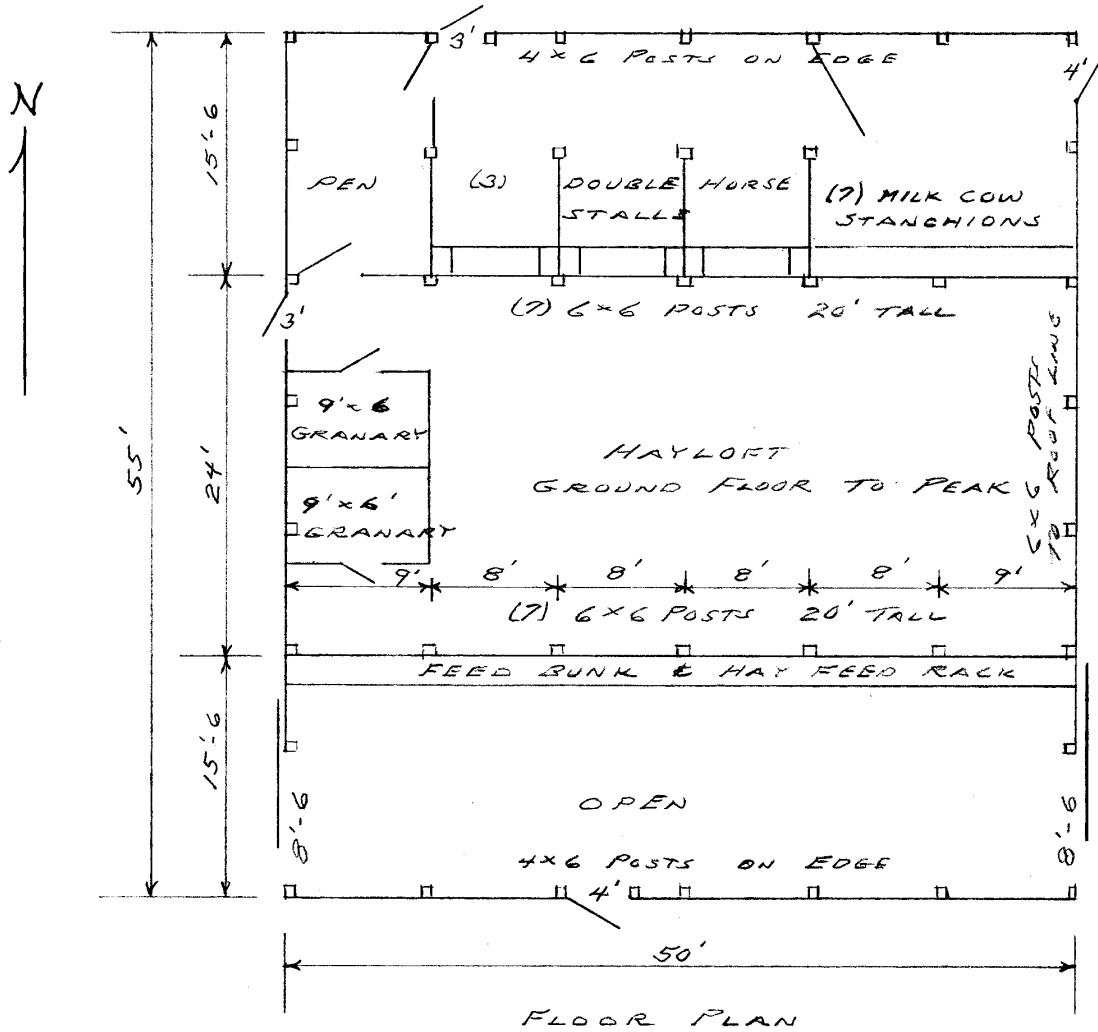

PHOTOGR

* = REQUIRED FIELD

* = REQUIRED FIELD

**SOUTH DAKOTA STATE HISTORIC PRESERVATION OFFICE
HISTORIC SITES SURVEY STRUCTURE FORM**



PHOTOGRAPHER: Jim Stone
DATE OF PHOTO: February 5, 2013

ROLL NUMBER: _____
PHOTO NUMBER: 1
CAMERA DIRECTION: Looking NE, SW corner



PHOTOGRAPHER: Jim Stone
DATE OF PHOTO: February 5, 2013

ROLL NUMBER: _____
PHOTO NUMBER: 2
CAMERA DIRECTION: Looking NW, SE corner

* = REQUIRED FIELD

**SOUTH DAKOTA STATE HISTORIC PRESERVATION OFFICE
HISTORIC SITES SURVEY STRUCTURE FORM**



PHOTOGRAPHER: Jim Stone
DATE OF PHOTO: February 5, 2013

ROLL NUMBER: _____
PHOTO NUMBER: 3
CAMERA DIRECTION: Looking SW, NE corner



PHOTOGRAPHER: Jim Stone
DATE OF PHOTO: February 5, 2013

ROLL NUMBER: _____
PHOTO NUMBER: 4
CAMERA DIRECTION: Looking SE, NW corner

* = REQUIRED FIELD

**SOUTH DAKOTA STATE HISTORIC PRESERVATION OFFICE
HISTORIC SITES SURVEY STRUCTURE FORM**



PHOTOGRAPHER: Jim Stone
DATE OF PHOTO: February 5, 2013

ROLL NUMBER: _____
PHOTO NUMBER: 5

CAMERA DIRECTION: First floor, South side,
looking NE, feed bunk
and hay feed rack above



PHOTOGRAPHER: Jim Stone
DATE OF PHOTO: February 5, 2013

ROLL NUMBER: _____
PHOTO NUMBER: 6

CAMERA DIRECTION: First floor, North side,
looking NE, seven milk
cow stanchions

* = REQUIRED FIELD

**SOUTH DAKOTA STATE HISTORIC PRESERVATION OFFICE
HISTORIC SITES SURVEY STRUCTURE FORM**



PHOTOGRAPHER: Jim Stone
DATE OF PHOTO: February 5, 2013

ROLL NUMBER: _____
PHOTO NUMBER: 7

First floor, center area,
looking SE, hay feed
rack and 6x6 posts 20'
high with bracing

CAMERA DIRECTION: _____



PHOTOGRAPHER: Jim Stone
DATE OF PHOTO: February 5, 2013

ROLL NUMBER: _____
PHOTO NUMBER: 8

First floor, looking SE,
6x6 post 20' high, (2)
2x6's for a beam to
support rafters and
bracing

CAMERA DIRECTION: _____

* = REQUIRED FIELD

**SOUTH DAKOTA STATE HISTORIC PRESERVATION OFFICE
HISTORIC SITES SURVEY STRUCTURE FORM**

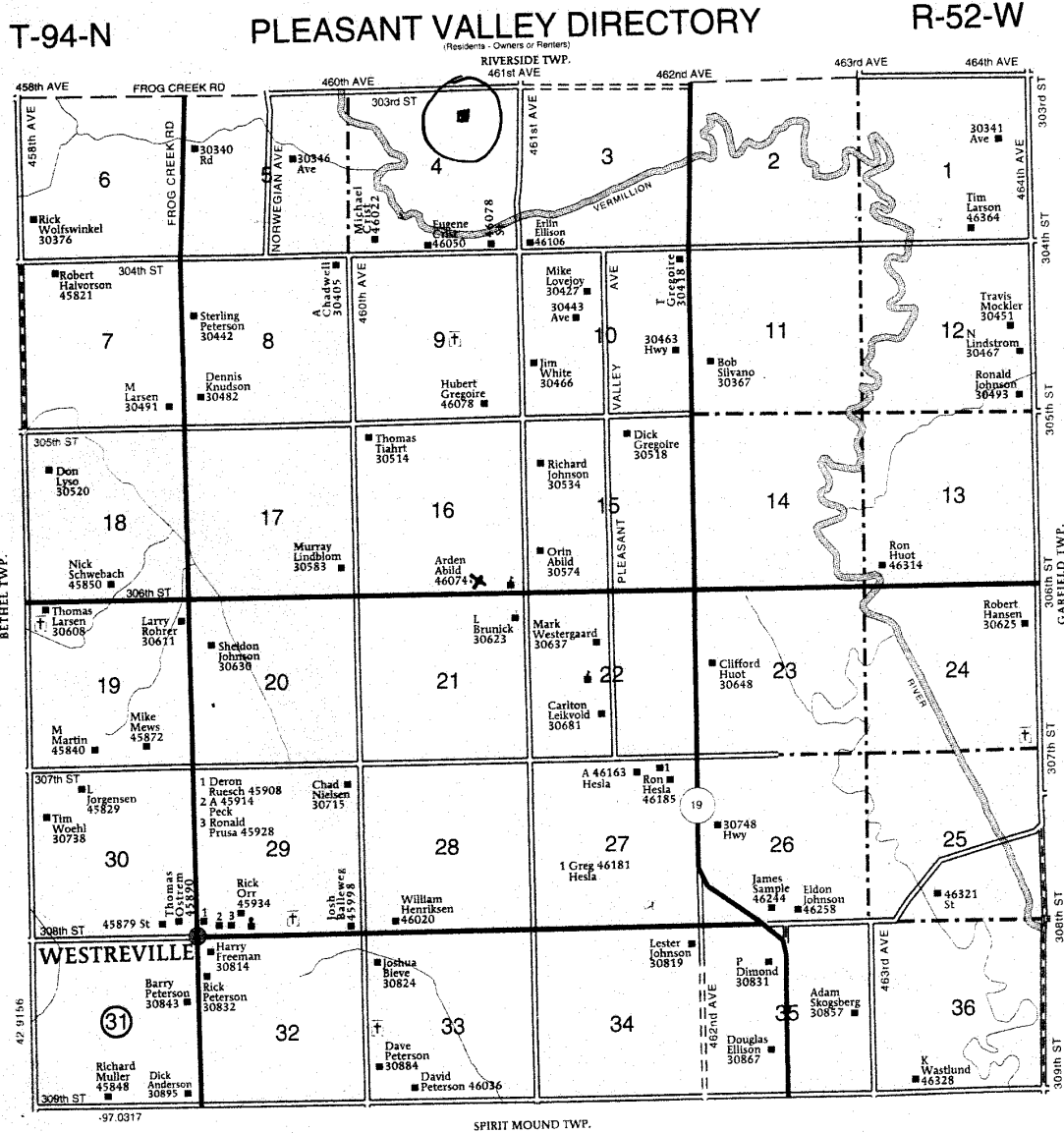

HISTORY

This farm located in the NE ¼ of Section 4, Pleasant Valley Township, Clay County was homesteaded by Lennder Pierce.

1894,1901 and 1912 Clay County Atlas lists George Wright as the owner.

1924 and 1937 Clay County Atlas lists Edward Heller as the owner.

The 1948 and 1956 Clay County Atlas lists L. A. Heller as the owner.

The following information is from

Wakonda, South Dakota Centennial book 1885 - 1985

Edward Heller and his wife Flora (Smith) and two children, Alva and Pearl, came to South Dakota in 1902 from Geneseo, Illinois. They settled on their farm six miles East and one mile South of Wakonda. Their daughter Ruby was born here. In 1910 they moved to LeMars, Iowa where Lewis was born, but they returned to their South Dakota farm the next year. Their youngest child Doris, was born in 1916. They continued farming until they retired in 1939 and moved to Centerville. Edward died in 1944 and Flora in 1965.

Lewis Heller and Alice Bixler were married August 18, 1933. They are both graduates of Centerville High School. They lived on the same East Heller farm since 1939. They experienced many floods. In 1983 there were five floods from February 28 to July 7.

They have two daughters, Jane and Loann. Jane married Gary Sommer. Gary Sommer died in 1984. Loann married George Kjeldseth in 1968.