

**SOUTH DAKOTA STATE HISTORIC PRESERVATION OFFICE
HISTORIC SITES SURVEY STRUCTURE FORM**



SITE INFORMATION

*SURVEY DATE: May 31, 2012 *ADDRESS: 45622 299th Street
*SURVEYOR: Jim Stone *COUNTY: Clay
*CITY: Wakonda

LOCATION DESCRIPTION: From the intersection of South Dakota Highway 50 bi-pass and South Dakota Highway 19, 18 miles to 299th Street, turn left (West), 5-3/4 miles, on the right (North) side

LEGAL DESCRIPTION: S 1/2 SW 1/4 11 - 95 - 53 Star Twp

*QUARTER 1: SW 1/4
*QUARTER 2: _____
*TOWNSHIP: Star
*RANGE: 53
*SECTION: 11
ACRES: 74.73

OWNER NAME: Dale Nelson
OWNER ADDRESS: 45622 299th Street
OWNER CITY: Wakonda
OWNER STATE: South Dakota
OWNER ZIP: 57073
QUAD NAME: _____

OWNER CODE 1: P
OWNER CODE 2: F S L P
OWNER CODE 3: F S L P

HISTORIC SIGNIFICANCE

*DOE: _____
*DOE DATE: _____
REASON INELIGIBLE: _____

REGISTER NAME: _____
MULTIPLE PROPERTY NAME: _____

NOMINATION STATUS: _____
DATE LISTED: _____
REFERENCE NUMBER: _____
HISTORIC DISTRICT RATING: C or NC
PERIOD: _____

CATEGORY: _____
SIGNIFICANCE LEVEL 1: N S L
SIGNIFICANCE LEVEL 2: N S L
CRITERIA 1: A B C D
CRITERIA 2: A B C D
CRITERIA 3: A B C D
CRITERIA 4: A B C D

SIGNIFICANCE NOTES: _____

* = REQUIRED FIELD

**SOUTH DAKOTA STATE HISTORIC PRESERVATION OFFICE
HISTORIC SITES SURVEY STRUCTURE FORM**



STRUCTURE DETAILS

SHPO ID: _____
 *PROPERTY NAME: _____
 OTHER NAME: _____

CURRENT FUNCTION:	<u>Shop</u>	FOUNDATION:	<u>Poured concrete Steel over cedar</u>
CURRENT SUBFUNCTION:	<u>Tractor storage</u>	ROOF MATERIAL:	<u>shingles</u>
HISTORIC FUNCTION:	<u>Livestock barn</u>	ROOF SHAPE:	<u>Gambrel</u>
HISTORIC SUBFUNCTION:	<u>Hay storage</u>	STRUCTURAL SYSTEM:	<u>Balloon framing</u>
		STYLE:	<u>Gambrel roof barn</u>
OCCUPIED:	<u>Yes</u>	TYPE:	<u>Livestock barn</u>
	<u>Yes with</u>		<u>2x6 with 1x6 #106</u>
ACCESSIBLE:	<u>permission</u>	WALLS:	<u>drop siding</u>

STORIES: 2 SIGNIFICANT PERSON: Leonard Holm
 *DATE OF CONSTRUCTION: Early 1920's CULTURAL AFFILIATION: ?

ALTERED/MOVED NOTES: Original site. Horse stalls, milk cow stanchions and calf pens have been removed. Hayloft floor raised to 12'-6" and covered with steel roofing for a ceiling. Walls and roof are covered with steel roofing. Metal cupola removed. Windows and door are covered with steel roofing. 16' x 12' insulated steel door installed in the North wall for access to shop.

INTERIOR NOTES: Everything has been removed. Owner said that there were two rows of 4x6 posts and 4x6 beams. 2x10 floor joists for hayloft floor. Owner showed where horse stalls, milk cow stanchions and calf pens were. He also said that the calf pens were replaced with two granaries.

OTHER NOTES: East and West walls are 2x6 studs 12'-6" high. North and South walls are 2x6 walls ballooned framed. No sheathing, 1x6 pattern #106 drop siding directly applied to the stud walls. 9"x12" four light windows. With ceiling sealed, I could not get into hayloft. Owner said that there were no posts in hayloft to support the hip, that there was rafter bracing. He did not remember how it looked.

***PHYSICAL NOTES:** Barn is in good condition. The owner planned the conversion very well and now the barn is very useful in the farming operation.

* = REQUIRED FIELD

**SOUTH DAKOTA STATE HISTORIC PRESERVATION OFFICE
HISTORIC SITES SURVEY STRUCTURE FORM**

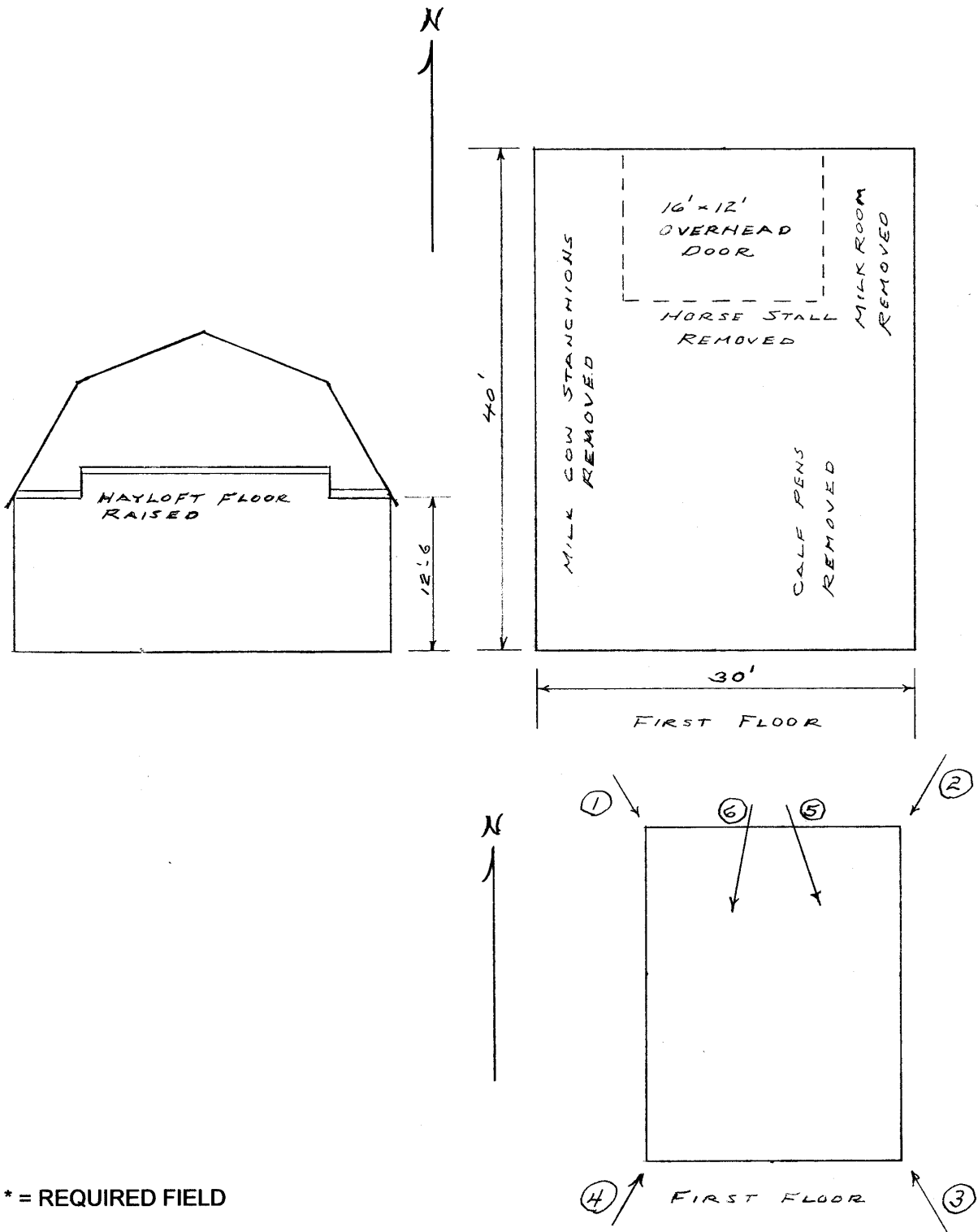

* = REQUIRED FIELD

* = REQUIRED FIELD

**SOUTH DAKOTA STATE HISTORIC PRESERVATION OFFICE
HISTORIC SITES SURVEY STRUCTURE FORM**



PHOTOGRAPHER: Jim Stone
DATE OF PHOTO: May 31, 2012

ROLL NUMBER: _____
PHOTO NUMBER: 1
CAMERA DIRECTION: Looking SE, NW corner



PHOTOGRAPHER: Jim Stone
DATE OF PHOTO: May 31, 2012

ROLL NUMBER: _____
PHOTO NUMBER: 2
CAMERA DIRECTION: Looking SW, NE corner

* = REQUIRED FIELD

**SOUTH DAKOTA STATE HISTORIC PRESERVATION OFFICE
HISTORIC SITES SURVEY STRUCTURE FORM**



PHOTOGRAPHER: Jim Stone
DATE OF PHOTO: May 31, 2012

ROLL NUMBER: _____
PHOTO NUMBER: 3
CAMERA DIRECTION: Looking NW, SE corner



PHOTOGRAPHER: Jim Stone
DATE OF PHOTO: May 31, 2012

ROLL NUMBER: _____
PHOTO NUMBER: 4
CAMERA DIRECTION: Looking NE, SW corner

* = REQUIRED FIELD

**SOUTH DAKOTA STATE HISTORIC PRESERVATION OFFICE
HISTORIC SITES SURVEY STRUCTURE FORM**



PHOTOGRAPHER: Jim Stone
DATE OF PHOTO: May 31, 2012

ROLL NUMBER: _____
PHOTO NUMBER: 5

CAMERA DIRECTION: Looking SE into shop area



PHOTOGRAPHER: Jim Stone
DATE OF PHOTO: May 31, 2012

ROLL NUMBER: _____
PHOTO NUMBER: 6

CAMERA DIRECTION: Looking SW into shop area

* = REQUIRED FIELD

SOUTH DAKOTA STATE HISTORIC PRESERVATION OFFICE HISTORIC SITES SURVEY STRUCTURE FORM



T-95-N

STAR PLAT

R-53-W

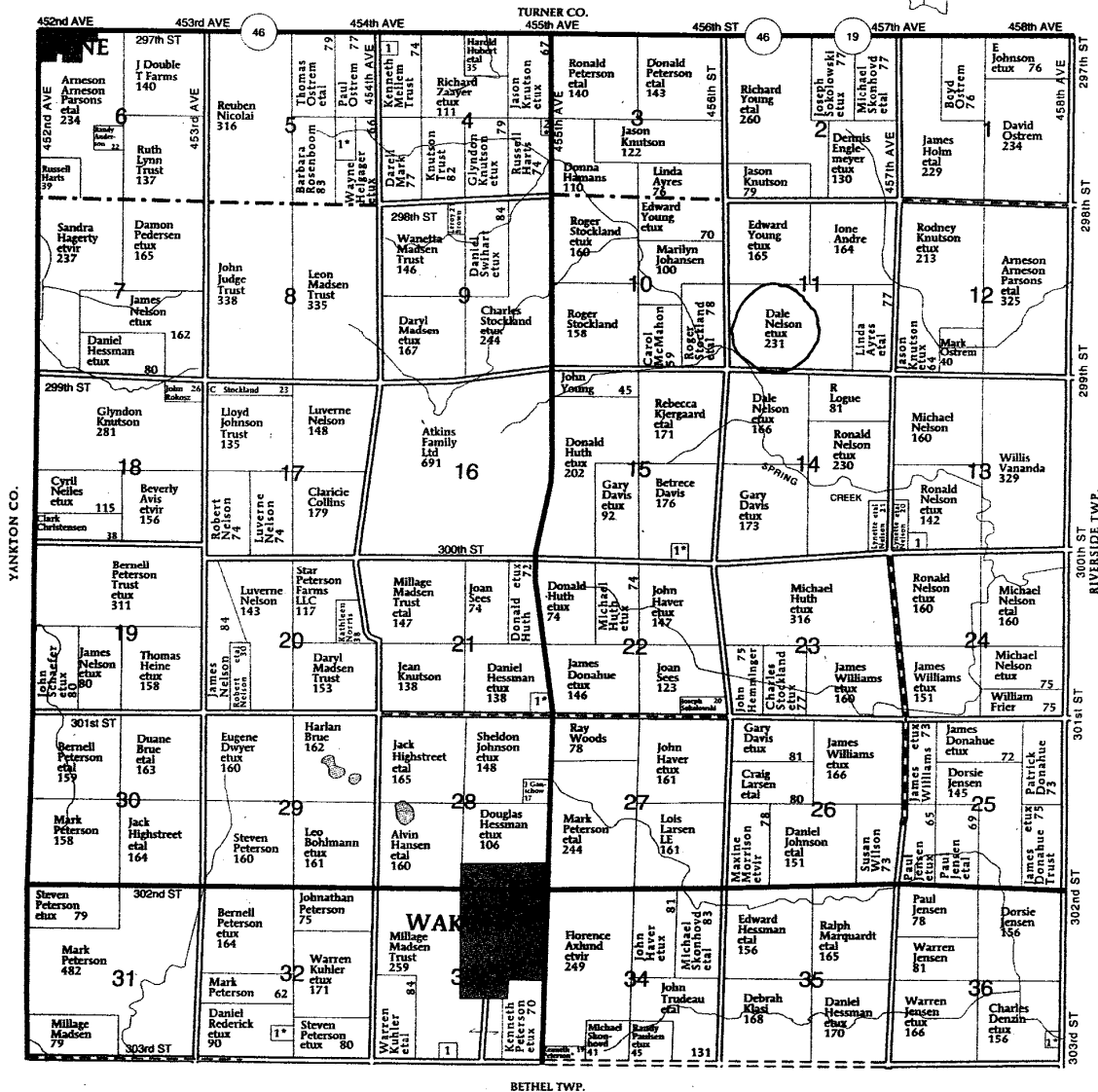

STAR TOWNSHIP

SECTION 4

- 1. Wagner, Daniel 10
- 2. Cox, Russell 5

SECTION 5

- 1. Sherman, Kimberly 15

SECTION 13

- 1. Nelson, Heath 5

SECTION 15

- 1. Davis, Gary 6

SECTION 21

- 1. Hessman, Douglas 11

SECTION 32

- 1. Sauer, Andrew 14

SECTION 33

- 1. Madsen, Martin 5

SECTION 36

- 1. Wilking, Dillon 7

HISTORY

This farm, located in the S ½ of the SW ¼, Section 11, Star Township, Clay County was homesteaded by John O'Brien.

The 1894 and 1901 Clay County Atlas lists E. B. Kvernevig as the owner.

The 1912 Clay County Atlas lists A. E. Lee as the owner.

The 1924 and 1937 Clay County Atlas lists Wiggo Holm as the owner.

The 1948 and 1956 Clay County Atlas lists Ertel Nelson as the owner.