

**SOUTH DAKOTA STATE HISTORIC PRESERVATION OFFICE
HISTORIC SITES SURVEY STRUCTURE FORM**



SITE INFORMATION

*SURVEY DATE: March 7, 2013 *ADDRESS: 46975 309th Street
*SURVEYOR: Jim Stone *COUNTY: Clay
*CITY: Beresford

LOCATION DESCRIPTION: From Vermillion, South Dakota Highway 50 East 2 miles to Greenfield Road, Turn left (North) 7-1/2 miles to 311th Street, turn right (East) to 469th Ave, turn left (North) 1 mile to 310th Street, out in field looking SW, vacated place, no lane

LEGAL DESCRIPTION: NE 1/4, 11 - 93 - 51 Prairie Center Twp.

*QUARTER 1: NE 1/4
*QUARTER 2: _____
*TOWNSHIP: Prairie Center
*RANGE: 51
*SECTION: 11
ACRES: 162.8

OWNER NAME: Lavaune Wetmore
OWNER ADDRESS: 627 Thomas
OWNER CITY: Vermillion
OWNER STATE: South Dakota
OWNER ZIP: 57069
QUAD NAME: _____

OWNER CODE 1: P
OWNER CODE 2: _____
OWNER CODE 3: _____

HISTORIC SIGNIFICANCE

*DOE: _____
*DOE DATE: _____
REASON INELIGIBLE: _____

REGISTER NAME: _____
MULTIPLE PROPERTY NAME: _____

NOMINATION STATUS: _____
DATE LISTED: _____
REFERENCE NUMBER: _____
HISTORIC DISTRICT RATING: C or NC
PERIOD: _____

CATEGORY: _____
SIGNIFICANCE LEVEL 1: N S L
SIGNIFICANCE LEVEL 2: N S L

CRITERIA 1: A B C D
CRITERIA 2: A B C D
CRITERIA 3: A B C D
CRITERIA 4: A B C D

SIGNIFICANCE NOTES: _____

STRUCTURE DETAILS

* = REQUIRED FIELD

**SOUTH DAKOTA STATE HISTORIC PRESERVATION OFFICE
HISTORIC SITES SURVEY STRUCTURE FORM**



SHPO ID: _____
 *PROPERTY NAME: _____
 OTHER NAME: _____

CURRENT FUNCTION: Vacant FOUNDATION: Poured concrete
 CURRENT SUBFUNCTION: Vacant ROOF MATERIAL: Steel roofing
 HISTORIC FUNCTION: Elevator / corncrib ROOF SHAPE: Gable
 HISTORIC SUBFUNCTION: Grain storage STRUCTURAL SYSTEM: Balloon framing
 OCCUPIED: Yes STYLE: Elevator / corn crib
 TYPE: Elevator / corncrib
 ACCESSIBLE: Yes with permission WALLS: 2x6 studs, 1x6 beveled crib boards

STORIES: 3 SIGNIFICANT PERSON: Christian Borup
 *DATE OF CONSTRUCTION: 1920's CULTURAL AFFILIATION: ?

ALTERED/MOVED NOTES: Original site. Cedar shingles removed and 1-1/4" x 26" corrugated, galvanized steel roofing installed on roof.

INTERIOR NOTES: Has grain pit in floor of driveway and a hoist to tilt wagons for unloading. Has a grain leg to elevate ear corn up and into side corncribs or grain into four grain bins above driveway. Two interior walls are double 2x6's, 24" O. C., 21 feet high with 1x6 boards. Double 3x12's support the granaries above the driveway. 8" foundations, three on each side support the 2x10 floor joists for floor in the corncribs. A (3) HP, single phase, Westinghouse electric motor was the power to run elevator. It was connected to an automotive transmission to set speed or power running elevator.

OTHER NOTES: 2x6 stud walls, 13' - 6" high, 24" O. C. on the exterior walls with 1x6 bevel crib boards. Gable ends are 2x6 studs with 1x6 bevel crib boards on corncribs and 1x6 # 106 drop siding on the gable ends. Dormer has 2x4 studs, sheathing and 1/2"x6" cedar lap siding. Rafters are 2x6 with sheathing and steel roofing. Windows are 8"x10" four light. (3) 1x12 braces run East to West up about half way on each stud, 24" O. C. to hold the side walls from the pressure of the ear corn pushing out as it settled.

*PHYSICAL NOTES: Corncrib is in fair condition. Some to the roofing has blown off. Chain on grain leg is broken.

*UTM ZONE: _____ *RESTRICTED: Y or N
 *UTM EASTING: _____
 *UTM NORTHING: _____

* = REQUIRED FIELD

**SOUTH DAKOTA STATE HISTORIC PRESERVATION OFFICE
HISTORIC SITES SURVEY STRUCTURE FORM**

SKETCH MAP

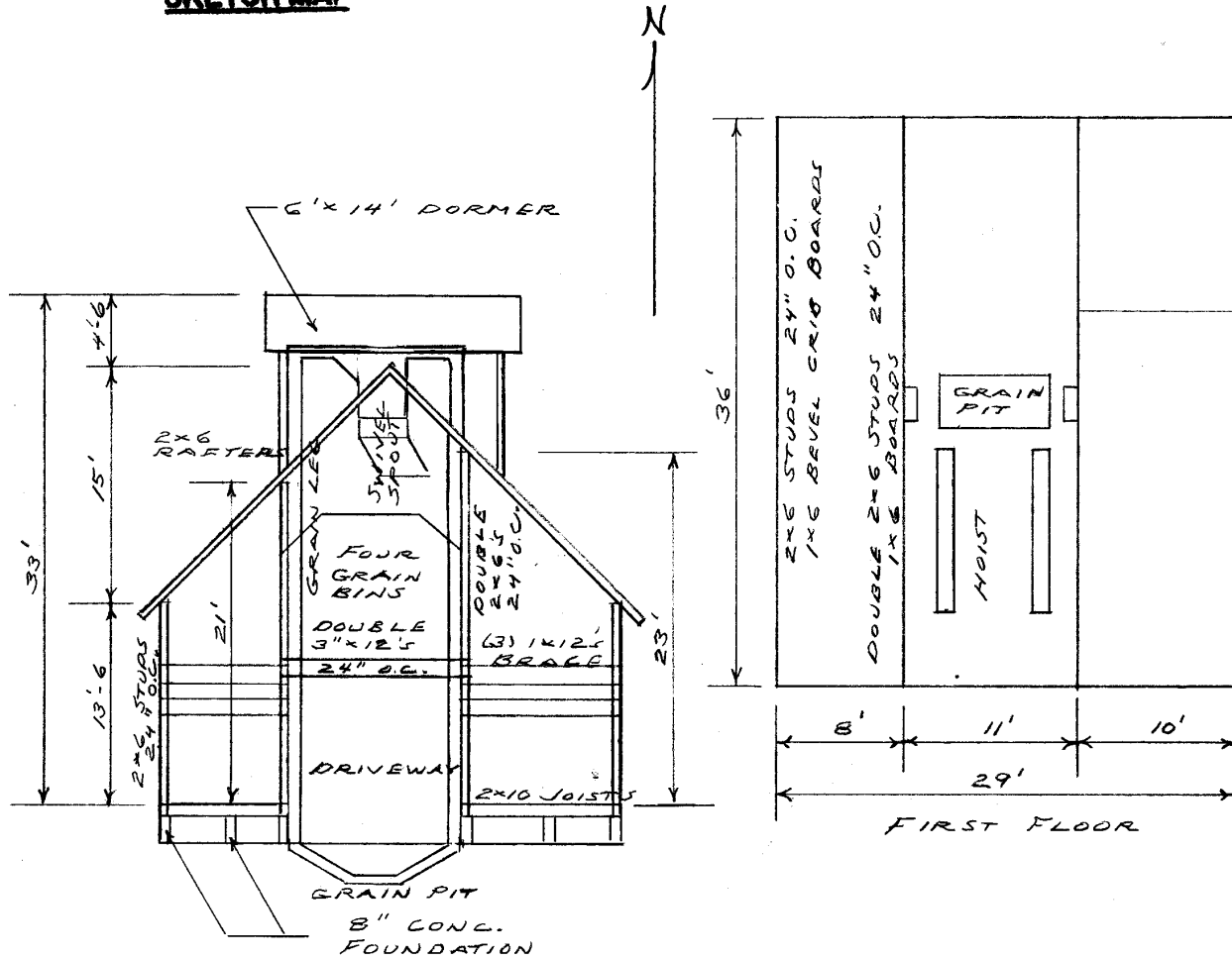

PHOTOGR

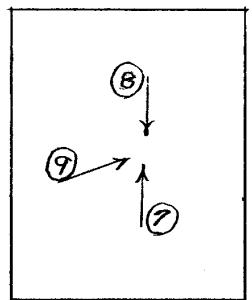

THIRD FLOOR

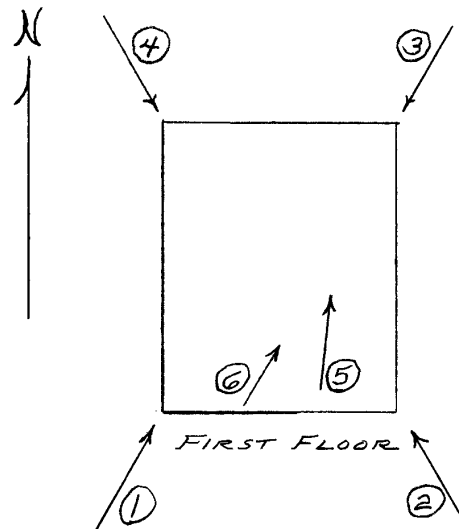

FIRST FLOOR

* = REQUIRED FIELD

**SOUTH DAKOTA STATE HISTORIC PRESERVATION OFFICE
HISTORIC SITES SURVEY STRUCTURE FORM**



PHOTOGRAPHER: Jim Stone
DATE OF PHOTO: March 7, 2013

ROLL NUMBER: _____
PHOTO NUMBER: 1
CAMERA DIRECTION: Looking NE, SW corner



PHOTOGRAPHER: Jim Stone
DATE OF PHOTO: March 7, 2013

ROLL NUMBER: _____
PHOTO NUMBER: 2
CAMERA DIRECTION: Looking NW, SE corner

* = REQUIRED FIELD

**SOUTH DAKOTA STATE HISTORIC PRESERVATION OFFICE
HISTORIC SITES SURVEY STRUCTURE FORM**



PHOTOGRAPHER: Jim Stone
DATE OF PHOTO: March 7, 2013

ROLL NUMBER: _____
PHOTO NUMBER: 3
CAMERA DIRECTION: Looking SW, NE corner



PHOTOGRAPHER: Jim Stone
DATE OF PHOTO: March 7, 2013

ROLL NUMBER: _____
PHOTO NUMBER: 4
CAMERA DIRECTION: Looking SE, NW corner

**SOUTH DAKOTA STATE HISTORIC PRESERVATION OFFICE
HISTORIC SITES SURVEY STRUCTURE FORM**



PHOTOGRAPHER: Jim Stone
DATE OF PHOTO: March 7, 2013

ROLL NUMBER: _____
PHOTO NUMBER: 5

CAMERA DIRECTION: First floor, looking NE in driveway, electric motor and transmission, grain leg and hoist.



PHOTOGRAPHER: Jim Stone
DATE OF PHOTO: March 7, 2013

ROLL NUMBER: _____
PHOTO NUMBER: 6

CAMERA DIRECTION: First floor, looking NE in driveway, hoist to tilt wagons for unloading, note double 3x12's above.

* = REQUIRED FIELD

**SOUTH DAKOTA STATE HISTORIC PRESERVATION OFFICE
HISTORIC SITES SURVEY STRUCTURE FORM**



PHOTOGRAPHER: Jim Stone
DATE OF PHOTO: March 7, 2013

ROLL NUMBER: 7
PHOTO NUMBER: 7

Third floor, looking NE,
top of grain leg and
spout to direct flow of
grain

CAMERA DIRECTION: grain



PHOTOGRAPHER: Jim Stone
DATE OF PHOTO: March 7, 2013

ROLL NUMBER: 8
PHOTO NUMBER: 8

Third floor, looking
South, top of grain leg
and spout, note
manufacture and
patents.

CAMERA DIRECTION: patents.

* = REQUIRED FIELD

**SOUTH DAKOTA STATE HISTORIC PRESERVATION OFFICE
HISTORIC SITES SURVEY STRUCTURE FORM**



PHOTOGRAPHER: Jim Stone
DATE OF PHOTO: March 7, 2013

ROLL NUMBER: _____
PHOTO NUMBER: 9

CAMERA DIRECTION: Third floor, looking East, top of grain leg on down side, cups are 16" long, 8" deep and 6" wide.

**SOUTH DAKOTA STATE HISTORIC PRESERVATION OFFICE
HISTORIC SITES SURVEY STRUCTURE FORM**

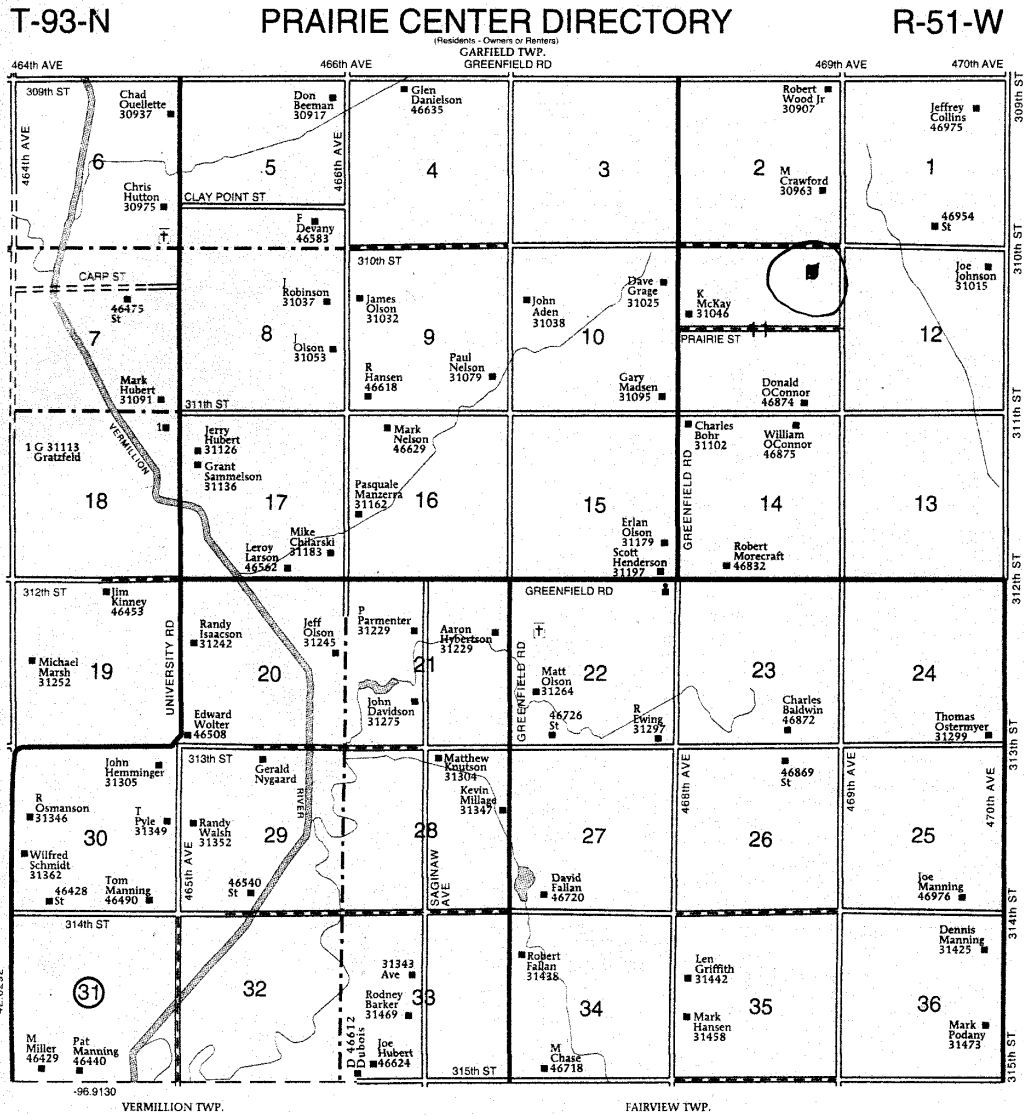

HISTORY

This farm located in the NE ¼ of Section 11 Prairie Center Township, Clay County was homesteaded by John Benson.

The 1894 Clay county Atlas lists John Benson as the owner.

The 1901 Clay County Atlas lists Andrew Benson as the owner.

The 1912, 1924, and 1937 Clay County Atlas lists Christian Borup as the owner.

The 1948 Clay county Atlas lists Christine Borup as the owner.

The 1956 Clay County Atlas lists Thomas Host as the owner.

Construction Notes

The grain bins above the driveway have a floor over the top the length of the corncrib (North to South). This floor has doors that can be opened to fill the four bins from the elevator. Note on the drawing the bevel on this floor on the East and West sides. This made it easier to fill the corncribs on each side without letting ear corn being spilled into the granaries. It also allowed filling the corncribs to the rafters.

This corn crib would hold 2050 bushels of ear corn on the West side and 2450 bushels of ear corn on the East side for a total of 4500 bushels. The grain bins above the drive would hold 2100 bushels of grain or shelled corn.