

**SOUTH DAKOTA STATE HISTORIC PRESERVATION OFFICE  
HISTORIC SITES SURVEY STRUCTURE FORM**



**SITE INFORMATION**

\*SURVEY DATE: February 25, 2013 \*ADDRESS: 45529 Cottonwood Street  
\*SURVEYOR: Jim Stone \*COUNTY: Clay  
\*CITY: Meckling

LOCATION DESCRIPTION: From Vermillion, South Dakota Highway 50 West to Meckling, just West of Meckling to Cottonwood Street, turn left (West), 1-1/2 miles, on left (South) side, vacant place.

LEGAL DESCRIPTION: SW 1/4, 27- 93 - 53 Meckling Twp.

\*QUARTER 1: SW 1/4 OWNER NAME: Vivian M. Mecca, Trustee, Mecca Family Trust  
\*QUARTER 2: \_\_\_\_\_ OWNER ADDRESS: 19011 Wyandotte  
\*TOWNSHIP: Meckling OWNER CITY: Reseda  
\*RANGE: 53 OWNER STATE: California  
\*SECTION: 27 OWNER ZIP: 91335  
ACRES: 163.39 QUAD NAME: \_\_\_\_\_  
OWNER CODE 1: P  
OWNER CODE 2:  
OWNER CODE 3:

**HISTORIC SIGNIFICANCE**

\*DOE: \_\_\_\_\_ REGISTER NAME: \_\_\_\_\_  
\*DOE DATE: \_\_\_\_\_ MULTIPLE PROPERTY NAME: \_\_\_\_\_  
REASON INELIGIBLE: \_\_\_\_\_

NOMINATION STATUS: \_\_\_\_\_ CATEGORY: \_\_\_\_\_  
DATE LISTED: \_\_\_\_\_ SIGNIFICANCE LEVEL 1: N S L  
REFERENCE NUMBER: \_\_\_\_\_ SIGNIFICANCE LEVEL 2: N S L  
HISTORIC DISTRICT RATING: C or NC CRITERIA 1: A B C D  
PERIOD: \_\_\_\_\_ CRITERIA 2: A B C D  
CRITERIA 3: A B C D  
CRITERIA 4: A B C D

SIGNIFICANCE NOTES: \_\_\_\_\_  
\_\_\_\_\_  
\_\_\_\_\_

**STRUCTURE DETAILS**

\* = REQUIRED FIELD

**SOUTH DAKOTA STATE HISTORIC PRESERVATION OFFICE  
HISTORIC SITES SURVEY STRUCTURE FORM**



SHPO ID: \_\_\_\_\_  
 \*PROPERTY NAME: \_\_\_\_\_  
 OTHER NAME: \_\_\_\_\_

CURRENT FUNCTION:	<u>Vacant</u>	FOUNDATION:	<u>Poured concrete</u>
CURRENT SUBFUNCTION:	<u>Storage</u>	ROOF MATERIAL:	<u>Cedar shingles</u>
	<u>Ear corn and grain</u>		
HISTORIC FUNCTION:	<u>elevator</u>	ROOF SHAPE:	<u>Gable</u>
	<u>Ear corn &amp; grain</u>		
HISTORIC SUBFUNCTION:	<u>storage</u>	STRUCTURAL SYSTEM:	<u>Balloon framing</u>
		STYLE:	<u>Gable roof barn</u>
OCCUPIED:	<u>Yes</u>	TYPE:	<u>Corn crib elevator</u>
			<u>2x6 studs, 1x6</u>
			<u>corn crib boards</u>
			<u>and 1x6 # 106 drop</u>
			<u>siding</u>
ACCESSIBLE:	<u>Yes with permission</u>	WALLS:	

STORIES: 3 SIGNIFICANT PERSON: Charles Walraven  
 \*DATE OF CONSTRUCTION: About 1920 CULTURAL AFFILIATION: Dutch

ALTERED/MOVED NOTES: Original site.  
 \_\_\_\_\_  
 \_\_\_\_\_  
 \_\_\_\_\_

INTERIOR NOTES: Has full 2"x 12" floor joists for floor above driveway to support grain bins above. These bins will hold 2750 bushels of grain. Has a grain leg with a Morton Elevator system that can handle ear corn and or grain. Grain leg at top swivels to fill any area of corn cribs or any of the five grain bins above the driveway. Has a hoist in driveway to dump wagons into grain pit. Corncrib holds 2500 bushels of ear corn on each side or 5000 bushels total. All of the 2x6 studs, 2x6 rafters, 2x12 floor joists and 1x12 bracing is rough sawn cottonwood.

OTHER NOTES: 2x6 stud walls with 1x6 corn crib boards on exterior walls and 1x6 boards at a diagonal on the two interior walls in the driveway. The rafters are 2x6's. Three 1x12 boards brace two long walls inside cribs about 8' high and 8' O. C. Another 1x12 brace is above at top of walls. Windows are 8"x10" four light. 12' x 14' dormer covers the top of the grain leg.

\*PHYSICAL NOTES: Corncrib is in good condition. Needs some siding repair, some window glass replaced and some of the doors repaired.

\*UTM ZONE: \_\_\_\_\_ \*RESTRICTED: Y or N  
 \*UTM EASTING: \_\_\_\_\_  
 \*UTM NORTHING: \_\_\_\_\_

\* = REQUIRED FIELD

**SOUTH DAKOTA STATE HISTORIC PRESERVATION OFFICE  
HISTORIC SITES SURVEY STRUCTURE FORM**

**SKETCH MAP**

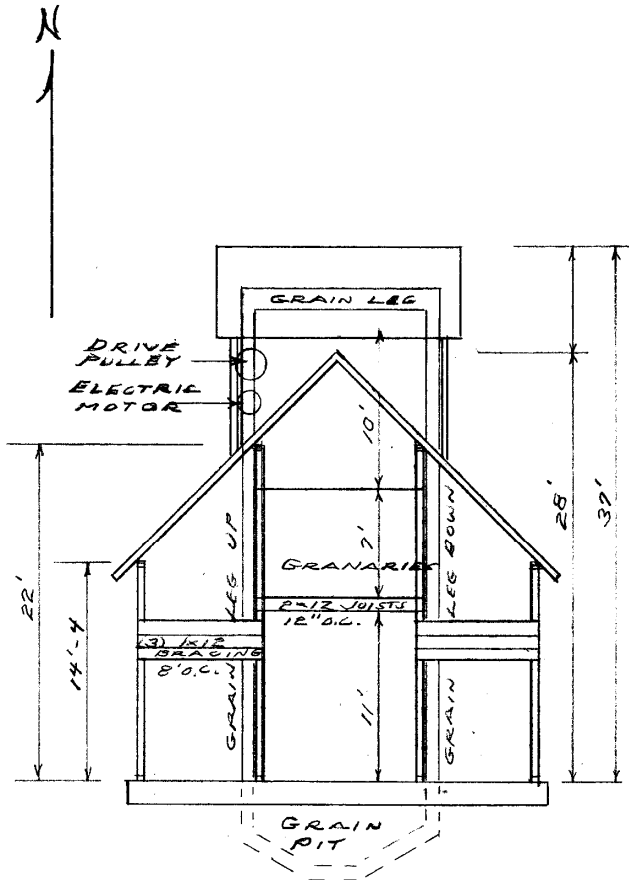

**SOUTH ELEVATION**

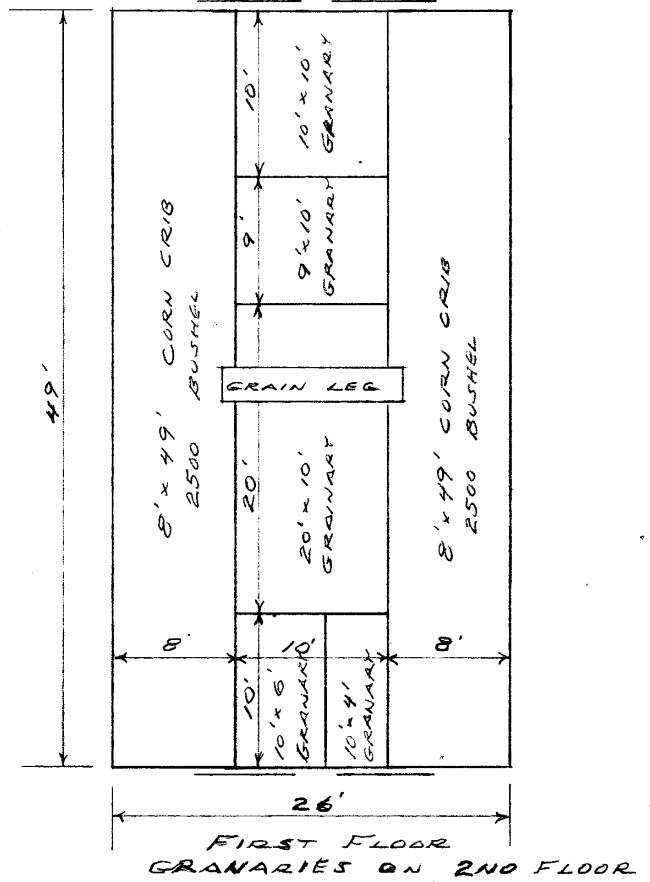

**PHOTOGR**

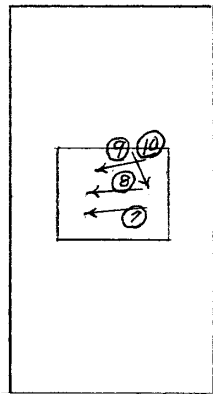

**THIRD FLOOR**

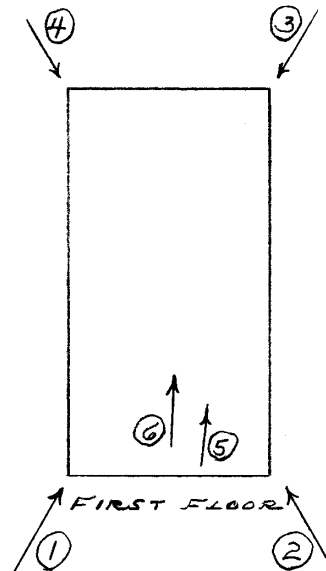

**FIRST FLOOR**

\* = REQUIRED FIELD

**SOUTH DAKOTA STATE HISTORIC PRESERVATION OFFICE  
HISTORIC SITES SURVEY STRUCTURE FORM**



**PHOTOGRAPHER:** Jim Stone  
**DATE OF PHOTO:** February 25, 2013

**ROLL NUMBER:** \_\_\_\_\_  
**PHOTO NUMBER:** 1  
**CAMERA DIRECTION:** Looking NE, SW corner



**PHOTOGRAPHER:** Jim Stone  
**DATE OF PHOTO:** February 25, 2013

**ROLL NUMBER:** \_\_\_\_\_  
**PHOTO NUMBER:** 2  
**CAMERA DIRECTION:** Looking NW, SE corner

\* = REQUIRED FIELD

**SOUTH DAKOTA STATE HISTORIC PRESERVATION OFFICE  
HISTORIC SITES SURVEY STRUCTURE FORM**



**PHOTOGRAPHER:** Jim Stone  
**DATE OF PHOTO:** February 25, 2013

**ROLL NUMBER:** \_\_\_\_\_  
**PHOTO NUMBER:** 3  
**CAMERA DIRECTION:** Looking SW, NE corner



**PHOTOGRAPHER:** Jim Stone  
**DATE OF PHOTO:** February 25, 2013

**ROLL NUMBER:** \_\_\_\_\_  
**PHOTO NUMBER:** 4  
**CAMERA DIRECTION:** Looking SE, NW corner

\* = REQUIRED FIELD

**SOUTH DAKOTA STATE HISTORIC PRESERVATION OFFICE  
HISTORIC SITES SURVEY STRUCTURE FORM**



**PHOTOGRAPHER:** Jim Stone  
**DATE OF PHOTO:** February 25, 2013

**ROLL NUMBER:** 5  
**PHOTO NUMBER:** 5

**CAMERA DIRECTION:** First floor, looking North,  
diagonal 1x6 on inside  
corncrib walls



**PHOTOGRAPHER:** Jim Stone  
**DATE OF PHOTO:** February 25, 2013

**ROLL NUMBER:** 6  
**PHOTO NUMBER:** 6

**CAMERA DIRECTION:** First floor, looking North,  
2x12 floor joists 12" O.C.  
supporting grains bins  
above, note slide chute  
unload grain into wagon.

**SOUTH DAKOTA STATE HISTORIC PRESERVATION OFFICE  
HISTORIC SITES SURVEY STRUCTURE FORM**



**PHOTOGRAPHER:** Jim Stone  
**DATE OF PHOTO:** February 25, 2013

**ROLL NUMBER:** \_\_\_\_\_  
**PHOTO NUMBER:** 7

**CAMERA DIRECTION:** Third floor, looking West,  
Electric motor that  
powers grain leg.



**PHOTOGRAPHER:** Jim Stone  
**DATE OF PHOTO:** February 25, 2013

**ROLL NUMBER:** \_\_\_\_\_  
**PHOTO NUMBER:** 8

**CAMERA DIRECTION:** Third floor, looking  
South, grain spout, can  
be connected to tubes to  
fill any grain bin or any  
area of corn cribs.

**SOUTH DAKOTA STATE HISTORIC PRESERVATION OFFICE  
HISTORIC SITES SURVEY STRUCTURE FORM**



**PHOTOGRAPHER:** Jim Stone  
**DATE OF PHOTO:** February 25, 2013

**ROLL NUMBER:** \_\_\_\_\_  
**PHOTO NUMBER:** 9

**CAMERA DIRECTION:** Third floor, looking West,  
North side of grain leg.



**PHOTOGRAPHER:** Jim Stone  
**DATE OF PHOTO:** February 25, 2013

**ROLL NUMBER:** \_\_\_\_\_  
**PHOTO NUMBER:** 10

**CAMERA DIRECTION:** Third floor, looking  
South, North side of  
grain leg, East side



**SOUTH DAKOTA STATE HISTORIC PRESERVATION OFFICE  
HISTORIC SITES SURVEY STRUCTURE FORM**



**PHOTOGRAPHER:** Jim Stone  
**DATE OF PHOTO:** February 25, 2013

**ROLL NUMBER:** \_\_\_\_\_  
**PHOTO NUMBER:** 11

**First floor, looking NW,  
hoist to tip wagons and  
unload into grain pit.**

**CAMERA DIRECTION:** \_\_\_\_\_



**PHOTOGRAPHER:** Jim Stone  
**DATE OF PHOTO:** February 25, 2013

**ROLL NUMBER:** \_\_\_\_\_  
**PHOTO NUMBER:** 12

**First floor, looking North,  
old grain wagon stored  
in driveway, like new.**

**CAMERA DIRECTION:** \_\_\_\_\_



## **HISTORY**

This farm located in the SW ¼ of Section 27, Meckling Township, Clay County was homesteaded by John Reeves.

The 1894 Clay County atlas lists G. W. Boot as the owner.

1901, 1912, 1924 and 1937 Clay County atlas lists Charles Walraven as the owner.

1948 and 1956 Clay county atlas lists V. W. Paulson as the owner.

The grain leg has stencils on the horizontal section on the third floor. It has Barton Elevator Company Barton, Illinois and ship to Oden Implement Vermillion, So. Dak. The cups on the leg are about 20” wide and 6” deep. The links on the chain are about 6” long and have a roller on each chain connection for a smoother operation.

Following is From

### **Gayville Hay County**

**The History of the Pioneers of the Gayville and Meckling , South Dakota Area**

#### **Charles Walraven**

The Walraven boys, Charles, John, Bert and Tunis came with their parents to America from the Netherlands and lived for some time at Pella, Iowa. Then they moved to Orange City, Iowa. Their father died and their mother re-married. So the four brothers, not wanting to live with their stepfather, left home and came to Gayville, where they lived and worked with the Peter J. Rykens for a year. The next year they moved onto a farm North of Gayville, which Mr Ryken helped them rent. Then the brothers each went their separate ways, as several of them were married. Charles bought a farm near Meckling in Section 27 where he farmed alone for 10 years. Then he married Marie Peterson, daughter of a nearby farmer, Henrich Peterson. The Charles Walravens had four children; Herman, Viola (Mrs. Anton Paulson), Gustava (Mrs. Willard Woods) and ? All of the Walraven children remained in the community.

Herman married Dorothy Berg and they have two adopted children, one of whom, Warren lives on the farm which Dorothy’s parents owned. Their son Warren is married and has two children; Kaelynn and Troy. The Tony Anton Paulsons have one daughter, Mrs. Romi Woods who lives in Van Nuys, California. The Willard Woods, who live West of Gayvile have one daughter, Rita, (Mrs. Jack Worden) and they have one daughter, Robin. The Wordens live on a farm adjoining the farm of the Willard Woods.

**SOUTH DAKOTA STATE HISTORIC PRESERVATION OFFICE  
HISTORIC SITES SURVEY STRUCTURE FORM**

