

**SOUTH DAKOTA STATE HISTORIC PRESERVATION OFFICE
HISTORIC SITES SURVEY STRUCTURE FORM**



SITE INFORMATION

*SURVEY DATE: November 8, 2013 *ADDRESS: 31186 456th Ave.
 *SURVEYOR: Jim Stone *COUNTY: Clay
 *CITY: Meckling

LOCATION DESCRIPTION: From Vermillion, South Dakota Highway 50 west to Meckling and 457th Ave., turn right (North) about 1-1/2 miles to 312th Street, turn left (West) 1 mile to 456th Ave., turn right ((North) about 1/4 mile on the right (East side).

LEGAL DESCRIPTION: SW 1/4, 14 - 93 - 53 Meckling Twp.

*QUARTER 1: <u>SW 1/4</u>	OWNER NAME: <u>Linda C. Christiansen LE - Lola M. & Charles H. Johnson Jr.</u>
*QUARTER 2: _____	OWNER ADDRESS: <u>31186 456th Ave.</u>
*TOWNSHIP: <u>Meckling</u>	OWNER CITY: <u>Meckling</u>
*RANGE: <u>53</u>	OWNER STATE: <u>So. Dak.</u>
*SECTION: <u>14</u>	OWNER ZIP: <u>57069</u>
ACRES: <u>163.01</u>	QUAD NAME: _____
OWNER CODE 1: <u>P</u>	
OWNER CODE 2: _____	
OWNER CODE 3: _____	

HISTORIC SIGNIFICANCE

*DOE: _____ REGISTER NAME: _____
 *DOE DATE: _____ MULTIPLE PROPERTY NAME: _____
 REASON INELIGIBLE: _____

NOMINATION STATUS: _____	CATEGORY: _____
DATE LISTED: _____	SIGNIFICANCE LEVEL 1: <u>N S L</u>
REFERENCE NUMBER: _____	SIGNIFICANCE LEVEL 2: <u>N S L</u>
HISTORIC DISTRICT RATING: <u>C or NC</u>	CRITERIA 1: <u>A B C D</u>
PERIOD: _____	CRITERIA 2: <u>A B C D</u>
	CRITERIA 3: <u>A B C D</u>
	CRITERIA 4: <u>A B C D</u>

SIGNIFICANCE NOTES: _____

* = REQUIRED FIELD

**SOUTH DAKOTA STATE HISTORIC PRESERVATION OFFICE
HISTORIC SITES SURVEY STRUCTURE FORM**



STRUCTURE DETAILS

SHPO ID: _____
 *PROPERTY NAME: _____
 OTHER NAME: _____

CURRENT FUNCTION: Vacant FOUNDATION: Poured concrete
 CURRENT SUBFUNCTION: Storage ROOF MATERIAL: Asphalt shingles over cedar shingles
 HISTORIC FUNCTION: Livestock barn ROOF SHAPE: Gable roof
 HISTORIC SUBFUNCTION: Hay & grain storage STRUCTURAL SYSTEM: Balloon framing
 OCCUPIED: No STYLE: Gable roof barn
Yes with TYPE: Livestock barn
 ACCESSIBLE: permission WALLS: 2x6 studs, 1x6" car siding

STORIES: 2 SIGNIFICANT PERSON: Charles W. Rainey
 *DATE OF CONSTRUCTION: 1910 to 1920 CULTURAL AFFILIATION: ?

ALTERED/MOVED NOTES: Original site. Asphalt shingles applied over cedar shingles.

INTERIOR NOTES: Two 14' x 10' granaries on the East side. Two spaced 2x6's for posts and a 6x6 beam that runs 18' from the West wall over to the two granaries. One double horse stall is still in place on the West side. Another double horse stall was on the North side in the west end, but has been removed.
 OTHER NOTES: 2x6 stud walls with 1x6" car siding on all four walls. The dividing wall between the main barn and the North lean-to has 1x8 shiplap up 8' high and has open studs above in hayloft. The rafters are 2x6's with 2x4 bracing from rafters down to the exterior wall at the floor level and 2x6 bracing from the bottom of the rafters down to the floor both 4' O. C. Windows are 9" x 12" four light. Metal cupola is still in place. The East granaries and the North lean-to appear to have been built with the original barn. The North wall of the lean-to is leaning out and rotting out.

*PHYSICAL NOTES: Barn is in poor to fair condition. *RESTRICTED: Y or N
 *UTM EASTING: _____
 *UTM NORTHING: _____

* = REQUIRED FIELD

**SOUTH DAKOTA STATE HISTORIC PRESERVATION OFFICE
HISTORIC SITES SURVEY STRUCTURE FORM**

SKETCH MAP

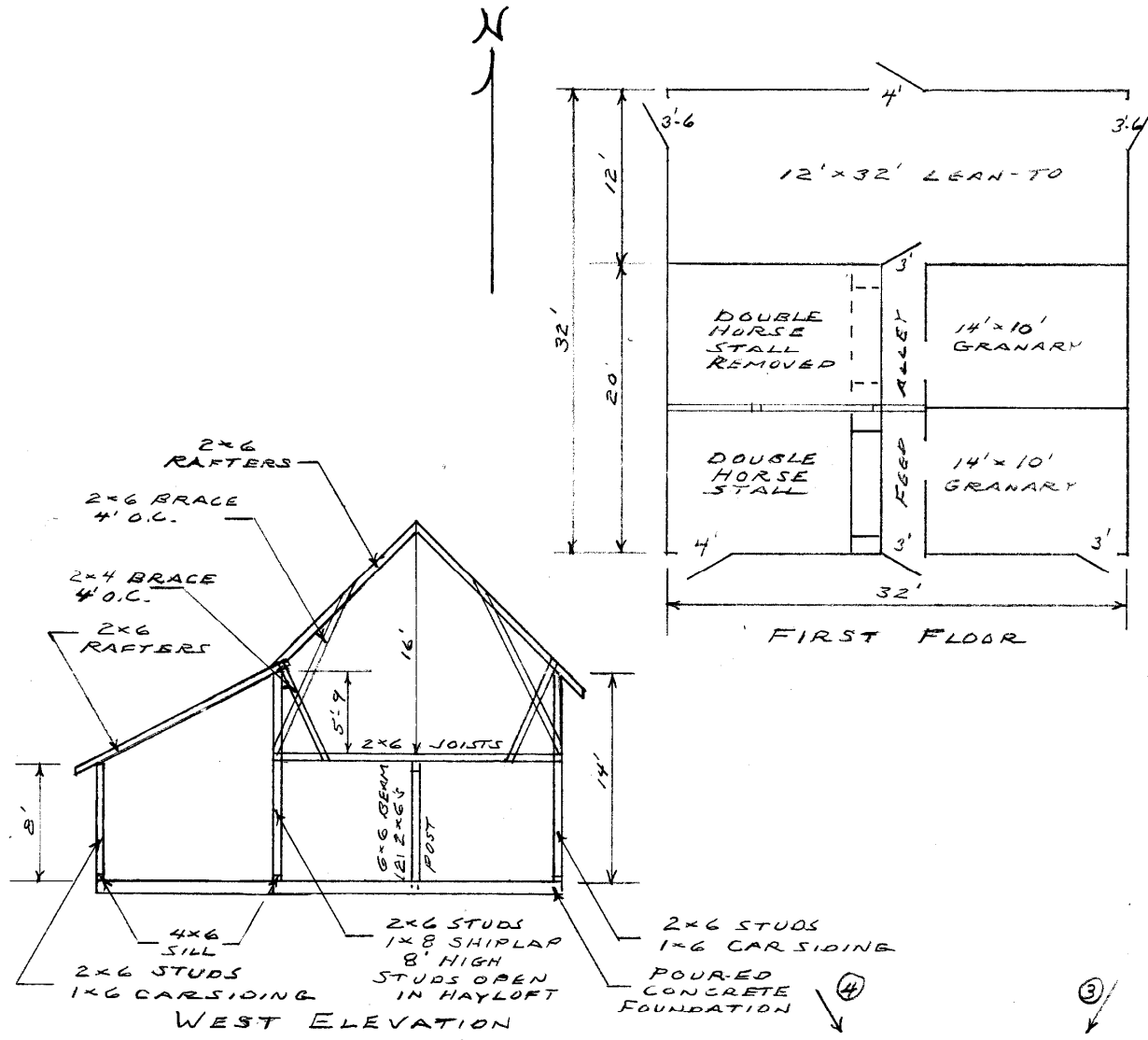

PHOTOGR

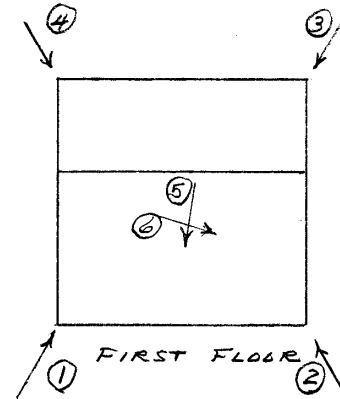
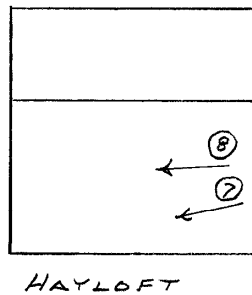

* = REQUIRED FIELD

**SOUTH DAKOTA STATE HISTORIC PRESERVATION OFFICE
HISTORIC SITES SURVEY STRUCTURE FORM**



PHOTOGRAPHER: Jim Stone
DATE OF PHOTO: November 8, 2013

ROLL NUMBER: _____
PHOTO NUMBER: 1
CAMERA DIRECTION: Looking NE, SW corner



PHOTOGRAPHER: Jim Stone
DATE OF PHOTO: November 8, 2013

ROLL NUMBER: _____
PHOTO NUMBER: 2
CAMERA DIRECTION: Looking NW, SE corner

* = REQUIRED FIELD

**SOUTH DAKOTA STATE HISTORIC PRESERVATION OFFICE
HISTORIC SITES SURVEY STRUCTURE FORM**



PHOTOGRAPHER: Jim Stone
DATE OF PHOTO: November 8, 2013

ROLL NUMBER: _____
PHOTO NUMBER: 3
CAMERA DIRECTION: Looking SW, NE corner



PHOTOGRAPHER: Jim Stone
DATE OF PHOTO: November 8, 2013

ROLL NUMBER: _____
PHOTO NUMBER: 4
CAMERA DIRECTION: Looking SE, NW corner

* = REQUIRED FIELD

**SOUTH DAKOTA STATE HISTORIC PRESERVATION OFFICE
HISTORIC SITES SURVEY STRUCTURE FORM**



PHOTOGRAPHER: Jim Stone
DATE OF PHOTO: November 8, 2013

ROLL NUMBER: _____
PHOTO NUMBER: 5
CAMERA DIRECTION: First floor, looking SE in to granary on East side



PHOTOGRAPHER: Jim Stone
DATE OF PHOTO: November 8, 2013

ROLL NUMBER: _____
PHOTO NUMBER: 6
CAMERA DIRECTION: First floor, looking SW, spaced double 2x6 posts, 6x6 beam, 2x6 floor joists, double horse stall on south side of West end.

* = REQUIRED FIELD

**SOUTH DAKOTA STATE HISTORIC PRESERVATION OFFICE
HISTORIC SITES SURVEY STRUCTURE FORM**



PHOTOGRAPHER: Jim Stone
DATE OF PHOTO: November 8, 2013

ROLL NUMBER: _____
PHOTO NUMBER: 7

Hayloft, looking SW, 2x6 rafters, 2x4 bracing from rafters down to floor, 2x4 bracing from bottom of rafters down to hayloft floor, both 4' O. C.

CAMERA DIRECTION: _____

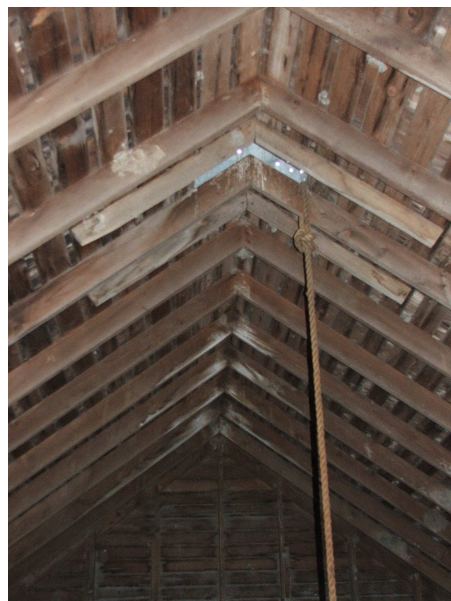

PHOTOGRAPHER: Jim Stone
DATE OF PHOTO: November 8, 2013

ROLL NUMBER: _____
PHOTO NUMBER: 8

Hayloft, looking West, 2x6 rafters and West gable end.

CAMERA DIRECTION: _____

* = REQUIRED FIELD

**SOUTH DAKOTA STATE HISTORIC PRESERVATION OFFICE
HISTORIC SITES SURVEY STRUCTURE FORM**

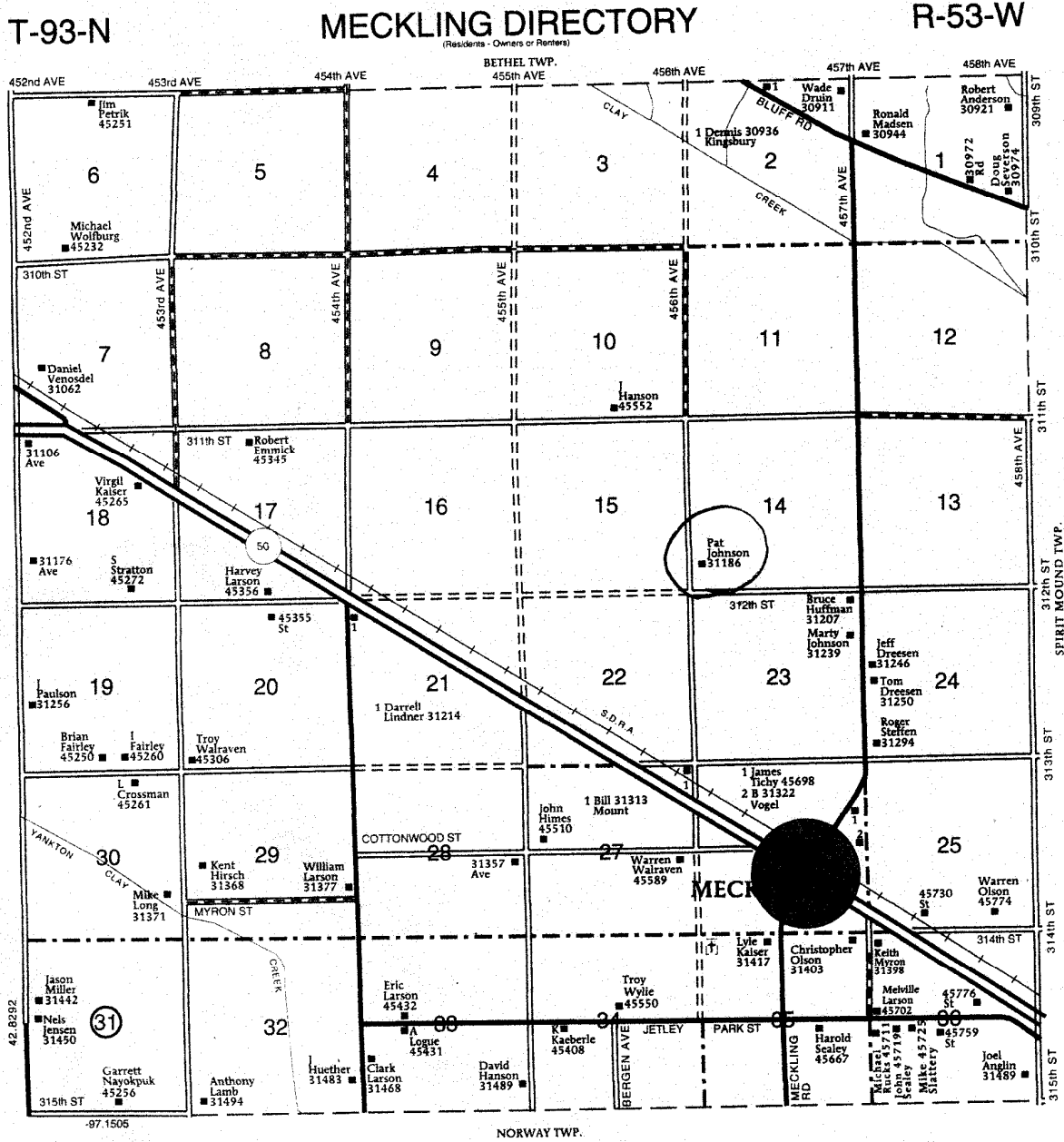

* = REQUIRED FIELD

History

This farm located in the SW ¼ of Section 14, Meckling Township, Clay County was homesteaded by Edward Rederich.

The 1894 Clay County Atlas lists Daniel S. Good as the owner.

The 1901 Clay County Atlas lists Susan Good as the owner.

The 1912 and 1924 Clay County Atlas lists Charles W. Rainey as the owner.

The 1937 Clay County Atlas lists Mrs. Charles W. Rainey as the owner. I. W. Whittaker is listed as the operator, (renter).

The 1948 Clay County Atlas lists Elis Rainey as the owner.

The 1956 Clay County Atlas lists Charles H. Johnson as the owner.

**SOUTH DAKOTA STATE HISTORIC PRESERVATION OFFICE
HISTORIC SITES SURVEY STRUCTURE FORM**

