

**SOUTH DAKOTA STATE HISTORIC PRESERVATION OFFICE
HISTORIC SITES SURVEY STRUCTURE FORM**



SITE INFORMATION

*SURVEY DATE: November 4, 2012 *ADDRESS: 4424 East Main Street
*SURVEYOR: Jim Stone *COUNTY: Clay
*CITY: Vermillion

LOCATION DESCRIPTION: From Main Street in Vermillion, East to Crawford Road, continue East for about 2-1/4 miles, from Fairview Ave. road will be gravel for last 1/2 mile, on the left (North) side.

LEGAL DESCRIPTION: Lot FM -1 of SW 1/4, SW 1/4, 15 - 92 - 51 Fairview Twp.

*QUARTER 1: SW 1/4
*QUARTER 2: _____
*TOWNSHIP: Fairview
*RANGE: 51
*SECTION: 15
ACRES: 7.18

OWNER NAME: Dustin K. Carter & Katie Lynn Schoenrock
OWNER ADDRESS: 4424 East Main Street
OWNER CITY: Vermillion
OWNER STATE: South Dakota
OWNER ZIP: 57069
QUAD NAME: _____

OWNER CODE 1: P
OWNER CODE 2: _____
OWNER CODE 3: _____

HISTORIC SIGNIFICANCE

*DOE: _____
*DOE DATE: _____
REASON INELIGIBLE: _____

REGISTER NAME: _____
MULTIPLE PROPERTY NAME: _____

NOMINATION STATUS: _____
DATE LISTED: _____
REFERENCE NUMBER: _____
HISTORIC DISTRICT RATING: C or NC
PERIOD: _____

CATEGORY: _____
SIGNIFICANCE LEVEL 1: N S L
SIGNIFICANCE LEVEL 2: N S L
CRITERIA 1: A B C D
CRITERIA 2: A B C D
CRITERIA 3: A B C D
CRITERIA 4: A B C D

SIGNIFICANCE NOTES: _____

STRUCTURE DETAILS

* = REQUIRED FIELD

**SOUTH DAKOTA STATE HISTORIC PRESERVATION OFFICE
HISTORIC SITES SURVEY STRUCTURE FORM**



SHPO ID: _____
 *PROPERTY NAME: _____
 OTHER NAME: _____

CURRENT FUNCTION: <u>Livestock barn</u>	FOUNDATION: <u>Poured concrete foundation</u>
CURRENT SUBFUNCTION: <u>Hay and feed storage</u>	ROOF MATERIAL: <u>Steel roofing over cedar shingles</u>
HISTORIC FUNCTION: <u>Livestock barn</u>	ROOF SHAPE: <u>Gable</u>
HISTORIC SUBFUNCTION: <u>Hay and grain storage</u>	STRUCTURAL SYSTEM: <u>Balloon framing</u>
	STYLE: <u>Gable roof barn</u>
OCCUPIED: <u>Yes</u>	TYPE: <u>Livestock barn</u>
	<u>2x6 stud with 1x6 #106 drop siding and steel roofing</u>
ACCESSIBLE: <u>Yes with permission</u>	WALLS: _____
STORIES: <u>2</u>	SIGNIFICANT PERSON: <u>Carrie Burgess</u>
*DATE OF CONSTRUCTION: <u>1910-1920</u>	CULTURAL AFFILIATION: <u>?</u>

ALTERED/MOVED NOTES: Original site. Any evidence of milk cow stanchions and horse stalls has been removed. Walls and roof have been covered with steel roofing. Office built in the SE corner. All walls have been insulated and lined. All walk doors have been replaced with insulated steel doors. All windows have been replaced with aluminum slider windows.

INTERIOR NOTES: Has two rows of 6x6 posts with 6x6 for beams. 2x8 floor joists. Granary, feed room and stairs are still in the SW corner.

OTHER NOTES: 2x6 stud walls with 1x6 T&G sheathing. It may be the siding as there is no additional siding on the outside of wall between the hayloft and West lean-to. All of the other walls are covered with steel and hides any evidence of original siding. In hayloft there is a 2x6 brace 8' O.C. from center of the rafter down to the bottom of wall, with 1x6 brace back to top of wall. All of the 2x6's, 2x8's and 6x6's are rough sawn cottonwood. The rafters in the hayloft are milled lumber, which is strange, as the rafters in lean-to are rough sawn.

*PHYSICAL NOTES: Barn is in very good condition.

*UTM ZONE: _____ *RESTRICTED: Y or N
 *UTM EASTING: _____
 *UTM NORTHING: _____

* = REQUIRED FIELD

**SOUTH DAKOTA STATE HISTORIC PRESERVATION OFFICE
HISTORIC SITES SURVEY STRUCTURE FORM**



SKETCH MAP

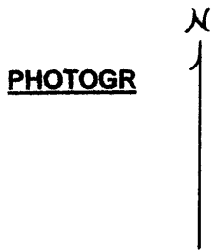
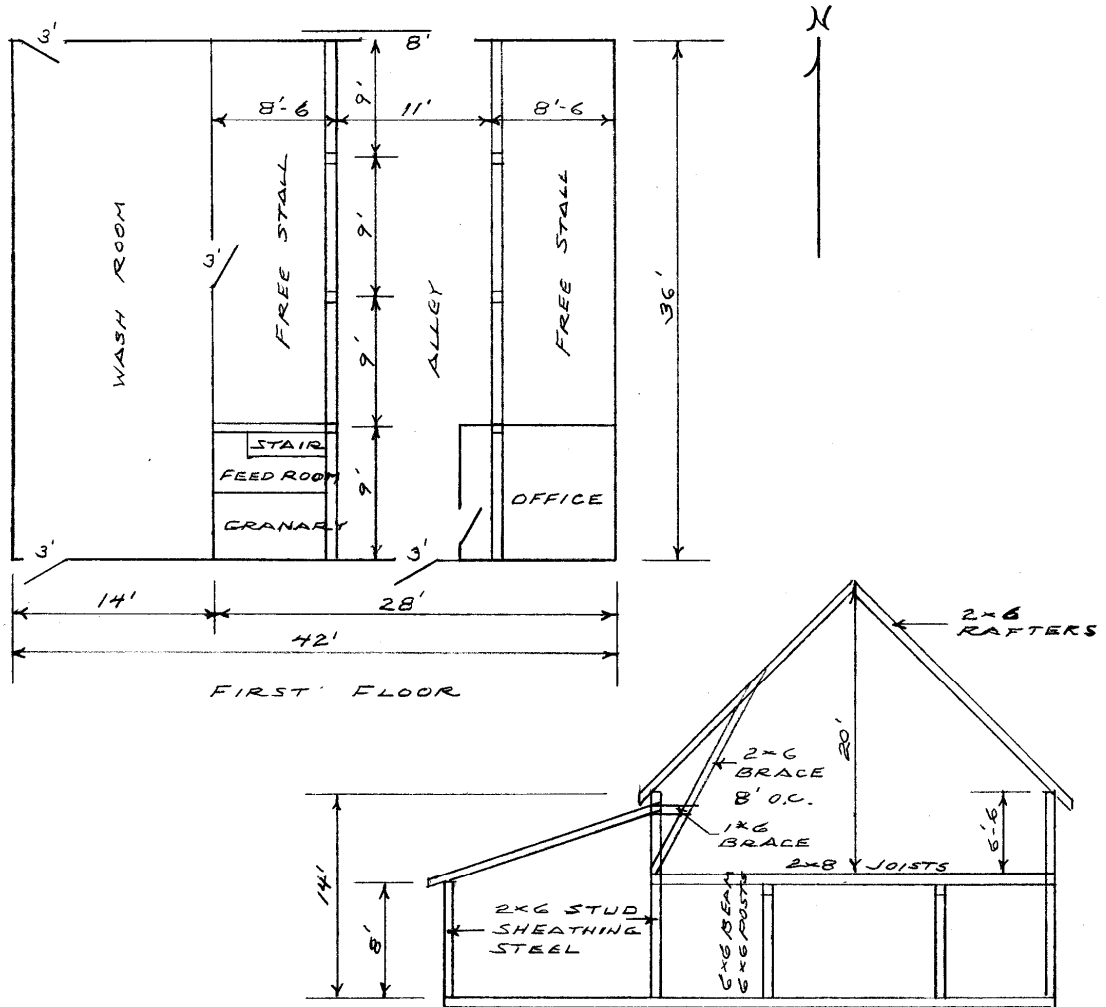

* = REQUIRED FIELD

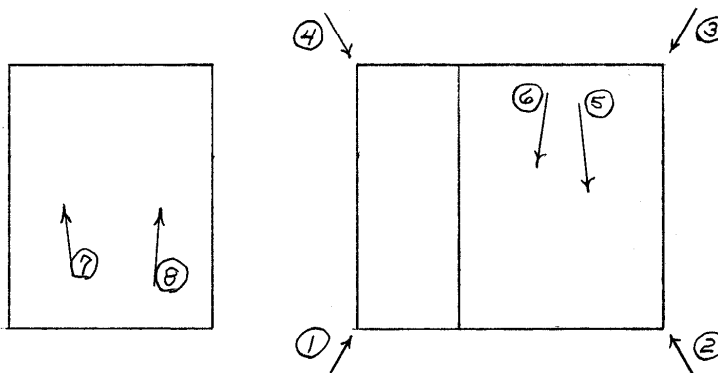

* = REQUIRED FIELD

**SOUTH DAKOTA STATE HISTORIC PRESERVATION OFFICE
HISTORIC SITES SURVEY STRUCTURE FORM**



PHOTOGRAPHER: Jim Stone
DATE OF PHOTO: November 4, 2012

ROLL NUMBER: _____
PHOTO NUMBER: 1
CAMERA DIRECTION: Looking NE, SW corner



PHOTOGRAPHER: Jim Stone
DATE OF PHOTO: November 4, 2012

ROLL NUMBER: _____
PHOTO NUMBER: 2
CAMERA DIRECTION: Looking NW, SE corner

* = REQUIRED FIELD

**SOUTH DAKOTA STATE HISTORIC PRESERVATION OFFICE
HISTORIC SITES SURVEY STRUCTURE FORM**



PHOTOGRAPHER: Jim Stone
DATE OF PHOTO: November 4, 2012

ROLL NUMBER: _____
PHOTO NUMBER: 3
CAMERA DIRECTION: Looking SW, NE corner



PHOTOGRAPHER: Jim Stone
DATE OF PHOTO: November 4, 2012

ROLL NUMBER: _____
PHOTO NUMBER: 4
CAMERA DIRECTION: Looking SE, NW corner

* = REQUIRED FIELD

**SOUTH DAKOTA STATE HISTORIC PRESERVATION OFFICE
HISTORIC SITES SURVEY STRUCTURE FORM**



PHOTOGRAPHER: Jim Stone
DATE OF PHOTO: November 4, 2012

ROLL NUMBER: _____
PHOTO NUMBER: 5

CAMERA DIRECTION: First floor, looking SE,
office built into SE
corner.



PHOTOGRAPHER: Jim Stone
DATE OF PHOTO: November 4, 2012

ROLL NUMBER: _____
PHOTO NUMBER: 6

CAMERA DIRECTION: First floor, looking SW,
granary, feed room and
stairs in SW corner.

**SOUTH DAKOTA STATE HISTORIC PRESERVATION OFFICE
HISTORIC SITES SURVEY STRUCTURE FORM**



PHOTOGRAPHER: Jim Stone
DATE OF PHOTO: November 4, 2012

ROLL NUMBER: _____
PHOTO NUMBER: 7

CAMERA DIRECTION: Hayloft, looking North,
2x6 brace from rafter
down to floor



PHOTOGRAPHER: Jim Stone
DATE OF PHOTO: November 4, 2012

ROLL NUMBER: _____
PHOTO NUMBER: 8

CAMERA DIRECTION: Hayloft, looking North,
2x6 rafter bracing.

* = REQUIRED FIELD

T-91-92-N

FAIRVIEW DIRECTORY

R-51-W

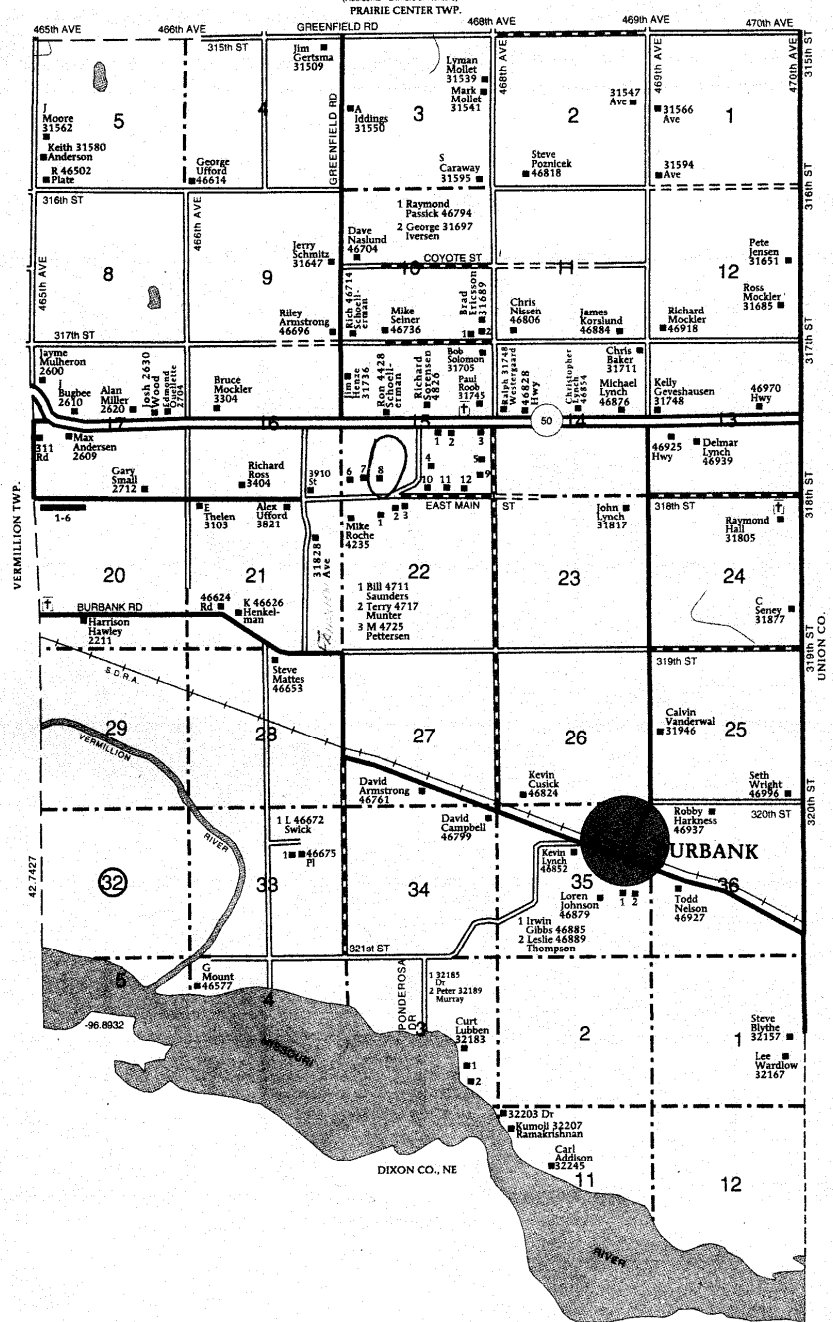

FAIRVIEW TOWNSHIP	6 Meyer, Leroy 4206	SECTION 20
SECTION 15	7 Nauertz, James 4306	1 2509
1 Turnbaugh, V 5009	8 Schoenrock, K 4424	2 Crew, M 2531
2 Ashes, Severn 5225	9 Knutson, Richard 5101	3 Neitzke, Mark 2703
3 Behrmann, David 31761	10 Mogck, John 4733	4 Cook, Cleland 2711
4 Albers, Dave 4745	11 Miller, Stan 4901	5 Miskimins, Robin 2835
5 Ouellette, Loren 31765	12 Hovden, Donald 4905	6 Ahmed, Mike 2925

© Farm & Home Publishers, Ltd.

* = REQUIRED FIELD

HISTORY

This farm located in the SW ¼ of SW ¼ in Section 15, Fairview Township, Clay County was homesteaded by Lyman Burgess

The 1894, 1901, 1912, 1924, and 1937 Clay County Atlas lists Carrie Burgess as the owner and the 1937 atlas lists P. Ouellette as the operator (renter).

The 1948 Clay County Atlas lists Joie Chaussee as the owner.

The 1956 Clay County Atlas lists J. A. Chaussee as the owner.

**SOUTH DAKOTA STATE HISTORIC PRESERVATION OFFICE
HISTORIC SITES SURVEY STRUCTURE FORM**

