

SOUTH DAKOTA STATE HISTORIC PRESERVATION OFFICE
HISTORIC SITES SURVEY STRUCTURE FORM



SITE INFORMATION

*SURVEY DATE: March 12, 2014

*SURVEYOR: Jim Stone

*ADDRESS: 46186 300th Street

*COUNTY: Clay

*CITY: Centerville

LOCATION DESCRIPTION: From Vermillion, intersection of South Dakota Highway 50 bi-pass and South Dakota Highway 19, North 17 miles to 300th Street, turn left (West) about 1/8 mile, on the right (North) side.

LEGAL DESCRIPTION: S 555' of E 1,055' of the SE 1/4, SE 1/4, Exc Lot H2, 15 -95 - 52 Riverside Twp.

*QUARTER 1: SE 1/4

*QUARTER 2: _____

*TOWNSHIP: Riverside

*RANGE: 52

*SECTION: 15

ACRES: 12.45

OWNER CODE 1: P

OWNER CODE 2: _____

OWNER CODE 3: _____

OWNER NAME: Mary E. White

OWNER ADDRESS: 46186 300th Street

OWNER CITY: Centerville

OWNER STATE: South Dakota

OWNER ZIP: 57014

QUAD NAME: _____

HISTORIC SIGNIFICANCE

*DOE: _____

*DOE DATE: _____

REASON INELIGIBLE: _____

REGISTER NAME: _____

MULTIPLE PROPERTY NAME: _____

NOMINATION STATUS: _____

DATE LISTED: _____

REFERENCE NUMBER: _____

HISTORIC DISTRICT RATING: C or NC

PERIOD: _____

CATEGORY: _____

SIGNIFICANCE LEVEL 1: N S L

SIGNIFICANCE LEVEL 2: N S L

CRITERIA 1: A B C D

CRITERIA 2: A B C D

CRITERIA 3: A B C D

CRITERIA 4: A B C D

SIGNIFICANCE NOTES: _____

STRUCTURE DETAILS

SOUTH DAKOTA STATE HISTORIC PRESERVATION OFFICE

HISTORIC SITES SURVEY STRUCTURE FORM



SHPO ID: _____

*PROPERTY NAME: _____

OTHER NAME: _____

CURRENT FUNCTION: Vacant

CURRENT SUBFUNCTION: Storage

HISTORIC FUNCTION: Livestock barn

HISTORIC SUBFUNCTION: Hay and grain storage

OCCUPIED: Yes

ACCESSIBLE: Yes with permission

STORIES: 2

*DATE OF CONSTRUCTION: 1900 to 1910

FOUNDATION: Poured concrete

ROOF MATERIAL: Steel roofing over cedar shingles

ROOF SHAPE: Gable roof

STRUCTURAL SYSTEM: Balloon framing

STYLE: Gable roof barn

TYPE: Livestock barn

2x4 studs, 1x10 shiplap and 1/2"x 6" cedar lap siding

WALLS: _____

SIGNIFICANT PERSON: B. S. Barton

CULTURAL AFFILIATION: ?

ALTERED/MOVED NOTES: Moved from Section 22, just South across the road. Original studs were 7'. Studs were spliced on the side to make an 8' 10" wall. Two rows of 4x6 posts with (2) 2x8's for a beam and 2x8 floor joists were added to make a hayloft. Horse stalls were added on the West side and a 22' x 9'- 6" granary was added on the west wall at the North end. Roof was covered with steel roofing. New concrete foundation was poured. Don't know year it was moved. Best guess is 1910 to 1920.

INTERIOR NOTES: Two rows of 4x6 posts, (2) 2x8's for beams and 2x8 floor joists for the hayloft floor. Five horse stalls along West wall. 4' x 9'- 6" tack room in the SW corner and a 22' x 9'- 6" granary in the NW corner. Two rows of 4x4 posts and a (2) 2x4's beam support the center of rafters in the hayloft.

OTHER NOTES: 2X4 stud walls with 1x10 shiplap and 1/2"x 6" cedar lap siding. Windows are 8" x 10" four light. Rafters are 2x4's. Two metal cupola's still on roof. One weather vane has a hog on it.

*PHYSICAL

NOTES: Barn is in fair condition.

*RESTRICTED: Y or N

*UTM EASTING: _____

*UTM NORTHING: _____



**SOUTH
DAKOTA STATE
HISTORICAL SOCIETY**
Department of Tourism and State Development

3

**SOUTH DAKOTA STATE HISTORIC PRESERVATION OFFICE
HISTORIC SITES SURVEY STRUCTURE FORM**



PHOTOGRAPHER: Jim Stone
DATE OF PHOTO: March 12, 2014

ROLL NUMBER: _____
PHOTO NUMBER: 1
CAMERA DIRECTION: Looking NE, SW corner



PHOTOGRAPHER: Jim Stone
DATE OF PHOTO: March 12, 2014

ROLL NUMBER: _____
PHOTO NUMBER: 2
CAMERA DIRECTION: Looking NW, SE corner

SOUTH DAKOTA STATE HISTORIC PRESERVATION OFFICE
HISTORIC SITES SURVEY STRUCTURE FORM



PHOTOGRAPHER: Jim Stone
DATE OF PHOTO: March 12, 2014

ROLL NUMBER: _____
PHOTO NUMBER: 3
CAMERA DIRECTION: Looking SW, NE corner



PHOTOGRAPHER: Jim Stone
DATE OF PHOTO: March 12, 2014

ROLL NUMBER: _____
PHOTO NUMBER: 4
CAMERA DIRECTION: Looking SE, NW corner

**SOUTH DAKOTA STATE HISTORIC PRESERVATION OFFICE
HISTORIC SITES SURVEY STRUCTURE FORM**



PHOTOGRAPHER: Jim Stone
DATE OF PHOTO: March 12, 2014

ROLL NUMBER: _____
PHOTO NUMBER: 5

**First floor, looking NW at
6x6 posts, (2) 2x8's
beam and 2x8 floor
joists, horse stalls on
West wall.**

CAMERA DIRECTION: _____



PHOTOGRAPHER: Jim Stone
DATE OF PHOTO: March 12, 2014

ROLL NUMBER: _____
PHOTO NUMBER: 6

**First floor, looking SW
into a horse stall on
West wall.**

CAMERA DIRECTION: _____

**SOUTH DAKOTA STATE HISTORIC PRESERVATION OFFICE
HISTORIC SITES SURVEY STRUCTURE FORM**



PHOTOGRAPHER: Jim Stone
DATE OF PHOTO: March 12, 2014

ROLL NUMBER: _____
PHOTO NUMBER: 7

CAMERA DIRECTION: First floor, looking NE into the East side, any evidence of what was there is gone.



PHOTOGRAPHER: Jim Stone
DATE OF PHOTO: March 12, 2014

ROLL NUMBER: _____
PHOTO NUMBER: 8

CAMERA DIRECTION: Hayloft, looking NW, 9'-6" x 22' granary extended into the hayloft.

SOUTH DAKOTA STATE HISTORIC PRESERVATION OFFICE
HISTORIC SITES SURVEY STRUCTURE FORM



PHOTOGRAPHER: Jim Stone
DATE OF PHOTO: March 12, 2014

ROLL NUMBER: _____
PHOTO NUMBER: 9

CAMERA DIRECTION: Hayloft, looking NE. 4x4 posts and (2) 2x4's for a beam supporting 2x4 rafters.

SOUTH DAKOTA STATE HISTORIC PRESERVATION OFFICE

HISTORIC SITES SURVEY STRUCTURE FORM



T-95-N

RIVERSIDE DIRECTORY

R-52-W

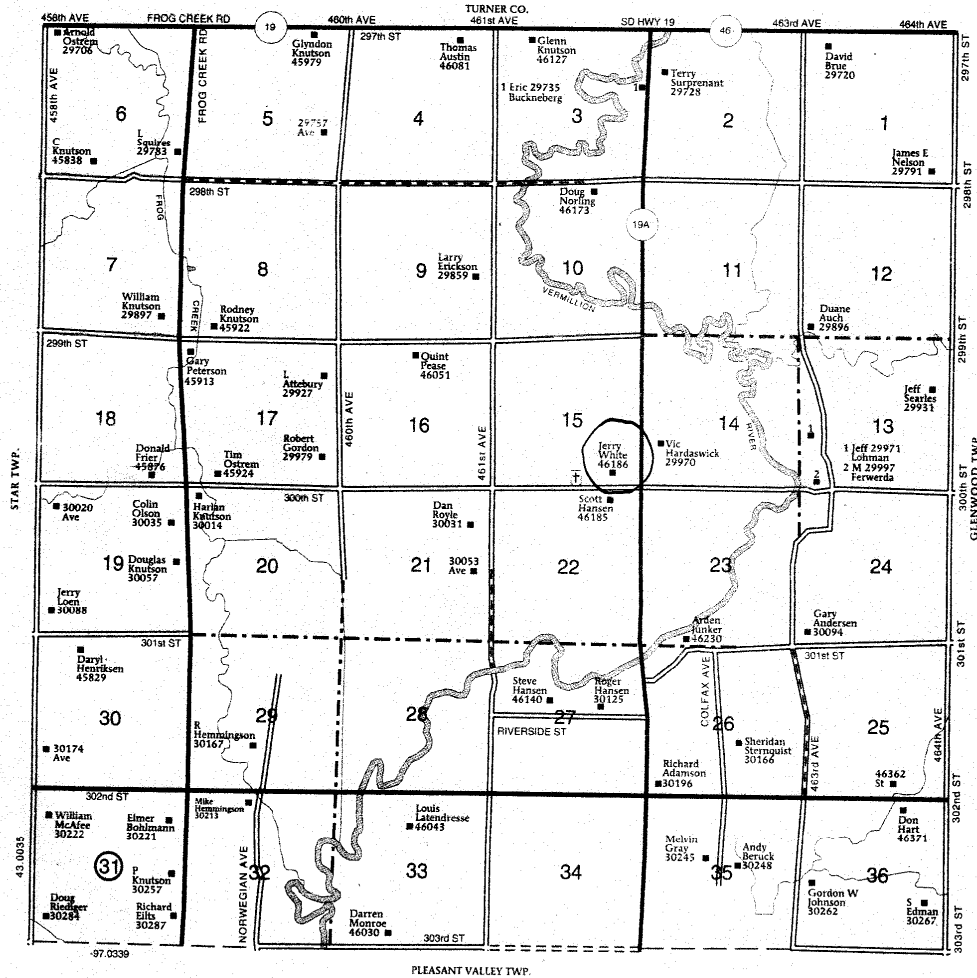

History

This farm located in the SE ¼ of Section 15, Riverside Township, Clay County was homesteaded by Moses Stanley.

The 1894 Clay County Atlas lists Mary Barton as the owner.

The 1901 and 1912 Clay County Atlas lists B. S. Barton as the owner.

The 1924 Clay County Atlas lists Ole Paulson as the owner.

The 1937, 1948 and 1956 Clay County Atlas lists B. A. Paulson as the owner.