

SOUTH DAKOTA STATE HISTORIC PRESERVATION OFFICE
HISTORIC SITES SURVEY STRUCTURE FORM



SITE INFORMATION

*SURVEY DATE: January 18, 2013
*SURVEYOR: Jim Stone

*ADDRESS: 30387 470th Ave.
*COUNTY: Clay
*CITY: Beresford

LOCATION DESCRIPTION: From Vermillion, South Dakota Highway 50, East 2 miles to Greenfield Road, turn left (North) 12-1/2 miles to 306th Street, turn right (East) 2 miles to 470th Ave., turn left (North), about 2-1/4 miles, on the left (West side).

LEGAL DESCRIPTION: S 1/2 , SE 1/4, 1- 94 - 51 Garfield Twp.

*QUARTER 1: SE 1/4
*QUARTER 2: _____
*TOWNSHIP: Garfield
*RANGE: 51
*SECTION: 1
ACRES: 80.77

OWNER CODE 1: P
OWNER CODE 2: _____
OWNER CODE 3: _____

OWNER NAME: Betty I. Jensen, 2009 Trust
OWNER ADDRESS: 309 SE 13th Street
OWNER CITY: Beresford
OWNER STATE: South Dakota
OWNER ZIP: 57004
QUAD NAME: _____

HISTORIC SIGNIFICANCE

*DOE: _____
*DOE DATE: _____
REASON INELIGIBLE: _____

REGISTER NAME: _____
MULTIPLE PROPERTY NAME: _____

NOMINATION STATUS: _____
DATE LISTED: _____
REFERENCE NUMBER: _____
HISTORIC DISTRICT RATING: C or NC
PERIOD: _____

CATEGORY: _____
SIGNIFICANCE LEVEL 1: N S L
SIGNIFICANCE LEVEL 2: N S L

CRITERIA 1: A B C D
CRITERIA 2: A B C D
CRITERIA 3: A B C D
CRITERIA 4: A B C D

SIGNIFICANCE NOTES: _____

STRUCTURE DETAILS

* = REQUIRED FIELD

SOUTH DAKOTA STATE HISTORIC PRESERVATION OFFICE
HISTORIC SITES SURVEY STRUCTURE FORM



SHPO ID: _____
*PROPERTY NAME: _____
OTHER NAME: _____

CURRENT FUNCTION:	<u>Shop</u>	FOUNDATION:	<u>Poured concrete foundation</u>
			<u>Galv. Corri. steel over cedar shingles</u>
CURRENT SUBFUNCTION:	<u>Storage</u>	ROOF MATERIAL:	<u>shingles</u>
HISTORIC FUNCTION:	<u>Livestock barn</u>	ROOF SHAPE:	<u>Gable</u>
HISTORIC SUBFUNCTION:	<u>Hay storage</u>	STRUCTURAL SYSTEM:	<u>Balloon framing</u>
			<u>Western feeder barn</u>
		STYLE:	<u>barn</u>
OCCUPIED:	<u>Yes</u>	TYPE:	<u>Livestock barn</u>
	<u>Yes with</u>		<u>2x4 studs, 1x8 #106 drop siding</u>
ACCESSIBLE:	<u>permission</u>	WALLS:	
STORIES:	<u>2</u>	SIGNIFICANT PERSON:	<u>Axel Jensen</u>
*DATE OF CONSTRUCTION:	<u>About 1920</u>	CULTURAL AFFILIATION:	<u>Danish</u>

ALTERED/MOVED NOTES: Original site. 26" galvanized corrugated steel roofing applied on roof over cedar shingles. 12'x24' lean-to added on the North side at a later date.

INTERIOR NOTES: Has two rows of 4x6 posts, with (2) 2x4's for a beam. 2x6 floor joists for hayloft floor. Horse stalls, tack room and granary still in place in the center of barn. Seven milk cow stanchions are still in place in the South lean-to. Hay feed rack still in place in North lean-to.

OTHER NOTES: 2x4 stud walls with 1x8 #106 drop siding. Rafters are 2x4's with a 2x6 horizontal brace 4' O.C. Windows are 8"x10" four light except in the North lean-to where they are 9"x 12" four light windows. 4x6 sill that is on edge to fit 2x4 studs.

*PHYSICAL NOTES: Barn is in fair condition.

*UTM ZONE: _____

*RESTRICTED: Y or N

*UTM EASTING: _____

*UTM NORTHING: _____

SOUTH DAKOTA STATE HISTORIC PRESERVATION OFFICE
HISTORIC SITES SURVEY STRUCTURE FORM

SKETCH MAP

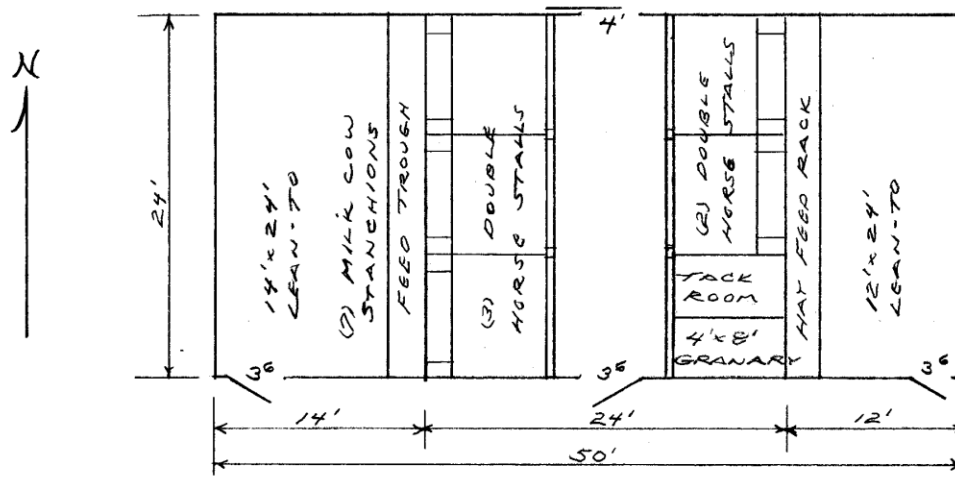

FIRST FLOOR

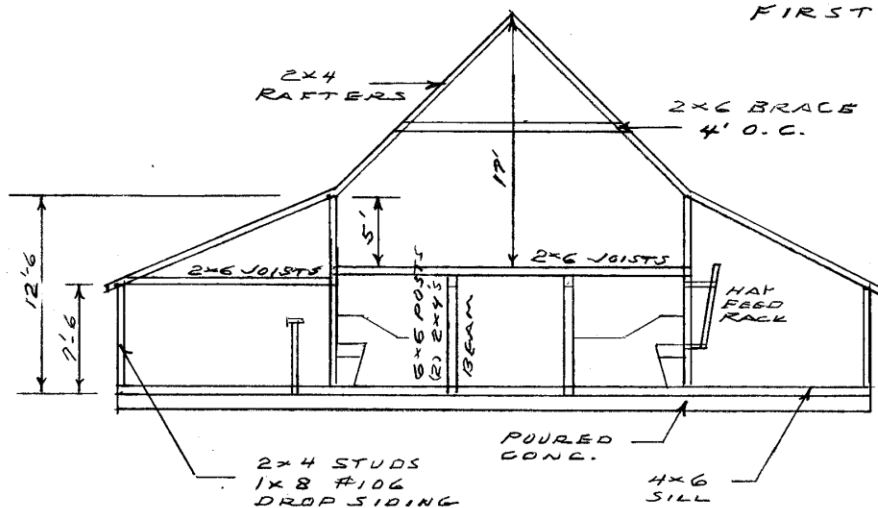

EAST ELEVATION

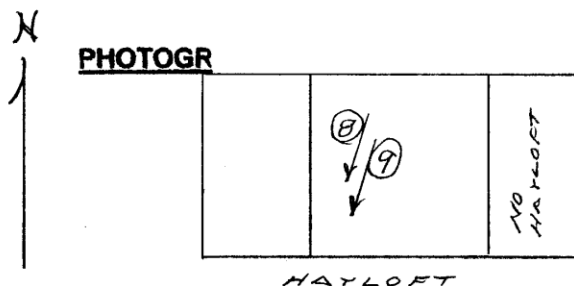

PHOTOGR

HAYLOFT

* = REQUIRED FIELD

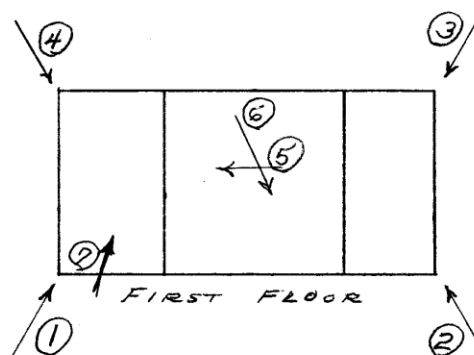

FIRST FLOOR

* = REQUIRED FIELD

**SOUTH DAKOTA STATE HISTORIC PRESERVATION OFFICE
HISTORIC SITES SURVEY STRUCTURE FORM**



PHOTOGRAPHER: Jim Stone
DATE OF PHOTO: January 18, 2013

ROLL NUMBER: _____
PHOTO NUMBER: 1
CAMERA DIRECTION: Looking NE, SW corner



PHOTOGRAPHER: Jim Stone
DATE OF PHOTO: January 18, 2013

ROLL NUMBER: _____
PHOTO NUMBER: 2
CAMERA DIRECTION: Looking NW, SE corner

**SOUTH DAKOTA STATE HISTORIC PRESERVATION OFFICE
HISTORIC SITES SURVEY STRUCTURE FORM**



PHOTOGRAPHER: Jim Stone
DATE OF PHOTO: January 18, 2013

ROLL NUMBER: _____
PHOTO NUMBER: 3
CAMERA DIRECTION: Looking SW, NE corner



PHOTOGRAPHER: Jim Stone
DATE OF PHOTO: January 18, 2013

ROLL NUMBER: _____
PHOTO NUMBER: 4
CAMERA DIRECTION: Looking SE, NW corner

**SOUTH DAKOTA STATE HISTORIC PRESERVATION OFFICE
HISTORIC SITES SURVEY STRUCTURE FORM**



PHOTOGRAPHER: Jim Stone
DATE OF PHOTO: January 18, 2013

ROLL NUMBER: _____
PHOTO NUMBER: 5

CAMERA DIRECTION: First floor, looking South, horse stall in center of barn



PHOTOGRAPHER: Jim Stone
DATE OF PHOTO: January 18, 2013

ROLL NUMBER: _____
PHOTO NUMBER: 6

CAMERA DIRECTION: First floor, looking NE, tack room and granary in the NE corner of center of barn

**SOUTH DAKOTA STATE HISTORIC PRESERVATION OFFICE
HISTORIC SITES SURVEY STRUCTURE FORM**



PHOTOGRAPHER: Jim Stone
DATE OF PHOTO: January 18, 2013

ROLL NUMBER: _____
PHOTO NUMBER: 7

CAMERA DIRECTION: First floor, South lean-to, looking NW, seven milk cow stanchions still in place.



PHOTOGRAPHER: Jim Stone
DATE OF PHOTO: January 18, 2013

ROLL NUMBER: _____
PHOTO NUMBER: 8

CAMERA DIRECTION: Hayloft, looking SE, 2x4 rafters and 2x6 horizontal bracing 4' O.C.

**SOUTH DAKOTA STATE HISTORIC PRESERVATION OFFICE
HISTORIC SITES SURVEY STRUCTURE FORM**



PHOTOGRAPHER: Jim Stone
DATE OF PHOTO: January 18, 2013

ROLL NUMBER: _____
PHOTO NUMBER: 9

CAMERA DIRECTION: Hayloft, looking SE, 5'
South wall and hayloft
over South lean-to.

SOUTH DAKOTA STATE HISTORIC PRESERVATION OFFICE HISTORIC SITES SURVEY STRUCTURE FORM



T-94-N

GARFIELD DIRECTORY

R-51-W

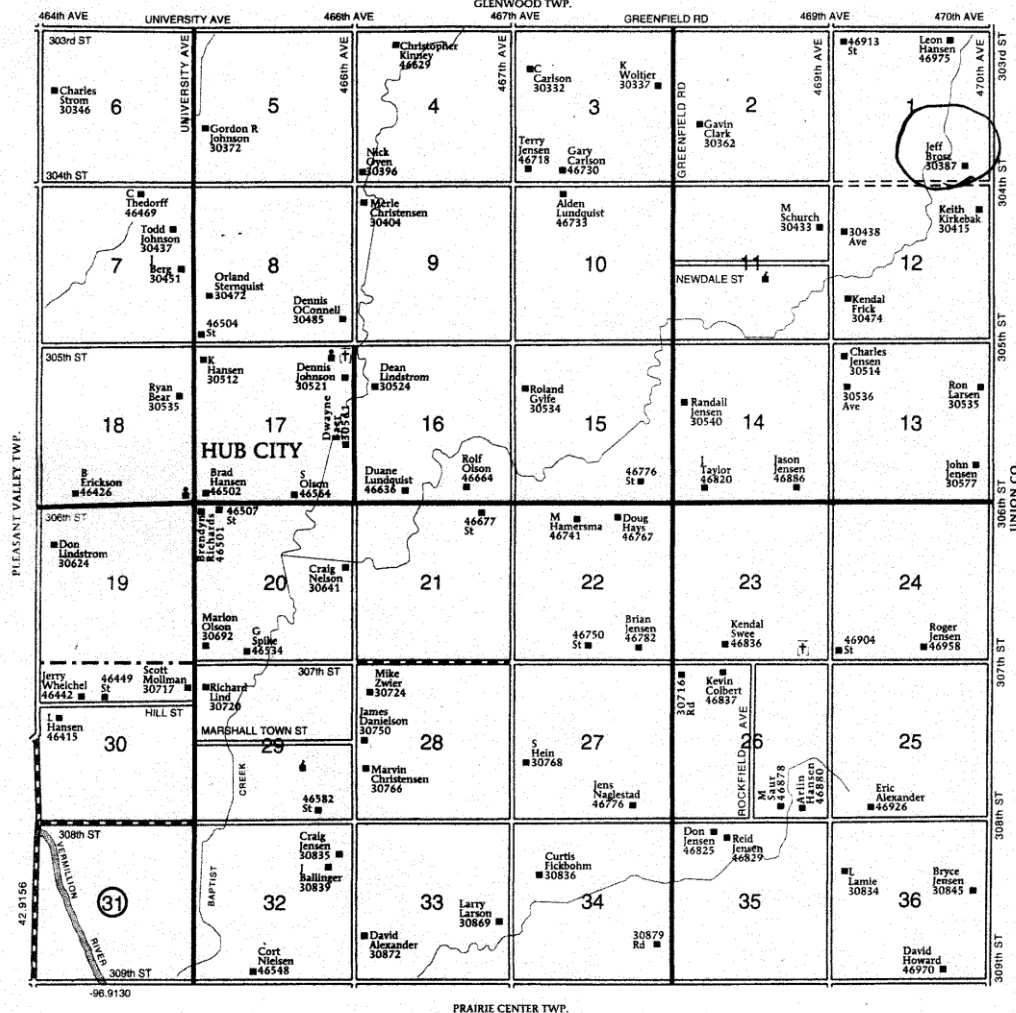

© Farm & Home Publishers, Ltd.

21

CLAY CO., ST

HISTORY

* = REQUIRED FIELD

SOUTH DAKOTA STATE HISTORIC PRESERVATION OFFICE
HISTORIC SITES SURVEY STRUCTURE FORM



Farm located in the SE ¼ of Section 1, Garfield Township, Clay County was homesteaded by John Vernard.

The 1901 Clay County Atlas lists Susan Vernard as the owner.

The 1901 Clay County Atlas lists August Benson as the owner.

The 1912 Clay County Atlas lists Wm. C. Smith as the owner.

The 1924, 1937, 1948 and 1956 Clay County Atlas lists Axel Jensen as the owner.