

**SOUTH DAKOTA STATE HISTORIC PRESERVATION OFFICE
HISTORIC SITES SURVEY STRUCTURE FORM**



SITE INFORMATION

*SURVEY DATE: May 16, 2013 *ADDRESS: 30238 467th Ave.
*SURVEYOR: Jim Stone *COUNTY: Clay
*CITY: Beresford

LOCATION DESCRIPTION: From Vermillion, the intersection of South Dakota Highway 50 bi-pass and University Road, North 16 miles to 302 nd Street, turn right, (East) about 1- 1/4 miles, on the right (South) Side.

LEGAL DESCRIPTION: W. E. Anderson Addn in SW 1/4, NW 1/4, 34- 95 - 51 Glenwood Twp.

*QUARTER 1: NW 1/4
*QUARTER 2: _____
*TOWNSHIP: Glenwood
*RANGE: 51
*SECTION: 34
ACRES: 9.13

OWNER NAME: Charles G. & Diane A. Larson
OWNER ADDRESS: 30238 467th Av.
OWNER CITY: Beresford
OWNER STATE: South Dakota
OWNER ZIP: 57004
QUAD NAME: _____

OWNER CODE 1: P
OWNER CODE 2: _____
OWNER CODE 3: _____

HISTORIC SIGNIFICANCE

*DOE: _____
*DOE DATE: _____
REASON INELIGIBLE: _____

REGISTER NAME: _____
MULTIPLE PROPERTY NAME: _____

NOMINATION STATUS: _____
DATE LISTED: _____
REFERENCE NUMBER: _____
HISTORIC DISTRICT RATING: C or NC
PERIOD: _____

CATEGORY: _____
SIGNIFICANCE LEVEL 1: N S L
SIGNIFICANCE LEVEL 2: N S L
CRITERIA 1: A B C D
CRITERIA 2: A B C D
CRITERIA 3: A B C D
CRITERIA 4: A B C D

SIGNIFICANCE NOTES: _____

STRUCTURE DETAILS

**SOUTH DAKOTA STATE HISTORIC PRESERVATION OFFICE
HISTORIC SITES SURVEY STRUCTURE FORM**



SHPO ID: _____
 *PROPERTY NAME: _____
 OTHER NAME: _____

CURRENT FUNCTION: Vacant FOUNDATION: Poured concrete
 CURRENT SUBFUNCTION: Storage ROOF MATERIAL: Steel roofing over cedar shingles
 HISTORIC FUNCTION: Livestock barn ROOF SHAPE: Gable
 HISTORIC SUBFUNCTION: Hay and grain storage STRUCTURAL SYSTEM: Balloon framing
 OCCUPIED: Yes STYLE: Gable roof barn
 Yes with TYPE: Livestock barn
 ACCESSIBLE: Yes with permission WALLS: 2x6 studs and 1x6 #106 drop siding

STORIES: 2 SIGNIFICANT PERSON: Alfred Anderson
 *DATE OF CONSTRUCTION: Early 1920's CULTURAL AFFILIATION: ?

ALTERED/MOVED NOTES: Original site. Steel roofing over the cedar shingles. Any evidence of horse stalls or milk cow stanchions has been removed. One or more of the rows of posts and beams may have been moved or added. Three modern ventilators added to peak, when steel roof was installed.

INTERIOR NOTES: Four rows of 6x6 posts and 6x6 beams. 2x8 floor joists for hayloft floor. 8' x 8' granary still in the center on the West wall. There is a 2x4 solid wall between the south 18' of the barn and the North 28'. There is a 4' gate in this wall.

OTHER NOTES: 2x6 stud walls with 1x6 #106 drop siding. Rafters are 2x6's with double 2x6 posts and a 4x4 beam supporting the center of the rafters. These posts are 10' - 6' - 6' - 8' - 6' - 10' O. C. there is a 2x6 brace from top of wall down to the floor 8' O. C.

*PHYSICAL NOTES: Barn is in fair condition.

*UTM ZONE: _____ *RESTRICTED: Y or N
 *UTM EASTING: _____
 *UTM NORTHING: _____

**SOUTH DAKOTA STATE HISTORIC PRESERVATION OFFICE
HISTORIC SITES SURVEY STRUCTURE FORM**

SKETCH MAP

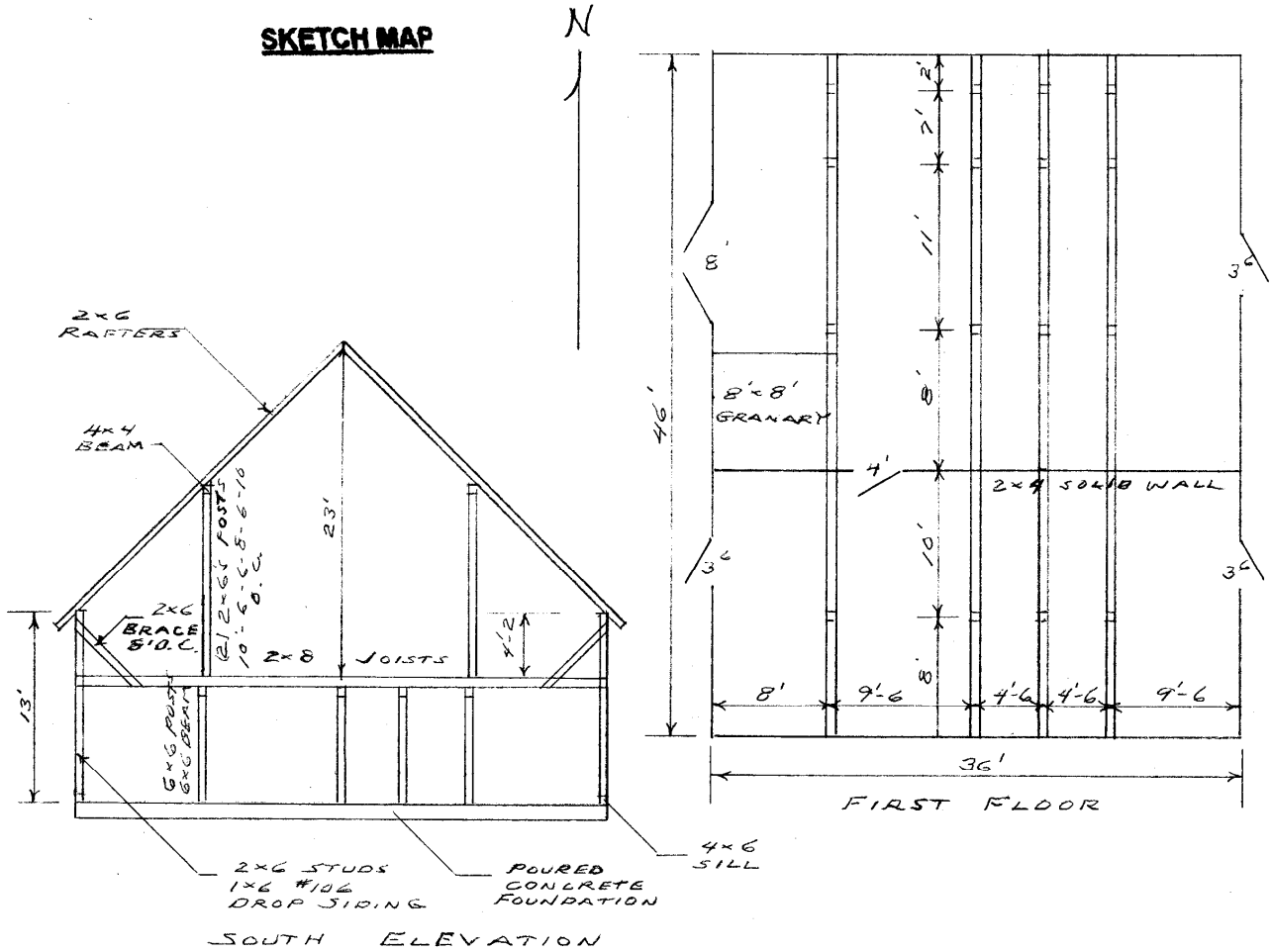

PHOTOGR

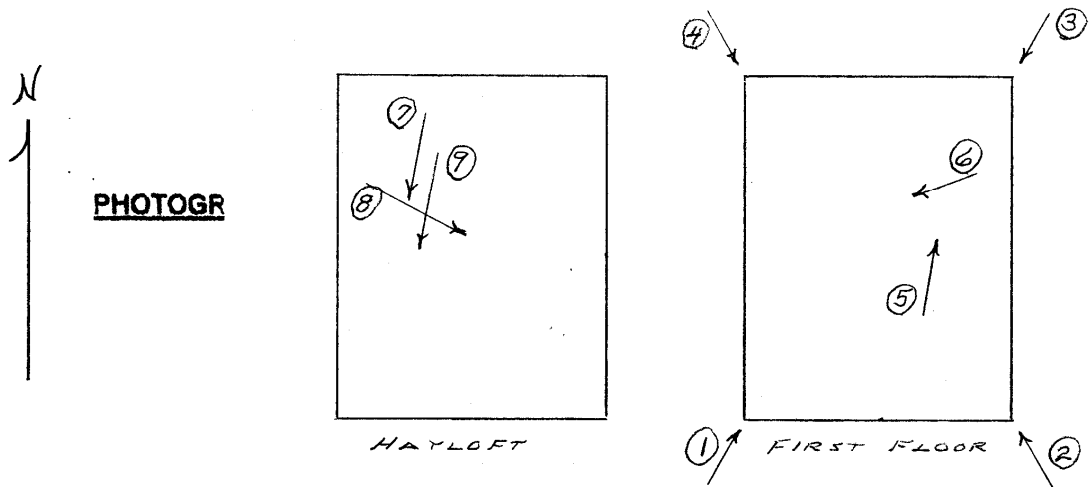

**SOUTH DAKOTA STATE HISTORIC PRESERVATION OFFICE
HISTORIC SITES SURVEY STRUCTURE FORM**



PHOTOGRAPHER: Jim Stone
DATE OF PHOTO: May 16, 2013

ROLL NUMBER: _____
PHOTO NUMBER: 1
CAMERA DIRECTION: Looking NE, SW corner



PHOTOGRAPHER: Jim Stone
DATE OF PHOTO: May 16, 2013

ROLL NUMBER: _____
PHOTO NUMBER: 2
CAMERA DIRECTION: Looking NW, SE corner

**SOUTH DAKOTA STATE HISTORIC PRESERVATION OFFICE
HISTORIC SITES SURVEY STRUCTURE FORM**



PHOTOGRAPHER: Jim Stone
DATE OF PHOTO: May 16, 2013

ROLL NUMBER: _____
PHOTO NUMBER: 4
CAMERA DIRECTION: Looking SW, NE corner



PHOTOGRAPHER: Jim Stone
DATE OF PHOTO: May 16, 2013

ROLL NUMBER: _____
PHOTO NUMBER: 4
CAMERA DIRECTION: Looking SE, NW corner

**SOUTH DAKOTA STATE HISTORIC PRESERVATION OFFICE
HISTORIC SITES SURVEY STRUCTURE FORM**



PHOTOGRAPHER: Jim Stone
DATE OF PHOTO: May 16, 2013

ROLL NUMBER: _____
PHOTO NUMBER: 5

CAMERA DIRECTION: First floor, looking NE, 6x6 posts, 6x6 beam and 2x8 floor joists



PHOTOGRAPHER: Jim Stone
DATE OF PHOTO: May 16, 2013

ROLL NUMBER: _____
PHOTO NUMBER: 6

CAMERA DIRECTION: First floor, looking West, posts and beams and granary on West wall

**SOUTH DAKOTA STATE HISTORIC PRESERVATION OFFICE
HISTORIC SITES SURVEY STRUCTURE FORM**



PHOTOGRAPHER: Jim Stone
DATE OF PHOTO: May 16, 2013

ROLL NUMBER: _____
PHOTO NUMBER: 7

**Hayloft, looking SW, 2x6
rafters with double 2x6
posts and 4x4
supporting center of
rafters**

CAMERA DIRECTION: _____



PHOTOGRAPHER: Jim Stone
DATE OF PHOTO: May 16, 2013

ROLL NUMBER: _____
PHOTO NUMBER: 8

**Hayloft, looking SE, 2x6
posts and 2x6 bracing
from top of wall down to
floor 8' O. C.**

CAMERA DIRECTION: _____

**SOUTH DAKOTA STATE HISTORIC PRESERVATION OFFICE
HISTORIC SITES SURVEY STRUCTURE FORM**



PHOTOGRAPHER: Jim Stone
DATE OF PHOTO: May 16, 2013

ROLL NUMBER: _____
PHOTO NUMBER: 9

CAMERA DIRECTION: Hayloft, looking SW, 2x6
bracing from top of wall
down to floor 8' O. C.,
note diagonal 2x6 brace
on bottom of rafters.

SOUTH DAKOTA STATE HISTORIC PRESERVATION OFFICE
HISTORIC SITES SURVEY STRUCTURE FORM



T-95-N

GLENWOOD DIRECTORY

R-51-W

(Residents - Owners or Renters)

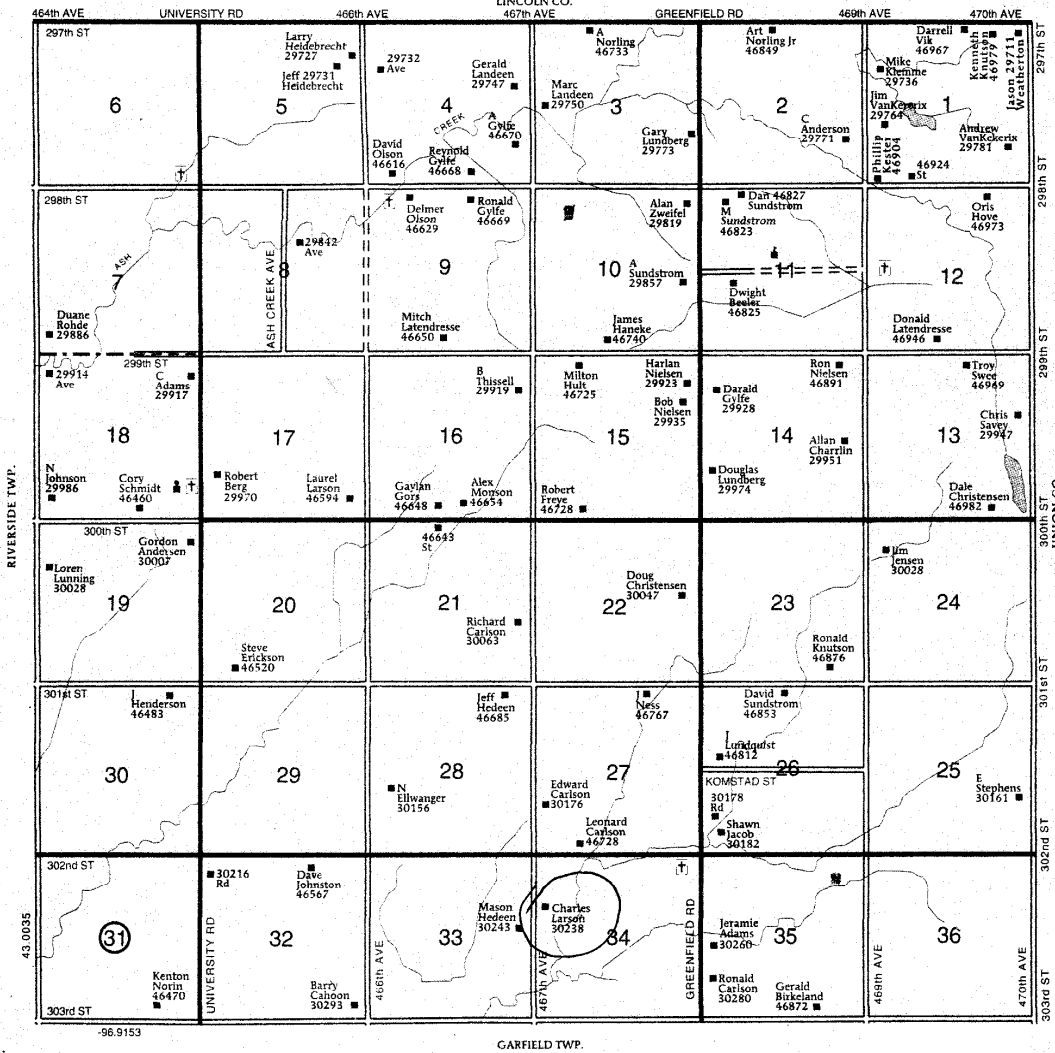

HISTORY

This farm located in the NW ¼ in Section 34, in Glenwood Township, Clay County was homesteaded by Alfred Anderson.

The 1894, 1901, 1912 and 1924 Clay County Atlas lists Alfred Anderson as the owner.

The 1937 Clay County Atlas lists A. A. Anderson as the owner and F. E. Anderson as the operator.

The 1948 Clay County Atlas lists E. T. Anderson as the owner.

The 1956 Clay County Atlas lists W. E. Anderson as the owner.