

**SOUTH DAKOTA STATE HISTORIC PRESERVATION OFFICE
HISTORIC SITES SURVEY STRUCTURE FORM**



SITE INFORMATION

*SURVEY DATE: May 23, 2012 *ADDRESS: 46583 Clay Point St.
*SURVEYOR: Jim Stone *COUNTY: Clay
*CITY: Vermillion

LOCATION DESCRIPTION: From South Dakota Highway 50 bi-pass, take University Road North 8-1/4 Miles to Clay Point Street, turn right (East), about 3/4 mile turn right (South) 1/4 mile driveway

LEGAL DESCRIPTION: S 1/2 SE 1/4 5 - 93 - 51 Prairie Center Twp

*QUARTER 1: SE 1/4 OWNER NAME: F. Arlene Devany
*QUARTER 2: _____ OWNER ADDRESS: 46583 Clay Point Street
*TOWNSHIP: Prairie Center OWNER CITY: Vermillion
*RANGE: 51 OWNER STATE: South Dakota
*SECTION: 5 OWNER ZIP: 57069
ACRES: 80.56 QUAD NAME: _____
OWNER CODE 1: P
OWNER CODE 2: F S L P
OWNER CODE 3: F S L P

HISTORIC SIGNIFICANCE

*DOE: _____ REGISTER NAME: _____
*DOE DATE: _____ MULTIPLE PROPERTY NAME: _____
REASON INELIGIBLE: _____

NOMINATION STATUS: _____ CATEGORY: _____
DATE LISTED: _____ SIGNIFICANCE LEVEL 1: N S L
REFERENCE NUMBER: _____ SIGNIFICANCE LEVEL 2: N S L
HISTORIC DISTRICT RATING: C or NC CRITERIA 1: A B C D
PERIOD: _____ CRITERIA 2: A B C D
CRITERIA 3: A B C D
CRITERIA 4: A B C D

SIGNIFICANCE NOTES: _____
Daniel Ostlund immigrated from Sweden in 1868. Land was homesteaded in 1868 by Daniel Ostlund. Daniel's son Albert Ostlund built this barn. Albert Ostlund's daughter F. Arlene Devany now owns the farm and still lives here. Land has been in the family for 144 years.

**SOUTH DAKOTA STATE HISTORIC PRESERVATION OFFICE
HISTORIC SITES SURVEY STRUCTURE FORM**



STRUCTURE DETAILS

SHPO ID: _____
 *PROPERTY NAME: _____
 OTHER NAME: _____

CURRENT FUNCTION: <u>Vacant</u>	FOUNDATION: <u>Poured concrete</u>
CURRENT SUBFUNCTION: <u>Storage</u>	ROOF MATERIAL: <u>Steel roofing</u>
HISTORIC FUNCTION: <u>Livestock barn</u>	ROOF SHAPE: <u>Gambrel</u>
HISTORIC SUBFUNCTION: <u>Hay and grain storage</u>	STRUCTURAL SYSTEM: <u>Balloon framing</u>
	STYLE: <u>Gambrel roof barn</u>
OCCUPIED: <u>Yes</u>	TYPE: <u>Livestock barn</u>
	<u>2x6, sheathing,</u>
ACCESSIBLE: <u>Yes with permission</u>	WALLS: <u>1/2"x6" cedar lap siding</u>
STORIES: <u>2</u>	SIGNIFICANT PERSON: <u>Albert Ostlund</u>
*DATE OF CONSTRUCTION: <u>1936</u>	CULTURAL AFFILIATION: <u>Swedish</u>

ALTERED/MOVED NOTES: Original site. Cedar shingles removed and steel roofing installed on the roof.

INTERIOR NOTES: 6x6 posts 8' O. C. with (3) 2x8's for a beam 12' in from the East wall. 32" in from the West wall (2) 2x6's with (2) 2x4's for a beam and 12' in from the West wall (2) 2x6's 4'-10" O. C. with (3) 2x8's for a beam. 2x8 floor joists 24" O. C.

OTHER NOTES: 2x6 walls 7'-7" high with 4x6 sill on the East and West walls. 2x6 walls 14' high in the center 12' on the gable ends. 2x6 walls on each side and 2x6 walls above the 14' walls. Horizontal sheathing with 1/2"x6" cedar lap siding. Rafters are 2x6. Roof hip is supported with (2) 2x6's 10' O. C. with (2) 2x6 for a beam. These 2x6 posts are nailed one each side of the floor joist and have short 2x6 spacer blocks in the hayloft. Windows are 9"x12" four light on the East and West. 9"x12" 6 light windows in the gable ends and in the hayloft. Metal cupola.

*PHYSICAL NOTES: Barn in very good condition. Original milk cow stanchions are still in place. Six single horse stalls and 6'x10' granary still in place on the West side. 5'x8' milk room, calf pen and milk cow stanchions are along the East side. Rough sawn 2x8 floor in all horse stalls. Concrete floor in the rest of the barn with a gutter behind milk cows.

**SOUTH DAKOTA STATE HISTORIC PRESERVATION OFFICE
HISTORIC SITES SURVEY STRUCTURE FORM**

SKETCH MAP

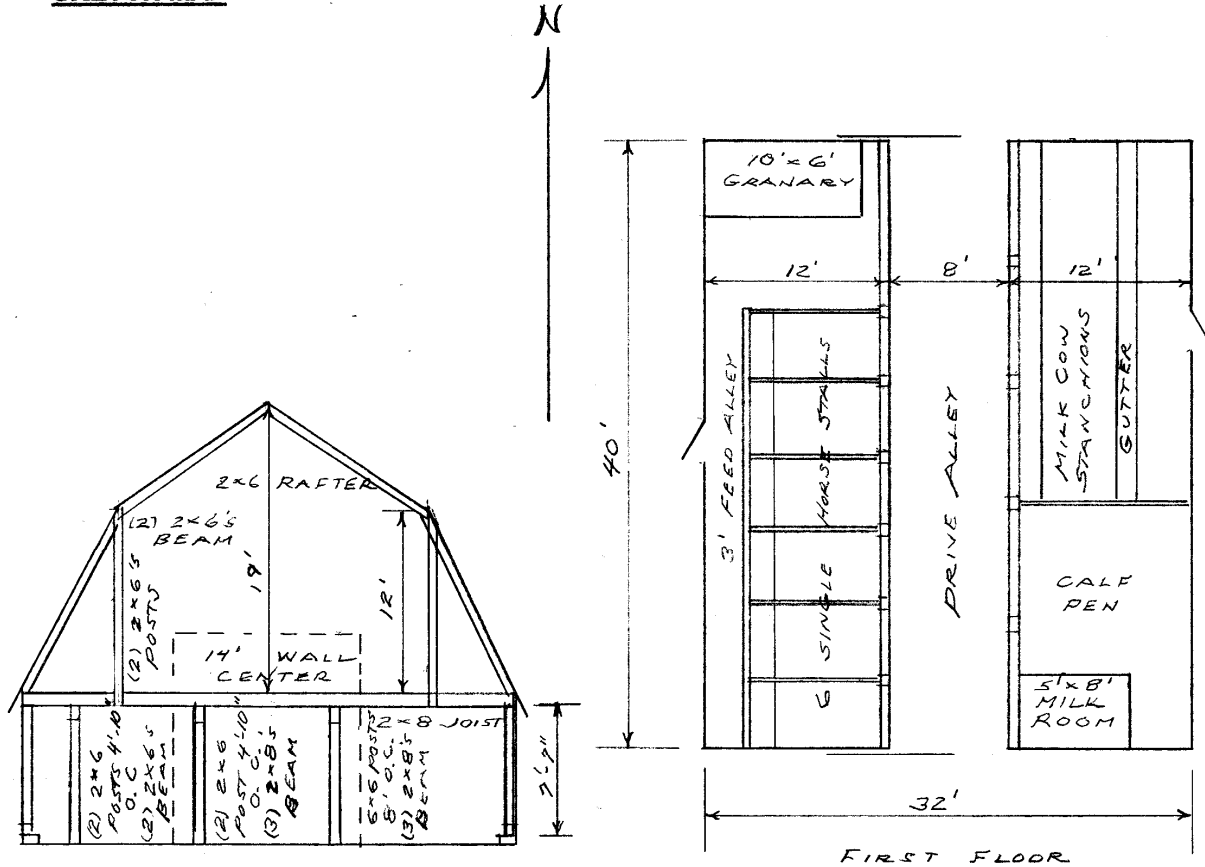

PHOTOGR

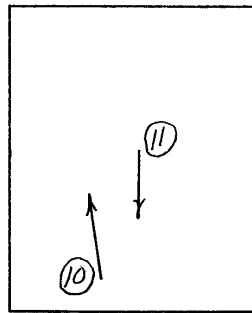

HAYLOFT

* = REQUIRED FIELD

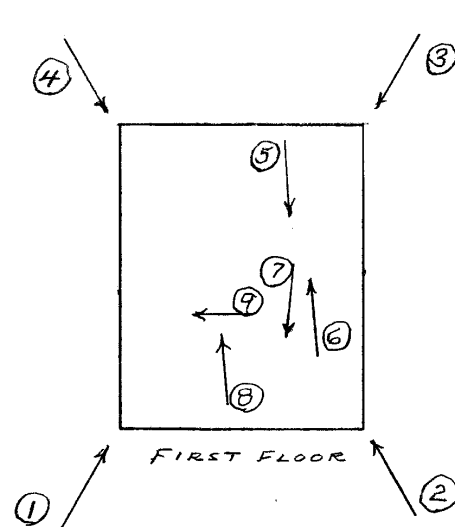

FIRST FLOOR

**SOUTH DAKOTA STATE HISTORIC PRESERVATION OFFICE
HISTORIC SITES SURVEY STRUCTURE FORM**



PHOTOGRAPHER: Jim Stone
DATE OF PHOTO: May 23, 2012

ROLL NUMBER: _____
PHOTO NUMBER: 1
CAMERA DIRECTION: Looking NE, SW corner



PHOTOGRAPHER: Jim Stone
DATE OF PHOTO: May 23, 2012

ROLL NUMBER: _____
PHOTO NUMBER: 2
CAMERA DIRECTION: Looking NW, SE corner

**SOUTH DAKOTA STATE HISTORIC PRESERVATION OFFICE
HISTORIC SITES SURVEY STRUCTURE FORM**



PHOTOGRAPHER: Jim Stone
DATE OF PHOTO: May 23, 2012

ROLL NUMBER: _____
PHOTO NUMBER: 3
CAMERA DIRECTION: Looking SW, NE corner



PHOTOGRAPHER: Jim Stone
DATE OF PHOTO: May 23, 2012

ROLL NUMBER: _____
PHOTO NUMBER: 4
CAMERA DIRECTION: Looking SE, NW corner

**SOUTH DAKOTA STATE HISTORIC PRESERVATION OFFICE
HISTORIC SITES SURVEY STRUCTURE FORM**



PHOTOGRAPHER: Jim Stone
DATE OF PHOTO: May 23, 2012

ROLL NUMBER: _____
PHOTO NUMBER: 5
CAMERA DIRECTION: First floor, looking
South, East post & beam



PHOTOGRAPHER: Jim Stone
DATE OF PHOTO: May 23, 2012

ROLL NUMBER: _____
PHOTO NUMBER: 6
CAMERA DIRECTION: First floor, Looking
North, milk cow
stanchions

**SOUTH DAKOTA STATE HISTORIC PRESERVATION OFFICE
HISTORIC SITES SURVEY STRUCTURE FORM**



PHOTOGRAPHER: Jim Stone
DATE OF PHOTO: May 23, 2012

ROLL NUMBER: _____
PHOTO NUMBER: 7

CAMERA DIRECTION: First Floor, looking South, calf pens & milk room



PHOTOGRAPHER: Jim Stone
DATE OF PHOTO: May 23, 2012

ROLL NUMBER: _____
PHOTO NUMBER: 8

CAMERA DIRECTION: First floor, looking North, single horse stalls

**SOUTH DAKOTA STATE HISTORIC PRESERVATION OFFICE
HISTORIC SITES SURVEY STRUCTURE FORM**



PHOTOGRAPHER: Jim Stone
DATE OF PHOTO: May 23, 2012

ROLL NUMBER: _____
PHOTO NUMBER: 9

CAMERA DIRECTION: First floor, looking West,
single horse stall



PHOTOGRAPHER: Jim Stone
DATE OF PHOTO: May 23, 2012

ROLL NUMBER: _____
PHOTO NUMBER: 10

CAMERA DIRECTION: Hayloft, looking North,
2x6 post & beam
supporting roof hip

**SOUTH DAKOTA STATE HISTORIC PRESERVATION OFFICE
HISTORIC SITES SURVEY STRUCTURE FORM**



PHOTOGRAPHER: Jim Stone
DATE OF PHOTO: May 23, 2012

ROLL NUMBER: _____
PHOTO NUMBER: 11
CAMERA DIRECTION: Hayloft, looking South

**SOUTH DAKOTA STATE HISTORIC PRESERVATION OFFICE
HISTORIC SITES SURVEY STRUCTURE FORM**



T-93-N PRAIRIE CENTER DIRECTORY R-51-W

(Residents - Owners or Renters)

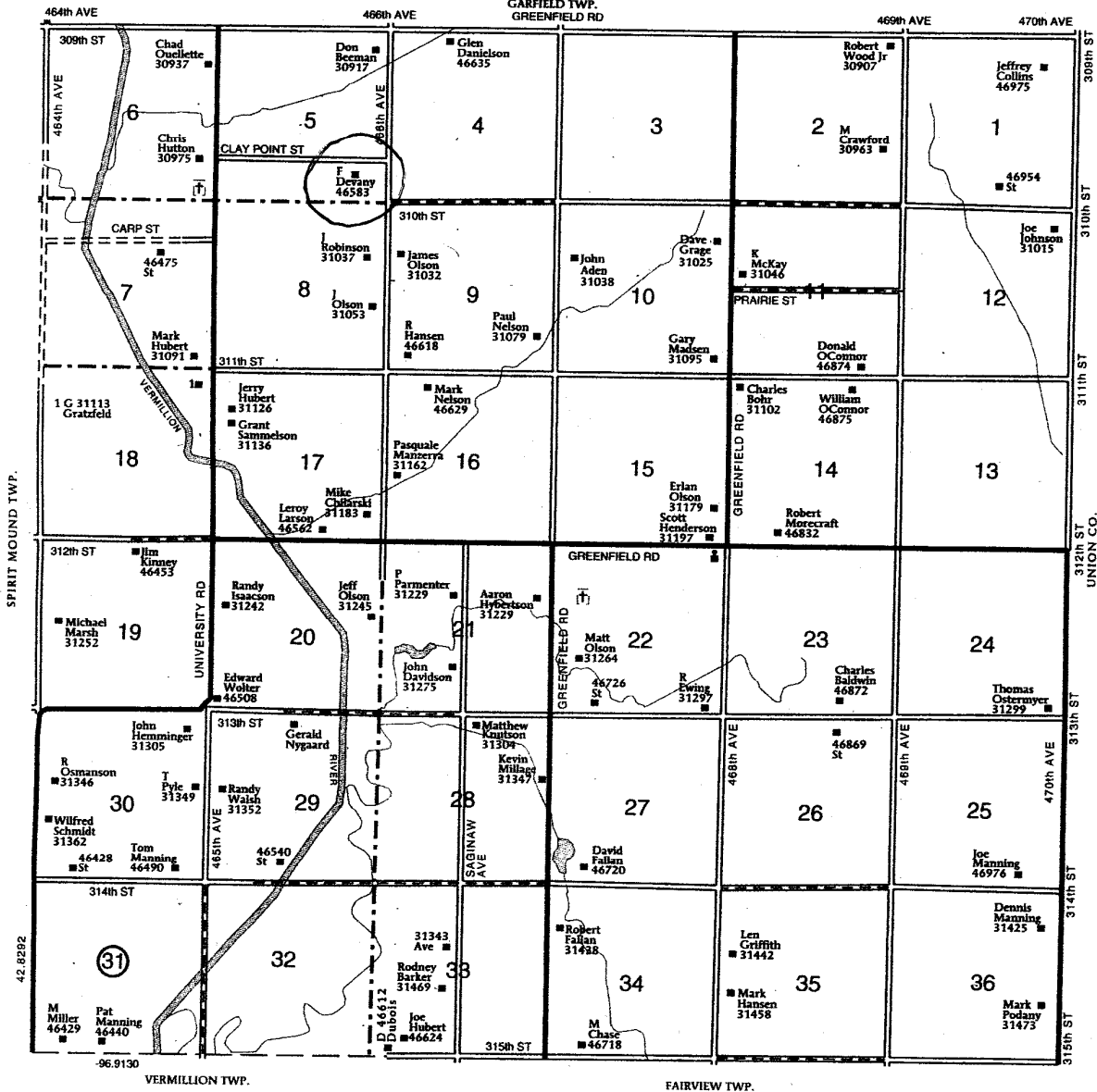

HISTORY

This farm located in the S ½ of the SE ¼ of section 5, Prairie Center Township, Clay County was homesteaded by Hans Ostlund.

The 1894, 1901 and 1912 Clay County Atlas lists Daniel Ostlund as the owner.

The 1924, 1937, 1948 and 1956 Clay County Atlas lists Albert Ostlund as the owner.

The Following is from
Arlene (Ostlund) DeVany

Daniel Ostlund was born May 8, 1844 in Svardsjo, Dalarno, Sweden. He immigrated to the United States of America in 1868. He came to Clay County, South Dakota and homesteaded the South ½ of the SE ¼ of Section 5 and the North ½ of the NE ¼ of Section 8 in Prairie Township in 1868. The two 80 acre's join each other on the section line.

He married Brita Erickson in March, 1872. She was born August 15, 1847 in Sweden. Brita immigrated with her parents to the United States on May 19, 1870. Their son Albert Ostlund was born on the farm in 1886. He farmed and lived here all of his life. He built this barn in 1936. We do not know what the original barn looked like.



Daniel and Brita Ostlund Original picture and original ornate frame

Albert married Etta Bernice Ellison Jan 7, 1925. Etta was born January 16, 1894. She was Norwegian. Their daughter is F. Arlene (Ostlund) Devany.

**SOUTH DAKOTA STATE HISTORIC PRESERVATION OFFICE
HISTORIC SITES SURVEY STRUCTURE FORM**



Arlene married Jack Devany. Jack was an attorney in Vermillion, but they lived on the farm after Albert died in May 1972 at 86 years of age.

Daniel Ostlund died July 1895 from sun stroke
Britta (Erickson) Ostlund died January 1921
Albert Ostlund Died May 1972
Etta Bernice (Ellison) Ostlund died May 1961