

**SOUTH DAKOTA STATE HISTORIC PRESERVATION OFFICE
HISTORIC SITES SURVEY STRUCTURE FORM**



SITE INFORMATION

*SURVEY DATE: May 10, 2014 *ADDRESS: 31362 463rd Ave.
*SURVEYOR: Jim Stone *COUNTY: Clay
*CITY: Vermillion

LOCATION DESCRIPTION: From Vermillion, intersection of South Dakota Highway 50 bi-pass and South Dakota Highway 19, North 3 miles, to 314th Street, turn right (East) 1/2 mile to 463rd Ave., turn left (North) about 1/3 mile, on the right (East) side.

LEGAL DESCRIPTION: W 50 A of the North 1/2, SW 1/4, Exc W 25 A, 25 -95 - 52 Spirit Mound Twp.

*QUARTER 1: SW 1/4 OWNER NAME: Harry L. Scholten
*QUARTER 2: _____ OWNER ADDRESS: P O Box 110
*TOWNSHIP: Spirit Mound OWNER CITY: Vermillion
*RANGE: 52 OWNER STATE: South Dakota
*SECTION: 25 OWNER ZIP: 57069
ACRES: 25.43 QUAD NAME: _____
OWNER CODE 1: P
OWNER CODE 2:
OWNER CODE 3:

HISTORIC SIGNIFICANCE

*DOE: _____ REGISTER NAME: _____
*DOE DATE: _____ MULTIPLE PROPERTY NAME: _____
REASON INELIGIBLE: _____

NOMINATION STATUS: _____ CATEGORY: _____
DATE LISTED: _____ SIGNIFICANCE LEVEL 1: N S L
REFERENCE NUMBER: _____ SIGNIFICANCE LEVEL 2: N S L
HISTORIC DISTRICT RATING: C or NC CRITERIA 1: A B C D
PERIOD: _____ CRITERIA 2: A B C D
CRITERIA 3: A B C D
CRITERIA 4: A B C D

SIGNIFICANCE NOTES: _____

STRUCTURE DETAILS

* = REQUIRED FIELD

**SOUTH DAKOTA STATE HISTORIC PRESERVATION OFFICE
HISTORIC SITES SURVEY STRUCTURE FORM**



SHPO ID: _____
 *PROPERTY NAME: _____
 OTHER NAME: _____

CURRENT FUNCTION:	<u>Vacant</u>	FOUNDATION:	<u>Original native stone, replaced with brick</u>
CURRENT SUBFUNCTION:	<u>Vacant</u>	ROOF MATERIAL:	<u>Cedar shingles</u>
HISTORIC FUNCTION:	<u>Horse barn</u>	ROOF SHAPE:	<u>Gable roof</u>
HISTORIC SUBFUNCTION:	<u>Hay and grain storage</u>	STRUCTURAL SYSTEM:	<u>Balloon framing</u>
		STYLE:	<u>Western Feeder barn</u>
OCCUPIED:	<u>Yes</u>	TYPE:	<u>Livestock barn</u>
	<u>Yes with</u>		<u>2x6 studs, 1x6 #106</u>
ACCESSIBLE:	<u>permission</u>	WALLS:	<u>drop siding</u>
STORIES:	<u>2</u>	SIGNIFICANT PERSON:	<u>A. O. Hancock</u>
*DATE OF CONSTRUCTION:	<u>1910 to 1920</u>	CULTURAL AFFILIATION:	<u>?</u>

ALTERED/MOVED NOTES: Original site. Some of horse stalls have been removed. Original foundation was native stone without any mortar. Dirt floors were excavated in the lean-tos when the native stone foundation walls were replaced with three foot high brick foundation walls.

INTERIOR NOTES: One row of 4x4 posts 10' O. C. with a 4x6 beam, 2x6 stud walls on the East and West sides of the center 20' of the barn, 2x8 floor joists 16" O. C. for first floor and 2x8 joists 24" O. C. for the hayloft floor. The 2x6 stud walls are covered with 1x8 shiplap up to the hayloft floor and open studs in the hayloft. West 10' of the center area of the barn is grain bins and the East 10' is a drive alley.

OTHER NOTES: 2X6 stud walls with 1x6 #106 drop siding on all four exterior walls. Windows are 8"x10" four light. Rafters are 2x6's on both lean-tos and the center part of the barn with no bracing. Foundation walls have collapsed under the first floor in the Northwest part of the center 20' causing the floor to fall down and breaking a lot of the hayloft floor joists above the same area.

***PHYSICAL NOTES:** Barn is in poor condition. ***RESTRICTED:** Y or N
***UTM EASTING:** _____
***UTM NORTHING:** _____

**SOUTH DAKOTA STATE HISTORIC PRESERVATION OFFICE
HISTORIC SITES SURVEY STRUCTURE FORM**



SKETCH MAP

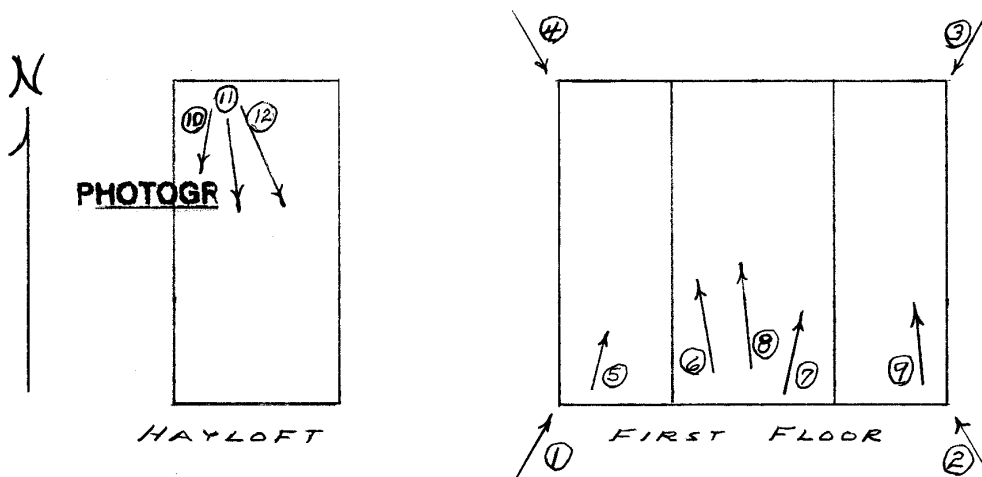
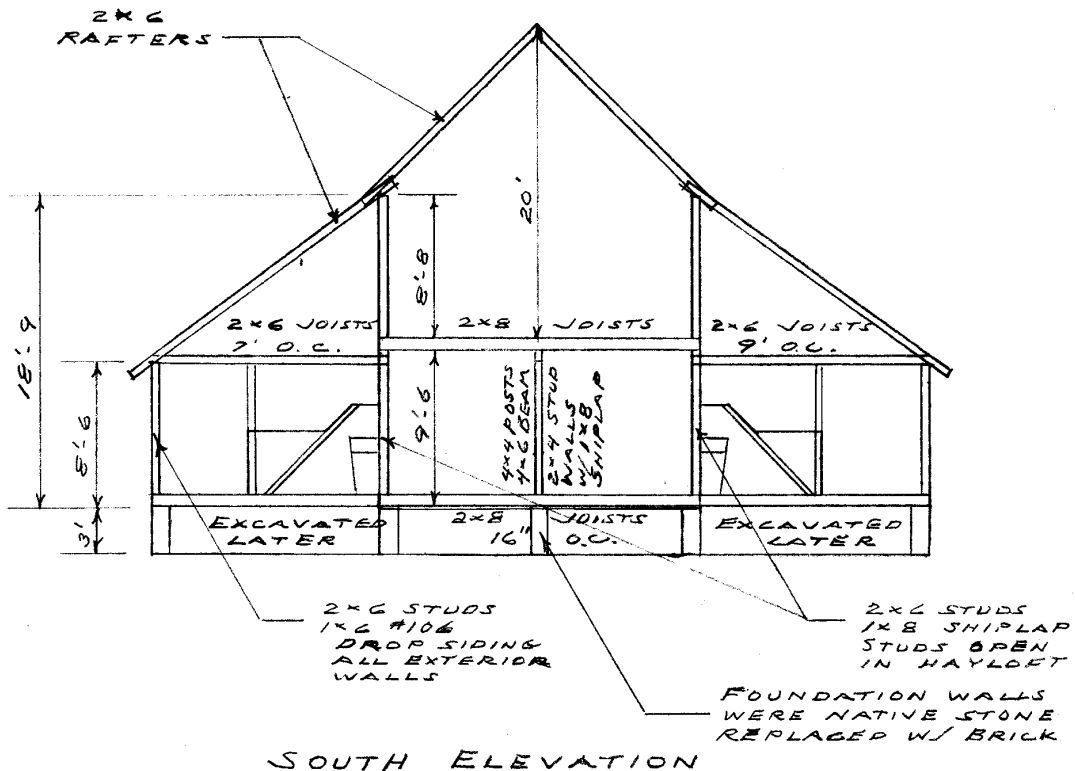

* = REQUIRED FIELD

SOUTH DAKOTA STATE HISTORIC PRESERVATION OFFICE
 HISTORIC SITES SURVEY STRUCTURE FORM



SKETCH MAP

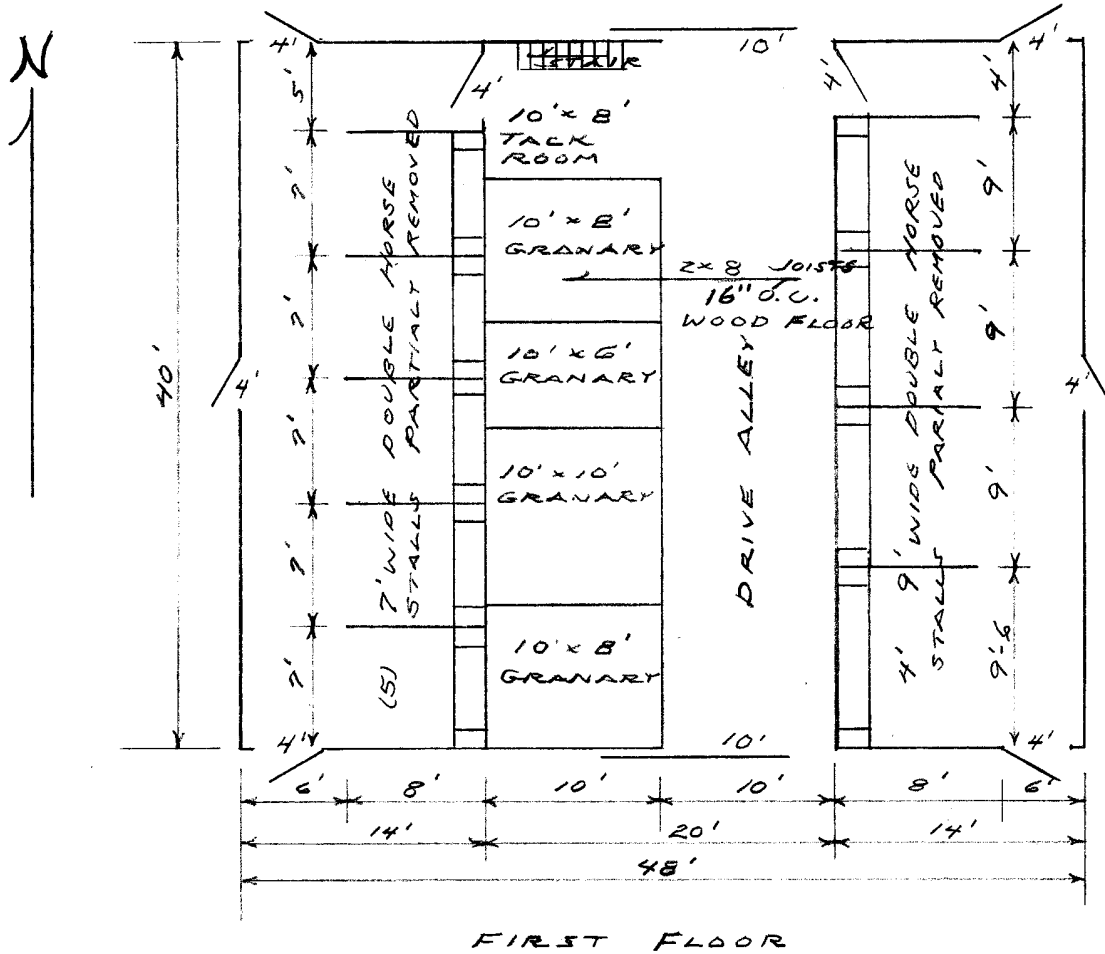

PHOTOGR

* = REQUIRED FIELD

**SOUTH DAKOTA STATE HISTORIC PRESERVATION OFFICE
HISTORIC SITES SURVEY STRUCTURE FORM**



PHOTOGRAPHER: Jim Stone
DATE OF PHOTO: May 10, 2014

ROLL NUMBER: _____
PHOTO NUMBER: 1
CAMERA DIRECTION: Looking NE, SW corner



PHOTOGRAPHER: Jim Stone
DATE OF PHOTO: May 10, 2014

ROLL NUMBER: _____
PHOTO NUMBER: 2
CAMERA DIRECTION: Looking NW, SE corner

* = REQUIRED FIELD

**SOUTH DAKOTA STATE HISTORIC PRESERVATION OFFICE
HISTORIC SITES SURVEY STRUCTURE FORM**



PHOTOGRAPHER: Jim Stone
DATE OF PHOTO: May 10, 2014

ROLL NUMBER: _____
PHOTO NUMBER: 3
CAMERA DIRECTION: Looking SW, NE corner



PHOTOGRAPHER: Jim Stone
DATE OF PHOTO: May 10, 2014

ROLL NUMBER: _____
PHOTO NUMBER: 4
CAMERA DIRECTION: Looking SE, NW corner

* = REQUIRED FIELD

**SOUTH DAKOTA STATE HISTORIC PRESERVATION OFFICE
HISTORIC SITES SURVEY STRUCTURE FORM**



PHOTOGRAPHER: Jim Stone
DATE OF PHOTO: May 10, 2014

ROLL NUMBER: _____
PHOTO NUMBER: 5

CAMERA DIRECTION: First floor, looking NE in West lean-to, 7' wide double horse stalls



PHOTOGRAPHER: Jim Stone
DATE OF PHOTO: May 10, 2014

ROLL NUMBER: _____
PHOTO NUMBER: 6

CAMERA DIRECTION: First floor, looking NW, East solid wall on the East side of drive alley, first floor and hayloft floor have collapsed.

* = REQUIRED FIELD

**SOUTH DAKOTA STATE HISTORIC PRESERVATION OFFICE
HISTORIC SITES SURVEY STRUCTURE FORM**



PHOTOGRAPHER: Jim Stone
DATE OF PHOTO: May 10, 2014

ROLL NUMBER: 7
PHOTO NUMBER: 7

**First floor, looking NE
at granaries on East
side of the center 20' of
barn**

CAMERA DIRECTION: barn



PHOTOGRAPHER: Jim Stone
DATE OF PHOTO: May 10, 2014

ROLL NUMBER: 8
PHOTO NUMBER: 8

**First floor, looking North,
brick foundation walls
collapsed and the floor
fell down about 3 feet.**

CAMERA DIRECTION: fell down about 3 feet.

**SOUTH DAKOTA STATE HISTORIC PRESERVATION OFFICE
HISTORIC SITES SURVEY STRUCTURE FORM**



PHOTOGRAPHER: Jim Stone
DATE OF PHOTO: May 10, 2014

ROLL NUMBER: _____
PHOTO NUMBER: 9

CAMERA DIRECTION: First floor, looking NW in East lean-to, 9' wide double horse stalls



PHOTOGRAPHER: Jim Stone
DATE OF PHOTO: May 10, 2014

ROLL NUMBER: _____
PHOTO NUMBER: 10

CAMERA DIRECTION: Hayloft, looking SW, open 2x6 stud wall supporting the rafters between the center 20' barn and the West lean-to

* = REQUIRED FIELD

**SOUTH DAKOTA STATE HISTORIC PRESERVATION OFFICE
HISTORIC SITES SURVEY STRUCTURE FORM**



PHOTOGRAPHER: Jim Stone
DATE OF PHOTO: May 10, 2014

ROLL NUMBER: _____
PHOTO NUMBER: 11

CAMERA DIRECTION: Hayloft, looking South, 2x6 rafters and peak in hayloft.



PHOTOGRAPHER: Jim Stone
DATE OF PHOTO: May 10, 2014

ROLL NUMBER: _____
PHOTO NUMBER: 12

CAMERA DIRECTION: Hayloft, looking SE, open 2x6 wall supporting the rafters between center 20' barn and the East Lean-to

**SOUTH DAKOTA STATE HISTORIC PRESERVATION OFFICE
HISTORIC SITES SURVEY STRUCTURE FORM**

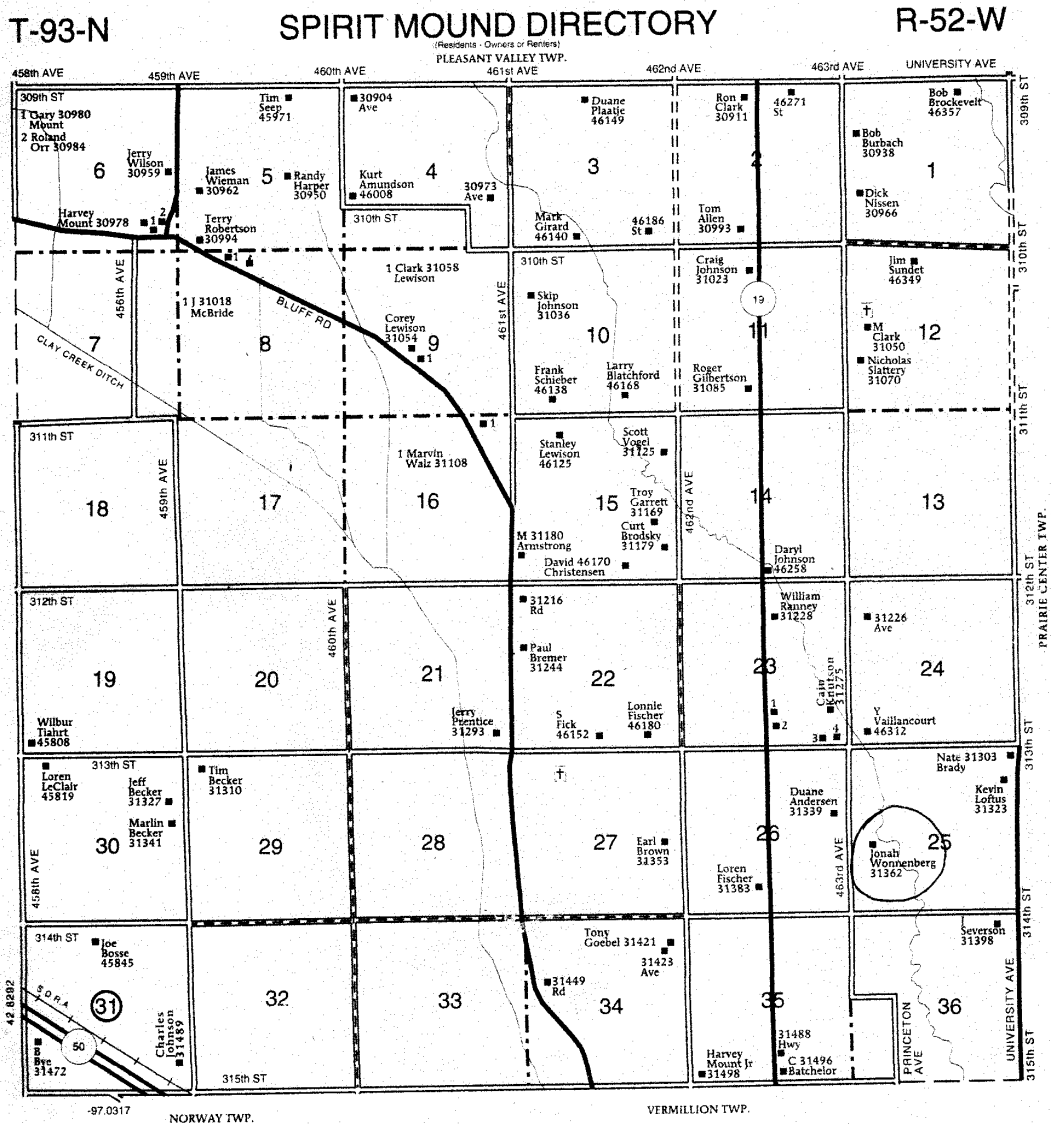

**SPIRIT MOUND
TOWNSHIP
SECTION 23**

- 1 McDonald, Ben 31284
- 2 Freidel, Mike 31288
- 3 46292
- 4 Wood, Robert 46296

© Farm & Home Publishers, Ltd.

* = REQUIRED FIELD

HISTORY

This farm located in the SW¹/₄ of Section 25, Spirit Mound Township, Clay County was homesteaded by Zararias Ester.

The 1894, 1901, 1912 and 1924 Clay County Atlas lists A. O. Hancock as the owner.

The 1937 Clay County Atlas lists Louise Eberhart as the owner and L. Hancock was listed as the operator (renter).

The 1948 and 1956 Clay County Atlas lists Len Scholten as the owner.