

**SOUTH DAKOTA STATE HISTORIC PRESERVATION OFFICE
HISTORIC SITES SURVEY STRUCTURE FORM**



SITE INFORMATION

*SURVEY DATE: October 25, 2013 *ADDRESS: 46775 313th Street
*SURVEYOR: Jim Stone *COUNTY: Clay
*CITY: Vermillion

LOCATION DESCRIPTION: From Vermillion, east 2 miles on South Dakota Highway 50 to Greenfield Road, turn left (North) about 4 -1/2 miles to 313th Street, turn right about 3/4 mile on the right (South) side, long lane.

LEGAL DESCRIPTION: W 1/2, NE 1/4, 27 - 93 - 51 Prairie Center Twp.

*QUARTER 1: NE 1/4 OWNER NAME: Gary A. Stensaas
*QUARTER 2: _____ OWNER NAME: C-D Roger Stensaas
*TOWNSHIP: Prairie Center OWNER ADDRESS: 7500 E. Palomino Road
*RANGE: 51 OWNER CITY: Sioux Falls
*SECTION: 27 OWNER STATE: So. Dak.
ACRES: 80.08 OWNER ZIP: 57110
QUAD NAME: _____

OWNER CODE 1: P
OWNER CODE 2:
OWNER CODE 3:

HISTORIC SIGNIFICANCE

*DOE: _____ REGISTER NAME: _____
*DOE DATE: _____ MULTIPLE PROPERTY NAME: _____
REASON INELIGIBLE: _____

NOMINATION STATUS: _____ CATEGORY: _____
DATE LISTED: _____ SIGNIFICANCE LEVEL 1: N S L
REFERENCE NUMBER: _____ SIGNIFICANCE LEVEL 2: N S L
HISTORIC DISTRICT RATING: C or NC CRITERIA 1: A B C D
PERIOD: _____ CRITERIA 2: A B C D
CRITERIA 3: A B C D
CRITERIA 4: A B C D

SIGNIFICANCE NOTES: _____

**SOUTH DAKOTA STATE HISTORIC PRESERVATION OFFICE
HISTORIC SITES SURVEY STRUCTURE FORM**



STRUCTURE DETAILS

SHPO ID: _____
 *PROPERTY NAME: _____
 OTHER NAME: _____

CURRENT FUNCTION: <u>Vacant</u>	FOUNDATION: <u>Native stone and poured concrete</u>
CURRENT SUBFUNCTION: <u>Vacant</u>	ROOF MATERIAL: <u>Cedar shingles</u>
HISTORIC FUNCTION: <u>Horse barn</u>	ROOF SHAPE: <u>Gambrel roof</u>
HISTORIC SUBFUNCTION: <u>Hay & grain storage</u>	STRUCTURAL SYSTEM: <u>Balloon framing</u>
OCCUPIED: <u>No</u>	STYLE: <u>Gambrel roof barn</u>
ACCESSIBLE: <u>Yes with permission</u>	TYPE: <u>Horse barn</u>
	<u>2x6 studs, 1x8 shiplap, 1/2"x6" cedar lap siding</u>
STORIES: <u>2</u>	WALLS: _____
*DATE OF CONSTRUCTION: <u>1925</u>	SIGNIFICANT PERSON: <u>Andrew Stensaas</u>
	CULTURAL AFFILIATION: <u>Norwegian</u>

ALTERED/MOVED NOTES: Original site. Five double horse stalls still in place. Original foundation was native stone without mortar and a 4x6 sill. Poured concrete on the outside of original native stone foundation and some of the concrete is crumbling.

INTERIOR NOTES: Two rows of 6x6 posts with 6x6's for beams and two rows of 4x6 posts with 6x6 beams on each side of center feed alley. The beams support 2x8 joists for hayloft floor and run East to West with the long axis of the barn. 2x6 rafters with two 2x6-s for a beam at the hip. 2x6 bracing from the center of the top rafter down to the exterior wall at the hayloft floor level 8' O. C. and a 2x6 brace from the center of the lower rafter down to the exterior wall at the hayloft floor level 2' O. C. And a 2x6 brace on the hip 2' O. C.

OTHER NOTES: 2x6 stud walls with 1x8 shiplap and 1/2"x6" cedar lap siding on all four walls. Original cupola still in place. The cupola has star cut outs on the wind band, which makes it different from all of the other cupola's seen in Clay County. Windows were 9"x 12" four light.

*PHYSICAL NOTES: Barn is in poor condition. *RESTRICTED: Y or N
 *UTM EASTING: _____
 *UTM NORTHING: _____

**SOUTH DAKOTA STATE HISTORIC PRESERVATION OFFICE
HISTORIC SITES SURVEY STRUCTURE FORM**

SKETCH MAP

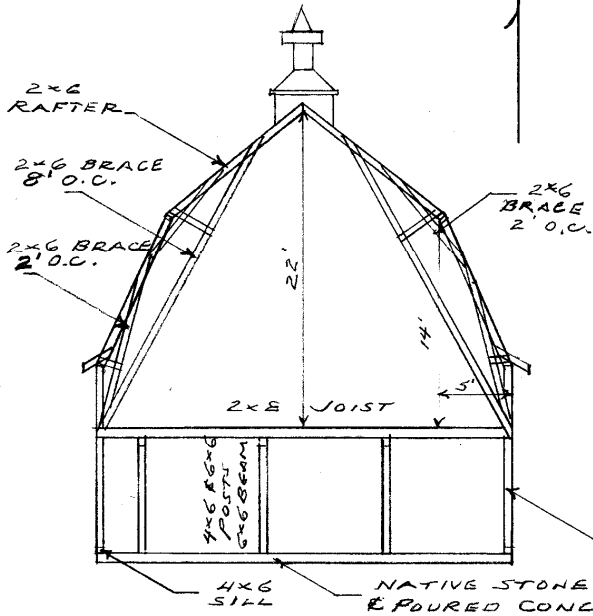

EAST ELEVATION

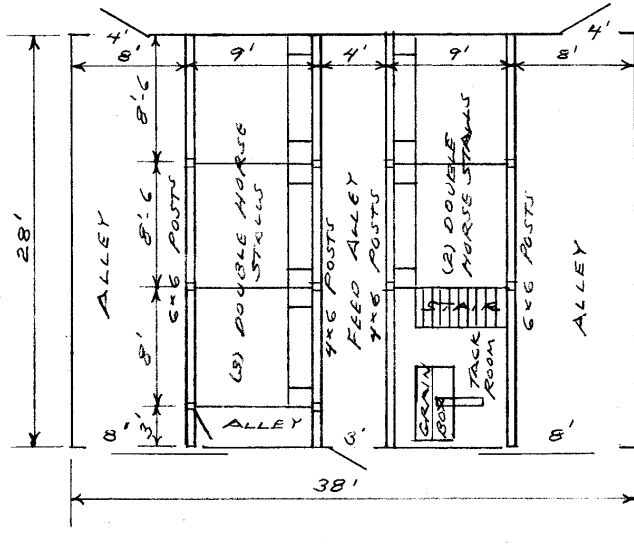

FIRST FLOOR

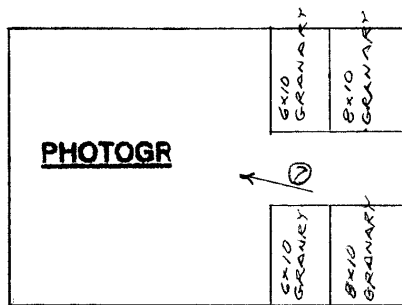

HAYLOFT

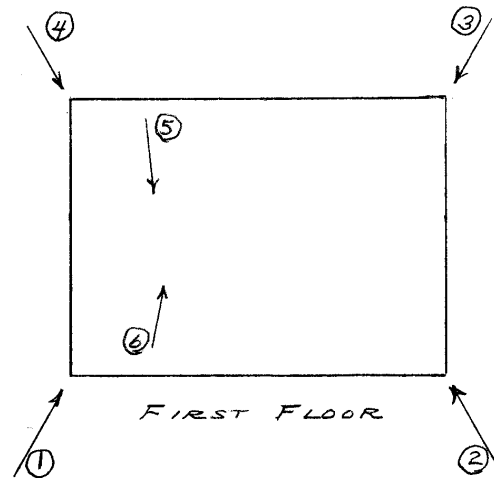

**SOUTH DAKOTA STATE HISTORIC PRESERVATION OFFICE
HISTORIC SITES SURVEY STRUCTURE FORM**



PHOTOGRAPHER: Jim Stone
DATE OF PHOTO: September 3, 2013

ROLL NUMBER: _____
PHOTO NUMBER: 1
CAMERA DIRECTION: Looking NE, SW corner



PHOTOGRAPHER: Jim Stone
DATE OF PHOTO: September 3, 2013

ROLL NUMBER: _____
PHOTO NUMBER: 2
CAMERA DIRECTION: Looking NW, SE corner

**SOUTH DAKOTA STATE HISTORIC PRESERVATION OFFICE
HISTORIC SITES SURVEY STRUCTURE FORM**



PHOTOGRAPHER: Jim Stone
DATE OF PHOTO: September 3, 2013

ROLL NUMBER: _____
PHOTO NUMBER: 3
CAMERA DIRECTION: Looking SW, NE corner



PHOTOGRAPHER: Jim Stone
DATE OF PHOTO: September 3, 2013

ROLL NUMBER: _____
PHOTO NUMBER: 4
CAMERA DIRECTION: Looking SE, NW corner

**SOUTH DAKOTA STATE HISTORIC PRESERVATION OFFICE
HISTORIC SITES SURVEY STRUCTURE FORM**



PHOTOGRAPHER: Jim Stone
DATE OF PHOTO: October 25, 2013

ROLL NUMBER: _____
PHOTO NUMBER: 5

CAMERA DIRECTION: First floor, looking SE at double horse stalls on West side



PHOTOGRAPHER: Jim Stone
DATE OF PHOTO: October 25, 2013

ROLL NUMBER: _____
PHOTO NUMBER: 6

CAMERA DIRECTION: First floor, looking NE, 6x6 posts, 4x6 beam, 2x8 floor joists, double horse stalls on West side.

**SOUTH DAKOTA STATE HISTORIC PRESERVATION OFFICE
HISTORIC SITES SURVEY STRUCTURE FORM**



PHOTOGRAPHER: Jim Stone
DATE OF PHOTO: October 25, 2013

ROLL NUMBER: _____
PHOTO NUMBER: 7

Hayloft, looking NW, 2x6 rafters, double 2x6 beam at the hip, 2x6 bracing from top and bottom rafters down to exterior wall at hayloft floor level, and 2x6 bracing on each hip.

CAMERA DIRECTION: _____

History

This farm located in the NE ¼ of Section 27, Prairie Center Township, Clay County was homesteaded by Jorgen Nielson.

The 1894 and 1901 Clay County Atlas lists J. Jorgenson as the owner

The 1912, 1924 and 1937 Clay County Atlas lists Andrew Stensaas as the owner.

The 1948 and 1956 Clay County Atlas lists Arnold Stensaas as the owner.

History as per Richard Stensaas October 28, 2013

Andrew Stensaas immigrated to the United States with his parents in the 1890's. Two of his brothers who also immigrated were Even and Jens. Jens did not come to South Dakota. He stayed in Pennsylvania and worked in the mines. The rest of the family settled at Centerville, South Dakota. In 1900 Andrew went back to Norway to bring his bride-to-be back to the United States. Anne Rofstad left her family when she came to the United States. Her family remained in Norway and did not immigrate. They were married at Centerville, So. Dak. in 1900. They moved to Section 16 in Prairie Center Township where Andrew rented a farm. In 1903 Andrew bought the W ½ of the NE ¼ (80 acres) in Section 27, Prairie Center Township. This is where they made their home.

They built the large home in 1916 that still stands today. In 1925 they built the barn that also still stands today. The house was built by a Norwegian carpenter, who worked alone. He lived with the family while he was building the house. It took him two years to complete the house. He may have built the barn.

**SOUTH DAKOTA STATE HISTORIC PRESERVATION OFFICE
HISTORIC SITES SURVEY STRUCTURE FORM**



Later Andrew Stensaas also bought the farm that Even Stensaas, Andrew's brother, owned just northwest of where they lived. This farm was located in the SW ¼ of Section 22, Prairie Center Township and was 160 acres.

In 1930 Andrew Stensaas and his wife Anne went back to Norway to visit her family. Her father was 96 years old at the time. He died two months later.